



[Home](#) » [ZZPLAY](#) » **ZZPLAY ITZ-MYLINK Integration For GM Vehiclesequipped With IO5 or IO6 System User Guide** 



**Advanced CarPlay/Android Auto
integration for GM vehicles equipped
with IO5 or IO6 system**

**Wireless CarPlay / Android Auto + Camera input for
GM vehicles equipped with the IO5/IO6 System**



Contents [[hide](#)]

- 1 Kit Components:
- 2 Installation Diagram:
- 3 Radio Tuner location:
- 4 HMI location:
- 5 DIP Switch Settings:
- 6 ITZ-MYLINK Phone Pairing
- 7 ITZ-Mylink Menu Overview
- 8 ITZ-Mylink Menu Options
- 9 IT2-MYLINK FAQ
- 10 Documents / Resources
 - 10.1 References

Kit Components:



ITZ-MYLINK Interface

Provided MIC is required for A
Command Purpc
CarPlay does not require th



MIC (Optiona



USB/Camera Harness



Radio/HMI T-Har



Installation Diagram:

NOTE:

- If the screen is flashing once connected, disconnect the single violet cable (gray T-Harness) and reset the system
- Using the OEM MyLink system to handle phone calls & music is recommended for best performance

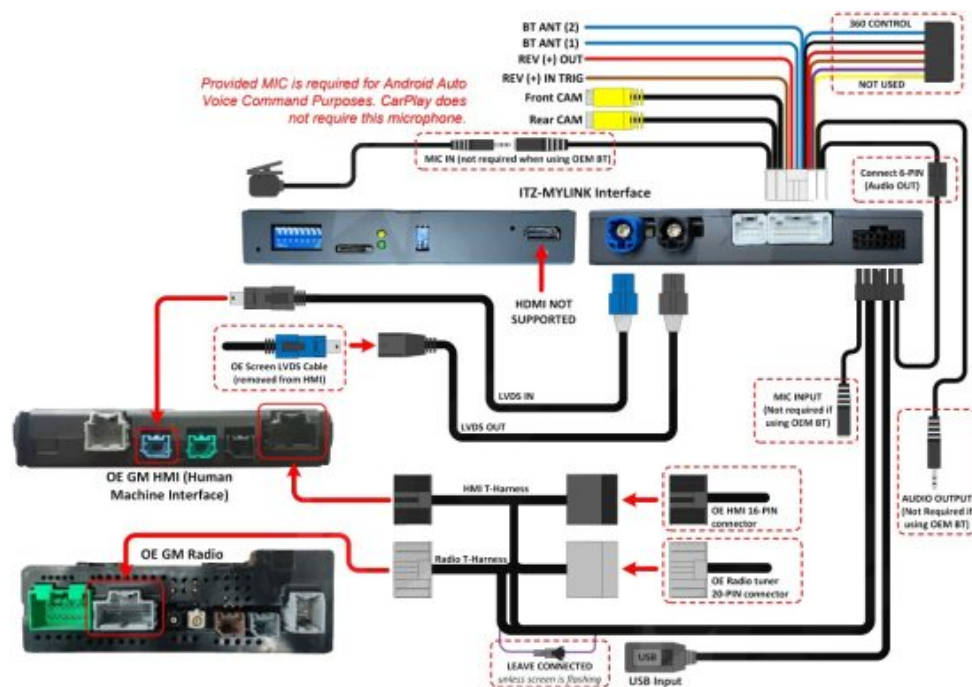

Radio Tuner location:

Known Radio Locations:

Vehicle	Radio Tuner Location
---------	----------------------

Cadillac ATS/CTS/XTS/XTS/SRX	Passenger kick (high)
Cadillac CT6	Trunk, passenger side (vertically)
Cadillac ELR	Trunk, passenger side (floor)
Chevy Impala/Camaro	Passenger kick (high)
Chevy Corvette	Passenger footwell
ALL Trucks/SUVs	Behind Screen



105/106 OEM GM radio tuner

HMI location:

Known HMI Locations:

Vehicle	HMI Location
Cadillac ATS/CTS	Directly below the glove box
Cadillac SRX	Below/behind the glove box
Corvette*	The driver's kick panel
Silverado/Sierra	Behind the glove box- high
Colorado/Canyon	Behind Screen – low
Escalade/SUVs	Behind the radio tuner OR the glovebox



Factory GM HMI (Human Machine Interface)

*For Corvette, the gray radio T-Harness may need to be extended so the installation can stay at the HMI location.

DIP Switch Settings:



ALL VEHICLES:

1	2	3	4	5	6	7	8
KEEP	KEEP	KEEP	KEEP	KEEP	KEEP	KEEP	KEEP
ON	OFF	OFF	OFF	OFF	OFF	ON	ON

IMPORTANT NOTES:

- ZZ-2 recommends that the end user connect the phone's Bluetooth to both the ZZPLAY system and the factory Bluetooth audio system for best results.
The settings 'BT Channel' must be turned ON for this to function properly (default).
This allows the GM 105/106 radio to handle all audio from CarPlay / Android Auto.
- HDMI is not supported on this kit

ITZ-MYLINK Phone Pairing

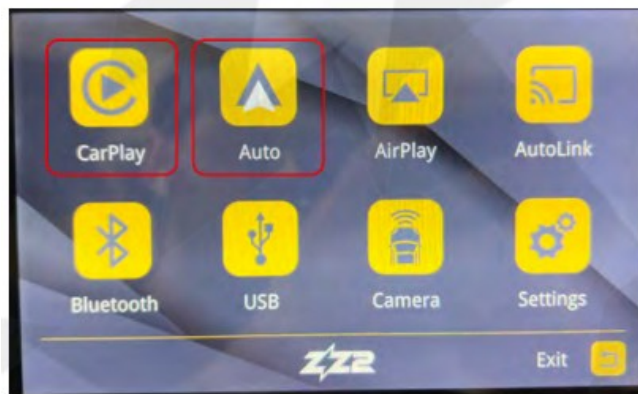

Connection for iPhone and Android phones is mostly the same process: Verify Bluetooth & WIFI are enabled. Then connect to the ZZPLAY unit through Bluetooth, and once that connection is established, the system will create an Ad-Hoc WIFI connection automatically (in the background). For iPhone, this WIFI will prompt as 'Use CarPlay'

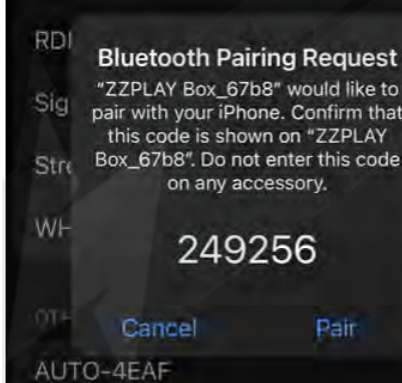

Iphone Connection Example

	
<p>1. Go to Settings > Bluetooth, look under 'OTHER DEVICES' for 'ZZPLAY Box _ xxxx' and touch on it.</p>	<p>2. Press 'Pair' when the code is</p>



3. Press 'Allow' for contacts to be shared.

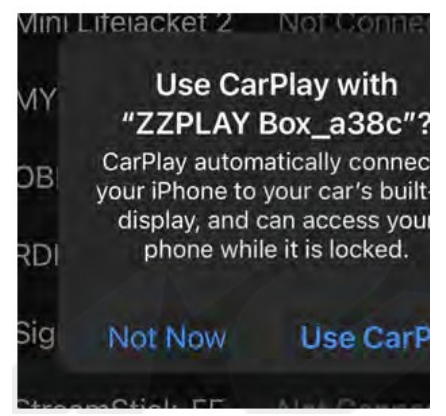

4. Wait for the 'Use CarPlay' prompt – shortly after this, CarPlay starts.

ITZ-Mylink Menu Overview

To gain access to the Interface menu, from within CarPlay/AA mode, and locate the exit tile, labeled as 'ZZPLAY' for CarPlay or 'Exit' for Android Auto. Selecting this tile will bring you to the interface setup menu, NOT the OE system.

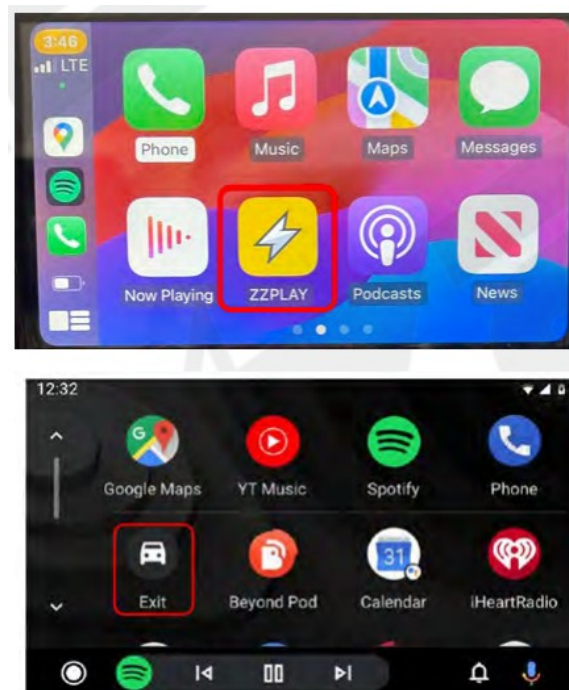

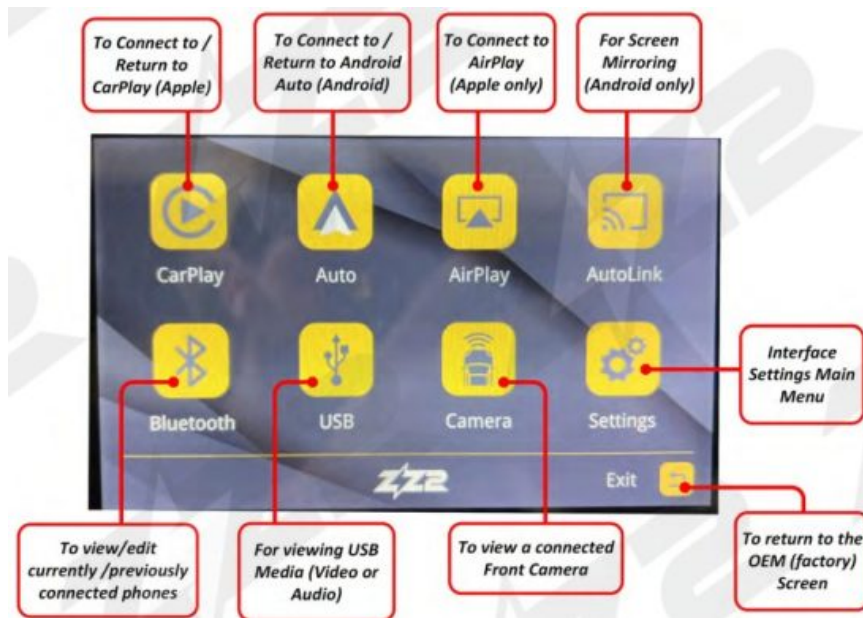

ITZ-Mylink Menu Options

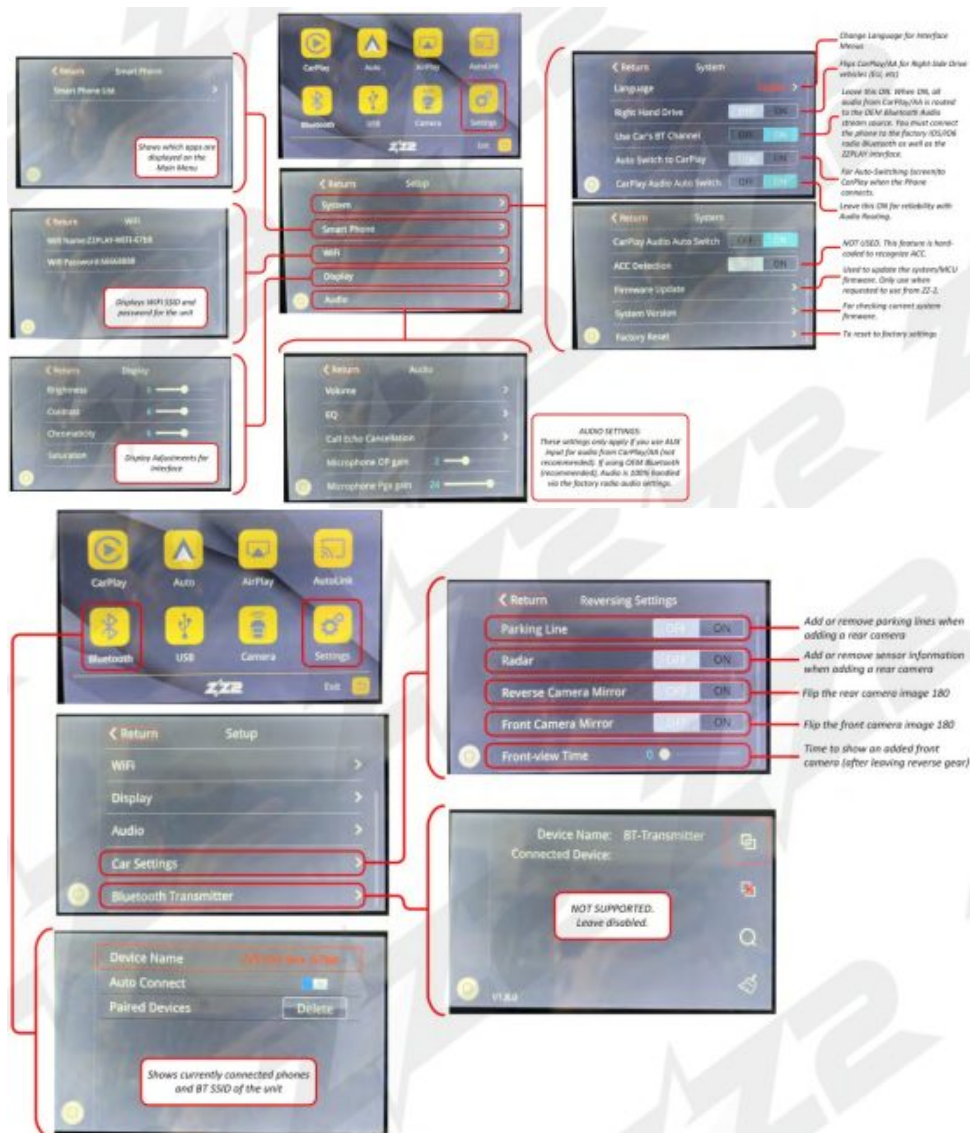

ITZ-Mylink Operation



When a phone connects, the screen will flip automatically.

IT2-MYLINK FAQ

Question: I can't hear any audio from the CarPlay Android Auto system.

Answer: Your OE system must be resting on Bluetooth audio mode in order to hear any sound from the kit, and the phone being paired must be connected to the factory GM Bluetooth system for Phone calls and audio. AUX is generally NOT used in this system.

Question: Sometimes my phone won't connect lately. Sometimes when it connects, the screen goes black. Sometimes CarPlay kicks me out back to the interface menu.

Answer: For iPhone users, you must perform a Hard Reset on the phone in use on average twice a month to clear certain cache and reset the processors. This will not wipe any data. Follow the steps in the right image and perform this task. After this is done, you will see a difference in the speed and reliability of pairing and connecting.

Question: Incoming text responses from SIRI are silent on CarPlay. It mutes the audio, but I don't hear the read-out.

Answer: This often happens for 2 reasons: The iPhone needs a hard reset, see previous question, or the phone is connected to the vehicle's OE Bluetooth for both phone calls & audio, and the text read-outs are being sent to the vehicle BT source -

you're on AUX source. You want to be connected to the vehicle for phone calls ONLY - for iPhone, the only way to make this distinction is to adjust the phone setup on the OE radio side. Find your phone name in the Bluetooth or Phone setup in the OEM radio settings and disconnect as an audio player. NOTE: not all vehicles have this option, but it seems to happen mostly with cars that do have this option Lexus, etc.

Question: Using Android, I cannot get the phone to reliably connect wirelessly or at all.

Answer: Android phones are more finicky than iPhones with their wireless connectivity. Make sure the OS is fully up-to-date. Clear the cache on the Android Auto application. The Android OS must be at least version 11. Some phones TCL, Motorola, seem to have protocols that don't play nicely with every system. If you run into this, use a good USB-C cable for the Android Auto Connection instead.

Perform a 'Hard Reset' (iPhone):

1. Press and Release Volume UP
2. Press and Release Volume DOWN
3. Press and HOLD the Main Power button for 20 seconds. IGNORE the 'Slide to Power Off slider after a few seconds-wait until the Apple logo appears before letting go of the power button.
4. Test the system when the phone reboots.

NOTE: This will not erase personal phone data.



support@zz-2.com

[929-220-1212](tel:929-220-1212)

Toll-free: [877-241-2526](tel:877-241-2526)

Extension 2: Tech Support

Agreement: End user agrees to use this product in compliance with all State and Federal laws. ZZDOIS LLC dba ZZ-2 is not to be held liable for misuse of its product. If you do not agree, please discontinue use immediately and return the product to the retailer. This product is intended for off-road use and passenger entertainment only.

[929-220-1212](tel:929-220-1212) / [877-241-2526](tel:877-241-2526)

www.zz-2.com

01/23/2024

Documents / Resources

	<p>ZZPLAY ITZ-MYLINK Integration For GM Vehiclesequipped With IO5 or IO6 System [pdf] User Guide</p> <p>ZZ-2, 1628GM, 929-220-1212, ITZ-MYLINK Integration For GM Vehiclese quipped With IO5 or IO6 System, ITZ-MYLINK, Integration For GM Vehicl esequipped With IO5 or IO6 System, GM Vehiclesequipped With IO5 or IO 6 System, IO5 or IO6 System, IO6 System, System</p>
---	--

References

- [User Manual](#)

■ ZZPLAY

🔑 1628GM, 929-220-1212, GM Vehiclesequipped With IO5 or IO6 System, Integration For GM Vehiclesequipped With IO5 or IO6 System, IO5 or IO6 System, IO6 System, ITZ-MYLINK, ITZ-MYLINK Integration For GM Vehiclesequipped With IO5 or IO6 System, System, ZZ-2, ZZPLAY

Leave a comment

Your email address will not be published. Required fields are marked *

Comment *

Name

Email

Website

☐ Save my name, email, and website in this browser for the next time I comment.

Post Comment

Search:

e.g. whirlpool wrf535swhz

Search

[Manuals+](#) | [Upload](#) | [Deep Search](#) | [Privacy Policy](#) | [@manuals.plus](#) | [YouTube](#)

This website is an independent publication and is neither affiliated with nor endorsed by any of the trademark owners. The "Bluetooth®" word mark and logos are registered trademarks owned by Bluetooth SIG, Inc. The "Wi-Fi®" word mark and logos are registered trademarks owned by the Wi-Fi Alliance. Any use of

these marks on this website does not imply any affiliation with or endorsement.