



ZYXEL PX3321-T1 WiFi 6 Gpon Volp Gateway ONT with 1 Port USB User Guide

[Home](#) » [ZYXEL](#) » ZYXEL PX3321-T1 WiFi 6 Gpon Volp Gateway ONT with 1 Port USB User Guide 

Contents

- [1 ZYXEL PX3321-T1 WiFi 6 Gpon Volp Gateway ONT with 1 Port USB](#)
- [2 Package Contents](#)
- [3 Quick Start Guide](#)
- [4 Step 1 Hardware Installation](#)
- [5 Step 2 WiFi Connection](#)
- [6 Step 3 Quick Start Setup](#)
- [7 Documents / Resources](#)



ZYXEL PX3321-T1 WiFi 6 Gpon Volp Gateway ONT with 1 Port USB



Package Contents



PX3321-T1

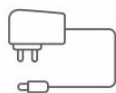

Power Cable



Ethernet Cable



Phone Cable



Quick Start
Guide



Declaration of
Conformity
Safety Warnings

Quick Start Guide

Step 1 Hardware Installation

Warning! To avoid possible eye injury, do NOT look into an operating fiber module's connector.

1. Connect the fiber optic cable from your service provider's network to the PON port.

2. Carefully coil the fiber optic cable from inside to outside. Make sure the cable goes under the tabs to keep it in place. Do not exceed 2.5 meters of fiber optic cable with an outer diameter of 3.0 mm.
3. Connect the power cable to the PX3321-T1 and press the power button.
4. Connect a computer to the LAN port using the yellow Ethernet cable.
5. Connect a phone to the PHONE port using the phone cable

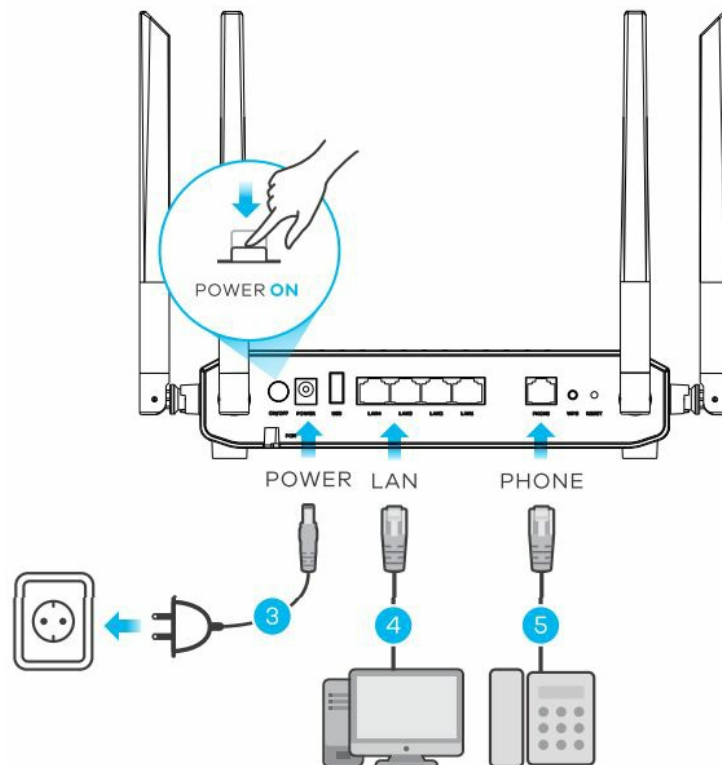
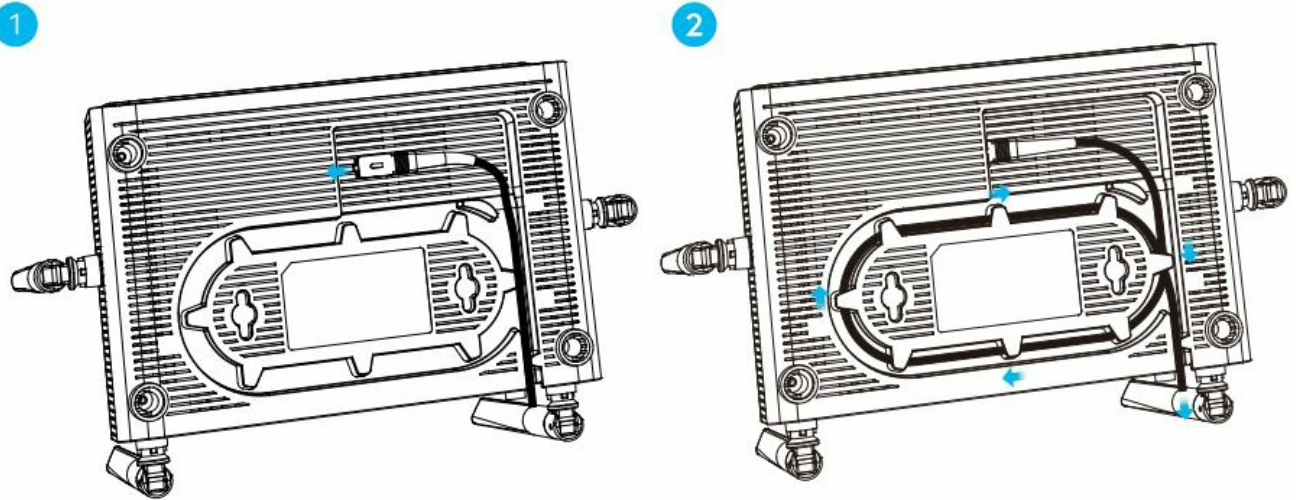

LEDs



Power/ System	Green On - Power on and system ready Blinking (slow) - Booting Blinking (fast) - Boot up fail Off - Power off
PON	Green On - PON connection ready Blinking - Trying to link up Off - Not receiving optical signal normally
LOS	Red On - PON transceiver power down Blinking - PON transceiver low power alarm Off - PON connection ready
Internet	Green On - WAN connection is up Blinking - Transmitting/receiving data Off - WAN connection is down or in bridge mode Red On - Attempted to get an IP address but failed
LAN1- LAN4	Green On - Ethernet link is up Blinking - Transmitting/receiving data Off - Ethernet link is down
Phone	Green On - SIP account registered, telephone on-hook and idle Blinking - Telephone off-hook or incoming call Off - SIP account not registered, telephone on-hook and idle Or VoIP is off Or power is off

Step 2 WiFi Connection

Using SSID

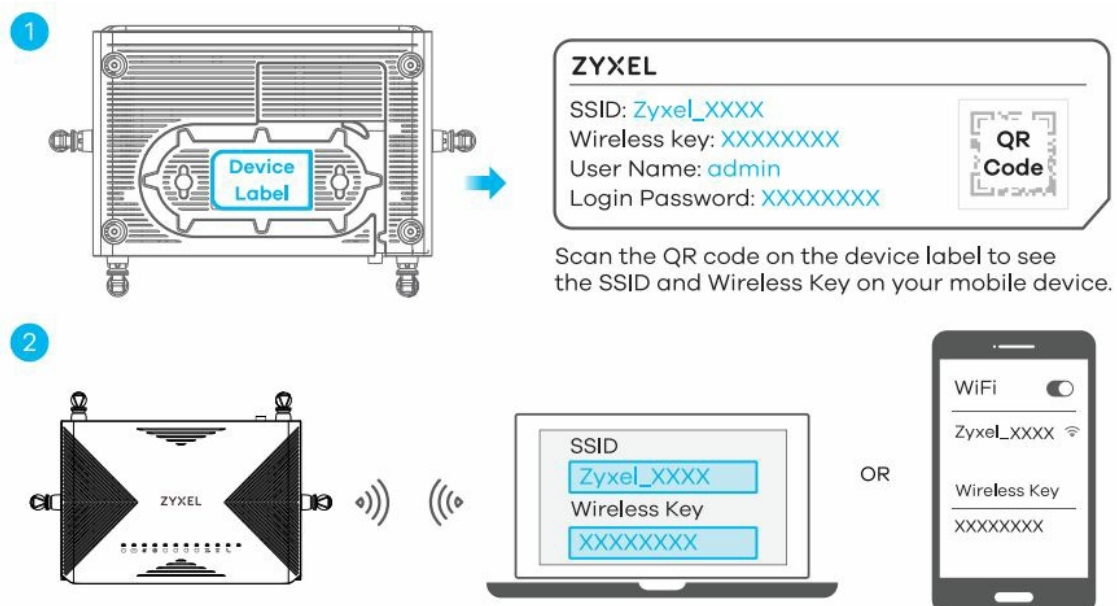

1. The SSID and wireless key are on the device label.
2. On your smartphone or notebook, find this SSID. Enter the wireless key to connect.

Using WPS

1. Press the WPS button until the WiFi 5GHz/WPS and 2.4GHz/WPS LEDs light up in amber.
2. Press the WPS button on the wireless client. If the WPS method fails, use the SSID and wireless key to set up a WiFi connection.

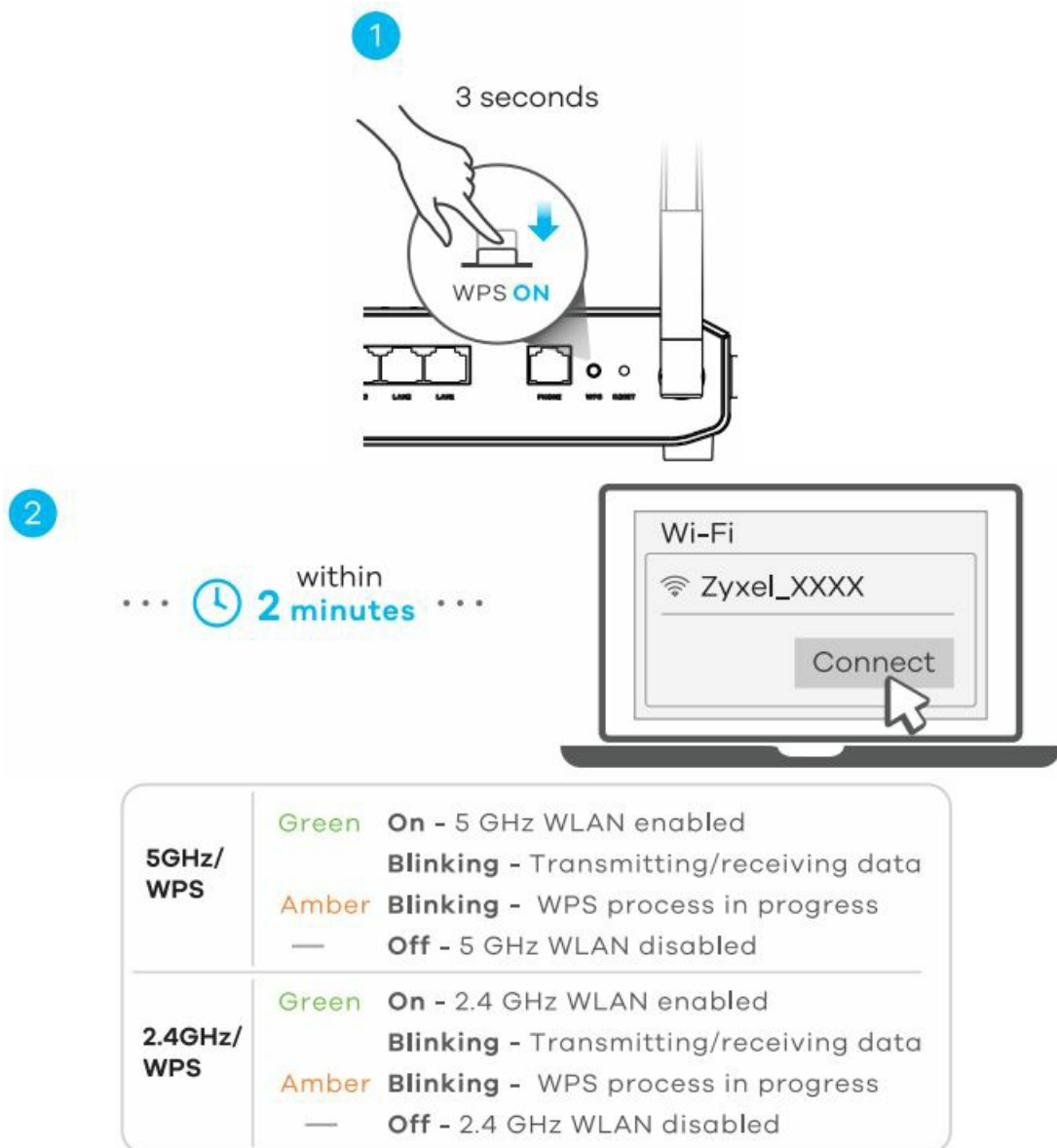

Step 3 Quick Start Setup

Open a web browser and go to <http://192.168.1.1>. Enter the default User Name (admin) and admin login password (on the device label), and then click Login. A wizard runs. Follow the wizard prompts to complete the setup.



<http://192.168.1.1>



User Name : **admin**

Password : Refer to the device label
(default)

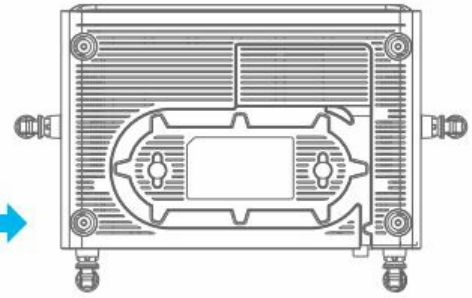

ZYXEL
PX3321-T1

User Name

Password

Login



Quick Start Wizard

1 > 2 > 3

Time Zone Internet WiFi

Let's go

Wall Mounting (Optional)

1. Drill two holes in the wall at a distance of 138.8 mm. Insert the screw anchors and screws (not provided).
2. Place the PX3321-T1 so the wall mount holes line up with the screws (2-a). Slide the PX3321-T1 down gently to fix it into place (2-b).

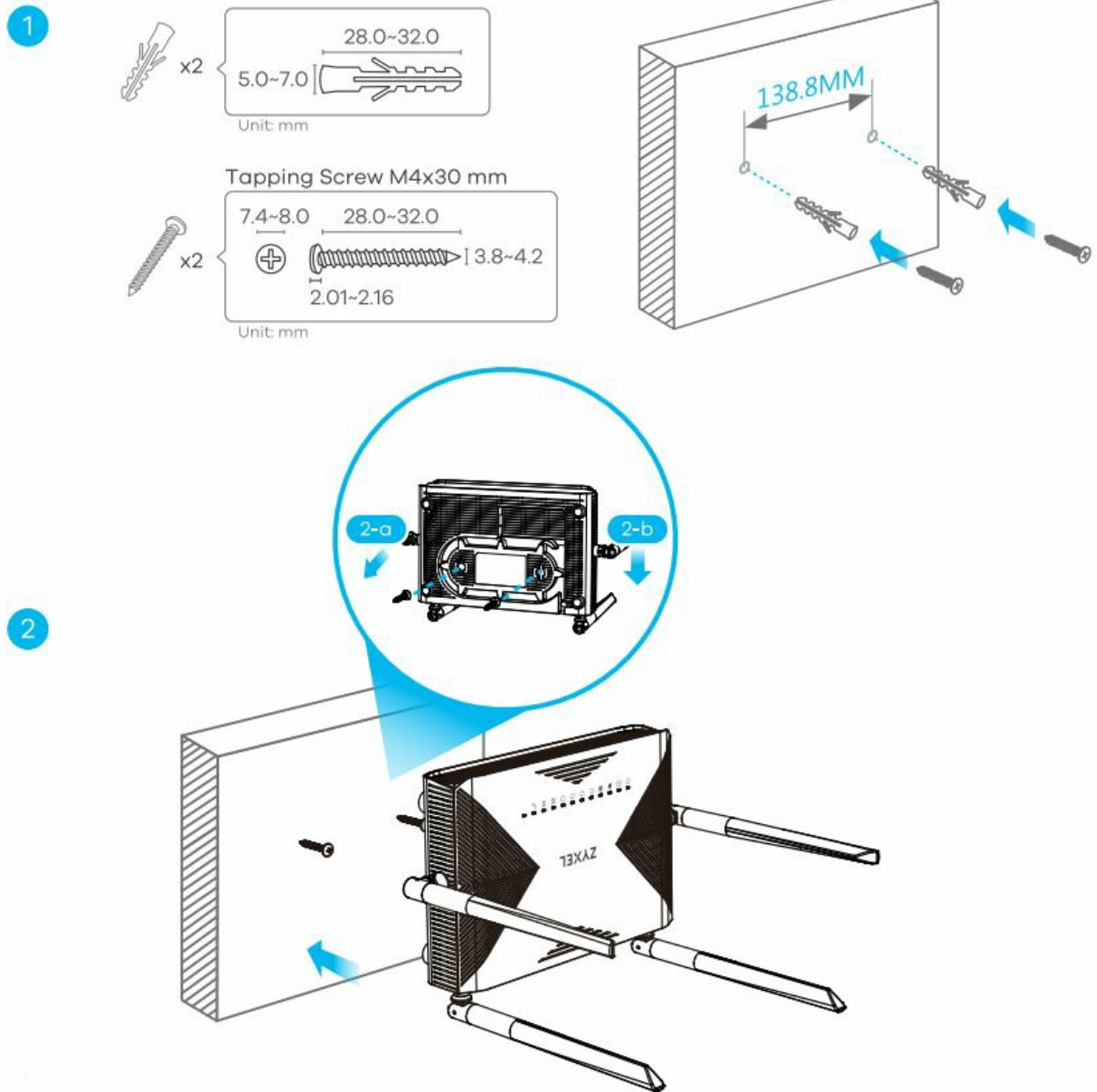

Support Information

<https://service-provider.zyxel.com/global/en/tech-support>



See the User's Guide at www.zyxel.com for more information, including customer support and safety warnings.

EU Importer

Zyxel Communications A/S Gladsaxevej 378, 2. th. 2860 Søborg, Denmark <https://www.zyxel.com/dk/da>

US Importer

Zyxel Communications, Inc. 1130 North Miller Street Anaheim, CA 92806-2001 <https://www.zyxel.com/us/en>

Documents / Resources

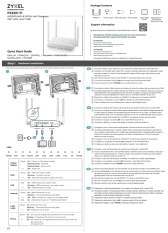
	<p>ZYXEL PX3321-T1 WiFi 6 Gpon Volp Gateway ONT with 1 Port USB [pdf] User Guide PX3321-T1, PX3321-T1 WiFi 6 Gpon Volp Gateway ONT with 1 Port USB, WiFi 6 Gpon Volp Gateway ONT with 1 Port USB, 6 Gpon Volp Gateway ONT with 1 Port USB, Volp Gateway ONT with 1 Port USB, Gateway ONT with 1 Port USB, 1 Port USB</p>
---	--