



[Home](#) » [ZYXEL NETWORKS](#) » **ZYXEL NETWORKS WBE530 Triple Radio Unified Access Point**

User Guide 

Contents [[hide](#)]

- [1 ZYXEL NETWORKS WBE530 Triple Radio Unified Access Point](#)
- [2 Hardware Connections](#)
- [3 Mounting Options](#)
- [4 Desk Placement](#)
- [5 Support Information](#)
- [6 Documents / Resources](#)
 - [6.1 References](#)

ZYXEL

ZYXEL NETWORKS WBE530 Triple Radio Unified Access Point



Hardware Connections

Wait until the LED
blinks green

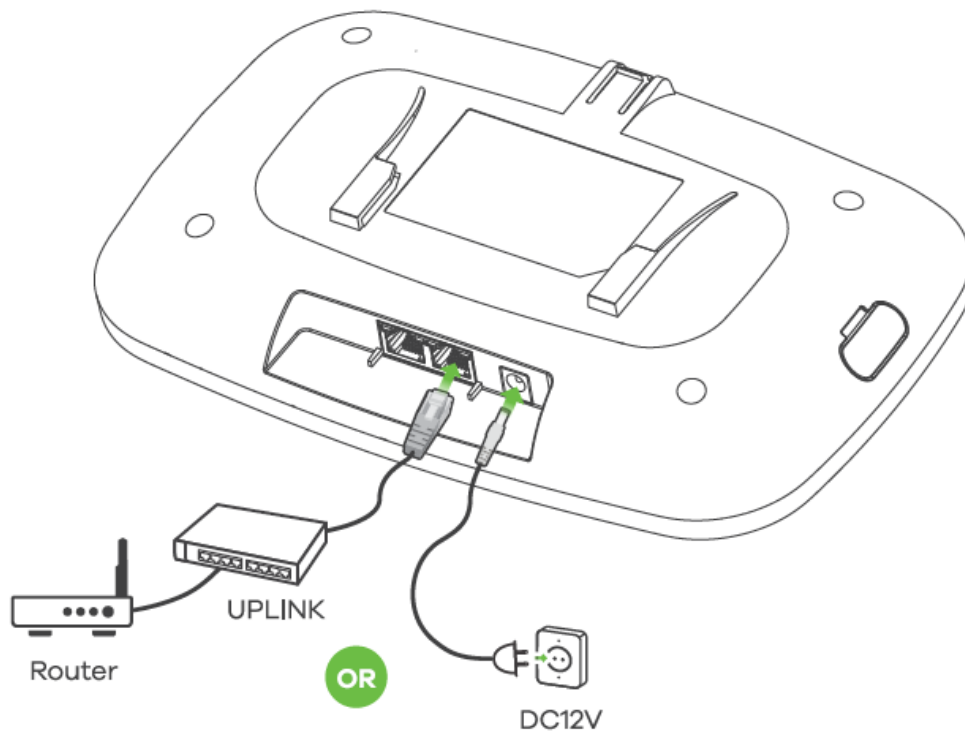

Connect the UPLINK port to a router with Internet access. If you are not using POE, connect the ZyXel Device power socket to an appropriate power source.

Nebula Registration with the App

Use the ZyXel Nebula Mobile app to register the ZyXel Device with the Nebula Control Center (NCC) using the QR code.



Where to find the QR code

Web Configurator or Label on the Zyxel Device



Download and open the Zyxel Nebula Mobile app. Log in with your Zyxel account. Create an organization and site or select an existing site. Scan the Zyxel Devices QR code to add it to the site. (You can find the QR code in its web configurator or on a label on the Zyxel Device or its box.)

Note: The Zyxel Device will go into cloud management mode automatically after it is registered to a site.

Nebula Registration with the Web

Use the Zyxel Nebula portal to register the Zyxel Device with the Nebula Control Center (NCC) using the MAC address and serial number.

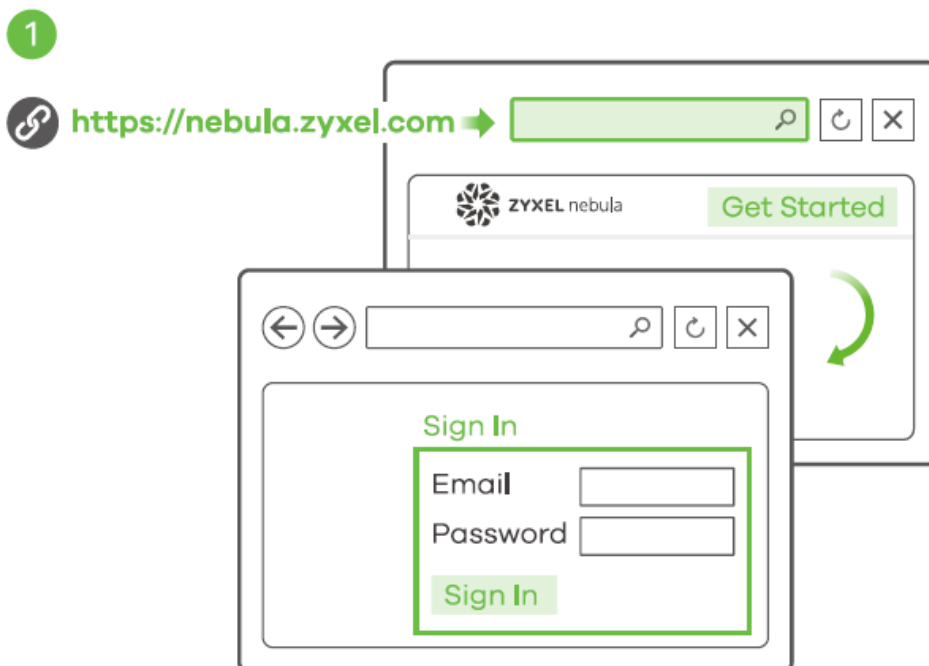

Follow the steps below to manage the Zyxel Device through the Zyxel cloud-based network management system.

Note: Make sure the connected router has Internet access.

Go to the Zyxel Nebula Control Center (NCC) website (<https://nebula.zyxel.com>). Click Get Started to sign up for a Zyxel account and log in.

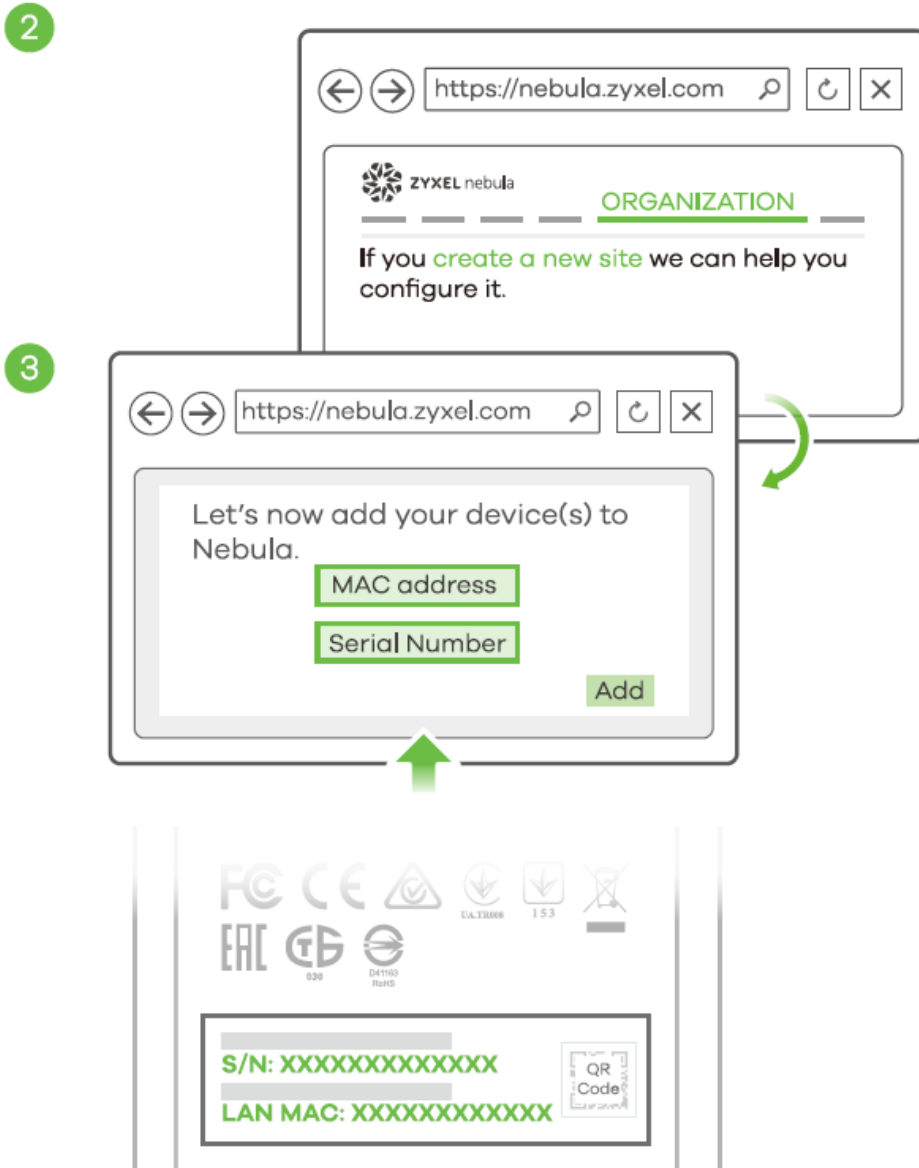

Create an organization and a site (network) in the NCC.

Enter the Zyxel Devices LAN MAC address and serial number (S/N) (see the label on the Zyxel Device) in the NCC configuration screen.

Note: The Zyxel Device will go into cloud management mode automatically after it is registered to a site. See the NCC Users Guide for more information about configuring the Zyxel Device through the NCC.

Direct Management

Use the web configurator to directly manage the Zyxel Device.

1-a WiFi connection

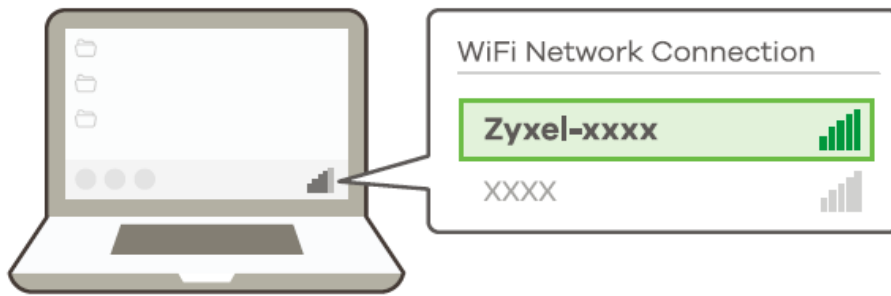

We are enhancing security by introducing unique passwords. If your Zyxel Device has a password printed on the back label, please use it. Otherwise, enter 1234.

 <https://1.1.1.1>
(<https://setup.zyxel.com>)
(First time configuration only)

 User Name: **admin**
Login Password:
See the Zyxel Device label or 1234

A screenshot of a web browser window. The address bar shows 'https://1.1.1.1'. The page content is titled 'Zyxel Device' and contains a login form with 'User Name' (admin) and 'Password' (XXXXXXXXXX) fields, and a 'Login' button.

<https://1.1.1.1> <https://setup.zyxel.com> (First time configuration only)

User Name: admin

Login Password: See the Zyxel Device label or 1234

From a WiFi enabled computer, search for the Zyxel Devices default WiFi network name (Zyxel-xxxx, where xxxx is the last four characters of the MAC address) and connect to it.

Wired connection

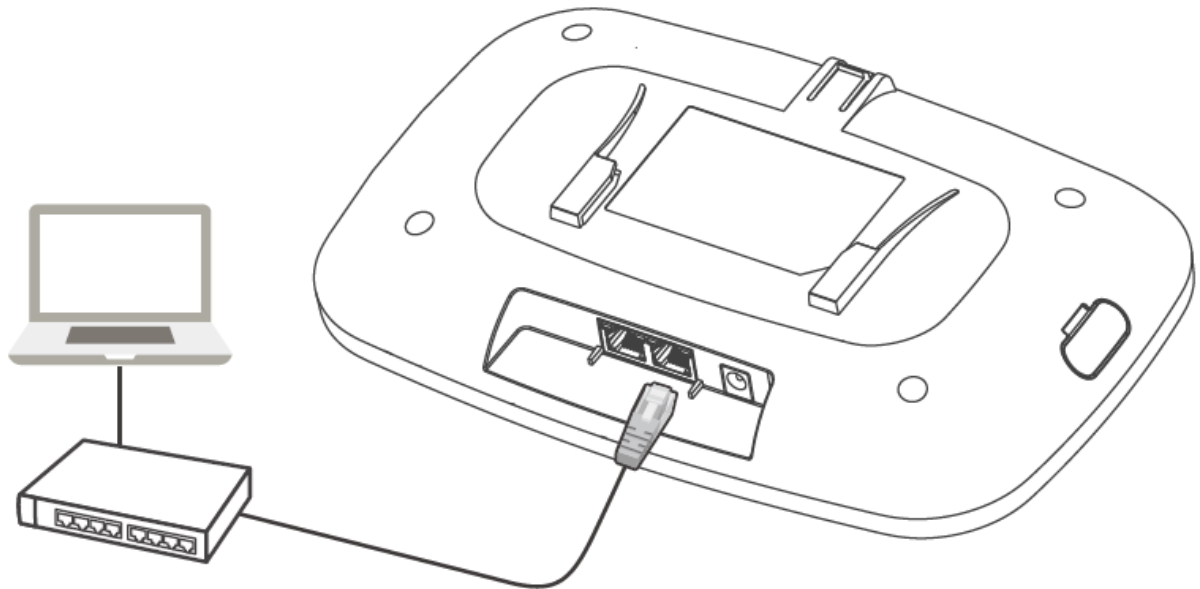

PoE injector
or
PoE switch

<https://192.168.1.2>

User Name: admin

Login Password:

See the Zyxel Device label or 1234

•

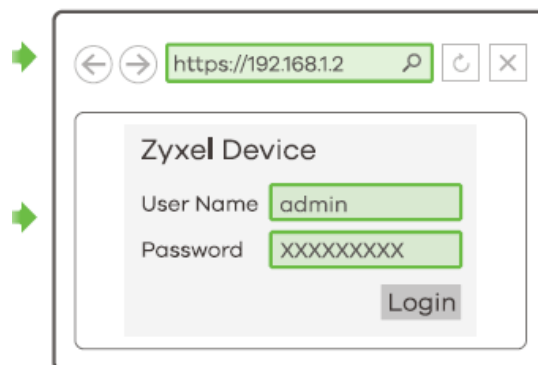

Use an Ethernet cable to connect your computer to the UPLINK port of the Zyxel Device through a POE injector or POE switch.

Use its DHCP-assigned IP or default static IP address "https://192.168.1.2" to access the web configurator. Make sure your computer IP address is in the same subnet as the Zyxel Device's.

2

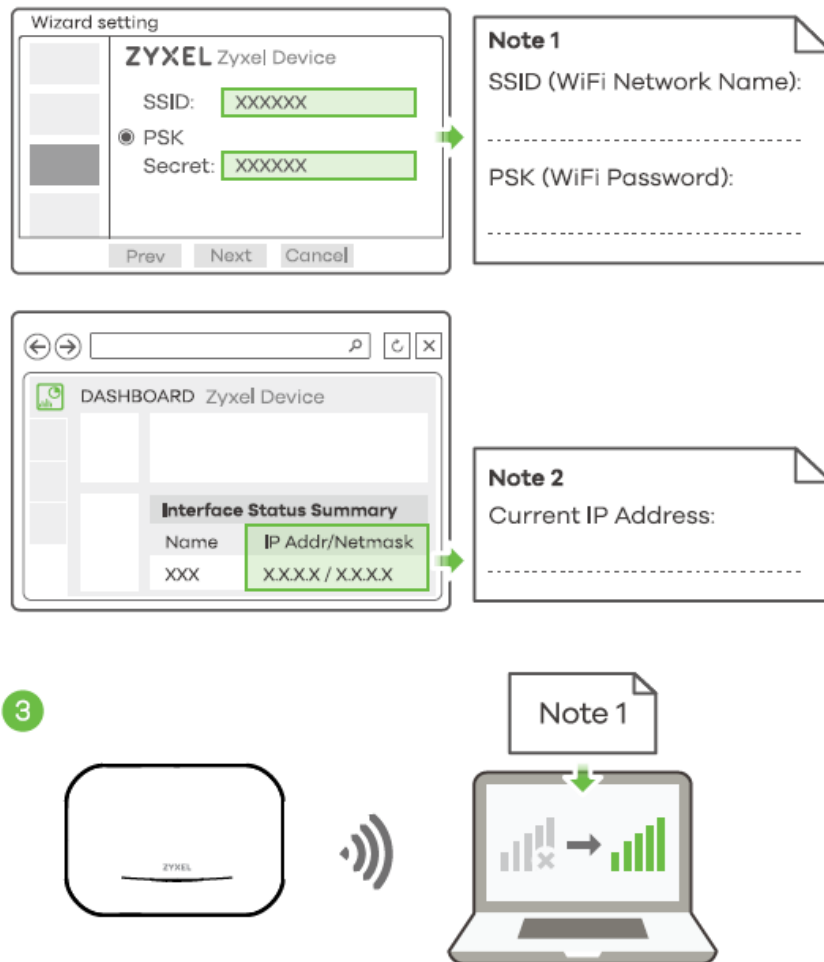

- The wizard appears automatically. Use the wizard to set up your ZyXel Device.
- Note: It takes 1 to 2 minutes to apply your wizard changes. The LED turns steady blue if you change the ZyXel Device default settings and the WiFi is on.
- Use the ZyXel Device's new wireless settings (SSID and key) to re-connect to the ZyXel Device's WiFi network for Internet access if you change them in the wizard (or log in to the web configurator when the ZyXel Device is using a WiFi connection). The LED turns steady green when WiFi clients connect to the ZyXel Device.
- Note : The <https://1.1.1.1> (setup.zyxel.com) is for initial setup only.
- It is not usable after the ZyXel Device is configured.
- Note : Check the Dashboard screen and note down the ZyXel Device's IP address in case you need to access its web configurator again

Mounting Options

Wall / Ceiling Mounting

The mounting kit is for wall or ceiling mounting. You need to choose how you want to

mount your Zyxel Device first.

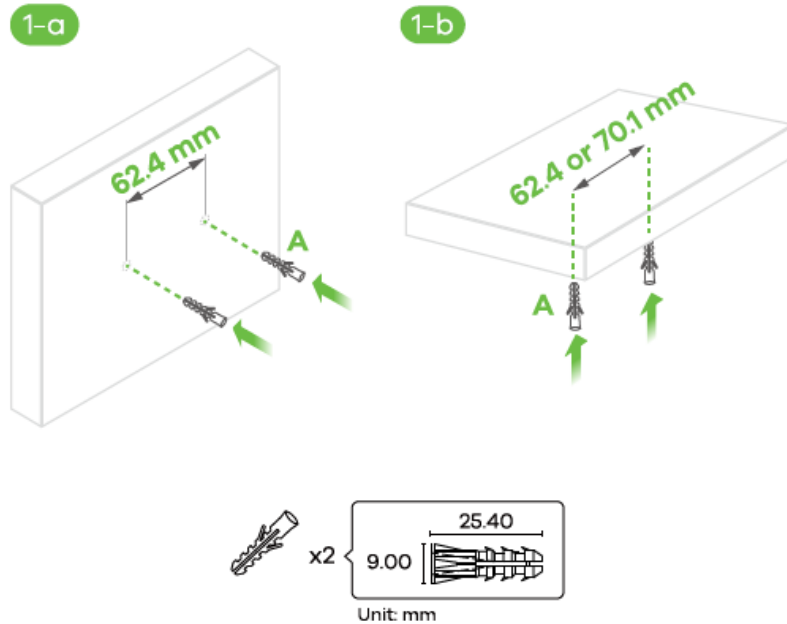
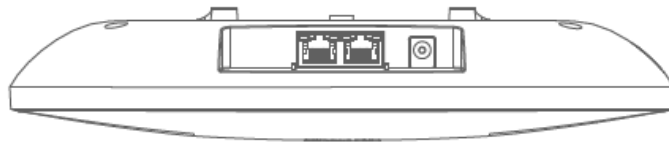

1. Wall mounting: Drill two holes for the screw anchors (A), 62.4 mm apart. Insert the screw anchors into the wall.
2. Ceiling mounting: Drill two holes for the screw anchors (A), 62.4 mm or 70.1 mm apart. Insert the screw anchors into the ceiling.

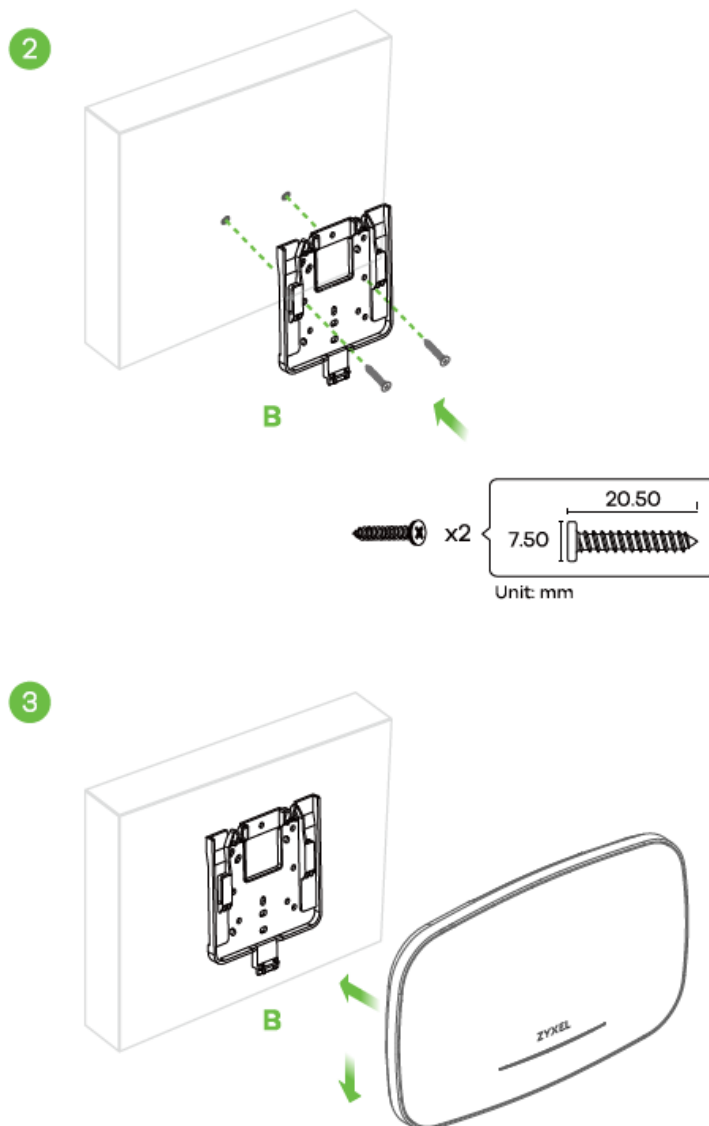

Insert two mounting screws through the holes on the bracket (B) into the plugs/anchors to secure the bracket to the wall/ceiling. Make sure the screws are snugly and securely fastened to the wall/ceiling.

After the bracket is attached to the wall/ceiling, slide the Zyxel Device onto the bracket until it clicks into place.

T-bar Ceiling Mounting

Clips (ACCESSORY-ZZ0105F) are sold separately.

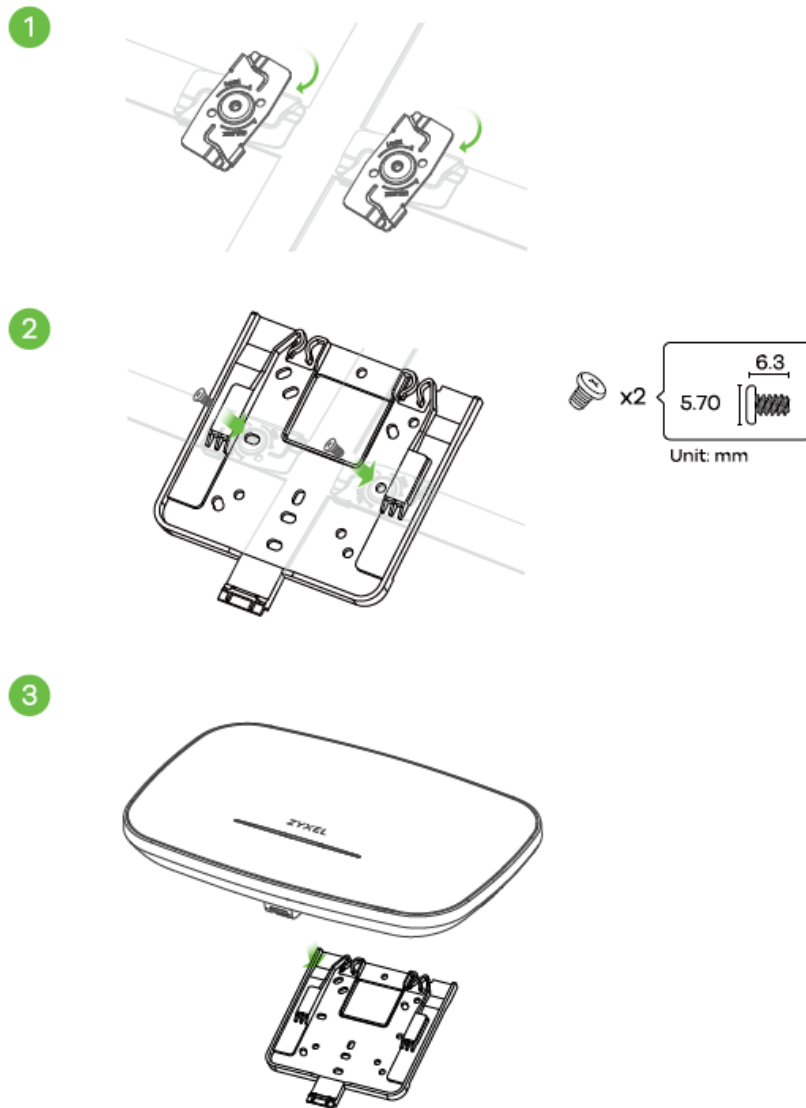

1. Attach two clips to the ceiling grids as shown.
2. Install two screws to secure the bracket to the clips.
3. Slide the Zyxel Device onto the bracket until it clicks into the place.

Note: clips (ACCESSORY-ZZ0105F) are sold separately.

Desk Placement

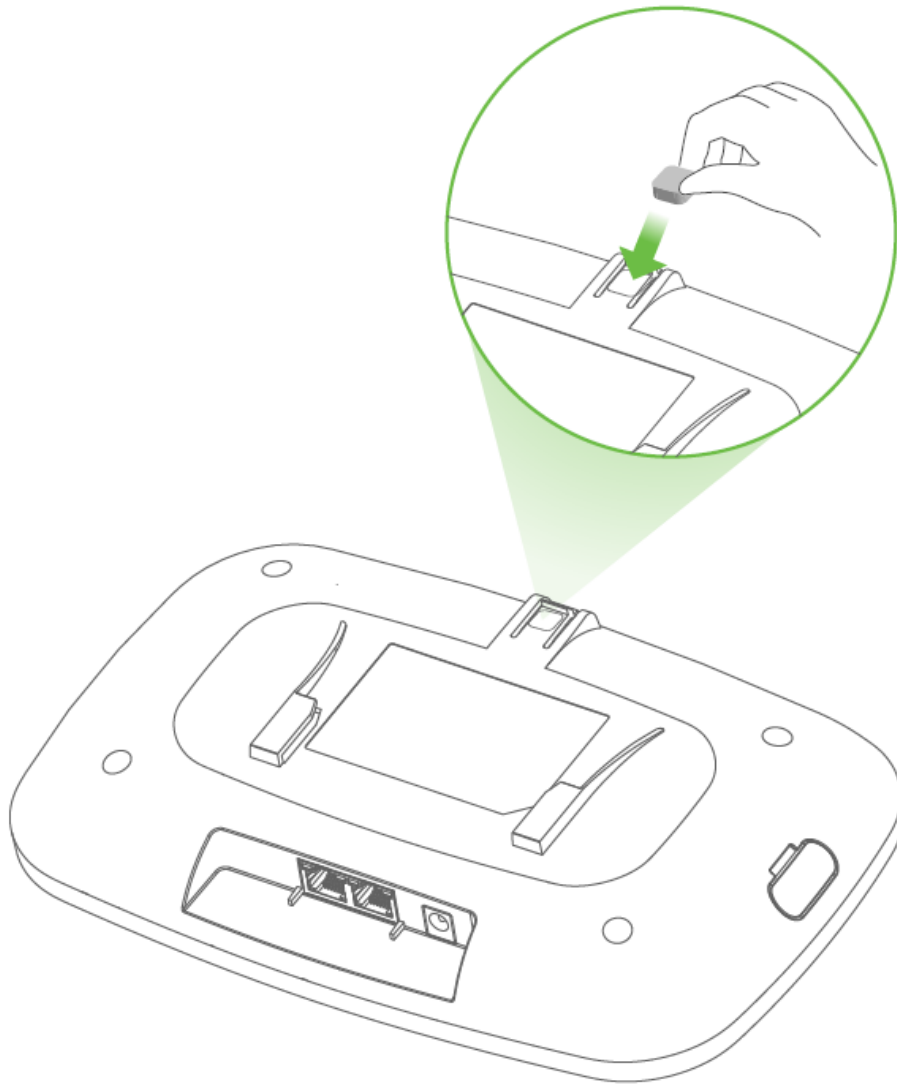

1. Remove the adhesive backing from the rubber pad.
2. Align and attach the rubber pad to the gray square to stabilize the Zyxel Device.
3. Place the Zyxel Device on the desk.

Attaching the Connection Stabilization Pad (Optional)

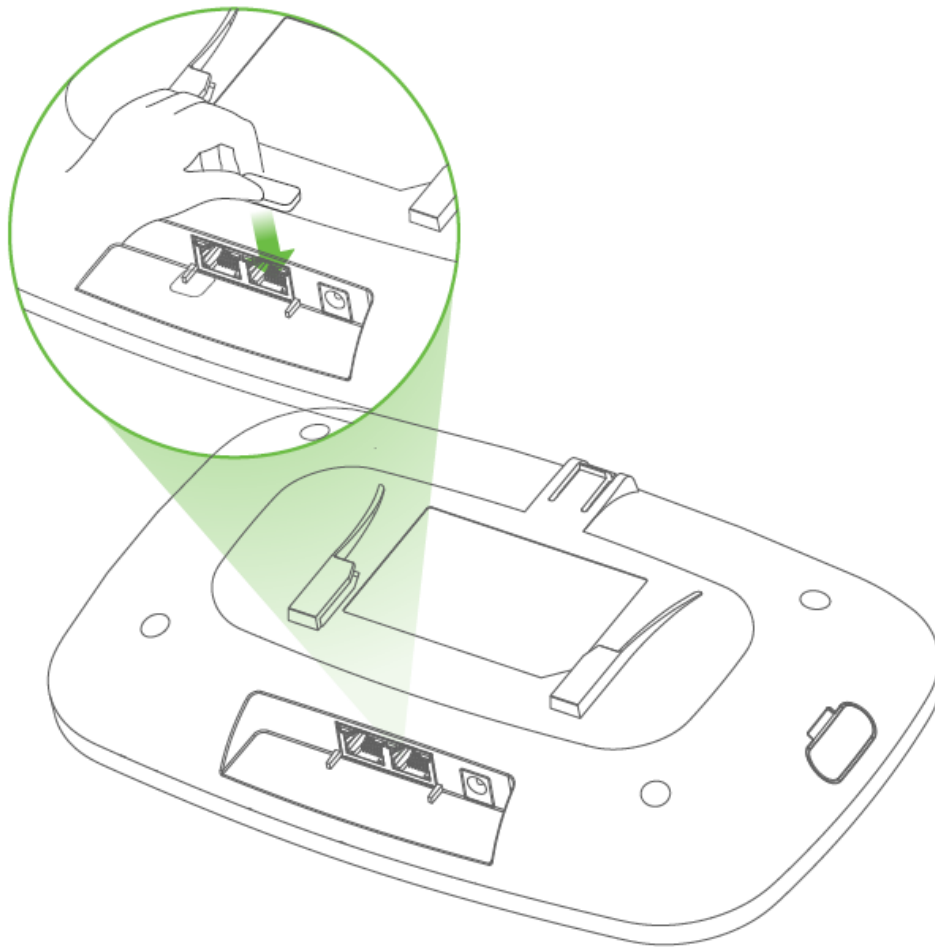

Remove the adhesive backing from the rubber pad.

Attach the rubber pad in front of the UPLINK port. This keeps the Ethernet cable steady for a stable connection speed.

Support Information

EU

<https://support.zyxel.eu>

USA

- +1 800 255 4101
- support@zyxel.com

Taiwan

- + 88622739 9889
- retail@zyxel.com.tw

Zyxel Community

- <https://community.zyxel.com>

See the User's Guide at www.zyxel.com for more information, including customer support and safety warnings.

UK Importer

Zyxel Networks UK 2 Old Row Court, Rose Street, Wokingham, RG40 1XZ, United Kingdom (UK) <https://www.zyxel.com/uk/en/>

Copyright © 2025 Zyxel and/or its affiliates. All Rights Reserved.

Documents / Resources

[illegible]

[illegible]

WBE530 Triple Radio Unified Access Point, WBE530, Triple Radio Unified Access Point, Radio Unified Access Point, Unified Access Point, Access Point

References

- User Manual

Leave a comment

Your email address will not be published. Required fields are marked *

Comment *

Name

Email

Website

☐ Save my name, email, and website in this browser for the next time I comment.

Post Comment

Search:

e.g. whirlpool wrf535swhz

Search

[Manuals+](#) | [Upload](#) | [Deep Search](#) | [Privacy Policy](#) | [@manuals.plus](#) | [YouTube](#)

This website is an independent publication and is neither affiliated with nor endorsed by any of the trademark owners. The "Bluetooth®" word mark and logos are registered trademarks owned by Bluetooth SIG, Inc. The "Wi-Fi®" word mark and logos are registered trademarks owned by the Wi-Fi Alliance. Any use of these marks on this website does not imply any affiliation with or endorsement.