



Zxtech Floodlight Camera User Manual

[Home](#) » [Zxtech](#) » Zxtech Floodlight Camera User Manual

Contents [[hide](#)]

- 1 Zxtech Floodlight Camera User Manual
- 2 Package Contents
- 3 Please note:
- 4 At a Glance
- 5 Setting Up Your Floodlight Camera
- 6 Installation Guide
 - 6.1 Please note:
 - 6.2 Please note:
 - 6.3 Please note:
- 7 Using Your Floodlight Camera
 - 7.1 Preparation
- 8 The Green LED Indicator Status
- 9 Installing and Taking Out the Micro SD Card
- 10 Installing the Micro SD Card:
- 11 Taking out the Micro SD card:
- 12 Install iObsurv app on your phone
- 13 Add a camera to the app
 - 13.1 Please note:
- 14 Device Interface
- 15 Live Video Viewing Interface
- 16 Reset the floodlight camera
- 17 Specifications
- 18 FAQs
- 19 Safety and Warranty
 - 19.1 Safety Instructions
- 20 Warranty
- 21 Documents / Resources
- 22 Related Posts

**Zxtech
Floodlight Camera
User Manual**

GF-L300PRO

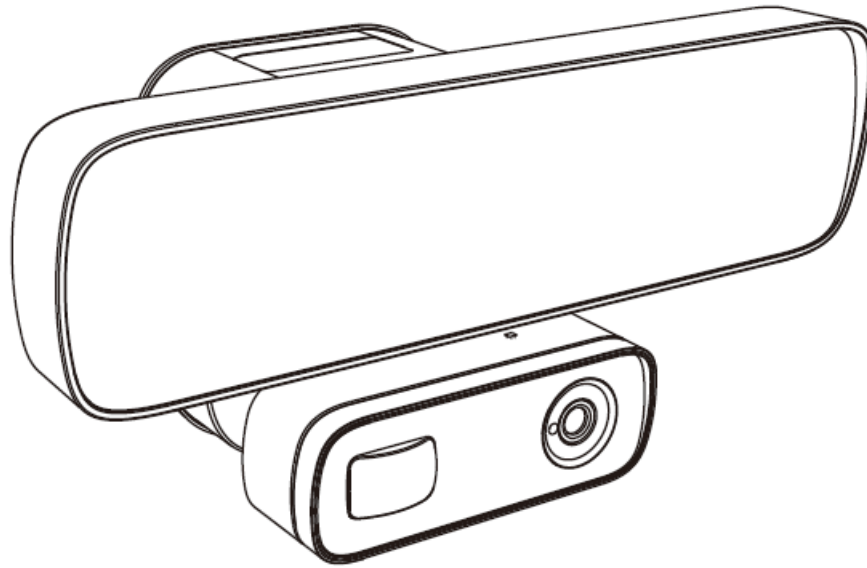

Thank you for purchasing our products. This manual addresses the safety guidelines, warranty and operating instructions.

Please review this manual thoroughly before operating your device.

Package Contents

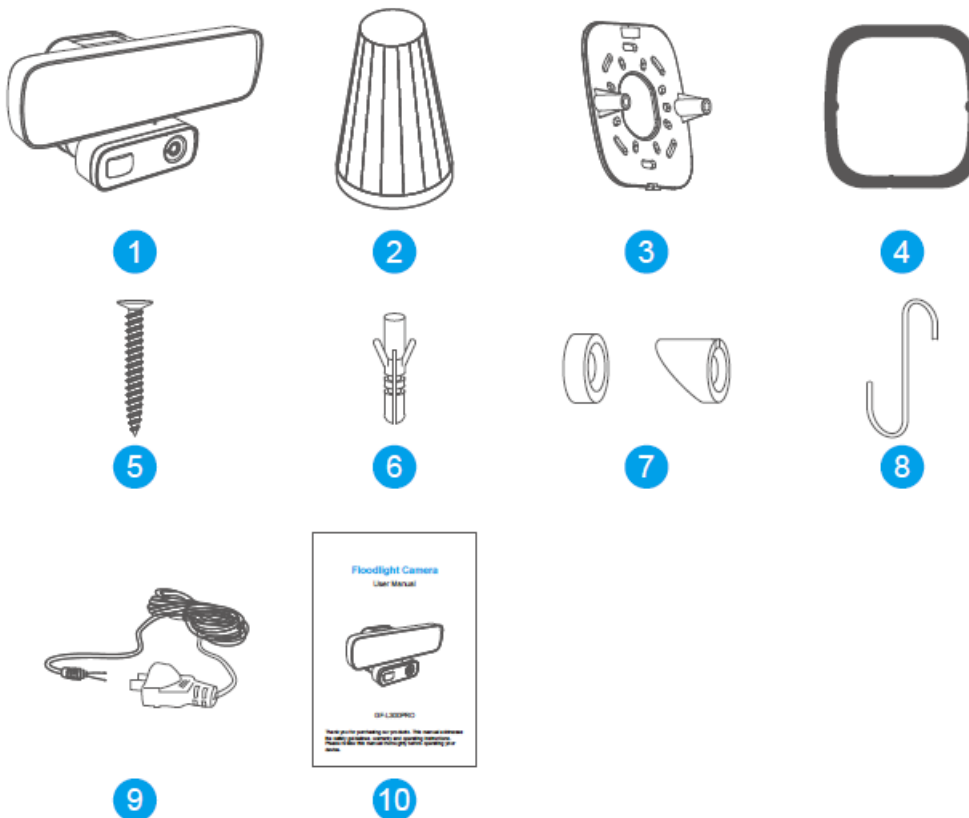

1. Floodlight Camera x 1
2. Wire Nuts x 3
3. Mounting Bracket x 1
4. Waterproof Rubber Gasket x 1
5. Screws x 4

6. Plastic Wall Anchors x 4
7. Waterproof Rubber Cap x 6
8. Hook x 1
9. Power Cable x 1
10. User Manual x 1

Please note:

The power cable included in the package is for you to test the product and get familiar with the functions of the product before installation.

At a Glance

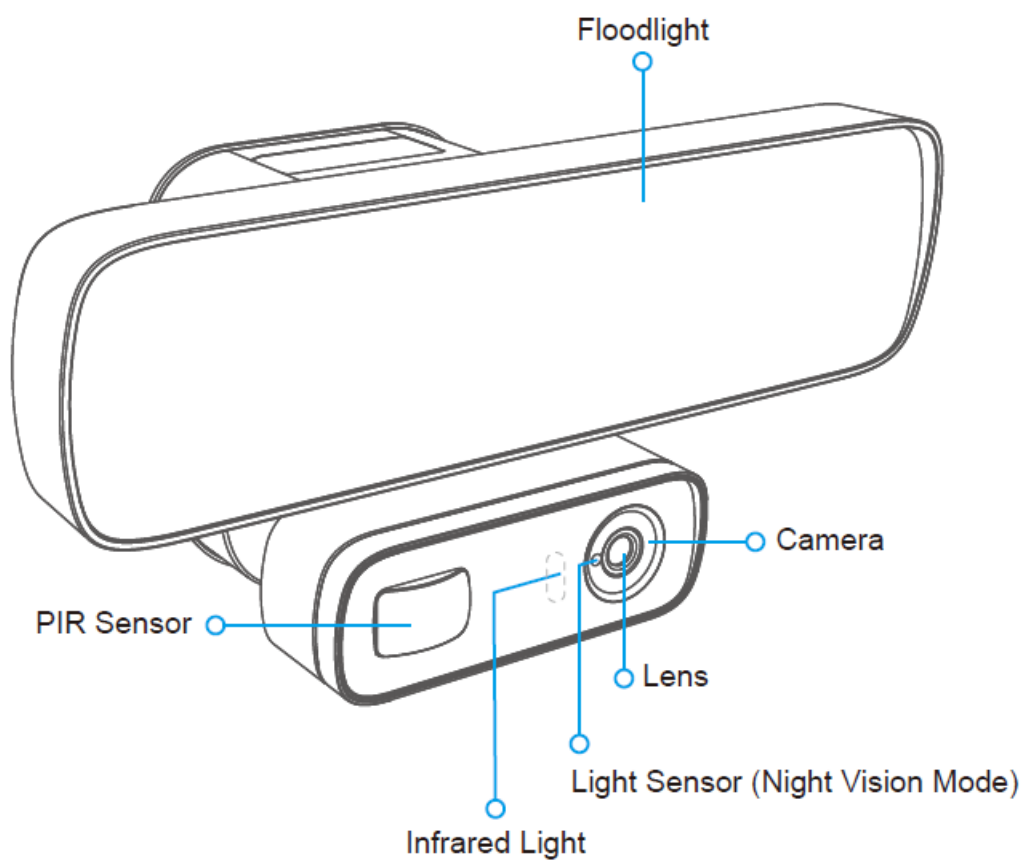

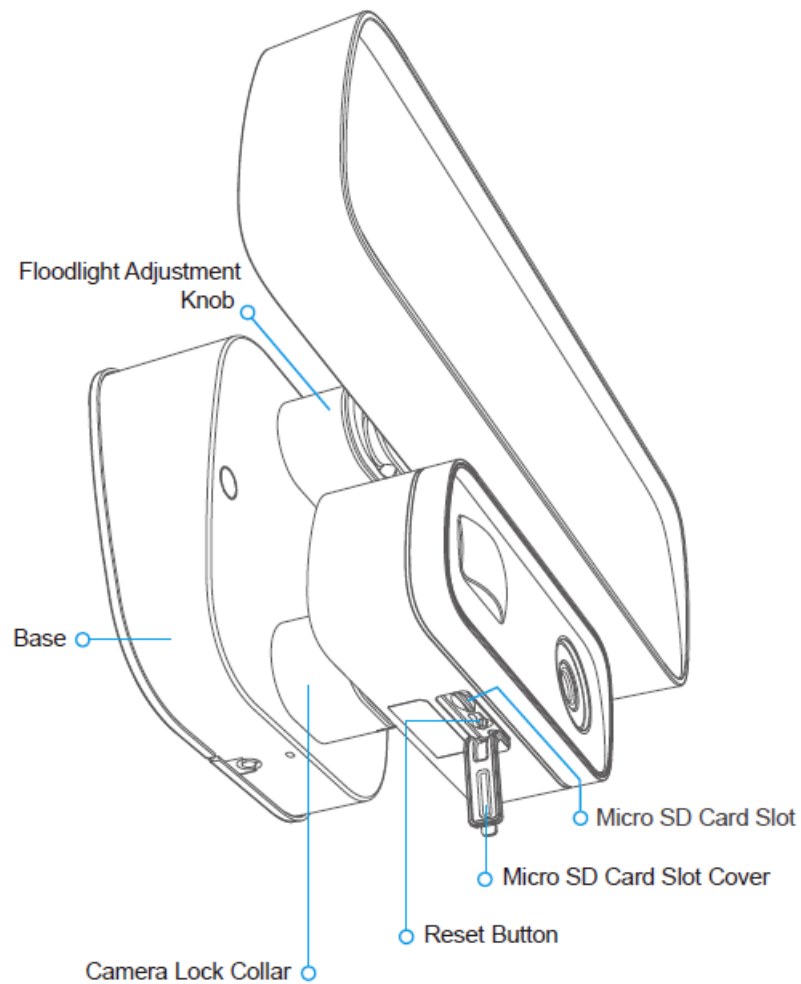

Setting Up Your Floodlight Camera

Before installation, please check the location where you want to install the floodlight. The installation height will influence the motion sensor's performance and the viewing angle of the camera.

When the motion detector is installed at a distance of 3 meters (9 feet) from the ground, and an angle of 30 degrees to the ground, it can detect human-sized objects at up to 8 meters (26 feet).

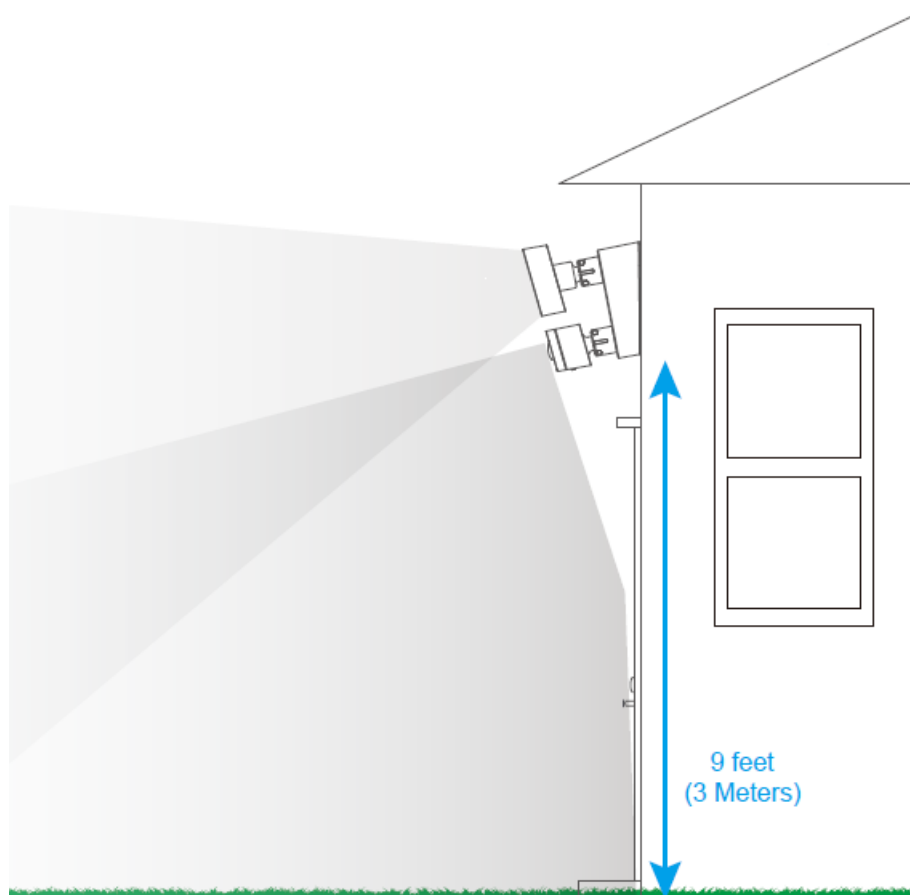
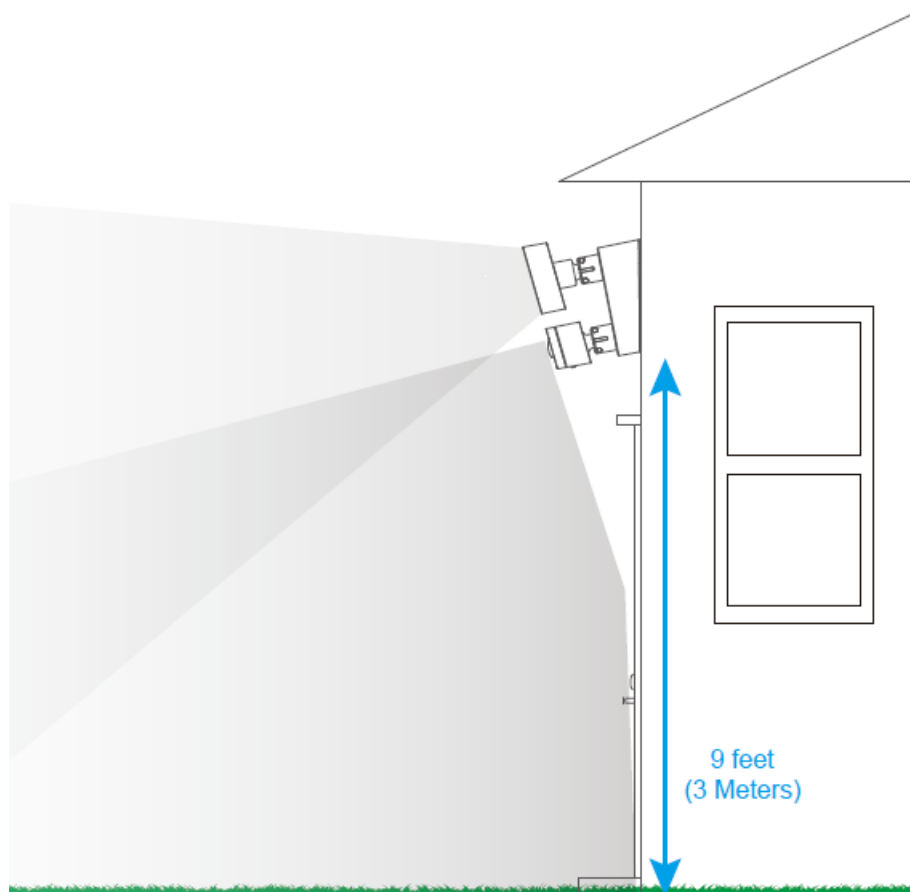

Installation Guide

Please note:

- If you are not sure about how to correctly assemble this device, consult with a licensed electrician. The wiring transition shall be strictly in compliance with the local regulations, rules and national electrical codes.
- Do not connect it to a dimmer switch or timer.
- Do not install it near combustible or flammable surfaces.
- Connect it to a power source (AC 110V to 240V).
- Install it in a place where it can be protected from heavy rain, heat, and humidity for long service life.

Step 1: Turn off the power to the floodlight at the fuse box

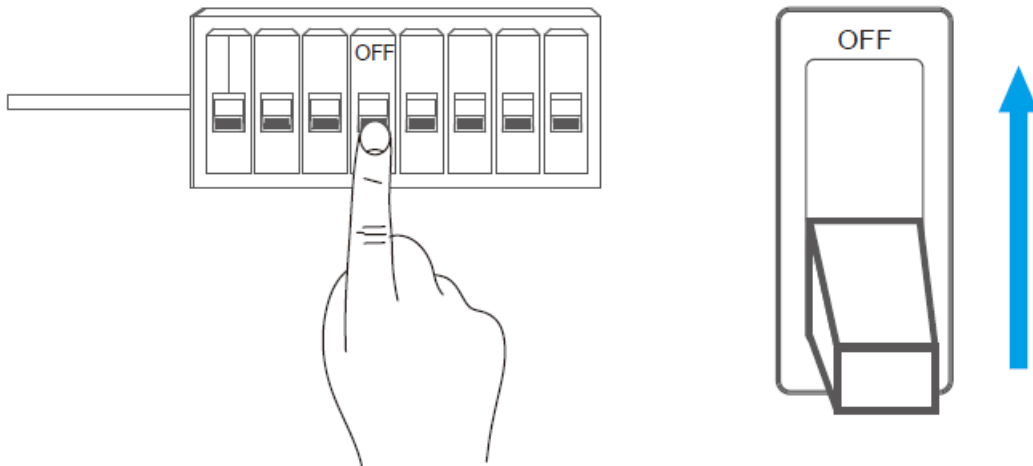

Please note:

If you don't know where your breaker is or how to turn off the power of the floodlight circuit, consult with a licensed electrician. For added safety we recommend an AC / DC Voltage Tester (not included) to ensure the power is off at the floodlight circuit.

Step 2: Remove the mounting bracket

1. Undo the screws with a screwdriver by turning counterclockwise.
2. Remove the mounting bracket.

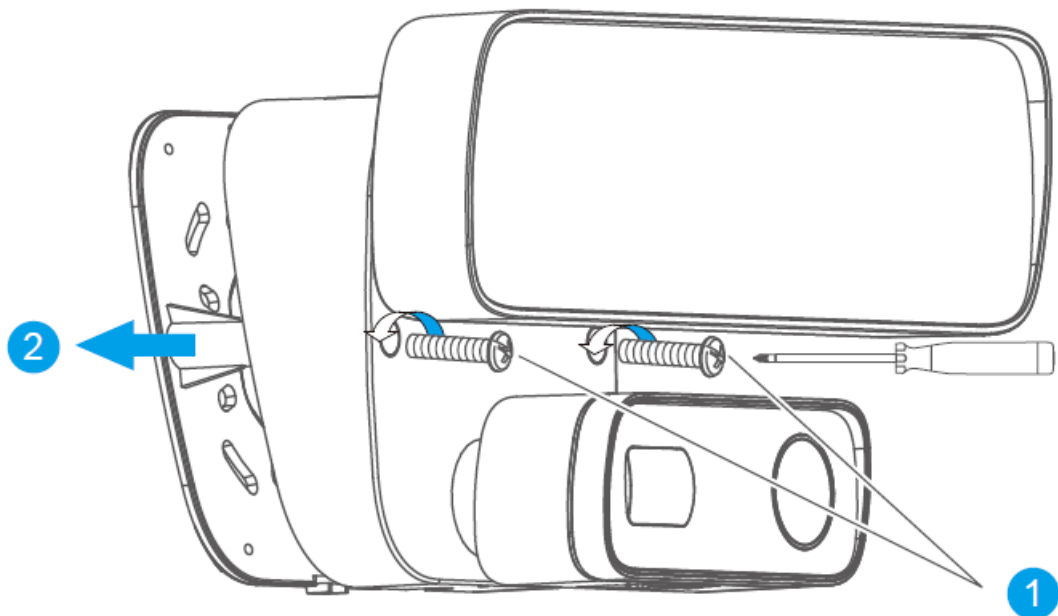

Step 3: Install the waterproof rubber gasket on the mounting bracket

Align the four corners of the gasket with the four corners of the mounting bracket and press these four corners to fix the gasket on the bracket.

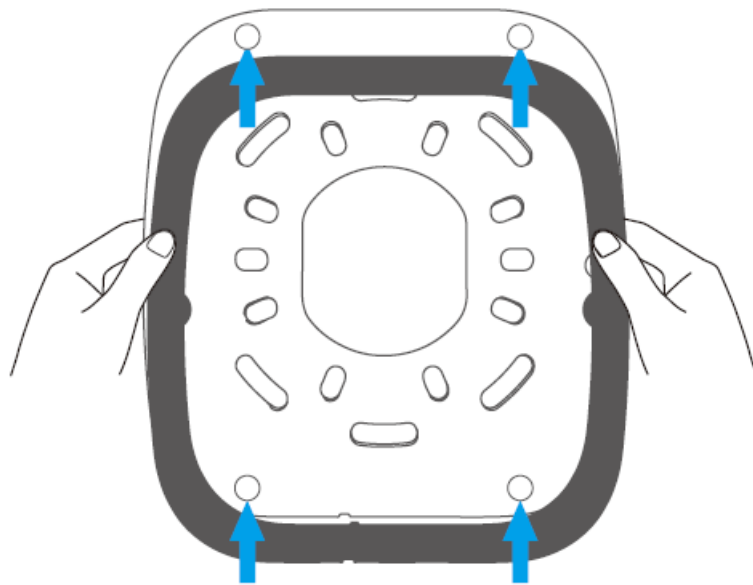

Step 4: Mark the mounting location

Use a pen to mark the screw holes after determining the mounting location. We recommend you use a level to make sure alignment to ground is correct.

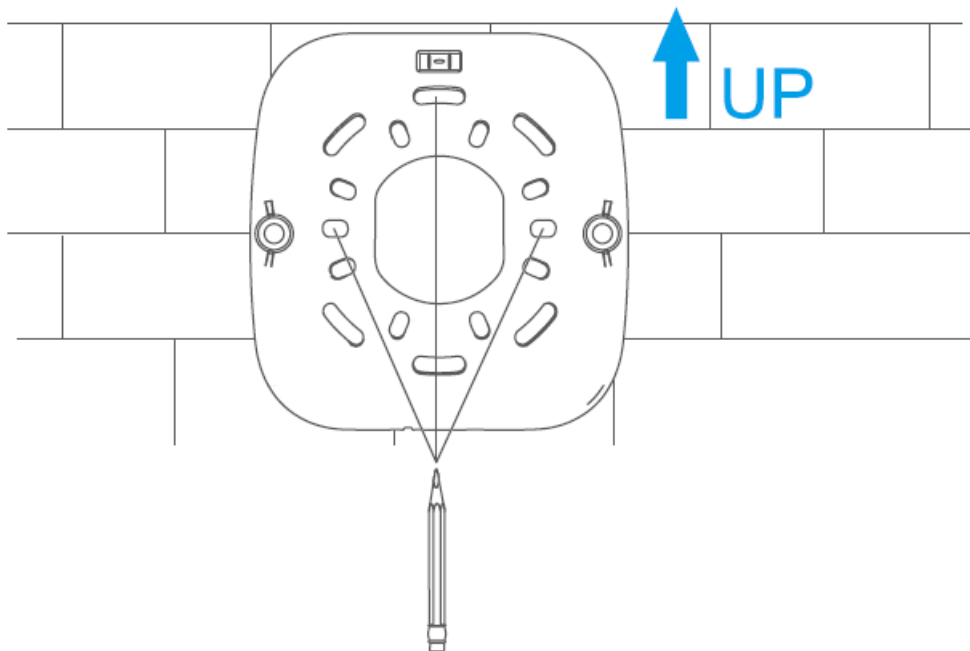

Step 5: Select a proper place for drilling

1. Drill a hole in the mounting place that does not influence plumbing, electrical cables or other building services.
2. Secure the plastic wall anchors into the hole with a hammer.

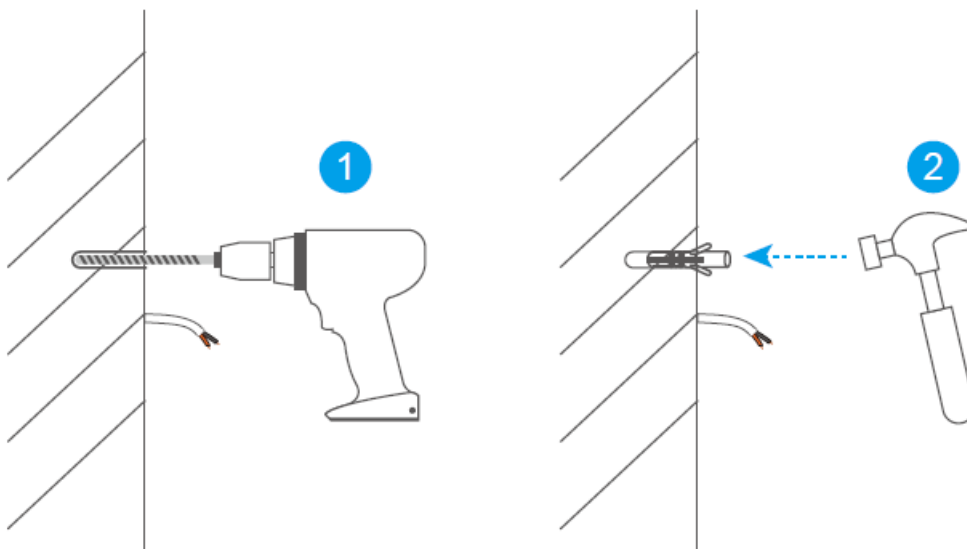

Step 6: Fix the mounting bracket on the mounting area

1. Push all the wires through the large opening of the bracket carefully.
2. Tighten the screws to fix the bracket on the mounting area. Pay attention to the horizontal position on the top.

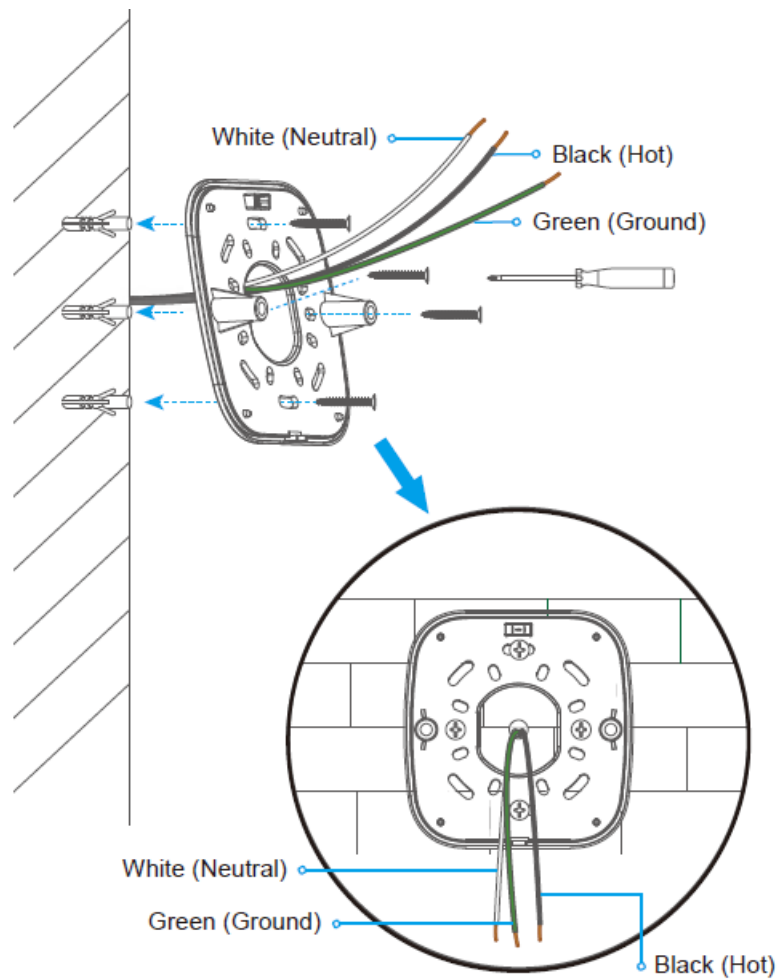

Step 7: Connect the power wire

1. Connect the ground wire coming out of your junction box to the yellow wire (ground) with tag.
2. Use a wire nut (included) to connect the white wire (neutral) to the neutral wire coming out of your junction box.
3. Connect the black wire (hot) to the hot wire coming out of your junction box using another wire nut.

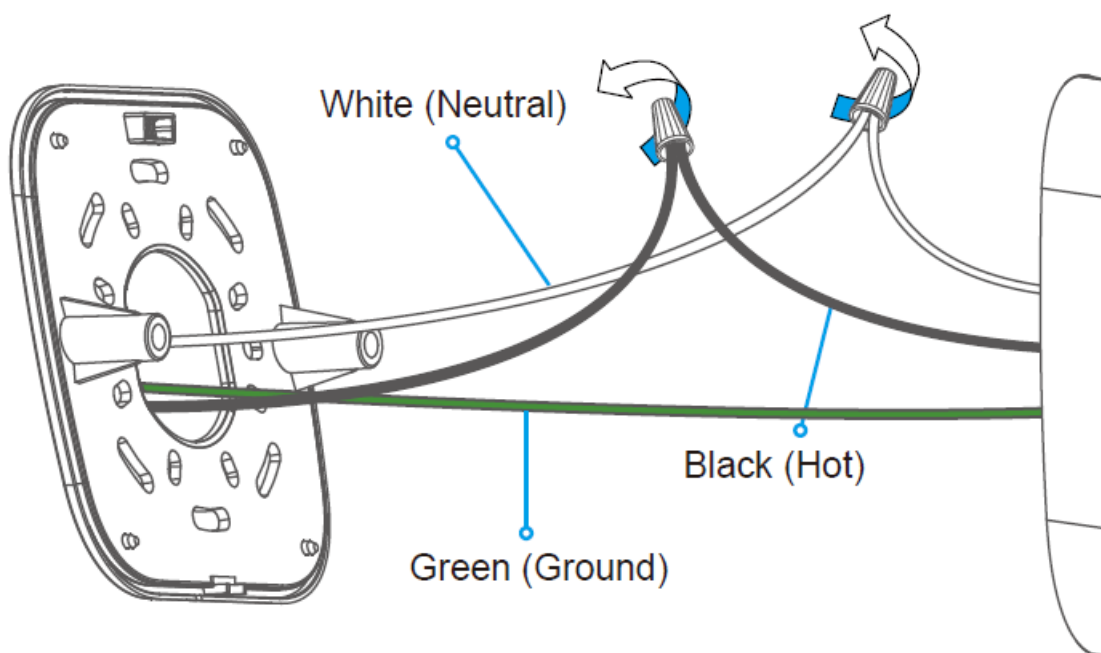

Please note:

If you are not clear about the neutral or hot wires coming out of the junction box, consult with a licensed electrician.

Step 8: Install the floodlight camera onto the bracket

1. Align the mounting posts with the holes on the floodlight camera and press them together.

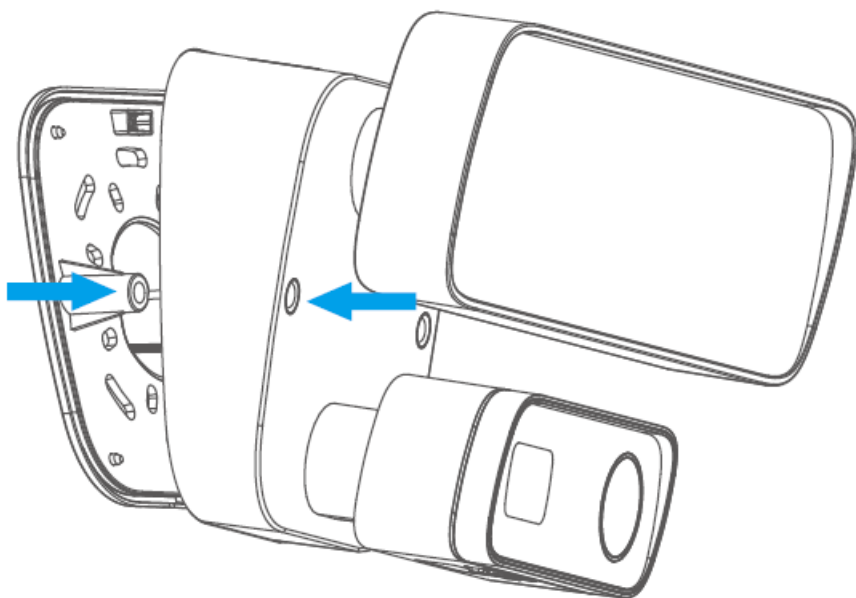

2. Secure the floodlight by screwing the screws clockwise.

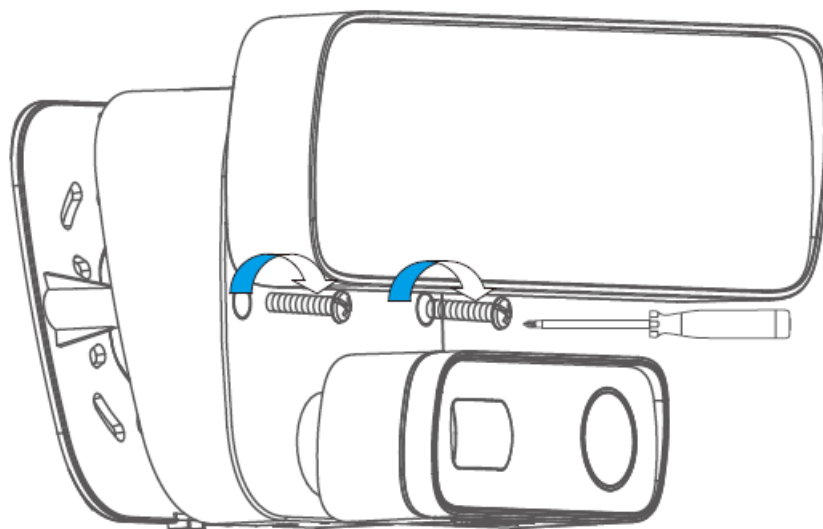

Step 9: Put the waterproof rubber cap on the screw hole

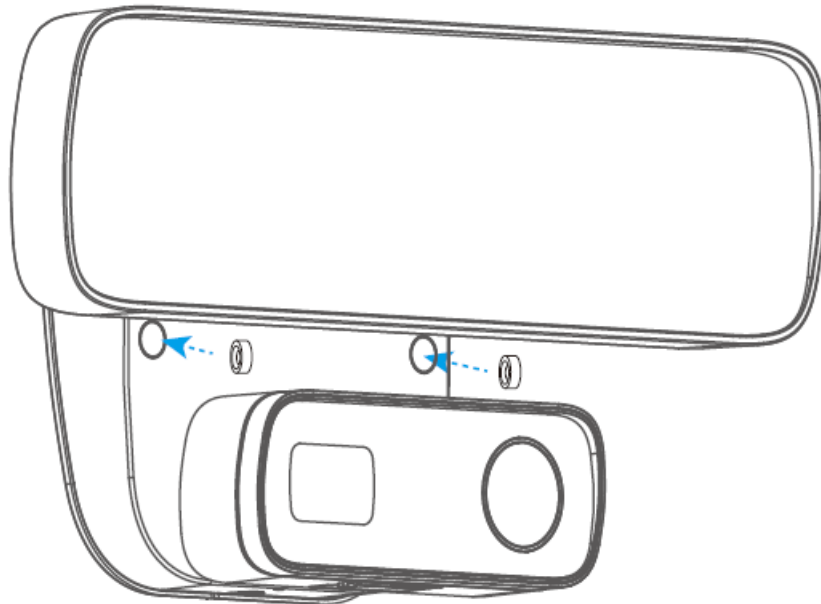

Step 10: Adjust the angle of the floodlight and camera

Loosen or tighten the screw to further adjust the angle of the floodlight and the camera. After adjusting the angle of the camera and floodlight, put the waterproof rubber cap on the screw hole.

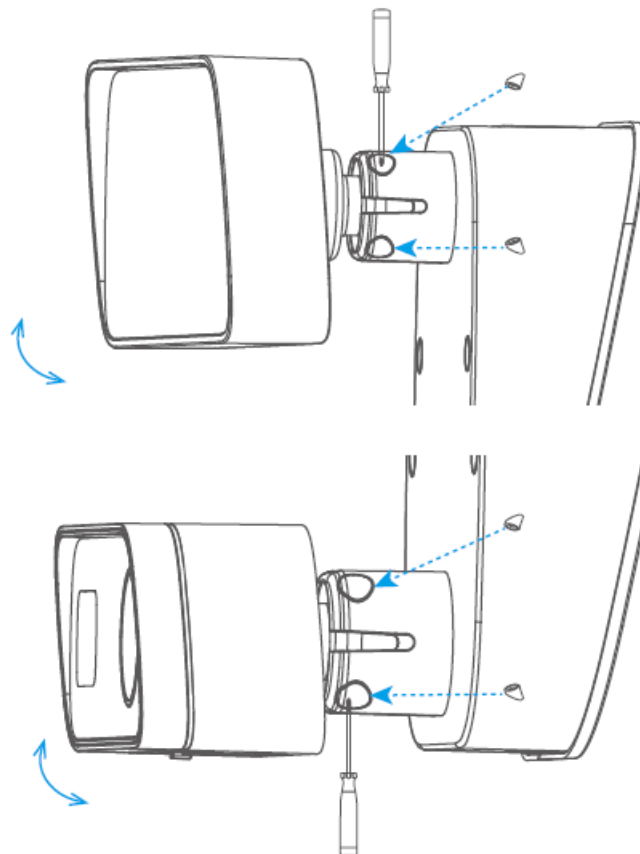

Please note:

Do not remove the floodlight part or the camera part from the ball socket on the base. Failure to do this may result in product being damaged.

Step 11: Turn on the power to the floodlight at the fuse box

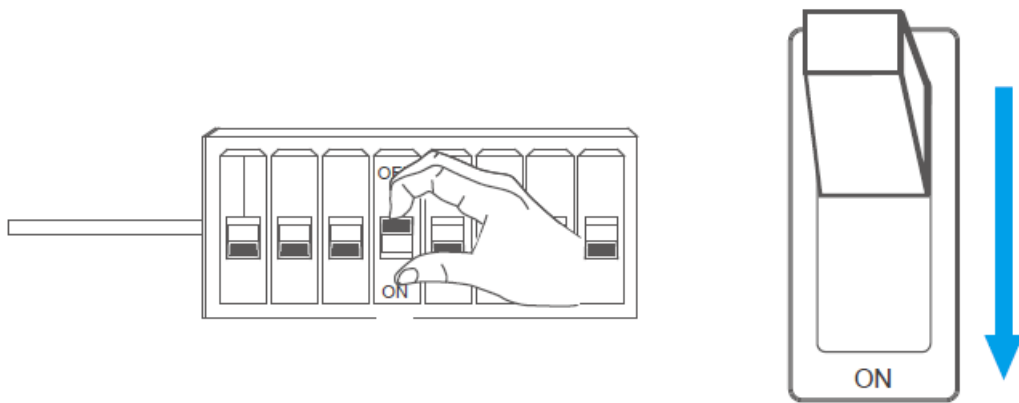

Using Your Floodlight Camera

Preparation

Please prepare the following stuff before using this floodlight camera.

A smartphone or tablet using IOS 12.0 / Android 6.0 or higher (A Mac or Windows PC will not work with this product).



Android phone

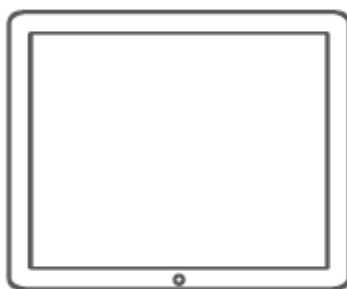

iPad



iPhone

A Wi-Fi router (2.4GHz)

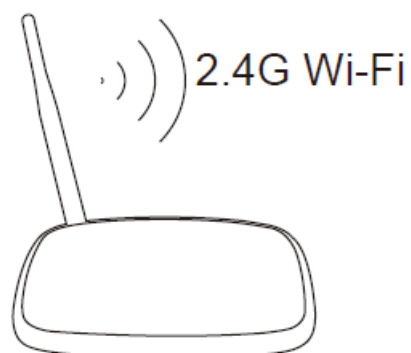

The Green LED Indicator Status

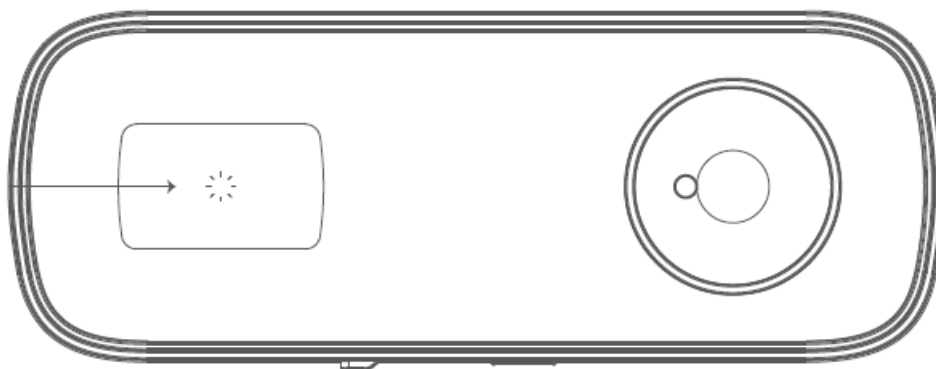

System State	Indicator Activity
Power On	The Green LED indicator turns on, and you can hear a voice prompt three times after about 40 seconds.
Power off / Wi-Fi is connected	The Green LED indicator goes out.
Wi-Fi is connecting	The Green LED indicator flashes slowly.
Wi-Fi is disconnected	The Green LED indicator flashes fast.

Installing and Taking Out the Micro SD Card

Please note:

- To ensure the stable video recording of the Micro SD card, we recommend that you use a Micro SD card (not included) that is Class 10 or above.
- To make sure the device works normally, please format the Micro SD card before using it.

Installing the Micro SD Card:

Insert the Micro SD card properly into the slot as below:

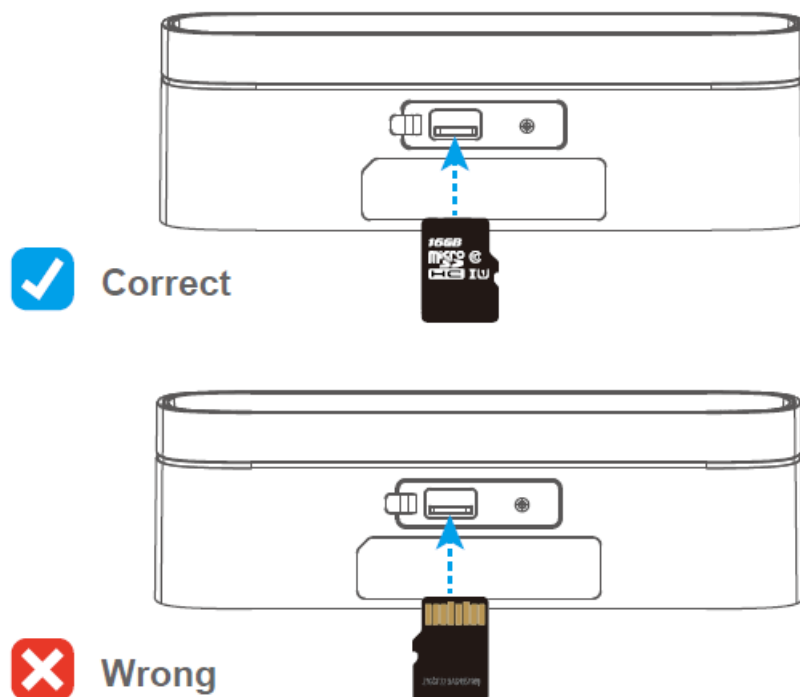

Taking out the Micro SD card:

Push in the card gently and it will pop outward. The card is then released from the slot and ready to be removed when you hear a clicking sound.

Install iObsurv app on your phone

Download the iObsurv app from Apple Store / Google Play.

Add a camera to the app

Before adding a camera to the app, please check the following points:

- Turn on the DHCP of the router. Your MAC address should be off. DHCP allows the floodlight to automatically connect to the internet.
- Distance between the router and the camera should be within 3 meters (9 feet) during configuration.
- Do not use Chinese or special symbols such as %, \$, #, @, *, etc to name the Wi-Fi or set its password. The name and password of the Wi-Fi can not be blank.
- Make sure your smartphone is connected to the Wi-Fi router before configuration.

1. Open the app. Tap the "+" icon in the upper right corner, and select "First Add".

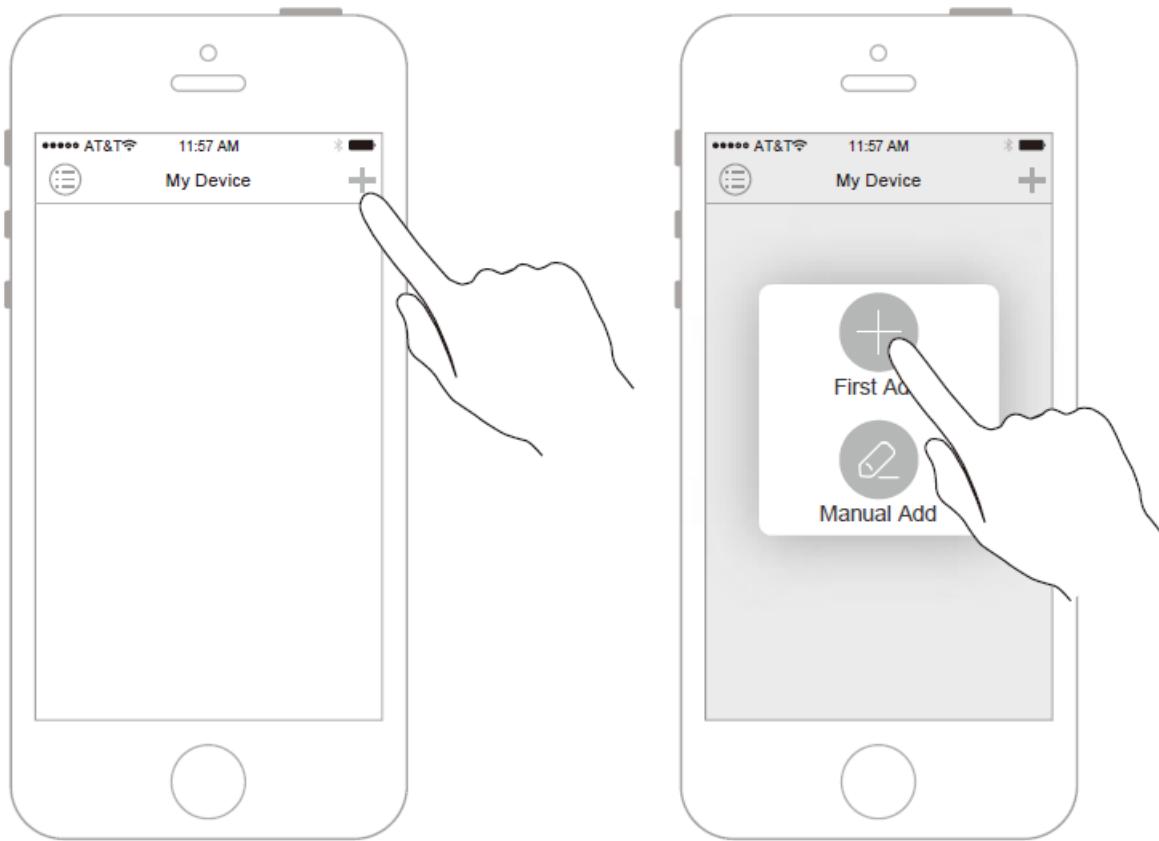

2. Name the camera and scan the camera's UID (the QR code on the bottom of the camera, or the tag in the package).

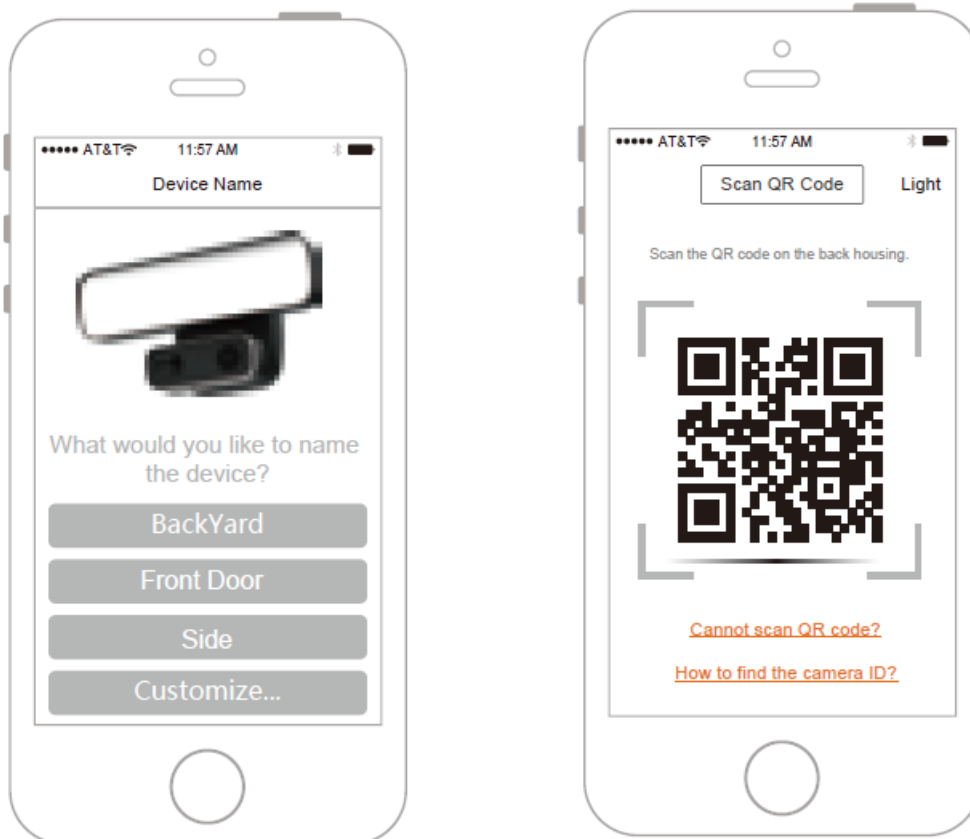

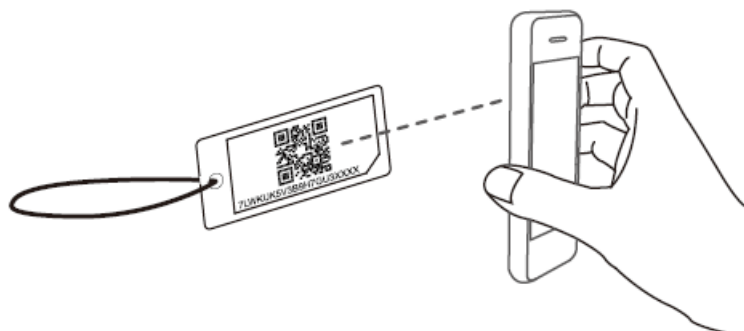
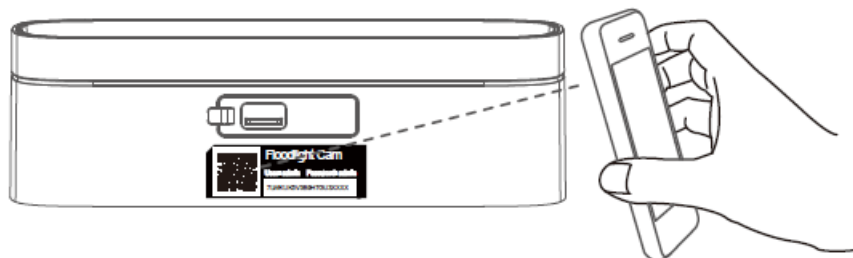

3. Enter the correct name and password of the Wi-Fi (2. 4GHz).

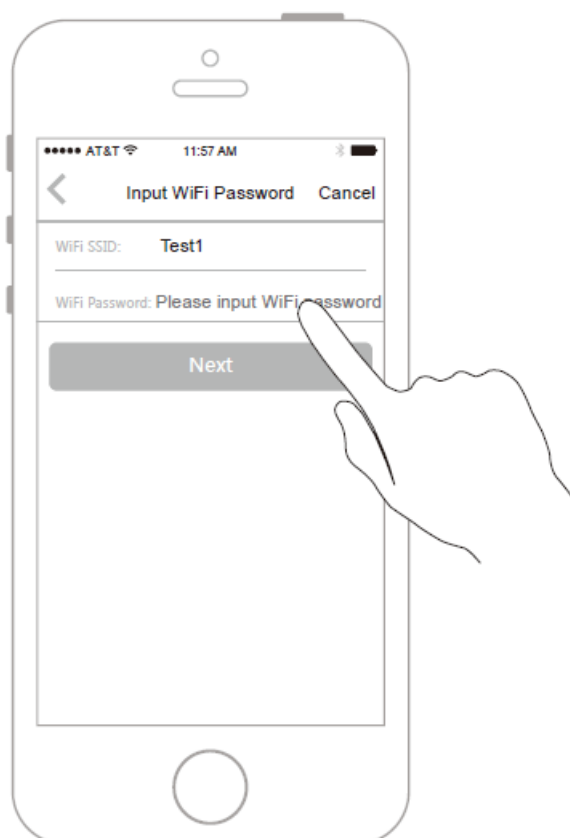

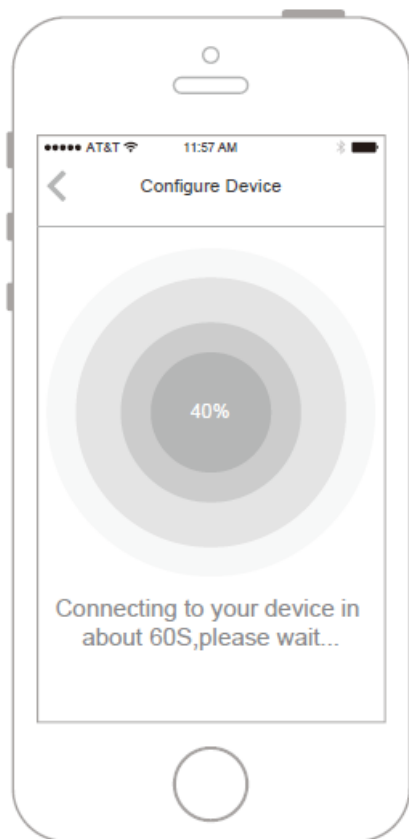

4. Put your smartphone or tablet close to the camera within 3 meters (9 feet).

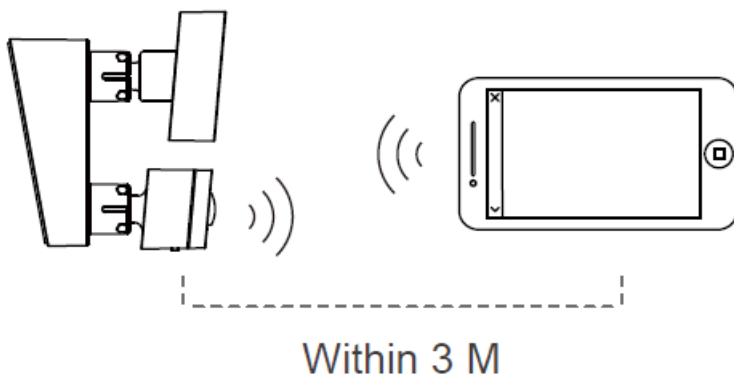

Please note:

Turn up the volume of your smartphone or tablet to the maximum when configuring.

5. Wait for about 60 seconds and the configuration is done (the Green LED indicator turns off when the configuration is successful).

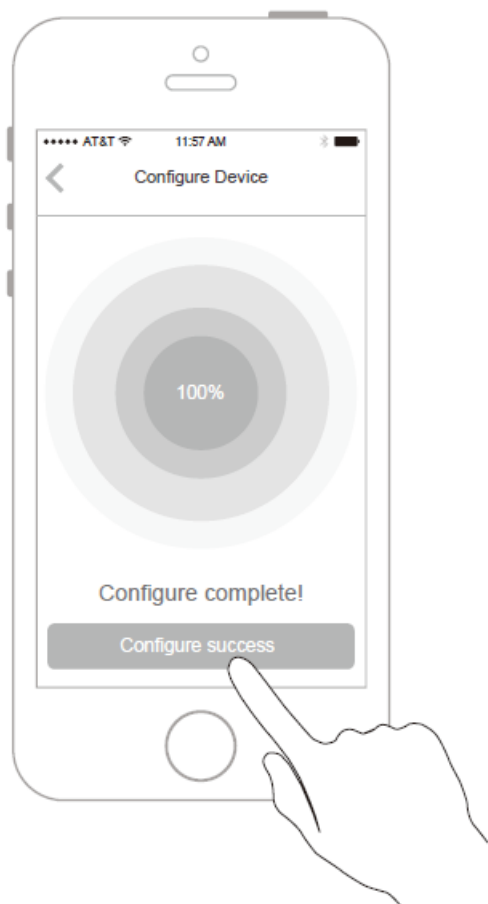

6. Tap the screen to watch the live video.

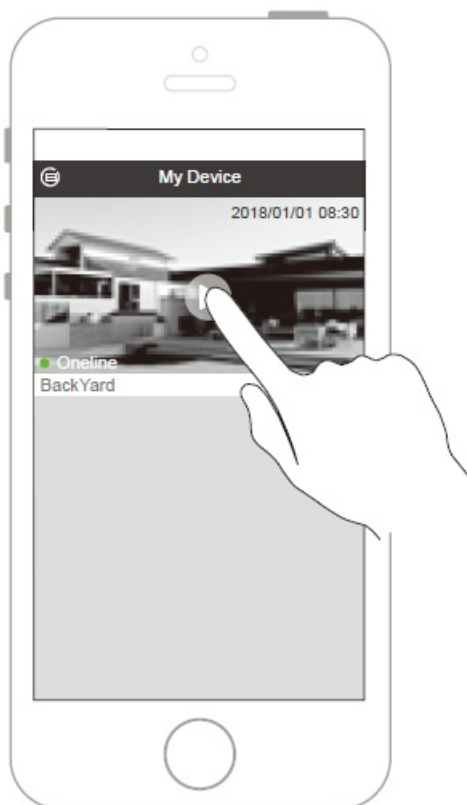

Device Interface

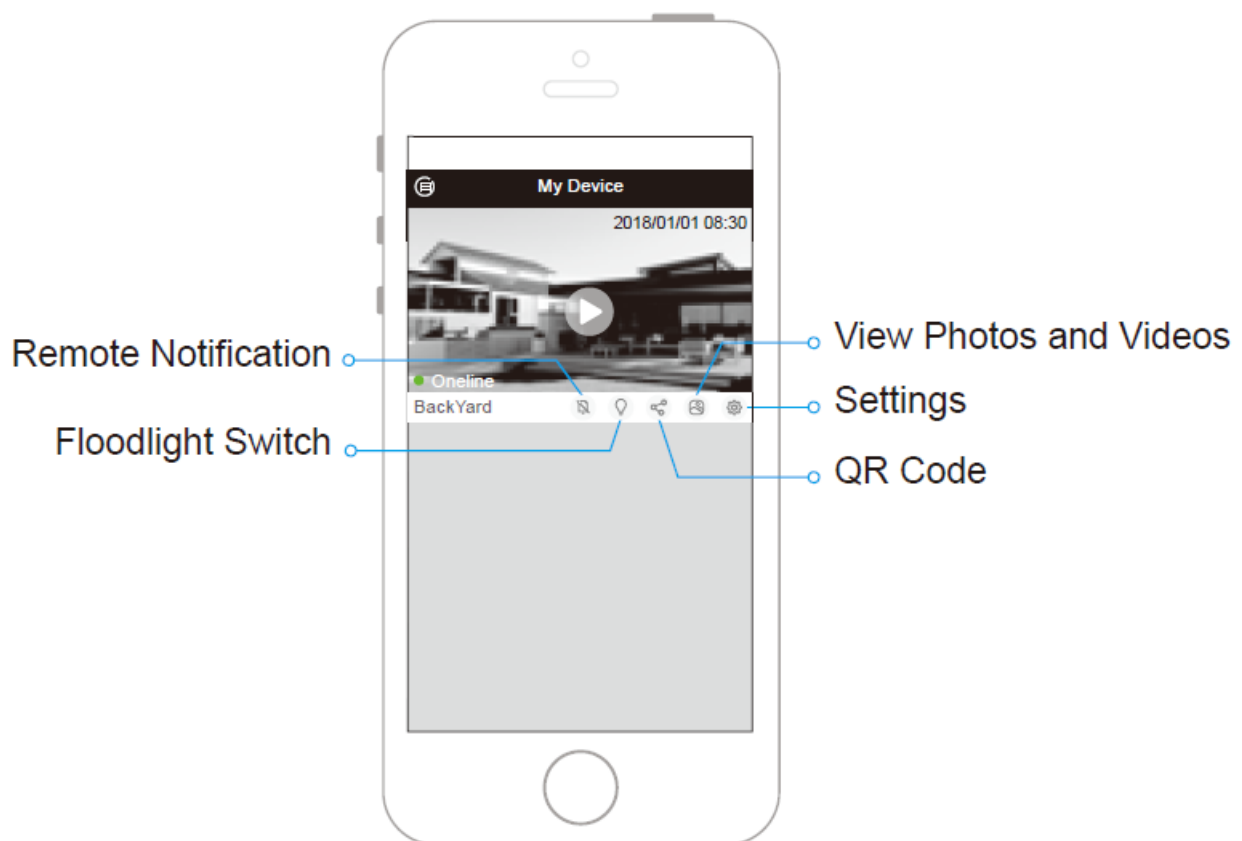

Live Video Viewing Interface

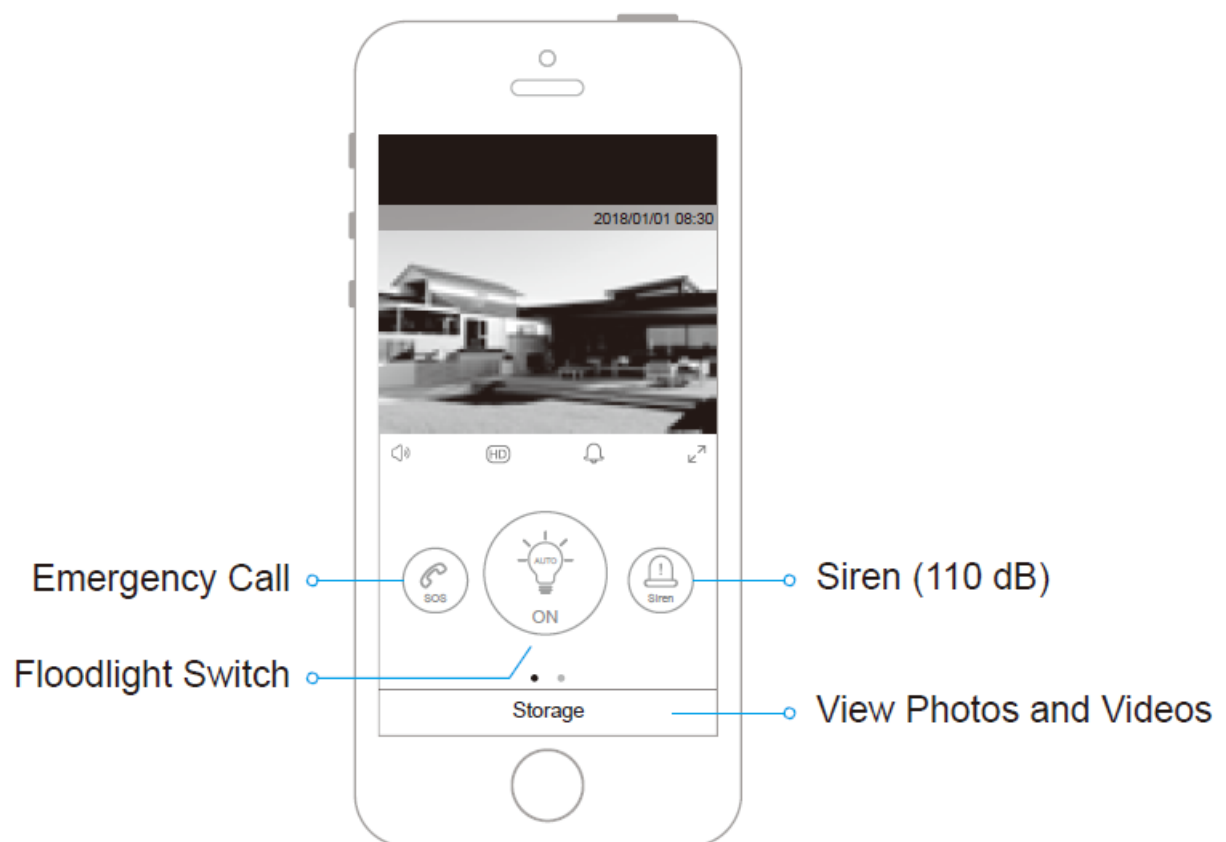

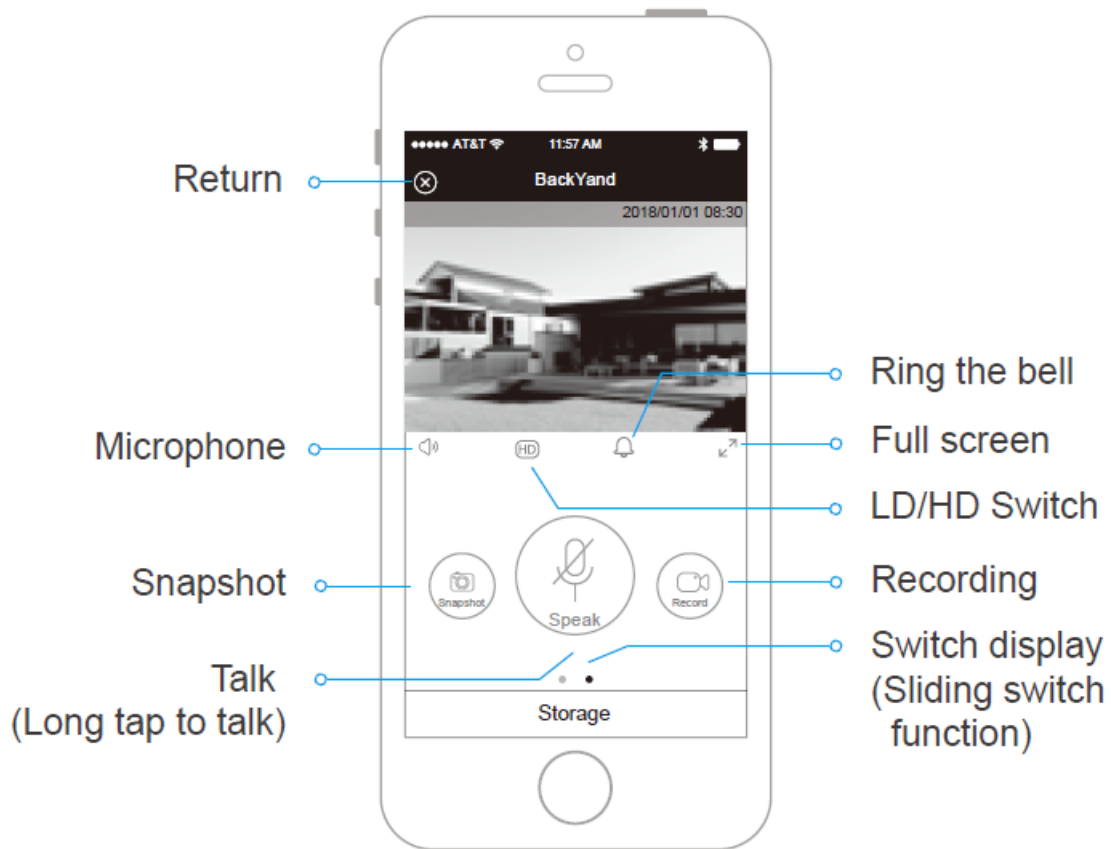

Reset the floodlight camera

If you fail to connect the camera to the app or want to replace the Wi-Fi system, you can reset the camera.

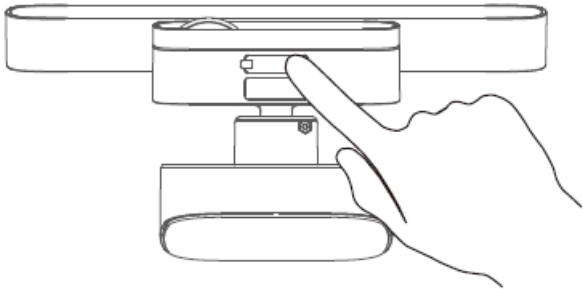

1. When the floodlight camera is powered on, press and hold the "Reset" button on the bottom of for 5 seconds until you hear a voice prompt, which indicates that the reset is done.
2. Wait for about 40 seconds, and you will hear a voice prompt three times, which indicates that the floodlight camera is on.
3. Open the app to complete the Wi-Fi configuration.

Specifications

Network Specification	
Port Protocol	ONVIF
Support Protocol	TCP / IP, HTTP, TCP, ICMP,UDP, ARP, IGMP, SMTP, FTP, DHCP, DNS, DDNS, NTP, UPNP, RTSP
Wi-Fi Specification	
Wireless Standard	WiFi802.11 b/g/n Wi-Fi connection @ 2.4GHz only
Frequency Range	2.4 GHz ~ 2.4835 GHz
Transmission Distance	Outdoor: 20 meters Indoor: 10 meters (sensitive to environmental change)
Security	64 / 128-bit WEP, WPA / WPA2, WPA-PSK / WPA2-PSK, WPS
Other Requirements	
Smartphone System Requirement	Android 6.0 or higher / IOS 12.0 or higher
Power Consumption	1.5W-3W (Camera running all functions)
Micro SD Card	128G Max. (*AVI video file format)
Siren	Remote-activated 110-decibel alarm
Working Temperature	-4°F to 149°F
Power Supply	AC 110V to 240V

LED Specification	
Power Consumption	24W
Beam Angle	120°
Color Temperature	5000 kelvin
Illumination	2400 lux
Life Time	20,000 hours
Camera Specification	
Pixel	2 Megapixels
Minimum Illumination	0.3 lux
Lens	f=3.6mm, F=2.0, Horizontal angle of view: 120°
PIR Detection Angle	120°
Video Specification	
Video Compression Type	H.264 / MJPEG
H.264 Encoding Type	Base Line Profile / Main Profile
Output Bit Rate	64kbps-4Mbps
Video Size	1920 x 1080
Frame Rate	25fps (max)
Audio Specification	
Audio Compression Standard	G.711 / G.726

FAQs

Please refer to the FAQ list in the iObsurv app.

1. Open the app, then tap ”  “



2. Tap "FAQ" to enter the FAQ page

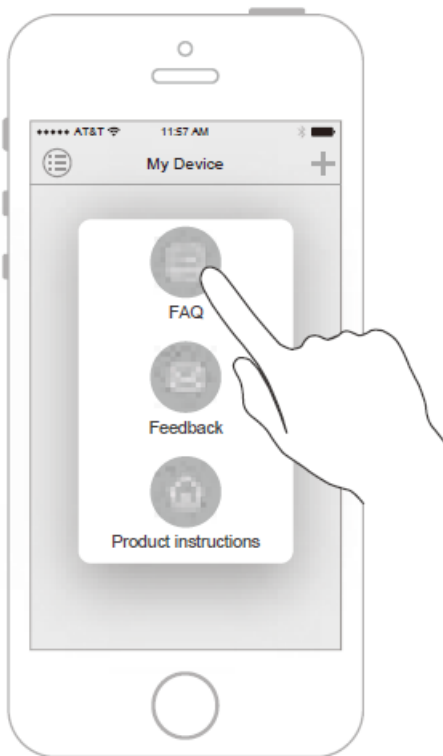

Safety and Warranty

Safety Instructions

- Turn the power off before inspection, installation or removal.
- Do not install this product on an unstable platform or bracket to prevent it from falling, which may cause serious equipment damage and personal injury.

- Do not install this product facing any objects with bright lights, including sunshine, bright lamp lights, etc.
- Avoid direct eye exposure to the floodlight while it is turned on.
- Do not operate the device if there are signs of smoke, steam, over-heating or crackling noise that can be heard from the device.
- Do not attempt to disassemble this product. The high voltage inside this product may cause personal injury. When you need to repair this product, please have it done by a trained or authorized personnel.
- Do not install this product near any equipment that generates strong magnetic fields, in any environment with flammable or explosive materials or in extremely hot, cold, rainy environments.
- When transporting this product, it is recommended to transport it with the factory packaging.
- Do not expose wiring to edges of sheet metal or other sharp objects to prevent wiring damage or abrasion.
- Make all electrical and grounded connections following the National Electrical Code (NEC) and any applicable local code requirements.
- The manufacturer will not be deemed liable or held responsible for any damage caused by faults or manufacturing defects that may be present in any of its products or the misuse or incorrect installation of the device.

Warranty

We strive to build our products with the highest attention to detail and craftsmanship. However, sometimes there are occurrences of defect.

We are happy to offer a one-year hassle-free warranty to all our products as we continue to make amazing products. Please contact us if you have any questions about our devices.

Documents / Resources

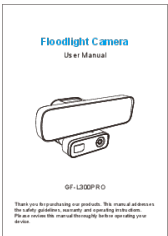
 The image shows the cover of a user manual for a Floodlight Camera. At the top, it says 'Floodlight Camera' in blue and 'User Manual' in black. Below this is a line drawing of the device, which is a rectangular floodlight with a camera lens on the right side. At the bottom, there is a small disclaimer in black text: 'Thank you for purchasing our products. This manual addresses the safety guidelines, installation and connecting instructions. Please review this manual thoroughly before operating your device.'	<p>Zxtech Floodlight Camera [pdf] User Manual Floodlight Camera</p>
--	---