

Zwift Play Handlebar Steering Controllers



Zwift Play Handlebar Steering Controllers User Guide

[Home](#) » [ZWIFT](#) » Zwift Play Handlebar Steering Controllers User Guide 

Contents

- [1 Zwift Play Handlebar Steering Controllers](#)
- [2 OPTIONAL SECURING](#)
- [3 POWERING UP](#)
- [4 CHARGING](#)
- [5 CONNECTING](#)
- [6 POWERING DOWN/SLEEP MODE](#)
- [7 ADDITIONAL SUPPORT](#)
- [8 Warranty Information](#)
- [9 FOR YOUR SAFETY](#)
- [10 Documents / Resources](#)
 - [10.1 References](#)
- [11 Related Posts](#)

ZWIFT:PLAY

Zwift Play Handlebar Steering Controllers



SCAN TO WATCH INSTRUCTIONAL VIDEOS



- [ZWIFT.COM/PLAY/SETUP](https://zwift.com/play/setup)

HELLO!

To get started with your new Zwift Play controllers, follow this quick start guide, go to zwift.com/play/setup, or scan the QR code for more help.

- Left and right Zwift Play controllers

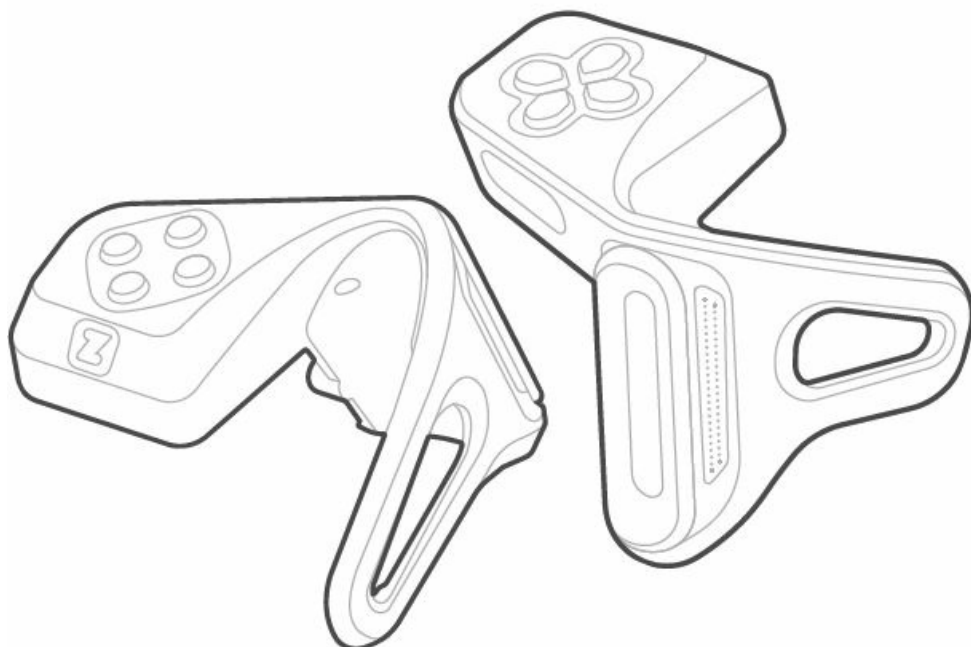

- Handlebar spacers (x2)

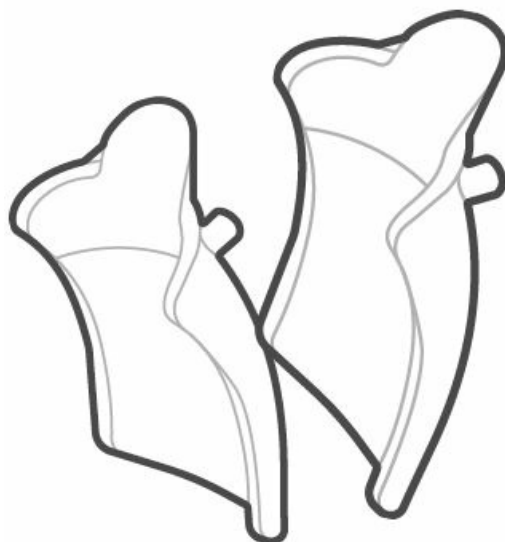

- Charge cable



ATTACHING 1/2

Identify your right and left controller.

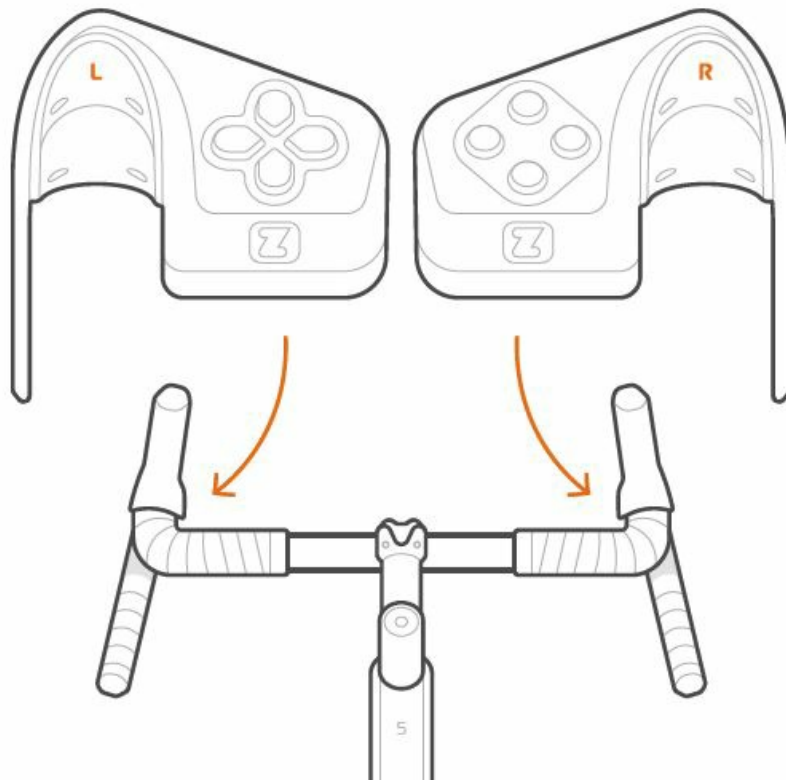

ATTACHING 2/2

To fasten your Zwift Play controllers onto your handlebar, place them snugly under the appropriate brake hoods. Wrap the flexible strap around your handlebars and onto the hook.

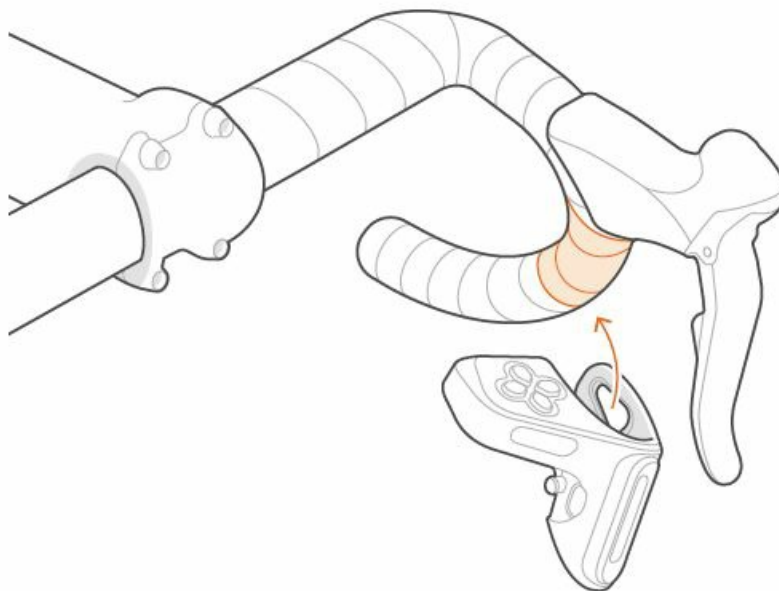

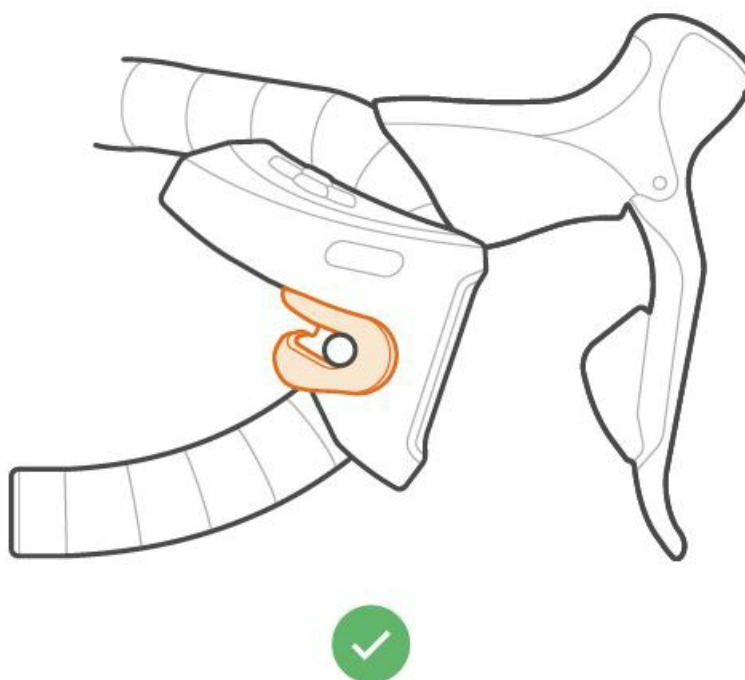
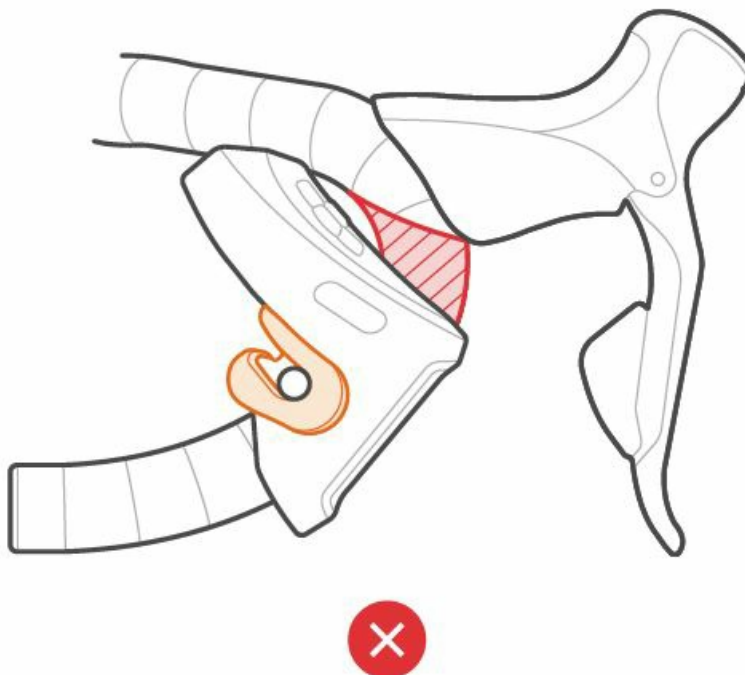

OPTIONAL SECURING

If the controllers aren't secure, use the spacers provided.

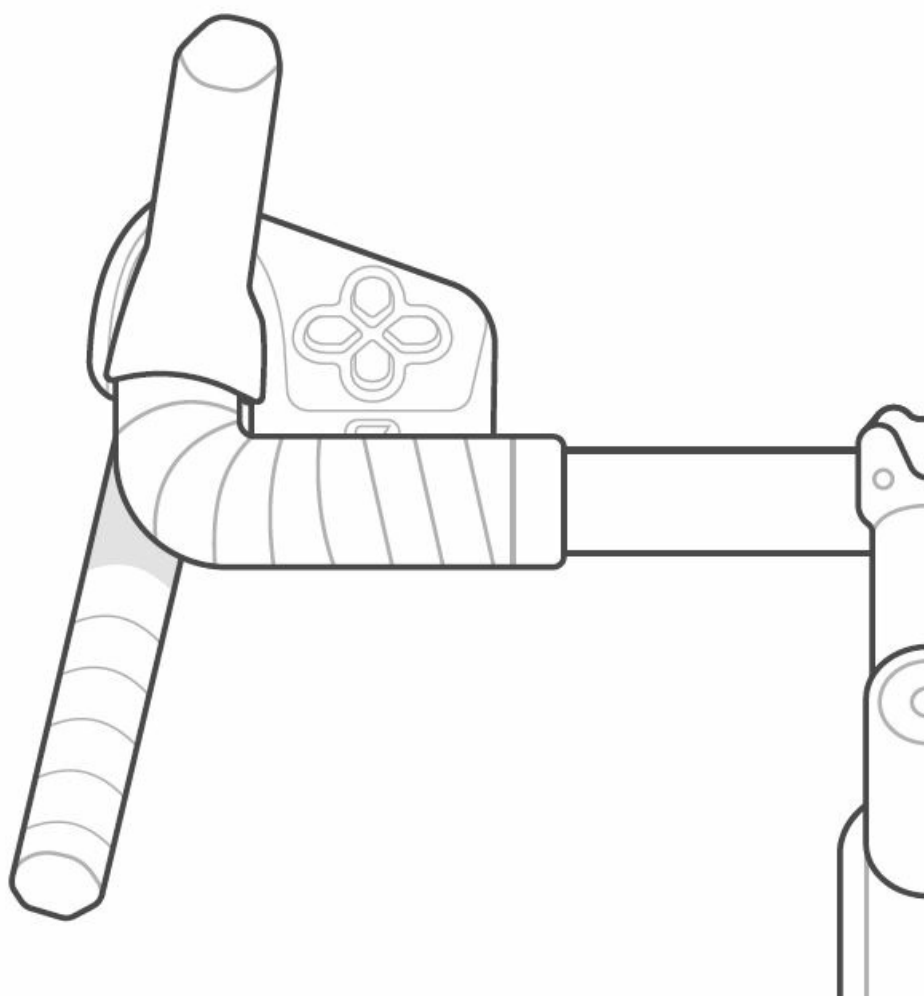
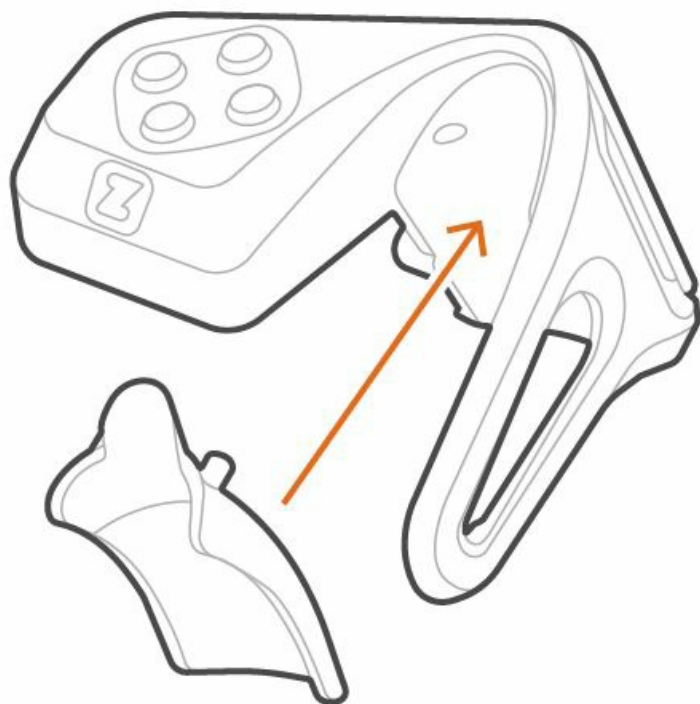

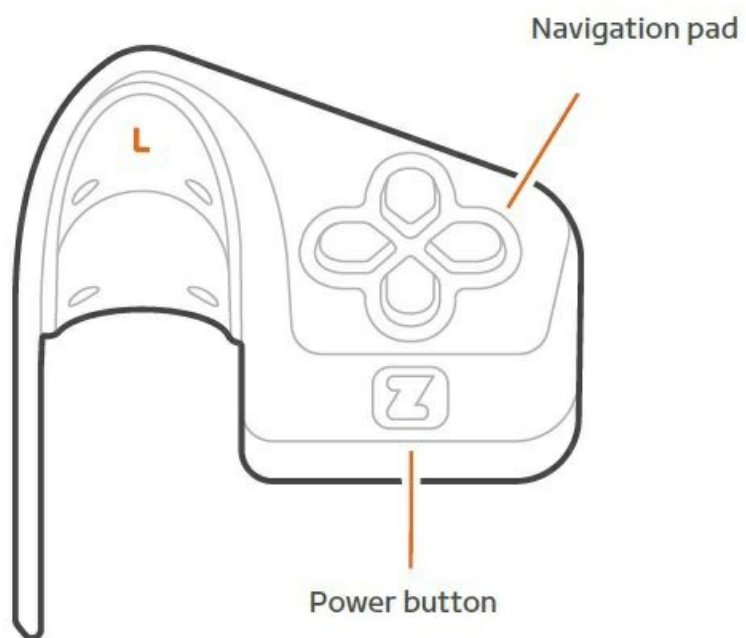
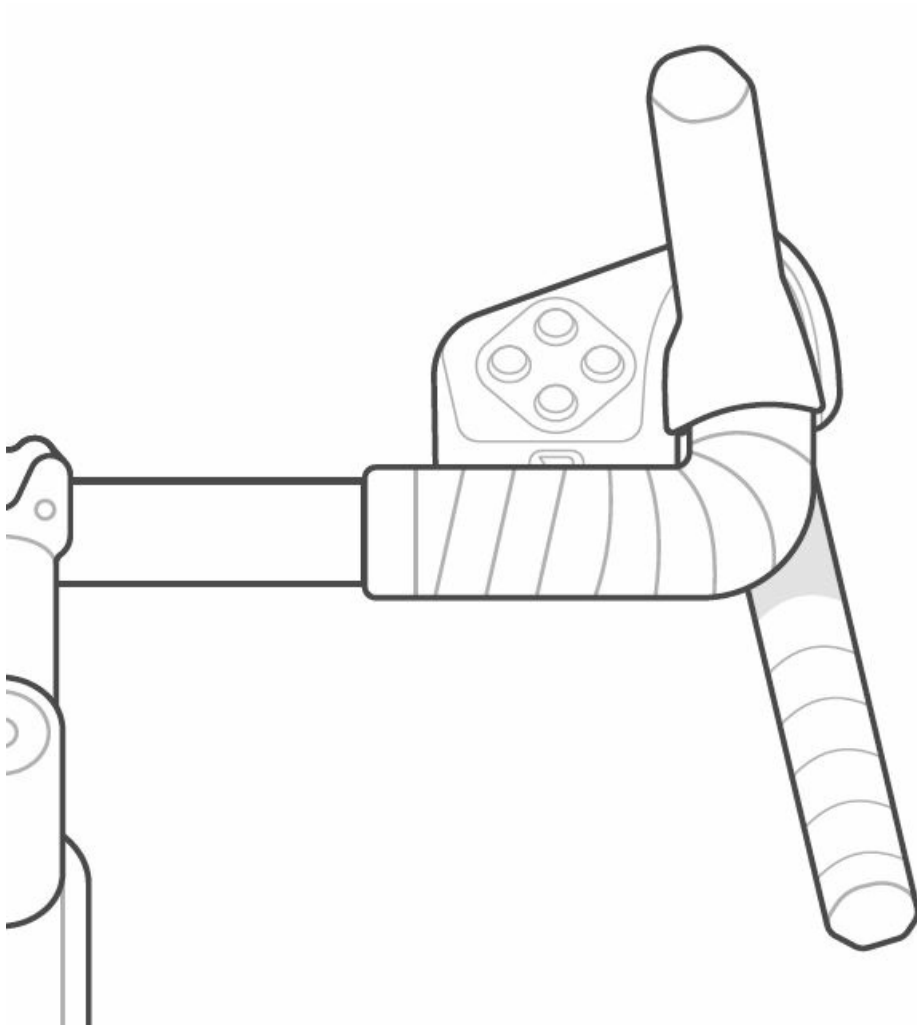

USB port

Handlebar strap

Analog paddle

ZL

LS

Side buttons

Action buttons

R

Power button

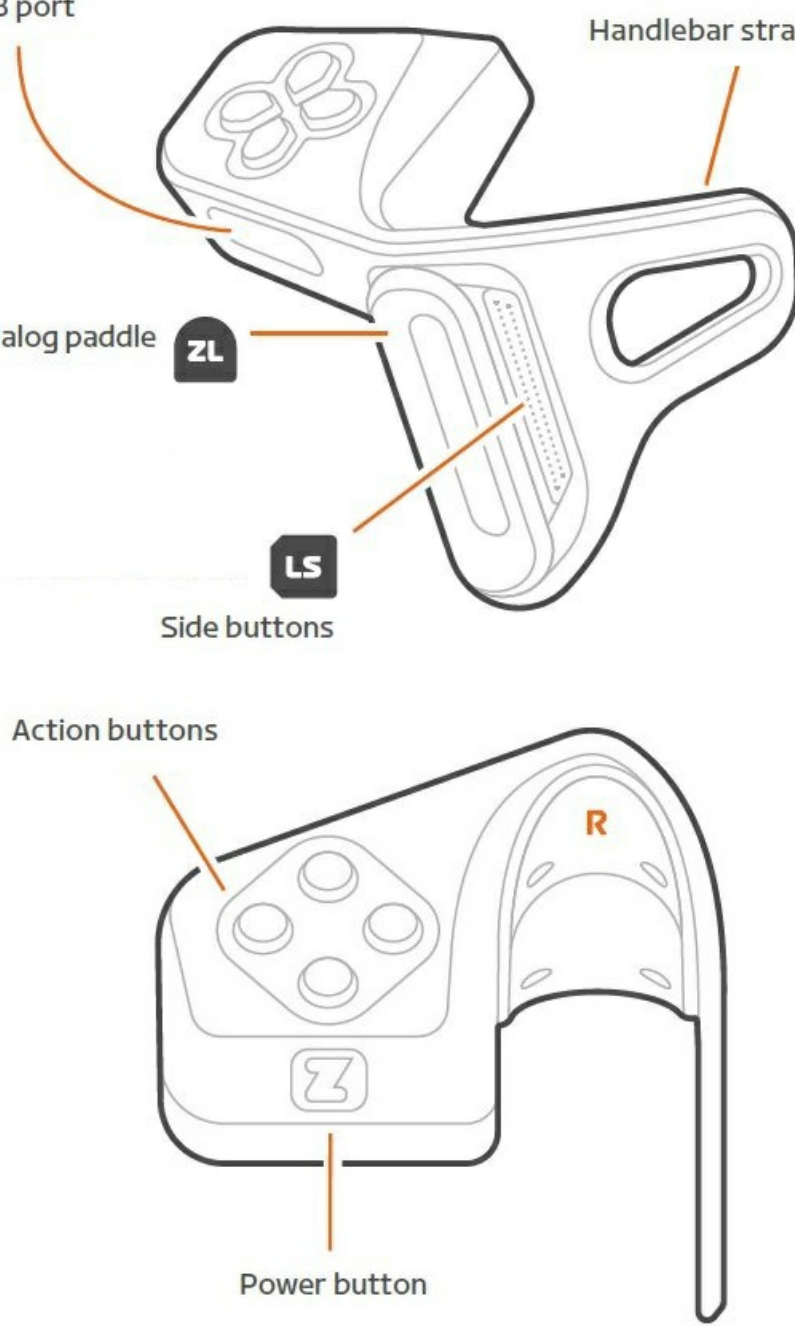

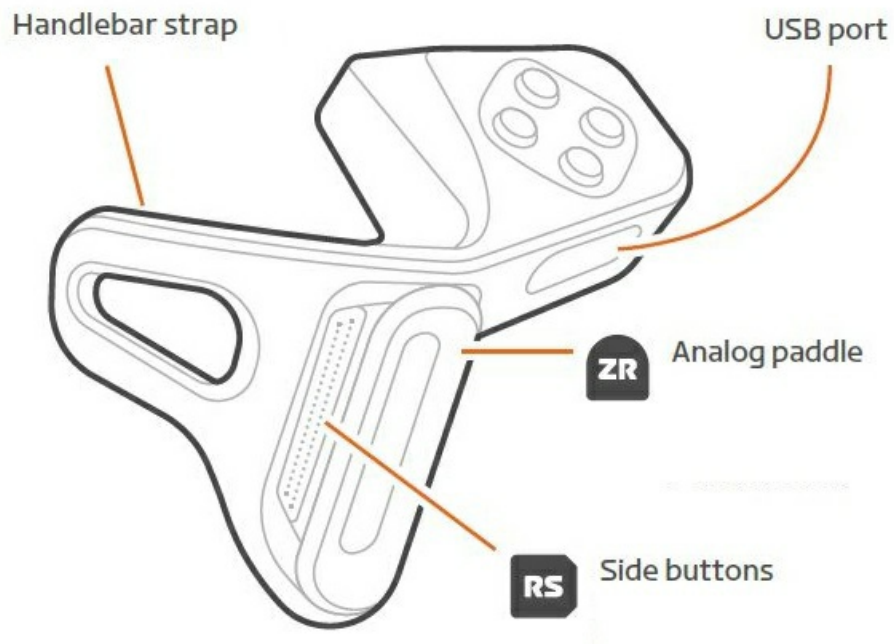

POWERING UP

Press the Zwift logo button to power up each Zwift Play controller. The LED will flash blue when it's ready to pair.

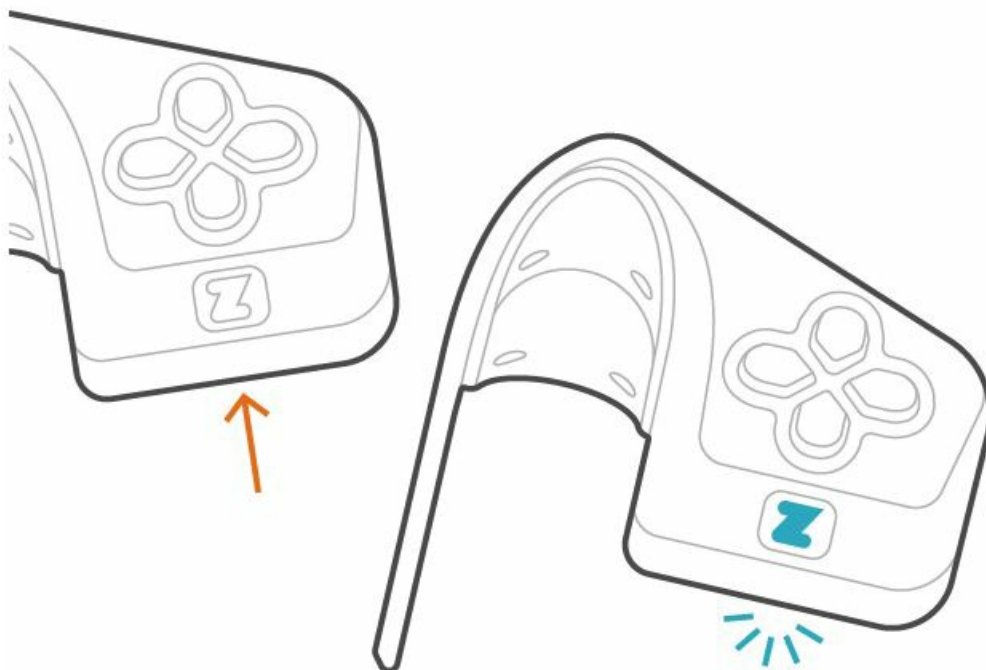

CHARGING

Fully charge your controllers with the cable provided. The Z logo button will pulse green while charging. Find out more about the LED states on.

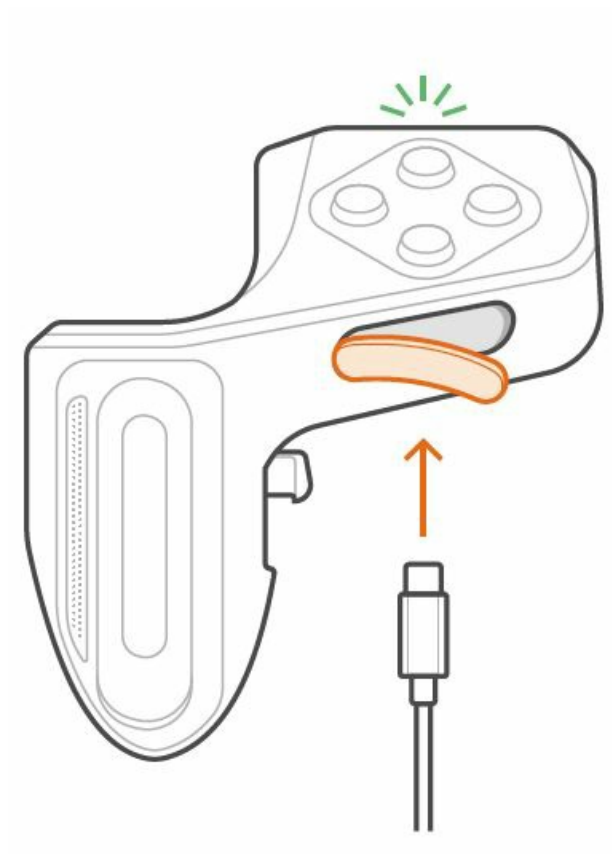

- Green pulsing – Charging



- Green – Charged



- Orange flashing – Low battery



- Red flashing – Error



- Blue pulsing – Ready to connect



- Blue – Connected



- Yellow – Updating



CONNECTING

Download and log in to Zwift on the device you're using for the game app. Turn on your Zwift Play controllers and follow the instructions on the screen to connect them.

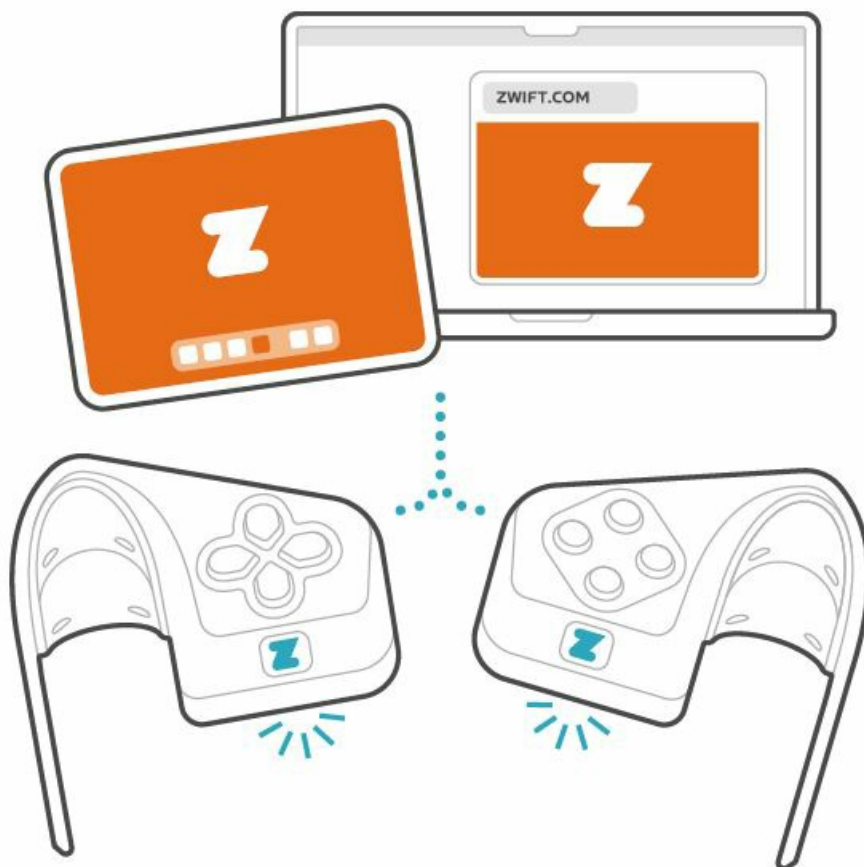

UPDATING

Download the Zwift Companion app to your mobile device or tablet to keep your Zwift Play controller firmware up to date.

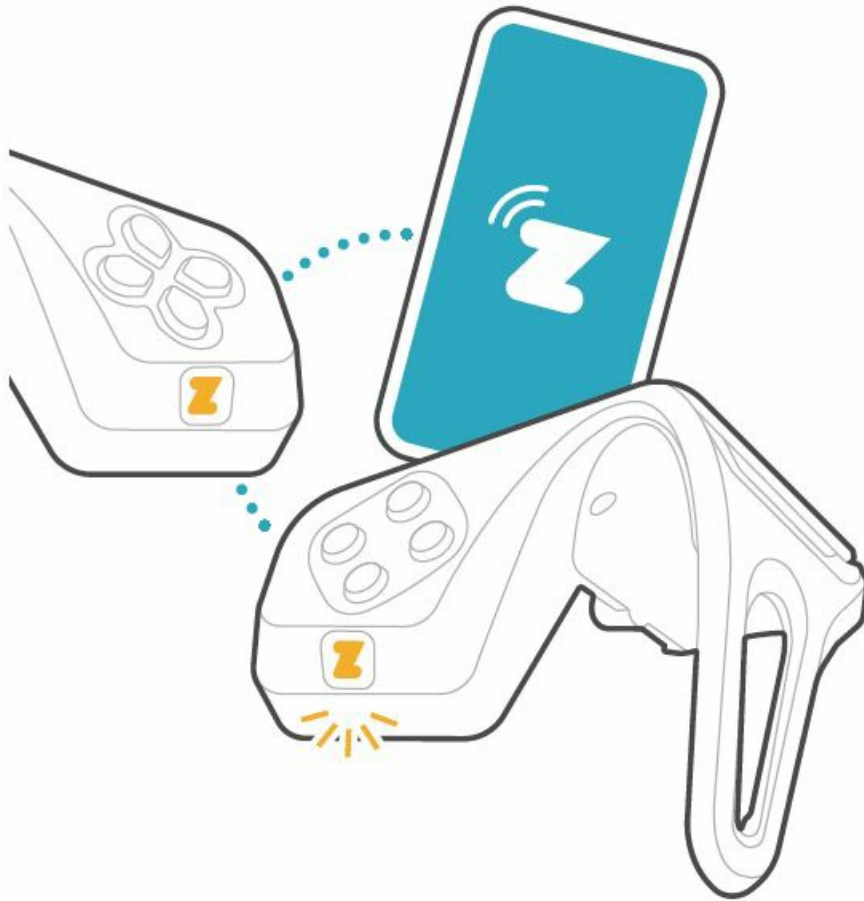

POWERING DOWN/SLEEP MODE

Your Zwift Play controllers automatically go into sleep mode after use. Press one of the buttons to wake them up.

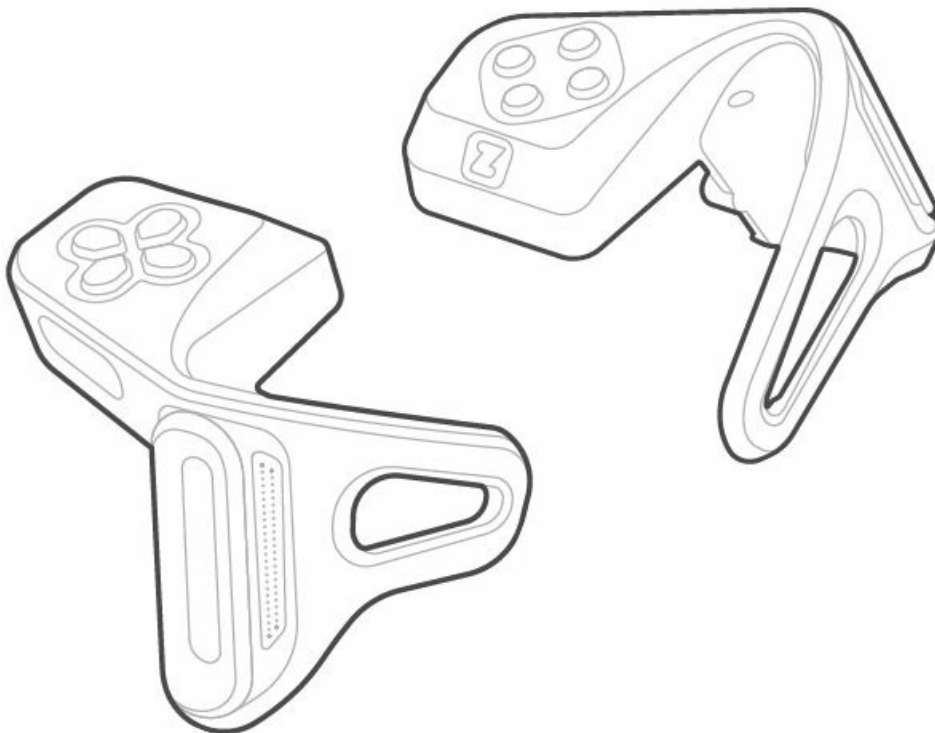

ADDITIONAL SUPPORT

Contact Zwift

- [Zwift.com/support](https://www.zwift.com/support)

Product tech spec

- Bluetooth® 5
- USB-C charge port
- Haptic Feedback
- Rechargeable Li-Ion battery
- Zwift Play experience enabled by TG0 technology.

Maintenance

1. Wipe clean after each ride.
2. Avoid using detergents, alcohol wipes, cleaning sprays, or any other cleaning products.
3. To avoid damage to the controllers, do not submerge in water.
4. Before cleaning your Zwift Play controllers, turn them off by pressing and holding the Z logo button.
5. You can leave your controllers attached between Zwift rides.



The device should only be connected to a limited power source (under 100 VA by IEC 60950-1) or that it is only connected to a power source of classification PS2 under 100W by IEC 62368-1. This device complies with part 15 of the FCC Rules. Operation is subject to the following two conditions: (1) This device may not cause harmful interference, and (2) this device must accept any interference received, including interference that may cause undesired operation. A copy of the full EU declaration of conformity is available at [zwift.com/play/compliance](https://www.zwift.com/play/compliance)

Warranty Information

Please see our returns and warranty policy here: [zwift.com/play/warranty](https://www.zwift.com/play/warranty)

FOR YOUR SAFETY

Please read the section below before setting up or using your Zwift Play controllers.

- Consult a doctor before beginning a new fitness regime: improper or excessive training may cause serious injury.
- If you experience faintness, shortness of breath, or chest or knee pain, consult a doctor.
- Make sure that your Zwift Play controllers are securely fitted to your handlebars before use.
- Your Zwift Play controllers are for indoor cycling use only. Remove both controllers before riding your bike outside.

- Do not use any power cables or adapters other than those provided by or recommended by Zwift.
- The battery charging voltage and the current should not exceed the Zwift Play-rated voltage and the current.

Battery Safety Warning

- This device is equipped with built-in rechargeable Lithium batteries that cannot be removed or replaced. Do not disassemble or modify the battery.
 - Zwift Play should NOT go in household garbage or recycling bins.
 - Disposal of a battery into fire or a hot oven or mechanically crushing or cutting the battery can result in an explosion.
 - Leaving a battery in an extremely high temperature surrounding environment can result in an explosion or the leakage of flammable liquid or gas.
 - A battery subjected to extremely low air pressure may result in an explosion or the leakage of flammable liquid or gas.
 - Do not use unauthorized or incompatible power adapters or data cables, which may damage the Zwift Play or cause fire, explosion or other hazards.
-

Documents / Resources



[Zwift Play Handlebar Steering Controllers](#) [pdf] User Guide

Play Handlebar Steering Controllers, Play, Handlebar Steering Controllers, Steering Controllers, Controllers

References

- [Zwift The at Home Cycling & Running Virtual Training App](#)
- [Zwift How to Connect Your Zwift Play: A Step-by-Step Guide](#)
- [Zwift Zwift Limited Warranty and Return Policy](#)
- [Zwift Zwift Support](#)
- [Zwift User Manual](#)

[Manuals+](#), [Privacy Policy](#)

This website is an independent publication and is neither affiliated with nor endorsed by any of the trademark owners. The "Bluetooth®" word mark and logos are registered trademarks owned by Bluetooth SIG, Inc. The "Wi-Fi®" word mark and logos are registered trademarks owned by the Wi-Fi Alliance. Any use of these marks on this website does not imply any affiliation with or endorsement.