

ZOOZ ZEN74 Toggle Dimmer



# ZOOZ ZEN74 Toggle Dimmer User Manual

[Home](#) » [ZOOZ](#) » ZOOZ ZEN74 Toggle Dimmer User Manual 

## Contents

- 1 ZOOZ ZEN74 Toggle Dimmer
- 2 Product Information
- 3 Product Usage Instructions
- 4 FAQ
- 5 FEATURES
- 6 SPECIFICATIONS
- 7 HOW TO INSTALL THE WIRES
- 8 COMPLETE INSTALLATION
- 9 TROUBLESHOOTING
- 10 SCENE CONTROL
- 11 WARRANTY
- 12 FCC STATEMENT
- 13 Documents / Resources
  - 13.1 References
- 14 Related Posts



**ZOOZ ZEN74 Toggle Dimmer**



## Product Information

- This product is a smart switch with advanced settings and scene control capabilities.
- It allows for the customization of various parameters and can be integrated with different smart home hubs for enhanced functionality.

## Product Usage Instructions

To install the wires, follow these steps:

1. **Lift Screw:** Carefully pull the screw away from the switch to ensure it's loose. Do not force it. Avoid using power tools.
2. **Press Down:** Press the loose screw down with your finger to catch the thread.
3. **Insert Wire:** Ensure the wire is straight, then insert it into the terminal while holding the screw down. Do not wrap wires around the terminal screws.
4. **Tighten:** Turn the screw clockwise to tighten the wire. Do not over-tighten.

The LED indicator may not light up initially. Toggle the switch up for ON and down for OFF. If the test fails, ensure power is fully restored, wiring matches instructions, and the load isn't too large.

Access advanced settings to customize your switch, including ramp rate, tap behavior, smart bulb mode, and more. Follow the provided instructions or contact support for assistance.

## FAQ

- **Q:** Can I install the switch outdoors?

- **A:** No, this product should be installed indoors only.
- **Q:** How do I trigger scenes with the switch?
- **A:** Enable scene control in Parameter 13 and assign scenes or actions to different tap combinations as well as held and released positions.
- **Q:** What should I do if the LED indicator doesn't light up?
- **A:** Toggle the switch up for ON and down for OFF. If issues persist, check the power supply, wiring, and load conditions.

## FEATURES

- Manual or Z-Wave® on/off and brightness control
- NEW: 800 series Z-Wave® chip for better range and faster control
- Simple Direct 3-Way: connect with existing on/off switches in 3-way, 4-way, and 5-way set-ups, no add-on is needed
- Scene control: trigger actions with multi-tap (select hubs only)
- Smart bulb mode: disable relay and control light via Z-Wave®
- Night light mode: press down when off to turn lights on to 20%
- Z-Wave® Long Range for ultra-reliable no-mesh communication
- Works with LED and incandescent bulbs (don't use with tubes)

## SPECIFICATIONS

- **Model Number:** ZEN74 800LR
- **Z-Wave® Region:** US/CA/MX
- **Power:** 120 VAC, 60 Hz
- **Maximum Load:** 100 W LED, 300 W incandescent; DON'T use with fans, switches receptacles, or tube lights
- **Range:** Up to 500 feet line of sight (up to 1300 ft with Long Range)
- **Operating Temperature:** 32-104° F (0-40° C)
- **Installation and Use:** Indoor only

## CAUTION

- This is an electrical device – please use caution when installing and operating the dimmer switch. Remote control of appliances may result in unintentional or automated activation of power.
- Do not use this Z-Wave® device to control electric heaters or other appliances that produce the risk of fire, burns, or electrical shock when unattended.
- To reduce risk of overheating and possible damage to other equipment, do not install this unit to control a receptacle; a motor-operated appliance; a fluorescent lighting fixture; or a transformer-supplied fixture.

## BEFORE YOU INSTALL

- This switch is intended for installation under the National Electric Code and local regulations. It is recommended that a licensed electrician perform this installation.

## WIRING: READ IT!

1. CHECK THE LOAD: lights only (100W for LEDs, 300W for incandescent), DON'T CONNECT THIS SWITCH TO OUTLETS OR TUBE LIGHTS.
2. POWER OFF: turn the circuit power off in the breaker panel before you start. If installed in a multi-switch box with multiple circuits, turn the power off at all of the circuits.
3. CHECK THE WIRES: Mark load (most often black), line (most often black), neutral (most often white), and ground (most often bare). 14 AWG wires only! Don't rely exclusively on your multimeter to identify the wires!



- NOT SURE WHAT YOU'RE SEEING? WE'LL HELP! [SUPPORT.GETZOOZ.COM](https://support.getzooz.com) SEND US PICTURES OF YOUR SET-UP BEFORE YOU DISCONNECT WIRES.

4. REMOVE THE OLD SWITCH: disconnect the wires and label them with the included label stickers.
5. CONNECT THE Z-WAVE® SWITCH: follow all installation steps carefully. Wire the switch EXACTLY like in the diagram.

## ZEN74 WIRING DIAGRAM FOR SINGLE POLE INSTALLATION

1. Insert the ground (bare) wire into the Ground terminal (not shown in the diagram)
2. Insert the power source wire to the Line terminal and load wire to the Load terminal. Load and line CAN'T be swapped so make sure you identified them correctly!
3. Run the white jumper (included in the box) from the bundle of white wires to the Neutral terminal

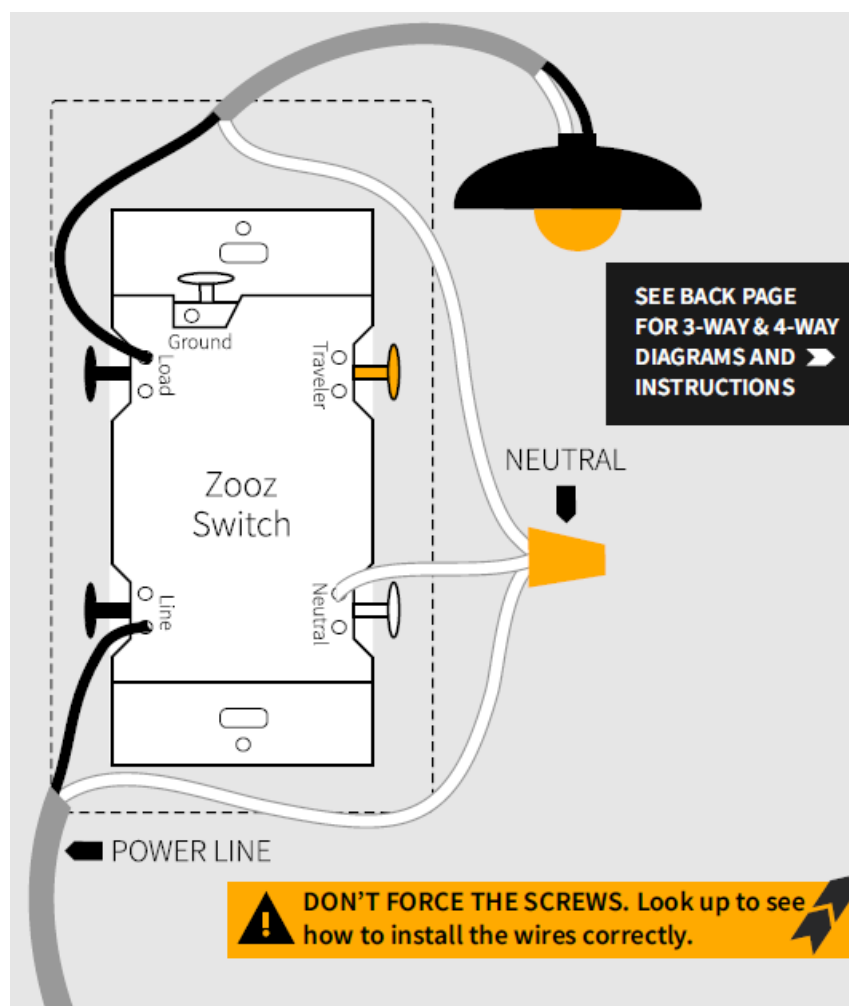

## HOW TO INSTALL THE WIRES

1. **LIFT SCREW:** carefully pull the screw away from the switch to make sure it's loose. **DO NOT** force it. **NO POWER TOOLS!**
2. **PRESS DOWN:** press the loose screw down with your finger so it catches the thread.
3. **INSERT WIRE:** make sure the wire is perfectly straight, then insert it into the terminal while holding the screw down. **DO NOT** wrap wires around the terminal screws!
4. **TIGHTEN:** turn the screw clockwise to tighten the wire. **DO NOT OVERTIGHTEN!**

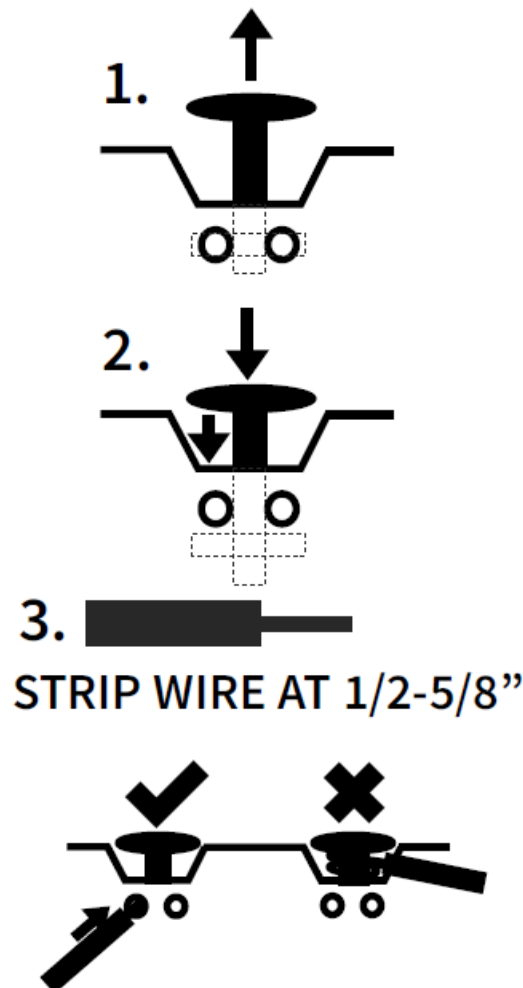

## COMPLETE INSTALLATION

- Secure your Z-Wave® switch in the box with mounting screws, handling the wires with care.
- Always use the supplied short screws! Install the wall plate and restore power to the circuit

## TEST THE SWITCH

The LED indicator will not light up when you turn the power back on, that's normal. Toggle the switch up for ON and toggle it down for OFF. If the test fails, please check that:

- power is fully restored to the circuit
- wiring matches the instructions exactly
- the load isn't too large and overheating the switch causes it to shut off

## WARNING

- This product should be installed indoors upon completion of any building renovations.
- Prior to installation, the device should be stored in a dry, dust-and-mold-proof place.
- Do not install the switch in a place with direct sun exposure, high temperature, or humidity.
- Keep away from chemicals, water, and dust.
- Ensure the device is never close to any heat source or open flame to prevent fire.
- Ensure the device is connected to an electric power source that does not exceed the maximum load power.
- No part of the device may be replaced or repaired by the user.

## Z-WAVE® CONTROL

1. ADD DEVICE to your hub Initiate inclusion (pairing) in the app (or web interface). Not sure how? Scan one of the QR codes below for step-by-step instructions or get in touch: [www.support.getzooz.com](http://www.support.getzooz.com).
2. Finalize inclusion at the switch TOGGLE UP 3 TIMES QUICKLY if using traditional Z-Wave® inclusion.

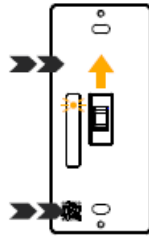

SCAN THE QR CODE / ENTER THE 5-DIGIT PIN if using the new SmartStart method.

SmartStart-enabled devices can be added to a Z-Wave® network by scanning the QR code on the product. The LED indicator will blink blue to signal communication and turn green for 3 seconds if inclusion is successful or turn red for 3 seconds if the pairing attempt fails.

NEED SOME HELP? [ask@getzooz.com](mailto:ask@getzooz.com)

- Choose your hub and scan the QR code with your phone's camera. Then click on the link to access the step-by-step pairing instructions.



- Get more tutorials and helpful tips at [www.support.getzooz.com](http://www.support.getzooz.com)

## TROUBLESHOOTING

The dimmer won't add to your system. Try this:

1. Initiate EXCLUSION and toggle the dimmer down 3 times quickly.
2. Toggle the dimmer up 4-5 times quickly when adding it.
3. Bring the gateway controller (hub) closer to the dimmer, it may be out of range.
4. Get troubleshooting tips for your hub at [www.support.getzooz.com](http://www.support.getzooz.com).

### **The light doesn't turn on when toggled up?**

1. Turn the power off at the breaker and check if a wire didn't get loose.
2. Slide the air gap switch located under the toggle to the right to make sure power is going to the bulbs.
3. Exclude the dimmer from the hub or reset it in case manual control was accidentally disabled.
4. The load may be incompatible so try it with a single incandescent bulb.

### **EXCLUSION (REMOVING / UNPAIRING DEVICE)**

1. Bring your Z-Wave® gateway (hub) close to the switch if possible
2. Put the Z-Wave® hub into exclusion mode (not sure how to do that? [ask@getzooz.com](mailto:ask@getzooz.com))
3. Toggle the dimmer down 3 times quickly (the LED indicator will start blinking blue)
4. Your hub will confirm exclusion, the LED indicator on the switch will turn green for 3 seconds, and the device will disappear from your controller's device list

### **FACTORY RESET**

If your primary controller is missing or inoperable, you may need to reset the device to factory settings. To reset the switch, hold the toggle DOWN for 10 seconds until the LED indicator starts blinking. Release the toggle, and immediately aer, toggle the switch DOWN 5 times to complete the reset. The LED indicator will flash blue 3 times and turn red for 3 seconds to confirm a successful reset.

**NOTE:** All previously recorded activity and custom settings will be erased from the device's memory.

### **ADVANCED SETTINGS**

- Please refer to your controller's user guide for advanced programming instructions as they are a little different for every software.
- Not sure where to start? Go to [www.support.getzooz.com](http://www.support.getzooz.com) for detailed instructions on how to change the settings on SmartThings, Vera, and more. Or just email us: [ask@getzooz.com](mailto:ask@getzooz.com).

### **CUSTOMIZE YOUR SWITCH**

- Here is a selection of settings available to customize your switch. Scan the QR code for a full list of parameters and look below for how to access them on your hub.
- Adjustable ramp rate for fade-in/fade-out
- Double-tap and single-tap behavior
- Smart Bulb Mode (disable the relay): HOLD UP for 10 seconds then 5 x TAP UP
- On/off status after power failure



Choose your hub and scan the QR code with your phone's camera. Then click on the link to learn how to access and change the advanced settings for the switch on your hub.

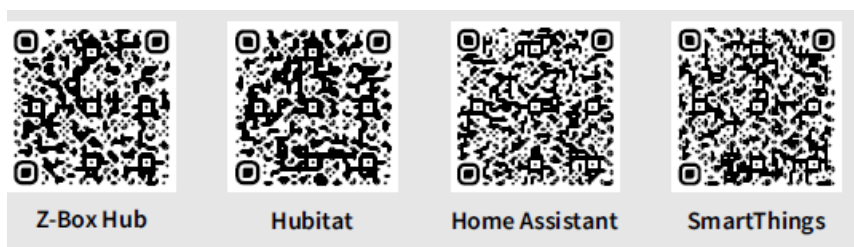

## SCENE CONTROL

- You can trigger scenes or control other connected devices in your network using this switch. Just enable the setting in Parameter 13 and verify that your hub supports scene control. Assign scenes or actions to 1-tap, 2-tap, 3-tap, 4-tap, and 5-tap as well as to hold and release for toggle up and toggle down.
- Scan the QR code for scene control programming instructions on your hub.

QUESTIONS? [ask@getzooz.com](mailto:ask@getzooz.com).



## ASSOCIATION

- This dimmer switch supports Group 1 with up to 1 device for Lifeline communication and Group 2 and 3 with up to 5 devices.
- This device will send BASIC REPORT to Group 1, BASIC SET to Group 2, and MULTILEVEL to Group 3 (for remote dimming) when operated manually.
- You can set direct association to have the switch control another Z-Wave® device independently of the hub by using Groups 2 and 3. Not every hub exposes direct association settings in the interface so please go to [www.support.getzooz.com](http://www.support.getzooz.com) to see if your system allows for direct association.



- This product can be included and operated in any Z-Wave® network with other Z-Wave® certified devices from



other manufacturers and/or other applications. All non-battery-operated nodes within the network will act as repeaters regardless of vendor to increase the reliability of the network.

- This product features the latest Security 2 (S2) framework to remove smart home network hacking risks. This device is equipped with a unique authentication code for trusted wireless communication. Find the full DSK key for the device on the QR sticker located on the green inner box the product came in.
- This is an ETL certified device. ETL, just like UL, is a Nationally Recognized Testing Laboratory. The ETL mark is proof of product compliance with North American safety standards.

## **WARRANTY**

This product is covered under a 12-month warranty and under a 5-year limited warranty once registered. To read the full warranty policy or file a warranty claim, please go to [www.getzooz.com/warranty](http://www.getzooz.com/warranty).

IN NO EVENT SHALL ZOOZ OR ITS SUBSIDIARIES AND AFFILIATES BE LIABLE FOR ANY INDIRECT, INCIDENTAL, PUNITIVE, SPECIAL, OR CONSEQUENTIAL DAMAGES, OR DAMAGES FOR LOSS OF PROFITS, REVENUE, OR USE INCURRED BY CUSTOMER OR ANY THIRD PARTY, WHETHER IN AN ACTION IN CONTRACT OR OTHERWISE EVEN IF ADVISED OF THE POSSIBILITY OF SUCH DAMAGES. ZOOZ'S LIABILITY AND CUSTOMER'S EXCLUSIVE REMEDY FOR ANY CAUSE OF ACTION ARISING IN CONNECTION WITH THIS AGREEMENT OR THE SALE OR USE OF THE PRODUCTS, WHETHER BASED ON NEGLIGENCE, STRICT LIABILITY, BREACH OF WARRANTY, BREACH OF AGREEMENT, OR EQUITABLE PRINCIPLES, IS EXPRESSLY LIMITED TO, AT ZOOZ'S OPTION, REPLACEMENT OF, OR REPAYMENT OF THE PURCHASE PRICE FOR THAT PORTION OF PRODUCTS TO WHICH DAMAGES ARE CLAIMED. ALL CLAIMS OF ANY KIND ARISING IN CONNECTION WITH THIS AGREEMENT OR THE SALE OR USE OF PRODUCTS SHALL BE DEEMED WAIVED UNLESS MADE IN WRITING WITHIN THIRTY (30) DAYS FROM ZOOZ'S DELIVERY, OR THE DATE FIXED FOR DELIVERY IN THE EVENT OF NONDELIVERY.

## **FCC STATEMENT**

### **FCC NOTE**

THE MANUFACTURER IS NOT RESPONSIBLE FOR ANY RADIO OR TV INTERFERENCE CAUSED BY UNAUTHORIZED MODIFICATIONS TO THIS EQUIPMENT. SUCH MODIFICATIONS COULD VOID THE USER'S AUTHORITY TO OPERATE THE EQUIPMENT. STORE INDOORS WHEN NOT IN USE. SUITABLE FOR DRY LOCATIONS ONLY. DO NOT IMMERSE IN WATER. NOT FOR USE WHERE DIRECTLY EXPOSED TO WATER.

This device complies with Part 15 of the FCC Rules.

Operation is subject to the following conditions:

1. This device may not cause harmful interference,
2. This device must accept any interference received, including interference that may cause undesired operation.

This equipment has been tested and found to comply with the limits for a Class B digital device, under part 15 of the FCC Rules.

These limits are designed to provide reasonable protection against harmful interference in a residential installation.

This equipment generates, uses, and can radiate radio frequency energy and, if not installed and used according to instructions, may cause harmful interference to radio communications.

However, there is no guarantee that interference will not occur in any given installation.

If this equipment causes harmful interference to radio or television reception, the user may try to correct the interference by taking one or more of the following measures:

- Reorient or relocate the receiving antenna
- Increase the separation between equipment and receiver
- Connect equipment to a separate outlet or circuit from the receiver

- Consult the dealer or an experienced radio/TV technician for additional assistance

All brand names displayed are trademarks of their respective holders. © Zooz 2024

## ZEN74 WIRING DIAGRAMS FOR THE MOST COMMON 3-WAY INSTALLATIONS

For more diagrams or to request custom instructions go to [support.getzooz.com](https://support.getzooz.com).

### STOP!

Wire and screw position, as well as color codes, are for illustration only. You should not follow the colors and positioning in the illustration blindly. Always identify all wires before installing Zooz switches and make sure you can match the diagrams to your set-up exactly. Don't experiment or attempt a "trial-and-error" installation for your safety.

### NOTE!

If you are not comfortable identifying the wiring and completing the installation, please consult a licensed electrician. Make sure you have identified all wiring correctly before connecting the switch. If your wiring doesn't match any of the below diagrams, contact our support: [ask@getzooz.com](mailto:ask@getzooz.com).

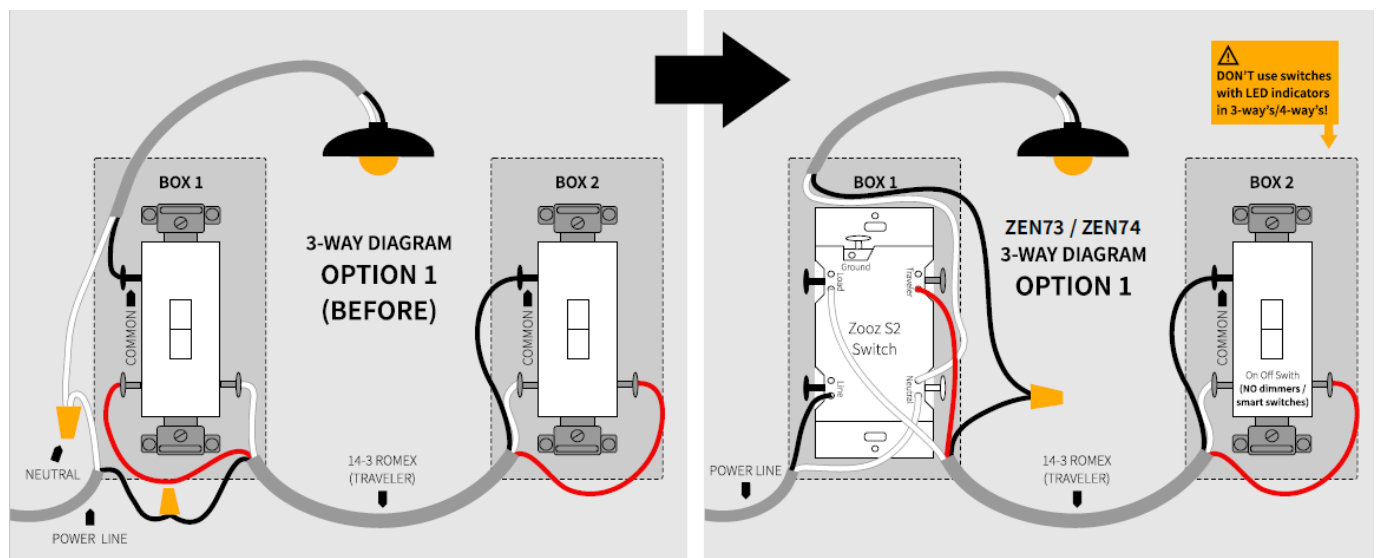

### ON/OFF SWITCHES ONLY

Do not connect Zooz Z-Wave® dimmers to an existing 3-way dimmer, illuminated switch, or an electronic add-on switch. Zooz switches can only be wired with mechanical on/off switches in a 3- way or 4-way setting!

To simplify the diagrams, we did not include connections for the ground wire. Remember that all Zooz switches need to be wired according to the electrical code, with ground wire connected to the ground terminal.

Always install your Zooz ZEN74 dimmer in the box with direct connection to power line. Diagrams and instructions in this manual are for ZEN73 and ZEN74 models ONLY!

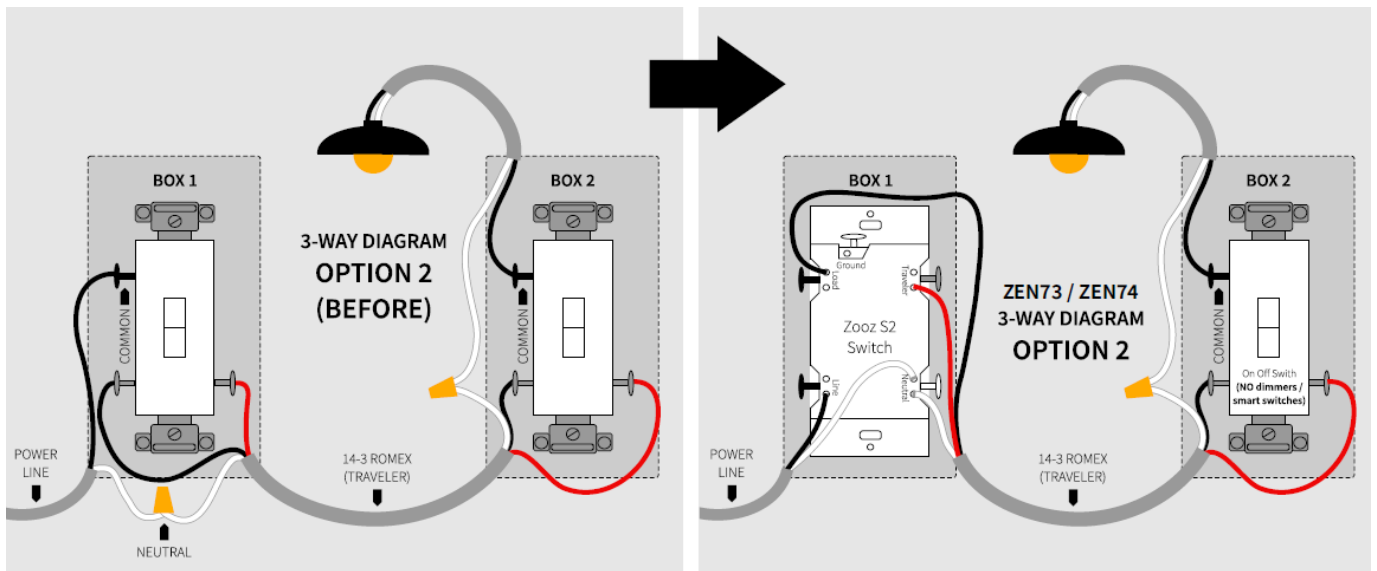

## ZEN74 WIRING DIAGRAM FOR THE MOST COMMON 4-WAY INSTALLATION

### NEED HELP?

If you're having trouble reading the diagrams or don't see your wiring set-up here, get in touch! We have more 3-way, 4-way, and 5-way diagrams and instructions. There are many ways to wire multi-point control set-ups so unless you can match your wiring to the diagrams here, please don't attempt the installation for your own safety.

[www.support.getzooz.com](http://www.support.getzooz.com). [ask@getzooz.com](mailto:ask@getzooz.com).

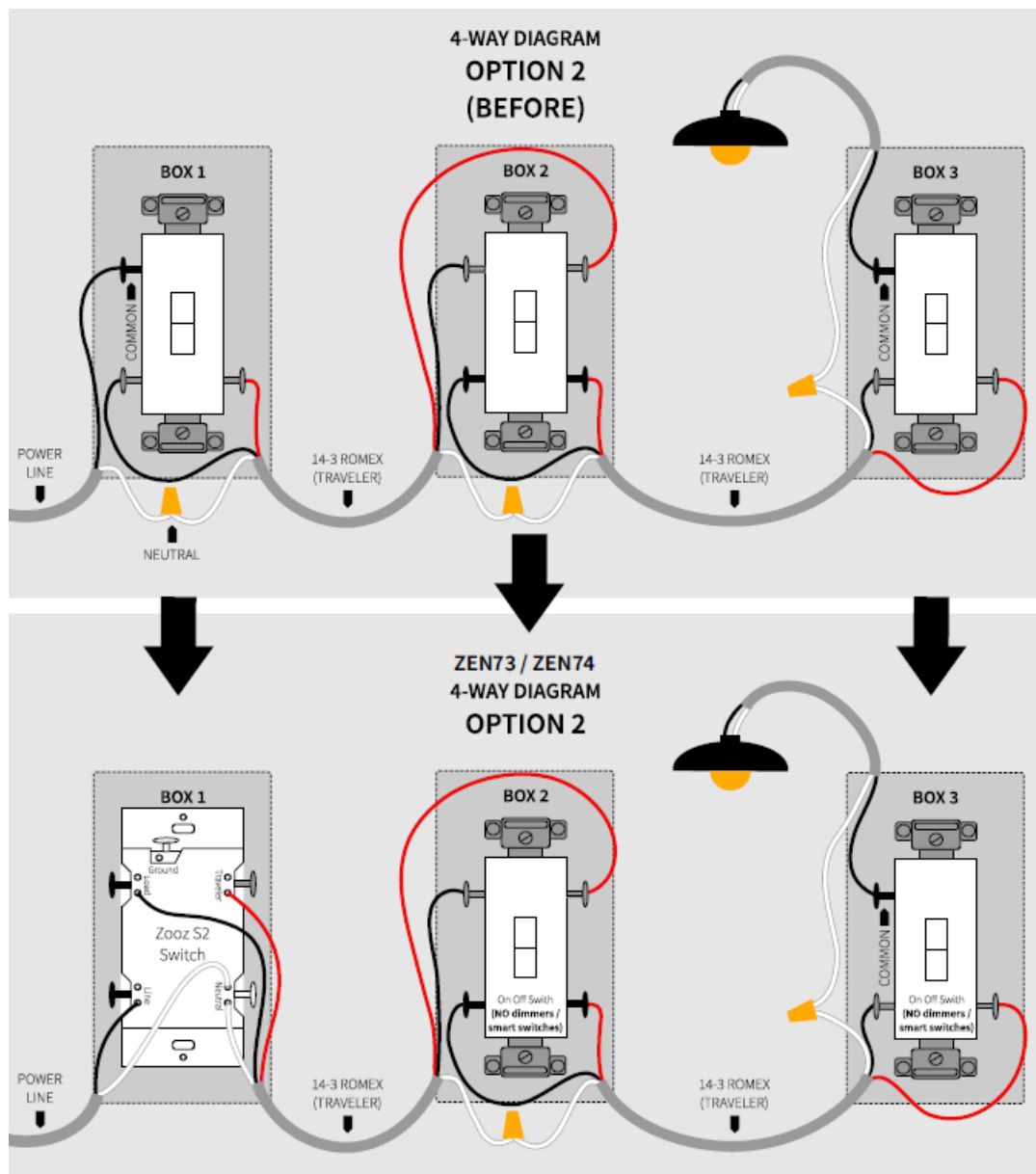

## RANGE TEST TOOL

- You can now easily check if the switch is within your Z-Wave® hub's range:
- Press and hold the toggle down for 10 seconds until the LED indicator starts blinking. Release the toggle and within 2 seconds, toggle it down again 2 times quickly. The LED indicator will then report signal strength.
- Solid green = direct communication with the primary controller is stable
- Flashing green = direct communication with the primary controller is established but signal is weak
- Solid blue = stable communication with hub via repeaters Flashing blue = communication with the primary controller is established via repeaters but signal is weak
- Solid red = communication with the primary controller has failed Tap the lower paddle to exit testing mode.
- **NOTE:** This function may only be activated once the switch has been included to a Z-Wave® network.

## VIRTUAL 3-WAY & 4-WAY

The diagrams above show how to wire your smart switch with existing mechanical switches. In certain scenarios you may want to use multiple Zooz switches in a 3-way or 4-way installation though. We have custom instructions and dedicated diagrams for this type of set-up published in the Support Portal. Simply scan this QR code and click on the link to access support articles for virtual 3-way and 4-way set-ups using multiple Zooz switches.



The Simple Direct 3-Way/4-Way implemented in this device is a unique Z-Wave® multi-point control solution covered under U.S. Patent 10,219,353 B1.

## Documents / Resources

	<a href="#">ZOOZ ZEN74 Toggle Dimmer</a> [pdf] User Manual ZEN74 Toggle Dimmer, ZEN74, Toggle Dimmer, Dimmer
---	---

## References

- [Z ZOOZ – Smart Home Technology](#)
- [Z Home - Zoos Support Center](#)
- [User Manual](#)

[Manuals+](#), [Privacy Policy](#)

This website is an independent publication and is neither affiliated with nor endorsed by any of the trademark owners. The "Bluetooth®" word mark and logos are registered trademarks owned by Bluetooth SIG, Inc. The "Wi-Fi®" word mark and logos are registered trademarks owned by the Wi-Fi Alliance. Any use of these marks on this website does not imply any affiliation with or endorsement.