



Zojirushi CD-JWC30/ CD-JWC40 Micom Water Boiler and Warmer Operating Instruction Manual

[Home](#) » [Zojirushi](#) » Zojirushi CD-JWC30/ CD-JWC40 Micom Water Boiler and Warmer Operating Instruction Manual 

Zojirushi CD-JWC30/ CD-JWC40 Micom Water Boiler and
Warmer Operating Instruction Manual



MICOM WATER BOILER & WARMER

OPERATING INSTRUCTIONS

CD-JWC30 / CD-JWC40

Contents

- [1 IMPORTANT SAFEGUARDS](#)
- [2 SAVE THESE INSTRUCTIONS](#)
- [3 IMPORTANT SAFEGUARDS](#)
- [4 SPECIFICATIONS](#)
- [5 PARTS NAMES AND FUNCTIONS](#)
- [6 BOIL MODE](#)
- [7 DISPENSE HOT WATER](#)
 - [7.1 DISPOSE WATER](#)
 - [7.2 DISPENSE HOT WATER](#)
- [8 HOW TO SET THE KEEP WARM MODE](#)
- [9 QUICK TEMP MODE](#)
- [10 ENERGY-SAVING TIMER FUNCTION](#)
- [11 CAFE DRIP DISPENSING MODE](#)
- [12 CLEANING AND MAINTENANCE](#)
- [13 Perform every 1-3 month\(s\) of usage HOW TO PERFORM CITRIC ACID CLEANING](#)
- [14 REPLACEMENT PARTS](#)
- [15 Q&A ON PRODUCT USE](#)
- [16 TROUBLESHOOTING GUIDE](#)
- [17 Related Posts](#)

IMPORTANT SAFEGUARDS

BASIC SAFETY PRECAUTIONS SHOULD ALWAYS BE FOLLOWED WHEN USING ELECTRICAL APPLIANCES, INCLUDING THE FOLLOWING:

1. Read all instructions thoroughly.
2. Avoid touching hot surfaces and do not close or clog the steam vent opening under any circumstances. The handles and knobs are provided for your safety and protection.
3. To safeguard against fire, electric shock and possible injury, keep the power cord, plugs and the appliance away from water or other liquids.
4. Close supervision is recommended when any appliance is used by or near children.
5. Unplug from outlet when not in use and before cleaning. Allow the appliance to cool before adding or removing parts, and before cleaning the appliance.
6. Do not use or operate any appliance with a damaged cord or plug. If the appliance malfunctions or has been damaged in any manner, unplug the appliance and return it to the nearest authorized service facility or dealer for examination, repair or adjustment.
7. The use of accessories or attachments not recommended by the appliance manufacturer may result in fire, electric shock or other injuries to persons.
8. Do not use outdoors.
9. Keep the power cord away from hot surfaces and do not let the cord hang over the edge of tables or counters.
10. Do not place on or near a heated surface such as a gas or electric stove, or in a heated oven.
11. Always use extreme caution when moving an appliance containing hot liquids.
12. The plug to the appliance should be attached first before plugging the cord into a wall outlet.
13. Do not use the appliance for other than intended or specified purposes.
14. To protect against electrical hazard, unplug the cord before cleaning.
15. Scalding may occur if the lid is removed during boiling cycles.

NOTE: This appliance has a polarized plug (one blade is wider than the other). To reduce the risk of electric shock, this plug was designed to fit into a polarized outlet in only one direction. If the plug does not fit fully into the outlet, do not attempt to force it or modify it in any way. Simply reverse the plug and insert. If it still does not fit, contact a qualified electrician.

SAVE THESE INSTRUCTIONS

THIS APPLIANCE IS FOR HOUSEHOLD USE ONLY.

- A.** A short detachable power-supply cord has been provided for your safety. To reduce risks from entanglement or tripping, a longer cord is not recommended.
- B.** Extension cords should only be used if care is exercised.
- C.** If using an extension cord: (1) the marked electrical rating of the detachable power-supply cord or extension cord should be at least as high as the electrical rating of the appliance; (2) if the appliance is of the grounded type, the extension cord should have a ground-type 3-pronged plug; and (3) the longer cord should not drape over the countertop or tabletop where it can be pulled on by children or tripped over.

IMPORTANT SAFEGUARDS

Before use

These WARNINGS and CAUTIONS are intended to protect you and others from personal injury and household damage . To ensure safe operation, please follow carefully

WARNINGS

Do not modify the product. Only a repair technician may disassemble or repair this unit.

- Attempting to do so may cause fire, electric shock or injury. Make any repair inquiries to Zojirushi Customer Service.

Do not immerse the product in water or splash it with water, and do not put it on a wet surface such as a sink.

- Doing so may cause short circuit or electric shock.

Do not allow liquid to come into contact with the Receptacle or Power Cord.

- Doing so may cause short circuit or electric shock.

Do not plug or unplug the Power Cord if your hands are wet.

- Doing so may cause electric shock or injury.

Do not touch the Steam Vent or bring your hands or face near the Steam Vent.

- Doing so may cause burns or scalding. Take special precautions with children and infants.

Do not cover the Steam Vent with anything such as a dishcloth.

- Hot water may spill out, resulting in scalds. It may also cause deformation or discoloration of the Upper Lid or breakdown of the product.

Do not allow children to use the product unsupervised. Keep it out of the reach of infants.

- Children are at risk of burns, electric shock or injury.

Do not fill over the Maximum Water Level Line.

- Overfilling may cause hot water to spill out, resulting in scalds.

Always remove the Upper Lid before disposing hot water.

- The Upper Lid may fall off and cause hot water to splash, resulting in scalds.

Do not tilt or shake the product or carry in your arms. Do not move it or drain hot water by holding the Upper Lid.

- Doing so may result in scalding by hot water spilling out from the Spout or Steam Vent, even if the Automatic Dispense Lock is on. Always use the handle when carrying.

Do not tilt the product or tip it over.

- Hot water may spill from the Spout or Steam Vent, even if the Automatic Dispense Lock is on.

Do not slam the Upper Lid when closing.

- Hot water may dispense or spill out, resulting in scalds.

Do not use the product if the Power Plug or Power Cord is damaged or if the Power Plug is loosely inserted into the electrical outlet.

- Doing so may cause electric shock, short circuit or fire.

Close the Upper Lid securely.

- Hot water may spill out when the product is overturned, resulting in scalds.

Do not remove the Upper Lid while boiling.

Do not damage the Power Cord. Do not bend, pull, twist, fold, or attempt to modify the Power Cord.

Do not place it on or near high temperature surfaces or appliances, under heavy items or between objects.

- A damaged Power Cord can cause fire or electric shock.

Do not use the product as a cooler or place ice inside of it.

- Doing so may cause condensation, resulting in electric shock or breakdown of the product.

Do not allow the end of the Appliance Plug to become soiled with dust or come into contact with any metal objects.

- Doing so may cause electric shock, short circuit or fire.

Do not allow infants or children to put the Appliance Plug in their mouth.

- Doing so may cause electric shock or injury. Take special precautions with children and infants.

Insert the Power Plug completely and securely into the electrical outlet.

- A loosely inserted Power Plug may cause electric shock, short circuit, smoke or fire.

Use only an electrical outlet rated at 15 amperes minimum, and do not plug other devices into the same outlet.

- Plugging other devices into the same outlet may cause the electrical outlet to overheat, resulting in fire.

If the blades or surface of the Power Plug become soiled, wipe them clean.

- A dirty Power Plug may cause fire.

Do not use a power source other than 120 V AC.

- Use of any other power supply voltage may cause fire or electric shock.

Do not boil anything other than water.

- Attempting to boil, cook, or heat up the following items may cause bubbling or boiling over, which may cause scalding. Doing so may also cause clogging of the water route or Electric Pump, corrosion of the Inner Container, or peeling of the Nonstick Coating.

- Milk, sake, soup, charcoal, tea bags or tea leaves.
- Instant food.
- Food and sauce pouches or foods in plastic bags.

Replace the Inner Lid Gasket if it hardens, changes shape, turns white, or otherwise becomes worn out.

- Hot water may spill out when the product is tilted or tipped over accidentally, and may cause scalding.

●The illustrations used in these Operating Instructions may vary from the actual product you have purchased.

This product is not intended for use by persons (including children) with reduced physical, sensory or mental capabilities, or lack of experience and knowledge, unless they have been given supervision or instruction concerning use of the product by a person responsible for their safety. Children should be supervised to ensure that they do not play with the product.

Stop using immediately if you notice any of the following symptoms indicating a malfunction or breakdown.

- Continued use of the product may cause smoke, fire, electric shocks or injury.
- The Power Plug or Power Cord has become very hot.
- The Power Cord is damaged or the electricity turns on and off when touched.
- The Body is deformed or unusually hot.
- Smoke is arising from the product or there is a burning smell.
- Some parts of the product is cracked, loose or unstable.
- The product emits steam for at least 10 minutes continuously and does not turn to Keep Warm mode.
- Water leaks from the Body.

If any of the above occurs, unplug the product immediately and return to Zojirushi Customer Service for check-ups and/or repairs.

CAUTIONS

Always use caution when opening the Upper Lid and avoid skin contact with steam.

- Loose water or steam may escape upon opening the Upper Lid and cause scalds.

Do not touch hot surfaces during or for a short period of time after use.

- Touching hot surfaces may cause burns. Be especially careful with metal parts such as the Inner Lid and the Inner Container.

Please allow the product to cool down before cleaning.

- Touching hot surfaces may cause burns.

Do not use the product near walls or furniture.

- Steam or heat may damage, discolor or deform walls or furniture.

Do not swivel or move the product while dispensing water.

- Hot water may splash out, resulting in scalds.

Do not place or use the product on unstable surfaces or on surfaces that are vulnerable to heat.

- Doing so may cause fire.

Do not attempt to dispense hot water while it is boiling.

- Hot water can spurt out, resulting in scalds.

Do not use other Power Cords than the one provided. Do not use the Power Cord for other appliances.

Do not use the Power Cord for overseas models.

- Doing so may cause malfunction or fire.

Do not place the product over direct flame (such as a gas stove top), or on top of electric or induction heating (IH) cookers.

- Doing so may cause fire, breakdown or damage of the product.

Unplug the Power Plug from the outlet when the product is not in use.

- Leaving the Power Plug in an outlet may cause the insulation to become damaged, resulting in electric shock, short circuit or fire, or result in injuries or scalds.

Do not touch the Lid Lock when carrying the product.

- Doing so may cause the Upper Lid to open, resulting in injuries or scalds.

Always unplug the product by holding the Power Plug, not by pulling the Power Cord.

- Pulling the Power Cord to unplug the product may cause electric shock, short circuit or fire.

If the Power Cord is damaged, it must be replaced by an appropriate cord or assembly made available by the manufacturer or its service agent.

IMPORTANT

Do not operate the product when it is empty.

- Doing so may burn or damage the product.

Avoid rough handling, dropping or bumping the product.

- Doing so may cause damage or cease operation of the product.

Avoid letting steam make contact with cabinets and walls when using near or under a kitchen shelf.

- Doing so may cause discoloration or deformation.

Allow the product to dry completely when storing the product in an area where it may freeze for a long period of time.

- If water left inside freeze, it may cause breakdown or malfunction.

Avoid using the product near a radio, TV, computer, etc.

- The product may cause interference with certain electronics.

Do not drag the product over any surface while attempting to move.

- Doing so may cause damage to surfaces such as countertops.

Do not allow hot water to come into contact with the Control Panel or the Water Level Gauge.

- Doing so may cause breakdown of the product.

Do not use the product where its steam may come into contact with other electrical appliances.

- The steam may cause fire, malfunction, discoloration or deformation to other electrical appliances.

This appliance is intended to be used in household and similar applications such as;

- Staff kitchen areas in shops, offices and other working environments;
- Environments comparable to residential living rooms and kitchens;
- ※ This appliance is not intended for use by many unspecified people for a long period of time.

SPECIFICATIONS

Model No.		CD-JWC30	CD-JWC40
Capacity		101 oz. (3.0 liters)	135 oz. (4.0 liters)
Rating		AC 120 V 60 Hz	
Electric Consumption		800 W	
Average Power Consumption during Keep Warm	208°F (98°C)	Approx. 46 W	Approx. 52 W
	195°F (90°C)	Approx. 38 W	Approx. 43 W
	175°F (80°C)	Approx. 31 W	Approx. 36 W
Length of the Power Cord		2' 11" (0.9 m)	
External Dimensions	(approx. inches)	8- $\frac{5}{8}$ (W) x 11- $\frac{1}{8}$ (D) x 11- $\frac{3}{8}$ (H)	8- $\frac{5}{8}$ (W) x 11- $\frac{1}{8}$ (D) x 13- $\frac{5}{8}$ (H)
	(approx. cm)	21.5 (W) x 28 (D) x 28.5 (H)	21.5 (W) x 28 (D) x 34.5 (H)
Weight (including the Power Cord)		Approx. 5 lbs. (2.3 kg)	Approx. 6 lbs. (2.5 kg)

- The average Keep Warm electric power consumption is for one hour , provided that the Inner Container is full and the room temperature is approximately 73°F (23°C) .
- The height refers to the product when the handle is down .
- In high altitudes or severely cold areas, the product may not perform as specified . Avoid using the product in such areas or in other extreme conditions .
- This product is not suitable for use in countries or regions with different power supply voltages or frequencies

PARTS NAMES AND FUNCTIONS

The light sound you may hear when opening and closing the Upper Lid is normal. (see pg.18)

Lid Lock

Steam Vent

- Exercise care during the boiling process as steam emitting from the Steam Vent is very hot.

Upper Lid

Inner Lid

Inner Lid Gasket (Consumable Part)

- If the Inner Lid Gasket hardens, changes shape, turns white, or otherwise becomes worn out, please replace it with a new one. (Separate charge required.) (see pg.15)
Not doing so may allow the product to leak hot water when tilted or tipped over resulting in scalding.

Water Removal Area

- Drain water here.

Inner Container (Nonstick Coating)

Maximum Water Level Line

Hinge

Control Panel

Handle

Spout

- Hot water dispenses from here.

Water Level Gauge

Body

REFILL Line

- Fill water above the line.

Receptacle

- Appliance Plug inserts here.

Filter

- For care and use instructions, see pg.15.

Swivel Base

- Do not let the Power Cord wrap around the Main Body when turning.

Power Cord

Twist Tie

- Please remove the twist tie holding the Power Cord before use.
- Do not use the Power Cord bundled up. Doing so may cause the Power Cord to become excessively hot, resulting in malfunction.

Appliance Plug

Power Plug

Cord



CONTROL PANEL

● Press buttons down firmly.

KEEP WARM light

ENERGY-SAVING TIMER button

Use when setting the Energy-Saving Timer function. (see pg.14)

TEMP SET button

Sets the Keep Warm temperature. (see pg.12)

REBOIL/QUICK TEMP button

Starts the Reboil mode. (see pg.11)
Sets the Quick Temp mode. (see pg.13)
Also used when performing the Citric Acid Cleaning (to initiate cleaning, press this button for more than 3 seconds). (see pg.16)

Display

LCD display shows the water temperature and Timer settings.

NOTE: Illustration is for reference only. Actual display will not show all functions simultaneously during use.

DISPENSE button

Press to dispense hot water. (see pg.10, 14)

UNLOCK light

UNLOCK button

This button must be pressed to dispense hot water. (see pg.10)

Press this button again for Café Drip Dispensing mode. (see pg.14)

BOIL light

How to Open/Close the Upper Lid

- To Open**
- 1 Press the indented area of the Lid Lock with your thumb.
 - 2 Pull the Lid Lock up with your fingers to open the Upper Lid.

To Close Depress the Upper Lid until it clicks shut.

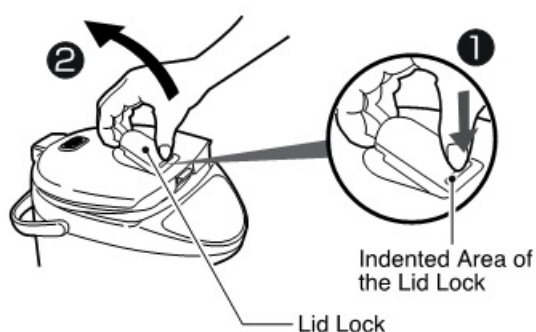

How to Detach/Attach the Upper Lid

- To Detach**
- 1 Open the Upper Lid to about a 45-degree angle.
 - 2 Push the Upper Lid Detach button.
 - 3 Pull the Upper Lid forward and up at an angle.

To Attach Push the Upper Lid back into place at the same angle.

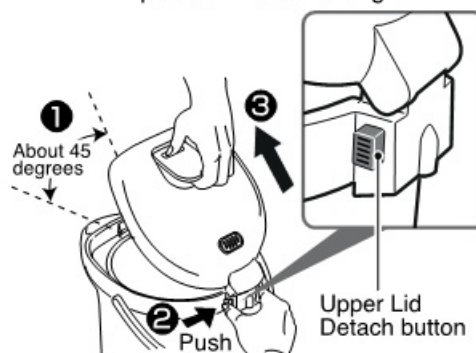

BOIL MODE

BOIL MODE

- 1 Open the Upper Lid and fill the Inner Container with water using a pitcher or other container.

To monitor the amount of water you are filling, look at the thickness of the stripes on the Water Level Gauge.

When the Inner Container is empty.

Water Level Gauge

Present Water Level

The stripes on the Water Level Gauge appear thicker when water is added.

Maximum Water Level Line
(MAX)

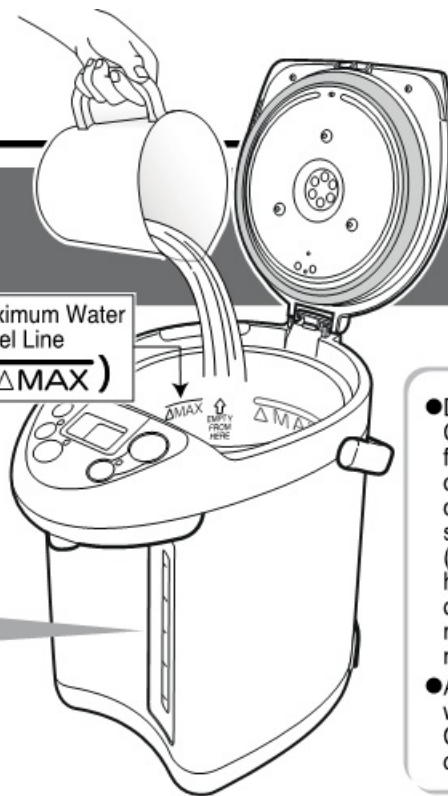

NOTE

- Do not fill the Inner Container directly from a water faucet or place the product on a wet surface such as a sink. (Exposing the heating element directly to water may cause malfunction.)
- Avoid splashing water on the Body or Control Panel. (May cause malfunction.)

- 2 Close the Upper Lid and connect the Power Cord.



Close the Upper Lid securely.

(To ensure safe operation while boiling and to prevent scalds if the product is overturned.)

It automatically starts the boiling process.

The BOIL light turns on and the Display shows the water temperature.

Below 170°F: Display shows the water temperature in 10°F increments.

Above 175°F: Display shows [175] → [180] → [185] → [190] → [195] → [200] → [205] → [212].



Be sure to insert the Power Cord securely.
(Otherwise, may cause electric shock, short circuit, smoke or fire.)

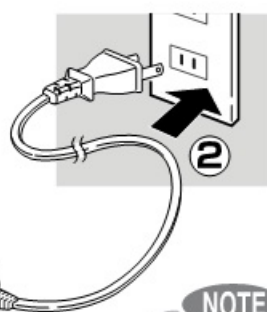

NOTE

- Do not allow the end of the Appliance Plug to get soiled with dust or come into contact with metal objects such as pins.

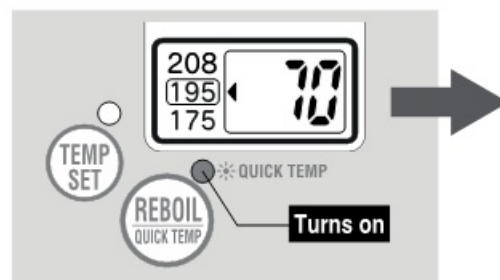

- How to set the Quick Temp mode: see pg.13

Temperature Conversion Guide

Fahrenheit (°F)	Celsius (°C)
212	100
208	98
195	90
175	80
73	23

The first time you use the product you may notice the smell of plastic. This is normal and will gradually fade away.

- Do not fill over the Maximum Water Level Line. (Hot water may overflow from the Steam Vent.)
- Do not fill the Inner Container with hot water. (The Automatic Shut-Off function may be activated.) (see pg.11)
- Do not fill the Inner Container with any liquid other than water.
- Do not use water additives such as charcoal for water purification or mineral additives. (Small particles may get clogged inside of the product.)
- If you wish to shorten the time, add less water to the Inner Container.

● At your initial use or when using the product after a long period of storage:

Attach the Filter, fill the Inner Container with water to the MAX line and boil as directed. Once it reaches a boil, dispense about 34 oz. (1 liter) of water to rinse the water route and dispose the remaining water. Fill with fresh water.

● When using mineral or Alkalized Ionic water:

When mineral or Alkalized Ionic water is used, a floating residue may develop or a milky white substance may form on the surface of the Inner Container. This is due to the ingredients in the water and is harmless to your health. Frequent cleaning is recommended.

When boiling has completed, it automatically switches to 195°F Keep Warm mode.

The BOIL light turns off, the Keep Warm light turns on and "212" appears on the Display.

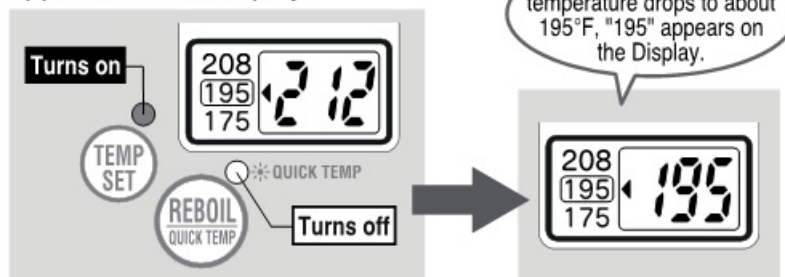

How to set the Keep Warm mode:

- 208°F Keep Warm Mode. (see pg.12)
- 175°F Keep Warm Mode. (see pg.12)

NOTE

- Add water when the water level is low during the Keep Warm mode. (The product automatically begins heating the water.) If the water level is still not high enough, it will not automatically switch to Boil. In this case, press the REBOIL/QUICK TEMP button to manually start the process. (see pg.11)
- Please follow the instructions below to reduce the risk of scalding:
 - Do not cover the Steam Vent with a cloth.
 - Do not touch the Steam Vent or bring your hands or face near the Steam Vent.
 - Do not open the Upper Lid while the BOIL light is on.
 - Do not dispense hot water while it is boiling.

Time required to boil water:

CD-JWC30	Approx. 27 minutes*
CD-JWC40	Approx. 35 minutes*

(At a room temperature of 73°F with the Inner Container filled to the Maximum Water Level Line with water temperature at 73°F.)

* Includes approx. 3 minutes to Dechlorinate.

Length of time until the water temperature reaches about 195°F:

CD-JWC30	Approx. 30 minutes
CD-JWC40	

(At a room temperature of 73°F with the Inner Container filled to the Maximum Water Level Line.)

- The length of time for the water temperature to reach 195°F will vary depending on the amount of water and room temperature.

DISPENSE HOT WATER

1 Press the **UNLOCK** button.

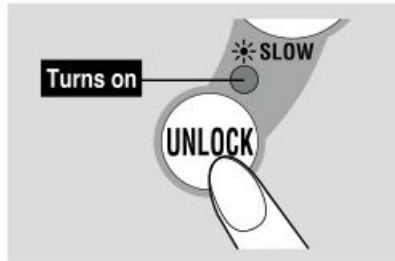

The **UNLOCK** light turns on and hot water can be dispensed.

NOTE

- Do not unlock and press the **DISPENSE** button if the Inner Container is empty.

2 Press the **DISPENSE** button to dispense hot water.



Do not swivel the product while dispensing water.

- Initially upon boiling or if it has been a while after dispensing, the water may not be very hot. Please discard the first cup (of the hot water).
- Do not attempt to dispense hot water while boiling.
- Water may not dispense smoothly for a short period of time after boiling.
- Be careful as the Body heats up during the Boil and Keep Warm modes.

DISPOSE WATER

Dispose the water when the product is not in use.

1 Unplug the Power Cord and detach the Upper Lid.

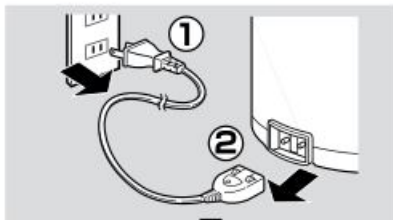

When detaching the Upper Lid:

- Take precaution with the steam. You may scald yourself.

2 Hold the product with both hands and dispose water where indicated "EMPTY FROM HERE" on the wall of the Inner Container.

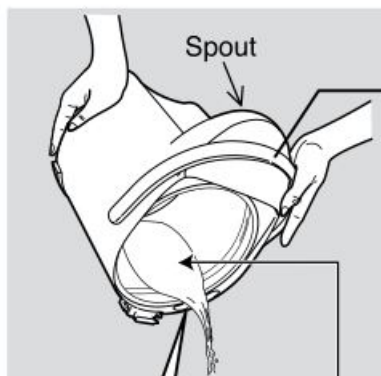

Hold the Handle securely.

When disposing hot water:

- Take precaution with the hot water and steam. You may scald yourself.
- Take precaution as hot water may drip from the Spout, causing scalds.

DISPENSE HOT WATER

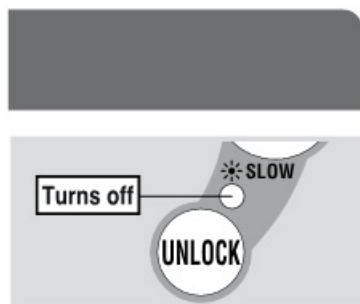

10 seconds after dispensing, the UNLOCK light turns off and the Automatic Dispense Lock is activated.

Automatic Dispense Lock

A safety function to prevent hot water from dispensing if the DISPENSE button is accidentally pressed.

- Even if no water is dispensed, the Automatic Dispense Lock will be activated after about 10 seconds.

Do not tilt or shake the product after dispensing. Hot water may drip from the Spout, causing scalds.

NOTE

- Do not plug or unplug the Power Plug or Appliance Plug with wet hands. (Doing so may cause short circuit or electric shock.)
- Do not dispose hot water with the Upper Lid in place. (The Upper Lid may come off, spilling hot water and causing scalds.)
- Do not allow water to splash on the Control Panel, Hinge, Handle or Receptacle. (Could cause scalding or breakdown.)
- Please do not lose the Filter while disposing water.
- Dispose the water at least once a day. (Leaving water in the Inner Container can cause unwanted odor or scale build-up.)

This function is used when reboiling water in the Keep Warm mode.

Reboil mode

Press the **REBOIL QUICK TEMP** button.

The BOIL light turns on when the boiling process begins.

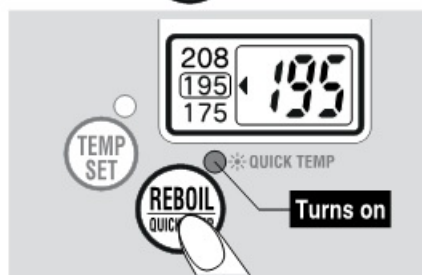

Time required to finish reboiling

(At a room temperature of 73°F / 23°C with the Inner Container filled to the Maximum Water Level Line.)

208°F Keep Warm Mode

Approx. 3–4 minutes

195°F Keep Warm Mode

Approx. 5–7 minutes

When the Reboil process is completed, the product switches to Keep Warm mode.

- Pressing the REBOIL/QUICK TEMP button twice activates the Quick Temp mode. (see pg.13)
- Do not attempt to dispense hot water while reboiling.
- Water may not dispense smoothly for a short period of time after reboiling.

NOTE

- Make sure the water level is above the REFILL Line before pressing the REBOIL/QUICK TEMP button.

Automatic Shut-Off function

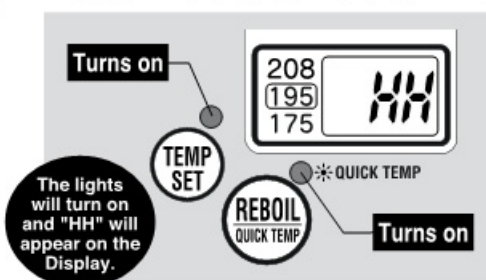

- Be careful not to repeat the boiling process without filling the Inner Container with water, as the Nonstick Coating may discolor and peel.

The Automatic Shut-Off function activates to shut down power to the heater in order to prevent damage from overheating. The Display will show "HH" to alert you that the Automatic Shut-Off has been activated. The following conditions may cause activation:

- When plugged in without filling the Inner Container with water.
- When the water level is lower than the REFILL Line and boiling has been attempted.
- When the Inner Container is empty or the Upper Lid is left open for adding water.
- When pouring in hot water immediately after plugging in the unit.

Remedy

Unplug the product. Allow the Inner Container to cool. Fill the Inner Container with water and plug back in.

HOW TO SET THE KEEP WARM MODE

Press the **TEMP SET** button to change the settings.

Each press of the button changes the position of the "◀" on the Display.

195 → 208 → 195 → 175
(Default)

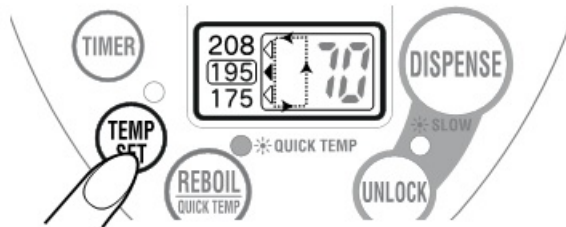

- You can change the temperature setting during Keep Warm mode.
(It may start reboiling depending on the water temperature and the selected setting.)

For making coffee, tea and instant noodles

208°F Keep Warm Mode

208°F is ideal for making coffee, tea and instant noodles.

Select the "208" on the Display.

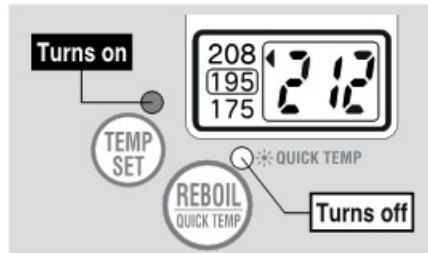

When the boiling process has completed, the BOIL light turns off and the KEEP WARM light turns on.



When the water temperature reaches 208°F, "208" appears on the Display.

- Depending on the altitude where the product is used, the Keep Warm mode may be set at 205°F-207°F, in order to prevent continuous boiling.

For making Japanese (green) tea

175°F Keep Warm Mode

175°F is ideal for making Japanese (green) tea.

Select the "175" on the Display.

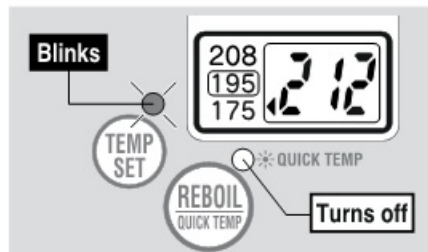

When the boiling process has completed, the BOIL light turns off, and the KEEP WARM light begins to blink.
(If initiated during Keep Warm mode, the light will blink 2 seconds after the selection.)

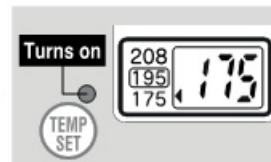

When the water temperature reaches about 175°F, "175" appears on the Display, and the KEEP WARM light stops blinking and remains on.

- Length of time for the water temperature to reach 175°F after boiling:

CD-JWC30	Approx. 1 hour and 10 minutes
CD-JWC40	

(At a room temperature of 73°F with the Inner Container filled to the Maximum Water Level Line.)

- The length of time for the water temperature to reach 175°F will vary depending on the amount of water and room temperature.

If the Power Cord is detached:

- Reinsert the Power Cord if it is accidentally detached.
- If the cord is detached for more than a few minutes and reinserted, the product returns to the 195°F Keep Warm mode and may start reboiling automatically.

QUICK TEMP MODE

This function heats the water to the selected Keep Warm temperature without reaching a boil. The water will reach the selected Keep Warm temperature quicker than the regular Boil mode. Other benefits include reduced steam and reduced energy use. Use this mode when dechlorination is not necessary, such as when using bottled or purified water.

**While the water is heating,
press the  button to
select the Quick Temp mode.**

You cannot activate Quick Temp mode while the product is set at 208°F Keep Warm mode.

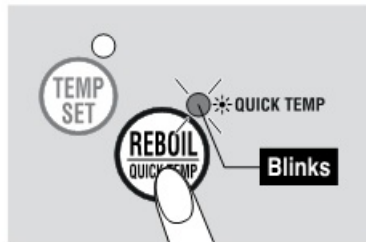

**After reaching the selected
temperature, it will
automatically switch to
Keep Warm.**

The BOIL light turns off and the KEEP WARM light turns on.

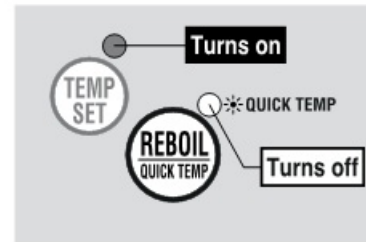

- You cannot select 208°F Keep Warm mode while Quick Temp mode is activated.
- There may be a lingering chlorine smell if tap water is used while Quick Temp mode is activated. If this is an issue, use the regular Boil mode instead.
- Depending on the amount of water and room temperature the actual water temperature after heating may differ from that shown on the Display.
- Depending on the amount of water, room temperature, and atmospheric pressure, some steam may be produced.
- The Quick Temp mode may be cancelled if the product is left unplugged for several minutes.

**Each press of the REBOIL/QUICK TEMP button
changes the boil mode.**

Regular Boil mode → **Quick Temp mode**
(Default) ↑

※Holding the REBOIL/QUICK TEMP button for more than 3 seconds activates Citric Acid Cleaning mode. (see pg.16)

NOTE

- Water does not reach a boil under Quick Temp mode, and should not be used to prepare baby formula.
- Although the water will not reach a boil when Quick Temp mode is activated, the Steam Vent will become hot. Please do not touch it.

Temperature Conversion Guide

Fahrenheit (°F)	Celsius (°C)
212	100
208	98
207	97
205	96
195	90
175	80
73	23

ENERGY-SAVING TIMER FUNCTION

The Boiling function will complete after the set time. (The Energy-Saving Timer function helps save energy by shutting off electricity to the heater until boiling begins.)

Press the **TIMER** button until the desired length of time is displayed.



The Energy-Saving Timer function is activated.

The Boiling function will complete at the set time.

The BOIL light turns off and the KEEP WARM light turns on.

Boiling may stop earlier than set, depending on room temperature, water temperature and amount of water.

Timer settings: (H for hours)

6H → 7H → 8H → 9H → 10H

Cancel

NOTE

- To cancel the Timer, press the TIMER button several times or press the REBOIL/QUICK TEMP button once.
- When using the Quick Temp mode with the Energy-Saving Timer function, set the Energy-Saving Timer function after selecting the Quick Temp mode.
- If the Power Cord is detached, the Energy-Saving Timer function will be cancelled and must be reset.

CAFE DRIP DISPENSING MODE

This mode decreases the amount of water dispensed to 60% of the normal setting, making it suitable for brewing cafe drip coffee.

1 Press the **UNLOCK** button twice.

When the UNLOCK light blinks, Café Drip Dispensing mode is activated.

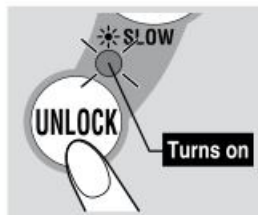

- Pressing the UNLOCK button again during Café Drip Dispensing mode returns it to the normal dispensing mode.
- When the light turns off, the Automatic Dispense Lock will be activated.
- If the water level is low, it may take longer for water to begin dispensing after pressing the DISPENSE button.
- If the water level is low or boiling has just completed, water may not dispense smoothly.

2 Press the **DISPENSE** button to dispense hot water.

You can use the Café Drip Dispensing mode for about 60 seconds while the UNLOCK light blinks.



NOTE

- Be careful not to burn yourself.
- If using a cone filter placed directly on a cup, be careful not to let it fall inside the cup while brewing.
- When using a manual drip coffee cone, dispense a cup of hot water before brewing. (The first cup may not be hot enough.)

CLEANING AND MAINTENANCE

Always unplug the Power Cord, dispose all water, and allow to cool completely before cleaning.

NOTE

- Do not attempt to dry the product by turning it upside down when the bottom is wet. (Water may get inside the body and cause it to break or rust.)
- Do not use the following:
 - Thinner, benzene or bleach. (Doing so may cause discoloration, crack, degradation and corrosion.)
 - Polishing powder, nylon brushes, anything made with metal, eraser pads, hard nylon sponges and abrasive cleaners. (Doing so may cause corrosion.)
 - Detergent. (Hot water may spill out, resulting in scalds or damage. Doing so may cause unwanted odor.)
- Do not use scrub brushes for any portions other than the Filter. (Doing so may cause corrosion.)
- When using chemically treated cloths, do not rub too hard or leave them on the product for a long time as the surfaces of the product may be damaged by chemical reactions.
- Do not use a dishwasher or dish dryer for cleaning or drying. (Doing so may cause the plastic parts to deform.)
- Before storing the product for a longer period of time, dry it completely and pack in a plastic bag to prevent odors from being absorbed.

Inner Lid

Wipe with a soft wet sponge.

Inner Container

Perform the Citric Acid Cleaning (see pg.16) periodically.

Especially when...

- Red rust-like spotting is visible on the Inner Container.
 - Milky white or gray discoloration and/or filmy objects are found in the water.
 - Boiling is louder than usual.
 - Hot water has an odor.
- (The condition of the Inner Container will vary depending on the water quality and frequency of use.)

Filter

Remove the Filter from the Inner Container and wash with a soft brush.

Pull the Filter up to release, and press down firmly to attach.

If you find it difficult to clean the Filter, replace it with a new one. (see pg.16)

- Never use the product without installing the Filter. (The Filter prevents foreign objects from entering the water route or Electric Pump and obstructing the flow of hot water.)

**Power Cord**

Wipe clean with a dry cloth.

Body/Upper Lid

Wipe clean with a damp well-wrung cloth.

- Do not wash any part of the Body, Control Panel or Water Level Gauge with water. (May cause malfunction or rust.)

**HOW TO REPLACE THE INNER LID GASKET**

The Inner Lid Gasket may need to be replaced due to time and wear. We recommend that you replace it about once a year.

Wipe new Inner Lid Gaskets with a wet soft sponge before attaching to the Inner Lid.

To remove the Inner Lid Gasket

- 1 Remove the three screws, and remove the Inner Lid.
 - Do not lose these screws.
- 2 Remove the Inner Lid Gasket which is installed on the Inner Lid.

After removing the Inner Lid, check the plastic part of the Upper Lid for abnormalities.

→ If this part is discolored or if it feels rough to the touch, replace it (there will be a charge for this).

When the Inner Lid Gasket hardens, changes shape, turns white, or otherwise becomes worn out.

Please purchase and replace with a new one.

To attach the Inner Lid Gasket

- 1 Fit the Inner Lid Gasket securely to the outer circumference as shown in the figure.
- 2 Line up the pin on the Upper Lid with the hole on the Inner Lid correctly with the Upper Lid, and tighten the three screws securely.

If the Inner Lid Gasket hardens, changes shape, turns white, or otherwise becomes worn out, hot water may leak from the gap between the Upper Lid and Body when tilted. This may result in scalds. If hot water spews from the gap or there is steam even after replacing the Inner Lid Gasket, other parts may be in need of repair. Please contact Zojirushi Customer Service.

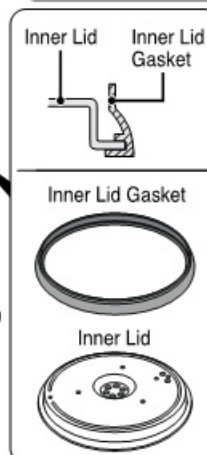
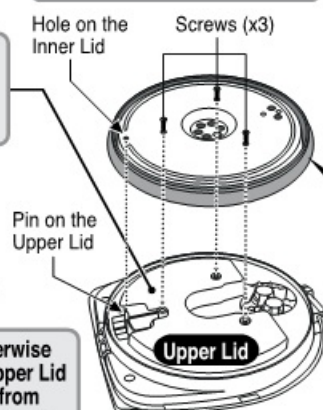

Perform every 1-3 month(s) of usage

HOW TO PERFORM CITRIC ACID CLEANING

Do Not Drink The Water Used For Citric Acid Cleaning

NOTE: In order to prevent gas bubbles and bubbling-over, the Citric Acid Cleaner for Electric Water Boilers (CD-K03E-JU) is recommended for cleaning. To purchase this cleaner, please visit an authorized Zojirushi dealer or www.zojirushi.com

Preparation:

Check that the Filter is attached to the Inner Container.

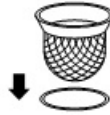

NOTE

● If the Filter is dirty, remove it from the Inner Container, wash with a soft brush and reinstall.

- 1** Put 1 package of the Citric Acid Cleaner CD-K03E-JU in a cup and add warm water to dissolve. Pour it into the Inner Container and fill with water to the Maximum Water Level Line.

NOTE

● Do not fill over the Maximum Water Level Line. (Hot water may spill out, resulting in scalds.)

- 2** Close the Upper Lid, insert the Power Plug and press the **REBOIL QUICK TEMP** button for more than 3 seconds.

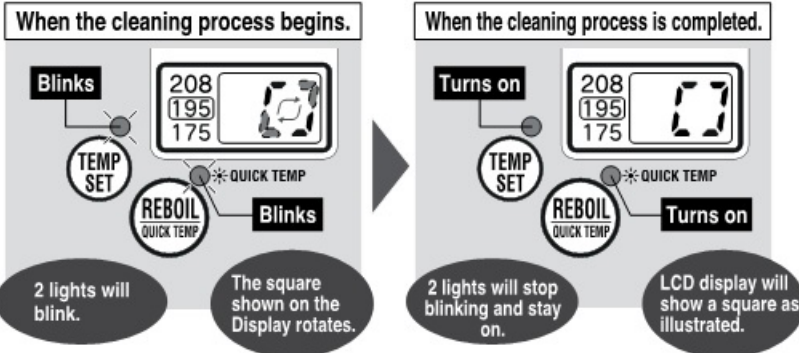

Cleaning time:
Approx. 1.5 hours.

※ Cleaning times may vary depending on the amount of water, water temperature and room temperature.

- 3** Unplug the Power Plug, detach the Upper Lid and dispose water where indicated "EMPTY FROM HERE." (Please take precautions not to splash water on the Hinge.)

NOTE

● Repeated citric acid cleaning may be necessary for hard-to-remove residues or if water does not dispense smoothly.

- 4** To rinse, fill the Inner Container with water. Boil and dispense about a cup of hot water to rinse out the Spout, allow to cool, then dispose the remaining water.

When disposing hot water:

- Take precaution with the hot water and steam. You may scald yourself.
- Take precaution as hot water may drip from the Spout, causing scalds.

● If mineral or Alkalized Ionic water is used, calcium tends to build up on the surface of the Inner Container. If scale accumulates on the Inner Container or the Filter, boiling may become louder than usual and water may not dispense smoothly. Frequent cleaning is recommended when using mineral or Alkalized Ionic water.

To cancel the Citric Acid Cleaning at any time, unplug the Power Plug for more than 5 seconds.

REPLACEMENT PARTS

- Replacement parts may be available for an additional charge. Please replace damaged parts only with new parts.
- When replacing parts, please record the model number and part name beforehand. Then contact Zojirushi Customer Service. Zojirushi Customer Service 1-800-733-6270 www.zojirushi.com

Parts Names	Parts Number
Inner Lid Gasket	625702-00
Filter	626251-00
Citric Acid Cleaner for Electric Water Boilers (1 oz. / 30 g × 4 packets)	CD-K03E-JU

Q&A ON PRODUCT USE

Is it okay to use the product for heating liquids other than water? ▶	Do not fill the product with any liquid other than water. It may cause malfunction, or may overflow and cause scalding. ▶	pg.3
Does the water need to be changed every day? ▶	To prevent scale from building up, please change the water at least once a day. ▶	pg.10
Is it okay to use mineral water or Alkalized Ionic water? ▶	Yes. However, when mineral or Alkalized Ionic water is used, a floating residue may develop or milky white substance may form on the surface of the Inner Container. This is due to the ingredients in the water and is harmless to your health. Frequent cleaning is recommended. ▶	pg.9 pg.16
I accidentally drank water while performing the Citric Acid Cleaning. Is this harmful to my health? ▶	Please follow the instructions shown on the package of the citric acid cleaner CD-K03E-JU. ▶	
Is it okay to go out while the product is turned on? ▶	It is safe to use the product unattended as it has an Automatic Shut-Off function (power to the heater will be automatically turned off), which will be activated once it is empty of water. However be careful not to repeat the boiling process without filling the Inner Container with water, as the Nonstick Coating may discolor and peel. ▶	pg.11

TROUBLESHOOTING GUIDE

Please check the following points before calling for service.

Condition	Cause	Remedy
Water does not heat up.	Power Plug is not connected to an electrical outlet. ▶	Connect the Power Plug.
Water does not boil.	The Quick Temp mode is selected. (Water does not reach a boil under Quick Temp mode.) ▶	Press the REBOIL/QUICK TEMP button, select the regular Boil mode. (see pg.13)
Hot water has a disagreeable odor. ● A mild plastic odor may be noticeable with a new product. This odor will gradually fade away. ● You may smell chlorine (used for sterilization of tap water) after boiling.	Scale or other residue has accumulated on the Inner Container. ▶	Perform citric acid cleaning. (see pg.16)
	You have not performed citric acid cleaning regularly. ▶	
	The product has not been used for a long time. ▶	Boil water, unlock and dispense about 34 oz. (1 liter) of hot water. Discard the remaining. (see pg.9)
	If tap water is used under Quick Temp mode, it will take an additional 15 minutes after boiling completes to remove up to 80% of the chlorine. ▶	If this is an issue, use the regular Boil mode instead. (see pg.13)
Water pours out by itself from the Spout or Steam Vent.	Check that the Inner Container is not filled over the Maximum Water Level Line. ▶	Pour out the excess water until it is below the Maximum Water Level Line.
The Quick Temp mode cannot be selected.	Is the 208°F Keep Warm mode selected? ▶	Select the 195 or 175°F Keep Warm mode, then select the Quick Temp mode. (see pg.13)
The 208°F Keep Warm mode cannot be selected during the Quick Temp mode.	You cannot select the 208°F Keep Warm mode during the Quick Temp mode. ▶	
Water does not dispense or does not pour properly.	Hot water does not pour properly a few minutes after boiling. ▶	Open the Upper Lid to release air bubbles, then close. (Be careful of steam when opening the Upper Lid.)
	Scale or other residue has accumulated on the Inner Container and Filter. ▶	Clean the Inner Container and Filter. (see pg.15)
	The Automatic Dispense Lock is engaged. ▶	Press the UNLOCK button, then press the DISPENSE button. (see pg.10)
	Power Plug is not connected to an electrical outlet. ▶	Connect the Power Plug.
	Scale may build up in the water route or Electric Pump and prevent water from dispensing smoothly. ▶	Perform citric acid cleaning. (see pg.16)

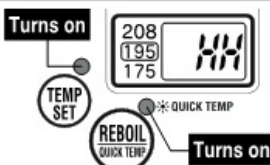
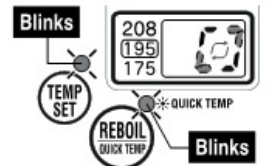
Condition	Cause	Remedy
A filmy, floating residue is noticeable. (Could the Nonstick Coating be peeling off?)	Residue is due to the mineral content in water, not from corrosion of the Inner Container or peeling of the Nonstick Coating.	Perform citric acid cleaning. (see pg.16)
Milky white and rough-surfaced objects have built up on the surface of the Inner Container.	Excessive accumulation of scale and other build-up on the surface of the Inner Container can cause boiling to become louder.	<div data-bbox="1054 208 1445 459"> Scale Over time and use, calcium and other minerals contained in water build up on the surface of the Inner Container and the Filter. It is called "scale" and is harmless to your health. </div>
Boiling is louder than usual.		
Red rust-like spotting appears on the surface of the Inner Container.	Caused by iron in the water, not deterioration of the Inner Container.	
A white floating residue is noticeable.	Remove the Inner Lid and check the plastic part of the Upper Lid for abnormalities. (see pg.15)	If this part is discolored or if it feels rough to the touch, replace it.
Water is not hot.	Initially upon boiling or if it has been a while after dispensing, the water may not be very hot due to water remaining in the Water Level Gauge.	Please discard the first cup (of the hot water).
	Is the Timer set?	Press the REBOIL/QUICK TEMP button. (see pg.14)
The Body becomes hot.	● When the water temperature and/or room temperature is high, the outer surface of the Body may reach up to 140°F (60°C). This is not a malfunction.	
The Power Cord becomes hot.	● The Power Cord may become hot while the water is boiling. This is not a malfunction.	
You hear a light sound when opening and closing the Upper Lid.	● This sound is normal and comes from the movement of the weight which prevents hot water from flowing out when the product is overturned.	
Humidity builds in the Display window.	● If water is filled from a faucet or the product is placed directly on a sink and the bottom becomes wet, water may go inside of the Body and the Display may show moisture. If this happens, stop using the product and allow it to dry as it may cause short circuit or electric shock.	
Error Displays and their meaning	<p>Lights turn on and "HH" appears on the Display.</p> 	<p>The Inner Container is low on water or hot water was added to the Inner Container, causing the Automatic Shut-Off function to engage.</p> <p>Unplug the Power Plug and wait until the Inner Container cools down. Add water and plug in the Power Cord. (see pg.11)</p>
	<p>2 lights blink at the same time and the Display shows a rotating square.</p> 	<p>The Inner Container is in a citric acid cleaning cycle.</p> <p>To cancel the citric acid cleaning cycle, unplug the Power Plug and wait more than 5 seconds before plugging back in. (see pg.16)</p>
	<p>Ⓔ3 or Ⓔ4 is displayed.</p> <p>Indicates malfunction.</p>	<p>Please contact Zojirushi Customer Service.</p>
Replacement for the Upper Lid	<p>Inner Lid Gasket</p> <p>● The Inner Lid Gasket is replaceable, and we recommend that you replace it about once a year. If steam leaks from the gap between the Upper Lid and the Body, or if the Inner Lid Gasket hardens, changes shape, turns white, or otherwise becomes worn out, please replace it. (see pg.15)</p>	
	<p>Plastic Parts</p> <p>● The plastic part of the Upper Lid may deteriorate over use. When replacing the Inner Lid Gasket, check the plastic part. If discoloration occurs or the surface becomes coarse, replace the Upper Lid (must purchase separately). (We take care in only using materials for the plastic parts that are safe and hygienic for food contact.)</p>	

The Nonstick Coating of the Inner Container may become damaged over use. Contact or call Zojirushi Customer Service at: 1-800-733-6270



www.zojirushi.com

CD-JWC_1

Zojirushi CD-JWC30/ CD-JWC40 Micom Water Boiler and Warmer Operating Instruction Manual – [Download
\[optimized\]](#)

Zojirushi CD-JWC30/ CD-JWC40 Micom Water Boiler and Warmer Operating Instruction Manual – [Download](#)

[Manuals+](#)