

ZLINE RT36 Island Conversion Procedure Range Top



ZLINE RT36 Island Conversion Procedure Range Top Instructions

[Home](#) » [Zline](#) » ZLINE RT36 Island Conversion Procedure Range Top Instructions 

Contents

- [1 ZLINE RT36 Island Conversion Procedure Range Top](#)
- [2 ISLAND CONVERSION PROCEDURE for RT36 and RT48](#)
- [3 Documents / Resources](#)
 - [3.1 References](#)
- [4 Related Posts](#)

ZLINE

ZLINE RT36 Island Conversion Procedure Range Top



Product Specifications

- Model: RT36 and RT48
- Manufacturer: ZLINE
- Availability: Prior to Spring 2020
- Conversion Type: Island conversion

Island Conversion Procedure for RT36 and RT48

1. Remove the UPPER SHEET:

Unscrew two screws on each side of the UPPER SHEET located at the back of the range top.

- Lift the UPPER SHEET and flip it to the under side. Unscrew two screws on each side.

2. Remove the BOTTOM SHEET:

- After removing the UPPER SHEET, unscrew six screws holding the BOTTOM SHEET.
- Lift the BOTTOM SHEET and set aside for future use or dispose of it.

3. Reinstall UPPER SHEET:

- Slide the UPPER SHEET back onto the range top.
- Secure the UPPER SHEET using two screws into the holes as shown in the diagram.
- The UPPER SHEET should sit lower than before, with only two holes visible on the back side if successfully installed.

Note: This island conversion procedure is only applicable to ZLINE 36 and 48 range tops (models RT36 and RT48) manufactured before Spring 2020. Newer models do not support this feature.

Frequently Asked Questions (FAQ):

Q: Can I perform the island conversion procedure on newer models of ZLINE range tops?

A: No, this feature is only available for ZLINE 36 and 48 range tops manufactured prior to Spring 2020. Newer models do not support this island conversion procedure.

ISLAND CONVERSION PROCEDURE for RT36 and RT48

Contact 1-614-777-5004 or contact@zlinekitchen.com for assistance.

1. On the back side of the range top, remove the UPPER SHEET by unscrewing the two screws from the holes near the edge of each side of the sheet.
2. Lift the UPPER SHEET and flip to the under side. Two screws on each side must be unscrewed. Set aside once the screws are removed.
3. Once this UPPER SHEET has been removed, remove the six screws holding the BOTTOM SHEET.

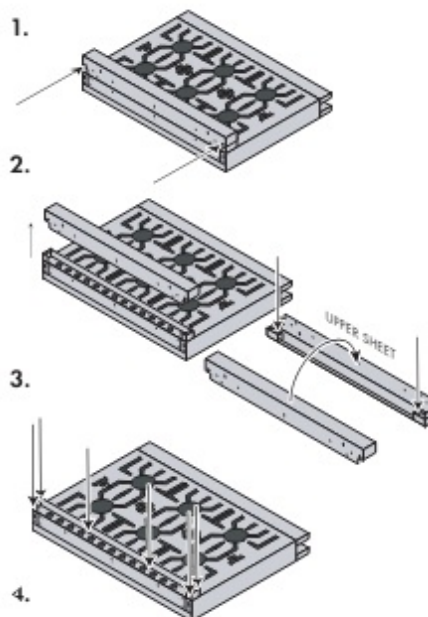

4. After unscrewing, lift the BOTTOM SHEET and set aside for future use if you plan to re-convert back to a range top. You may also dispose of the BOTTOM SHEET.
5. Slide the UPPER SHEET back onto the range top. Using two screws removed earlier, secure the UPPER SHEET into the two holes as shown in the diagram to the left.
6. The UPPER SHEET should sit lower than before as it has replaced the BOTTOM SHEET. If successful, once installed, two holes should only be seen on the back side.

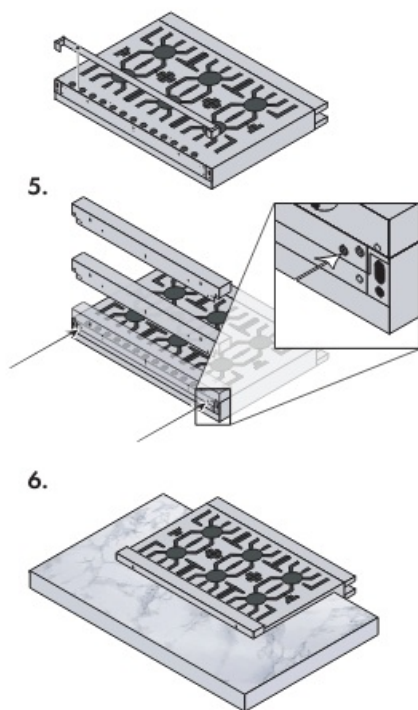

NOTE: The island conversion procedure is only available for ZLINE 36" and 48" range tops (models RT36 and RT48) manufactured prior to spring 2020. Newer models of ZLINE's 30", 36" and 48" range tops do not have this feature.

Documents / Resources

| | |
|--|--|
| | <p>ZLINE RT36 Island Conversion Procedure Range Top [pdf] Instructions RT36 Island Conversion Procedure Range Top, RT36, Island Conversion Procedure Range Top , Conversion Procedure Range Top, Procedure Range Top, Range Top</p> |
|--|--|

References

- [User Manual](#)

[Manuals+](#), [Privacy Policy](#)

This website is an independent publication and is neither affiliated with nor endorsed by any of the trademark owners. The "Bluetooth®" word mark and logos are registered trademarks owned by Bluetooth SIG, Inc. The "Wi-Fi®" word mark and logos are registered trademarks owned by the Wi-Fi Alliance. Any use of these marks on this website does not imply any affiliation with or endorsement.