



ZKTECO SpeedFace-V4L Pro Series Video Intercom Device User Guide

[Home](#) » [ZKTECO](#) » ZKTECO SpeedFace-V4L Pro Series Video Intercom Device User Guide 

ZKTECO SpeedFace-V4L Pro Series Video Intercom Device



Contents

- 1 Overview
- 2 Installation Environment
- 3 Standalone Installation
- 4 Door Bell, Exit Button and Alarm Connection
- 5 Door Sensor and Smoke Detection Connection
- 6 Power Connection
- 7 RS485 and Wieg and Connection
- 8 Ethernet Connection
- 9 Lock Relay Connection
- 10 User Registration
- 11 Ethernet and Cloud Server Settings
- 12 Connecting to ZK Bio Zink App
- 13 Connecting to ZK Bio Zink Web
- 14 Connect the Wireless Doorbell ★
- 15 CUSTOMER SUPPORT
- 16 Documents / Resources
- 16.1 References

Overview

Due to regular upgrades of systems and products, ZK Teco could not guarantee exact consistency between the actual product and the written information in this manual.

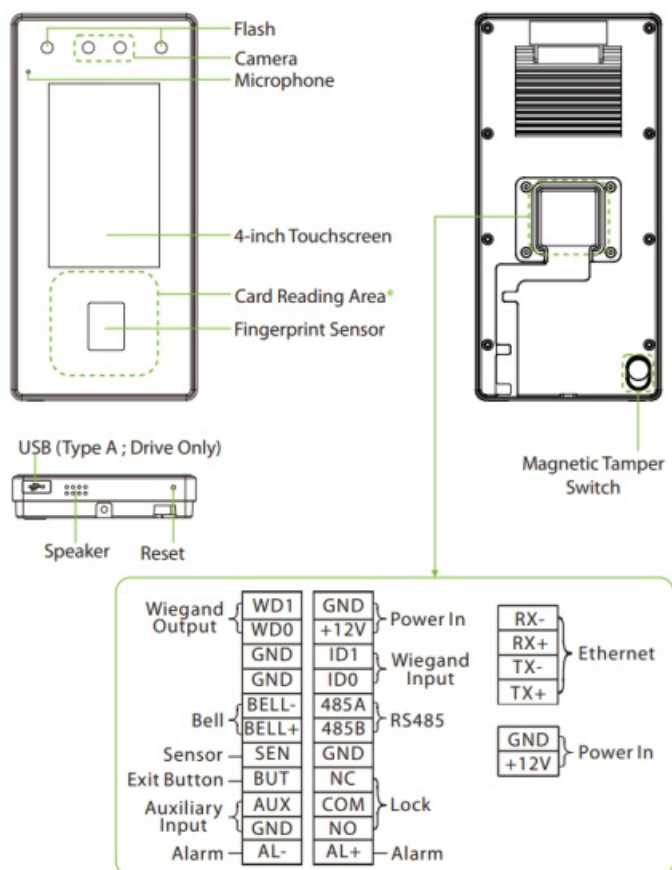

Note:

- To ensure the accuracy of fingerprint recognition, please remove the fingerprint sensor protective film before using your fingerprint.

- Not all products have the function with , the real product shall prevail.

Installation Environment

Please refer to the following recommendations for installation:

- INSTALL INDOORS ONLY



- AVOID INSTALLATION NEAR GLASS WINDOWS



- AVOID DIRECT SUNLIGHT AND EXPOSURE



- AVOID USE OF ANY HEAT SOURCE NEAR THE DEVICE



- Avoid direct contact to sunlight for a long time.
- Protect the device from moisture, water, and rain.
- Handle the device with care.
- Make sure that the device is not installed in close proximity to a sea or other environments where metal oxidation and rust may occur if the device is exposed for a long time.
- Protect the device from lightning.
- Make sure that the device is not working in an acidic or alkaline environment for a long time.

Standalone Installation

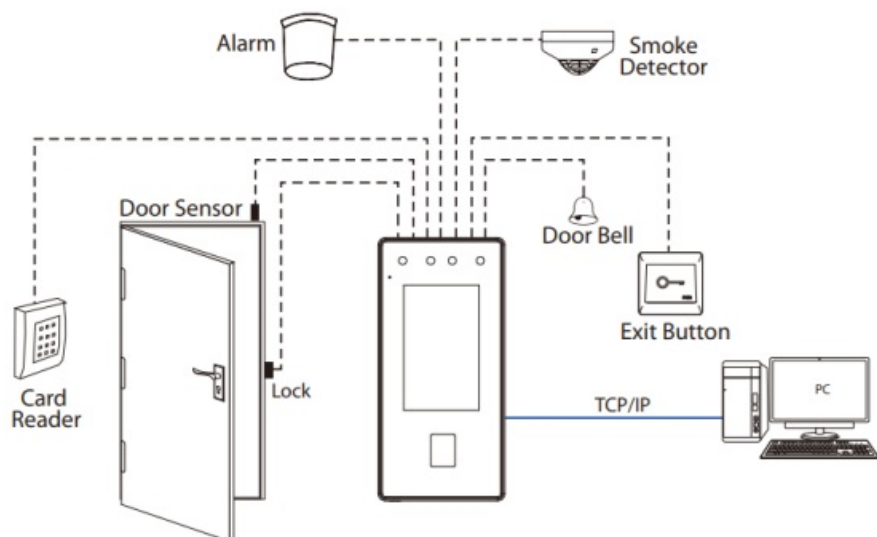

Door Bell, Exit Button and Alarm Connection

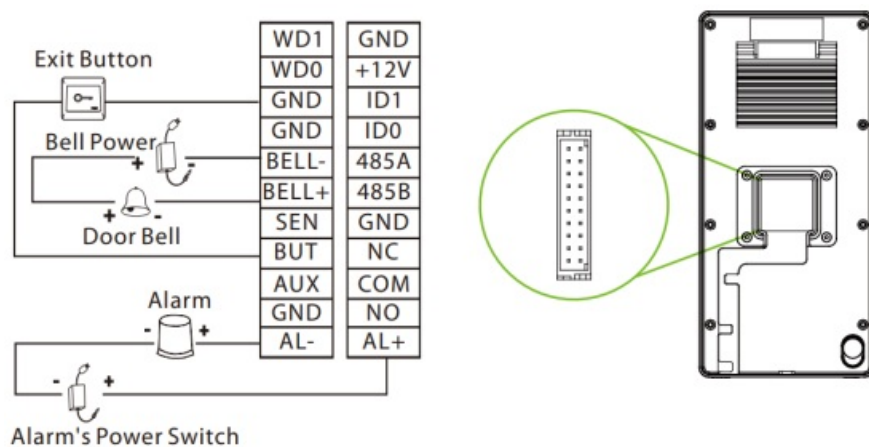

Door Sensor and Smoke Detection Connection

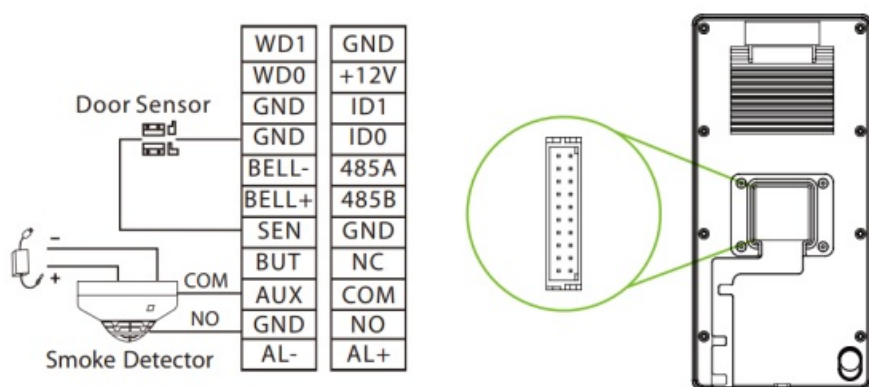

Power Connection

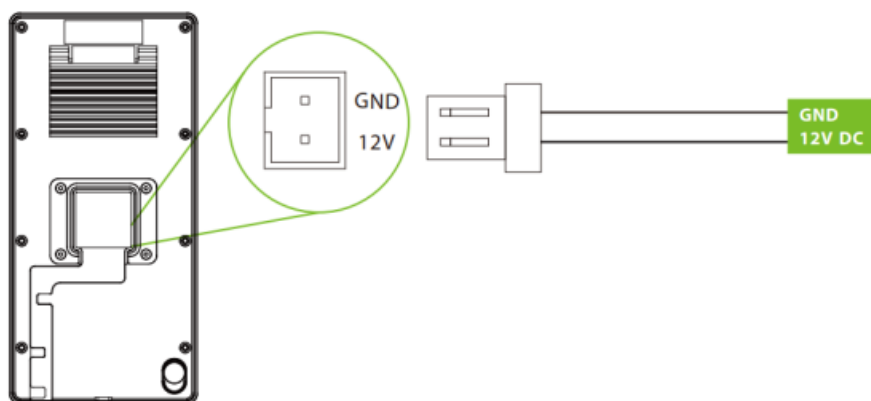

Recommended Power Supply:

- 12V \pm 10%, at least 3000mA.
- To share power with other devices, use a power supply with higher current ratings.

RS485 and Wiegand Connection

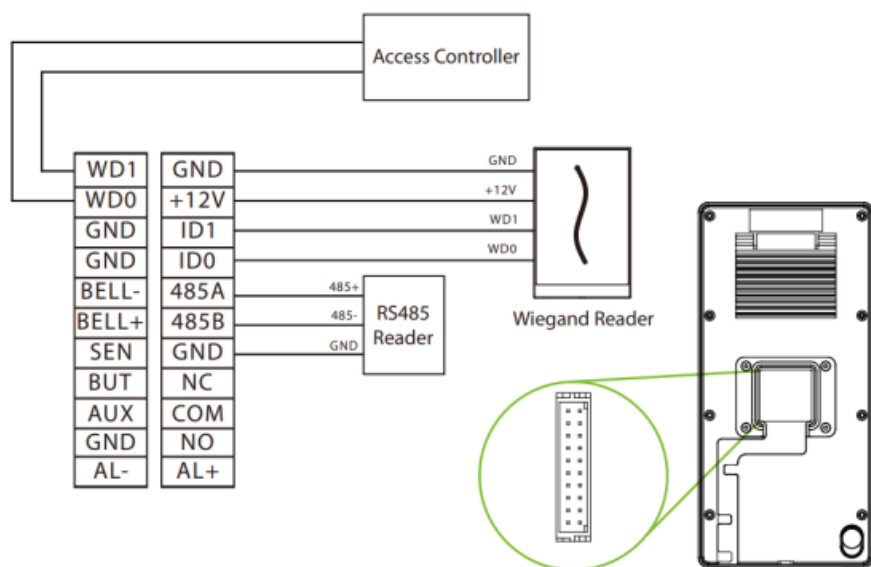

Ethernet Connection

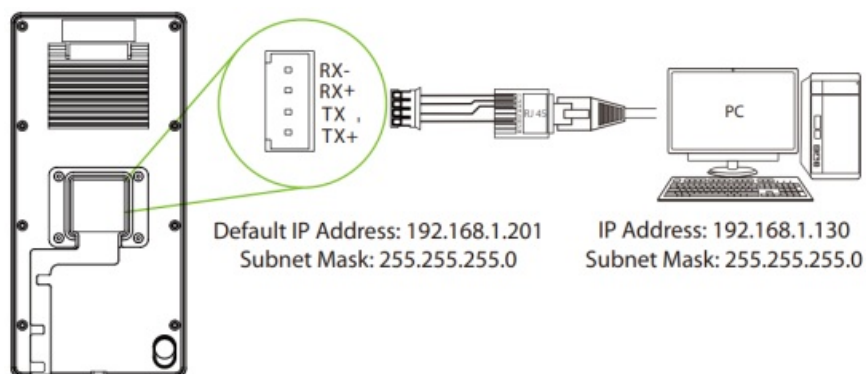

Click COMM. > Ethernet > IP Address on the device, to input the IP address and then click OK.

Lock Relay Connection

The system supports Normally Opened Lock and Normally Closed Lock.

The NO LOCK (Normally opened at Power On) is connected with “NO1” and “COM” terminals, and the NC LOCK (Normally closed at Power On) is connected with “NC1” and “COM” terminals. Take NC Lock as an example below:

Device not sharing power with the lock:

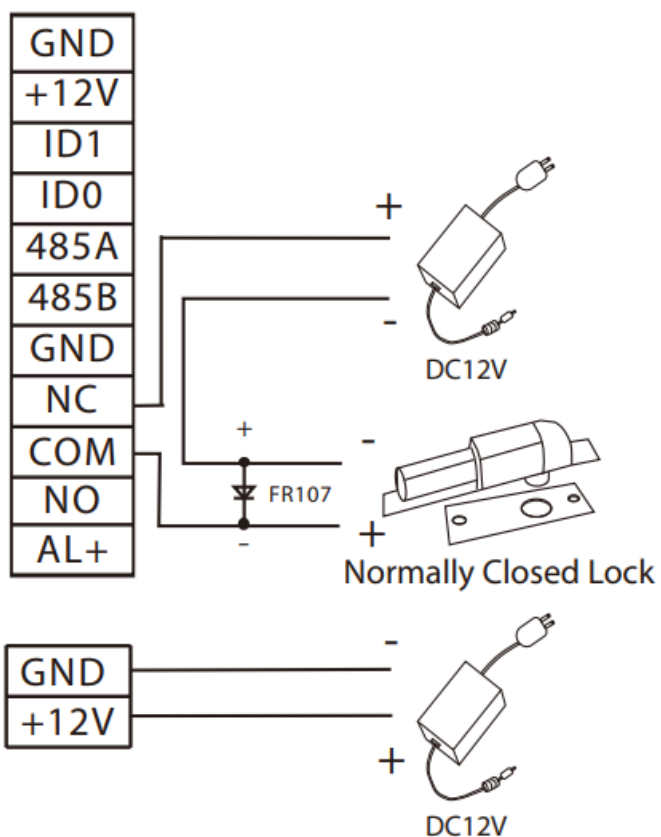

Device sharing power with the lock:

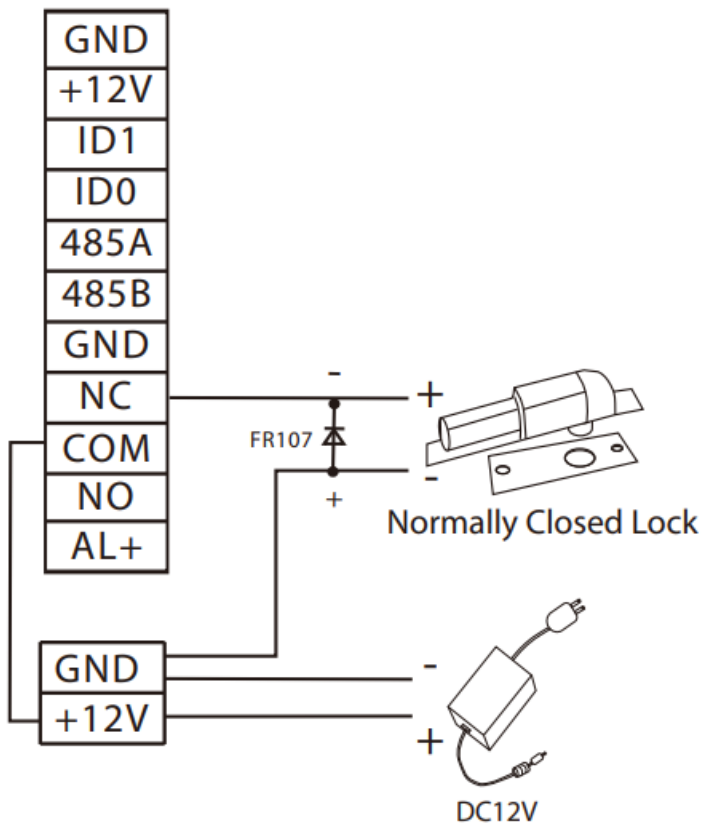

User Registration

When there is no super administrator set in the device, click on  to enter the menu.

Add a new user, set their User Role to Super Admin, and the system will request administrator verification before granting access to the menu. It is strongly recommended to register a super administrator initially for security purposes.

Method 1: Register on the Device

Click on  > User Mgt. New User to register a new user. The options include entering the User ID and Name, Setting User Role, Registering Fingerprint, Face, Card Number, Password and Adding Profile Photo.



Method 2: Register on ZK Bio CV Access Software

Register on the PC

Please set the IP address and cloud service server address, in the Comm. Menu option on the device.

1. Click Access > Access Device > Device > Search to search the device on the software. When an appropriate server address and port are set on the device, the searched devices are displayed automatically.

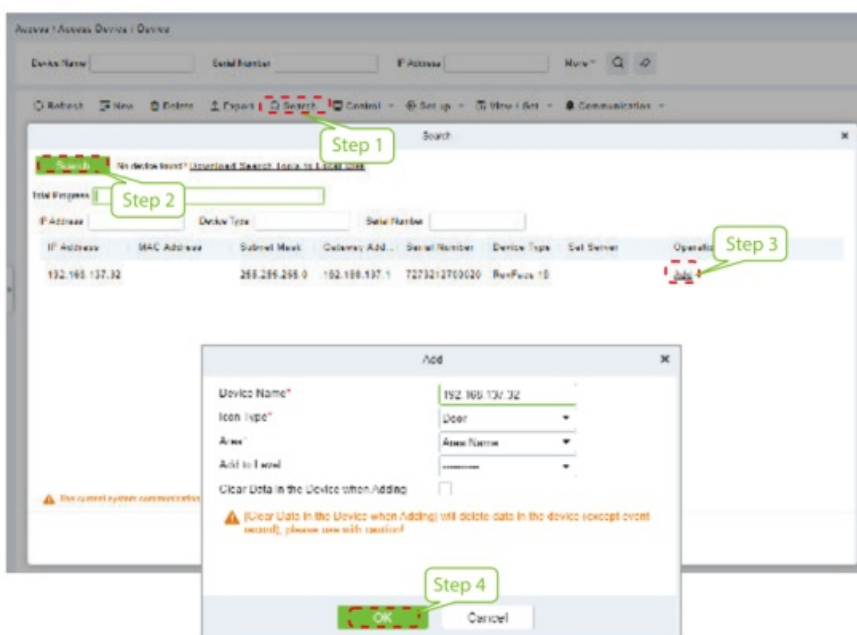

2. Click Add in an operation column, a new window will pop-up. Select Icon type, Area, and Add to Level from each dropdowns and click OK to add the device.
3. Click Personnel > Person > New and fill in all the required fields to register new users in the software.

4. Click Access > Device > Control > Synchronize All Data to Devices to synchronize all the data into the device including the new users.

For more details, please refer to the ZK Bio CV Access User Manual.

Register on the Phone

Once the ZK Bio CV Access software is installed, the users could enroll their face template via a browser application on their own mobile phone.

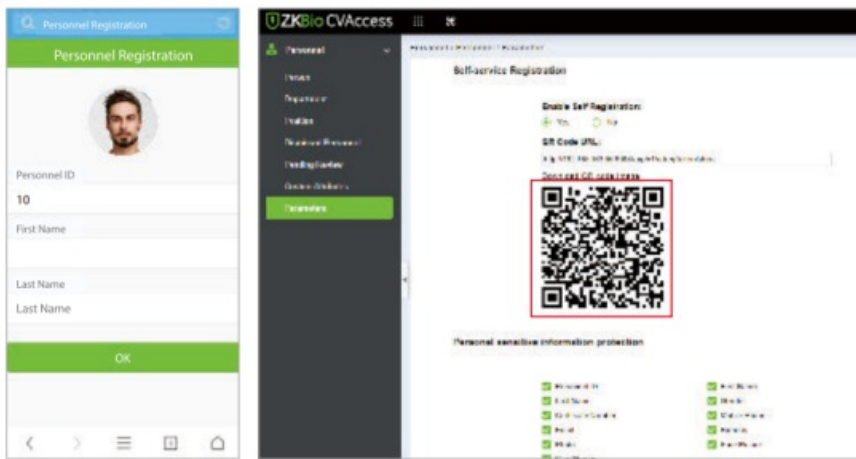

1. Click Personnel > Parameters, input "<http://Serveraddress:Port>" in the QR Code URL. The software will automatically generate a QR code. To register users, scan the QR code or log in at 'http://ServerAddress:Port/app/v1/adreg' using a mobile phone.



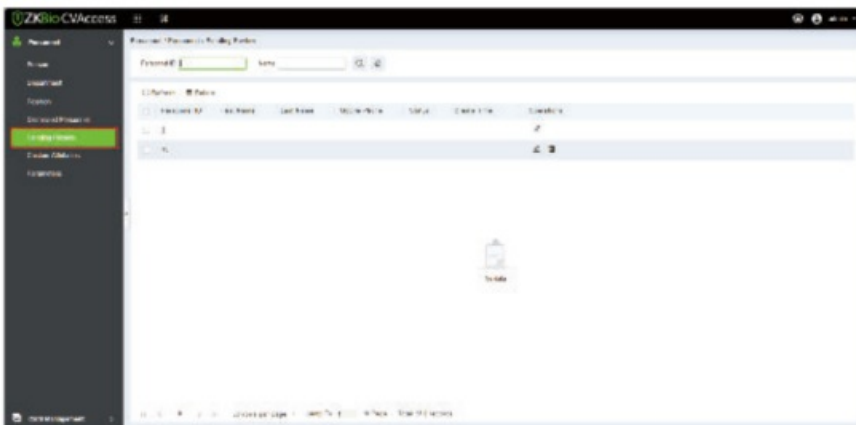

2. The users will be displayed in Personnel > Pending Review.

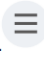

Ethernet and Cloud Server Settings

Click on  > COMM. > Ethernet to set the network parameters. If the TCP/IP communication of the device is successful, the icon  will be displayed in the upper right corner of the standby interface.

Click on  > COMM. > Cloud Server Settings to set the server address. If the device communicates with the server successfully, the icon  will be displayed in the upper right corner of the standby interface.



Connecting to ZK Bio Zink App

Click on  > System > Device Type Setting to change the device communication protocol to the BEST protocol, the device can then be managed by ZK Bio **Zink** .

Step 1: Download the App

Search for the **ZK Bio Zink** App in Apple App Store or Google Play Store and download the App into your smartphone.



Step 2: Create Your Account

Open the **ZK Bio Zink** App and create an account with your phone number or an Email ID.

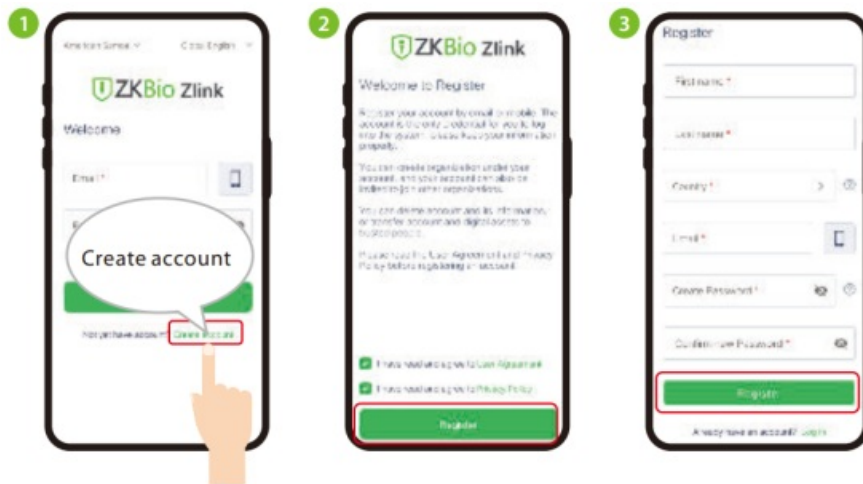

Step 3: Create the Organization

Log in with your successfully registered account and follow the page prompts to create an organization.



Step 4: Add the Site and Zone

Log in with your created account and organization. After a successful login, add Site and Zone in the Me interface

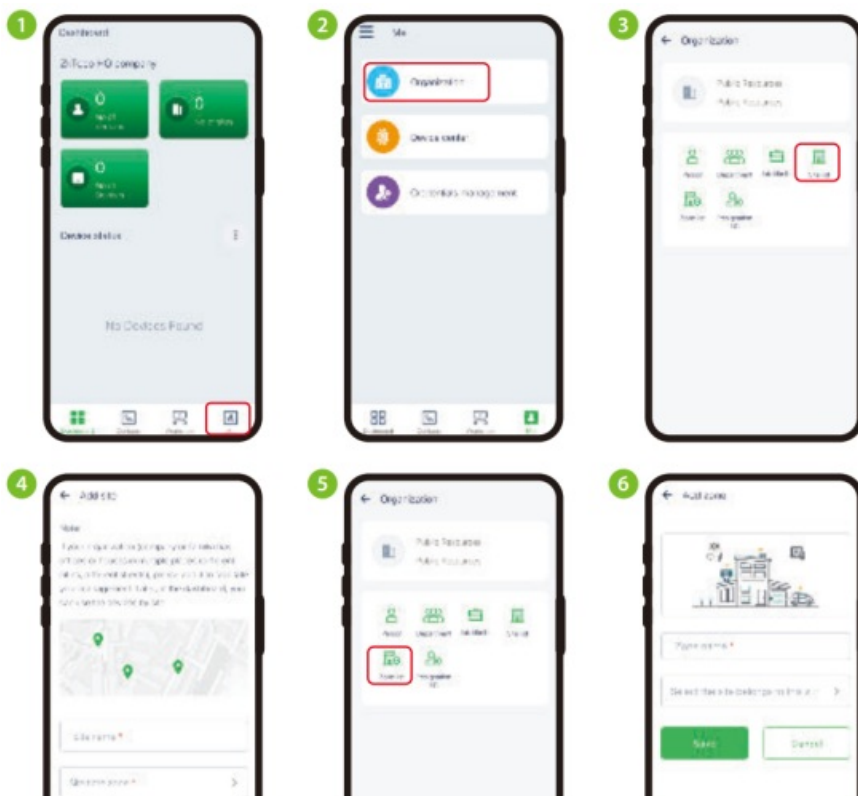

Step 5: Binding the Device

In Workshop interface, click Cloud ACC > Me > Device List to add devices.

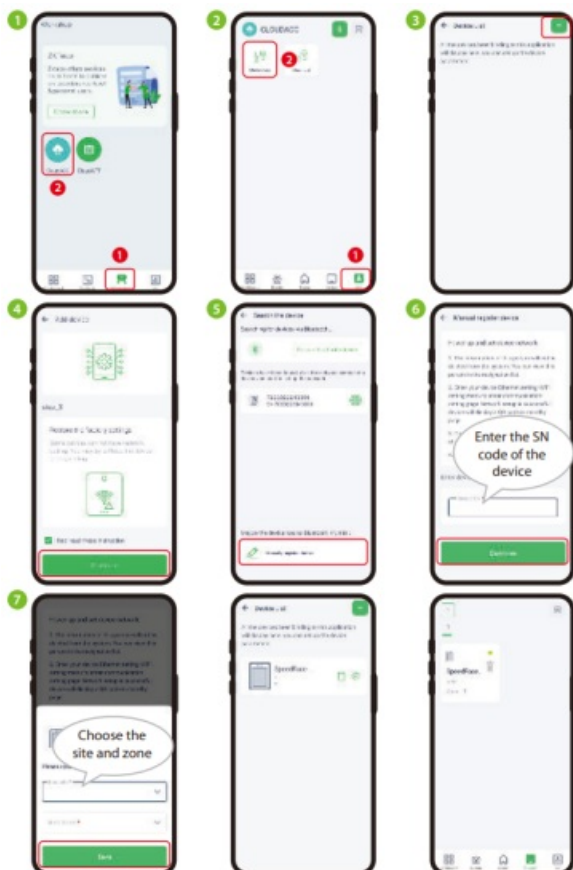

Connecting to ZK Bio Zink Web

After successfully adding devices using the ZK Bio Zink App, you can use the created account to access the ZK Bio Zink Web. With this web interface, you can find devices, add new personnel, register verification methods for

registered personnel, synchronize personnel to devices, and query records. To access the ZK Bio Zink Web, please visit <https://zlink.minervaiot.com/>.

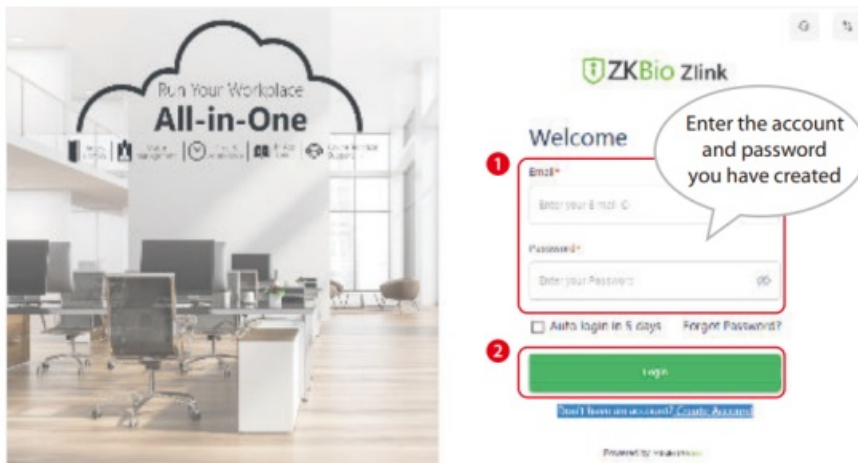

Add Person:

1. Click Me > Organization on the ZK Bio Zink Web main menu to add a person.

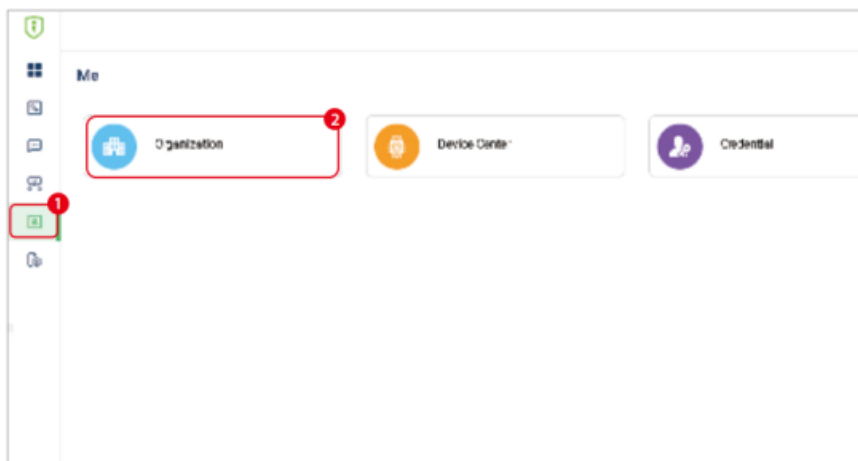

2. Click add icon  to add a new person. Enter the person's information, and click Save.



Synchronize Persons to Device

1. Click **Workshop** > **Cloud ACC** on the ZK Bio Zink Web main menu.

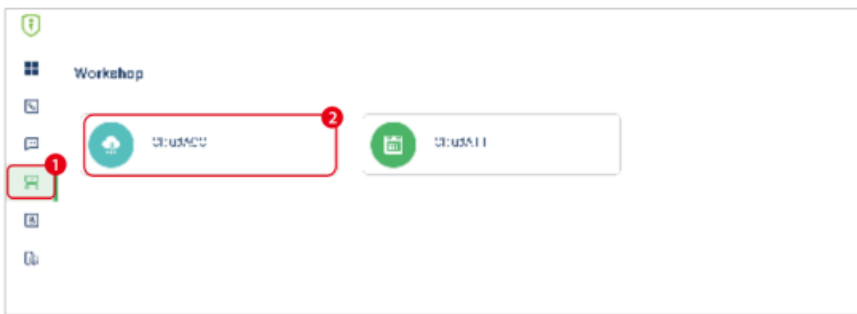

2. Click **Access Control** > **Group Access Time** > **Manage Door** icon  to choose the device.

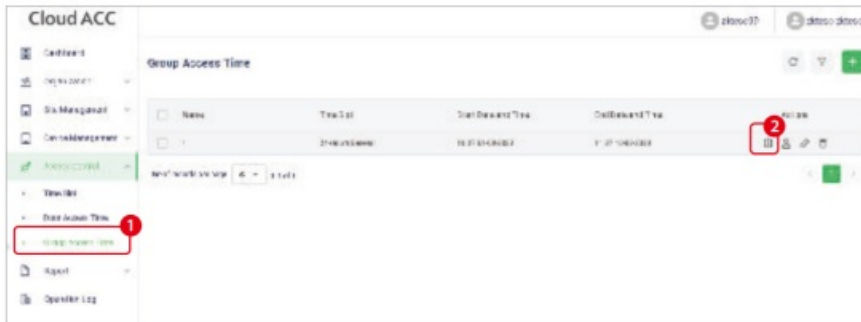

3. Click **Access Control** > **Group Access Time** > **Manage Person** icon  to choose persons for synchronization to this device.

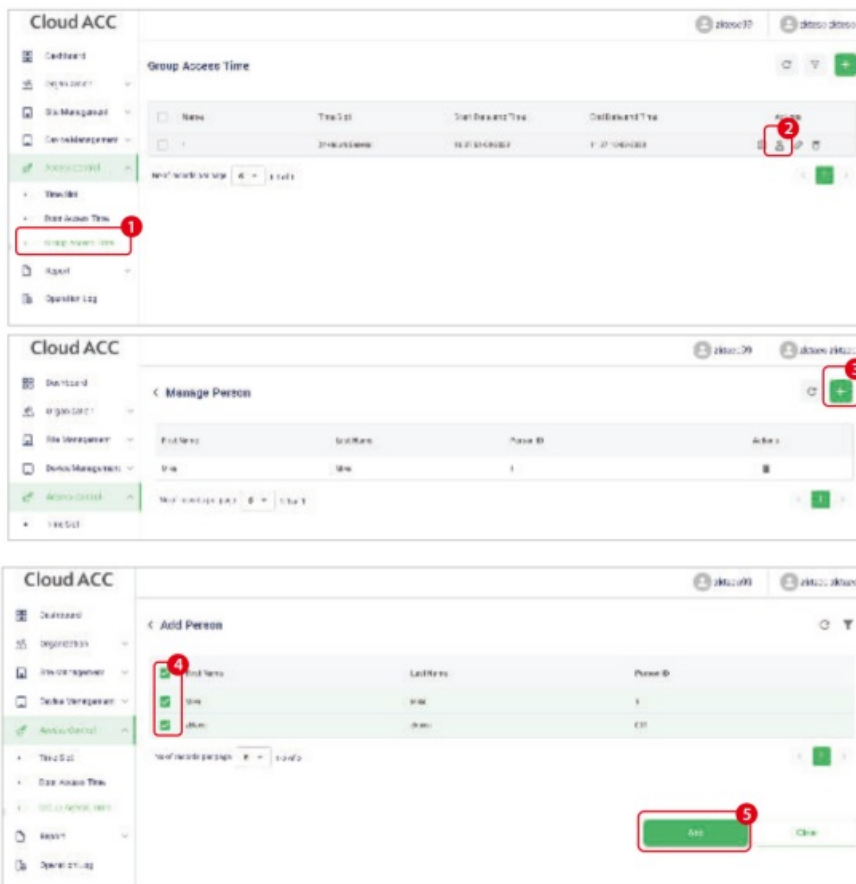

Register Verification Mode

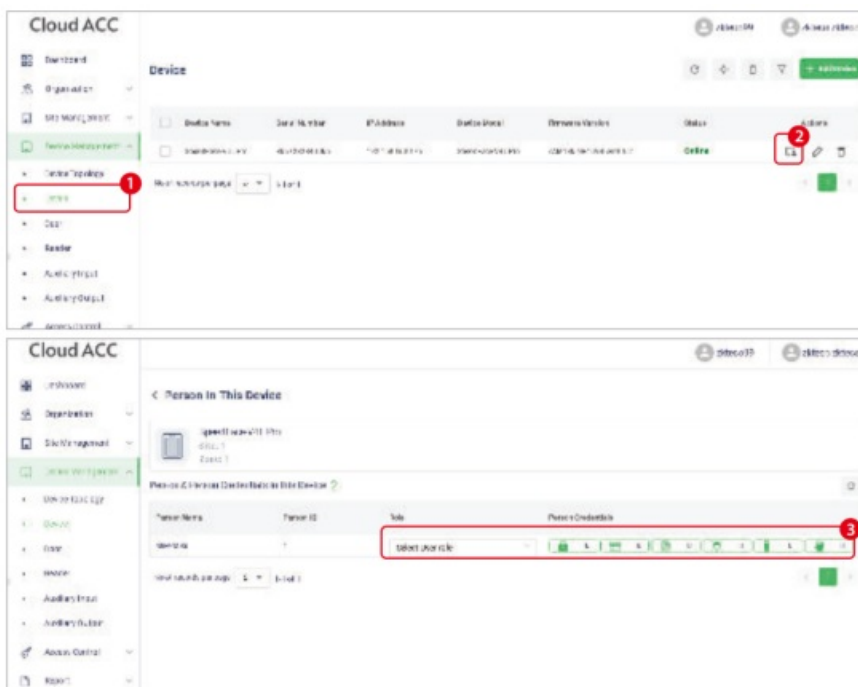

After successfully synchronizing persons to the device, you can view their basic information in the Person in the device interface. Click Workshop > Cloud ACC > Device Management > Device > Persons in the Device icon , click the relevant biometric function icon  (Fingerprint/Face/Password/Card) to remotely register the Personnel Biometric Identification Method.



Note: SpeedFace-V4L Pro Series does not support the palm verification method.

Connect the Wireless Doorbell ★

This function needs to be used with the wireless doorbell.

First, power on the wireless doorbell. Then, press and hold the music button  for 1.5 seconds until the indicator flashes to indicate it's in pairing mode. After that, click on the SpeedFace-V4L Pro icon , if the wireless doorbell rings and the indicator flashes, it means the connection is successful.

- SpeedFace-V4L Pro



- Wireless Doorbell

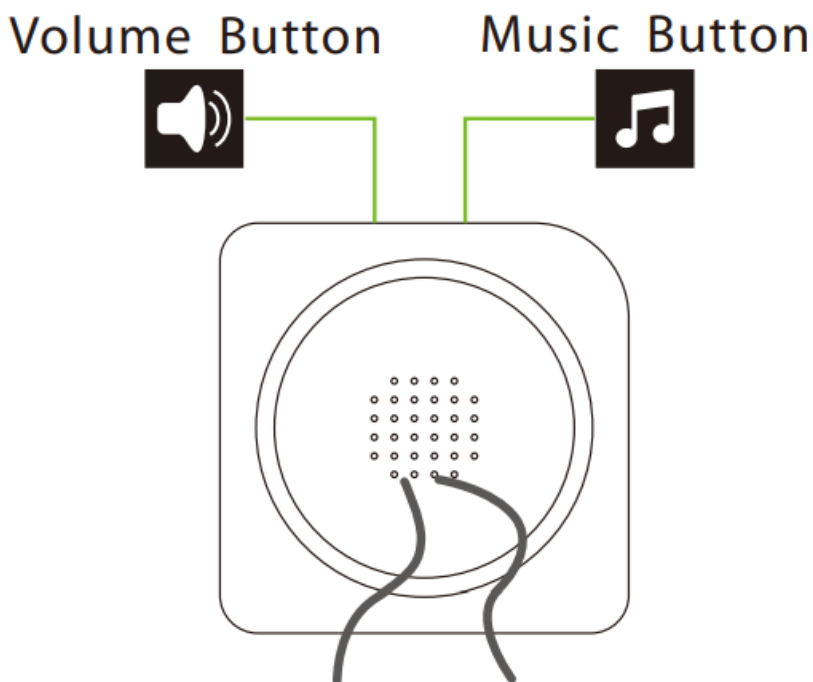

After a successful pairing, clicking the icon  of SpeedFace-V4L Pro will ring the wireless doorbell.

Note: Generally, each SpeedFace-V4L Pro connects to 1 wireless doorbell.

CUSTOMER SUPPORT



ZKTeco Industrial Park, No. 32, Industrial Road,
Tangxia Town, Dongguan, China.

Phone : +86 769 – 82109991

Fax : +86 755 – 89602394

www.zkteco.com

Copyright © 2023 ZKTECO CO., LTD. All Rights Reserved.

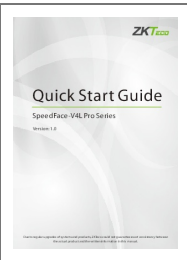

Documents / Resources

	<p>ZKTECO SpeedFace-V4L Pro Series Video Intercom Device [pdf] User Guide SpeedFace-V4L Pro Series, SpeedFace-V4L Pro Series Video Intercom Device, Video Intercom Device, Intercom Device</p>
--	--

References

- [ZKTeco | Biometrics and Computer Vision](#)
- zlink.minervaiot.com/
- [User Manual](#)

Manuals+, Privacy Policy

This website is an independent publication and is neither affiliated with nor endorsed by any of the trademark owners. The "Bluetooth®" word mark and logos are registered trademarks owned by Bluetooth SIG, Inc. The "Wi-Fi®" word mark and logos are registered trademarks owned by the Wi-Fi Alliance. Any use of these marks on this website does not imply any affiliation with or endorsement.