



# ZKTECO EFace10 Visible Light Face Recognition Device Installation Guide

[Home](#) » [ZKTECO](#) » ZKTECO EFace10 Visible Light Face Recognition Device Installation Guide

## Contents [ [hide](#) ]

- [1 ZKTECO EFace10 Visible Light Face Recognition Device](#)
- [2 How to Install the Device](#)
- [3 Wiring Diagram](#)
- [4 Download Center](#)
- [5 Documents / Resources](#)
  - [5.1 References](#)
- [6 Related Posts](#)



## ZKTECO EFace10 Visible Light Face Recognition Device



### How to Install the Device

1. Attach the mounting template sticker to the wall, and drill holes according to the mounting paper.
2. Fix the Backplate on the wall using the wall mounting screws.
3. Attach the device to the Backplate.
4. Fasten it with a security screw.

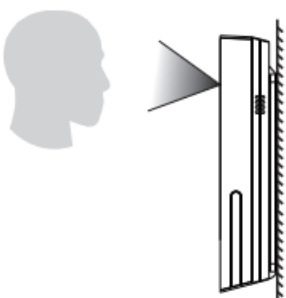
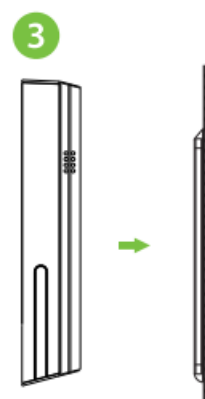
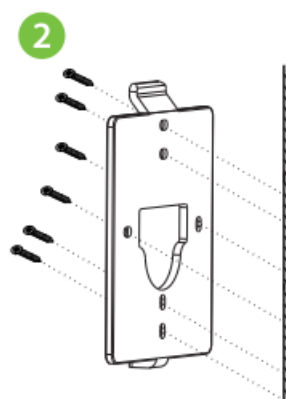
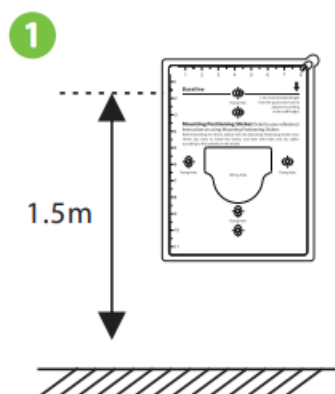

#### With Back Cover

1. Attach the mounting template sticker to the wall, and drill holes according to the mounting paper.
2. Fix the Back Cover on the wall using the wall mounting screws.
3. Attach the device to the Back Cover.
4. Fasten it with a security screw.

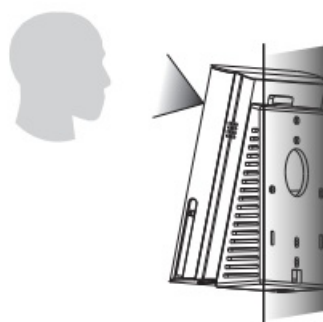
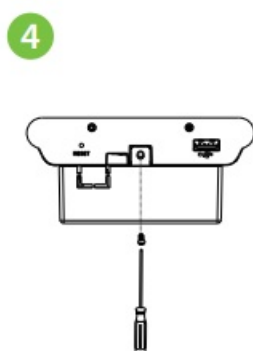
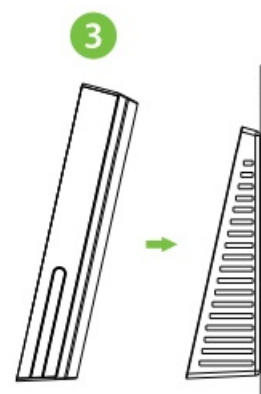
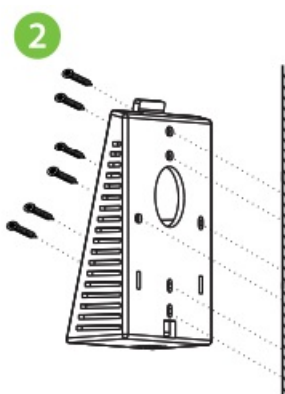
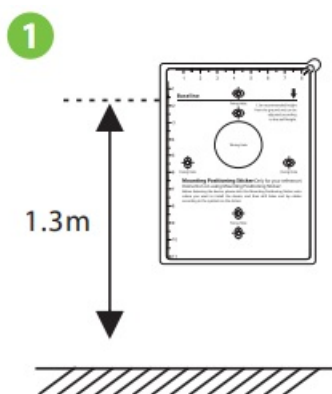

## Desktop Placement

1. Attach the Back Cover to the Device.
2. Fasten it with a security screw.

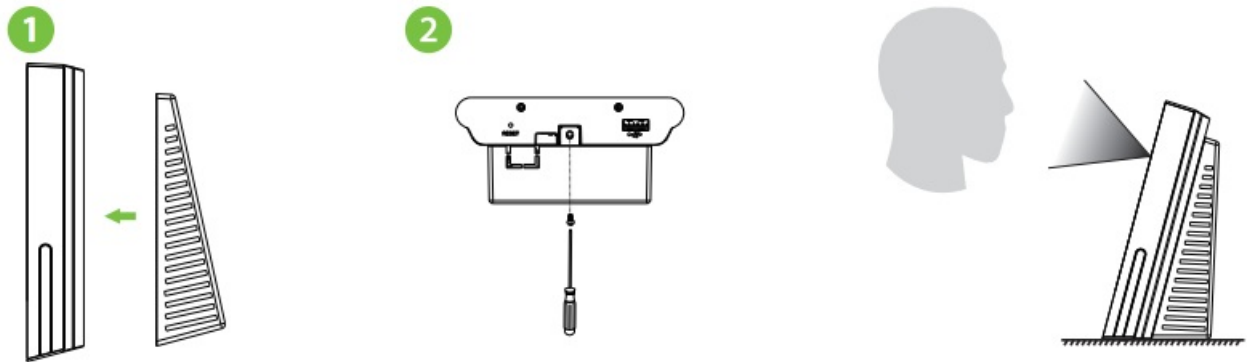

## Wiring Diagram

### Power Connection:

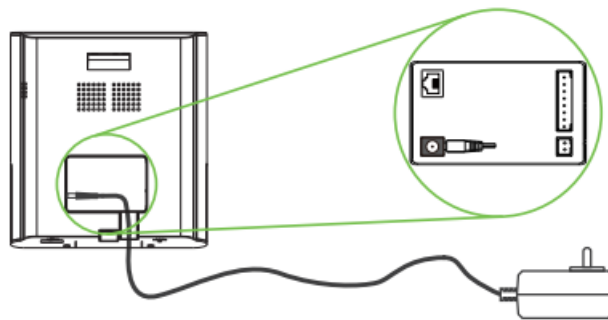

### Recommended AC Adapter

1. 12V  $\pm$  10%, at least 1500mA.
2. To share the power with other devices, use an AC Adapter with higher current ratings

### Ethernet Connection:

Connect the device and computer software over an Ethernet cable. As shown in the example below:

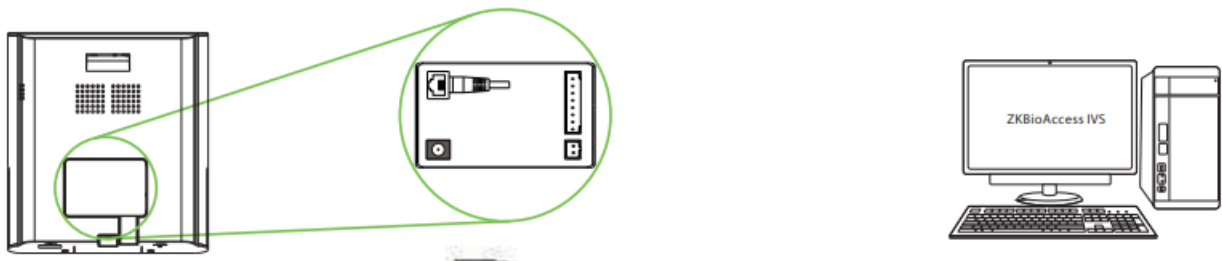

Click on [COMM.] > [Ethernet] > [IP Address] , input the IP address and click on [OK]. Note: In LAN, the IP addresses of the server (PC) and the device must be in the same network segment when connecting to the ZKBioAccess IVS software.

### Lock Relay Connection:

The device not share power with the lock

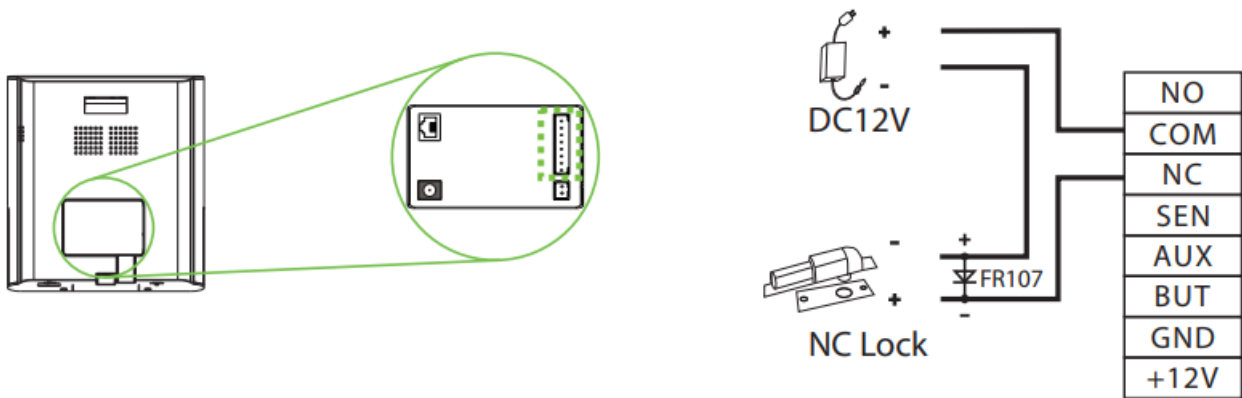

### Door Sensor, Exit Button & Auxiliary Input Connection

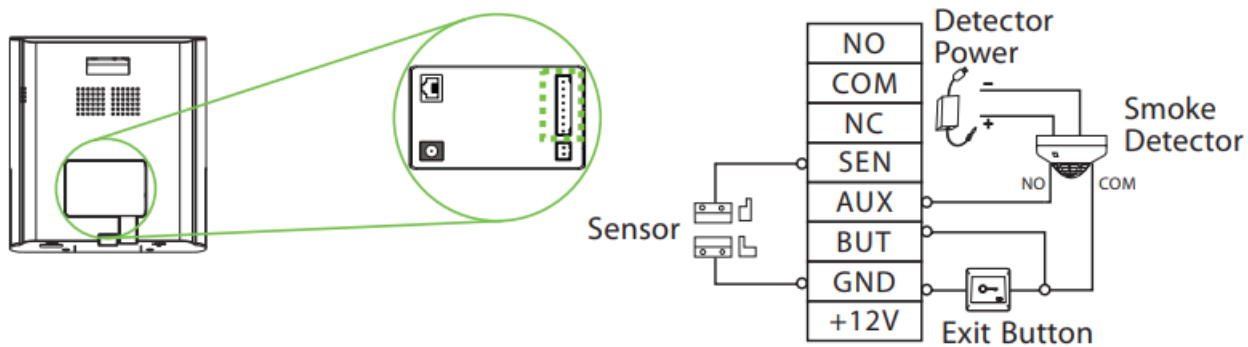

### Download Center

Scan the QR Code to download the User Manual, Installation Guide and Quick Start Guide.



### Documents / Resources



[ZKTECO EFace10 Visible Light Face Recognition Device](#) [pdf] Installation Guide  
Eface10, Visible Light Face Recognition Device, Face Recognition Device, Face Recognition, E  
Face10, Recognition Device

## References

- [ZKTeco | Home Page](#)