



ZKTECO EFace10 Time & Attendance and Access Control Terminal Installation Guide

[Home](#) » [ZKTECO](#) » ZKTECO EFace10 Time & Attendance and Access Control Terminal Installation Guide 



Installation Guide

Eface10

Version: 1.0

Due to regular upgrades of systems and products, ZKTeco could not guarantee exact consistency between the actual product and the written information in this manual.

Contents

- [1 How to Install the Device?](#)
- [2 Wiring Diagram](#)
- [3 Download Center](#)
- [4 Documents / Resources](#)
 - [4.1 References](#)
- [5 Related Posts](#)

How to Install the Device?

With Backplate:

1. Attach the mounting template sticker to the wall, and drill holes according to the mounting paper.
2. Attach the device to the Backplate.
3. Fix the Backplate on the wall using the wall mounting screws.
4. Fasten it with a security screw.

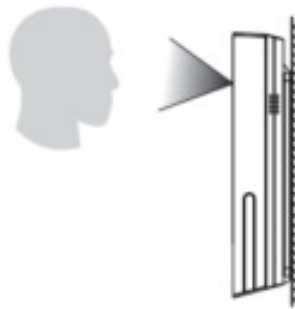
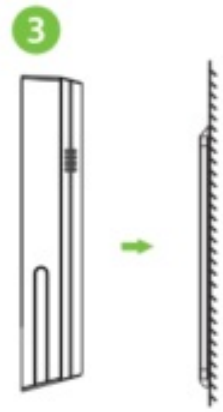
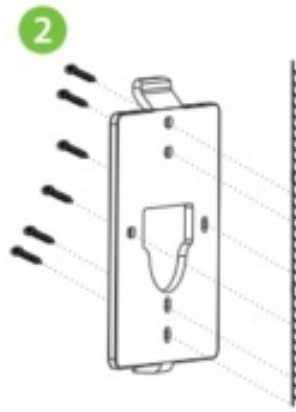
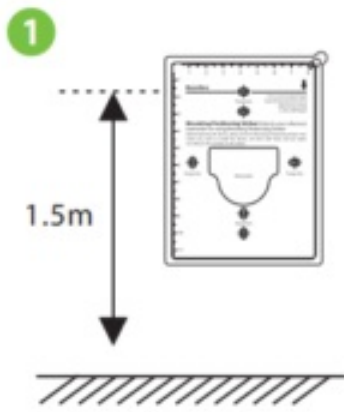

Note: Features and parameters with ★ marks are not available on all devices.

With Back Cover :★

Wall Mount

1. Attach the mounting template sticker to the wall, and drill holes according to the mounting paper.
2. Attach the device to the Back Cover.
3. Fix the Back Cover on the wall using the wall mounting screws.
4. Fasten it with a security screw.

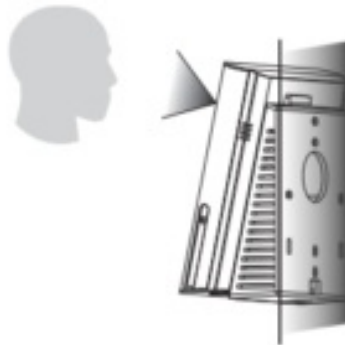
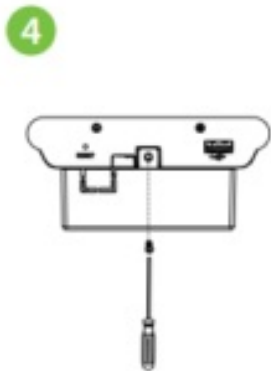
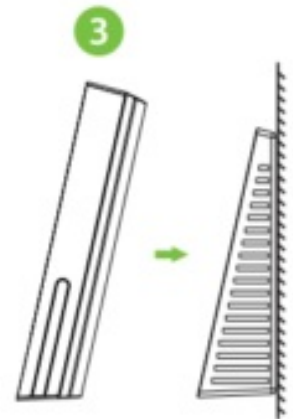
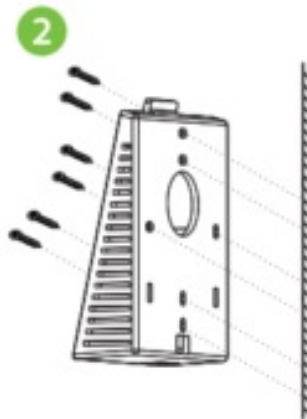
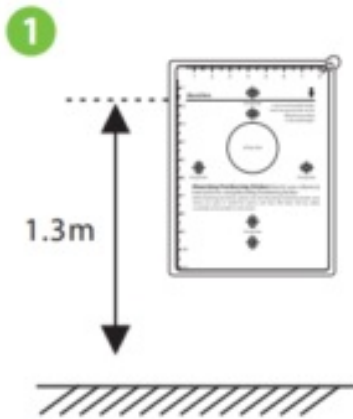

Desktop Placement

1. Attach the Back Cover to the Device.
2. Fasten it with a security screw.

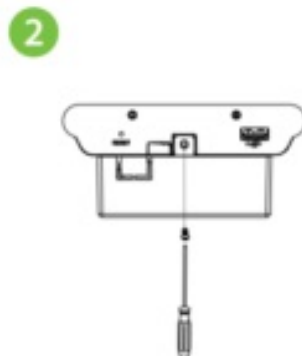
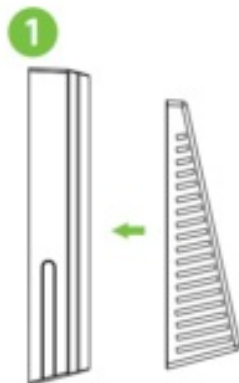

Wiring Diagram

Power Connection:

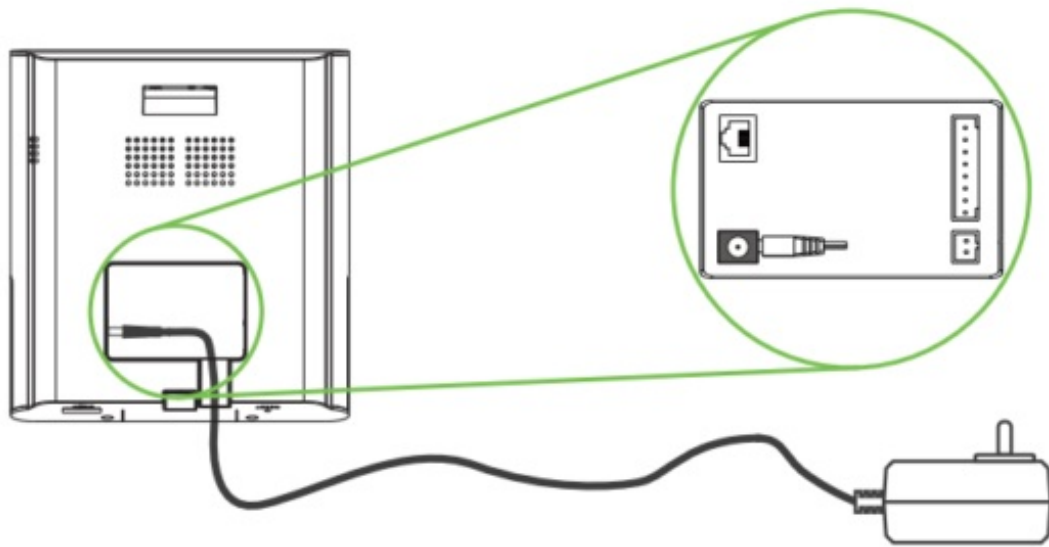

Recommended AC Adapter

1. 12V \pm 10%, at least 1500mA.
2. To share the power with other devices, use an AC Adapter with higher current ratings.

Ethernet Connection:

Connect the device and computer software over an Ethernet cable. As shown in the example below:

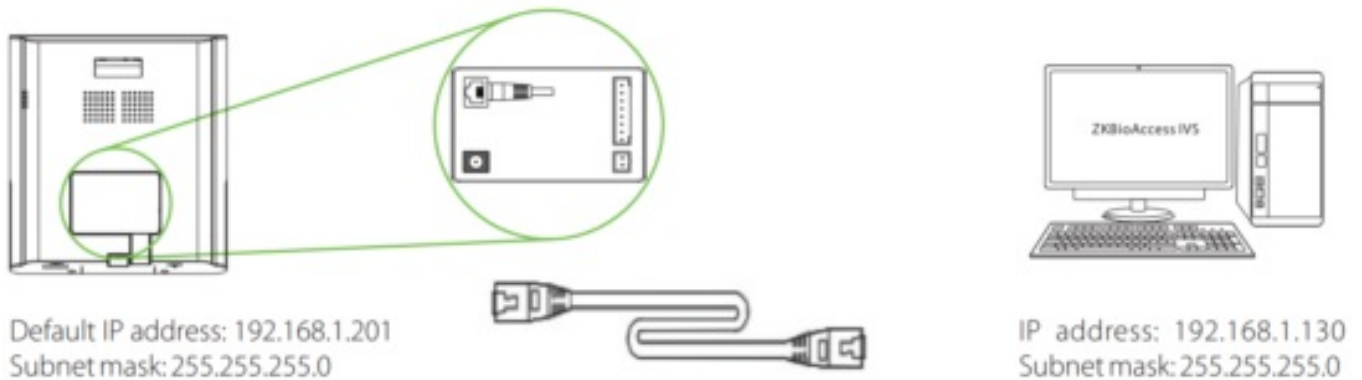

Click on **[COMM.]** > **[Ethernet]** > **[IP Address]** , input the IP address and click on **[OK]**.

Note: In LAN, the IP addresses of the server (PC) and the device must be in the same network segment when connecting to the ZKBioAccess IVS software.

Lock Relay Connection:

The device does not share power with the lock

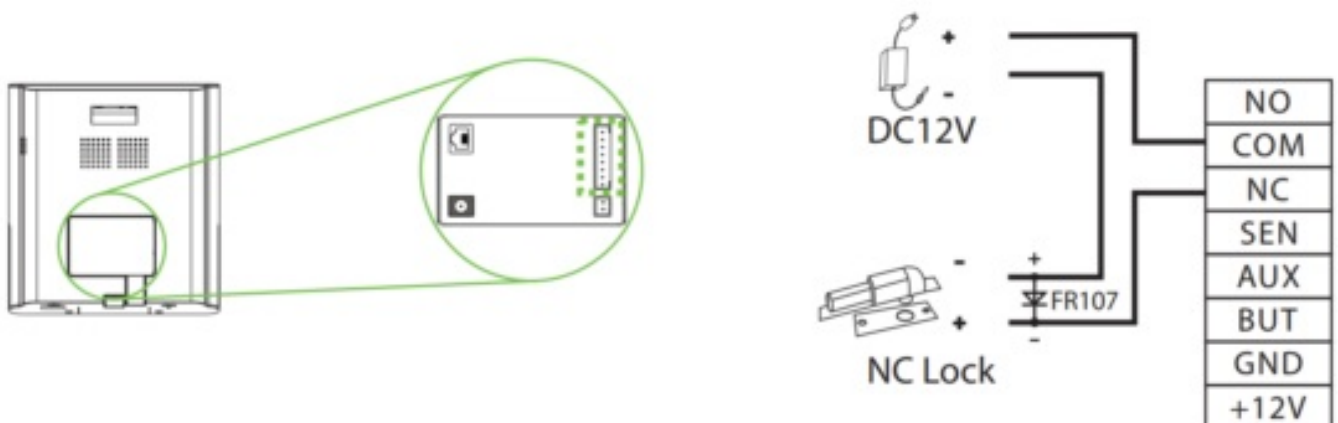

Door Sensor, Exit Button & Auxiliary Input Connection:

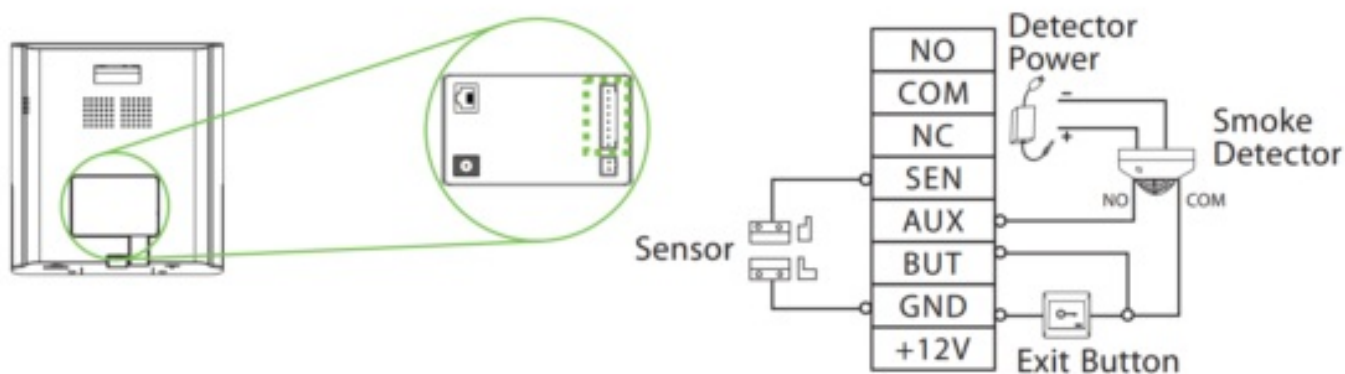

Download Center

Scan the QR Code to download the User Manual, **Installation Guide**, and **Quick Start Guide**.



QR Code (Download Center)

https://www.zkteco.com/en/download_catgory/41.html

ZKTeco

ZKTeco Industrial Park, No. 32, Industrial Road,
Tangxia Town, Dongguan, China.

Phone : +86 769 – 82109991

Fax : +86 755 – 89602394

www.zkteco.com



<https://www.zkteco.com/en/>

Documents / Resources

| | |
|---|---|
|  | <p>ZKTECO EFace10 Time & Attendance and Access Control Terminal [pdf] Installation Guide EFace10, Time Attendance and Access Control Terminal</p> |
|---|---|

References

- [ZKTeco | Home Page](#)

Manuals+