



## Zip Micro B Instant Boiling and Chilled Water User Manual

[Home](#) » [Zip](#) » Zip Micro B Instant Boiling and Chilled Water User Manual 

### Contents

- [1 Zip Micro B Instant Boiling and Chilled Water](#)
- [2 Major components and accessories](#)
- [3 Technical specification](#)
- [4 Before Installation](#)
- [5 Installation instructions](#)
- [6 Commissioning](#)
- [7 Operation](#)
- [8 Maintenance](#)
- [9 Troubleshooting](#)
- [10 Documents / Resources](#)
- [11 Related Posts](#)



**Zip Micro B Instant Boiling and Chilled Water**



## **WARNINGS AND PRECAUTIONS**

### **1. WARNING:**

For continued safety of this appliance it must be installed, operated and maintained in accordance with the manufacturer's instructions.

2. Plumbing and electrical connections must be made in accordance with local regulations and relevant standards. In Australia: Plumbing standard AS/NZS 3500 series & Electrical Wiring Rules AS/NZS 3000.
3. For residential chilled models, all refrigeration must comply with AS/NZS 60335.2.24.
4. This appliance must be earthed.
5. The power cord and general power outlet must be in a safe and accessible position after installation.
6. Do not remove the cover of the appliance under any circumstances without first isolating the appliance from the power supply.
7. This unit is designed for indoor use and must not be installed outdoors or exposed to the elements of nature.
8. This appliance must not be cleaned by a water jet. This appliance must not be positioned in an area that may be cleaned by a water jet.
9. This appliance is intended to be used in: staff kitchen areas in shops, offices and other working environments; farm houses and by clients in hotels, motels and other residential type environments; bed and breakfast type environments; catering and similar non-retail applications.
10. Due to the process of continuous improvement, Zip reserves the right to change details in this manual, without notice. Visit [zipwater.com](http://zipwater.com) to ensure you have the latest copy of this document.

### **Safety**

This appliance is not intended for use by persons (including children) with reduced physical, sensory or mental capabilities, or lack of experience and knowledge, unless they have been given supervision or instruction concerning use of the appliance by a person responsible for their safety. For products sold in Europe, this appliance can be used by children aged from 8 years and above and persons with reduced physical, sensory or mental capabilities or lack of experience and knowledge if they have been given supervision or instruction concerning use of the appliance in a safe way and understand the hazards involved. Children should be supervised to ensure that they do not play with the appliance. Cleaning and user maintenance shall not be made by children without supervision.

**Refrigerant (BC model)**

The Hydro Tap Micro (BC model) contains R134A refrigerant under pressure. Maintenance of the refrigeration unit must be carried out by an accredited service provider or qualified refrigeration technician.

**Qualifications**

If the power cable is damaged it must be replaced by a qualified technician. To avoid hazards, all installation procedures must be carried out by a suitably qualified tradesperson.

**Venting**

Occasionally steam and / or boiling water may discharge through a vent outlet on the tap. Ensure the tap body is located so the tap outlet safely dispenses into the drip tray or sink bowl area.

**Lifting**

Take care when lifting. The Micro command centre may exceed safe lifting limits. If you feel this is beyond your personal capabilities, please seek assistance with the lift. Do not lift the Micro command centre by the front cover or any of its connections. Refer to the Technical specification for the weight of the product.





**Airflow**

The ambient operating temperatures, when installed in a cupboard, must be between 5°C – 35°C. The system will operate satisfactorily only if the recommended air gaps of 50 mm on each side, and 200mm above the command centre are provided. If a vent kit is supplied, it is recommended to be fitted according to these instructions.

**Frost Protection**

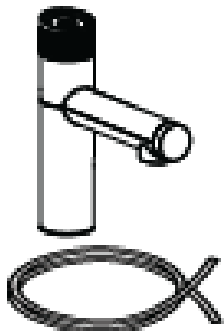
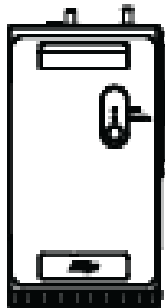
If this appliance is located where the ambient air temperature could fall below 5°C when the heater is not in use, do not turn off the appliance electrically. This safeguard does not offer the same protection to the connecting pipework and fittings.

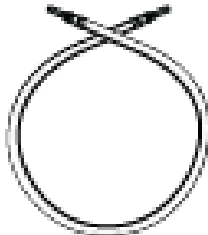
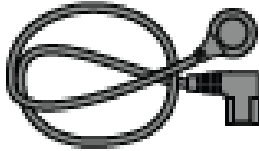
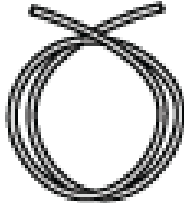
**Major components and accessories**

Parts supplied	Description
	<p>Micro Tap and hoses</p> <p>part no: 94873 B hoses (x2) 94863 BC hoses (x3) 94063 tap fixing kit</p>
	<p>Micro command centre, including water filter</p>
	<p>350 kPa PLV part no. 90833</p>
	<p>Braided hose for mains water (1m) part no. 95006</p>
	<p>IEC power cable (1.8m) part no. 94704</p>
	<p>1/4" filter flush hose (1m) part no. 91025</p>
	<p>Installation instructions (this book)</p>

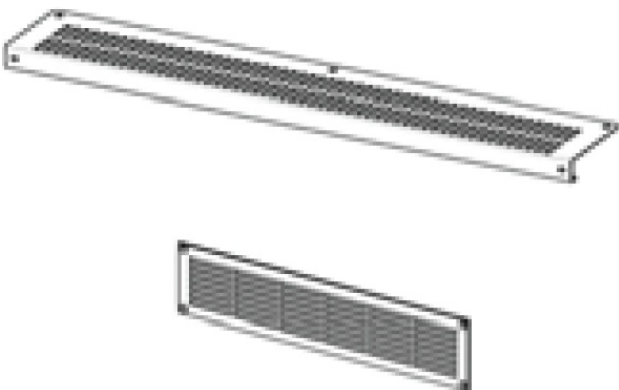
Parts supplied	Description
	<p><b>For BC model: Vent Kit</b></p> <p><b>1 x inlet, 1 x outlet</b></p> <p><b>9 x screws</b></p> <p><b>part no. 93257</b></p>
<ul style="list-style-type: none"> <li>• Allen key</li> <li>• Tube spanner</li> <li>• Filter flush key</li> <li>• 4x 6mm adhesive door buffers</li> <li>• Tap operation label</li> </ul>	

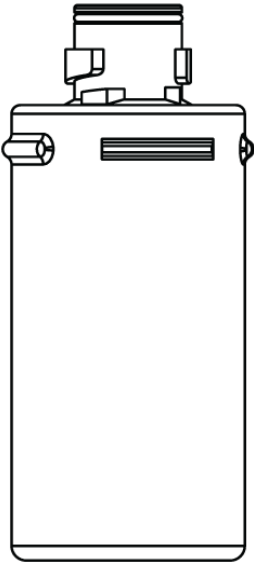
Accessories	Description
	<p><b>Replacement filter</b></p> <p><b>part no: 93701 (0.2 micron)</b></p>

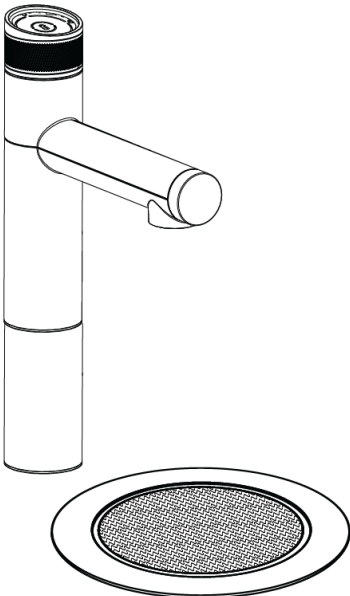
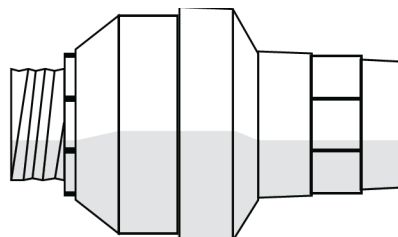
	<p><b>Font and tap extension kit part no:</b></p> <p><b>95162 (Chrome)</b></p> <p><b>95163 (Matte Black)</b></p>
	<p><b>Water block</b></p> <p><b>part no. 95136</b></p>

## Technical specification

<b>Model:</b>	<b>Micro B (Boiling)</b>	<b>Micro BC (Boiling Chilled)</b>
<b>Rated Voltage/Power</b>	220-240V, 50Hz, 1.39 kW 220V, 60Hz, 1.23 kW	220-240V, 50Hz, 1.52 kW
<b>Rated mains inlet water pressure</b>	150 – 700 kPa	
<b>Water connection</b>	1/2" BSP (G 1/2")	
<b>Ambient operating temperature</b>	5 – 35 °C	
<b>Boiling water temperature setpoint</b>	98°C	
<b>Boiling water performance</b>	15 L (90 cups) per hour	
<b>Chilled water temperature setpoint</b>	–	6 – 8°C
<b>Chilled water coolant</b>	–	R134a
<b>Chilled water performance – Commercial installations</b>	–	12 L (60 glasses) per hr
<b>Chilled water performance – Residential installations</b>	–	2.4L (12 glasses) per hr
<b>Dimensions (W x D x H) (mm)</b>	180 x 270 x 340	180 x 502 x 340
<b>Dry weight (command centre)</b>	9 kg (+1.8kg when filled)	15.6 kg (+3.6kg when filled)

#### **Note**

1 cup = 167 mL, 1 glass = 200mL.

An optional water block may be fitted in the water supply line to minimize the potential damage in the event of leakage. Contact your local service centre.

## **Before Installation**

### **Before installation, ensure that:**

- All technical specifications and instructions have been reviewed.
- The under bench can support the product weight when full of water (see Technical specification).
- There is sufficient space in the cupboard to install the command centre and other components in accordance with these installation instructions.
- A user easily-accessible 220-240V AC, 10A power outlet is required.
- The appliance must be connected in accordance with current local electrical regulations. See Technical specification for power ratings. Check cable and plumbing against inlet /outlet positions before proceeding.
- Potable water supply with working pressure of 150 – 700 kPa (1.5 – 7.0 bar), with isolating valve within reach of the hose and positioned so that the valve will not be obstructed.
- A 350 kPa (3.5 bar) pressure limiting valve, which also functions to prevent backflow of water into the water mains (supplied) must be fitted.

- The appliance must be placed upright with its base in a horizontal position.

### IMPORTANT!

Do not proceed with the installation if these requirements are not met.

## Installation instructions

### Tap installation

Position the Micro Tap so that water from its spout will fall into a sink/drip tray fitted with a drain. Cut a 35mm hole into the sink or benchtop, using a sheet metal punch or hole saw (not supplied).

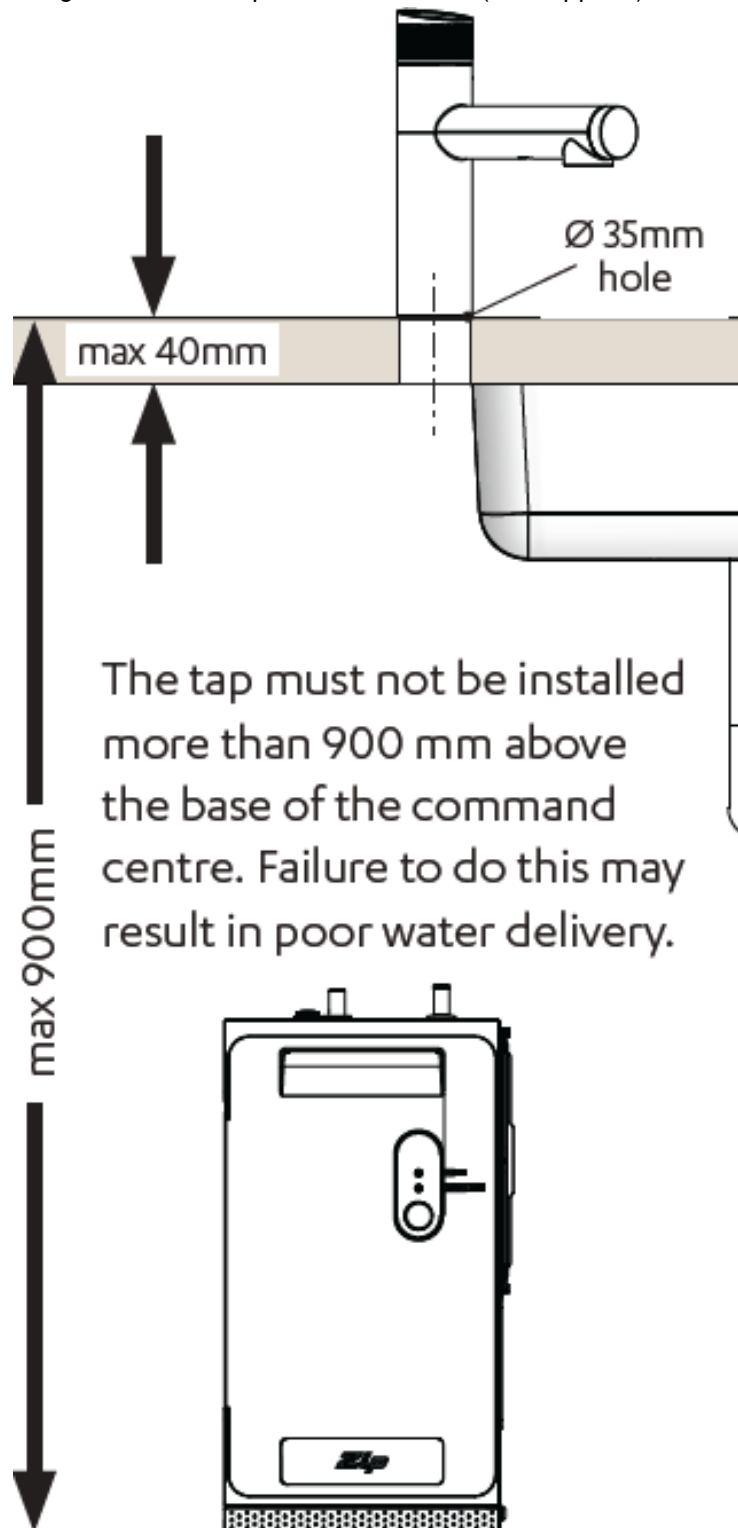



**2** View from below the tap.  
Connect the silicone hoses to the tap tubes.

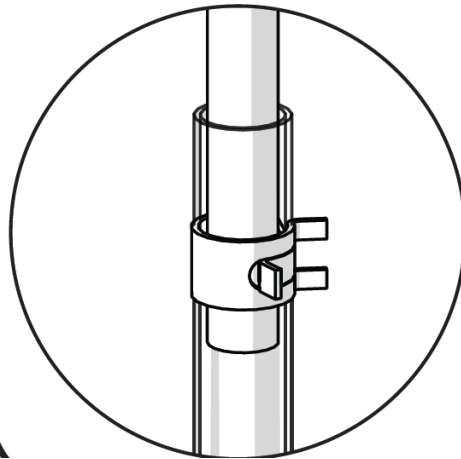
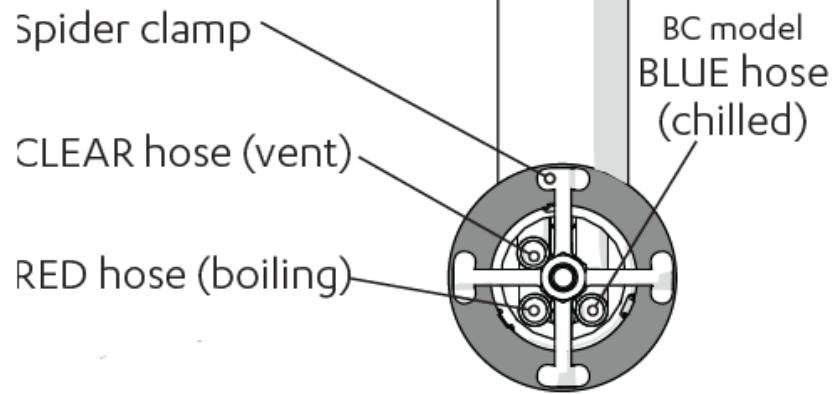

- Push the hose 20mm over the tube. Fasten with a hose clamp.

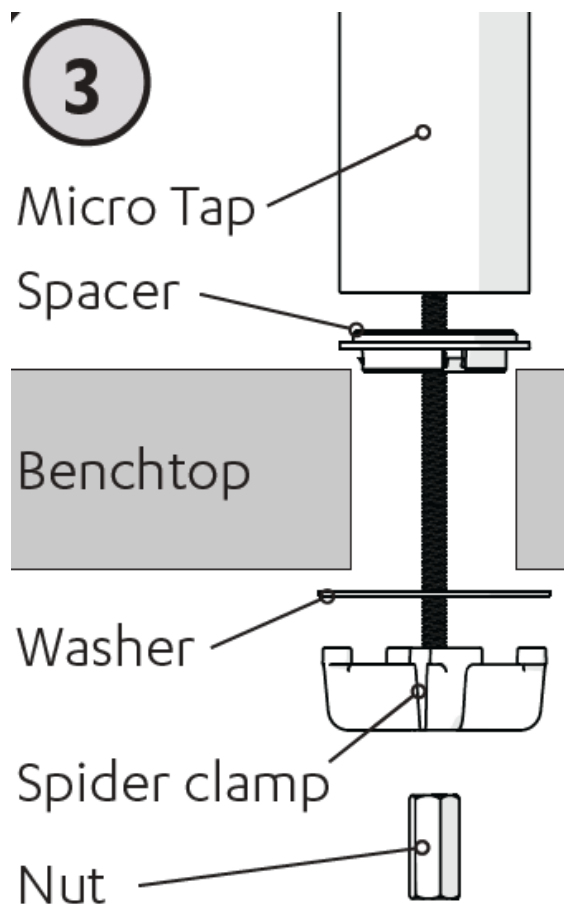

- From above the bench, pass hoses down through the hole. Push spacer on to the base of the tap. A light smear of silicone sealant under the spacer is recommended for a watertight fit. From below the bench, assemble washer, spider clamp and fastening nut. Check the tap is in the correct position before tightening the nut.

### Ventilation

#### IMPORTANT:

Allow a minimum clearance envelope of 50mm either side, and 200mm above the command centre. Proper air circulation must be provided for the system to operate correctly.

- Fit the silicone door buffers to the inside edge of the cupboard door to provide an air space. The top and front of the command centre must remain accessible for servicing.

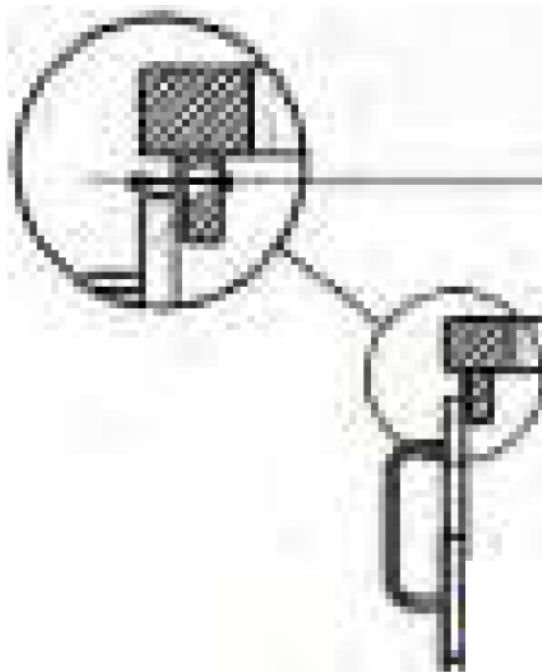

- (Boiling/Chilled models) Install the cupboard floor inlet vent (supplied) in the cupboard where the command centre is located. Refer to the instructions supplied with the vent kit.

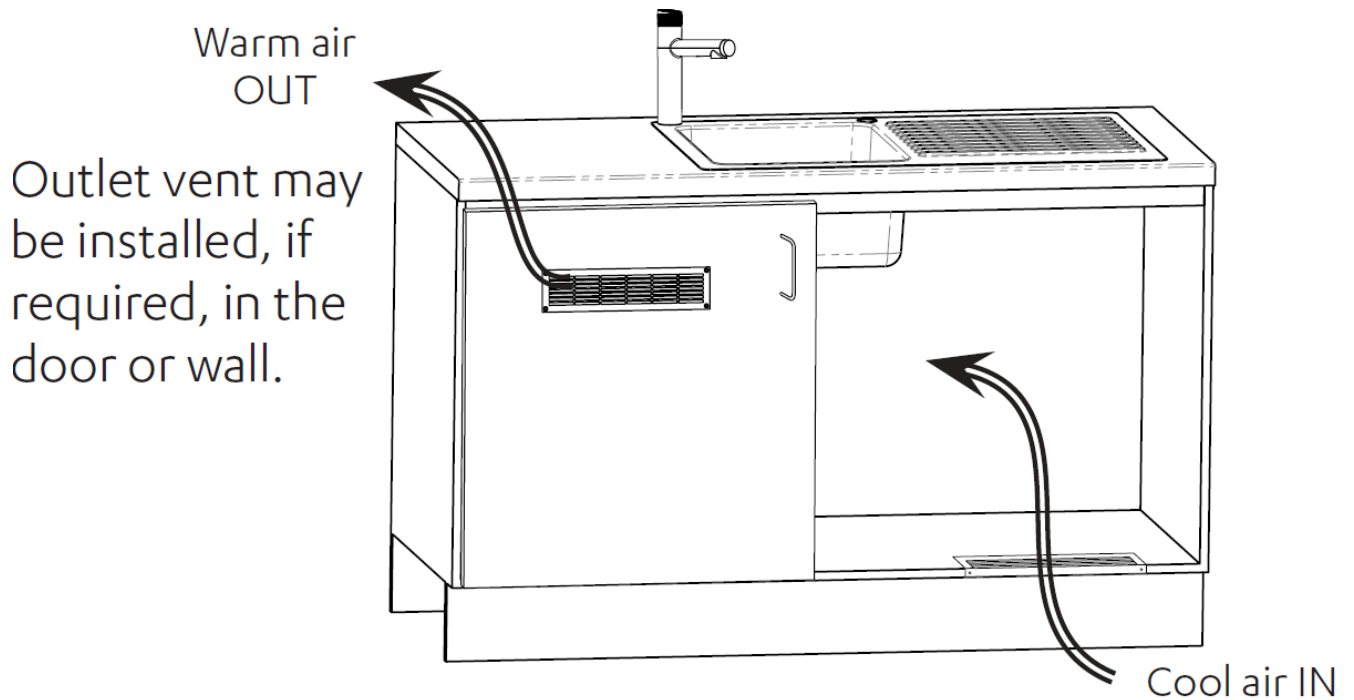

- If cupboard temperature rises above 35°C

The outlet vent may be installed in the door or wall. If additional ventilation is required, please contact your local service centre for more details.

**Command centre installation**  
**Installation diagram**

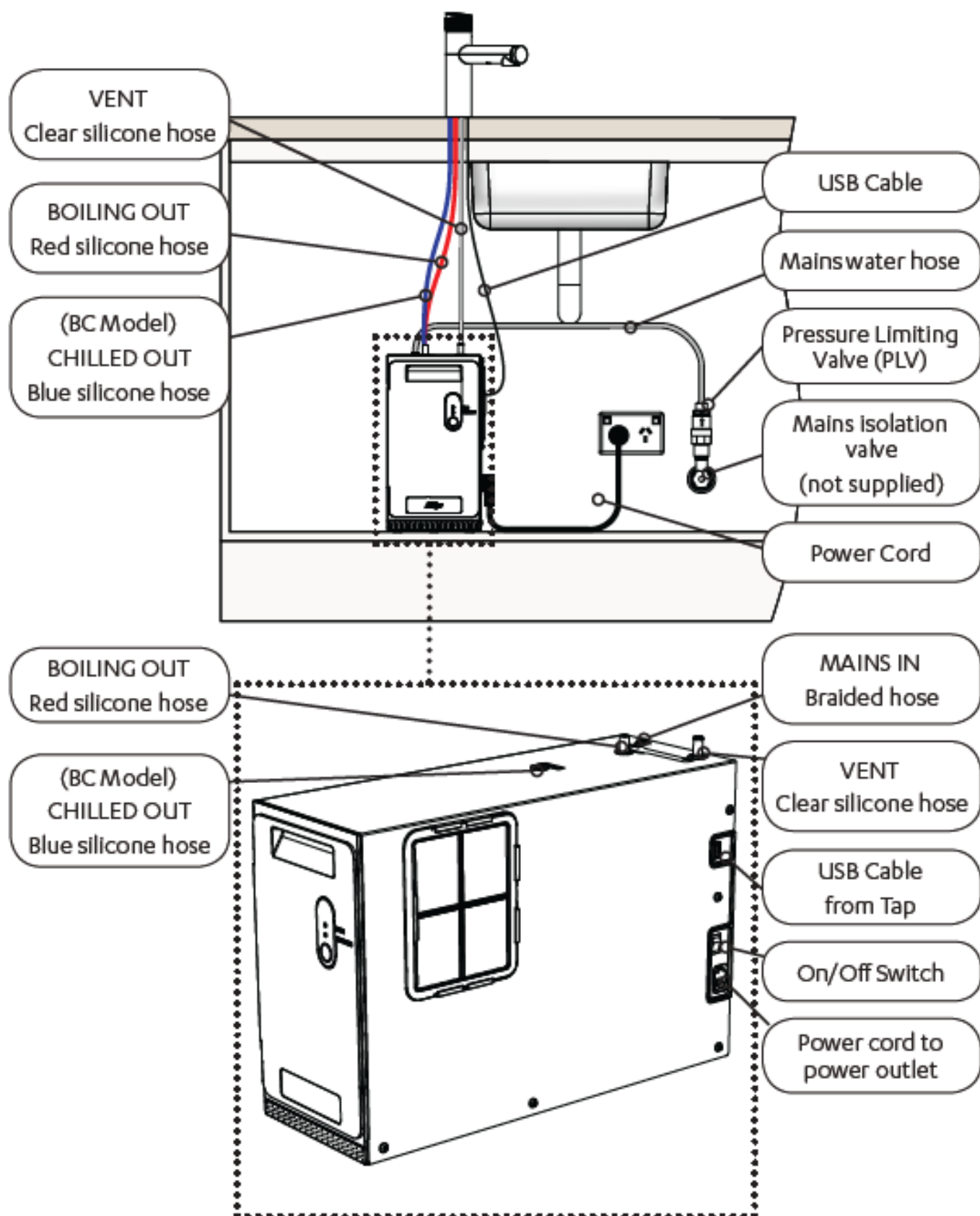

- 1** Connect electrical power cable to a 220-240V AC, 10A power outlet.

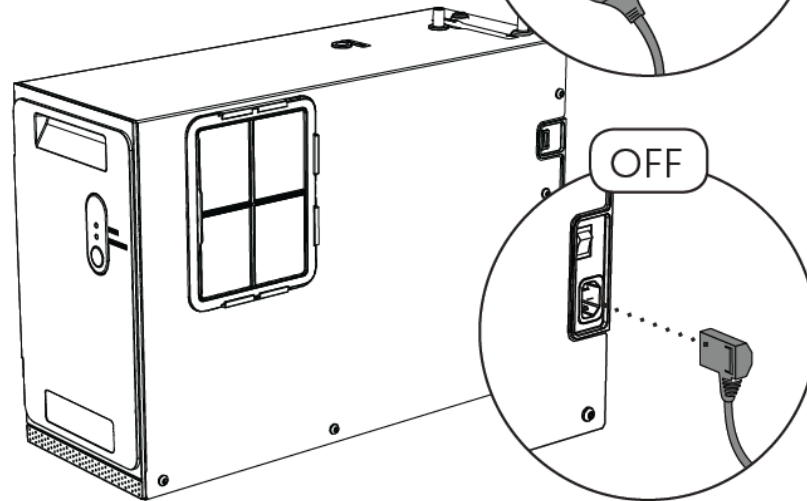

- Connect the USB cable from the tap to the command centre.

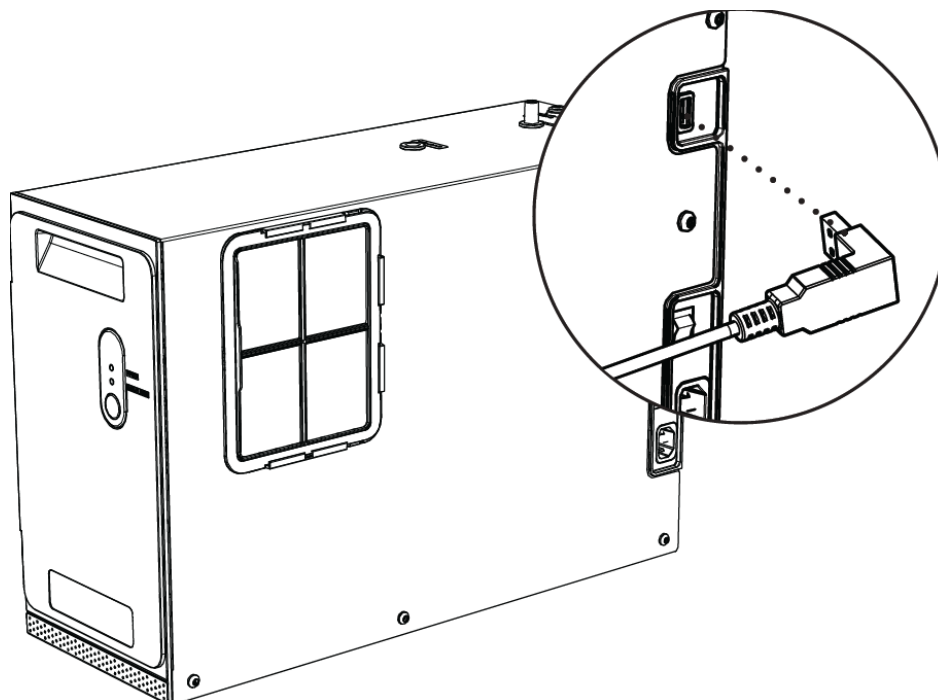

- The Hydro Tap Micro must be installed with an isolation valve (not supplied) to the mains water supply, for servicing. Use the new hose sets supplied. Do not re-use old hose sets. Flush all water supply lines before connecting, to prevent sediment from affecting operation.

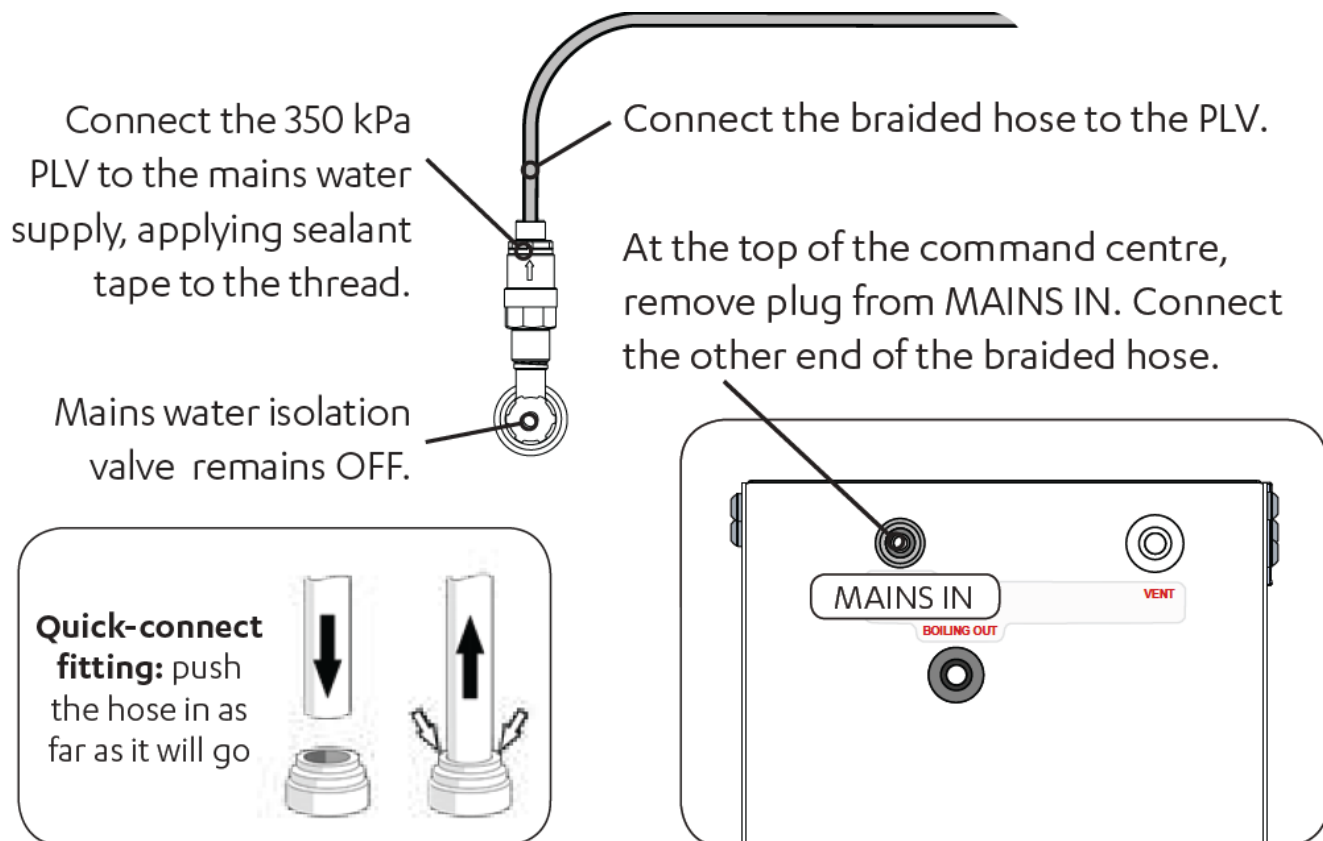

- Remove caps from the connectors at the top of the command centre. Connect the silicone hoses from the tap to the command centre. Refer to the installation layout diagram overleaf.

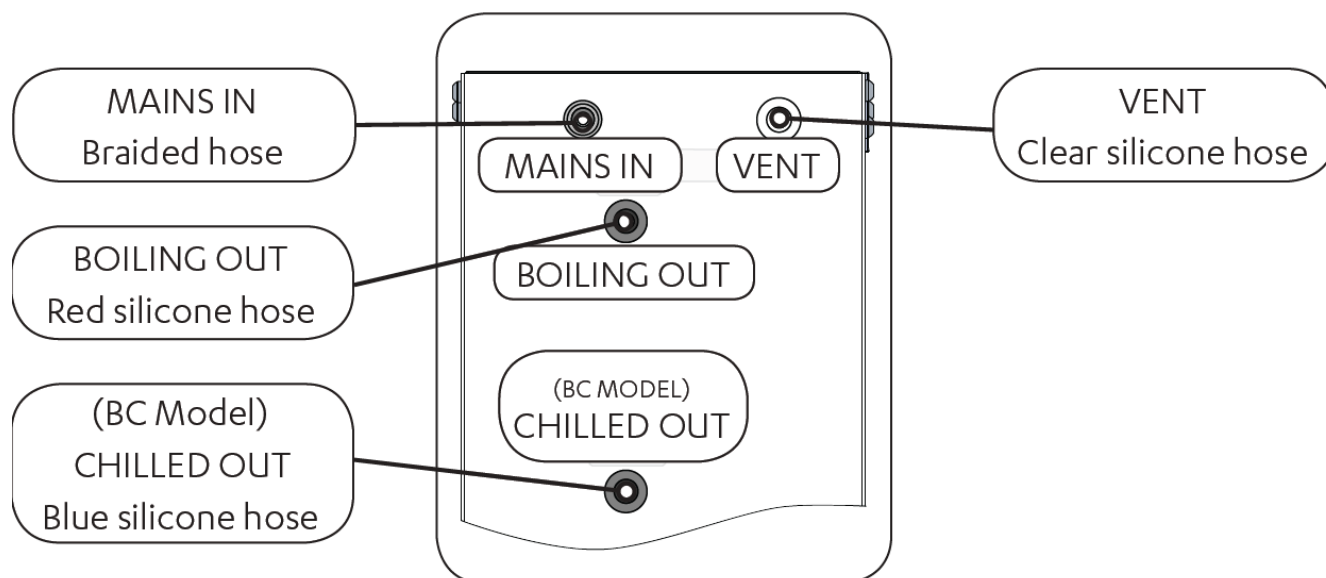

#### Tips for hose connection

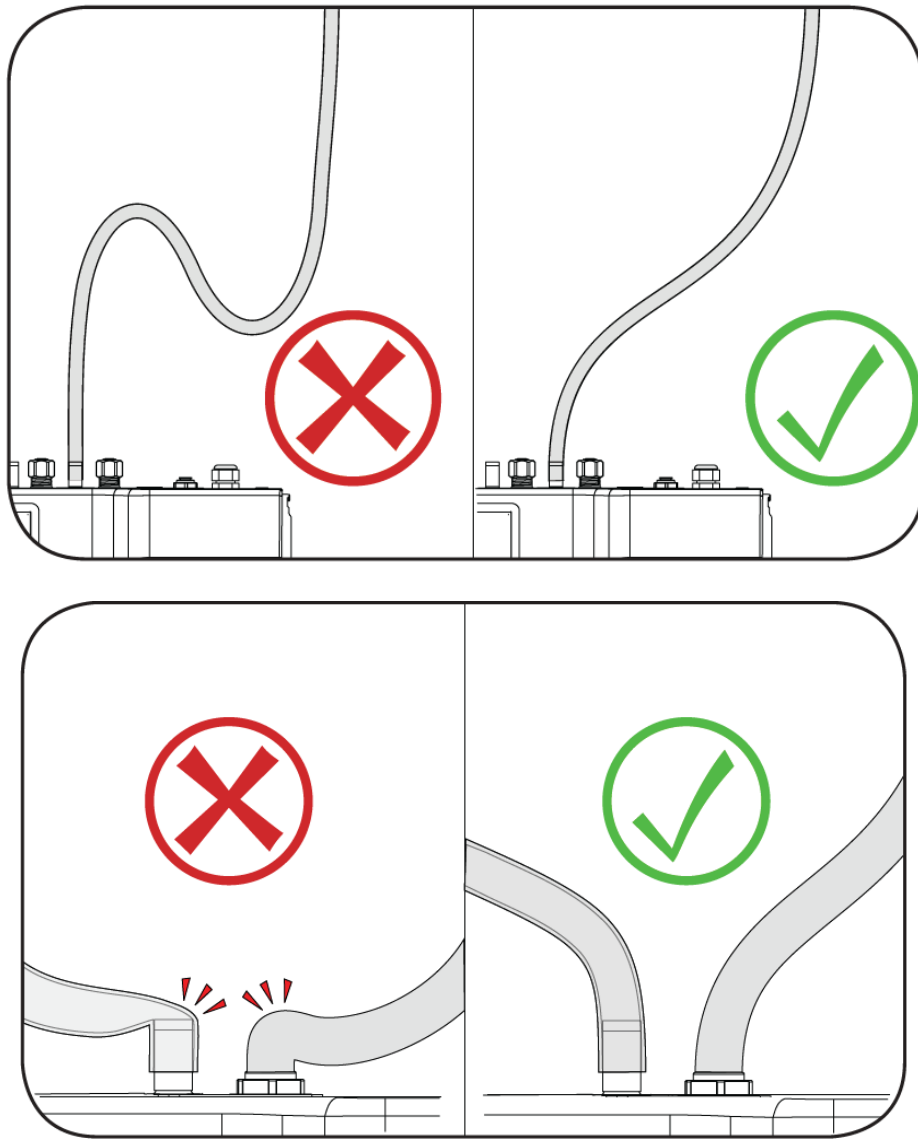

- Push the silicone hose over the connector for a minimum of 15mm.
- Ensure there is a constant fall from the tap down to the command centre.
- Hoses must be trimmed to avoid loops and kinks. Take care when positioning before cutting and make a clean cut straight across the hose, using a sharp blade.
- The hoses must not be under tension when installed.
- Hoses must not be lengthened beyond the maximum supplied 1- metre length.

## Commissioning

### Commissioning

- Turn water supply ON and check connections for leaks.

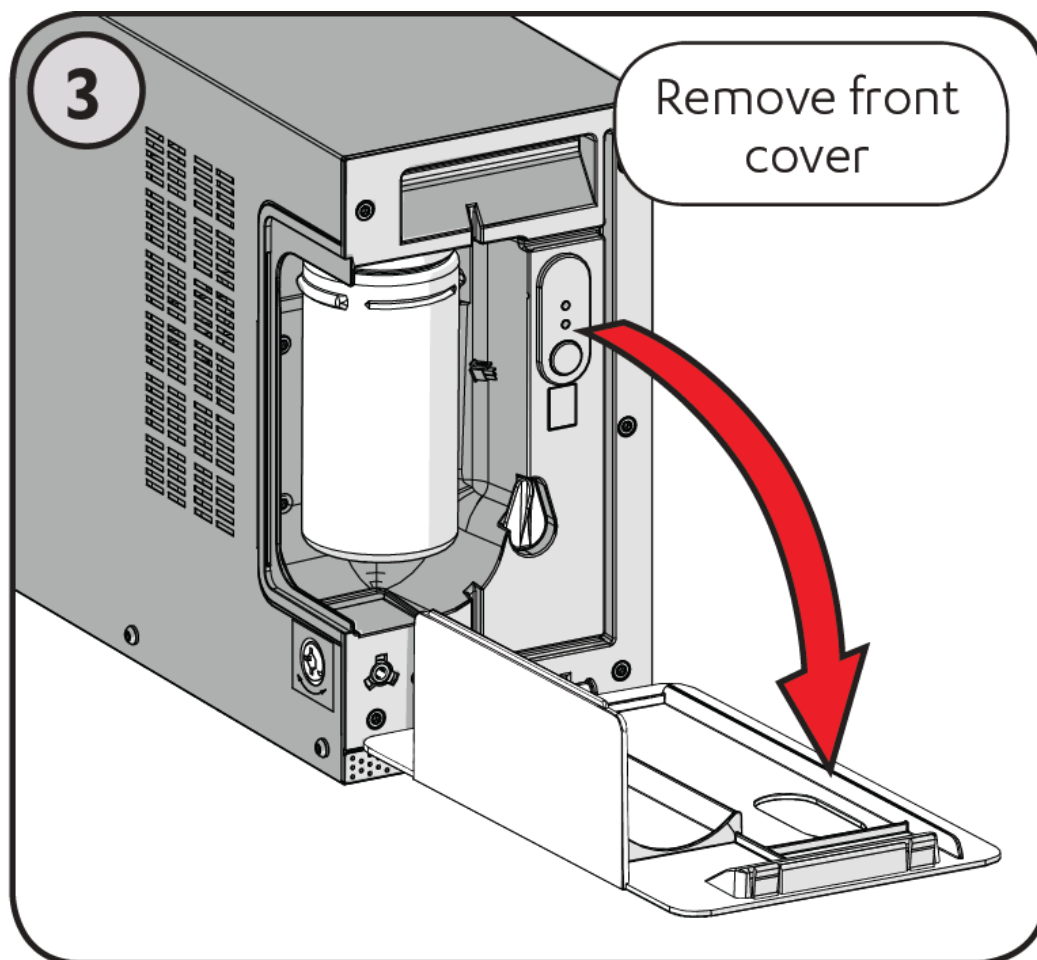
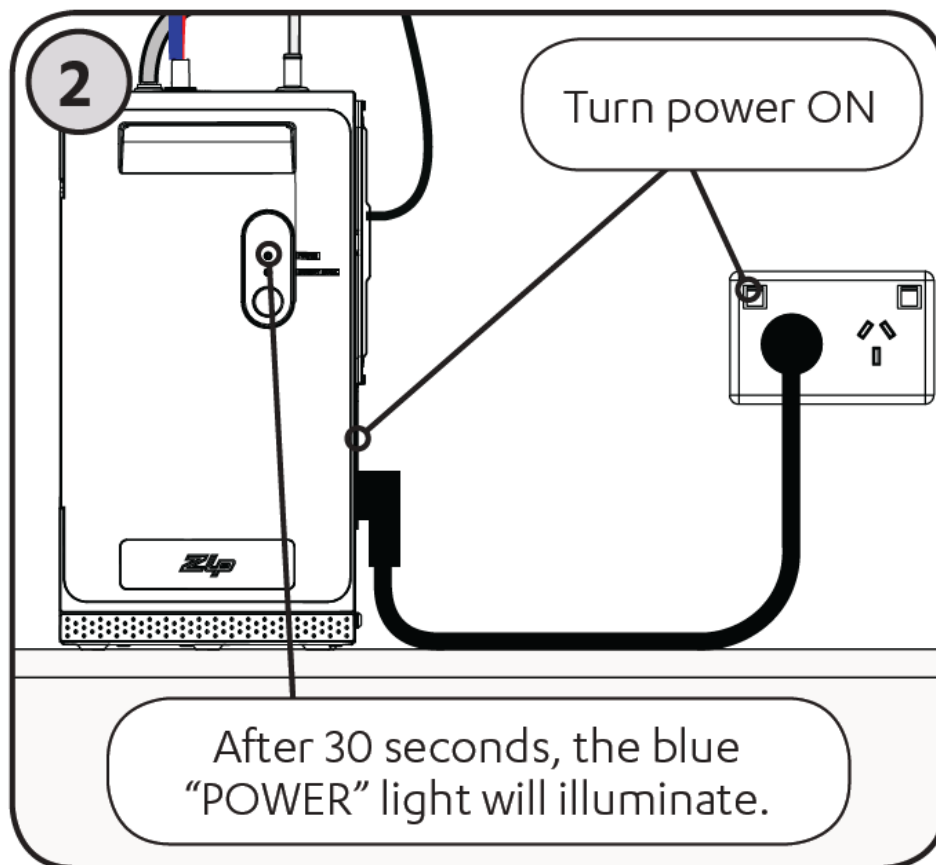



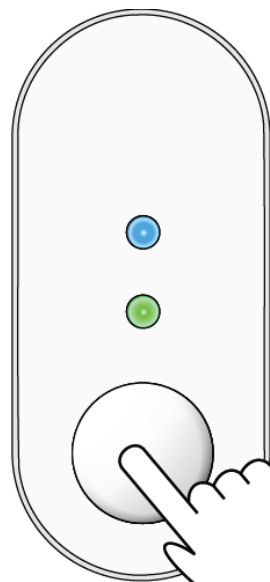

POWER

ENERGY MODE



If the LCD is not flashing the letter "F", press and hold the button for 30 seconds. When F flashes, release the button.

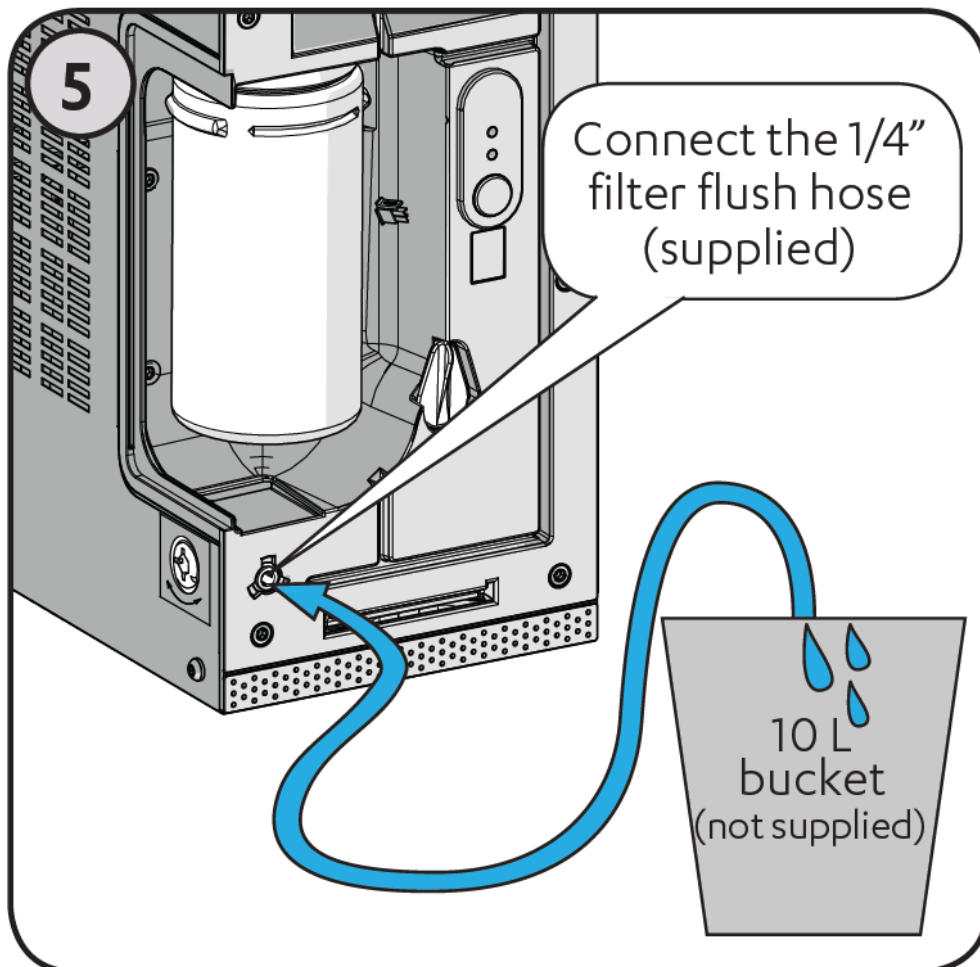

Connect the 1/4" filter flush hose (supplied)

10 L  
bucket  
(not supplied)

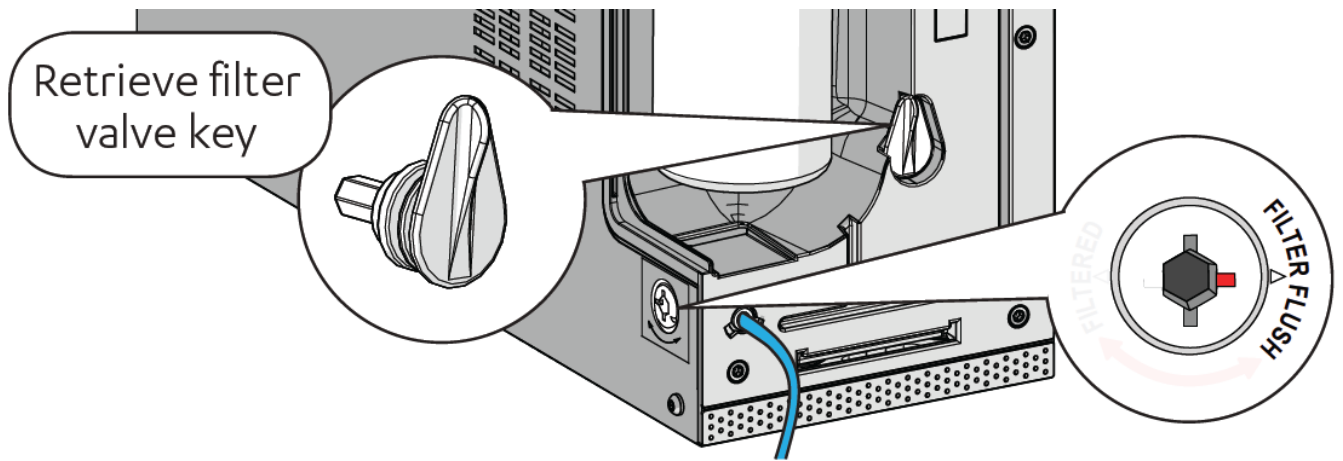

- turn filter valve key to FILTER FLUSH

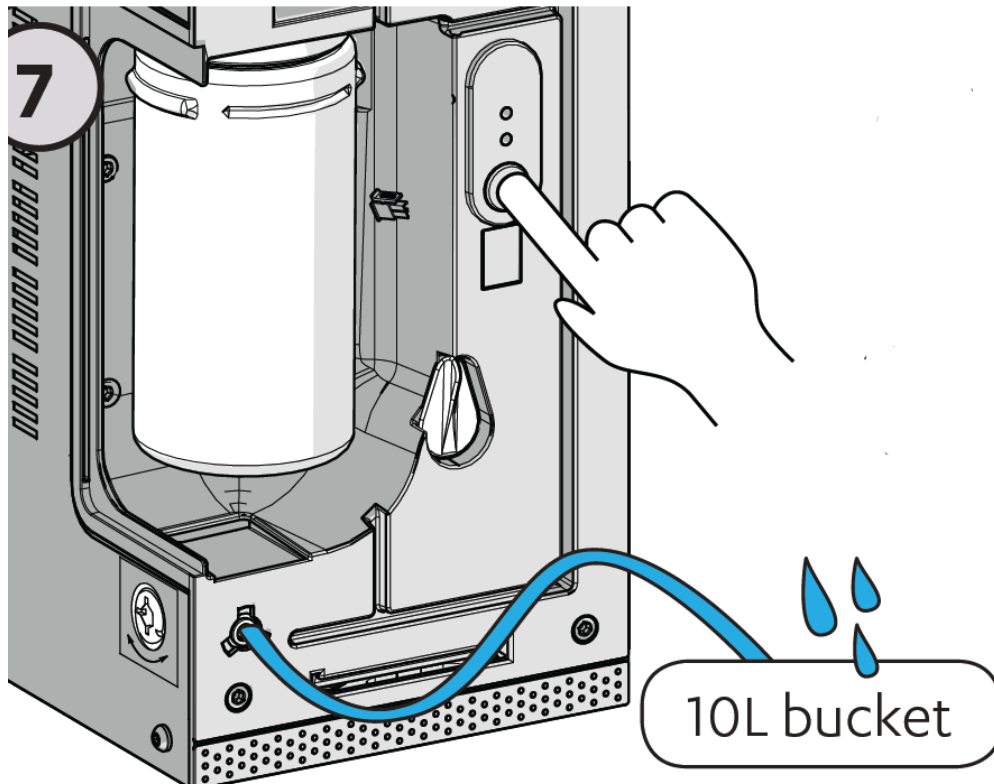

- While the LCD flashes "F", press and hold the button. Water will flow through the filter and out the hose. The "F" displayed will stay on. Continue holding the button. The button may be released to temporarily stop water flow. After 2 minutes (10 litres), water flow will stop. The LCD shows "P" and filter life will be reset to zero. Release the button.

8

Turn filter valve key  
to FILTERED

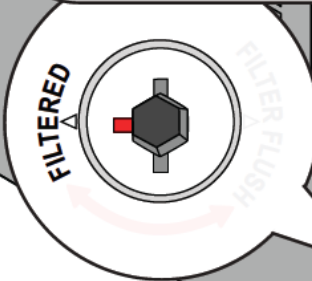

Return filter valve  
key to holder.



**WARNING:** Ensure flush valve  
is rotated to “FILTERED” before  
normal operation, to prevent  
unwanted water flow.

9

Remove the filter flush hose, dry it and return to storage.

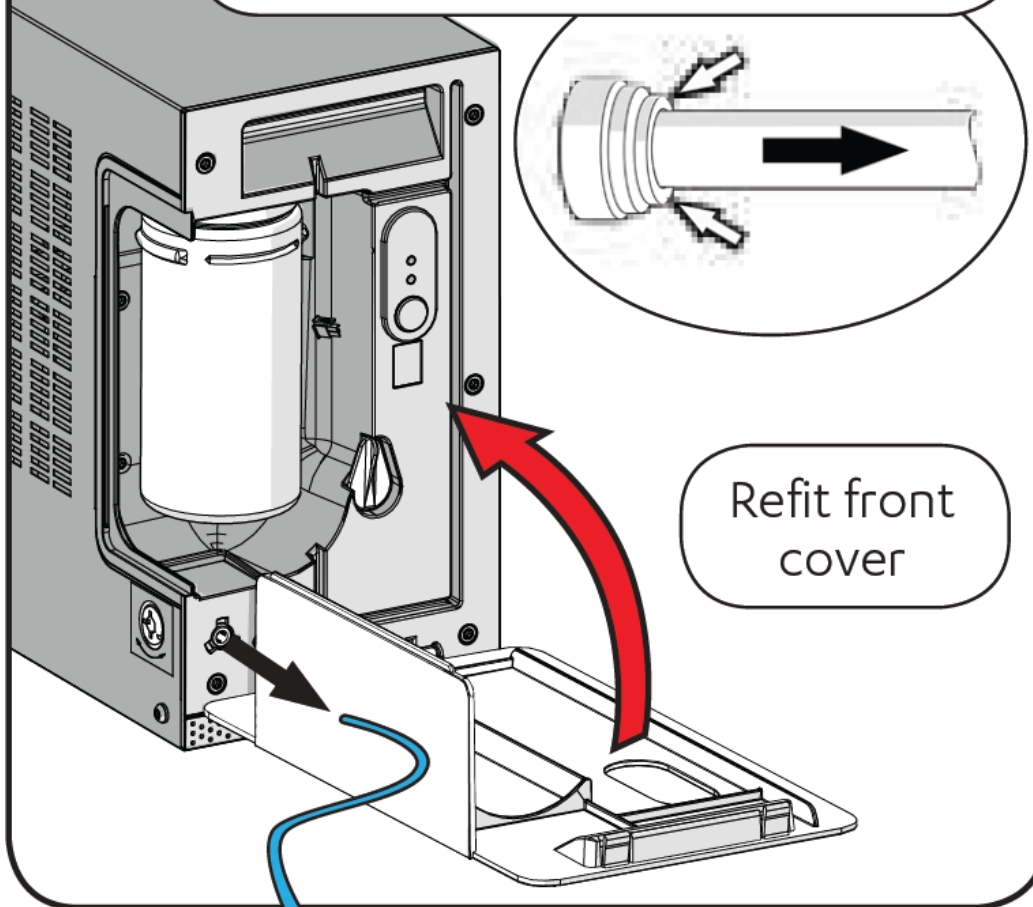

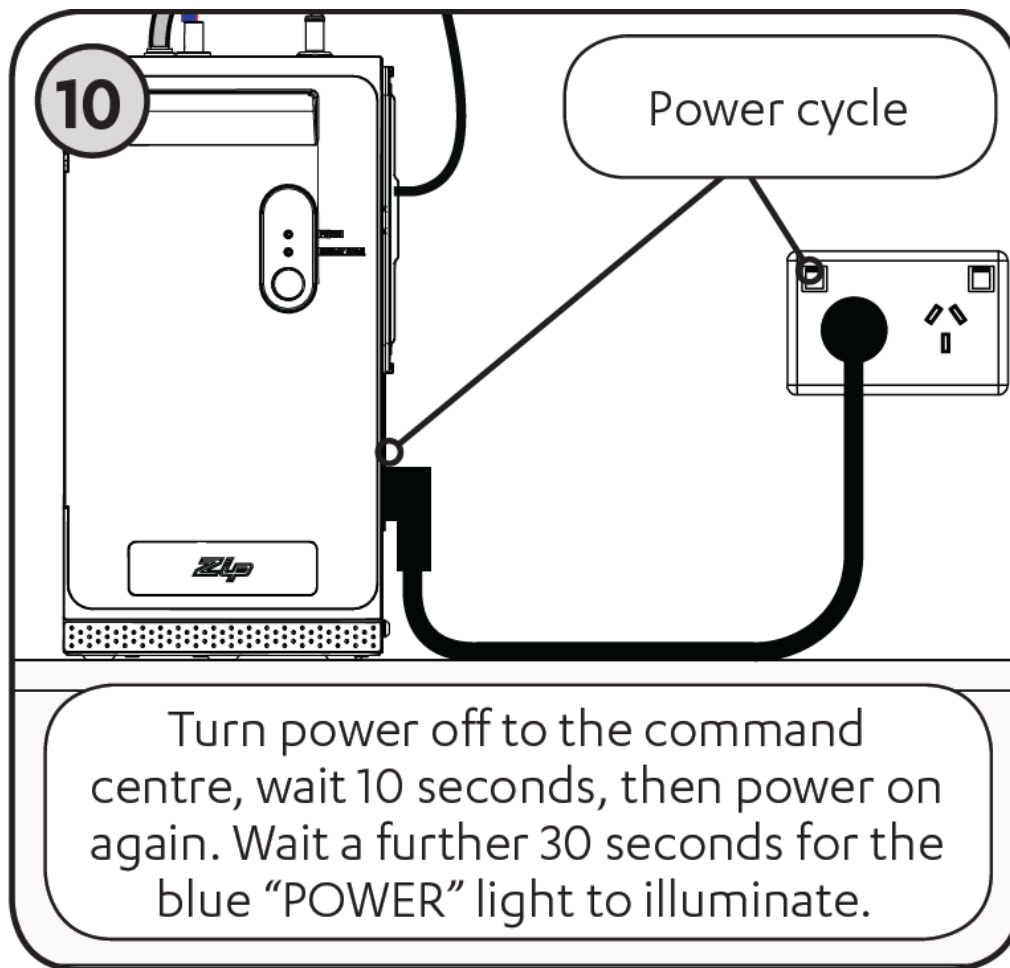

#### **Before first use:**

Check for leaks. Allow 5 minutes for tanks to fill. Flush with fresh water to remove any residue from factory sanitisation.

- (All models) Dispense 1.8 litres of boiling water from the tap, equivalent to a complete tankful of water. Repeat 3 times.
- (BC model) Dispense 1.8 litres of chilled water from the tap, equivalent to a complete tankful of water. Repeat 3 times.

## **Operation**

### **Tap operation**

#### **Boiling water**

Tap the red lock icon at the centre of the tap head, twice. The lock light turns off. Rotate and hold in the direction of the red arrow to dispense boiling water. The tap head springs back when released. You may continue to dispense boiling water while the red arrow flashes (10 seconds).

You may continue to dispense boiling water while the red arrow flashes (10 seconds).  
If the lock icon flashes, it has not been properly disabled. Try again.

### Boiling continuous flow

Tap the red lock icon twice. The lock light turns off.  
Rotate to the second stop; it remains in position.  
Boiling water flows for 10 seconds. Manually return the tap head to the neutral position.

### Service Light

For details, see Troubleshooting.

### Chilled water (Micro BC)

Rotate and hold in the direction of the blue arrow to dispense chilled water. The tap head springs back to the neutral position, when released.

### Chilled continuous flow

Rotate tap head to the second stop; it remains in position.

Chilled water flows for 10 seconds. Manually return the tap head to the neutral position.

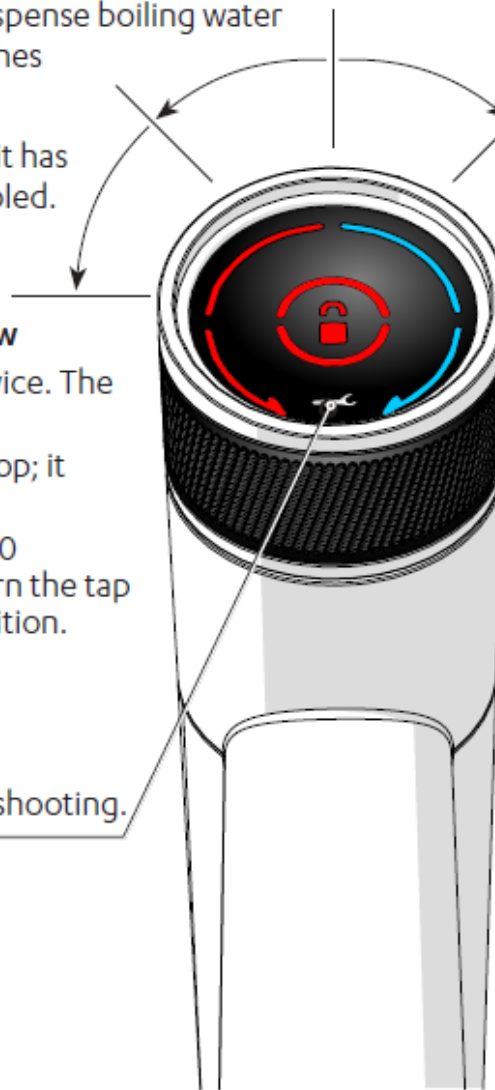

### Energy mode

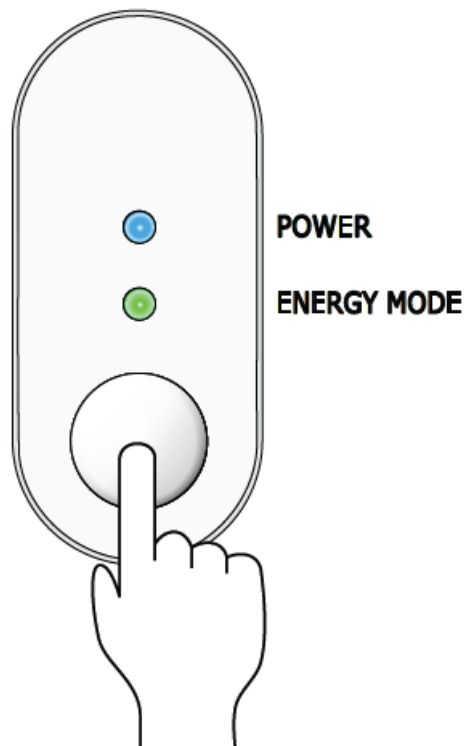

To enable/disable energy mode, press the button on the front of the command centre. The green light will illuminate when energy mode is enabled. When energy mode is enabled, after 2 hours of inactivity, the boiling tank set point temperature is reduced to 68°C, to conserve energy. If the tap is operated to dispense boiling water, the boiling set point temperature is restored to 98°C. Allow time for the water to return to the set point temperature.

## Maintenance

### Water filter



The Micro water filter has a 6 month usage capacity. The filter cartridge may require changing earlier depending on water quality, usage, or if you notice unpleasant odours or tastes. The Service icon on the tap will illuminate and "C F" will flash on the command centre LCD, to indicate a filter change is due. Failure to change the filter may adversely affect water quality or supply to the tanks.

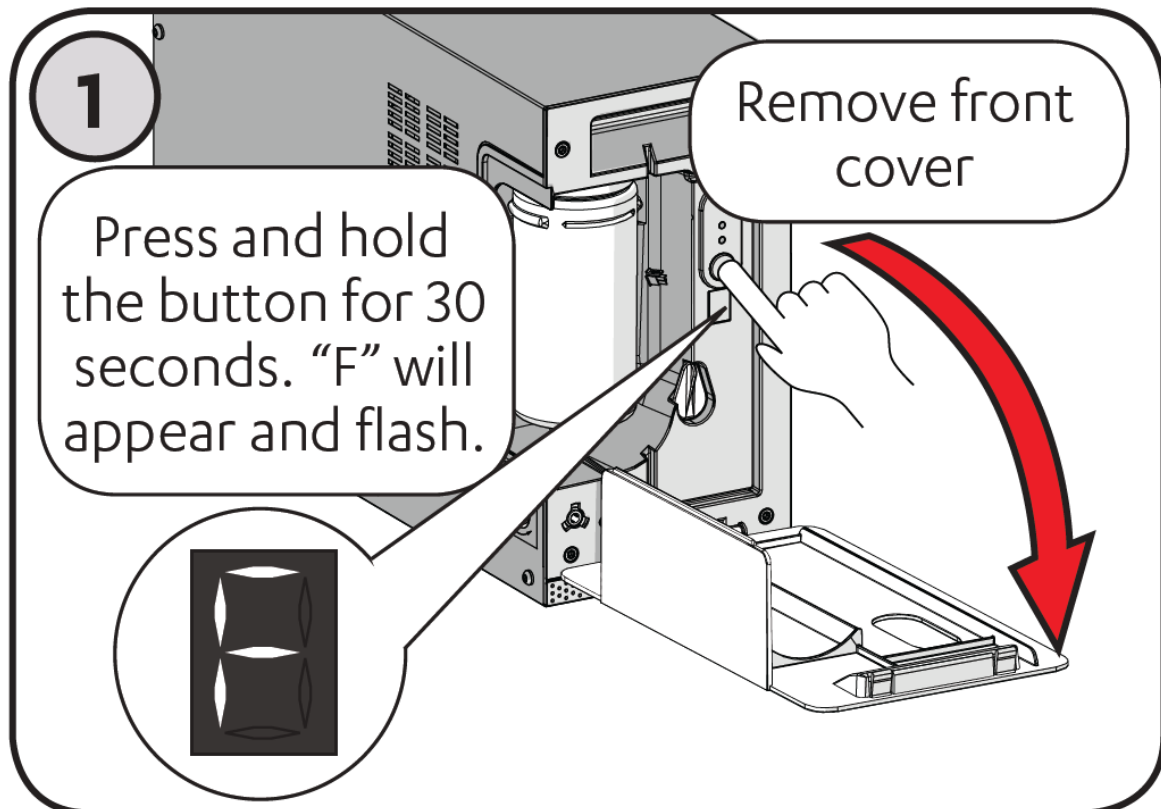



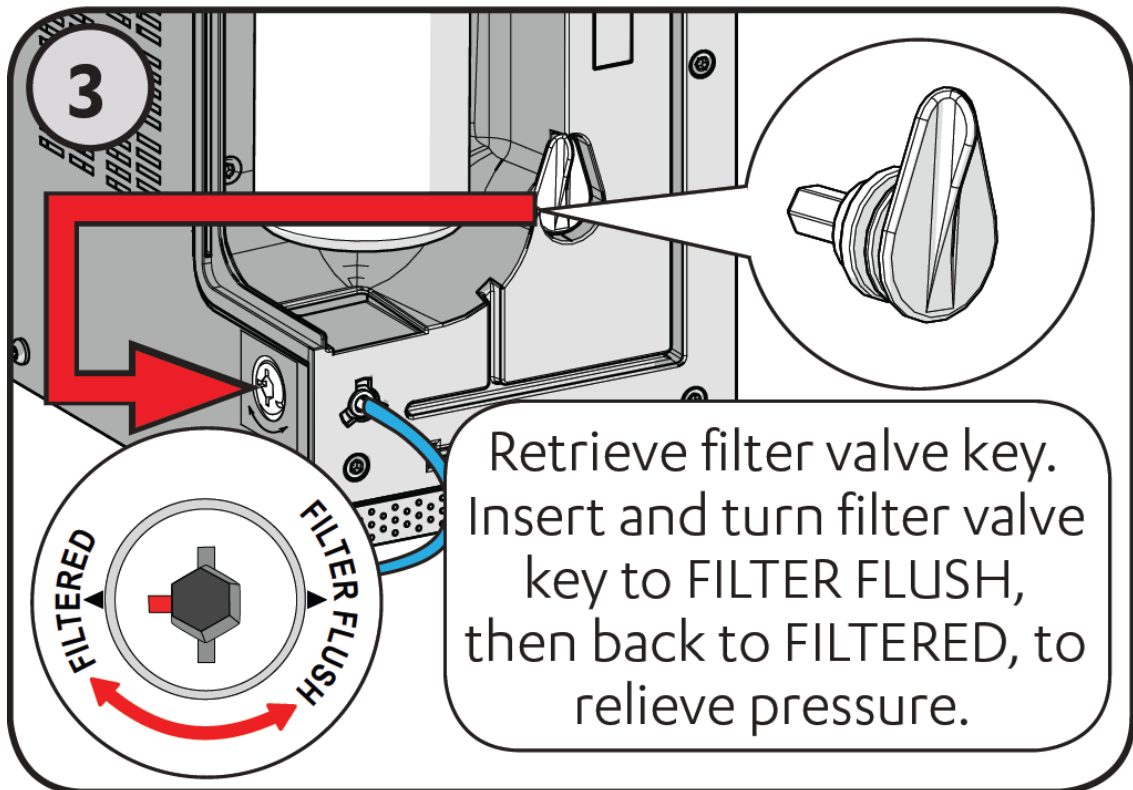
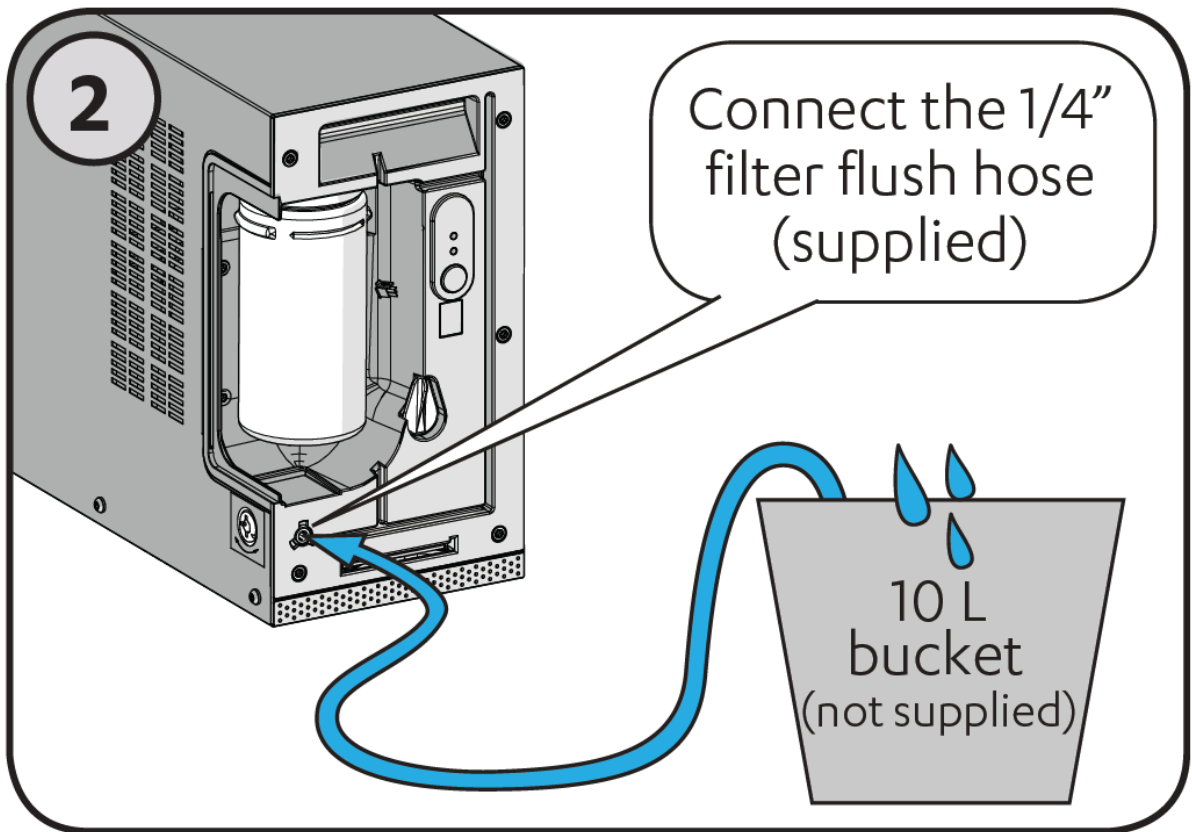



4

Remove old filter cartridge

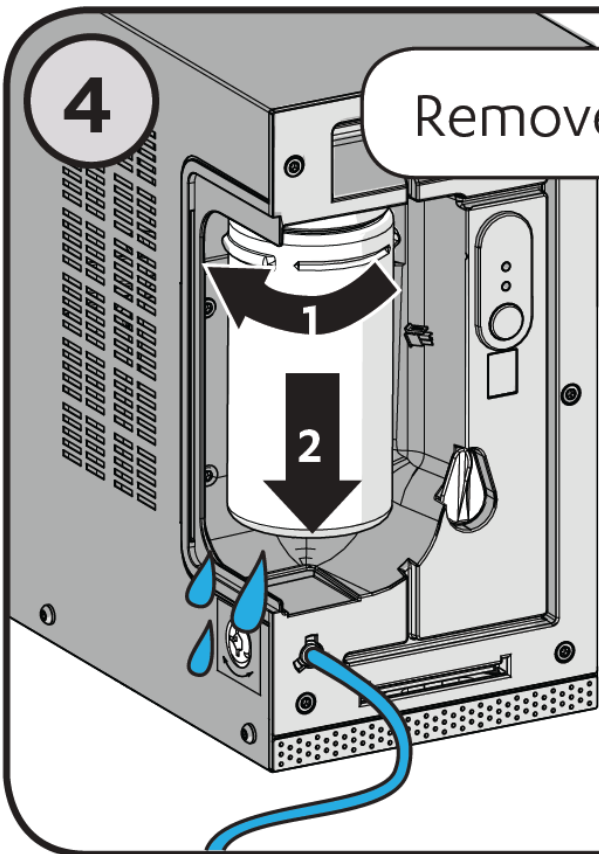

Dispose of the used cartridge and packaging thoughtfully

5

Unpack new filter cartridge. Moisten the top O-ring with tap water. Do not touch!

Write today's date on the label.

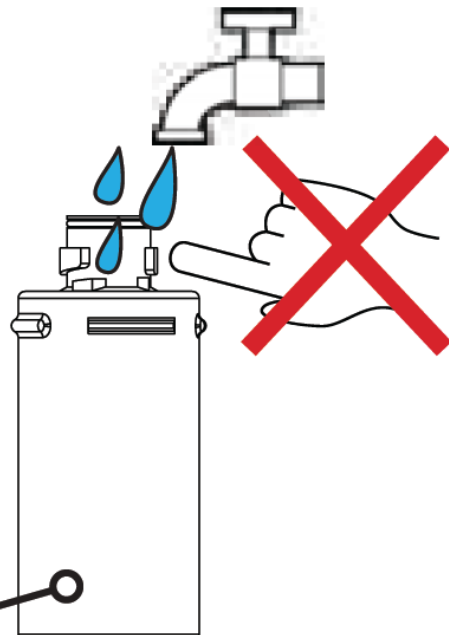

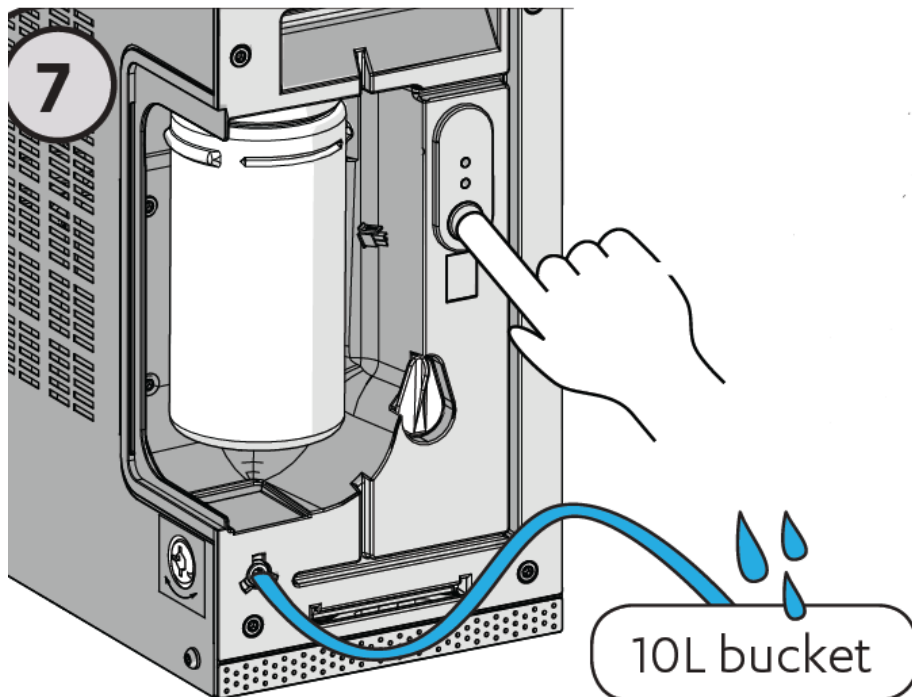
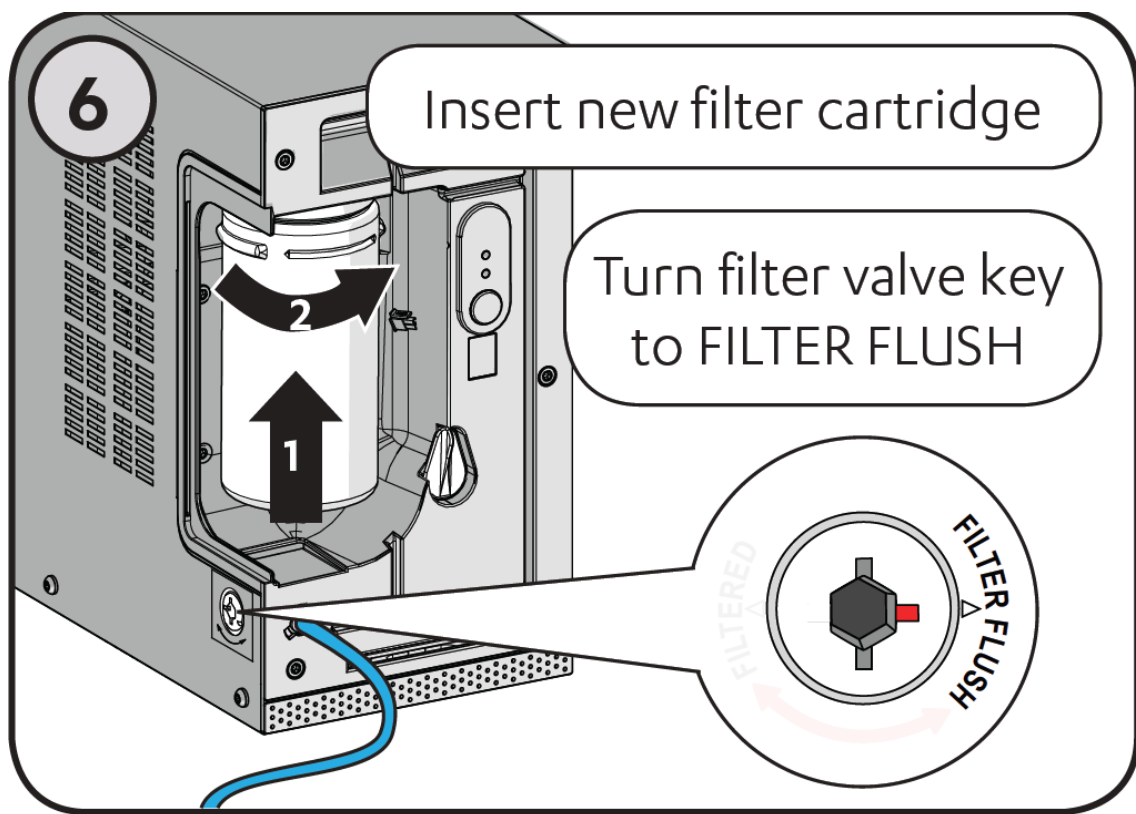

While the LCD flashes “F”, press and hold the button. Water will flow through the filter and out the hose. The “F” displayed will stay on. Continue holding the button. The button may be released to temporarily stop water flow. After 2 minutes (10 litres), water flow will stop. The LCD shows “P” and filter life will be reset to zero. Release the button.

8

Turn filter valve key  
to FILTERED

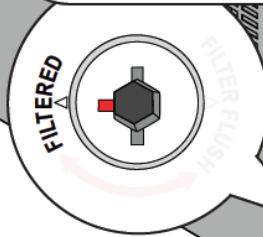

Return filter valve  
key to holder.

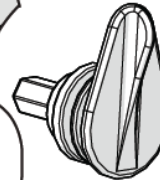

**WARNING: Ensure flush valve  
is rotated to “FILTERED” before  
normal operation, to prevent  
unwanted water flow.**

9

Remove the filter flush hose, dry  
it and return to storage.

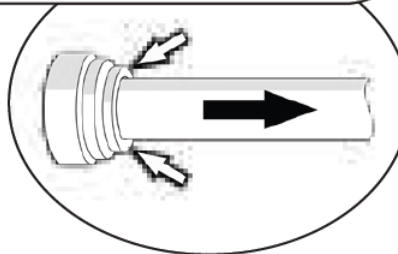

Refit front  
cover

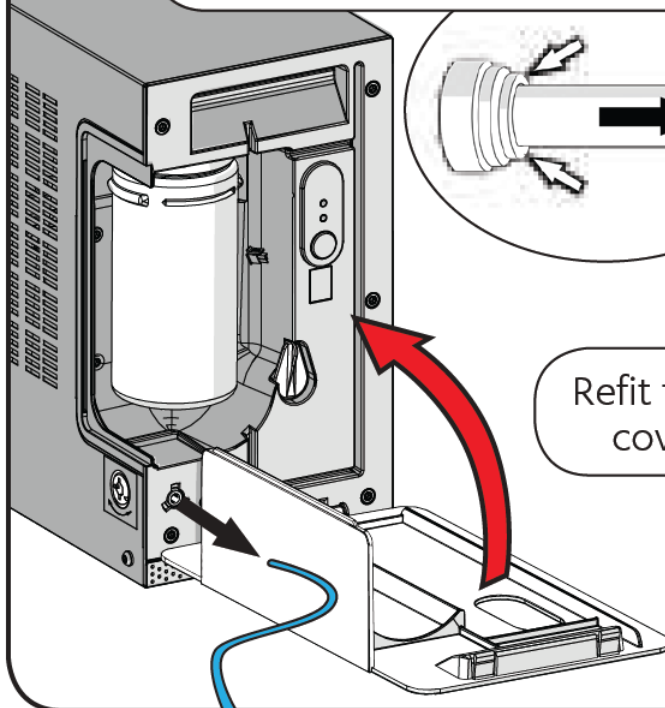

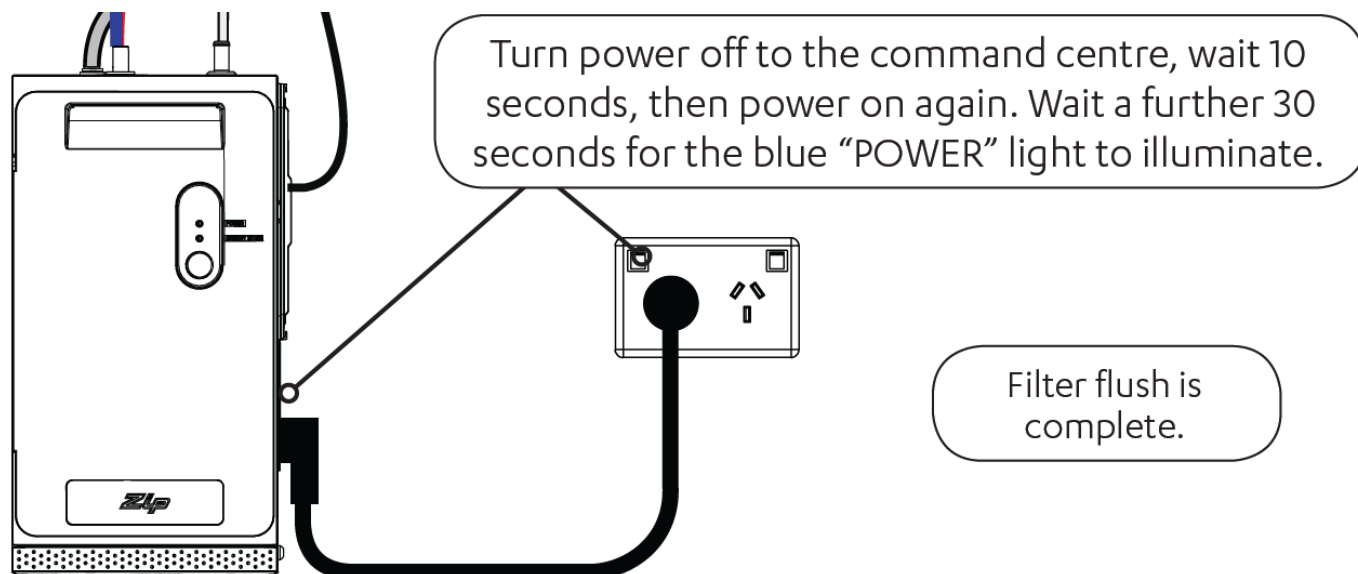

#### **Air inlet filter (Boiling/Chilled model)**

The air inlet filter screen should be inspected at least every three months, cleaned and replaced if damaged.

- Slide to remove the air inlet filter screen

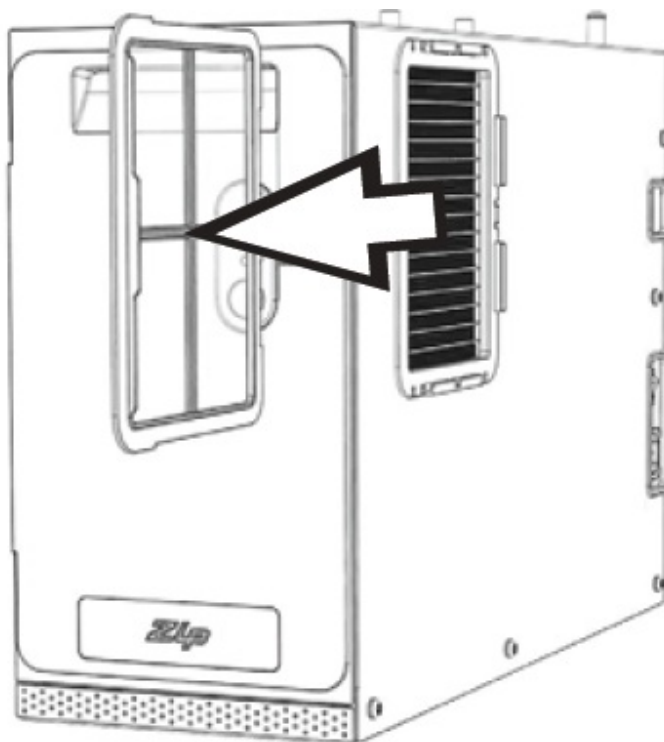

- Rinse off with tap water. Gently dry with cloth/towel.

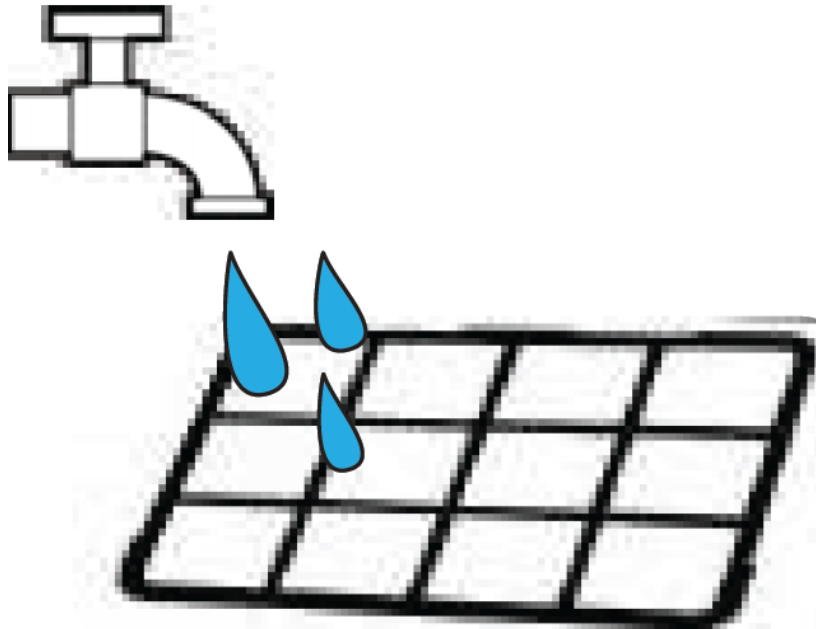

- Re-fit the air inlet filter screen

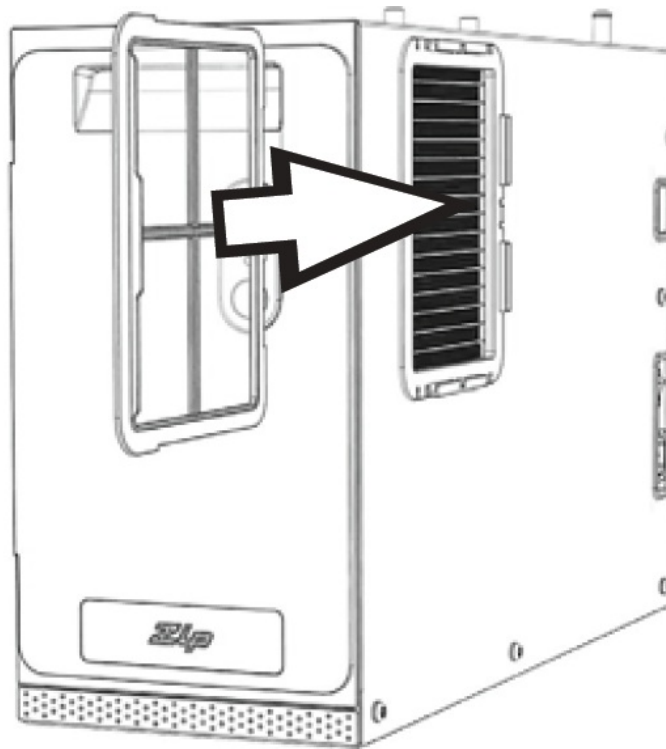

**Note:**

For best performance the unit should only be operated with a clean air inlet filter screen, correctly fitted in place. Maintain at least a 50mm air gap in front of the screen at all times. Take care not to allow cloths or other soft materials to accidentally block the air inlet.

**Warning:**

If the Micro is inactive for longer than 2-3 days, run the 15-second continuous flow at least four times before consumption.

## Troubleshooting

In the event of a fault, or if the service icon on the tap head illuminates, remove the front cover of the command centre and check if a code is shown on the display. Error codes consist of the letter E, followed by 2 digits, displaying in sequence repeatedly. Call an electrician, a plumber, or Zip free call in Australia on 1800 638 633 for assistance, service, spare parts or enquiries.

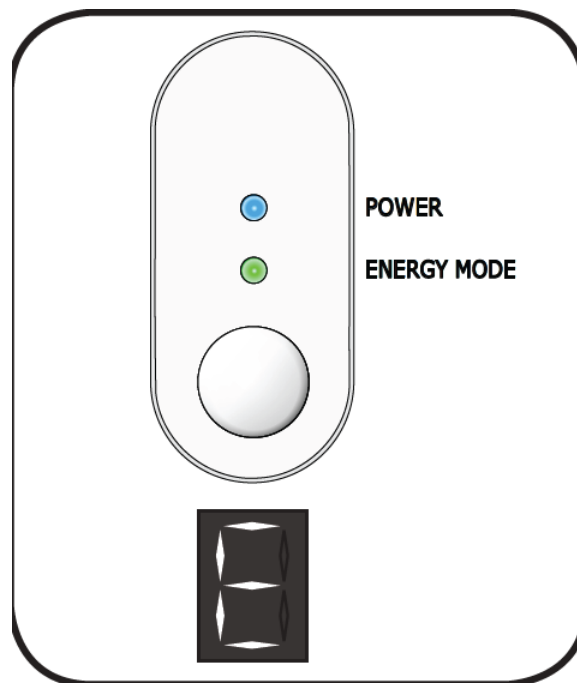
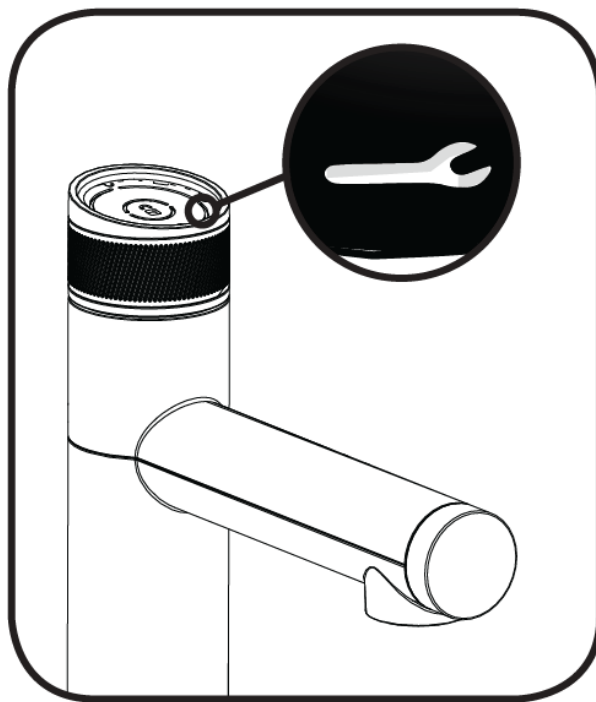

Code		Possible cause	Solution
CF		Filter life has exceeded 6 months	Change water filter and perform filter flush.
F		Filter flush mode enabled.	Complete the filter flush. Refer to Step 4.2-9.
P		Power cycle required after completing filter flush.	Turn power off and on again.
C		Calibration. Internal process to set hot temperature point.	No action required.
E01, E02	Boiling sensor fault	Water is not heated.	Contact Zip service.
E03, E04	Chilled sensor fault	Water is not chilled.	Contact Zip service.
E05, E06	Steam sensor fault	Water is not heated.	Contact Zip service.
E07, E08	Condenser fault	Water is not chilled.	Contact Zip service.
E09	Flood detected	Water detected in the unit due to tank overfill or internal/external leakage. All functions will turn off.	Disconnect power, check for external water leaks into the unit, resume power. If fault persists, contact Zip service.
E10	Boiling tank overfill	Water filled in the boiling tank beyond the allowed level.	Power cycle the unit. If fault persists, contact Zip service.
E11	Chilled tank overfill	Water filled in the chilled tank beyond the allowed level.	Power cycle the unit. If fault persists, contact Zip service.

Code		Possible cause	Solution
E12	Condenser overheat	Temperature of condenser has exceeded 60°C. Water does not chill.	Check adequate ventilation as per the installation instructions. Check fan vent is clean and unobstructed.
E13	Communication loss	Command centre does not detect a tap connected. Water will not dispense from tap.	Ensure tap connector is correctly inserted into the side of the command centre. If issue persists, contact Zip service
E14, E15	Compressor overrun	Compressor running continuously for 30 minutes, and chilled tank is full. Compressor did not turn off and water temperature is 2°C or lower.	Check adequate ventilation. Check chilled water is not dispensed beyond rated use. If issue persists, contact Zip service

<b>E16</b>	<b>Water supply fault</b>	<b>Hot or cold tanks not filling. Heating/cooling also stops.</b>	<b>Check if mains water supply is turned ON, with adequate flow of water. Check if filter is blocked and replace filter cartridge if necessary.</b>
<b>E17, E18, E19</b>	<b>Element Fault</b>	<b>Water is not heated or all functions disabled.</b>	<b>Contact Zip service</b>
<b>E20, E21, E22</b>	<b>Compressor Fault</b>	<b>Water is not chilled or all functions disabled.</b>	<b>Contact Zip service</b>
<b>E23, E24, E25</b>	<b>Safety Solenoid fault</b>	<b>No water in boiling or chilling tanks. Water is not boiled or chilled. All functions may be disabled.</b>	<b>Contact Zip service</b>
<b>E26, E27, E28</b>	<b>Boiling Solenoid Fault</b>	<b>No water in boiling tank. Water is not heated. All functions may be disabled.</b>	<b>Contact Zip service</b>
<b>E29, E30, E31</b>	<b>Chilled Solenoid Fault</b>	<b>No water in chilling tank. Water is not chilled. All functions may be disabled.</b>	<b>Contact Zip service</b>
<b>E32, E33, E34</b>	<b>Fan Driver Fault</b>	<b>Water is not chilled. Fan may not operate.</b>	<b>Contact Zip service</b>

## Cleaning

Do not use strong, corrosive or abrasive cleaning materials. Stainless steel surfaces will show scratches if an abrasive cleaning product is used. Wipe clean the outer surfaces with a damp sponge or soft cloth.

## End of life disposal

In order to help preserve our environment we ask that you dispose of this product correctly. Please contact your local city council for collection centre details.

## Documents / Resources

 <p>Zip Micro Instant Boiling and Chilled Water</p> <p>Models: Micro B Instant Boiling, Micro B Instant Chilled Water</p> <p>AFTER PRODUCT LABEL HERE</p>	<p><a href="#">Zip Micro B Instant Boiling and Chilled Water</a> [pdf] User Manual</p> <p>Micro BC, Micro B, Instant Boiling and Chilled Water, Micro B Instant Boiling and Chilled Water</p>
--	---