

zimi Powermesh Double Power Point Instruction Manual

[Home](#) » [Zimi](#) » zimi Powermesh Double Power Point Instruction Manual 



Let's get connected.
Double PowerPoint.



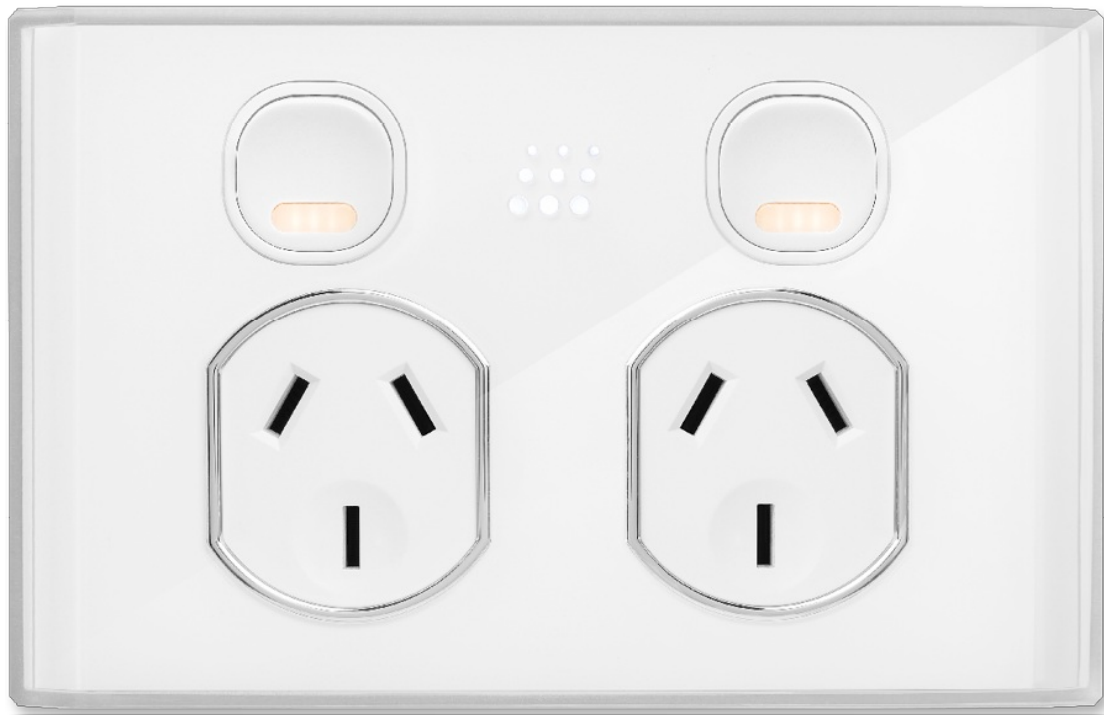

Contents

- [1 Important – Read before installing.](#)
- [2 Using the Power Point.](#)
- [3 Connect the wiring.](#)
- [4 Pair and setup with Zimi.](#)
- [5 Zimi Cloud Connect.](#)
- [6 Want to learn more or need help?](#)
- [7 Powermesh Status Indicator.](#)
- [8 Documents / Resources](#)
 - [8.1 References](#)
- [9 Related Posts](#)

Important – Read before installing.



Must only be installed by a LICENSED ELECTRICIAN to local wiring regulations.



Failure to follow these instructions can result in serious injury or death.

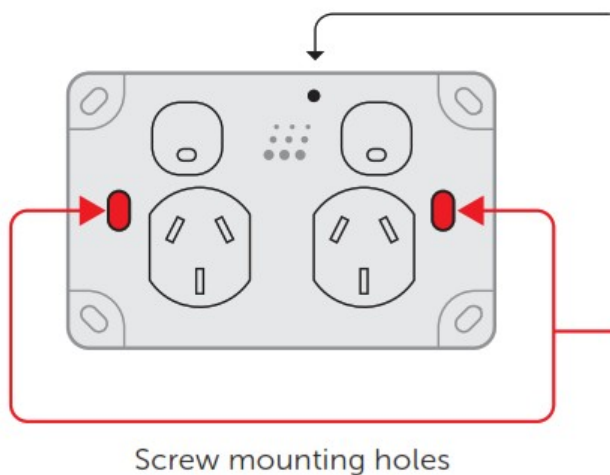

Factory Reset

Remove the cover and press the RESET button until the Powermesh indicator flashes blue. Release the button and when the indicator turns blue, it's ready to pair.

AVOID THE RISK OF ELECTRIC SHOCK

Once the product has been fastened to the wall, ensure the supplied screw caps are inserted firmly into the screw mounting holes.

Using the Power Point.

Powermesh Status Indicator

See overleaf for the meaning of each colour status.

Power Switch

Single press on / off with indicator.

Power Socket

Each socket can be controlled independently.

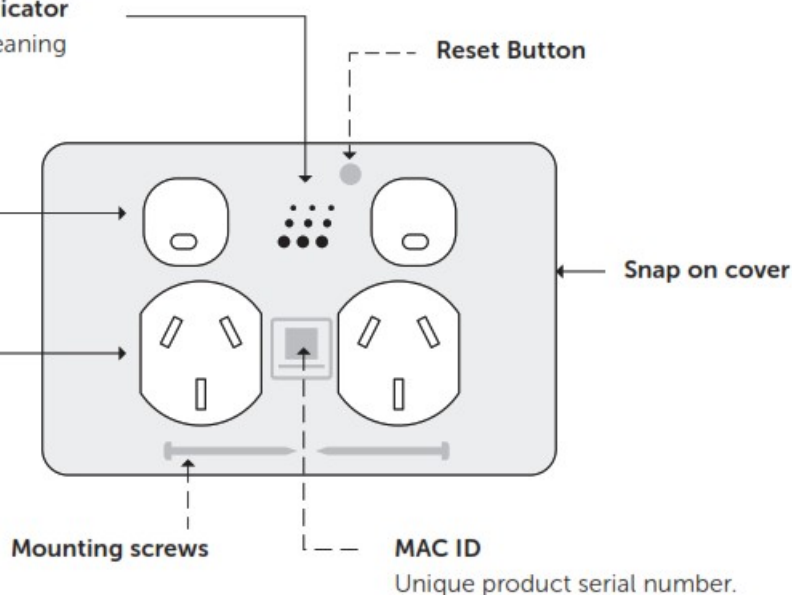

Connect the wiring.



Surge protection is recommended at the main switchboard. Products damaged by power surges are not covered by warranty.

Specifications

Part Number: **PMPP / PMPPBK**

Line Voltage **Frequency: 50Hz Nominal**

Rated Load: **Maximum Load 10A @ 250V / 2500W**

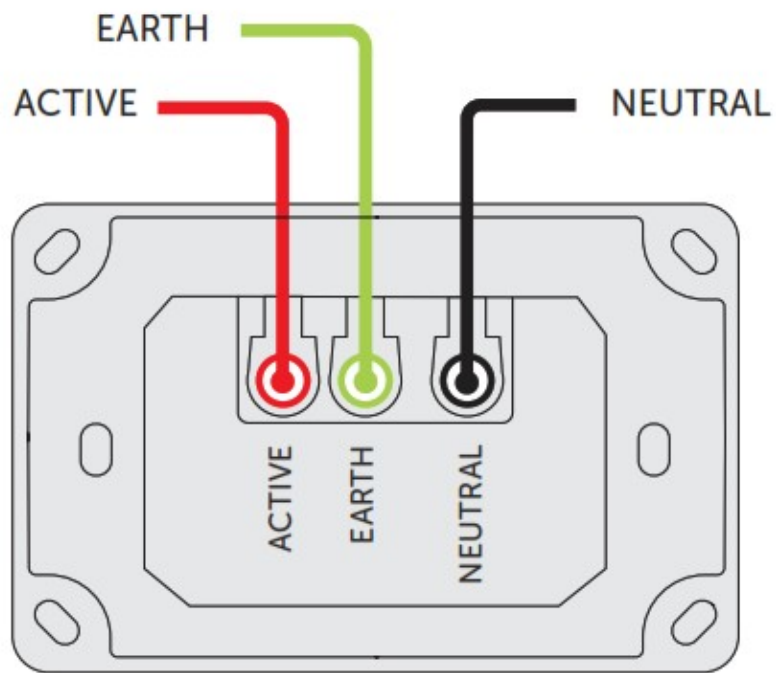

Pair and setup with Zimi.



- Download the Zimi App.
- Choose 'Add Device'.
- Follow the on-screen instructions.



<http://onelink.to/arrs92>

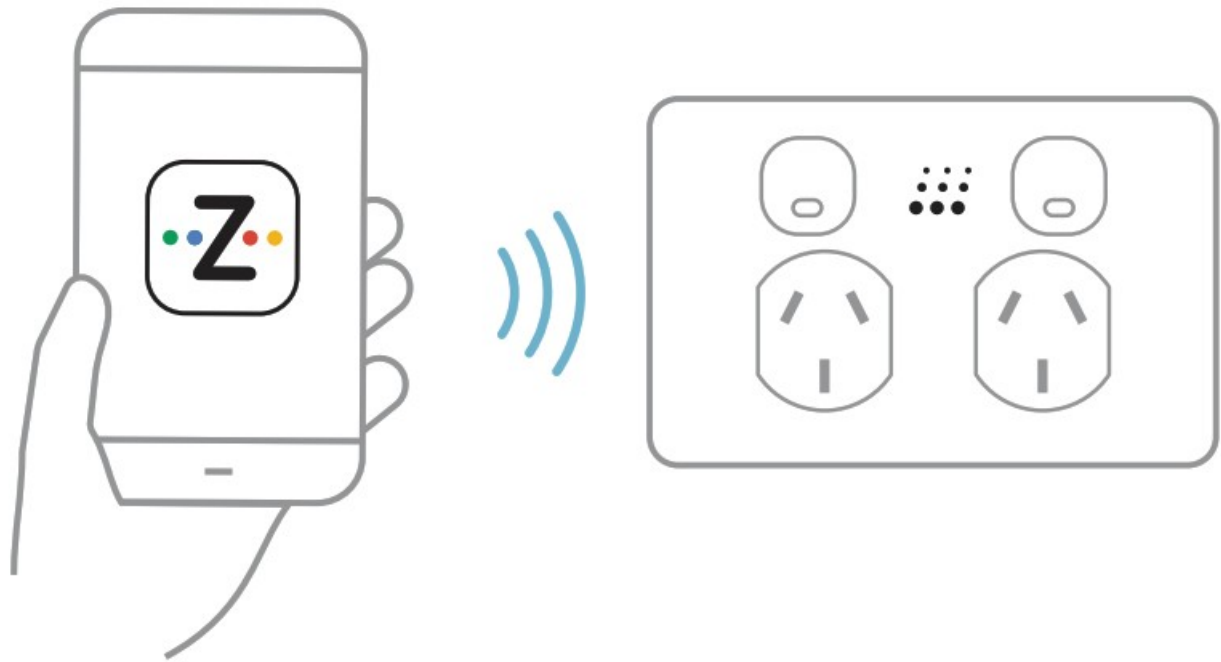

Zimi App Download

Point your phone camera at the QR code to open the app store.





Zimi Cloud Connect.

Enjoy the full experience with all your Powermesh devices.



Requires Wi-Fi with Internet connection.

	Remote access anywhere.
	Voice control hands-free.
	Energy history over time.

Want to learn more or need help?

Enjoy all the features to make your life easier.
Visit our website for tips, tricks and help.

support.zimi.life



Power Lock

Prevent power use
at the switch.



Schedules

Turn it on and off
any day or time.



Energy Use







Monitor the power
usage and cost.



Auto off Timer

Turn it off
automatically.

Powermesh Status Indicator.

	Blue	Ready to pair. 'Add device' in Zimi to pair and complete setup.
	White	Setup is complete. This device has been paired and setup completed.
	White pulsing	Action in progress. This lets you know an automatic function is being activated.
	Blue & White pulsing	Identify device. This shows the device when updating its settings.
	Green pulsing	Energy alert. This shows the device is using high power.
	Red	Device problem. Please refer to support to resolve the problem.
	Off	If the device is working, the indicator has been 'turned off' in device settings.

Manufacturer's Warranty

This product has been manufactured to the highest quality standards. This product is warranted to the original purchaser and is not transferable. The product is guaranteed to be free from defects in workmanship and parts for a period of 1 Year from the date of purchase. Defects that occur within this warranty period, under normal use and care will be repaired, replaced, or refunded. The benefits conferred by this warranty are in addition to all other rights and remedies of the consumer under a Commonwealth, State, and Territory laws in relation to the goods or services to which this warranty relates and Australian Consumer Law. Risk in regard to the product to be repaired shall at all times remain with the Purchaser. The warranty is given on the condition that the product to which it applies is used for the purpose and in the manner intended by its construction and for no other purposes whatsoever. GSM Innovations Pty Ltd shall not be responsible for damage of any kind, caused by accidents, power surges, electrical storm damage, incorrect power current, infestation (vermin or insect), incorrect installation, incorrect electricity or plumbing installation, improper use of controls or failure to use the unit in accordance with the operating instructions, general misuse or abuse or from normal wear and tear. Any attempt by an unauthorised person to repair or tamper with the equipment shall render the warranty null and void. Goods presented for repair under this warranty may be replaced by refurbished goods of the same type rather than being repaired. Refurbished parts may be used to repair the goods. GSM Innovations Pty Ltd's liability under this warranty is limited to the replacement and/or repair of the defective parts within the warranty period and does not extend to installation or removal of the product. Acceptance of liability by GSM Innovation Pty Ltd contained herein is to the exclusion of any other remedy whatsoever and howsoever arising in respect of any equipment to which it applies.

Proof of Purchase Please keep your purchase docket or receipt as proof of purchase and as proof of the date on which the purchase was made. The purchase docket or receipt must be presented with the warranty when making a claim under this warranty. Failure to produce documentary proof of the date of original acquisition by the original Purchaser will result in a charge being levied for work done, labour and parts supplied. Likewise, a charge will be made for any calls following warranty claim where no fault is found with the unit.

Service during the warranty period The first point of contact for product issues is the place of purchase. The product must be returned to the original place of purchase for product repair, replacement, or refund. Please ensure the product is properly packaged so as to ensure that no damage occurs to the product during transit and make sure that you have included an explanation of the problem. In the event of goods requiring repair under manufacturer's warranty, the owner is responsible for the cost of transportation. Should the goods be found to be in sound working order the owner might be charged a fee. This warranty is given by GSM Innovations Pty Ltd, 14 Millennium Circuit, Helensvale, QLD 4212

Safety Warnings Read all instructions and safety information. All electrical work must only be undertaken after disconnection of the power by removing fuses or turning off the circuit breaker, to ensure all pole disconnection from the electrical supply. All electrical work must be carried out by a licensed and qualified electrician and in accordance to AS/NZS 3000 Wiring Rules and applicable

local authority regulations. This product is not intended for use by persons (including children) with reduced physical, sensory or mental capabilities, or lack of experience and knowledge, unless they have been given supervision or instruction concerning use of the product by a person responsible for their safety. Young children should be supervised to ensure that they do not play with the unit. Do not cut or notch joists, beams, and rafters to install the unit. Do not damage hidden electrical wiring or utilities when cutting. The product must be installed so that switches and other controls cannot be touched by a person in the bath or shower. Do not install the product in a location where water will splash onto it. Check and confirm that all connections are proper and secure to prevent causing property damages or injury. Do not install outdoor where it could be exposed to water or moisture (indoor use only).

Trademarks Zimi and Powermesh and their respective logos are registered trademarks of GSM Innovations Pty Ltd. Google and Google Play are trademarks of Google LLC. Amazon, Alexa, and all related logos are trademarks of Amazon.com, Inc. or its affiliates. Apple, the Apple logo, Apple Watch, and iPhone are trademarks of Apple Inc., registered in the U.S. and other countries. App Store is a service mark of Apple Inc., registered in the U.S. and other countries.



14 Millennium Circuit Helensvale QLD 4212 Australia.
www.zimi.life



Documents / Resources

	zimi Powermesh Double Power Point [pdf] Instruction Manual Powermesh Double Power Point
---	--

References

- [a Amazon.com. Spend less. Smile more.](#)