

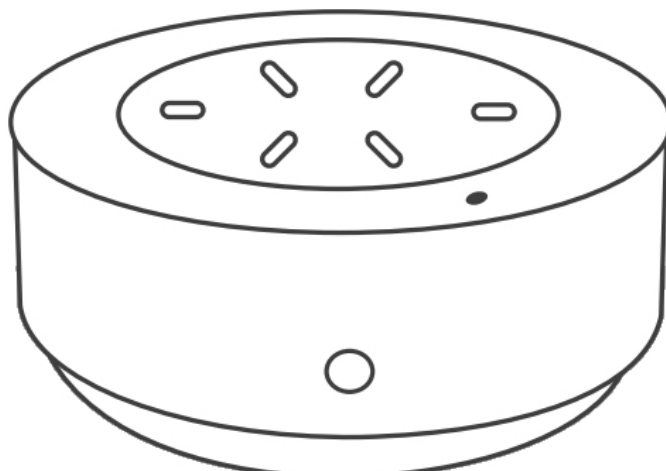

zigbee RSH-SC20 Smart Scene Button User Guide

[Home](#) » [zigbee](#) » zigbee RSH-SC20 Smart Scene Button User Guide 



Quick Guide

Contents

- [1 RSH-SC20 Smart Scene Button](#)
- [2 Dimension](#)
- [3 Specification](#)
- [4 Install the battery](#)
- [5 Remote mode](#)
- [6 Reset / Pairing](#)
- [7 Documents / Resources](#)
 - [7.1 References](#)

Remote Mode	
Single Press	On/Off
Long Press >3s	Set color
Rotate	Dimming
Press and Rotate	Set the color temperature
Remote control operate may vary depends on different model of smart light	

Scene Mode	
Single Press	Setting in APP
Double Clicks	Setting in APP
Long Press	Setting in APP
Rotate to left	Setting in APP
Rotate to right	Setting in APP

Dimension

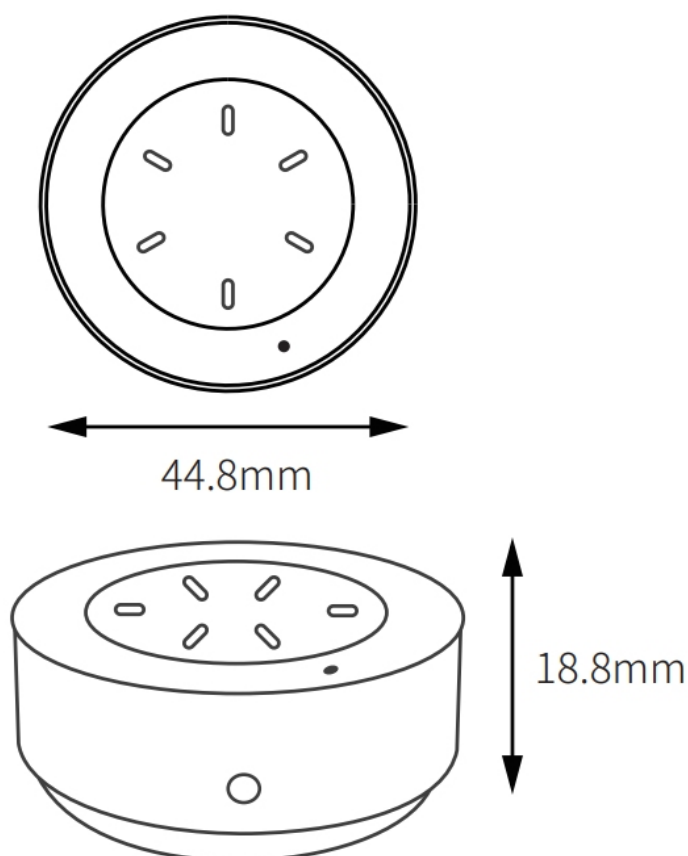

Specification

Model: RSH-SC20-Zigbee
 Size: 44.8X44.8X18.8mm
 Built-in battery :CR2032
 Operating voltage :DC 3V

Working current: Standby current $\leq 5\mu\text{A}$ / Maximum current $\leq 10\text{mA}$

Wireless: zigbee3.0

Wireless transmission distance; Open range $\geq 30\text{m}$

Operating environment: -5°C to 45°C (23°F to 113°F) / $\leq 95\%$ (no condensation)

*Available for selected model

Install the battery

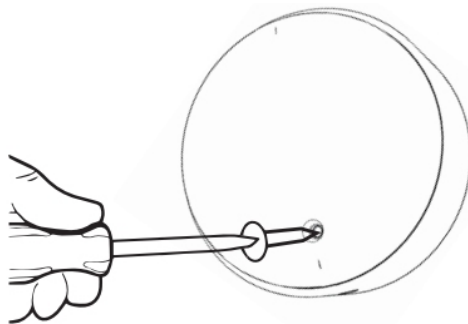

1. Remove the screw

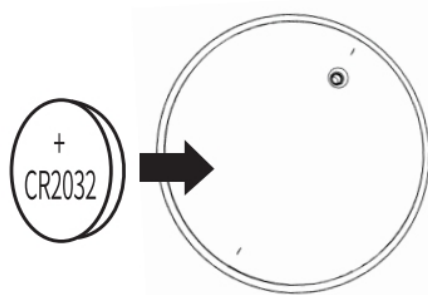

2. Install the CR2032 battery

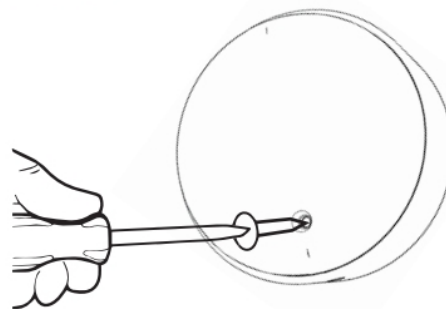

3. Install the cover

Remote mode

Scan the QR code to download APP



<https://smartapp.tuya.com/smartlife>

Gateway required to connect the device

Reset / Pairing

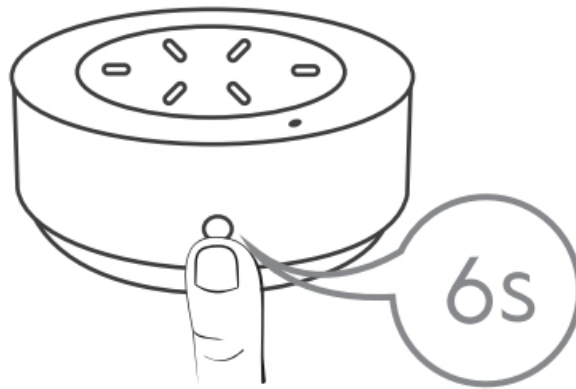

1. Hold "RESET" 6s

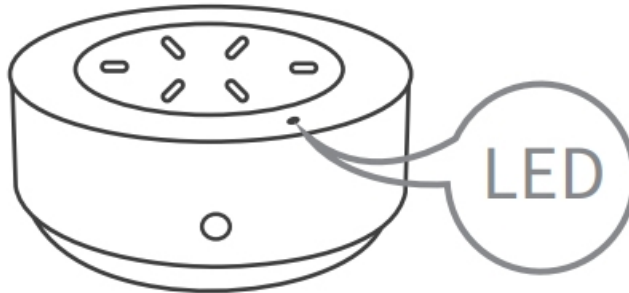

2. LED will start flashing

5.1 Add Device

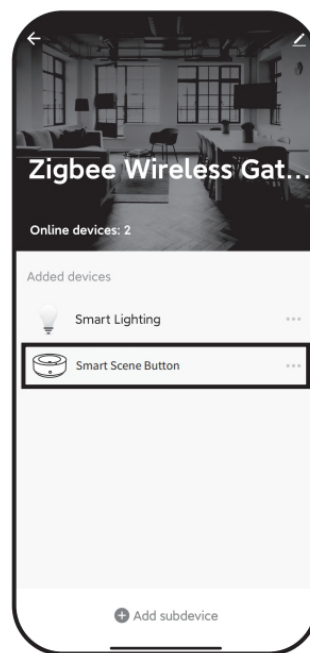
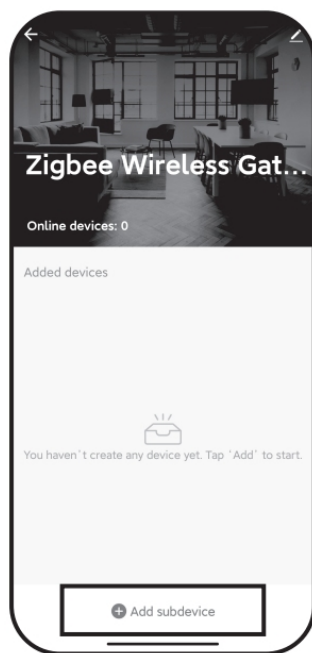

5.2 Remote mode (Default operate mode)

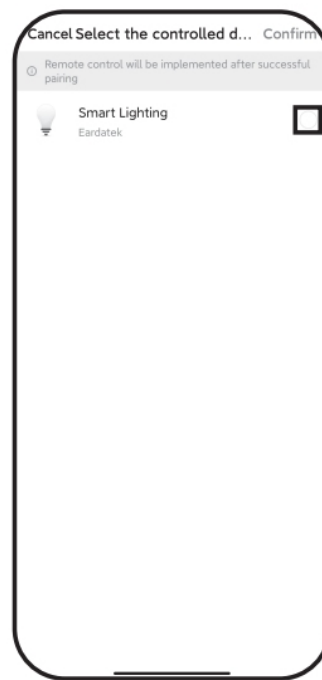



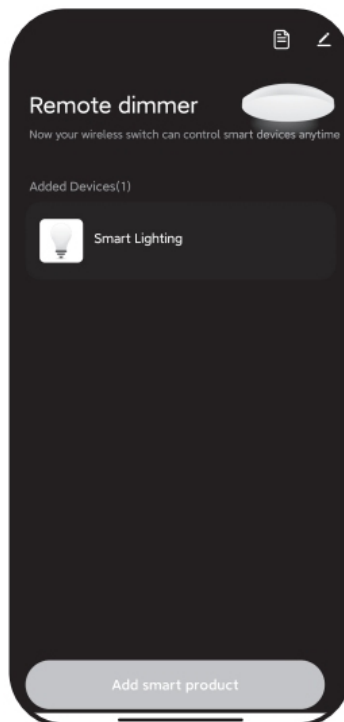

5.3 Remote mode

⚠ First time to add smart light MUST press the button to activate memory



5.4 Remote mode

Control description under remote control mode

	Single Press On/Off		Rotate Dimming
	Press and Rotate Set the color temperature		Long Press >3s Set color

Note: The operates may different depending on the smart lights

5.5 Mode swap

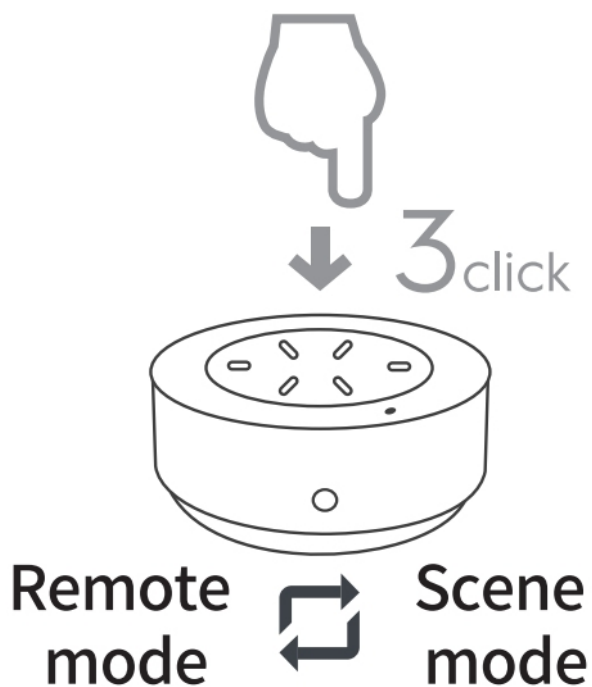

5.6 Scene mode

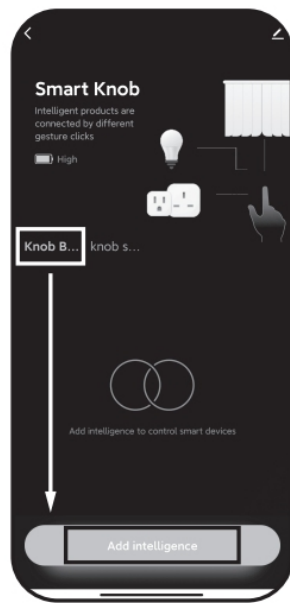

5.7 Scene mode

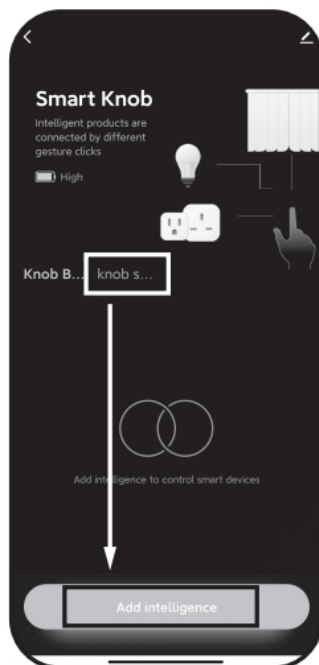

5.8 Scene mode

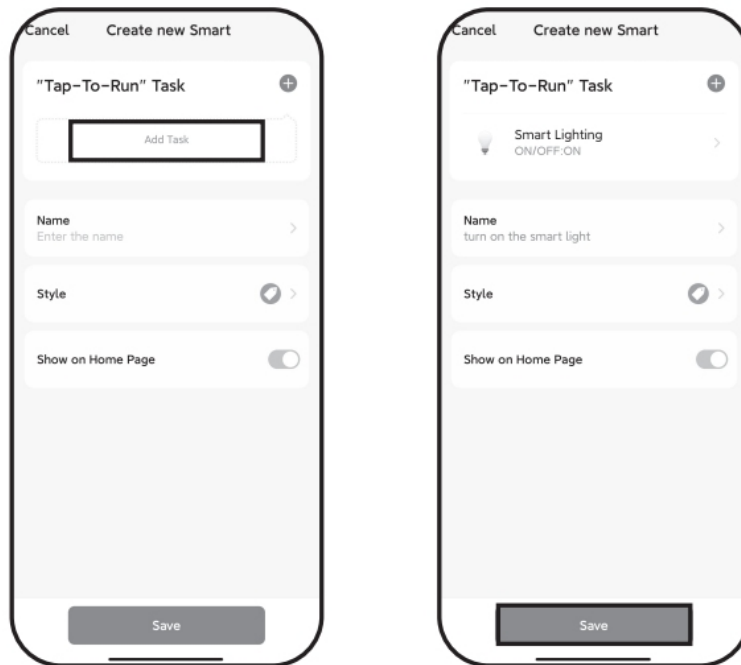

5.9 Scene mode

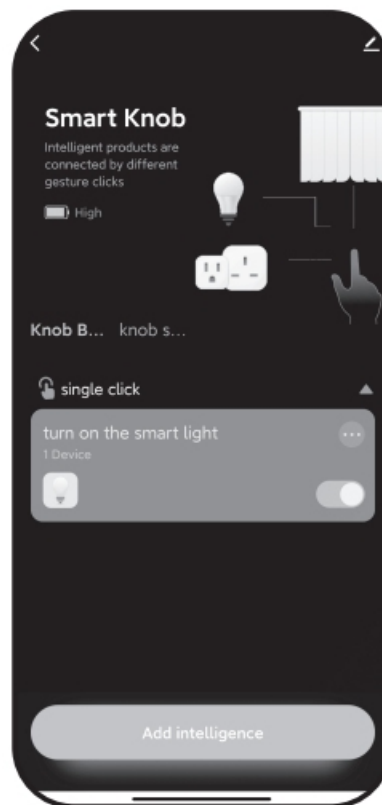

Warning:

Changes or modifications to this unit not expressly approved by the party responsible for compliance could void the user's authority to operate the equipment.

NOTE:

This device complies with part 15 of the FCC Rules. Operation is subject to the following two conditions: (1) This device may not cause harmful interference, and (2) this device must accept any interference received, including interference that may cause undesired operation.

FCC Statement:

This equipment has been tested and found to comply with the limits for a Class B digital device, pursuant to part

15 of the FCC Rules. These limits are designed to provide reasonable protection against harmful interference in a residential installation. This equipment generates, uses and can radiate radio frequency energy and, if not installed and used in accordance with the instructions, may cause harmful interference to radio communications. However, there is no guarantee that interference will not occur in a particular installation.

If this equipment does cause harmful interference to radio or television reception, which can be determined by turning the equipment off and on, the user is encouraged to try to correct the interference by one or more of the following measures:

- Reorient or relocate the receiving antenna.
- Increase the separation between the equipment and receiver.
- Connect the equipment into an outlet on a circuit different from that to which the receiver is connected.
- Consult the dealer or an experienced radio/TV technician for help.



Documents / Resources

	zigbee RSH-SC20 Smart Scene Button [pdf] User Guide RSH-SC20 Smart Scene Button, RSH-SC20, Smart Scene Button, Scene Button, Button
---	--

References

- [User Manual](#)

[Manuals+](#), [Privacy Policy](#)

This website is an independent publication and is neither affiliated with nor endorsed by any of the trademark owners. The "Bluetooth®" word mark and logos are registered trademarks owned by Bluetooth SIG, Inc. The "Wi-Fi®" word mark and logos are registered trademarks owned by the Wi-Fi Alliance. Any use of these marks on this website does not imply any affiliation with or endorsement.