



ZigBee RGBW Remote Instruction Manual

[Home](#) » [zigbee](#) » ZigBee RGBW Remote Instruction Manual 

ZigBee RGBW Remote



Important: Read All Instructions Prior to Installation

Revision Log	Previous Version	20220912 Revision
ON/OFF button function	Turn on/off all groups	Turn on/off the chosen group/groups
Group buttons function	Hold to turn on/off corresponding group	Hold to enter touch link pairing mode
Operation Chapter 4	Touch link only has normal operation mode	Touch link shortcut operation mode added

Contents

- [1 Function introduction](#)
- [2 Product Data](#)
- [3 Safety & Warnings](#)
- [4 Operation](#)
- [5 Documents / Resources](#)
- [6 Related Posts](#)

Function introduction

When controls RGB+CCT light devices, keep short pressing to turn on CCT channels and get 25% ww+75% cw, 50% ww+50% cw, 75% ww+25% cw, 100% ww+0% cw, 0% ww+100% cw one by one. Press and hold to adjust color temperature smoothly.

When controls RGBW light devices, keep short pressing to turn on the 4th channel W and get 25%, 50%, 75%, 100%, 0% intensity one by one. Press and hold to adjust W channel light intensity smoothly.

Press and hold down to decrease light intensity

ON/OFF button, click to activate the remote, once activated, the indicator turns on, click to turn on/off the chosen group/groups

Click to play / pause 1 built-in RGB color changing effect, Press and hold down to speed up/down the effect

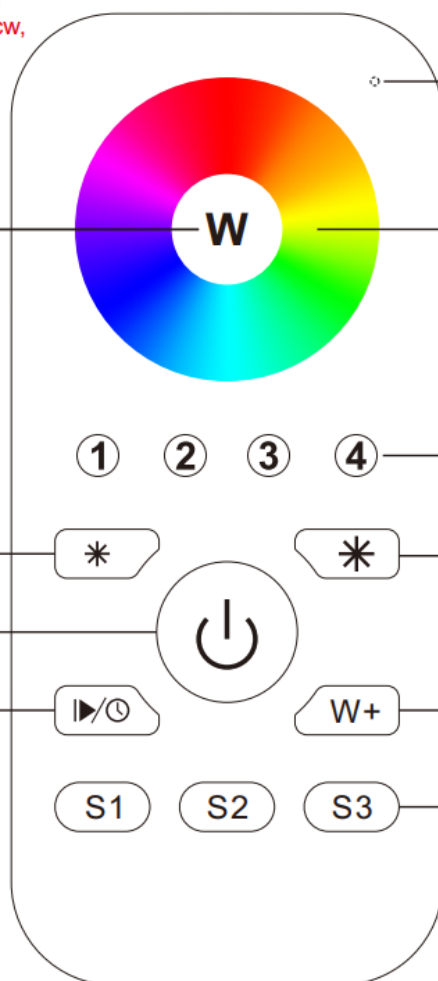

Indicator: indicate the state of remote control

Color wheel

Group numbers: click to choose the group, multiple groups can be chosen by clicking group numbers one by one within 3 seconds, press and hold down to enter touchlink pairing mode and add light device to the group

Press and hold down to increase light intensity

Click to switch CW, NW, WW mixed by RGB, double click to turn off RGB channels

Press and hold down to save colors; Click to recall the saved colors

Front side

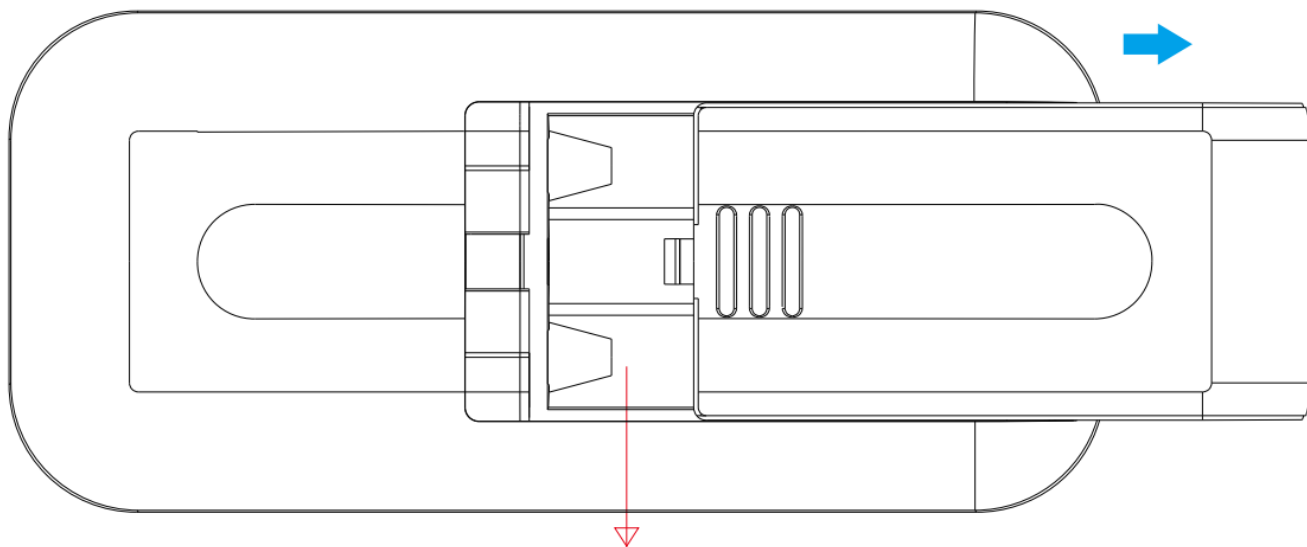

4.5V(3xAAA battery)
Bottom side

Product Data

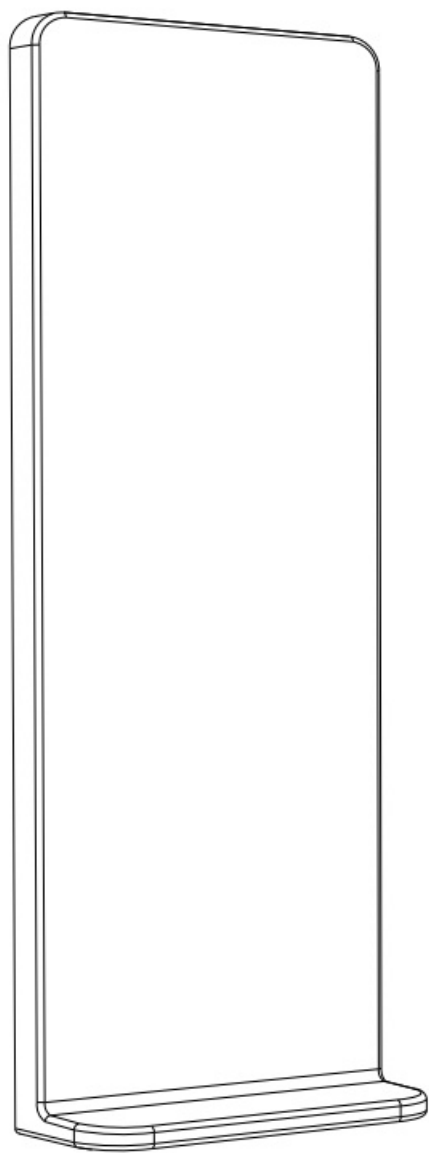

Magnetic Bracket

Protocol	ZigBee 3.0
Operation Voltage	4.5V(3xAAA battery)
Transmission Frequency	2.4GHz
Transmission Range (free field)	30m
Protection Type	IP20
Dimming Range	0.1%-100%
Dimension	120x55x 17mm
Protection Grade	IP20

- ZigBee RGBW remote based on ZigBee 3.0
- Enables to control RGB, RGBW and RGB+CCT lighting devices
- High sensitive & high stable touch color wheel, fast & precise color control
- Battery powered remote with low power consumption
- Enables to pair ZigBee lighting devices through touch link commissioning
- Supports find and bind mode to pair with ZigBee lighting devices
- Supports 4 groups for binding max. 30 lighting devices
- 2.4 GHz global operation
- Transmission range up to 30m
- Compatible with universal ZigBee Gateway products
- Compatible with universal RGBW and RGB+CCT ZigBee lighting devices

ZigBee Clusters Supported by This Remote Are As Follows:

Input clusters:

- Basic
- Power Configuration
- Identify
- Diagnostics

Output clusters:

- Identify

- Group
- Scene
- On/off
- Level control
- Ota
- Color control

Safety & Warnings

- This device contains AAA batteries that shall be stored and disposed properly.
- DO NOT expose the device to moisture.

Operation

1. **This ZigBee RGBW remote is a wireless transmitter that communicates with a variety of ZigBee compatible systems. This transmitter sends wireless radio signals that are used to remotely control a compatible system.**
2. **This ZigBee remote supports 4 groups for binding max. 30 lighting devices and enables to control RGB ZigBee lighting devices.**

ZigBee Network Pairing through Coordinator or Hub (Added to a Zigbee Network)

Step 1: Remove the remote from previous zigbee network if it has already been added to it, otherwise pairing will fail. Please refer to the part "Factory Reset Manually".

Step 4: Immediately short press to search nearby network, indicator flashes every 1 second, 20 seconds timeout if there is no network. Indicator will then blink 5 times quickly for successful pairing.



LED indicator

Step 2: From your zigbee controller or hub interface, choose to add device or accessory and enter Pairing mode as instructed by the controller.

Step 3: Press and hold down until LED indicator turns on.

Note:

1. After pairing successfully, the remote information will appear on the controller or hub interface.
2. No remote information will appear on the hub interface if pairing to Philips Hue Bridge.

Touch Link to a Zigbee Lighting Device

1. Normal Operation

Step 1: Set the zigbee lighting device to start TouchLink commissioning, please refer to its manual to learn how.

Step 4: Short press any button to choose a group to touchlink.

Step 5: Press and hold down until LED indicator blinks once and stay solid on.

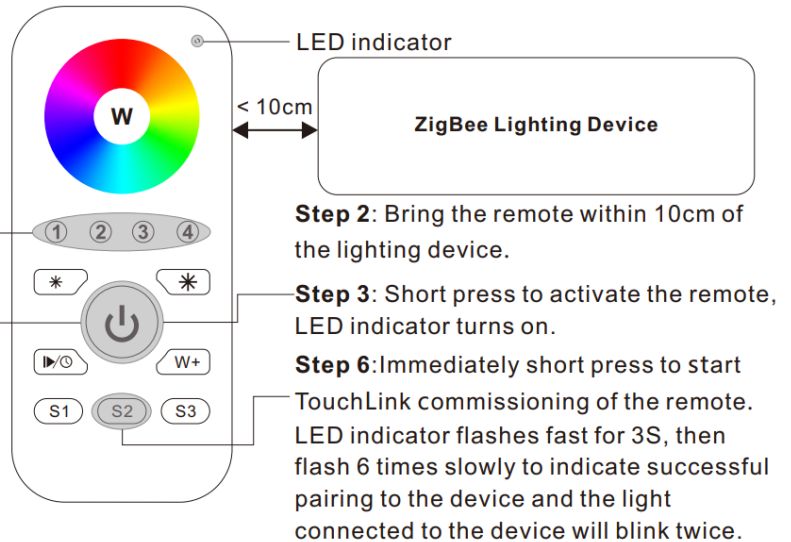

2. Shortcut Operation

Step 1: Set the zigbee lighting device to start TouchLink commissioning, please refer to its manual to learn how.

Step 4: Press and hold down to enter touchlink pairing mode and add light device to corresponding group.

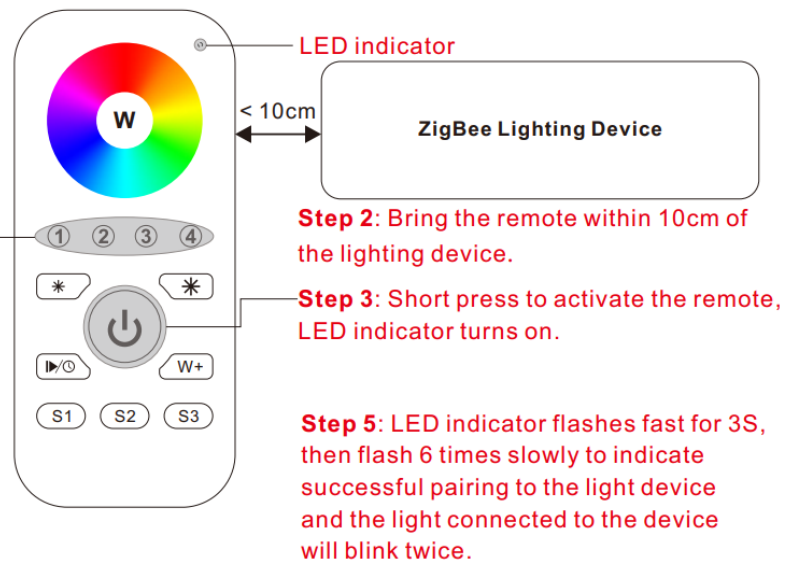

Note:

1. Directly Touch Link (both not added to a ZigBee network), each remote can link with 30 devices.
2. Touch Link after both added to a ZigBee network, each remote can link with max. 30 devices.
3. For Hue Bridge & Amazon Echo Plus, add remote and device to network first then Touch Link.
4. After Touch Link, the remote can control the linked lighting devices.

Removed from a Zigbee Network through Coordinator or Hub Interface

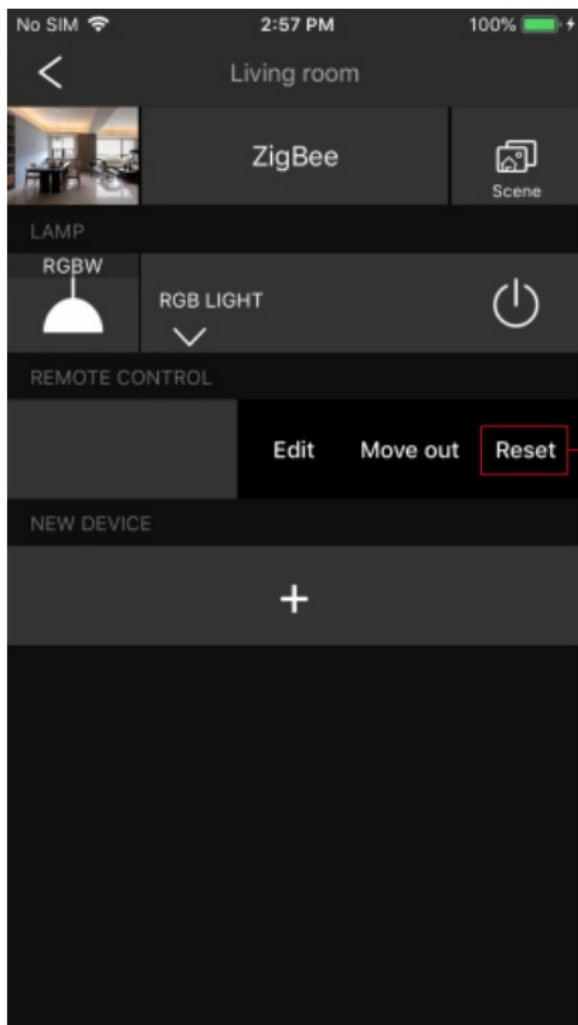

From your ZigBee controller or hub interface, choose to delete or reset the remote as instructed, indicator flashes 3 times quickly to indicate successful removing.

Factory Reset Manually

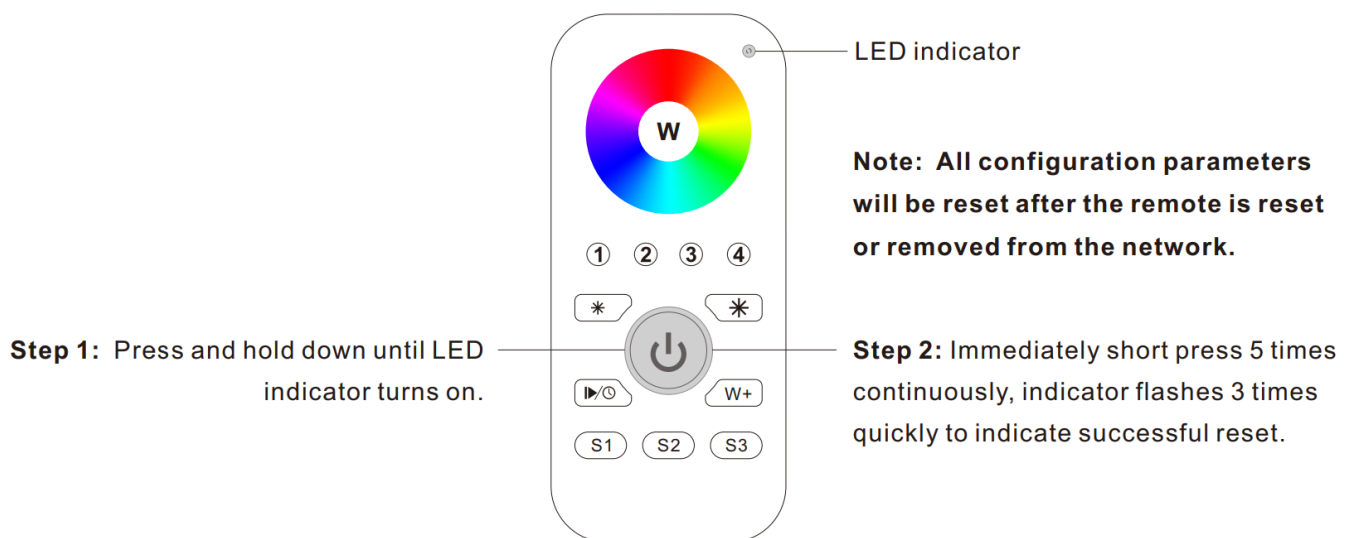

Remove a Touch link Paired ZigBee Lighting Device

Step 1: Set the Touchlink paired zigbee device to start TouchLink commissioning, please refer to its manual to learn how.

Step 4: Short press the group button that the device was linked to.

Step 5: Press and hold down until LED indicator blinks once and stay solid on.

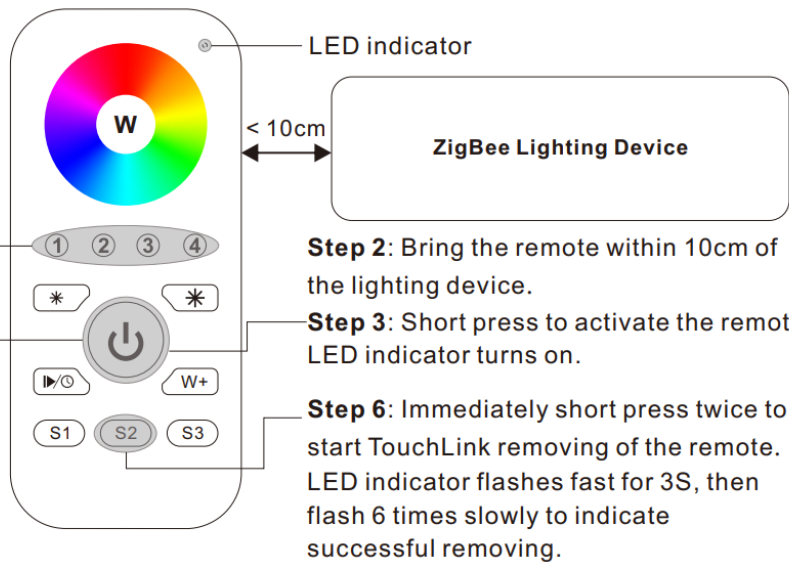

Factory Reset a Lighting Device (Touch Reset)

Note: the device shall be added to a network, the remote added to the same one or not added to any network.

Step 1: Set the zigbee device to start TouchLink commissioning, refer to its manual.

Step 3: Press and hold down until LED indicator turns on.

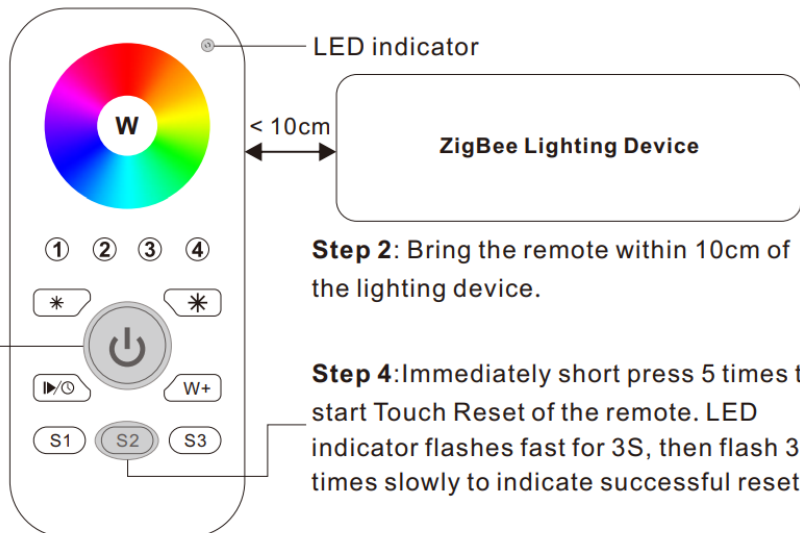

Find and Bind a Zigbee Lighting Device

Note: Make sure the device and remote already added to the same zigbee network.

Step 1: Start find and bind mode on the ZigBee lighting device (initiator node) and enable it to find and bind target, refer to its manual.

Step 3: Short press a group button that you would like to bind the device to.

Step 4: Press and hold down until LED indicator blinks once and stay solid on.

Note: Each remote can bind max. 30 lighting devices.

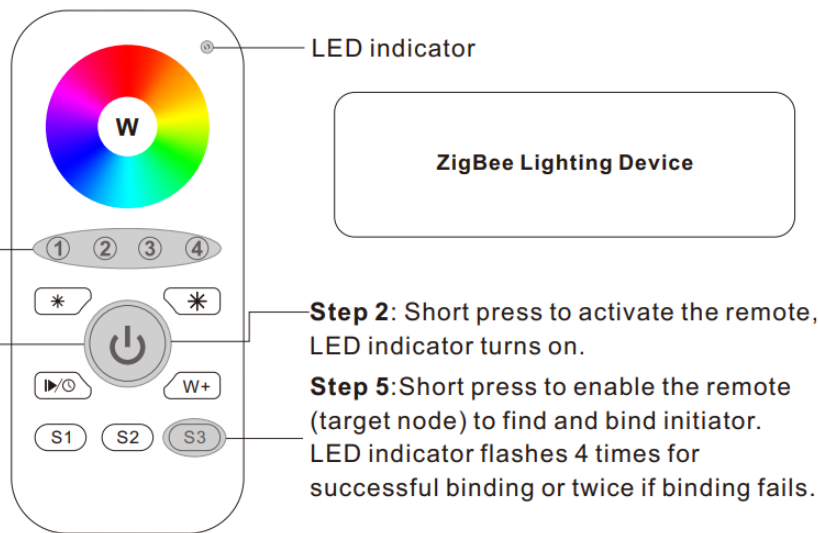

Step 2: Short press to activate the remote, LED indicator turns on.

Step 5: Short press to enable the remote (target node) to find and bind initiator. LED indicator flashes 4 times for successful binding or twice if binding fails.

Find and Unbind a Zigbee Lighting Device

Step 1: Start find and bind mode on the ZigBee lighting device (initiator node) and enable it to find and unbind target, refer to its manual.

Step 3: Short press the group button that the device already bound to.

Step 4: Press and hold down until LED indicator blinks once and stay solid on.

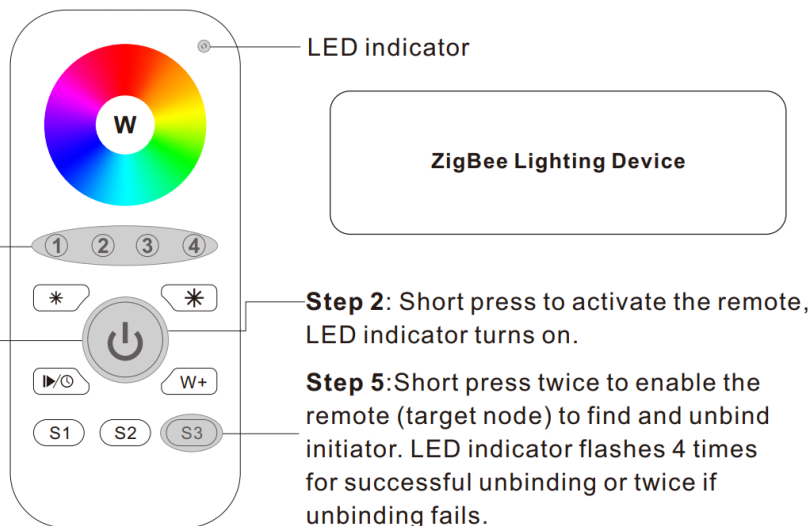

Step 2: Short press to activate the remote, LED indicator turns on.

Step 5: Short press twice to enable the remote (target node) to find and unbind initiator. LED indicator flashes 4 times for successful unbinding or twice if unbinding fails.

Clear All Find and Bind Mode Paired Lighting Devices of a Group

Step 2: Short press to choose the group that you would like to unbind all devices.

Step 3: Press and hold down until LED indicator blinks once and stay solid on.

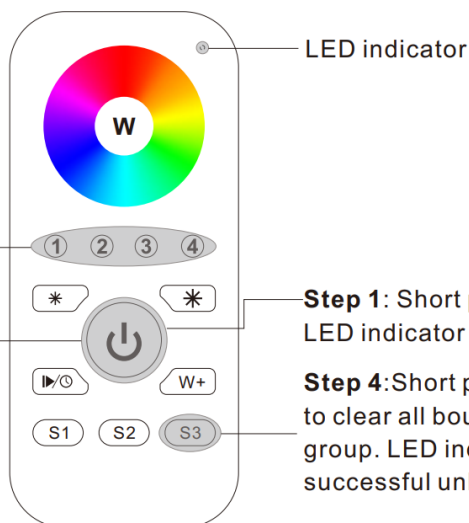

Step 1: Short press to activate the remote, LED indicator turns on.

Step 4: Short press 5 times continuously to clear all bound lighting devices with this group. LED indicator flashes 4 times for successful unbinding.

Setup a Network & Add Devices to the Network (No Coordinator or Hub Required)

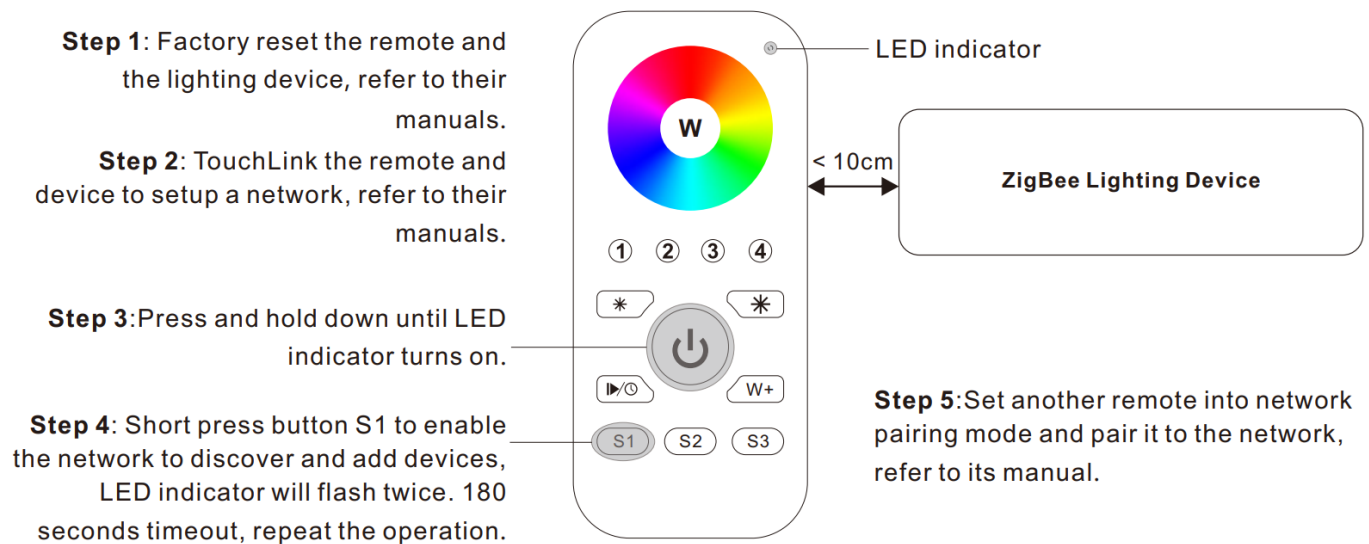

Step 6: Add more remotes to the network as you would like.

Step 7: Factory reset the lighting devices that you would like then add them to the network, refer to their manuals.

Step 8: Touch link to pair the added remotes and lighting devices, refer to their manuals. Each remote can link with max. 30 lighting devices. Each lighting device can be linked by max. 30 remotes.

OTA

The remote supports firmware updating through OTA, and will acquire new firmware from zigbee controller or hub every 10 minutes automatically.

How to Check Whether the Remote Belongs to a Network or not

Activate the remote by clicking All On/Off button (indicator on), then short press any other buttons except group buttons, indicator blinking 3 times means the remote does not belong to any network, blinking once or twice means it has already been added to a network.

Battery Power Monitor Function

The remote will report battery power value to the coordinator under following situations:

- When powered on.
- When short pressing both S2 and S3 buttons simultaneously.
- When operating the switch to send data packets (over 4 hours since last operation).
- When added to the network by a coordinator.





Documents / Resources

	<p>ZigBee RGBW Remote [pdf] Instruction Manual SR-ZG2819S-RGB, 70100073, RGBW Remote, RGBW, Remote</p>
---	--

Manuals+.