



# ZigBee MS-108ZR Curtian Switch Instruction Manual

[Home](#) » [zigbee](#) » ZigBee MS-108ZR Curtian Switch Instruction Manual 

## Contents

- [1 ZigBee MS-108ZR Curtian Switch](#)
- [2 Inhouse local operation](#)
- [3 INSTALLATION](#)
- [4 TECHNICAL SPECIFICATIONS](#)
- [5 WIRING DIAGRAM](#)
- [6 Wiring Instructions and Diagrams](#)
- [7 FAQ](#)
- [8 MANUAL OVERRIDE](#)
- [9 RF Link Method \(only for MS-108ZR\)](#)
- [10 Reset Method](#)
- [11 Documents / Resources](#)
- [12 Related Posts](#)



**ZigBee MS-108ZR Curtian Switch**

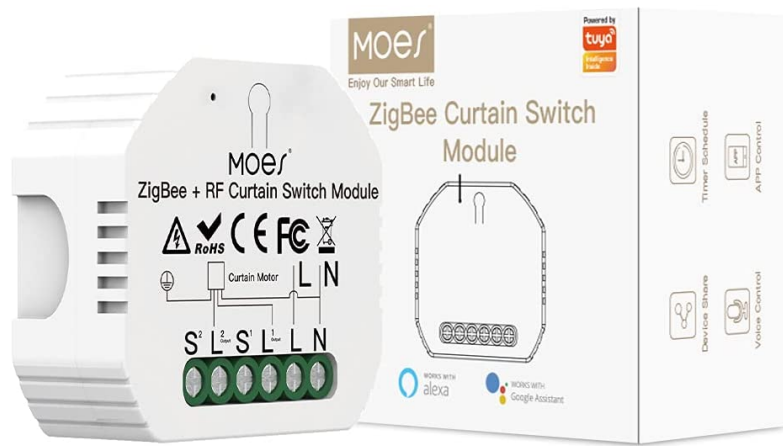

**MS-108Z:ZigBee**  
**MS-108ZR:ZigBee+RF433**

**Global international operation**  
 Whenever & Wherever You are, All-in-one Mobile App

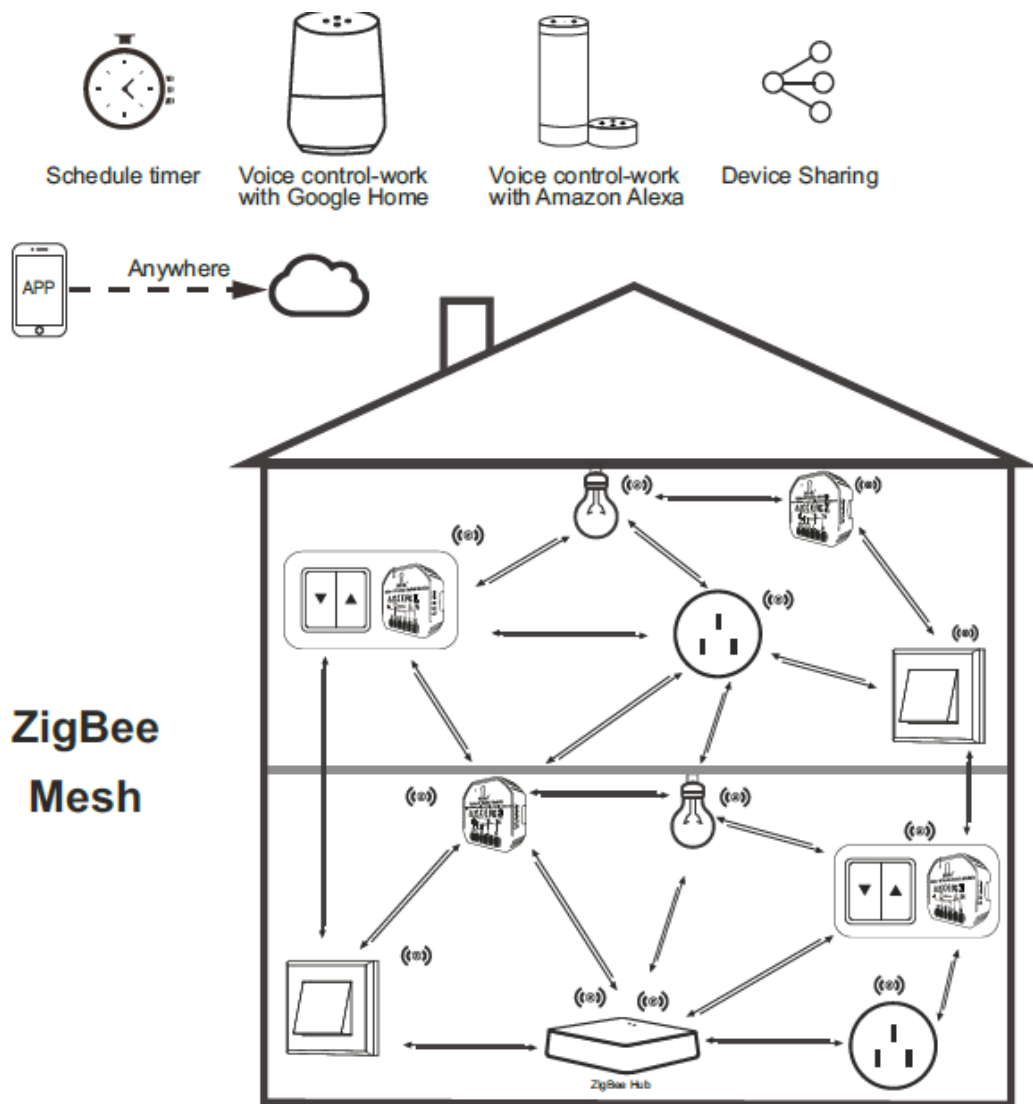

Inhouse local operation

Inhouse local operation

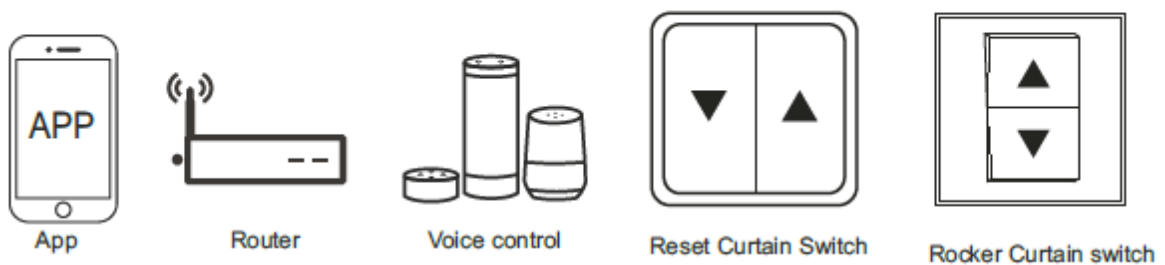

**Note:** Press the traditional curtain switch once after switch to up/down (any button on the switch ) to stop the curtains (connect your switch to the curtain module first).

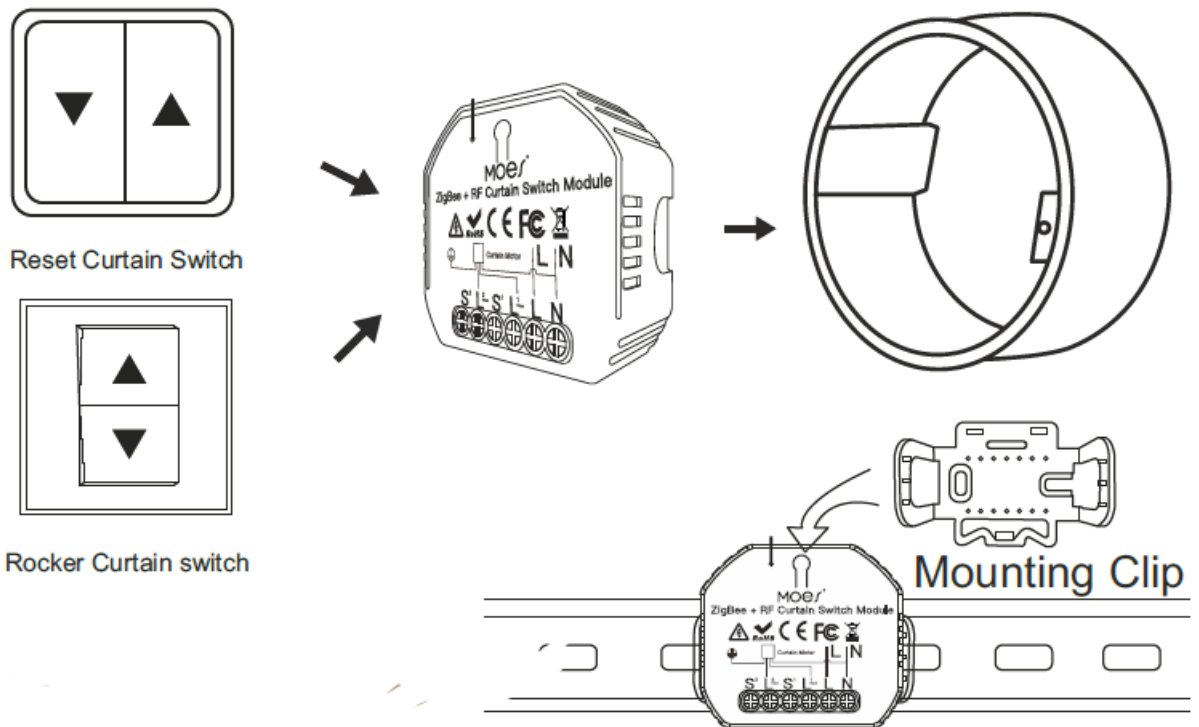

## INSTALLATION

### Warnings:

1. Installation must be carried out by a qualified electrician in accordance with local regulations.
2. Keep the device out of the reach of children.
3. Keep the device away from water , damp or hot environment.
4. Install the device away from strong signal sources such as microwave oven that may cause signal interruption resulted in abnormal operation of the device.
5. Obstruction by concrete wall or metallic materials may reduce the effective operation range of the device and should be avoided.
6. Do NOT attempt to disassemble, repair or modify the device.

## TECHNICAL SPECIFICATIONS

- **Product type**  
ZigBee/ZigBee+RF
- **Curtain Module Voltage**  
90-250V A
- **Current**  
2A
- **Max. Power**  
500W(250V)
- **Wireless Protocol ZigBee**  
3.0
- **Operation temp.**

-10°C – +40°C

- **Case temp**

Tc: +80°C (Max.)

- **Operation range**

≤ 200 m

- **Dims (WxDxH)**

52x47x18 mm

- **IP rating**

IP20

- **Warranty**

1 year

## **EMC Standard (EMC)**

- EN 300 328 V2.1.1 (2016-11),
- EN 301489-1 V2.1.1 (2017-02),
- EN 301489-17 V3.1.1 (2017-02),
- EN 62311: 2008, EN 55015:2013
- +A1:2015, EN 61547:2009

## **Safety Standard (LVD)**

- IEC 60669-2-1:2002/AMD1:2008/ AMD2:2015, IEC 60669-1:1998/ AMD1:1999/AMD2:2006,
- EN 60669-2-1:2004+A1: 2009+ A2:2010, EN 60669-1:2018

## **RoHS Standard (RoHS)**

- 2011/65/EU, (EU) 2015/683

## **WIRING DIAGRAM**

**With curtain switch**

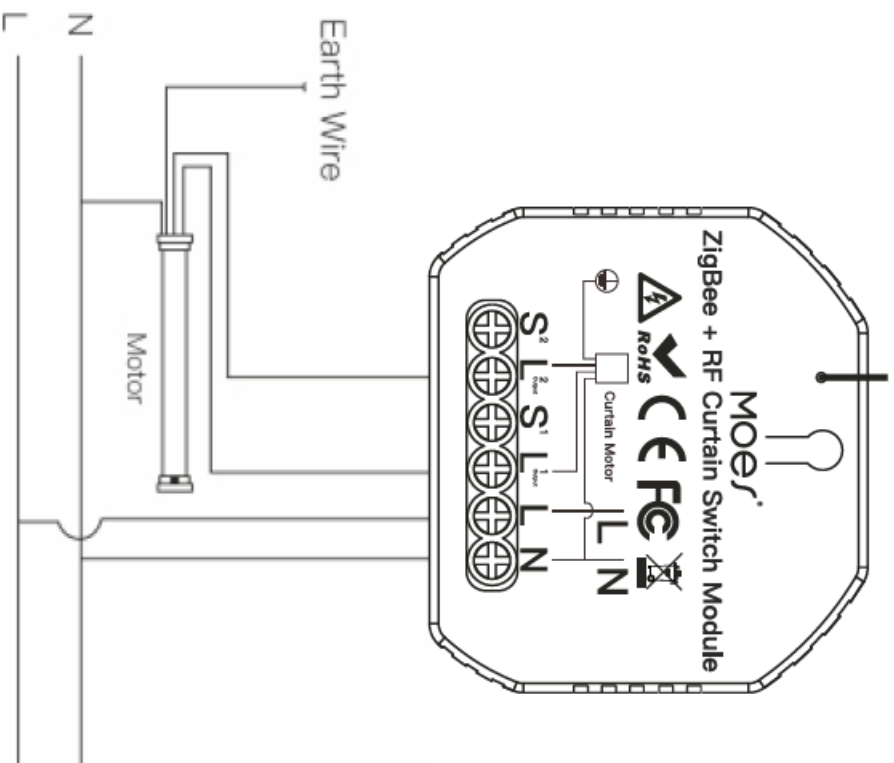
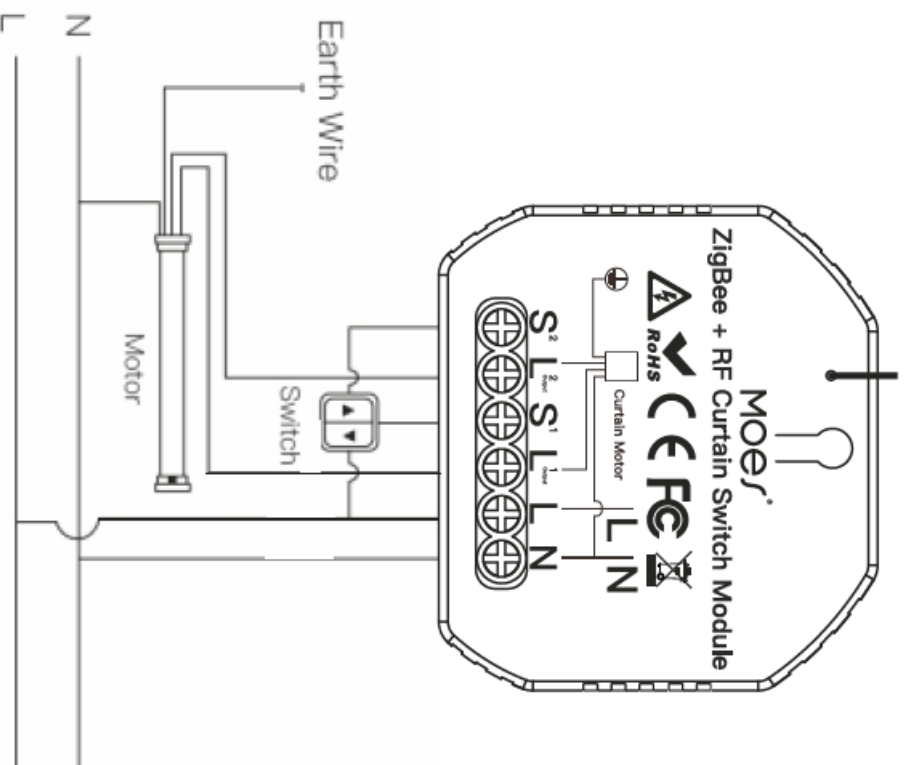

Without switch

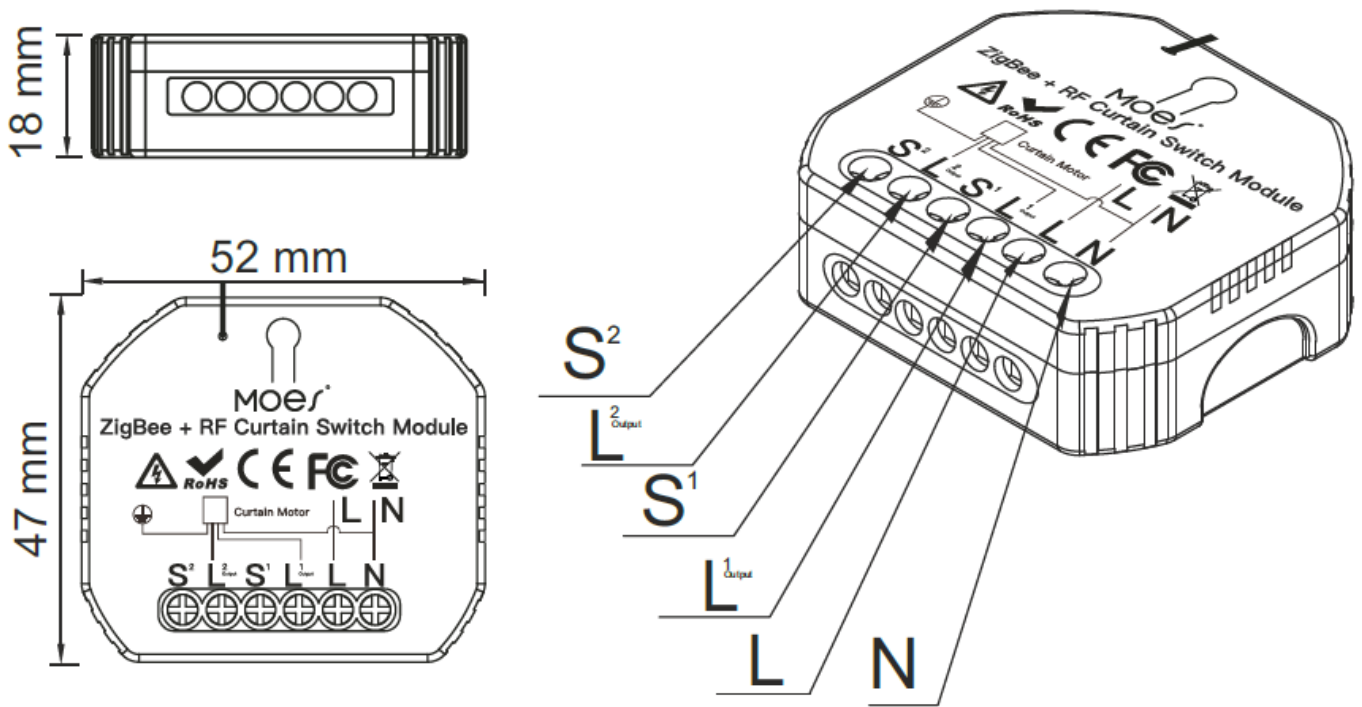

## Wiring Instructions and Diagrams

1. Turn off the power supply before carrying out any electrical installation work.
2. Connect wires according to the wiring diagram.
3. Insert the module into the junction box.
4. Connect the power supply and follow curtain switch module configuration instructions.

**Notes:** Put your smartphone close to the curtain switch module when you're configuring, and make sure you have min. 50% Wi-Fi signal.

## FAQ

- **Q1: Does this work with Google Home?**

A: Yes, it does. And it's also compatible with Alexa.

- **Q2: Do I need to buy a hub to work with the curtain module**

A: Yes, there is need for you to buy a Tuya ZigBee hub

- **Q3: Can I control the module with my own remote controller?**

A: This curtain switch module (MS-108ZR) is RF433 built in and it can only work with RF433 remote control switch with encoding 1527.

- **Q4: Shall I buy a smart curtain switch to work with this module?**

A: No, you can just connect the module to your traditional curtain switch to realize intelligence.

- **Q5: What should I do if I can't configure the curtain module?**

A: Please check whether device is powered on.

b: Make sure your mobile and curtain module are under the same 2.4GHz wifi network.

c: Whether it's in good internet conditions.

d: Make sure the password entered in App is correct.

e: Make sure the wiring is correct.

- **Q6: Which products can I control with the device?**

A: Curtains, shutter, blind....

- **Q7: What happens if the wifi goes off?**

A: You can still control the device connected to the curtain module with your traditional curtain switch and once wifi is active again the device connected to the curtain module will connect automatically to your wifi network.

- **Q8: What should I do if I change the wifi network or change the password?**

A: You can connect the module to the wifi network according to the App User Manual.

## **MANUAL OVERRIDE**

The curtain switch module terminal reserves the access of manual override function for the end-user to switch on/off.

### **Switch on/off for permanent on/off function.**

#### **Notes:**

1. Both the adjustment on App and switch can be reset , the last adjustment remains in memory .
2. The App control is synchronized with the manual switch.



iOS App / Android App

Scan the QR code to download Smart Life App, or you can also search keyword "Smart Life" at App Store or Googleplay to download App.

Log in or register your account with your mobile number or e-mail address. Type in the verification code sent to your mobile or mail box, then set your login password. Click "Create Family" to enter into the App.



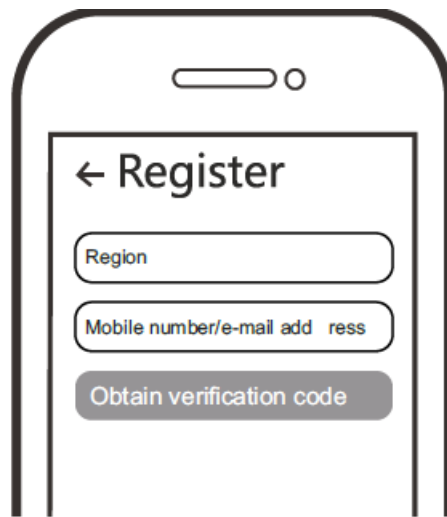

### ZigBee link method:

Pair with traditional pairing

Press the reset button for more than 7 seconds until the beep sounds continuously rapidly as Di-Di-Di... for entering into ZigBee pairing mode.

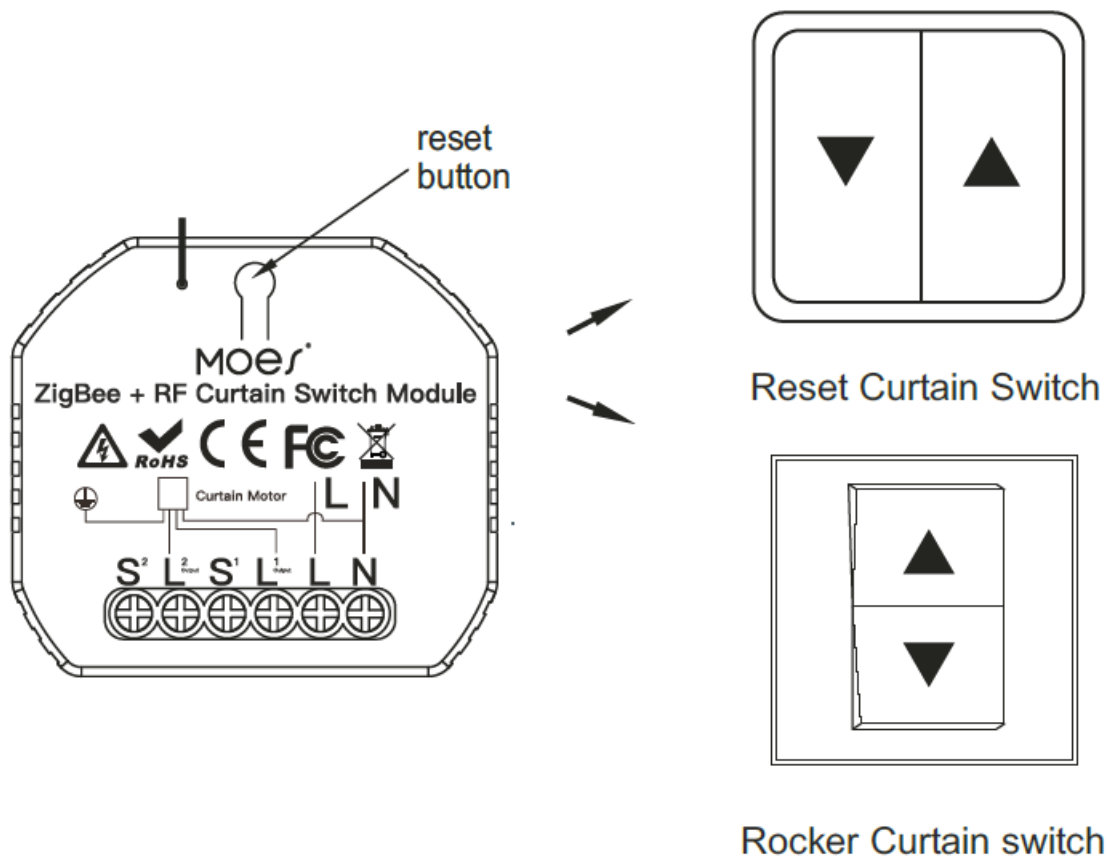

Open the App, select “+” on top right, choose

“Switch (Zigbee)” to add device. And select the right Gateway to confirm the connection.

**Note:** Make sure you have successfully connected one Zigbee gateway hub.

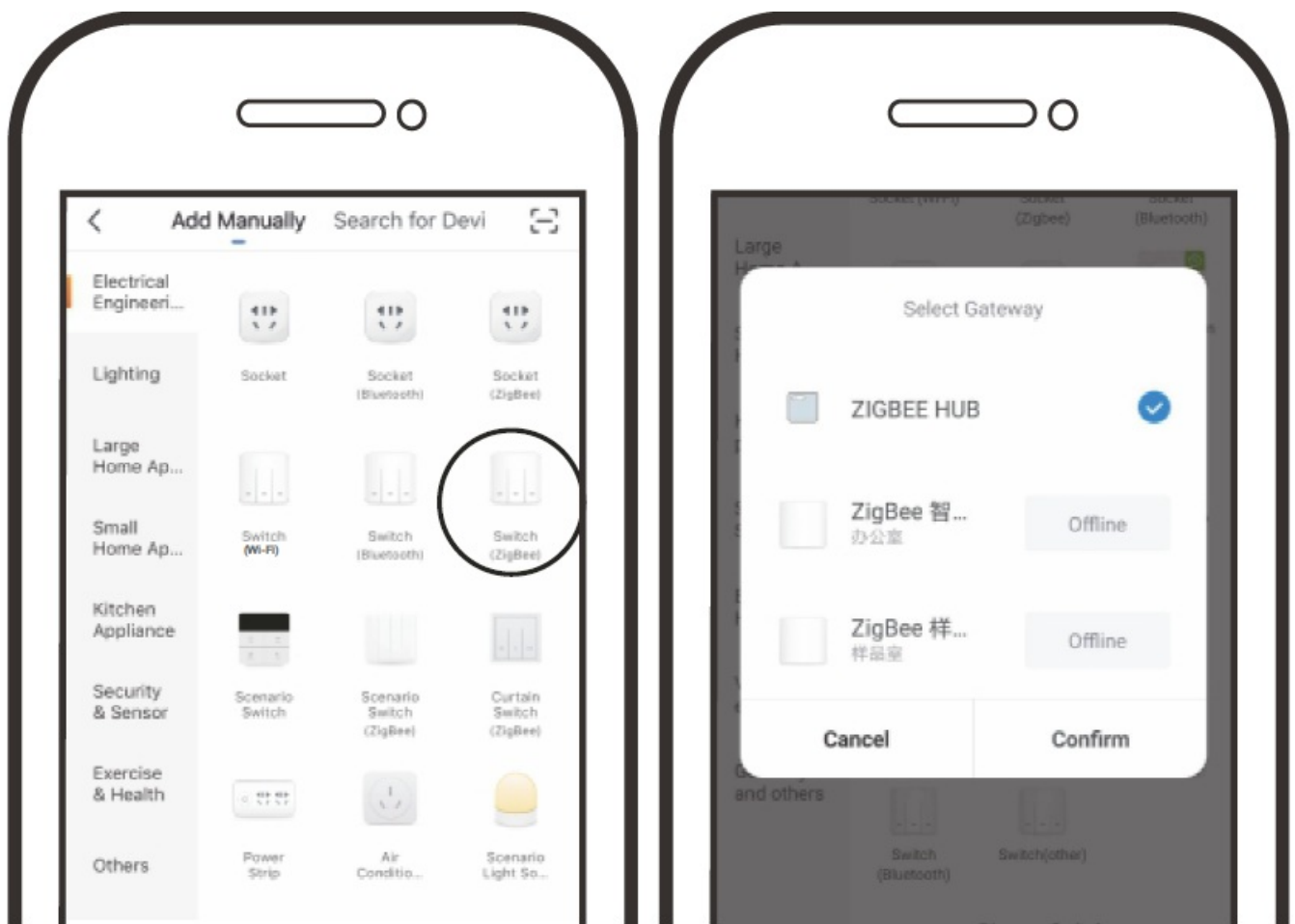

Make sure your smart phone and ZigBee switch module are under the same WiFi network at 2.4 GHz connection. Confirm when the beep sounds continuously rapidly (twice a second).

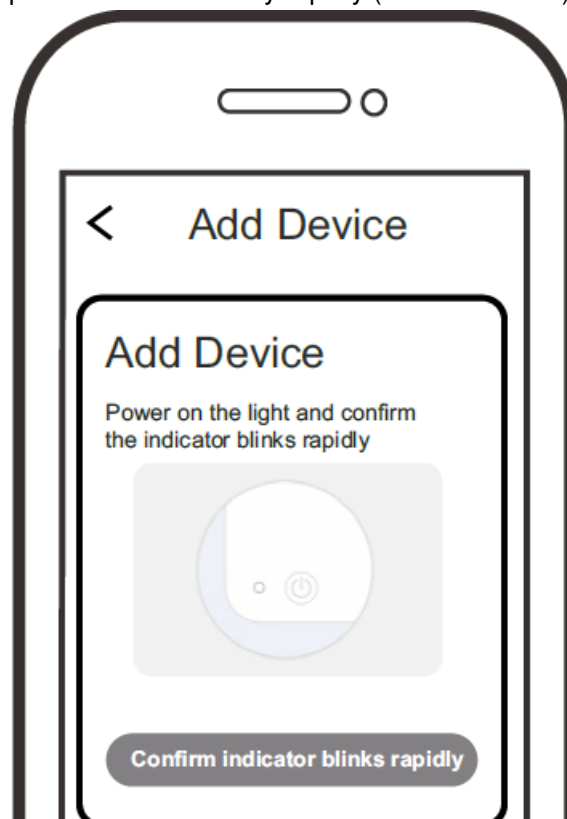

The connecting will take about 10-120 seconds to complete depending on your network condition.

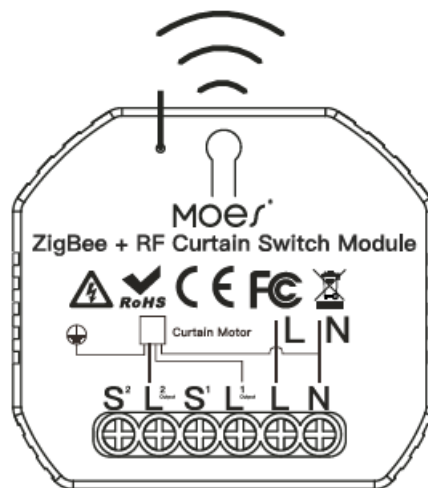
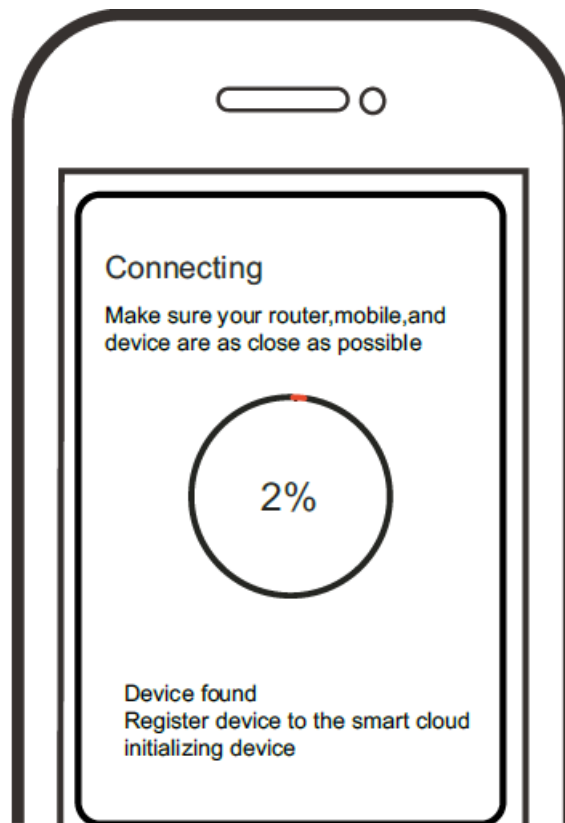

When pairing is done, the Zigbee switch will be shown on the App.



Connect to Amazon Alexa or Google Assistant for voice control, or share the devices with your families or friends.

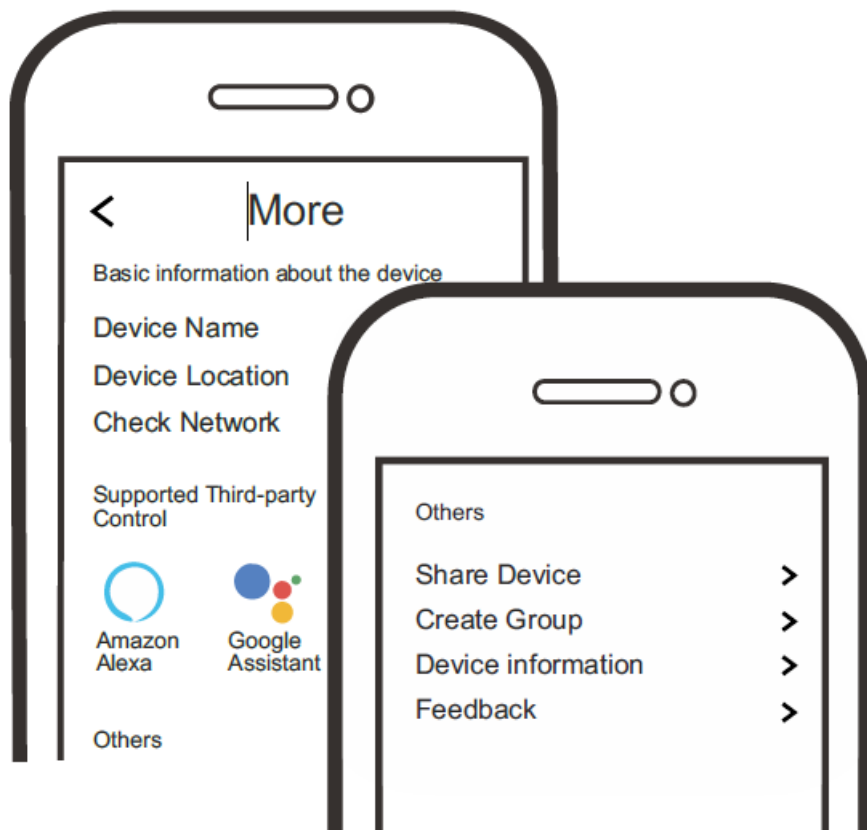

### RF Link Method (only for MS-108ZR)

1. Press the reset button for 5 times and wait for 2 seconds until the red indicator flashes fast to pair with the open button.
2. Press the reset button for 6 times and wait for 2 seconds until the red indicator flashes fast to pair with the close button.

3. Press the reset button for 7 times and wait for 2 seconds until the red indicator flashes fast to pair with the stop button.

## Reset Method

1. Press the reset button for more than 7 seconds to start to reset of Wi-Fi method.
2. Press the reset button for 10 times for clearing mode of RF.

## Documents / Resources

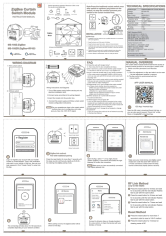
	<p><a href="#">ZigBee MS-108ZR Curtian Switch</a> [pdf] Instruction Manual MS-108ZR Curtian Switch, MS-108ZR, Curtian Switch</p>
---	--