

ZigBee Bridge Smart Home Gateway Hub



# ZigBee Bridge Smart Home Gateway Hub User Manual

[Home](#) » [zigbee](#) » ZigBee Bridge Smart Home Gateway Hub User Manual 

## Contents

- 1 ZigBee Bridge Smart Home Gateway Hub
- 2 Product Usage Instructions
- 3 Frequently Asked Questions
- 4 Distinguishing Feature
- 5 Works with Smart Life/Tuya
- 6 Works with Philips Hue
- 7 Works with Echo Plus
- 8 Works with SmartThings
- 9 Documents / Resources
  - 9.1 References
- 10 Related Posts

# ZigBee

**ZigBee Bridge Smart Home Gateway Hub**



## Product Specifications

- Works With: Smart Life, Philips Hue, Echo Plus, SmartThings
- Distinguishing Feature:
  1. Supports Smart Life, Philips Hue, Samsung SmartThings Hub, Amazon Echo Plus, Echo Show(2nd), or other HA and Zigbee 3.0 Hub
  2. Does not support all Zigbee gateways to work at the same time, can only choose one
  3. To connect, switch ON/OFF 3 times (on/off/on/off/on), switch light to breathing state, then connect

## Product Usage Instructions

### Works with Smart Life/Tuya

1. Connect Tuya Gateway (Zigbee) first
2. Click the Gateway, then select "Add subdevice"
3. Install the light and power on/off 3 times
4. Click "LED already blink"
5. You will find the device, then click "Done"

### Works with Philips Hue

1. Connect your Philips Hue Bridge
2. Install the light and power on/off 3 times
3. Open the Hue APP and go to settings – Light setup – Add light, then search
4. After waiting for a while, you will find a new device
5. Click on "Rooms & zones" – Create new – Create a new room, choose your light and save
6. If you want to use it with both Amazon Alexa and Philips Hue, enable Philips Hue skill in Amazon Alexa

### Works with Echo Plus

1. Connect Echo Plus first
2. Install the light and power on/off 3 times
3. Say "Alexa, discover my devices" and wait for about 45 seconds
4. Success, enjoy! You can also connect the light in the APP by going to More – Add a Device – Other – DISCOVER DEVICES

### **Works with SmartThings**

1. Connect your SmartThings Hub
2. Open the APP and click + – Device – SmartThings – Lighting – Smart Bulb
3. Install the light and power on/off 3 times
4. Then, click Start – Next – Skip this step – Skip – Done

### **Frequently Asked Questions**

#### **How many Zigbee gateways can I connect at the same time?**

You can only choose one Zigbee gateway to work with the product. It does not support multiple gateways simultaneously.

#### **How do I reset the device?**

The reset methods depend on the type of device:

- Sensor: Power on, then hold the RESET button for 5 seconds
- Socket: Power on, then hold the RESET button for 5 seconds
- Light Source: Power on, then turn OFF-ON-OFF-ON-OFF-ON-OFF-ON

#### **How do I add a device to my location?**

In the APP, go to More – Add – Device. Then, select the type of device you want to add and follow the instructions.

### **Distinguishing Feature**

1. Support smart life Philips Hue, Samsung SmartThings Hub, Amazon Echo Plus, Echo Show(2nd), or other HA and Zigbee 3.0 Hub.
2. Don't support all of the Zigbee gateways to work at the same time, can only choose one.
3. Switch ON/OFF 3 times( on\off/ on\off/on ), switch light to breathing state, then connect

### **Works with Smart Life/Tuya**

1. Please connect Tuya Gateway(Zigbee) first
2. Click the Gateway,—“Add subdevice”
3. Install the light and. POWER ON\OFF 3 TIMES
4. Click “LED already blink”
5. You will find the device, then click “Done”

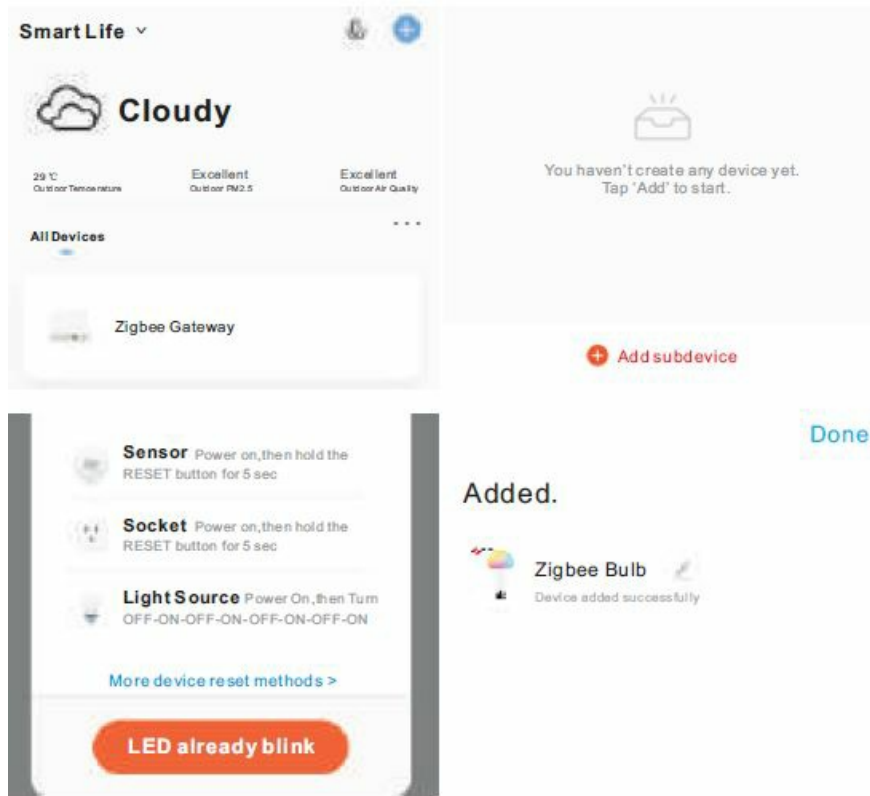

## Works with Philips Hue

1. Please connect your Philips Hue Bridge,
2. Install the light and. power on\off 3 times
3. Open the Hue APP, click on"settings"— "Light setup"—"Add light", and then search, After waiting for a while, you will find a new device.
4. Click on"Rooms&zones"—"Create new"— "Create new room" choose your light. Save.
5. If you want to use it in both Amazon Alexa and Philips Hue, you only need to enable the Philips Hue skill in Amazon Alexa.

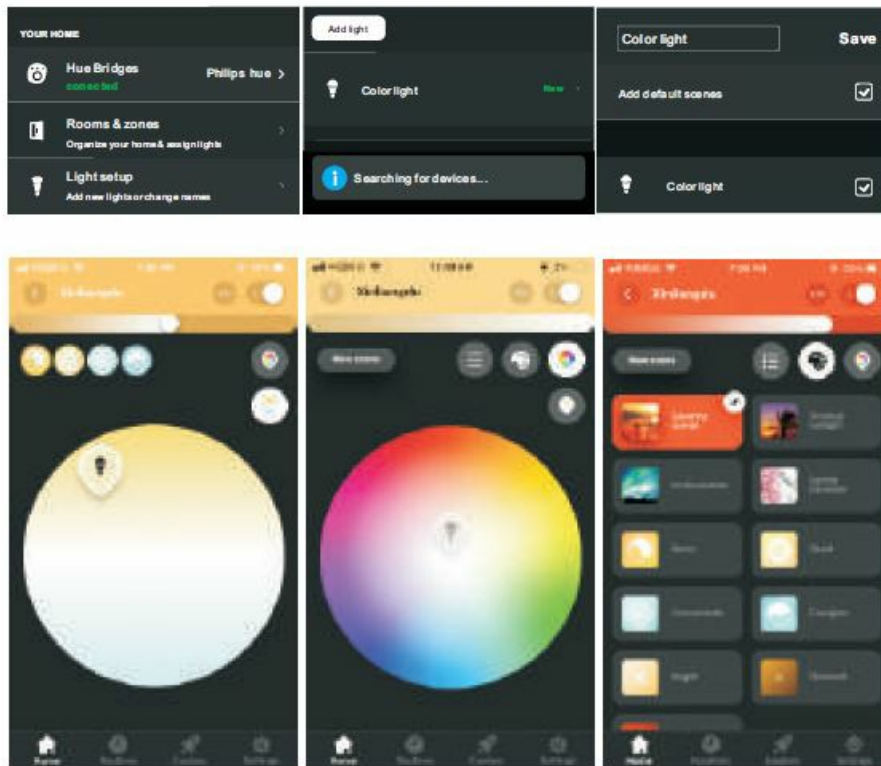

## Works with Echo Plus

1. Please connect Echo Plus first
2. Install the light and power on/off 3 times.



## Works with SmartThings

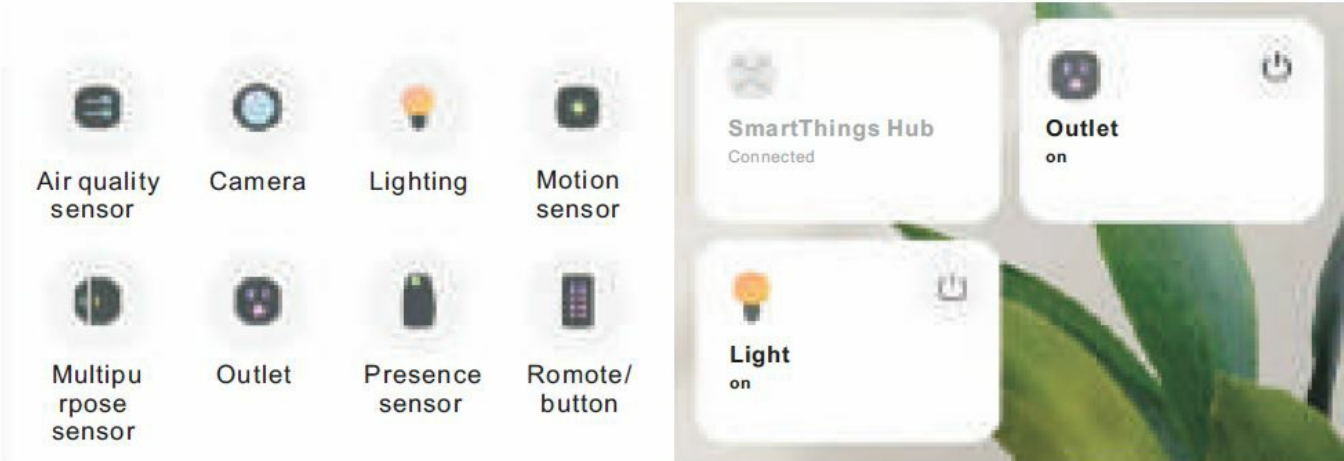
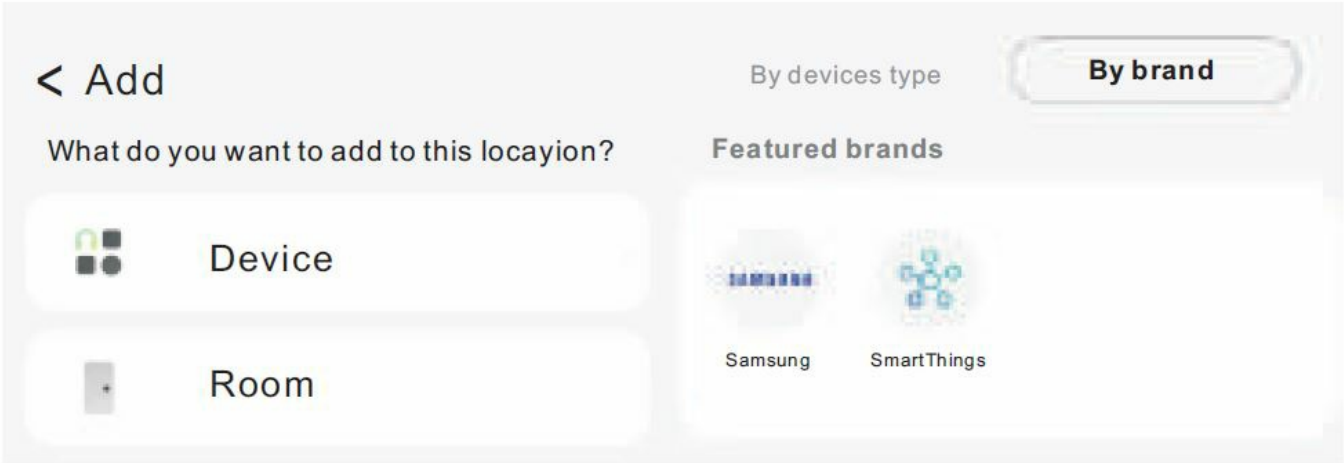

1. Please connect your SmartThings Hub,
2. Open the APP, click "+" — "Device" — "SmartThings" — "Lighting" — "Smart Bulb"
3. Install the light and. power it on/off 3 times.
4. Then, click "Start" — "Next" — "Skip this step" — "Skip" — "Done"



Documents / Resources



User Manual



Works with Smart Life

Works with Smart Life

Works with Smart Life

Works with Smart Life

[ZigBee Bridge Smart Home Gateway Hub](#) [pdf] User Manual

Bridge Smart Home Gateway Hub, Bridge, Smart Home Gateway Hub, Home Gateway Hub, Gateway HubHub

References

- [User Manual](#)

[Manuals](#), [Privacy Policy](#)

This website is an independent publication and is neither affiliated with nor endorsed by any of the trademark owners. The "Bluetooth®" word mark and logos are registered trademarks owned by Bluetooth SIG, Inc. The "Wi-Fi®" word mark and logos are registered trademarks owned by the Wi-Fi Alliance. Any use of these marks on this website does not imply any affiliation with or endorsement.