

Zhuhai Quin Technology D50 Smart Mini Label Maker Instructions

[Home](#) » [Zhuhai Quin Technology](#) » Zhuhai Quin Technology D50 Smart Mini Label Maker Instructions 

Instructions D50

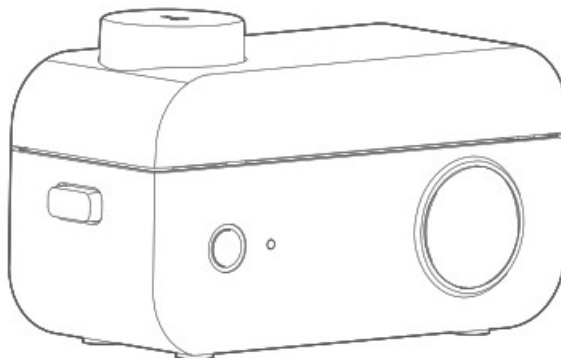

Please read this instruction book carefully before operating the product For more detailed information, please check the official website: www.phomemo.com



https://www.youtube.com/playlist?list=PL3_AhQ0D1H_BwlkzhFv8YQFvE4Tk3KBFM



Youtube Please scan the QR code to get the printer operation guide.

Contents

- 1 Packing list
- 2 Parts description/Appearance Introduction
- 3 Parts Description Power Button and Indicator light
- 4 APP Download Method
- 5 Boot Guide
- 6 Paper Roll Installation
- 7 Confirm the label size
- 8 Printing Guide identification label Paper
- 9 Printing Guide Select Edit Version
- 10 Printing Guide -Lite Mode
- 11 Printing Guide Creation Mode
- 12 Product specifications
- 13 Daily Cleaning
- 14 Solutions for Common Problems
- 15 After-sale support Product Warranty
- 16 After-sale support FCC Caution
- 17 After-sale support Maintenance Card
- 18 Documents / Resources
- 19 Related Posts

Packing list

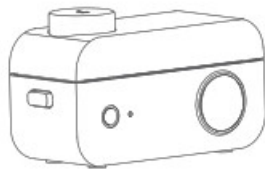

Printer*1



Product Instruction*1

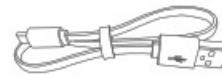

Power cord*1



NOTE

The number of paper rolls in the list is subject to the actual shipment

Parts description/Appearance Introduction

1. Parts description/Appearance Introduction

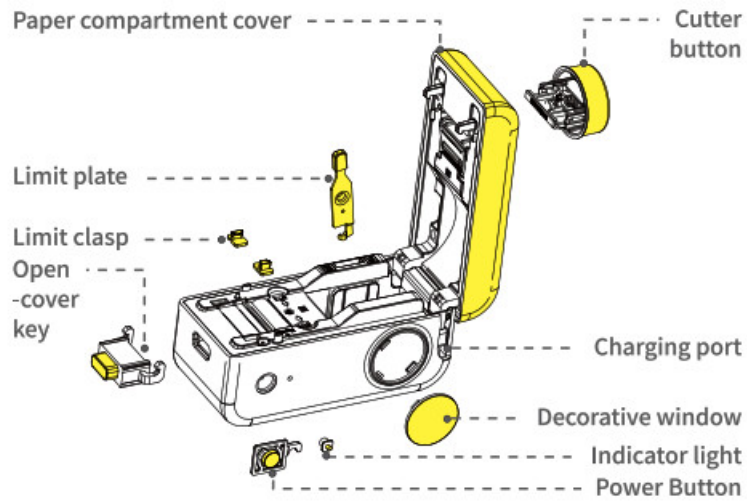

2. Label paper display various labels available for purchase

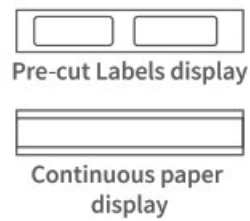

3. Continuous paper display

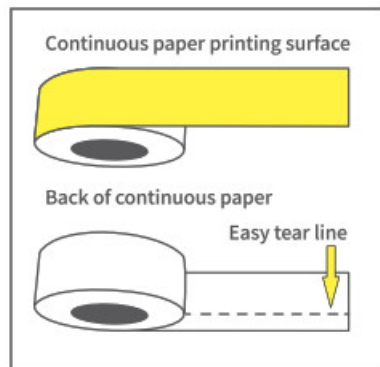

Easy to tear line design, easy to tear the bottom paper

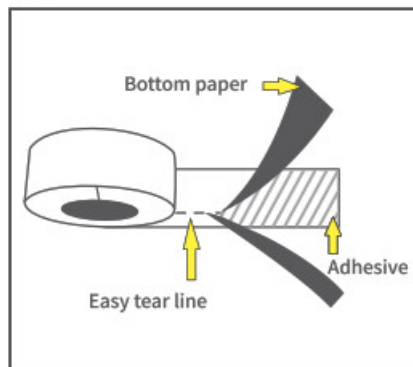

Gently bend the label paper along the easy-to-tear line to make it easier to peel the bottom paper from the adhesive

Parts Description



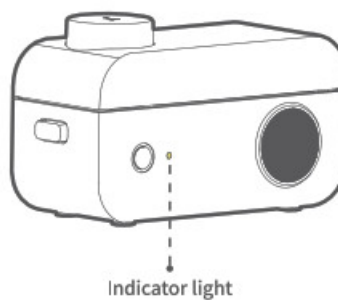



Power Button and Indicator light



Introduction of the function of the power button

Button	Operation Method	Functions
Power Button	Press and Hold 2s	Turn on/off
	Click	Print out the paper
	Double Click	Print the content of the self-test paper

Indicator light

 Greenlight keeps on	Normal status (printing)
 Greenlight flashes slowly	Charging with power on
 Greenlight flashes quickly	Charging with power off
 The red light keeps on	Error (lack of paper, cover opened, high temperature)
 Red light flashes slowly	10% battery
 Red light flashes quickly	5% battery

APP Download Method



Method 2: Search and download

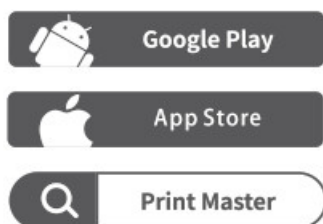

Method 1: Please use your mobile phone to scan the QR code to download the APP



NOTE

- This product needs to be connected to the printer in the APP;

- Due to the requirements of the mobile phone system, the Android mobile phone will use the user's geographic location when connecting, so the user needs to turn on the GPS and confirm the authorization

Boot Guide

1. Press and hold for 2s to turn on

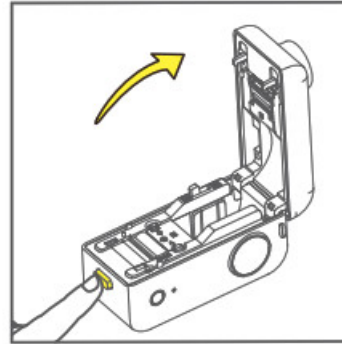
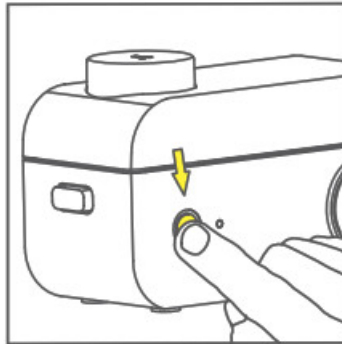

2. Press the open-cover key and open the paper hatch cover

Paper Roll Installation

1. Take out the label paper, tear off the anti-loosening sticker
2. Put the print side up in the paper hatch
3. Pass the label paper through the limit clasp

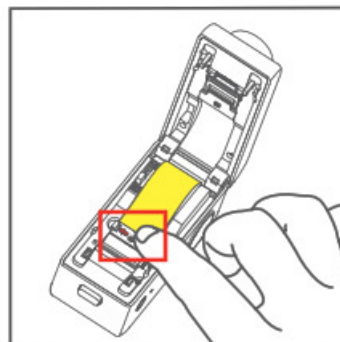
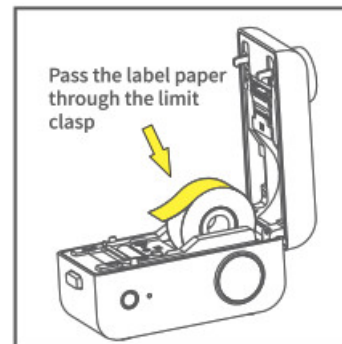
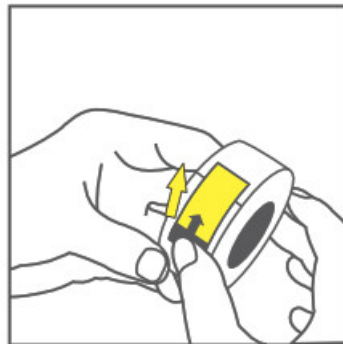

Note:

4. When the label paper width=16mm, please adjust the limit plate value to 16, and the limit clasp can shift in the

direction of the arrow inward

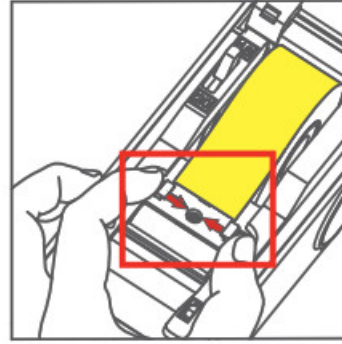
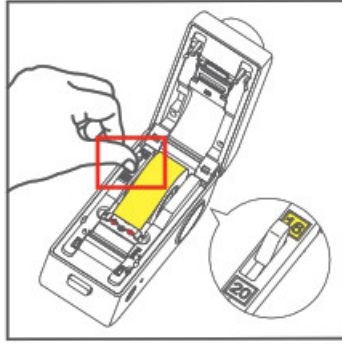

When the label paper width= 20mm/24mm, please adjust the limit plate value to 20, and slide the limit clasp in the direction of the arrow outward

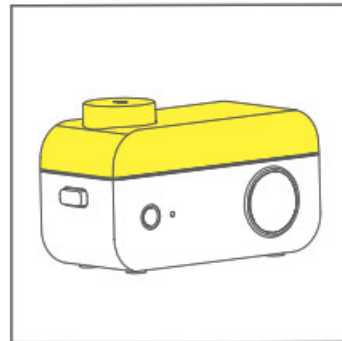
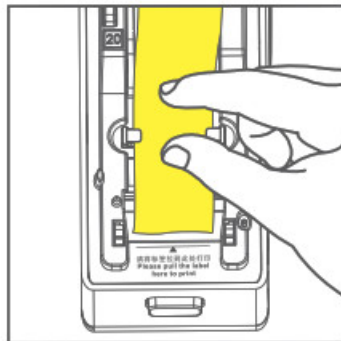
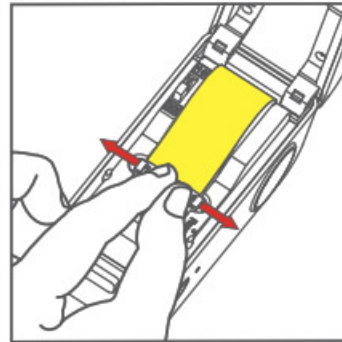
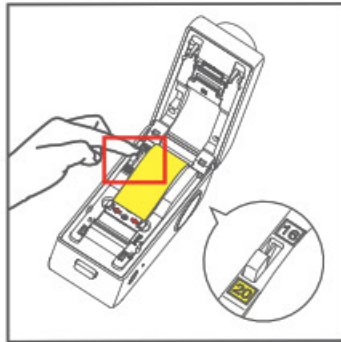

5. Pull out the label paper and pull it to the mark line at the outlet so that it can be printed normally click the power button to identify the label position
6. Close the paper hatch cover
7. Confirm the Label Size
8. Come out a piece of paper, positioning completed

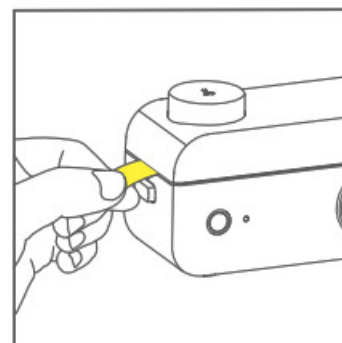
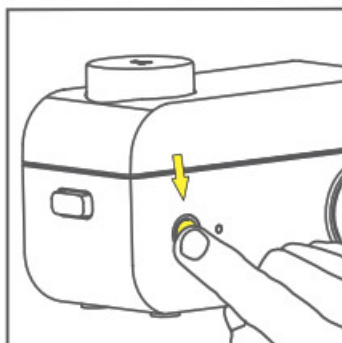



NOTE

- Gap label location identification is required when first installing or replacing label rolls (Step 07)
- If there is no gap label location identification (Step 07), there will be a problem that the first print is missing, and it is not in the middle, continuous papers do not need to click the power key locating, pulling to the prompt line location is enough Printer Connection

1. Turn on GPS (Android mobile phone only)

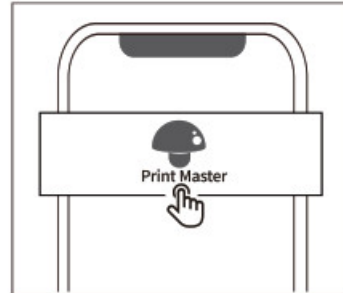
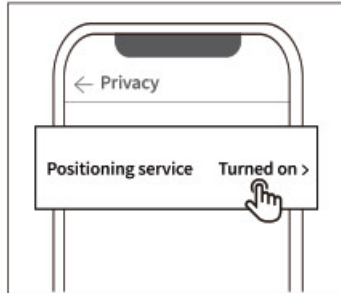

2. Open the APP



NOTE

- When connecting the device in the APP, please make sure that your printer is turned on and the Bluetooth of your mobile phone is turned on.
- Due to the requirements of the mobile phone system,the Android mobile I phone will use the user's geographic location when connecting,so that ' the user needs to turn on the GPS and confirm the authorization

3. Click to search for the device Connect ear

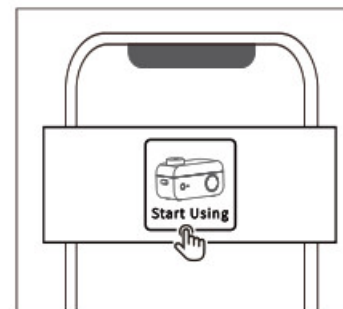
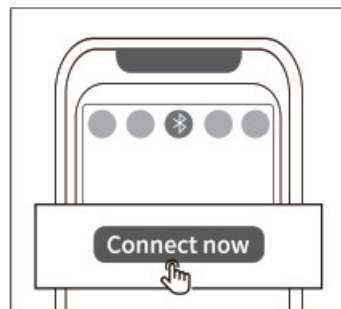

4. Connect immediately

Confirm the label size

Method 1: Check the label paper packaging 'please refer to the actual size used)

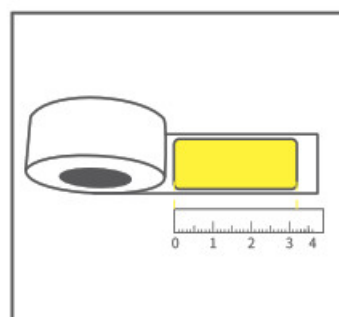
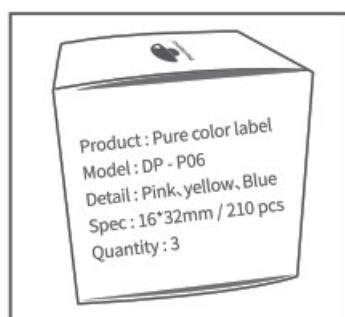

Method 2: Use a ruler to measure

Printing Guide identification label Paper

After the label paper is loaded, wait a few seconds for the machine to automatically identify the label paper template

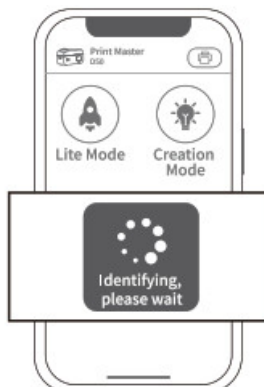

- If the identification of label paper is abnormal, you can manually select the label size and pattern or contact the official customer service

Printing Guide Select Edit Version

Lite Mode: Simple mode, convenient operation

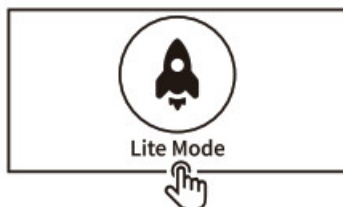

Creation Mode: Custom mode, Rich material

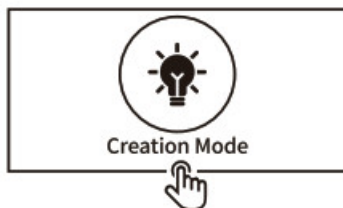

The user can view more operation tutorials and switch editing versions in the Profile

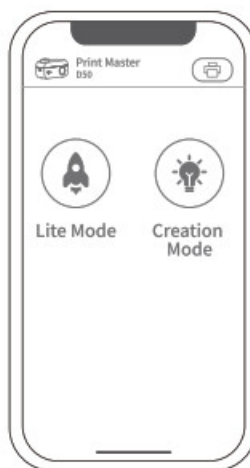

Printing Guide -Lite Mode

1. Select Edit Version -Lite Mode
2. If identification the dentition of label paper is abnormal, you can manually select the label template

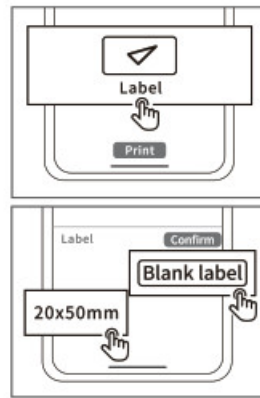
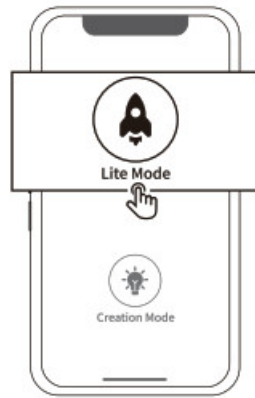



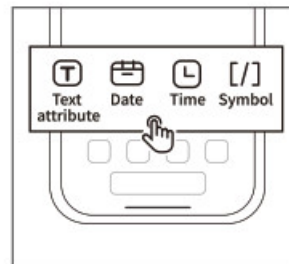

NOTE

If the matching template is not selected, there will be, undesirable situations such as the centered layout of printed, content, uneven layout, etc

3. Click the blank box to enter text
4. Edit function description.

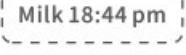
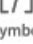
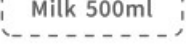

Functions	Operation method	Example
 Text attribute	Click to insert text. User can edit the text size, typesetting and select various fonts, etc	
 Date	Add date	
 Time	Edit specific time point	
 Symbol	Unit symbol	

5. After editing, click to "Print"
6. After the printing is completed, tear off the label

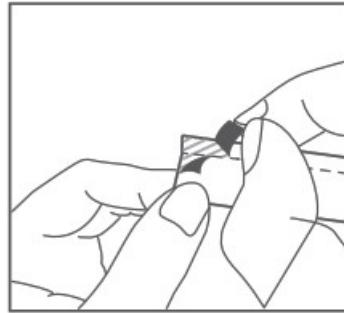
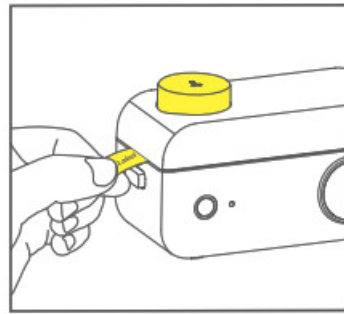
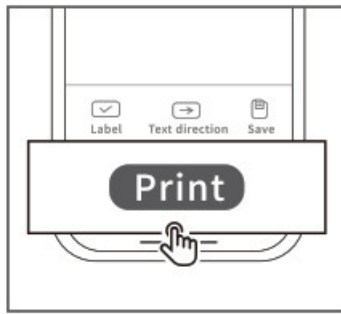

7. Continuous paper tears off the bottom paper

- Gently bend the label paper along the easy-to-tear line to make it easier to peel the backing

Printing Guide Creation Mode

1. Select Edit Version-Creation Mode
2. Click“(T)”to input text

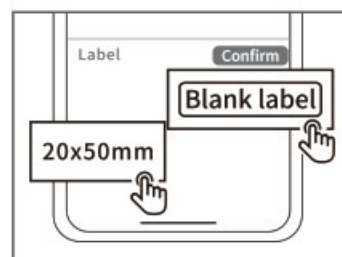
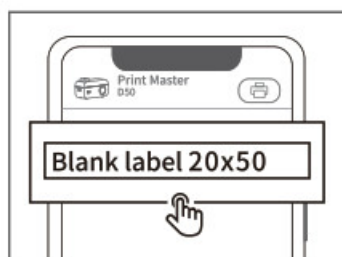
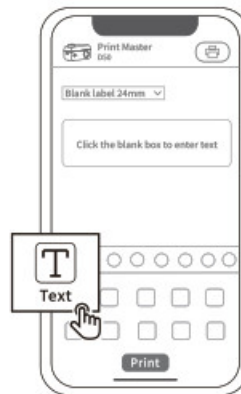
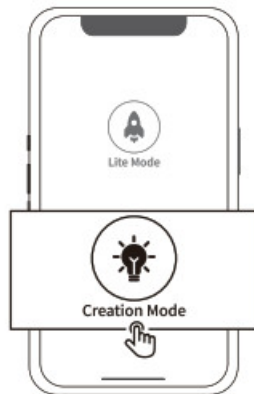

If the identification of label paper is abnormal, you can manually select the label template



NOTE

- If the corresponding size template is not recognized, please contact lp homemo service support in time

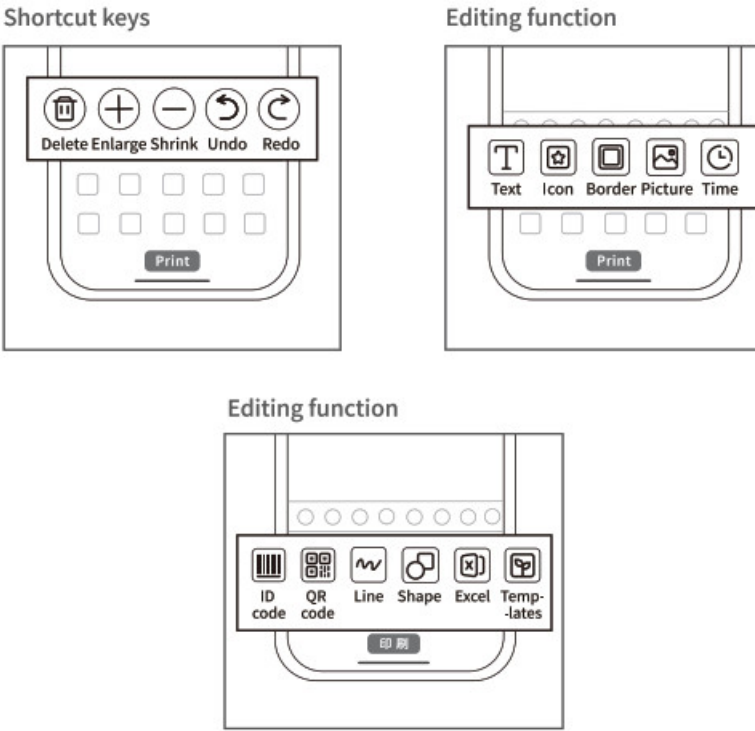

3. Edit function description



NOTE APP functions will be updated with new functions in irregular, please refer to the actual function

Functions	Description
<div>T</div> <div>☆</div> <div>□</div> <div>🖼️</div> <div>🕒</div> <div>📄</div> <div>📏</div> <div>🌿</div>	Click to insert text.User can edit the text size,typesetting and select various fonts, etc
	Icon function,click to insert all kinds of cute icons
	Click Border Function,and choose various cute borders to decorate your label
	Click to insert the picture you want to edit and print
	Insert date and specific time
	Click to scan the code to identify.It can quickly identify the text content in the QR Code
	One-click editing/printing of more scene label templates
	Click to insert a one-dimensional code. Enter the information to be edited. then a one-dimensional code can be automatically generated, and the layout can be adjusted
	Click to insert a QR code. Enter the information to be edited, then a QR code can be a utomatically generated,and the layout can be adjusted
	Insert a line. User can choose a dashed line or a solid line
	Click to insert round or square shapes
	Support table import, therefore quickly generating a list that needs to be printed



Click to recognize text in the picture

4. Click the print label after editing
5. After the printing is completed, tear off the label

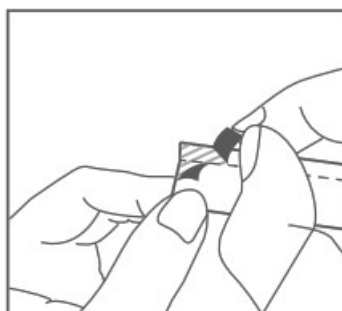
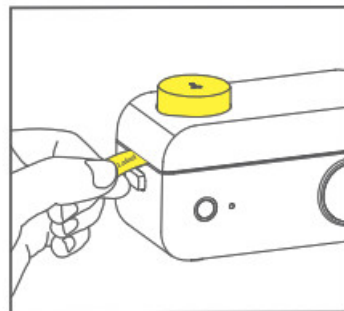
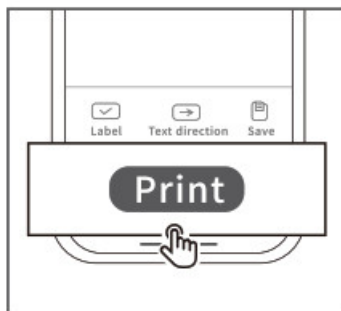

6. Continuous paper tear off the bottom paper

Gently bend the label paper along the easy-to-tear line to make it easier to peel the backing paper from the adhesive

Product specifications

Product name	Smart Mini Label Maker
Product model	D50
Printing technology	Thermal printing
Consumable width	16-24mm
Printing density	Light, standard, dark
Printing resolution	180dpi
Print head service life	50KM
Communication interface	Type-C
	Bluetooth 4.0
Product Size	118'51.5'69 mm (4.65'2'2.7 inch)
Power Input	5V =1A
Power supply method	Lithium battery
Supported operating system	Android
	iOS

Daily Cleaning

1. Turn off the printer
2. Use a cotton swab dipped in elite alcohol

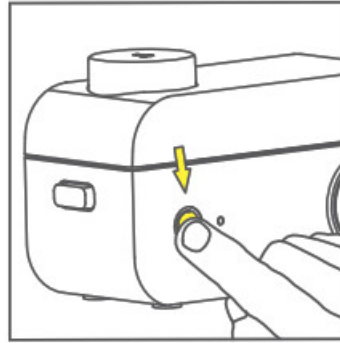
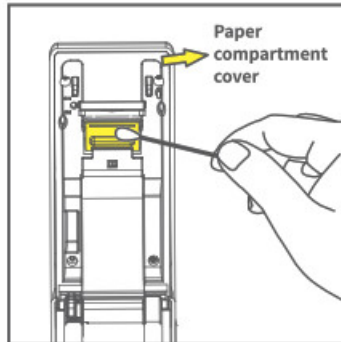
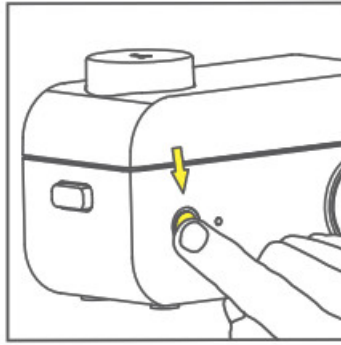

3. Wipe the print head gently
4. Wait for 30 s after the alcohol volatilize dry, boot double-click on the power button to print the self-checking page



NOTE

- Do not scratch the print head with a hard object, otherwise, the print head will be damaged and the printing effect will not be guaranteed

Solutions for Common Problems

Not centered, misplaced, offset, skipped, etc

Please check

Whether the paper roll is correctly placed in the machine?

Make sure that the label paper print face is placed in the machine in the direction of the battery. If the placement is error (reversed), it will not be printed.

Please check

Whether the APP IS Successfully recognize the paper roll?

This product supports automatic recognition of the official matching and sold paper roll patterns and sizes. If there is unrecognized and unable to print, please contact phomemo service support in time.

Please check

After the machine is turned on, whether to click the power button to allow the machine to calibrate and position the label? When installing or replacing label paper roll for the first time, the user needs to click the power button to print a blank label so that the print head can identify the position of the label paper. continuous papers do not need to click the power key locating, pulling to the prompt line location is enough.

Printing blurry

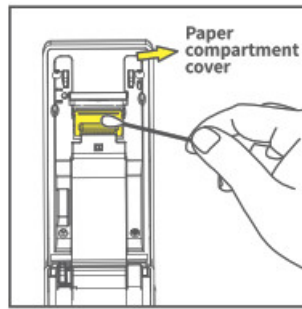

Please check

Whether the power of the machine is sufficient?

On the "Profile" page, click "Printer" to view the specific power level. If the remaining power of printer is less than 10%, you can charge it for at least half an hour before use.

Can't connect with the printer

Please check: The status of the printer is on, and the mobile phone bluetooth has been turned on?

Please check: Is the device connection performed in APP? This product needs to perform the device connection in APP.

Please check: Is the mobile phone authorized?

Because of the phone system's requirements, Android phones will use your location when it is connected, and you need to turn on GPS and confirm authorization (other phone systems don't need to turn on this function)

After-sale support Product Warranty

Thank you for choosing the Small Label Printer.

1. We will provide customers with reliable "replacement/return" support during the one-year warranty period from the date of purchase;
2. Please keep the warranty card in a safe place so that you can read it when needed.

support@phomemo.com

www.phomemo.com



Youtube Please scan the QR code to get the printer operation guide.

This manual has been carefully checked. If there are printing errors or misunderstandings in the content, please consult customer service.

NOTE: If the supporting software is updated, it will be compiled into the new version of the manual without notice



Operation Guide QR code

https://www.youtube.com/playlist?list=PL3_AhQ0D1H_BwlkzhFv8YQFvE4Tk3KBFM

After-sale support FCC Caution

This device complies with part 15 of the FCC Rules. Operation is subject to the following two conditions: (1) This device may not cause harmful interference, and (2) this device must accept any interference received, including interference that may cause undesired operation. Changes or modifications not expressly approved by the party responsible for compliance could void the user's authority to operate the equipment. Note: This equipment has been tested and found to comply with the limits for a Class B digital device, pursuant to part 15 of the FCC Rules. These limits are designed to provide reasonable protection against harmful interference in a residential installation. This equipment generates and can radiate radio frequency energy and, if not installed and used in accordance with the instructions, may cause harmful interference to radio communications. However, there is no guarantee that interference will not occur in a particular installation. If this equipment does cause harmful interference to radio or television reception, which can be determined by turning the equipment off and on, the user is encouraged to try to correct the interference by one or more of the following measures:

- Reorient or relocate the receiving antenna.
 - Increase the separation between the equipment and receiver.
 - Connect the equipment into an outlet on a circuit different from that to which the receiver is connected.
 - Consult the dealer or an experienced radio/TV technician for help.
- 'RF warning for Portable device: The device has been evaluated to meet general RF exposure requirements. The device can be used in portable exposure conditions without restriction.

After-sale support Maintenance Card

Replace

Return

Name: _____ Gender: _____ Phone: _____

User Information	Address:
Product Information	Date of purchase: Product order number : Product serial number:
Reason for Return (Replace / Repair / Request Maintenance)	Fault description:

Documents / Resources

	Zhuhai Quin Technology D50 Smart Mini Label Maker [pdf] Instructions D50, 2ASRB-D50, 2ASRBD50, D50 Smart Mini Label Maker, Smart Mini Label Maker, Label Maker
---	---