



# ZHIYUN ZHCMF03CMF04 TransMount Crane 3S Servo Zoom and Focus Motors User Guide

[Home](#) » [ZHIYUN](#) » ZHIYUN ZHCMF03CMF04 TransMount Crane 3S Servo Zoom and Focus Motors User Guide



**ZHIYUN-v1.10**  
**TransMount CRANE 3S Servo**  
**Zoom & Focus Motors**  
**User Guide**

## Contents

- [1 Product List](#)
- [2 Product Description](#)
- [3 Installation](#)
- [4 How to Use](#)
- [5 Product Specifications](#)
- [6 Disclaimer and Warning](#)
- [7 Safe Operation Guidelines](#)
- [8 Warranty Period](#)
- [9 Warranty Exclusions](#)
- [10 Warranty Claim Procedure](#)
- [11 Warranty Card](#)
- [12 Contact Card](#)
- [13 Warranty Card](#)
- [14 FCC Caution](#)
- [15 Documents / Resources](#)
- [16 Related Posts](#)

## Product List

Before using this product, please check carefully that all the following items are included in the product package. In case that any item is found missing, please contact ZHIYUN or your local selling agent.

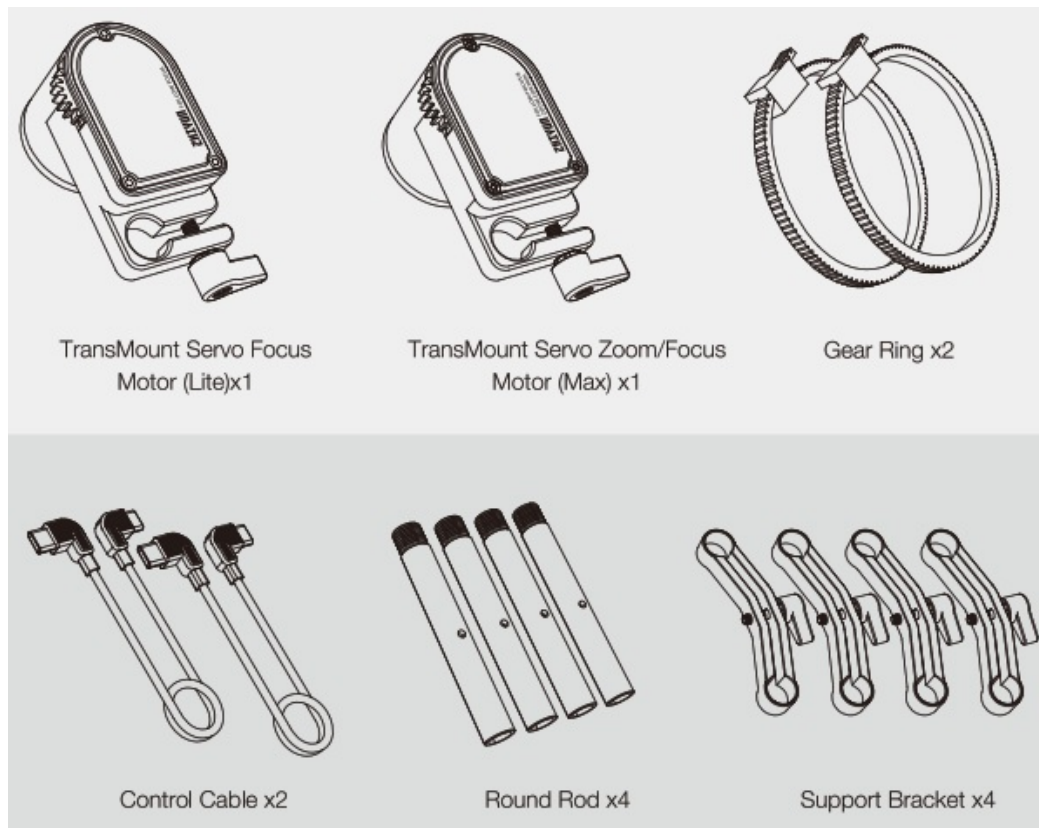

## Product Description

### TransMount Servo Focus Motor (Lite) x1 (model: CMF-03)

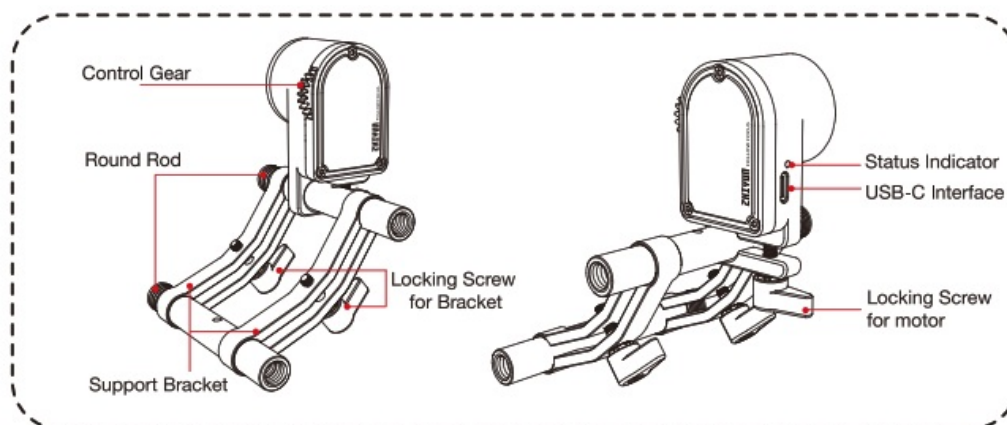

### TransMount Servo Zoom/Focus Motor (Max) x1 (model: CMF-04)

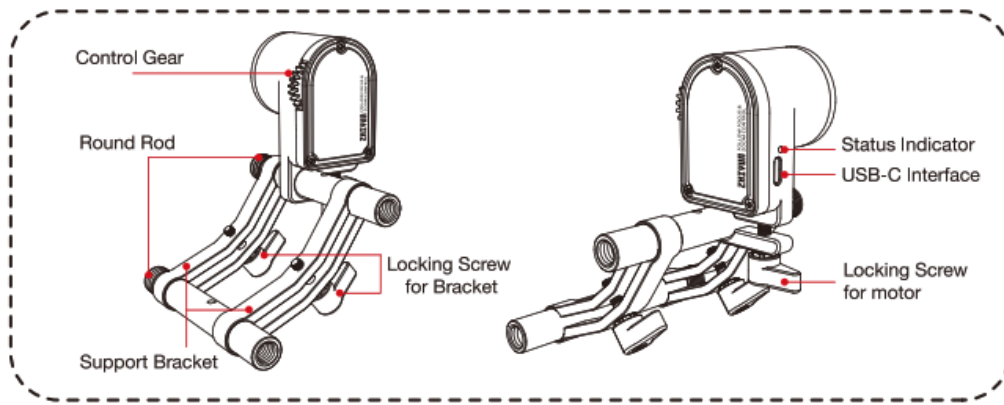

- **Locking Screw Specification:**

Locking Screw for Bracket: M4 x12

Locking Screw for motor: M4 x15

- **Round Rod Specification:**

Stud: M10 x1; screw tight in right direction

Threaded hole: M10 x1; screw tight in right direction

- **Status Indicator:**

Slow Blinking: Normal

Fast Blinking: In Upgrade

Solid Light: Malfunction



The lengths of the two locking screws are different. Please use them correctly.

## Installation

1. Install the round rods to the quick release plate. Screw tight the round rods with an M2.5 wrench to secure the setup.



2. Loosen the locking screws for the support brackets, then install the brackets to the round rods. Please make sure the first two support brackets are pressed tightly to the quick release plate. Finally, install two more round rods to the support brackets and tighten the screws for the support brackets.

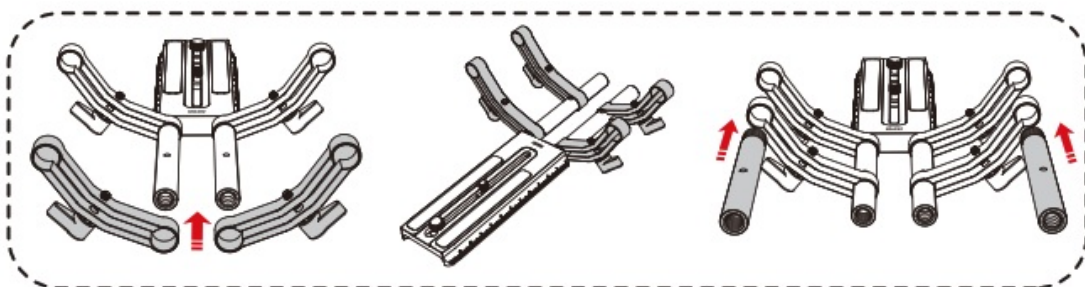

3. Loosen the locking screws for the motors, Lite and Max. Insert the motors to the appropriate positions on the round rods and tighten the screws.

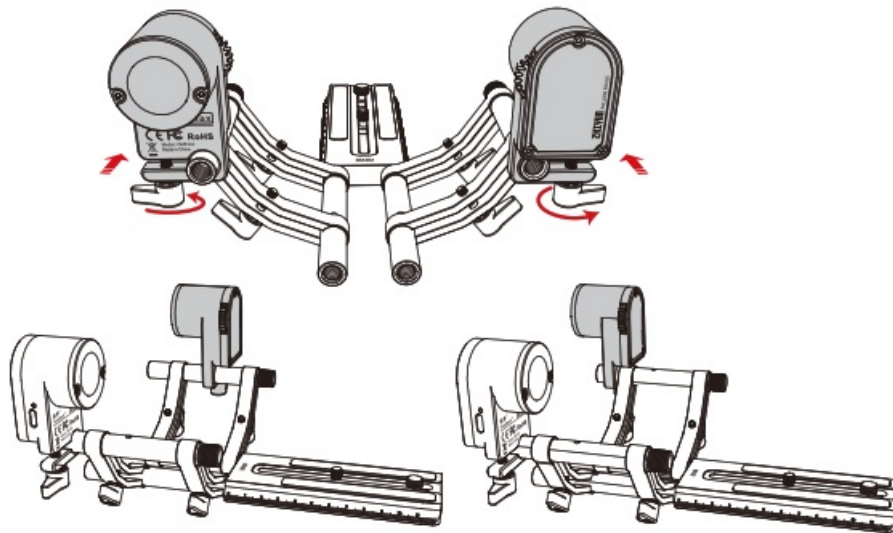

For cinema cameras, extend the round rods with the additional rods in the CRANE 3S package to allow more adjustment space for the motors. The specifications of round rods are the same.

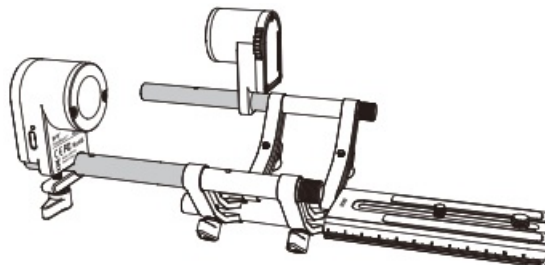

4. Install the lens support and lens support base plate to the ground rods. Adjust the lens support to an appropriate position. Install the lens support base plate to secure the whole setup.

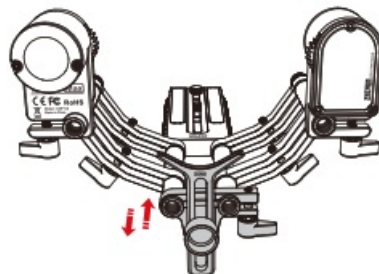

For cinema cameras and long-focus lens, extend the round rods with the additional rods in the CRANE 3S package to allow more adjustment space for the lens support. The specifications of round rods are the same.

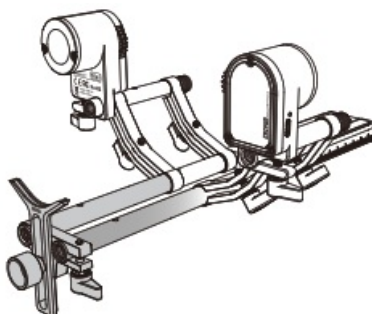

5. Untie the gear rings, fit them to the appropriate positions on the focus ring and zoom ring of the camera lens, then tighten the gear ring.

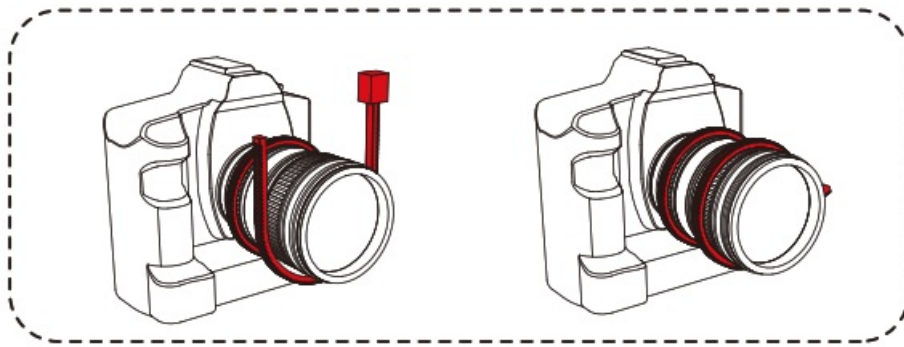

1. The control gears of the Servo Focus Motor and Servo Zoom/Focus Motor should fit the gear rings on the camera lens to ensure the two rings move synchronously and smoothly.
2. To avoid the tails of gear rings interfering with the rotation of the motors, before clamping the control gears with the gear rings, manually rotate the gear rings to confirm the start and end position of the focus range or the zoom range. Then adjust the tail positions of gear rings.
6. Loosen screws for the bracket to adjust the position of motors and the lens. Ensure the gear rings fit the control gears. lighten the screws. When the positions of motors and lens support are fixed, the motors are able to control the focus and zoom.

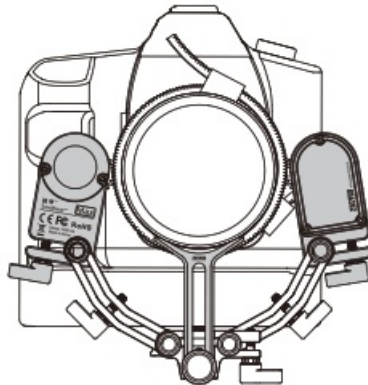

7. Mount the quick release plate with the camera and motors onto CRANE 3S. Follow the instruction to balance the setup.
8. Connect the motors and the stabilizer with USB-C cables.

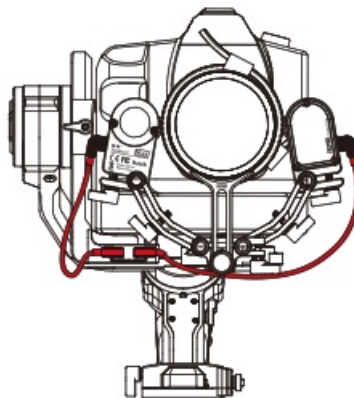

## How to Use

In a default situation, as long as the motors are properly connected to the stabilizer, they will be automatically turned on when the stabilizer is powered on. Rotate the focus wheel to adjust Servo Focus Motor (Lite). Press the zoom button to CRANE 3S to adjust Servo Zoom/Focus Motor (Max).



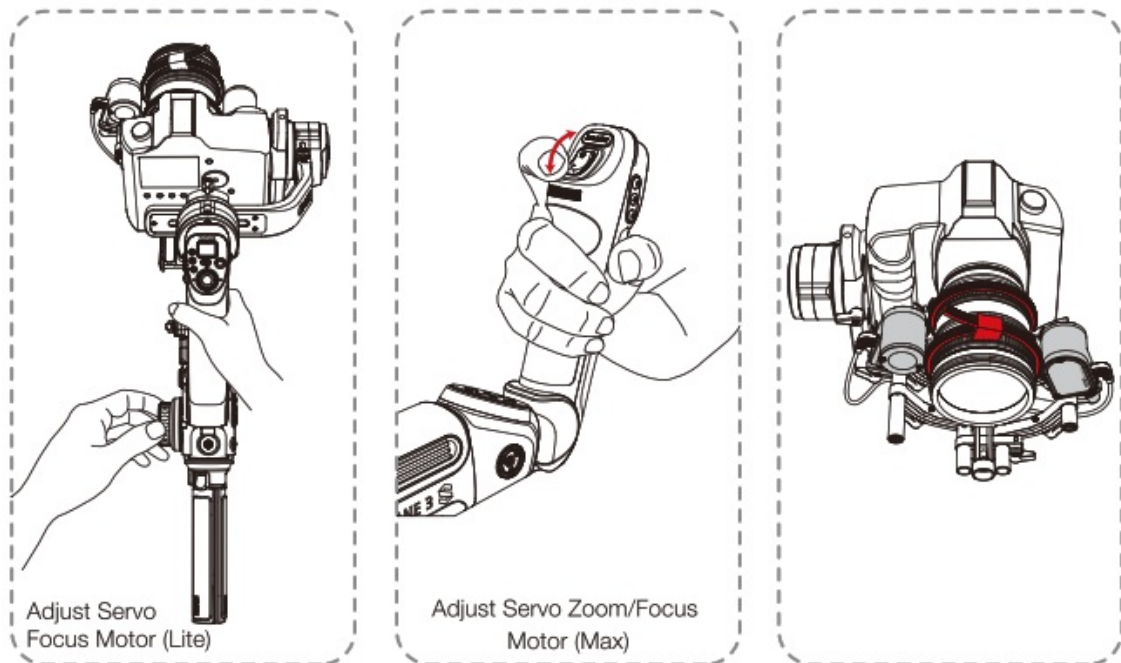

### Firmware Update

The firmware of motors is included in CRANE 3S firmware. If both firmware has been updated, you can directly update the firmware of the motor through CRANE 3S SmartSling Handle.

Connect Lite (CMF-03) or Max (CMF-04) to the stabilizer correctly (Note that the motors can be only updated one by one). Enter the menu to select focus>Lite>Max>upgrade. After selection, the status indicator of the motor blinks fast. Complete the update by restarting the stabilizer.

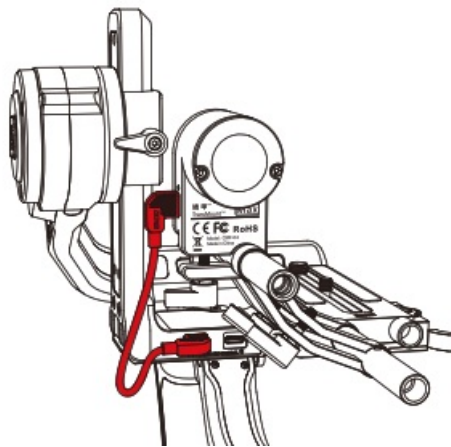

When updating the motor, please make sure the name of the motor corresponds to the one in the menu. Otherwise, the performance of the motor will be affected or malfunction of the motor will occur.

### Product Specifications

Product Model	CMF-03
Stabilizer Compatibility	CRANE 3 LAB, CRANE 3S
Weight of the motor	809
Gear	Gear Module: 0.8; Number of Teeth: 24
Product Model	CMF-04
Stabilizer Compatibility	WEEBILL LAB, WEEBILL-S, CRANE 3 LAB, CRANE 3S
Weight of the motor	100g
Gear	Gear Module: 0.8; Number of Teeth: 24

## Disclaimer and Warning



Thank you for purchasing TransMount CRANE 3S Servo Zoom & Focus Motors (herein referred to as Focus and Zoom Combo Kits). The information contained herein affects your safety, legitimate rights, and obligation. Please read this Instruction carefully to ensure proper configuration before use. Failure to read and follow this instruction and warnings herein may result in serious injury to you or bystanders, or damage to your device or property. Guilin Zhishen Information Technology Co., Ltd reserves all rights for a final explanation on this Instruction and other documents related to Focus and Zoom Combo Kits. The information is subject to update without notice. Please visit [www.Zhiyun-tecti.com](http://www.Zhiyun-tecti.com) to obtain the latest product information.

By using this product, you hereby signify that you have read this document carefully and that you understand and agree to abide by the terms and conditions herein. You agree that you are solely responsible for your own conduct while using this product, and for any consequences thereof. You agree to use this product only for purposes that are proper and in accordance with all terms, precautions, practices, policies and guidelines ZHIYUN has made and may make available.

ZHIYUN accepts no [ability for damage, injury, or any legal responsibility incurred directly or indirectly from the use of this product. Users shall observe safe and lawful practices including, but not limited to, those set forth herein.

ZHIYUN™, TransMount™ are the trademarks of Guilin Zhishen Information Technology Co., Ltd. (hereinafter referred to as “ZHIYUN” or “ZHIYUN TECH”) and its affiliates. All product names or trademarks referred to herein are trademarks or registered trademarks of their respective holders.

### Reading Tips

Legends:  Hints and Tips  Important

### Warnings

Read the ENTIRE User Guide to become familiar with the features of this product before operating. Failure to operate the product correctly can result in damage to the product or personal property and cause serious injury. This is a sophisticated product. It must be operated with caution and common sense and requires some basic mechanical ability. Failure to operate this product in a safe and responsible manner could result in injury or damage to the product or other property. This product is not intended for use by children without direct adult supervision. DO NOT use with incompatible components or in any way otherwise as mentioned or instructed in the product documents provided by ZHIYUN. The safety guidelines herein contain instructions for safety, operation, and maintenance. It is essential to read and follow all of the instructions and warnings in the User Guide, prior to assembly, setup or use, in order to operate the product correctly and avoid damage or serious injury.

## Safe Operation Guidelines

### CAUTION:

1. The Focus and Zoom Combo Kits are high-precision control devices. Damage may be caused to the Focus and Zoom Combo Kits if dropped or subject to external force, and this may result in malfunction.
2. Make sure the rotation of the gimbal axes is not blocked by external force when the Focus and Zoom Combo Kits are turned on.
3. The Focus and Zoom Combo Kits are not waterproof. Prevent contacts of any kind of liquid or cleaner with the Focus and Zoom Combo Kits. It is recommended to use a dry cloth for cleaning.
4. Protect the Focus and Zoom Combo Kits from dust and sand during use.

## Warranty Period

1. Customers are entitled to a replacement or free repair service in case of the quality defect(s) found in the product within 15 days upon receipt of the product.
2. Customers are entitled to free repair service from ZHIYUN for any product proven defective in material or workmanship that results in product failure during normal consumer usage and conditions within the valid warranty period, which is 12 months counting from the date of selling. However, the warranty period varies by product component and country of purchase. Please contact our after-sales service team on the ZHIYUN official website or your place of purchase for detailed warranty information.

## Warranty Exclusions

1. Products subjected to unauthorized repair, misuse collision, neglect, mishandling, soaking, accident, and unauthorized alteration.
2. Products subject to improper use or whose labels or security tags have been torn off or altered.
3. Products whose warranty has expired.
4. Products damaged due to force majeure, such as fire, flood, lightning, etc.

## Warranty Claim Procedure

1. If failure or any problem occurs to your product after purchase, please contact a local agent for assistance, or you can always contact ZHIYUN's customer service through email at [SERVICE@ZHIYUN-TECH.COM](mailto:SERVICE@ZHIYUN-TECH.COM) or website at [www.zhiyun-tech.com](http://www.zhiyun-tech.com).
2. Your local agent or ZHIYUN's customer service will guide you through the whole service procedure regarding any product issue or problem you have encountered. ZHIYUN reserves the right to reexamine damaged or returned products.

## Warranty Card

<b>Custom information</b> Customer Name: Address: Contact No :	<b>Sales Information</b> Sales Date : Dealer : Prod. Serial No : Contact No :	<b>#1 Maintenance Record</b> Service Date : Cause of Problem: Service Result : Signature of Repairman :
---	---	---

- solved
- Unsolved



- Refunded (Replaced)

## Contact Card

Scan the QR code below to stay tuned for more information on ZHIYUN.



Official website



Facebook  
( Zhiyun Tech )



Facebook  
( Zhiyun Support )



Instagram



YouTube

<http://zhiyun-tech.com/>

<https://www.facebook.com/ZhiyunGlobal/>

<https://www.facebook.com/officialzhiyunsupport/>

<https://www.youtube.com/channel/>

## Warranty Card

Tel: +86 (0) 773-3561275

USA Hotline: +1 808-319-6137, 9:00-18:00 GMT-7, Mon-Fri

Europe Hotline: +49 (0)6101 8132 180, 10:00-17:00 GMT+1, Mon-Fri

Email: [senrioe@zhiyun-tech.com](mailto:senrioe@zhiyun-tech.com)

Website: [www.zhiyun-tech.com](http://www.zhiyun-tech.com)

Address: 09 Huangtong Road, Tieshan Industrial Zone, Citing District, Guilin, Guangxi, China

Please download the latest version from [www.zhiyun-tech.com](http://www.zhiyun-tech.com)

This document is subject to change without notice.

ZHIYUNPTh TransMounPA is the trademark of Guilin Zhishen Information Technology Co., Ltd. (hereinafter referred to as "ZHIYUN\* or \*ZHIYUN TECH") and its affiliates. All product names or trademarks referred to herein are trademarks or registered trademarks of their respective holders. Copyright © 2020 ZHISHEN. All rights reserved.

Certificate of Quality This product is Manned 10 meet QUEILLY standards and pertained for sale Mee BIM Hampton.

Read EU Declaration of Conformity on User Guide on our official website at [www.zhiyun-tech.com](http://www.zhiyun-tech.com).

## FCC Caution

This device complies with part 15 of the FCC Rules. Operation is subject to the following two conditions: (1) This device may not cause harmful interference, and (2) this device must accept any interference received, including interference that may cause undesired operation. Any changes or modifications not expressly approved by the party responsible for compliance could void the user's authority to operate the equipment. Note: This equipment has been tested and found to comply with the limits for a Class B digital device, pursuant to part 15 of the FCC Rules. These limits are designed to provide reasonable protection against harmful interference in a residential installation. This equipment generates uses and can radiate radio frequency energy and, if not installed and used in accordance with the instructions, may cause harmful interference to radio communications. However, there is no guarantee that interference will not occur in a particular installation. If this equipment does cause harmful interference to radio or television reception, which can be determined by turning the equipment off and on, the user is encouraged to try to correct the interference by one or more of the following measures: -Reorient or relocate the receiving antenna. -Increase the separation between the equipment and receiver. -Connect the equipment into an outlet on a circuit different from that to which the receiver is connected. -Consult the dealer or an experienced radio/TV technician for help.

[zhiyun-tech.com](http://zhiyun-tech.com)

 <small>ENTER-UT-18</small>  TransMount CRANE 3S Servo Zoom & Focus Motors User Guide	<a href="#">ZHIYUN ZHCMF03CMF04 TransMount Crane 3S Servo Zoom and Focus Motors</a> [pdf] User Guide ZHCMF03CMF04, TransMount Crane 3S Servo Zoom and Focus Motors
---	--