



ZHIYUN COV-03 TransMount Video Transmission Transmitter User Guide

[Home](#) » [ZHIYUN](#) » **ZHIYUN COV-03 TransMount Video Transmission Transmitter User Guide** 

Contents

- [1 TransMount Video Transmission Transmitter \(AI\)](#)
- [2 Description of indicator lights and buttons](#)
- [3 Charging and Battery](#)
- [4 Installation and Use](#)
- [5 Firmware Upgrade](#)
- [6 Product Specifications](#)
- [7 Disclaimer and Warning](#)
- [8 Safe Operation Guidelines](#)
- [9 Documents / Resources](#)
- [10 Related Posts](#)

TransMount Video Transmission Transmitter (AI)

User Guide

The product package comes with the following items. If there are any missing items, please contact ZHIYUN or your local distributor.

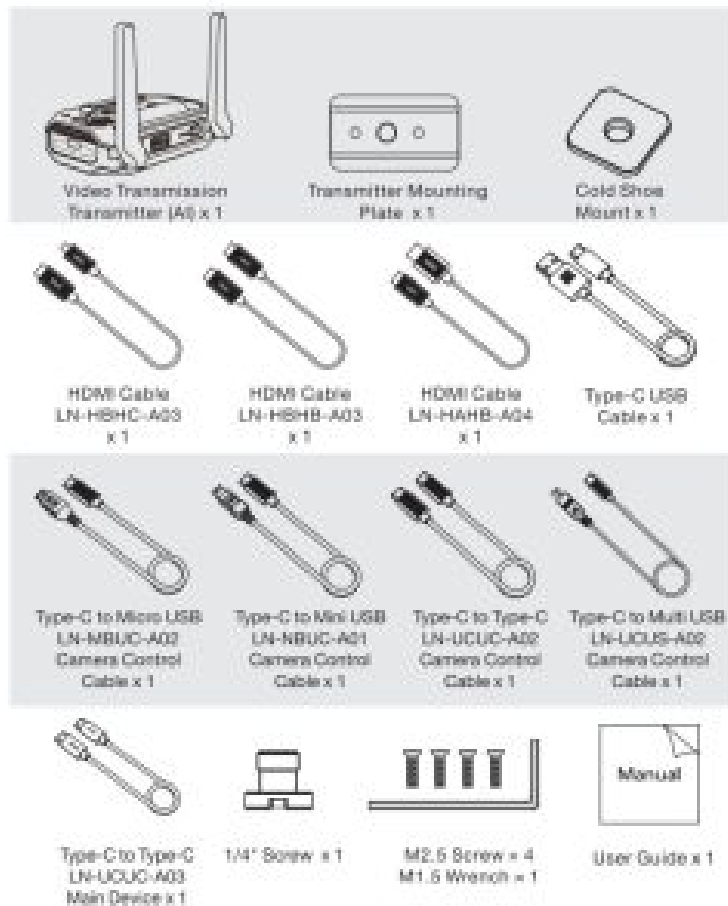

Please use the HDMI cables provided to achieve better performance. When using a non-ZHIYUN HDMI cable, channels 36 and 40 may not be available.

zhiyun-tech.com

Getting to know the TransMount Video Transmission Transmitter (AI) (hereinafter referred to as the “transmitter”)

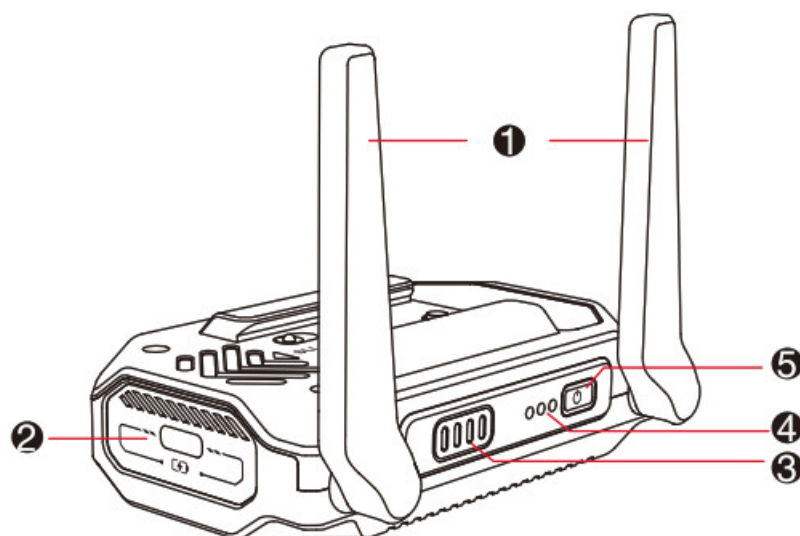

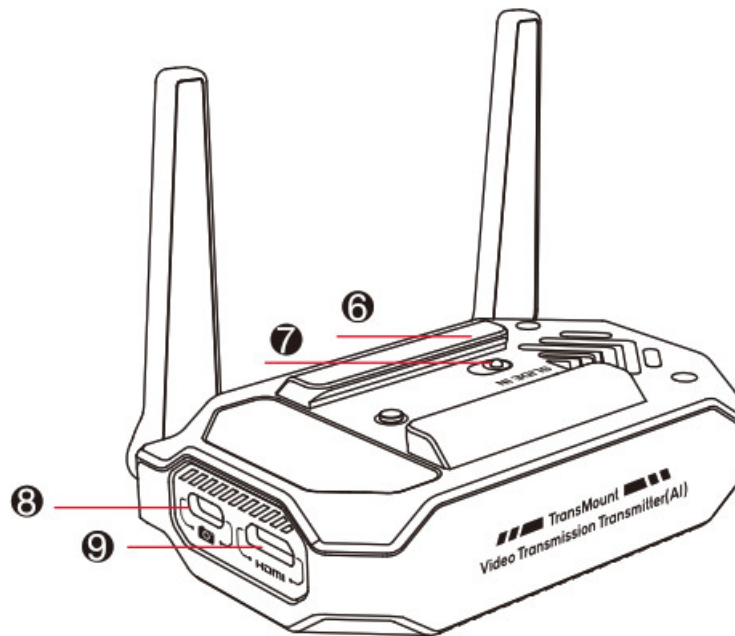

1. Antenna
2. Type-C charging/communication port
3. Battery indicator lights
4. Status indicator lights
5. Power Button
6. Mounting plate slot
7. safety lock
8. Type-C camera control port
9. HDMI video input port

Description of indicator lights and buttons

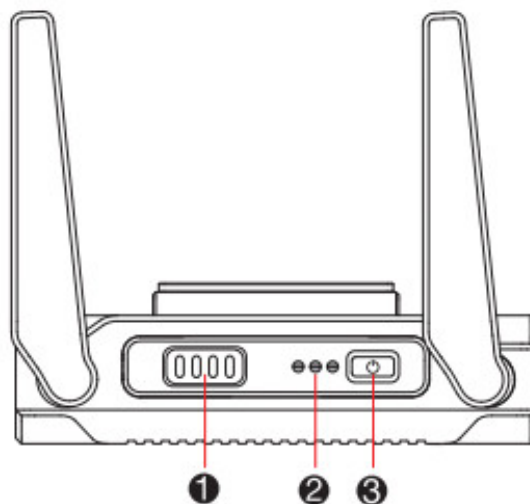

1. Battery indicator lights

Displays battery level after powering on. A steady red light indicates that the battery level is less than 10%. One solid white indicator light indicates that the battery level is at 10-25%. Two solid white indicator lights indicate that the battery level is at 25-50%. Three solid white indicator lights Indicate that the battery level is at 50-75%. Four solid white indicator lights indicate that the battery level is at 75-100%.

- When charging, the white lights will light up one by one. The four white lights will stay on after the device is fully charged.
2. Status indicator lights
- Greenlight [•]
- A steady light indicates that the Wi-Fi is working normally.
 - A slow blinking light indicates that the Wi-Fi is not ready. Blue light[•]
 - A steady light indicates that you are currently on the 5.2G frequency band.
3. Power button Key 
- Long press for three seconds to power the device on or off
 - After powering on, pressing the power button three times consecutively will toggle between the 5.2G and 5.8G frequency bands.
 - After powering on, pressing the power button five times consecutively will restore factory settings, reset Wi-Fi information, etc.

Charging and Battery

The transmitter uses built-in batteries. Before using it for the first time, please fully charge the transmitter to activate the battery and to ensure smooth use of the product. **Charging method:** Use the Type-C USB cable provided in the package to connect the adapter (5V/2A, not included with the product) to the Type-C charging/communication port on the transmitter. Charging is complete when the four battery indicator lights remain on.

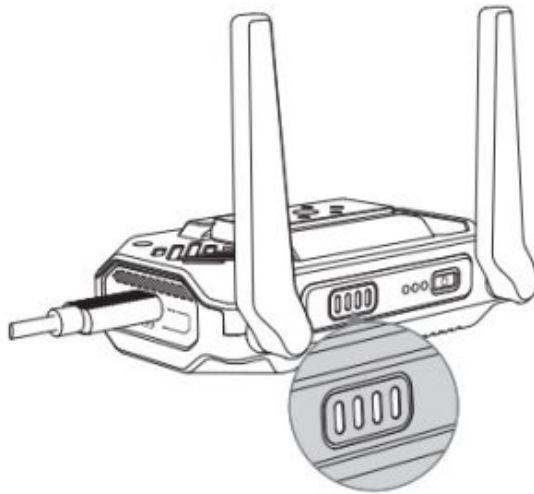

 it is recommended to fully charge the device before each use. The device performance will be affected if the battery is too low.

App Download



<https://api.zhiyun-tech.com/v1/r/QoOQGD>

Scan the QR code on the left (Android 5.0 and above or iOS 9.0 and above) or search for “ZY Play” in your phone’s app store to download the app.

1.  Users can make better use of the various functions of the transmitter with the dedicated “ZY Play” app.
2. The app is subject to updates. Please always refer to the latest version.

Installation and Use

Installing and connecting to the ZHIYUN CRANE 2S

1. This installation uses the ZHIYUN CRANE 2S as an example. Take out the transmitter mounting plate, two screws, and a wrench. Mount the transmitter mounting plate to the bottom of the CRANE 2S's quick release base (note the direction of the notch), and use the wrench to tighten the screws.

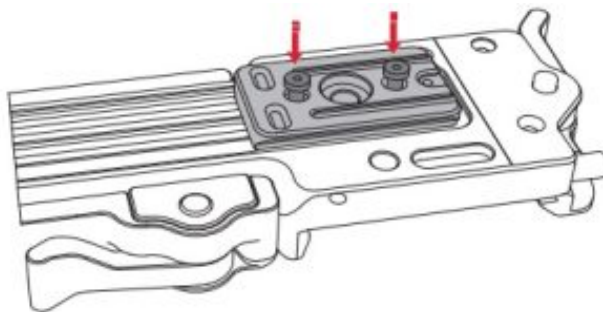

2. Place the transmitter with the mounting plate slot facing up, align the transmitter mounting plate, push the transmitter toward the tilt axis motor until it clicks into the safety lock, then rotate the antenna about 230° to complete the installation.

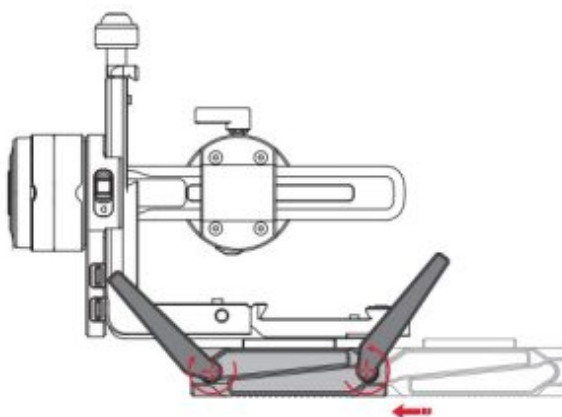

 The antenna can only be rotated in one direction, the maximum rotation angle is 270°. Please pay attention to the rotation direction.

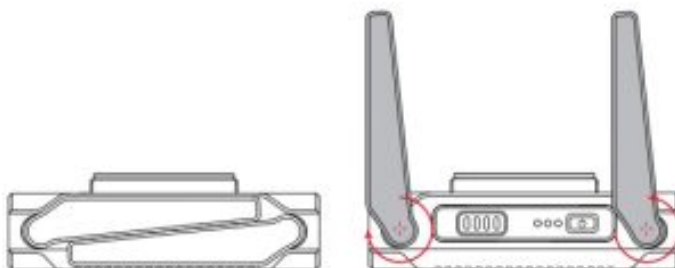

3. Take out the image transmission control cable (LN-UCUC-A03, Transmitter To stabilizer Only) , and connect the CRANE 2S camera control port to the transmitter's Type-C charging/communication port.

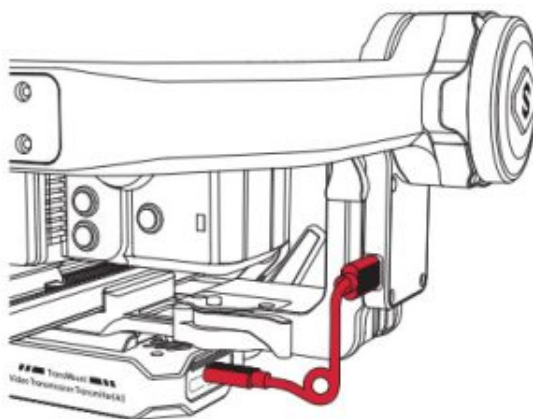

This cable is used for communication between the CRANE 2S and the transmitter. After connecting this cable, the CRANE 2S will supply power to the transmitter, which may have a slight effect on the battery life of the CRANE 2S.

4. Connect camera and transmitter with corresponding camera control cable and HDMI cable. Choose which camera control cable and HDMI cable to use according to camera USB port type and HDMI port type.

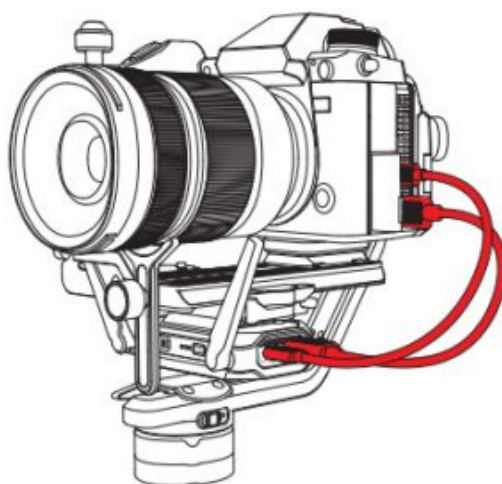

1. It is recommended that the CRANE 2S and transmitter be shut down and powered off before installing or removing the cable. The actual color of the wire is black. The red color used in the manual is only used for illustrative purposes.
2. After installing the equipment, you need to adjust the balance of the CRANE 2S. Refer to the CRANE 26 manual for instructions on how to do balance adjustment.

Using the ZHIYUN CRANE 2S

1. The ZHIYUN CRANE 2S is used as an example here. Turn on the CRANE 2S, enter the settings menu, select 'Camera Settings', and then select 'ccs (extension)'. Turn on the transmitter and camera. When the screen on the CRANE 2S displays a connection successful icon [i and emits a beep sound, you may then control the camera using the CRANE 2S handle.
2. Open the "ZY Play" app and select the product page corresponding to CRANE 2S. Tap 'Connect now', and select the CRANE 2S with the corresponding Bluetooth name.
3. After entering the image transmission interface on the app, click the Wi-Fi icon. Then, follow the prompts to connect to the transmitter's Wi-Fi (initial default password: 12345678). Click the image transmission icon to

begin image transmission. You can view the real-time image on the camera. and control camera recording and the rotation of the CRANE 2S gimbal through the app.



When using WEEBILL 2, the real-time footage of the camera can be viewed directly on the touch screen of WEEBILL 2 and can also achieve Smart Follow. For more details, please visit the official website of ZHIYUN (www.zhiyun-tech.com) to see the user guide of WEEBILL 2.

Installing and connecting to other devices

1. This installation takes the camera hot shoe as an example. Take out the transmitter, mounting plate, and a 1/4 screw. Mount the 1/4 screw on the transmitter mounting plate and cold shoe mount, and then mount them on the camera hot shoe as a whole (pay attention to the direction of the notch). Then, tighten the 1/4 screw.

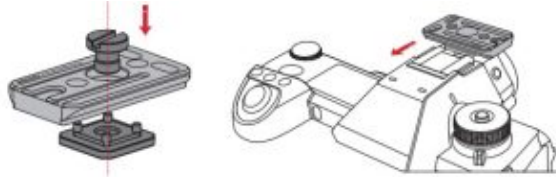

2. Place the transmitter with the mounting plate slot facing down, align the transmitter mounting plate, push the transmitter until it clicks into the safety lock, then rotate the antenna about 90° to complete the installation.

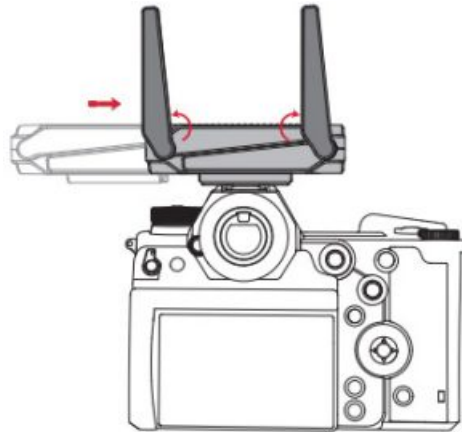

3. Connect camera and transmitter with corresponding camera control cable and HDMI cable. Choose which camera control cable and HDMI cable to use according to camera USB port type and HDMI port type.

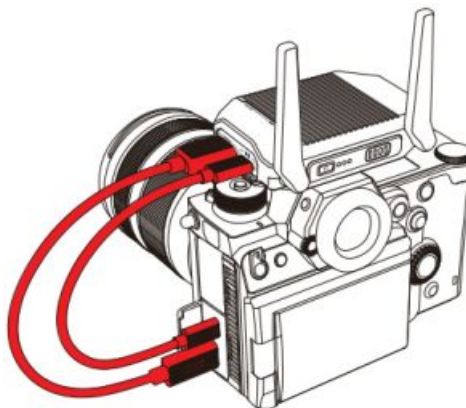

You can use a standard Type-C USB data cable to connect the transmitter's Type-C charging/communication port to a power bank or power adapter (not included in the package). This data cable is used for the power supply. Standard output voltage and current of the power bank or power adapter: 5V 2A.

Using with other devices

1. Power on the transmitter and the camera.

2. Open the Wi-Fi settings on your mobile phone and connect to the transmitter's Wi-Fi (initial default password: 12345678). Open the "ZY Play" app, select the product page corresponding to the transmitter, and click 'Connect Now'.
3. After entering the image transmission interface on the app, click the image transmission icon (S) to begin image transmission. You can view the real-time image on the camera, and control camera recording through the app.



1. The Wi-Fi name of the transmitter can be viewed on the transmitter label sticker (USER ID: XXXX).
2. Video transmission supports HDMI output to P format cameras but does not support I format output cameras. Video transmission resolution depends on the camera's HDMI output. 1080P is recommended.
3. During image transmission, the DSLR camera needs to be adjusted to live view mode before the HDMI signal can be output normally. 0 The transmitter only supports simultaneous connection with up to three mobile devices. The first device connected will be able to control the transmitter and camera.



For examples and details on how to use the control cables, refer to the "TransMount Image Transmission Transmitter 2.0 Camera Compatibility List" on the official website.

Control cable names	Type-C to Micro USB LN-MBUC-A02		Type-C to Mini USB LN-NBUC-A01	Type-C to Type-C LN-UCUC-A02	Type-C to Multi USB LN-UCUS-A02
Camera interface type	Micro USB		Mini USB	Type-C	Multi USB
HDMI cable names	HDMI Mini to HDMI Mini LN-HBHB-A03			HOW Mini to HDMI TYPE A LN-HAHB-A04	HDMI Mini to HDMI Micro LN-HBHC-A03
Camera HDMI port types	MINI HDMI			HDMI	MICRO HDMI
Camera brands and models	Nikon	Canon		Panasonic	Sony
	0850	5D Mark IV	6D Mark II	S1H	A7RM3

Firmware Upgrade

Method 1: Upgrade using the carrier's network.

1. Power on the transmitter and connect to the carrier's network on your mobile phone.
2. Open the Wi-Fi settings on your mobile phone and connect to the transmitter's Wi-Fi (initial default password: 12345678). Open the "ZY Play" app and select the product page corresponding to the transmitter.
3. If the "ZY Play" app prompts that the firmware can be upgraded, tap to begin the operation. The transmitter will automatically shut down after the upgrade has successfully completed.



This method is only available for mobile phones that can still use the carriers' network to browse the web after the mobile phone Wi-Fi has been connected to the transmitter, such as some iPhones.

Method 2: Upgrade using the router's Wi-Fi network.

1. Power on the transmitter.
2. Open the Wi-Fi settings on your mobile phone and connect to the transmitter's Wi-Fi (initial default password: 12345678). Open the 'ZY Play' app and select the product page corresponding to the transmitter. When you are prompted to "Enter now", exit the 'ZY Play' app.
3. Open the Wi-Fi settings on your mobile phone and connect to the router's Wi-Fi network. Open the "ZY Play" app again. If the 'ZY Play' app prompts you to upgrade the firmware, tap to download the upgraded firmware.
4. After the download, open the Wi-Fi settings on your mobile phone. Connect to the transmitter's Wi-Fi and return to the 'ZY Play' app. Select the upgrade operation. The transmitter will automatically shut down after the upgrade has been completed successfully.



Before upgrading the firmware, please ensure that the transmitter has more than 50% power remaining. Do not exit the app interface or switch the app to the background during the upgrade process. Pay attention to the app prompts.

Product Specifications

Product model: Cov-03

	Standard	Notes
Charging Voltage (Input)	5V	
Charging Current (Input)	2A	
Power consumption	<6W	
Power output voltage (Camera control interface)	5V	
Power output current (Camera control interface)	500mA	
Input resolution	1080P/720P/576P/480P	

Input frame rate	60/59.94/50/30/29.97/25/ 24/23.98fps	
Output resolution	1080P/720P/576P/480P	
Output frame rate	30/25fps	
Charging Temperature	0-45°C	
Operating temperature	-10°C-50°C	
Battery Capacity	3100mAh	
Operation Time	3h	
Charging Time	2.5h	
Operation Frequency	5.15GHz-5.25GHz (For Japan) 5.725GHz-5.825GHz	
Effective Isotropic Radiated Power (EIRP)	5.15GHz-5.25GHz <23dbm (CE) 5.725GHz-5.825GHz <14dbm (CE) 5.15GHz-5.25GHz <23dbm (SRRC) 5.725GHz-5.825GHz <27dbm (SRRC)	
Product dimensions (L x W x H)	91*66*27.	With dovetail slider
Product Net Weight	≈150g Without dovetail	slider
Antenna rotation angle	270° Only rotates in	one direction
Transmission distance	0-100m	Without interference in an open space

Disclaimer and Warning

Thank you for purchasing the TransMount Video Transmission Transmitter (AI). The information contained herein

relates to your safety and your legal rights and responsibilities. Read this entire document carefully to ensure proper configuration before use. Failure to read and follow the instructions and warnings herein may result in serious injury to you or bystanders, or damage to the transmitter or other property. ZHIYUN reserves the right of final interpretation for this document and all relevant documents relating to the transmitter, and the right to make changes at any time without notice. This document is subject to update without notice. Please visit www.zhiyun-tech.com for the latest product information. By using this product, you hereby signify that you have read this document carefully and that you understand and agree to abide by the terms and conditions herein. You agree that you are solely responsible for your own conduct while using this product, and for any consequences thereof. You agree to use this product only for purposes that are proper and in accordance with all terms, precautions, practices, policies, and guidelines ZHIYUN has made and may make available.

Except for what is mandated by the laws and regulations of the People's Republic of China, ZHIYUN accepts no liability for damage, injury, or any legal responsibility incurred directly or indirectly from the use of this product. Users shall observe safe and lawful practices including, but not limited to, those set forth herein. ZHIYUN™ and TransMount™ are the trademark of Guilin Zhishen Information Technology Co., Ltd. (hereinafter referred to as

"ZHIYUN" or "ZHIYUN TECH") and its affiliates. All product names or brands referred to hereunder are trademarks or registered trademarks of their respective holders.

Reading Tips

Legends:



Hints and Tips



Important

Scanning the OR code, while you are on the carrier's network, may incur data charges, which will be charged by your network carrier. It is recommended to perform the operation while connected to Wi-Fi.

Warnings

The transmitter is a high-precision device. Users should be equipped with basic hands-on skills and common safety knowledge, and the device should be used with care. Read the entire transmitter user guide to become familiar with the features of this product before operating it. Failure to operate the product correctly can result in damage to the product or personal property, or cause serious injury. This product is not intended for use by children. Do not use the transmitter with incompatible components or in any way that does not follow the safety guidelines in the product documentation provided by ZHIYUN. The safety guidelines herein contain instructions for safety, operation, and maintenance. It is essential to read and follow all of the instructions and warnings in the user guide prior to assembly, setup, or use of the transmitter, in order to operate the product correctly and avoid damage or serious injury.

Safe Operation Guidelines

Note:

1. The transmitter is a high-precision control device. Damage may be caused to the transmitter if it is dropped or subject to external force, and this may result in the device malfunctioning.
2. the transmitter is not waterproof. Do not let the transmitter come into contact with any kind of liquid, including cleaning liquids. It is recommended to use a dry soft cloth to clean the transmitter.
3. Protect the transmitter from dust and sand during use.

Caution: In order to avoid fire, property loss, and personal injury, the following safety guidelines must be followed during battery use, charging and storage.

Use: Ensure that the battery is fully charged before use.

Charging: The battery will automatically stop charging when it is fully charged. After charging is complete, disconnect the battery from the charger.

Storage:

1. If leaving the product unused for over 10 days, discharge the battery to 40%-65% for storage, which can extend the battery life.
2. When the battery voltage is too low, the 2 batteries will enter a low power consumption mode. Charge the battery to exit low power consumption mode.

Maintenance:

1. Do not overcharge or over-discharge the battery, or it may cause damage to the batteries.
2. Battery performance may be affected if they are not used for a long time.
3. Do not use in environments where the temperature is too high or too low.
4. Charge and discharge every 3 months or so to keep the battery active.

Disposal:

1. Completely discharge the battery before disposing of the battery in designated battery recycling bins. Batteries are hazardous chemical products, and disposing of them in ordinary trash cans is strictly prohibited. For more details, please follow your local laws and regulations on battery recycling and disposal.
2. Do not dispose of the battery directly in the battery recycling bin if the battery cannot be discharged completely; contact a professional battery recycling company for further processing.

Warranty Period

1. Customers are entitled to a replacement or free repair services for product defect(s) found within 15 days upon receipt of the product.
2. The default warranty period for products that are properly used and maintained is one year from the date of receipt. The warranty period may vary due to differences in product parts, and laws and regulations of different countries and regions. For details on the warranty periods in specific regions, consult the official ZHIYUN website or the ZHIYUN authorized dealer where the purchase was made.

Warranty Exclusions

1. Products subjected to unauthorized repair, misuse, collision, neglect, mishandling, soaking, accident, and unauthorized alteration.
2. Products subject to improper use or whose labels or security tags have been torn off or altered.
3. Products with an expired warranty.
4. Products damaged due to force majeure, such as fire, flood, lightning, etc.

To obtain ZHIYUN warranty service, please follow the steps below

1. If the product fails or if any problem occurs after purchasing the product, please contact a local authorized ZHIYUN distributor for assistance. If there is no local authorized ZHIYUN distributor, you may also contact ZHIYUN's customer service via email at info@zhiyun-tech.com or through ZHIYUN's website at

www.zhiyun-tech.com.

2. Your local distributor or ZHIYUN's customer service will guide you through the whole service procedure regarding any product issue or problem you may encounter. ZHIYUN reserves the right to reexamine damaged or returned products.

Contact Card

Scan the QR code below to stay tuned for more information of ZHIYUN.

 <p>Official website</p> <p>http://zhiyun-tech.com/</p>	 <p>Facebook (Zhiyun T</p> <p>https://www.facebook.cc</p>
 <p>Instagram</p> <p>https://www.instagram.com/zhiyun_tech/</p>	 <p>YouTube</p> <p>https://www.youtube.com/DCcKiN6hmKE</p>



Tel: +86 400 900 6868 USA

Hotline: +1 808-319-6137.9:00-18:00 GMT-7, Mon-Fri

Europe Hotline: +49 (0)6101 8132180.10:00-17:00 GMT+ 1.

Mon-Fri Email: info@zhiyun-tech.com

Website: www.zhiyun-tech.com Address: 09 Huangtong Road, Tieshan Industrial Zone,
Qixing District, Guilin, 541004. Guangxi, China

Please download the latest version from www.zhiyun-tech.com This document is subject to change without notice. ZHIYUNTM, TransMount TIA are the trademarks of Guilin Zhishen Information Technology Co., Ltd. (hereinafter referred to as "ZHIYUN" or "ZHIYUN TECH") and its affiliates. All product names or trademarks referred to herein are trademarks or registered trademarks of their respective holders. Copyright © 2021

FCC Caution.

This device complies with part 15 of the FCC Rules. Operation is subject to the following two conditions: (1) This device may not cause harmful interference, and (2) this device must accept any interference received, including interference that may cause undesired operation.

This equipment has been tested and found to comply with the limits for a Class B digital device, pursuant to part 15 of the FCC Rules. These limits are designed to provide reasonable protection against harmful interference in a residential installation. This equipment generates uses and can radiate radio frequency energy and, if not installed and used in accordance with the instructions, may cause harmful interference to radio communications. However, there is no guarantee that interference will not occur in a particular installation. If this equipment does cause harmful interference to radio or television reception, which can be determined by turning the equipment off and on, the user is encouraged to try to correct the interference by one or more of the following measures:

- Reorient or relocate the receiving antenna.
- Increase the separation between the equipment and receiver.
- Connect the equipment into an outlet on a circuit different from that to which the receiver is connected.
- Consult the dealer or an experienced radio/TV technician for help.

NOTE: The manufacturer is not responsible for any radio or TV interference caused by unauthorized modifications to this equipment. Such modifications could void the user's authority to operate the equipment.

RF Exposure

The SAR limit of USA (FCC) is 1.6 W/kg averaged over one gram of tissue. Device has also been tested against this SAR limit. This device was tested for typical body-worn operations with the front face of the device kept 5mm from the body. To maintain compliance with FCC RF exposure requirements, use accessories that maintain a 5mm separation distance between the user's body and the back of the handset. The use of belt clips, holsters, and similar accessories should not contain metallic components in its assembly. The use of accessories that do not satisfy these requirements may not comply with FCC RF exposure requirements and should be avoided.

CE Caution



This device is restricted to indoor use where operated in the European Community using frequency in 5150MHz – 5250MHz to reduce the potential for interference. The 5150 to 5250 MHz frequency range is restricted to indoor use only in: AT, BE, BG, CH, CY, CZ, DE, DK, EE, EL, ES, FI, FR, HR, HU, IE, IS, IT, LI, LT, LU, LV, MT, NL, NO, PL, PT, RO, SE, SI, SK, TR,

The SAR limit adopted by Europe is 2.0 W/kg averaged over 10 grams of tissue and the highest. SAR value for this device complies with this limit.

MIC Caution

TELEC statements: In-door use only (Except when communicating with 5.2GHz high power base stations or relay stations).

Documents / Resources

<div><div></div><div>TransMount Video Transmission Transmitter (A)</div><div>• EN: User Guide</div></div> <div>81 14 000002</div>	<p>ZHIYUN COV-03 TransMount Video Transmission Transmitter [pdf] User Guide COV-03 TransMount Video Transmission Transmitter, COV-03, TransMount Video Transmission Transmitter</p>
<div><div></div><div>TransMount Video Transmission Transmitter (A)</div><div>• EN: User Guide</div></div> <div>81 14 000002</div>	<p>ZHIYUN COV-03 TransMount Video Transmission Transmitter [pdf] User Guide COV-03, TransMount Video Transmission Transmitter, COV-03 TransMount Video Transmission Transmitter, Video Transmission Transmitter, Transmission Transmitter, Transmitter</p>