



Zhejiang Uniview Technologies CB1c Smart PTZ Camera Instruction Manual

[Home](#) » [Zhejiang Uniview Technologies](#) » Zhejiang Uniview Technologies CB1c Smart PTZ Camera Instruction Manual 

Contents

- [1 Zhejiang Uniview Technologies CB1c Smart PTZ Camera](#)
- [2 Product appearance](#)
- [3 Unbinding Device](#)
- [4 product specification](#)
- [5 FCC compliance statement](#)
- [6 Documents / Resources](#)
- [7 Related Posts](#)

Smart PTZ Camera

Operation Instruction

Zhejiang Uniview Technologies CB1c Smart PTZ Camera



Product appearance

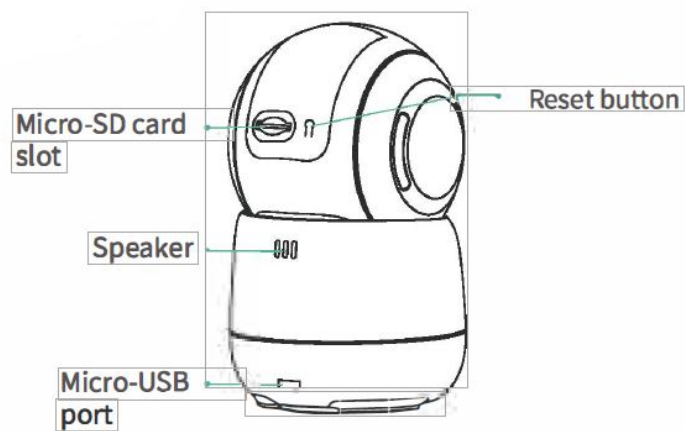
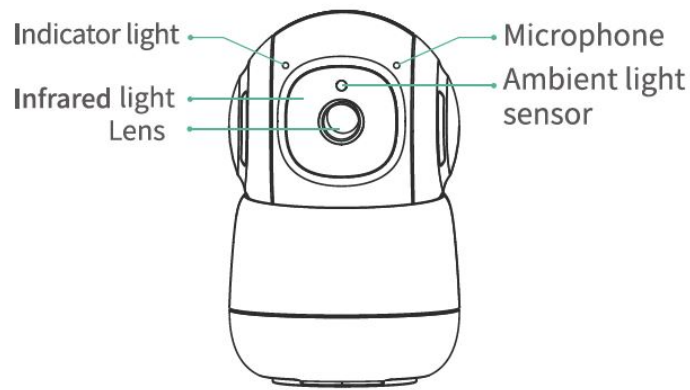

Install the camera

Select a good spot for your camera. Select a good spot for your camera, please install the camera in a position where its view is not blocked and ensure that it is within the coverage of the Wi-Fi network.

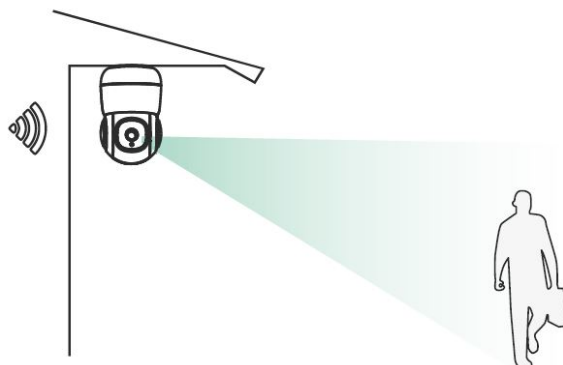

Install the bracket

Fix the camera to a desired location. You can directly place the camera on a flat surface, or fix the bracket to the wall or ceiling by screws, and then screw the camera to the fixed base.

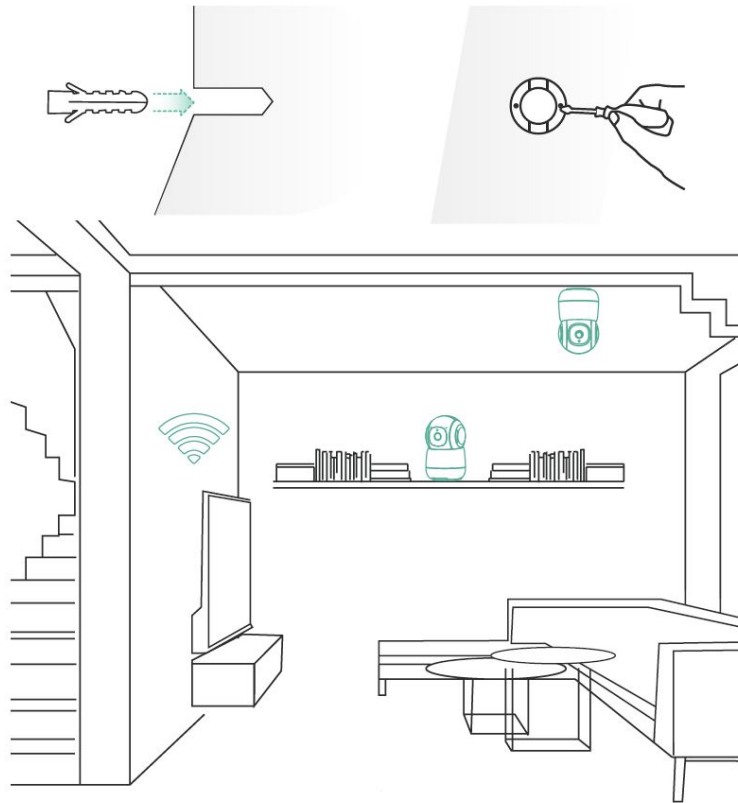

Set up the camera

Click the “Add Camera Now” in the App and enter the Wi-Fi network name and password that you want the camera to connect. Target the camera at the QR code of the mobile App, with a distance of about 20cm (about 7 inches) until the camera emits a “i.” sound, which represents the scanning is succeeded and the pairing is started.

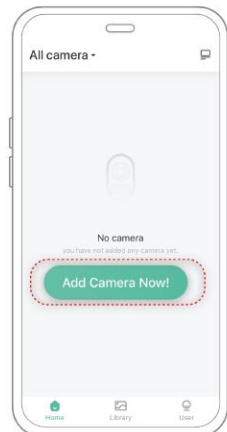

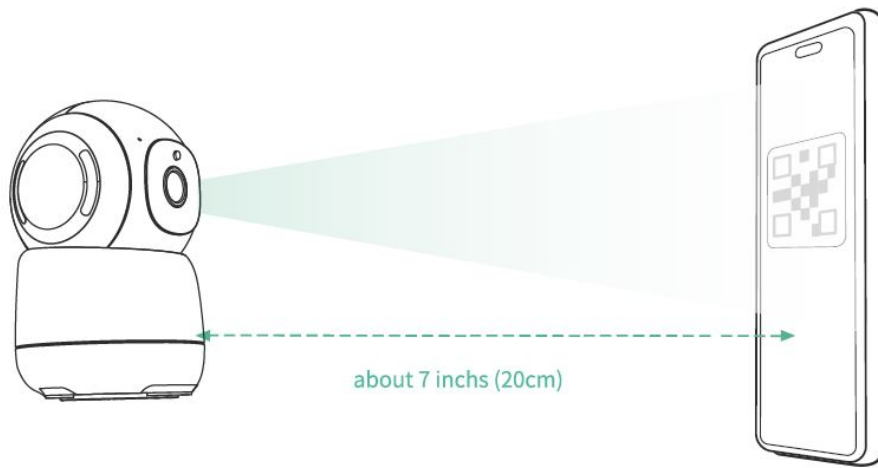

Unbinding Device

If this device has been connected to other Wi-Fi or has been bound by other users, you need to unbind the device before _ rebinding. Device unbinding method: After the device is powered on and self-checked, press and hold the reset button of the device for 5 seconds; the device will be reset and unbound.

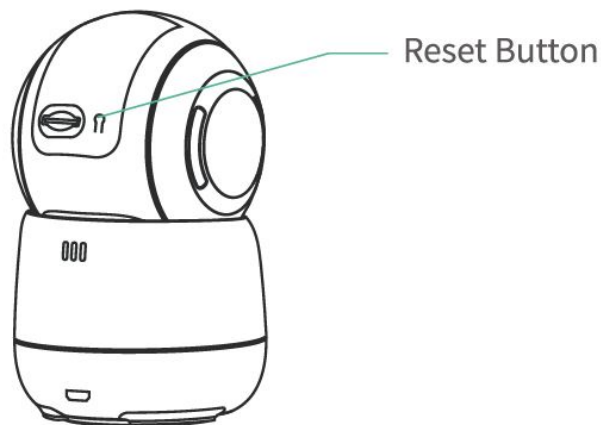

Share the camera

- 1) Find the camera you want to share on the App homepage or camera setting page. Click the share button and enter the sharing page.
- 2) Click "Invite", and a QR code will be generated for sharing.
- 3) For the members you need to share, find "Add Friend's Camera" on the "User" page to enter the scanning page.

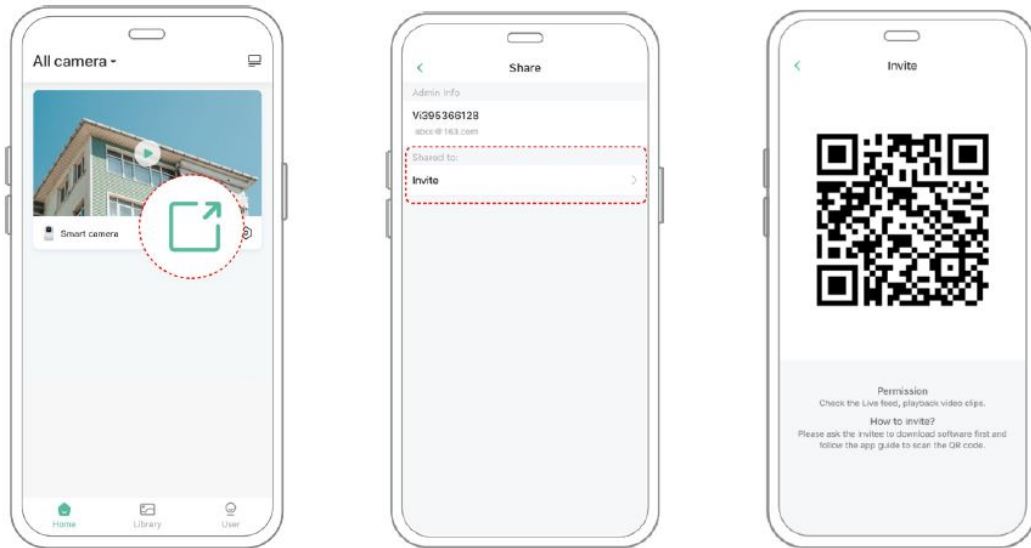

4) Scan the QR code on your mobile phone, and you will receive the confirmation notification after success. The sharing will be completed after you agree.

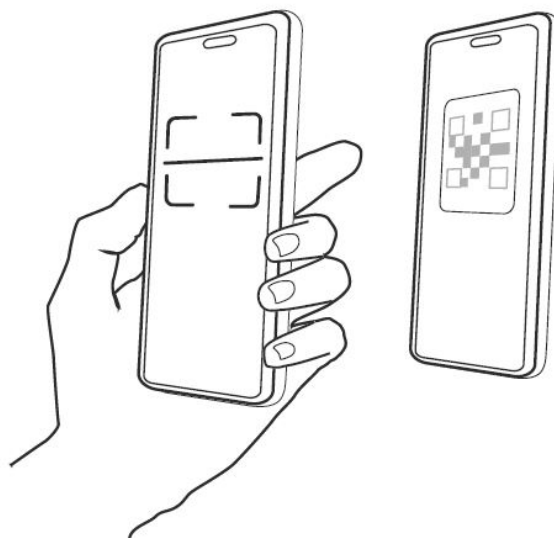
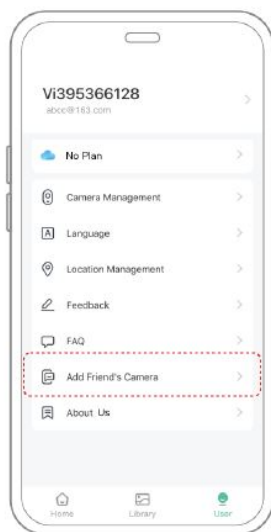

Packing list

1. Camera*1
2. Bracket*1
3. Power cable*1
4. Power adapter*1
5. Mounting kit*1
6. Operation instruction*1

product specification

| Item | Specification |
|---------------------------|--------------------------------|
| Horizontal angle | 355° |
| Vertical angle | 110° |
| Camera Lens | Field of view 100° |
| Image resolution | 1080P |
| Video bit rate | Adaptive |
| Image coding standard | H.265 |
| Audio | Duplex two-way audio intercom |
| Storage media | Micro SD card (Up to 128GB) |
| Night vision light source | Infrared light |
| Network | Wi-Fi (2.4GHz 802.11b/g/n) |
| Power | DC 5V/1A |
| Operating temperature | -10°C ~ 45°C |
| Size(LxWxH) | 72.0mm(L)*72.0mm(W)*115.5mm(H) |

FCC compliance statement

This device complies with Part 15 of the FCC Rules. Operation is subject to the following two conditions:

1. this device may not cause harmful interference, and
2. this device must accept any interference received, including interference that may cause undesired operation.

Changes or modifications not expressly approved by the party responsible for compliance could void the user's authority to operate the equipment.

This equipment has been tested and found to comply with the limits for a Class B digital device, pursuant to Part 15 of the FCC Rules. These limits are designed to provide reasonable protection against harmful interference in a residential installation. This equipment generates, uses and can radiate radio frequency energy and, if not installed and used in accordance with the instructions, may cause harmful interference to radio communications. However, there is no guarantee that interference will not occur in a particular installation. If this equipment does cause harmful interference to radio or television reception, which can be determined by turning the equipment off and on, the user is encouraged to try to correct the interference by one or more of the following measures:

- Reorient or relocate the receiving antenna
- Increase the separation between the equipment and receiver.
- Connect the equipment into an outlet on a circuit different from that to which the receiver is connected.
- Consult the dealer or an experienced radio/TV technician for help. FCC Radiation Exposure statement

This equipment complies with FCC radiation exposure limits set forth for an uncontrolled environment. This equipment should be installed and operated with minimum distance 20cm between the radiator and your body.

This transmitter must not be co-located or operating in conjunction with any other antenna or transmitter.

LVD/EMC Directive



This product complies with the European Low Voltage Directive 2014/35/EU and EMC Directive 2014/30/EU.

WEEE Directive-2012/19/EU



The product this manual refers to is covered by the Waste Electrical & Electronic Equipment (WEEE) Directive and must be disposed of in a responsible manner.

Documents / Resources



[Zhejiang Uniview Technologies CB1c Smart PTZ Camera](#) [pdf] Instruction Manual
0T1L2WT, 2AL8S0T1L2WT, CB1c Smart PTZ Camera, Smart PTZ Camera

[Manuals+](#).