

ZEPHYR

ZEPHYR RC-0003
Range Hood



ZEPHYR RC-0003 Range Hood Instructions

[Home](#) » [ZEPHYR](#) » ZEPHYR RC-0003 Range Hood Instructions 

Contents

- [1 ZEPHYR RC-0003 Range Hood](#)
- [2 Product Usage Instructions](#)
- [3 Pairing the Remote Control](#)
- [4 Installing the Battery](#)
- [5 Using the Remote Control](#)
- [6 Limited Warranty](#)
- [7 Documents / Resources](#)
 - [7.1 References](#)
- [8 Related Posts](#)

ZEPHYR

ZEPHYR RC-0003 Range Hood



Specifications:

- Model: RC-0003
- Communication Distance: 15 feet
- Battery Type: CR2032
- Battery Part Number: 15000014

Product Usage Instructions

Pairing the Remote Control: For Current Models:

1. Turn off the range hood.
2. Press and hold the Power button on the hood for 4 seconds until the 3rd speed indicator flashes 3 times.
3. Press any button on the remote control within 4 seconds to confirm the link.
4. The range hood is now synchronized with the remote control.

For Previous Models:

1. Turn off the range hood.
2. Press and hold the Power and Delay Off buttons on the remote for 4 seconds until the Delay Off indicator illuminates.
3. Press the Delay Off button on the hood within 4 seconds to confirm the link.
4. If successful, the Delay Off indicator on the hood will flash 3 times, indicating synchronization.

Installing the Battery:

1. Remove the rubber bottom of the remote.
2. Dislodge the top touch panel using a pen or screwdriver.
3. Install a CR2032 battery.
4. Reassemble the remote body.

Using the Remote Control:

- **Power Button:** Turn off the fan and lights.
- **Fan Button:** Cycle through low, medium, and high speeds.
- **Lights Button:** Cycle through high, medium, low, and off settings.
- **Delay Off Button:** Enable the delay off timer.
Fan and lights will turn off after a set period (10 minutes for current models, 5 minutes for previous models).

FAQ:

1. Q: What is the maximum communication distance for the remote control?

A: The maximum communication distance is 15 feet from the range hood.

2. Q: How can I replace the battery in the remote control?

A: To replace the battery, follow these steps:

1. Remove the rubber bottom of the remote.
2. Dislodge the top touch panel using a pen or screwdriver.
3. Install a CR2032 battery.
4. Reassemble the remote body.

3. Q: What is the warranty coverage for the remote control?

A: The remote control is covered by a One Year Limited Warranty from the date of original purchase. Refer to the warranty terms for details on coverage and limitations.

Pairing the Remote Control

RC-0003 must be paired to enable RF remote control capabilities. To synchronize your hood and remote control for the first time, please follow these steps:

For Current Models: DAP-M90Ax, DHZ-M90Ax, DLA-M90Ax, DLA-E42Ax, DME-M90Ax, DME-E48Ax, DVL-E36Ax, DVL-E42Ax, DVS-E30Ax, DVS-E36Ax, ZPO-E30AS, and ZPO-E36AS

1. With the range hood off, press and hold the Power button on the hood for 4 seconds until the 3rd speed indicator on the hood flashes 3 times.
2. Press any button on the remote control within 4 seconds to confirm the link. The range hood is now synchronized with the remote control. If any problems are experienced, please repeat the procedure. The hood lights will turn on if the Lights button on the remote control was pressed to confirm the link.

For Previous Models: AIN-M80Ax, AWA-M90Ax, ADL-M90Bx, ADL-E42Bx, ADU-M90Bx, ALA-M90Bx, ALA-E42Bx, ALL-M90Bx, ALL-E42Bx, and ALU-E43Ax

1. With the range hood off, press and hold the Power and Delay Off buttons on the remote for 4 seconds until the Delay Off indicator on the hood illuminates.
2. Press the Delay Off button on the hood within 4 seconds to confirm the link. If successful, the Delay Off indicator on the hood will flash 3 times. The range hood is now synchronized with the remote control. If any problems are experienced, please repeat the procedure.

NOTE: "x" within the model number represents a placeholder for different colors.

Installing the Battery

Please follow the steps below to install the battery. Visit our website, store.zephyronline.com, if a replacement battery is needed. The battery part number is 15000014.

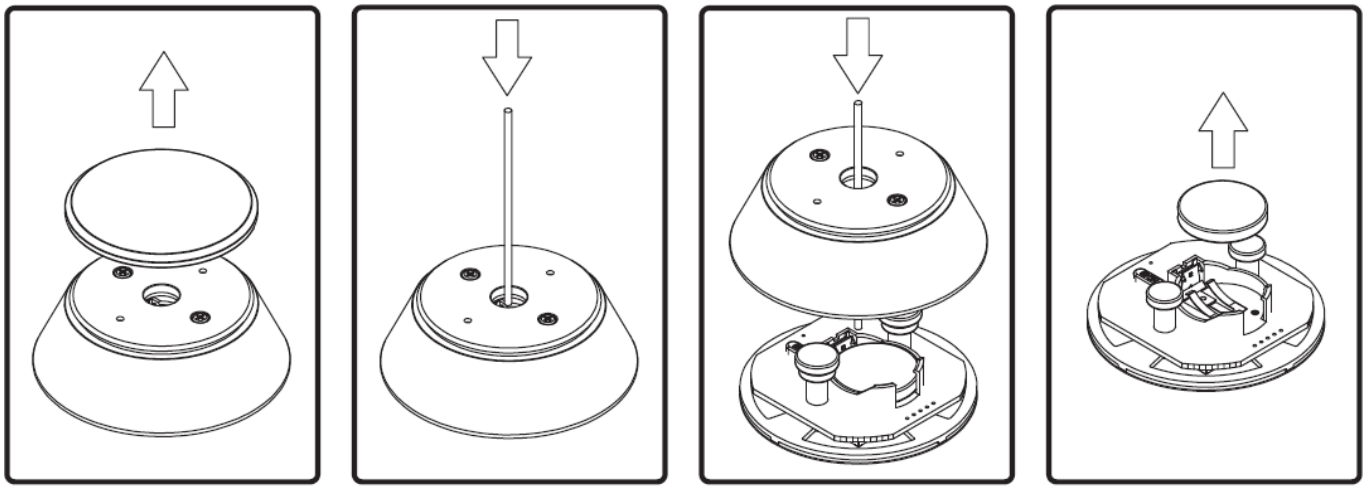

1. Remove the rubber bottom.
2. Place a pen or screwdriver in the bottom opening to dislodge the top touch panel.
3. Remove the top touch panel from the remote body.
4. Install (1) CR2032 battery and reassemble the remote body.

Using the Remote Control

The maximum remote control communication distance is 15 feet from the range hood.

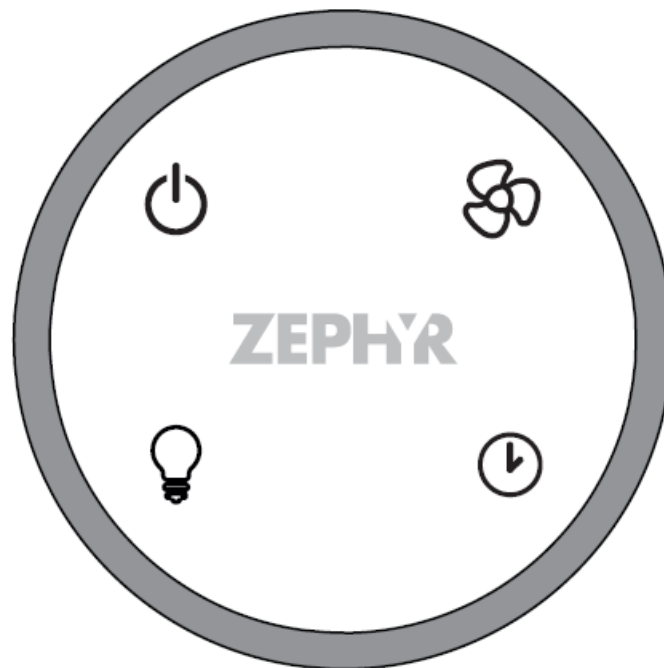

Power Button: Press the Power Button to turn off the fan and lights.



Fan Button: Press the Fan Button to cycle through low, medium, and high speeds.



Lights Button: Press the Lights Button to cycle from high, medium, low, and off.



Delay Off Button: Press the Delay Off Button to enable the delay off timer. After a period of time, the fan and lights will turn off. The timer is 10 minutes for current models and 5 minutes for previous models.

NOTE: The remote control is equipped with a magnetic base and may be attached to a ferrous surface for easy storage.

Limited Warranty

One Year Limited Warranty: For one year from the date of your original purchase of the Products, we will provide, free of charge, Products, or parts to replace those that failed due to manufacturing defects subject to the exclusions and limitations below. We may choose, in our sole discretion, to repair or replace parts before we elect to replace the Products.

Warranty Exclusions: This warranty covers only repair or replacement, at our option, of defective Products or parts and does not cover any other costs related to the Products including but not limited to:

- normal maintenance and service required for the Products and consumable parts such as batteries;
- any Products or parts which have been subject to freight damage, misuse, negligence, accident, faulty installation or installation contrary to recommended installation instructions, improper maintenance or repair (other than by us);
- commercial or government use of the Products or use otherwise inconsistent with its intended purpose;
- natural wear of the finish of the Products or wear caused by improper maintenance, use of corrosive and abrasive cleaning products, pads, and oven cleaner products;
- chips, dents or cracks caused by abuse or misuse of the Products;
- service trips to your home to teach you how to use the Products;
- damage to the Products caused by accident, fire, floods, acts of God; or
- Custom installations or alterations that impact serviceability of the Products.
- Damage to personal property or food spoilage from use of this product.

Limitations of Warranty: OUR OBLIGATION TO REPAIR OR REPLACE, AT OUR OPTION, SHALL BE YOUR SOLE AND EXCLUSIVE REMEDY UNDER THIS WARRANTY. WE SHALL NOT BE LIABLE FOR INCIDENTAL, CONSEQUENTIAL OR SPECIAL DAMAGES ARISING OUT OF OR IN CONNECTION WITH THE USE OR PERFORMANCE OF THE PRODUCTS. THE EXPRESS WARRANTIES IN THE PRECEDING SECTION ARE EXCLUSIVE AND IN LIEU OF ALL OTHER EXPRESS WARRANTIES. WE HEREBY DISCLAIM AND EXCLUDE ALL OTHER EXPRESS WARRANTIES FOR THE PRODUCTS, AND DISCLAIM AND EXCLUDE ALL WARRANTIES IMPLIED BY LAW, INCLUDING THOSE OF MERCHANT-ABILITY AND FITNESS FOR A PARTICULAR PURPOSE. Some states or provinces do not allow limitations on the duration of an implied warranty or the exclusion or limitation of incidental or consequential damages, so the above limitations or exclusions may not apply to you. To the extent that applicable law prohibits the exclusion of implied warranties, the duration of any applicable implied warranty is limited to the same one-year period described above if permitted by applicable law. Any oral or written description of the Products is for the sole purpose of identifying the Products and shall not be construed as an express warranty. Prior to using, implementing, or permitting use of the Products, you shall determine the suitability of the Products for the intended use, and you shall assume all risk and liability whatsoever in connection with such determination. We reserve the right to use functionally equivalent refurbished or reconditioned parts or Products as warranty replacements or as part of warranty service. This warranty is not transferable from the original purchaser and only applies to the consumer residence where the Product was originally installed located in the United States and Canada. This warranty is not extended to resellers.

FCC Caution: To assure continued compliance, any changes or modifications not expressly approved by the party responsible for compliance could void the user's authority to operate this equipment. (Ex[1]ample – use only shielded interface cables when connecting to computer or peripheral device. This device complies with Part 15 of the FCC Rules. Operation is subject to the following two conditions.

1. This device may not cause harmful interference, and
2. This device must accept any interference received, including interference that may cause undesired operation.

Documents / Resources

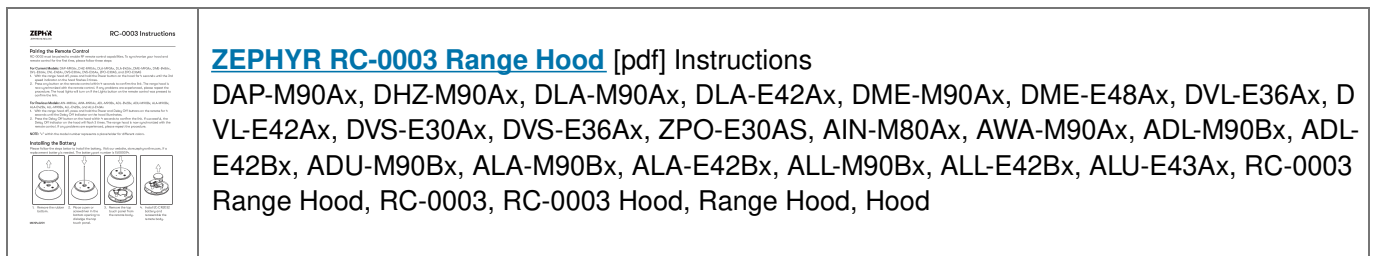

[Manuals+](#), [Privacy Policy](#)