

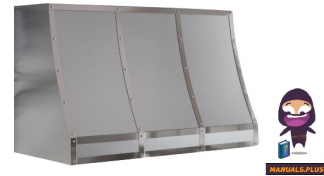

ZEPHYR
CHFT36ASX
Forte Custom
Hood



ZEPHYR CHFT36ASX Forte Custom Hood Installation Guide

[Home](#) » [ZEPHYR](#) » ZEPHYR CHFT36ASX Forte Custom Hood Installation Guide 

Contents

- [1 ZEPHYR CHFT36ASX Forte Custom Hood](#)
- [2 Installation Instructions](#)
- [3 Product Specifications](#)
- [4 Dimensions](#)
- [5 Installation Instructions](#)
- [6 Assembling the Banding](#)
- [7 Installing the Banding](#)
- [8 Cleaning the Forte Custom Metal Hood](#)
- [9 List of Parts & Accessories](#)
- [10 FAQs](#)
- [11 Documents / Resources](#)
 - [11.1 References](#)
- [12 Related Posts](#)

ZEPHYR

ZEPHYR CHFT36ASX Forte Custom Hood



Product Specifications

- **List of Materials**

- **Hood Installation Screws**

- (8) M4 x 8
 - (8) #10 x 2
 - (4) 3/16 x 1/2
 - (2) #10 x 3
 - (8) 5 x 14 x 1

- **Hood Banding Hardware**

- (8) M6
 - (20) 11*10.3 bushings
 - (8) OD18 x ID8 x 3
 - (20) M6

- **Hood Rivet Bolts, SS**

- (28) M6

- **Hood Insert Compatibility**

- AK9134xS
 - AK9234xS
 - AK9246xS
 - AK9434xS
 - AK9446xS
 - AK9534xS
 - AK9546xS

- **Dimensions**

- (36) 33-9/16, (48) 45-1/2
 - (36) 30-5/16, (48) 41-5/16
 - Net Weight: CHFT36ASX (48lb), CHFT48ASX (55lb)

Installation Instructions

1. Determine the hood mounting height above the cooking surface, 24 – 36 inches. Add 22-1/8 inches to this

number and mark Line A on the wall.

2. Center, level, and install the mounting bracket for the custom hood onto the wall using (4) #10 x 2 screws with (4) 5 x 14 x 1 washers. Secure the screws into the wall studs.
3. Prepare the Zephyr hood insert by following the instructions included with the insert. Remove filters and bottom panels before installing the insert into the Forte custom hood.
4. If using insert models AK91 & AK95, secure the filler panel to the back of the insert with (2) 3/16 x 1/2 screws.
5. Remove the front panel of the custom hood by unscrewing (2) M4 x 8 screws at the top.
6. Lay the custom hood on a stable surface, place the hood insert inside, and secure it with (8) M4 x 8 screws.
7. Reinstall all bottom panels to the hood insert following the instructions from the insert manual in reverse.
8. Lift the custom hood with assistance and hang it onto the mounting bracket. Secure the custom hood to the bracket with (2) M4 x 8 screws.

MODELS

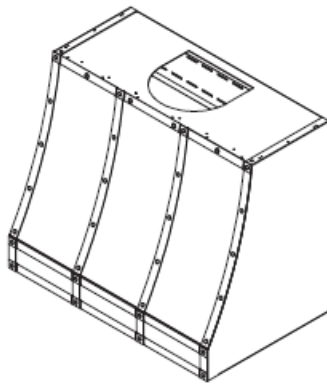

CHFT36A
CHFT48A

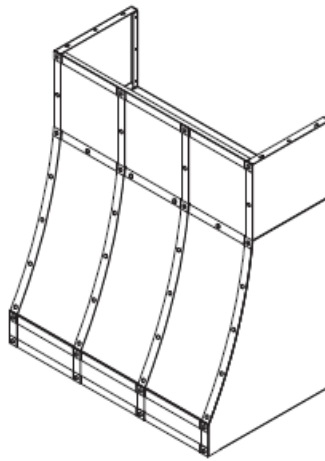

CHFT36A + DC13612A
CHFT48A + DC14812A
(with optional duct cover)

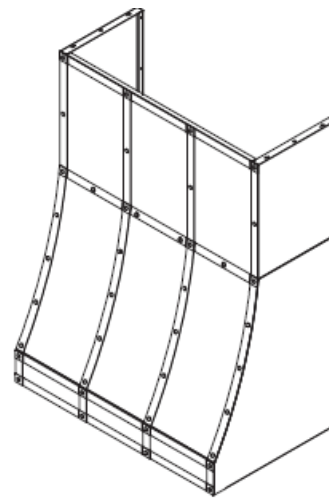

CHFT36A + DC13618A
CHFT48A + DC14818A
(with optional duct cover)

Product Specifications

List of Materials

Hood Installation Screws

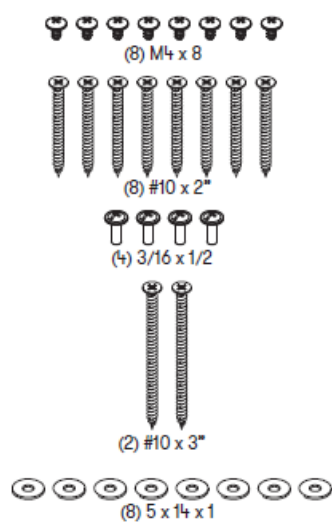

Hood Banding Hardware

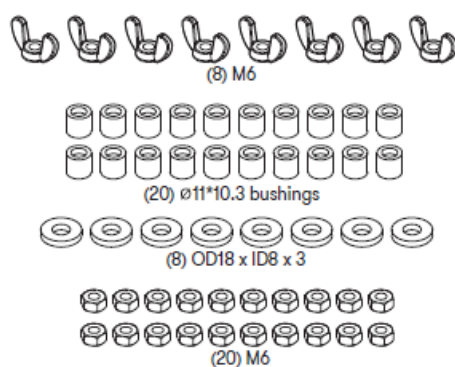

Hood Rivet Bolts, SS



Hood Insert Compatibility

Below are the hood inserts compatible with the Forte custom hood. The inserts are sold separately.

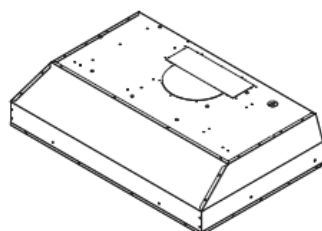

AK9134xS

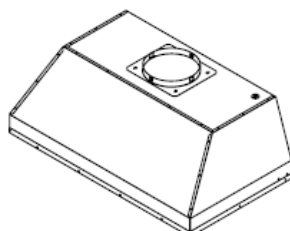

AK9234xS
AK9246xS

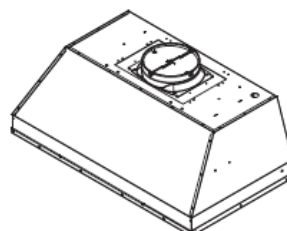

AK9434xS
AK9446xS

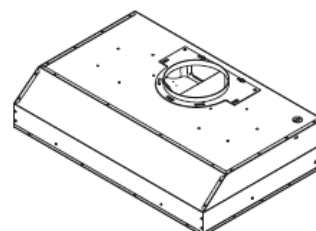

AK9534xS
AK9546xS

Dimensions

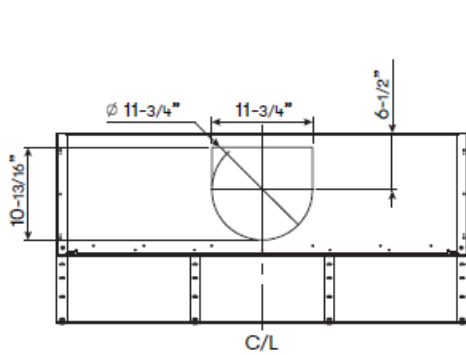

TOP

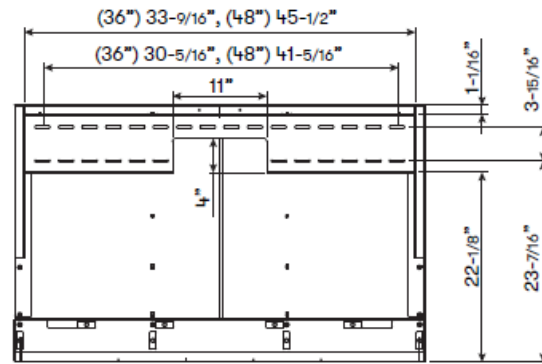

BACK

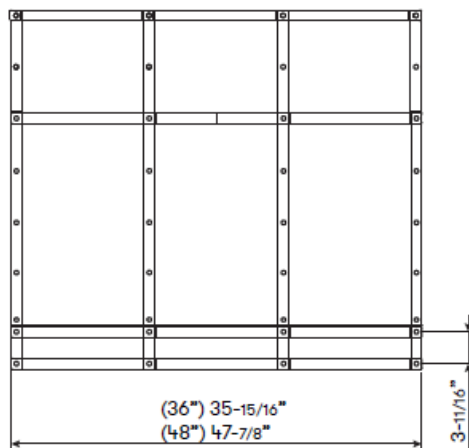

FRONT

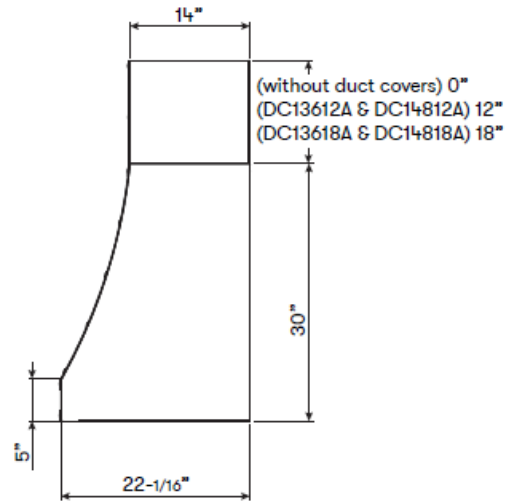

SIDE

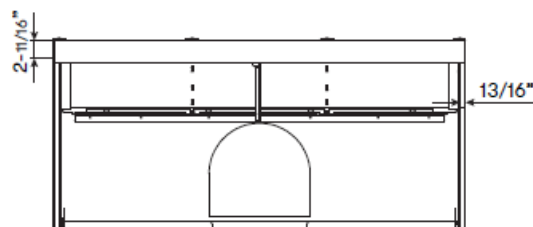

BOTTOM

Net Weight:

CHFT36ASX (48lb), CHFT48ASX (55lb)

NOTE:

The duct cover accessories are sold separately.

Installation Instructions

Installing the Forte Custom Hood

Refer to the installation manual of your specific hood insert and read all warnings before installing your product. To install the Forte Custom Metal Hood, CHFT-A, please follow the instructions below.

WARNING

Carefully remove all protective film before installation. Take care during assembly not to scratch any components

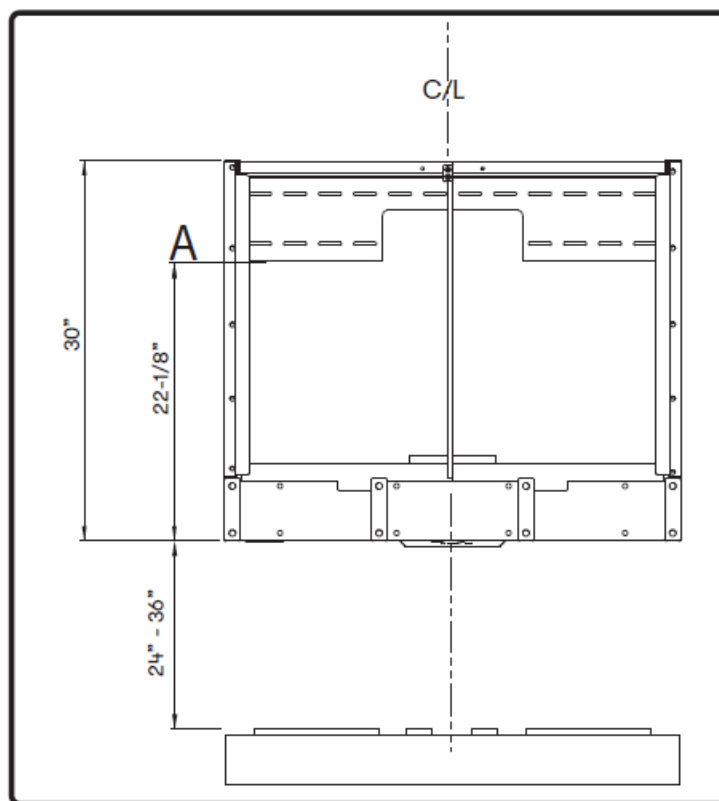

1. Determine the hood mounting height above the cooking surface, 24" – 36". Add 22-1/8" to this number and mark Line A, which is where the bottom of the wall bracket should be installed.

- **NOTE:**

If the optional 12" or 18" H duct covers are used, factor its height when mounting and adjust accordingly

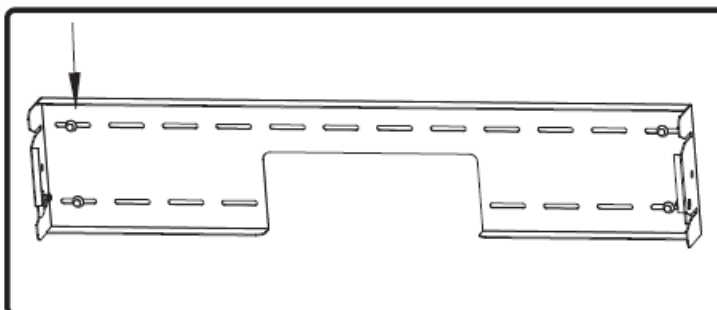

2. Center, level, and install the mounting bracket for the custom hood onto the wall by using (4) #10 x 2" screws with (4) 5 x 14 x 1 washers. Make sure to secure the screws into the wall studs.

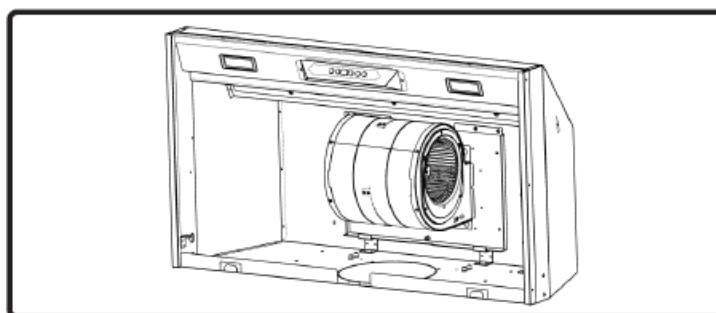

3. Prepare your Zephyr hood insert (sold separately) by following the instructions included with the insert. The filters and any bottom panels will need to be removed before installing the insert into your Forte custom hood.

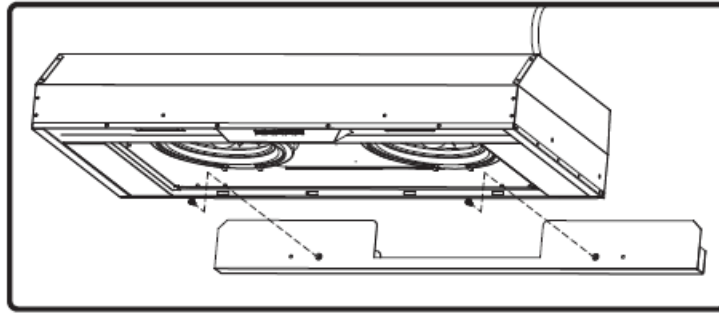

4. This step applies to insert models AK91 & AK95 only. For models AK92 & AK94, skip to the next step. Secure the filler panel to the back of the insert using (2) 3/16 x 1/2 screws.

Installing the Forte Custom Hood

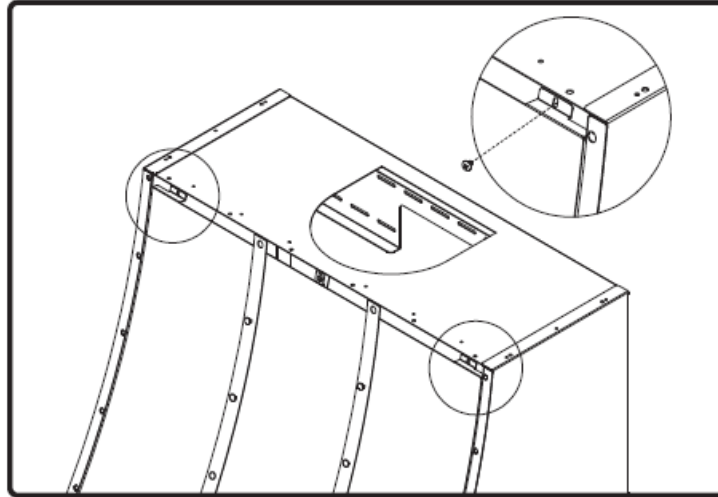

5. Remove the front panel of the custom hood by (2) M4 x 8 screws at the top.

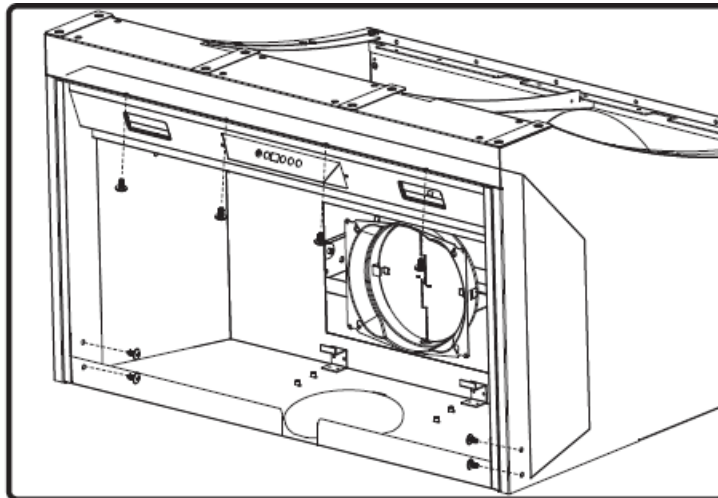

6. Lay the custom hood back on a stable surface before placing the hood insert inside the interior of the custom hood and securing it with (8) M4 x 8 screws; (4) screws in the front and (2) screws per side

- **NOTE:**

- If installing an optional duct cover, it is recommended to secure it to the custom hood during this step. Make sure to install all banding to the duct cover after assembly. See the duct cover assembly instructions for more information.

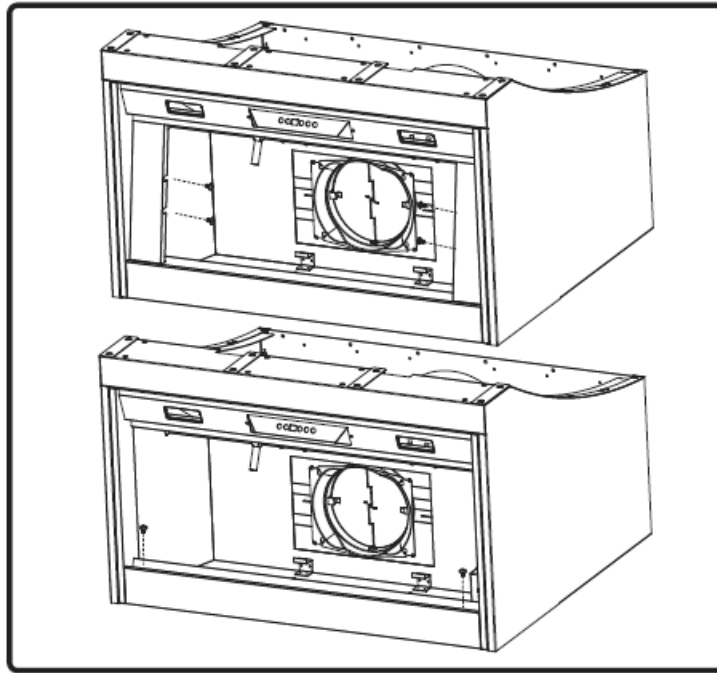

7. Reinstall all bottom panels to the hood insert by following the instructions from the insert manual in reverse

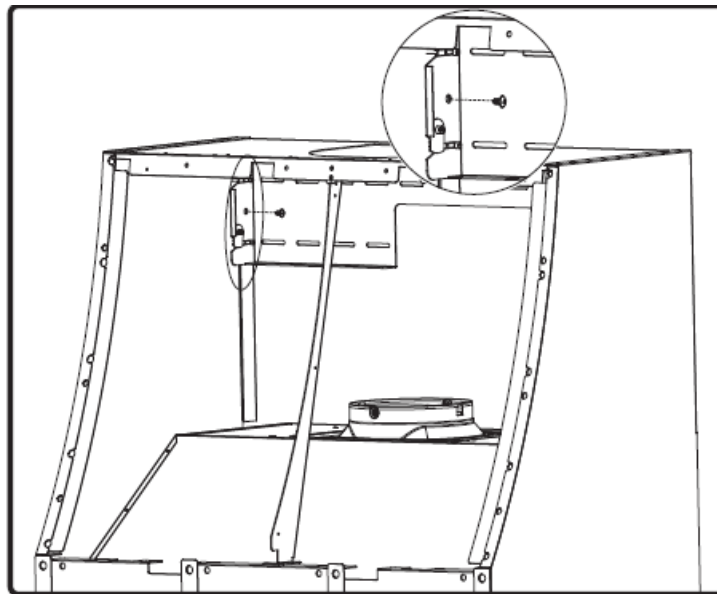

8. With the help of 2-3 people, lift the custom hood and hang it onto the mounting bracket. The safety clips will temporarily prevent the hood from falling off the bracket. Secure the custom hood to the mounting bracket with (2) M4 x 8 screws; (1) screw per side.

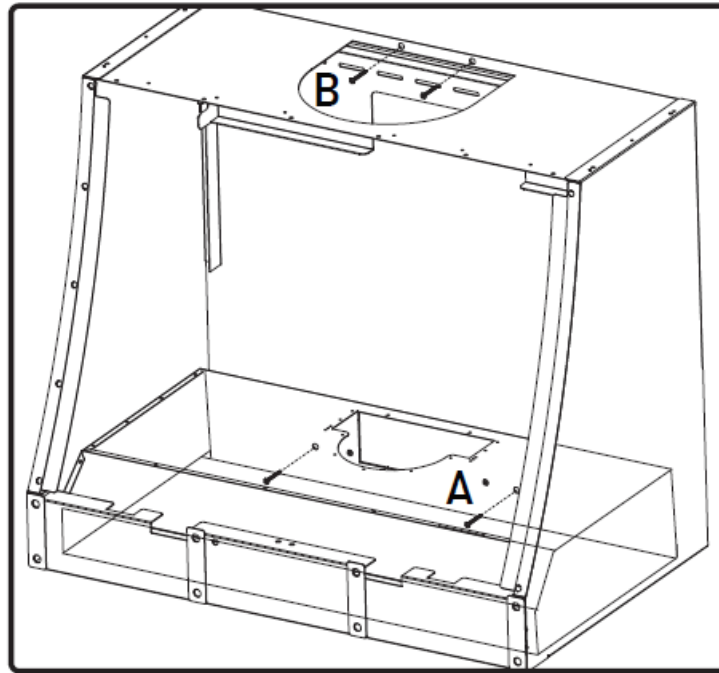

9. At the bottom (A), install (2) screws with washers through the hood insert into the wall.

- **For AK92 and AK94:**

Use (2) #10 x 2" screws with (2) washers.

- **For AK91 and AK95:**

Use (2) #10 x 3" screws with (2) washers.

- At the top (B), use (2) #10 x 2" screws with (2) washers to further secure the hood insert to the wall.

- **WARNING**

Electrical wiring must be done by a qualified person(s) by all applicable codes and standards. Turn off electrical power at the service entrance before wiring

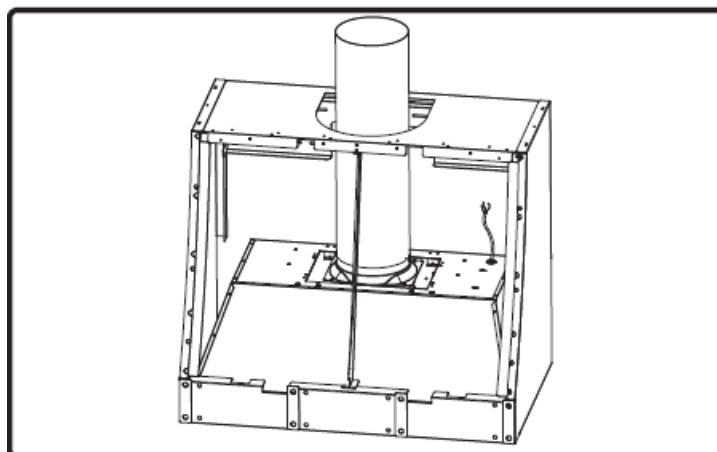

10. Connect the hood insert to power and ducting. Refer to the hood insert installation manual for detailed instructions.

Assembling the Banding

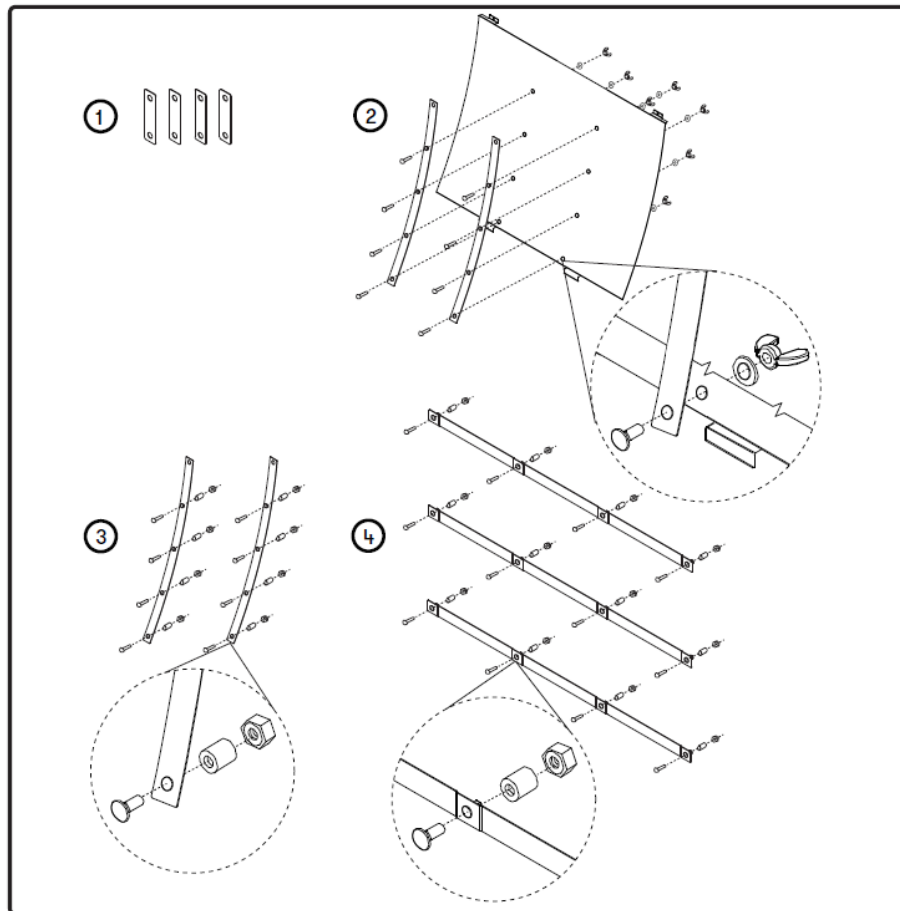

- (4) #1 Short vertical bands are secured by magnets, no assembly is required.
- (2) #2 long vertical bands should be installed onto the front of the panel using (4) rivet bolts, washers, and wingnuts per band
- (2) #3 long vertical bands and (3) #4 horizontal bands should be assembled using (4) rivet bolts, bushings, and M6 nuts per band.

Installing the Banding

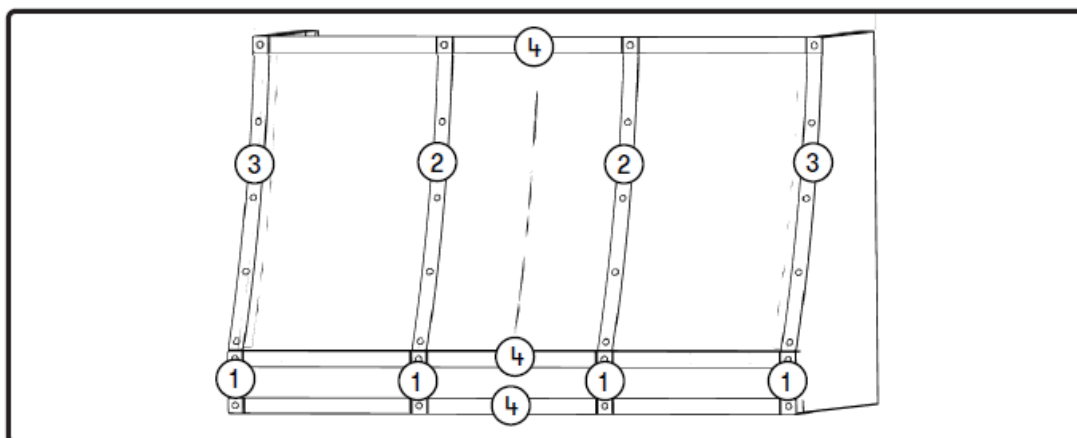

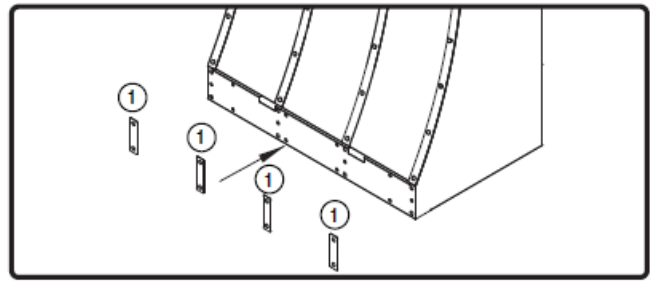
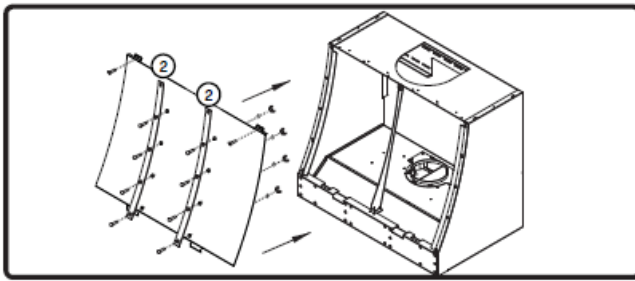

1. Secure the front panel with banding to the hood body at the top by using the (2) M4 x 8 screws previously removed.

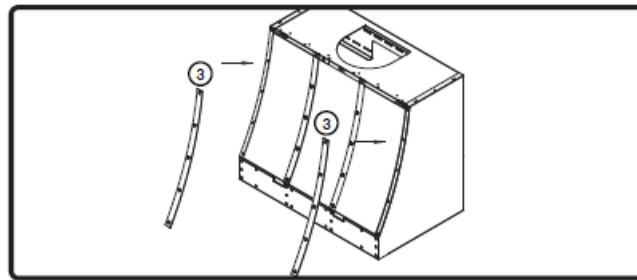

2. Place (2) #3 long vertical bands onto the custom hood. These two bands are secured by magnets.
3. Place (4) #1 short vertical bands onto the custom hood. These bands are secured by magnets.

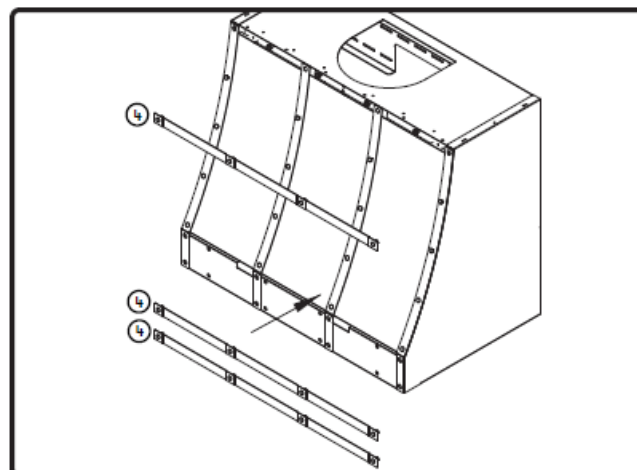

4. Place (3) #4 horizontal bands onto the custom hood, one at the very top of the custom hood, and two at the bottom. These bands are secured by magnets.

Cleaning the Forte Custom Metal Hood

Clean periodically with warm soapy water and a clean cotton cloth or microfiber cloth. Always rub in the direction of the stainless steel grain. To remove heavier grease build up use a liquid degreaser detergent. While cleaning, carefully clean around the areas with the banding as some of the bands are held up magnetically, which may fall off if cleaned too vigorously. After cleaning, use a non-abrasive stainless steel polish/cleaner to polish and buff out the stainless luster and grain. Always scrub lightly with a clean cotton cloth or microfiber cloth and buff in the direction of the stainless steel grain.

- Do not use corrosive detergents, abrasive detergents, or oven cleaners.
- Do not use any product containing chlorine bleach or any product containing chloride.
- Do not use steel wool or abrasive scrubbing pads which will scratch and damage the surface.

List of Parts & Accessories

Optional Accessories	Part Number
Duct Cover, 36" x 12", Stainless Steel	DC13612A
Duct Cover, 36" x 18", Stainless Steel	DC13618A
Duct Cover, 48" x 12", Stainless Steel	DC14812A
Duct Cover, 48" x 18", Stainless Steel	DC14818A
Forte Hood Banding Kit, 36", Matte Black	BKFT36AMB
Forte Hood Banding Kit, 36", Satin Gold	BKFT36ASG
Forte Hood Banding Kit, 48", Matte Black	BKFT48AMB
Forte Hood Banding Kit, 48", Satin Gold	BKFT48ASG
Duct Cover Banding Kit, 36" x 12", Matte Black	BKDC13612AMB
Duct Cover Banding Kit, 36" x 12", Satin Gold	BKDC13612ASG
Duct Cover Banding Kit, 36" x 18", Matte Black	BKDC13618AMB
Duct Cover Banding Kit, 36" x 18", Satin Gold	BKDC13618ASG
Duct Cover Banding Kit, 48" x 12", Matte Black	BKDC14812AMB
Duct Cover Banding Kit, 48" x 12", Satin Gold	BKDC14812ASG
Duct Cover Banding Kit, 48" x 18", Matte Black	BKDC14818AMB
Duct Cover Banding Kit, 48" x 18", Satin Gold	BKDC14818ASG

To order parts, visit us online at <http://store.zephyronline.com>.

FAQS

- Q: What should I do if I scratch any components during assembly?**

A: If you accidentally scratch any components during assembly, you can use touch-up paint or contact customer support for further assistance.

- Q: Are duct cover accessories included with the Forte Custom Hood?**

A: No, the duct cover accessories are sold separately and are not included with the Forte Custom Hood.

Documents / Resources

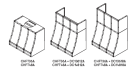
	<p>ZEPHYR CHFT36ASX Forte Custom Hood [pdf] Installation Guide CHFT36ASX, CHFT48ASX, CHFT36ASX Forte Custom Hood, Forte Custom Hood, Custom Hood, Hood</p>
---	---

References

- [Z Home | Zephyr Parts & Accessories Store](#)
- [User Manual](#)

[Manuals+](#), [Privacy Policy](#)

This website is an independent publication and is neither affiliated with nor endorsed by any of the trademark owners. The "Bluetooth®" word mark and logos are registered trademarks owned by Bluetooth SIG, Inc. The "Wi-Fi®" word mark and logos are registered trademarks owned by the Wi-Fi Alliance. Any use of these marks on this website does not imply any affiliation with or endorsement.