



Zenfox T3 Dash Camera User Manual

[Home](#) » [Zenfox](#) » Zenfox T3 Dash Camera User Manual 



User Manual

Contents

- [1 Package component](#)
- [2 Camera Parts](#)
- [3 Inserting / Removing the Memory Card](#)
- [4 Installation](#)
- [5 Button Scenario Guide](#)
- [6 LED Indicators](#)
- [7 Screen Overview](#)
- [8 Operation](#)
- [9 System Settings](#)
- [10 Notice](#)
- [11 Documents / Resources](#)
- [12 Related Posts](#)

Package component

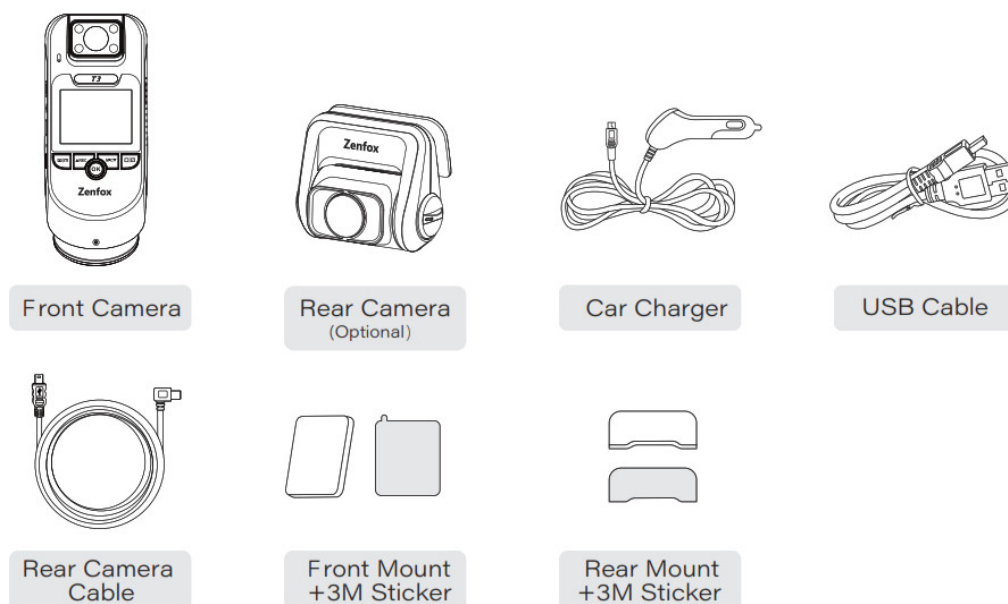

Camera Parts

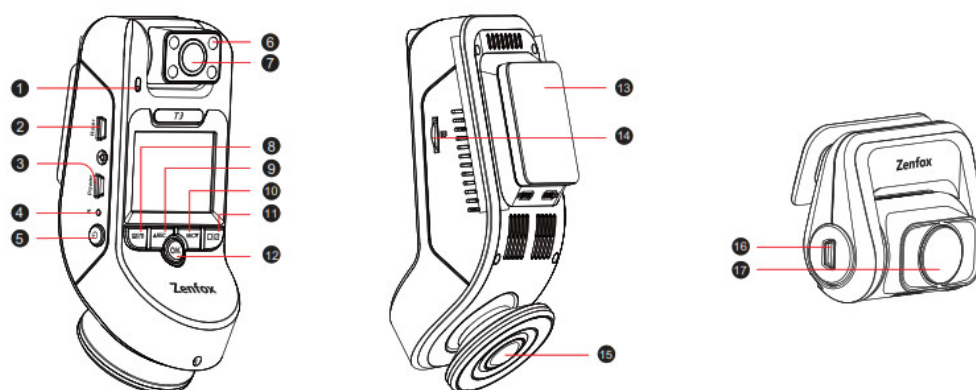

1.Microphone	8.Menu / Playback Button	15.Front Camera Lens
2.Rear Camera USB Port	9.Menu Up / Rec Button	16.Power In + Video Out
3.Power Input	10.Menu Down / Microphone Button	17.Rear Camera Lens
4.Reset.	11.Wi-Fi On / Off, Switch Live View Button	
5.Power On / Off, Turn On / Off Screen	12.OK Button	
6.Infrared Lights	13.Mount	
7.Interior Camera Lens	14.Memory Card Slot	

Inserting / Removing the Memory Card

• Inserting the memory card

Make sure the metal contacts on the memory card facing toward the logo side of the main unit. Ensure the camera is turned off and push the memory card into the card slot until you hear a click.

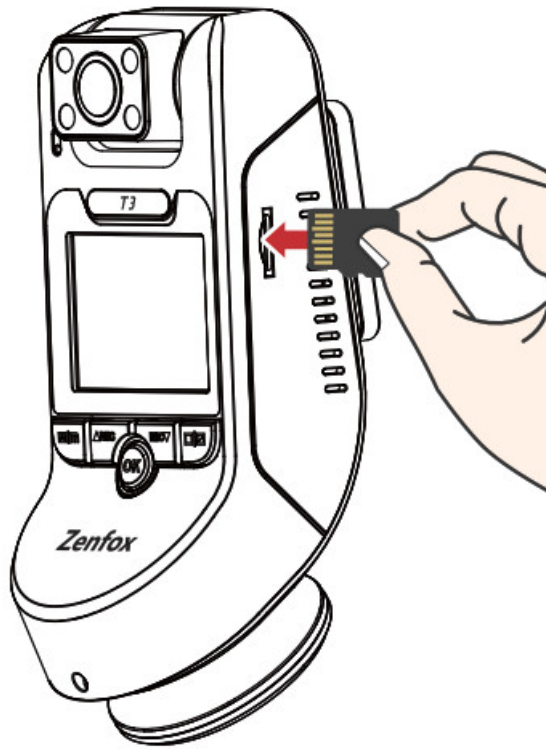

- **Removing the memory card**

Ensure that the camera is turned off, and then push the edge of the memory card with your fingernail. The card will spring out far enough to be removed.



Note:

The microSD card must have a UHS-U1/U3 or above rating and a capacity up to 256GB.

Please format the card on a computer to the FAT32 file system.

Formatting will permanently erase any data on the microSD card. For best performance, format periodically (after backing up any important files).



Warning:

- Please turn off the T3 before inserting or removing the microSD card.
- Inserting or removing the microSD card while recording may destroy the files.

Installation

Front Camera Installation

1. Insert MicroSD card to the slot of device.

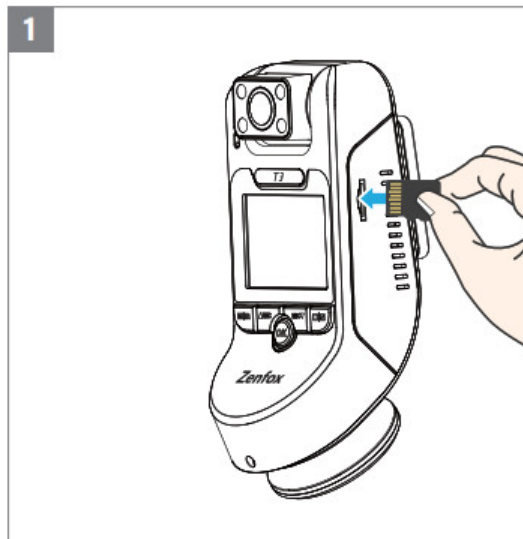

2. Slide the mount horizontally into the slot on the back of the camera.

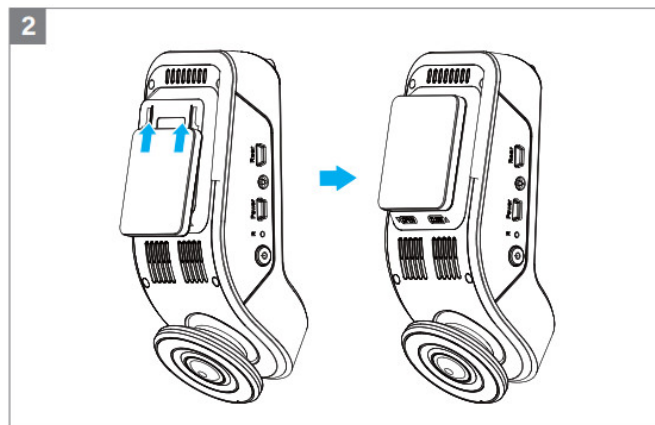

3. Select a location on the windshield behind the rear-view mirror and clean the place. The interior camera must install above the car rearview mirror.

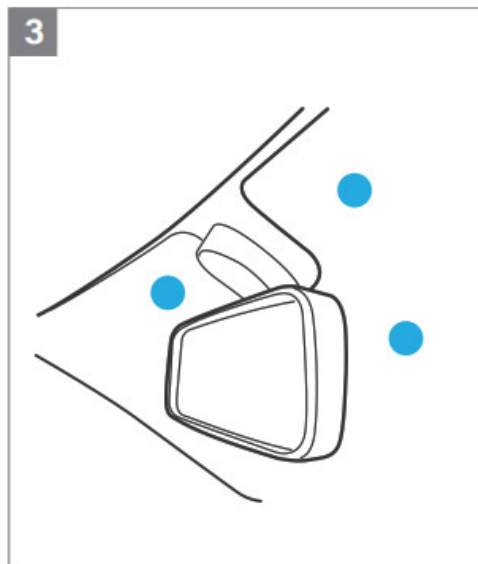

4. Peel the protection film of the sticky pad and camera lens. Fix the front camera on the selected location.

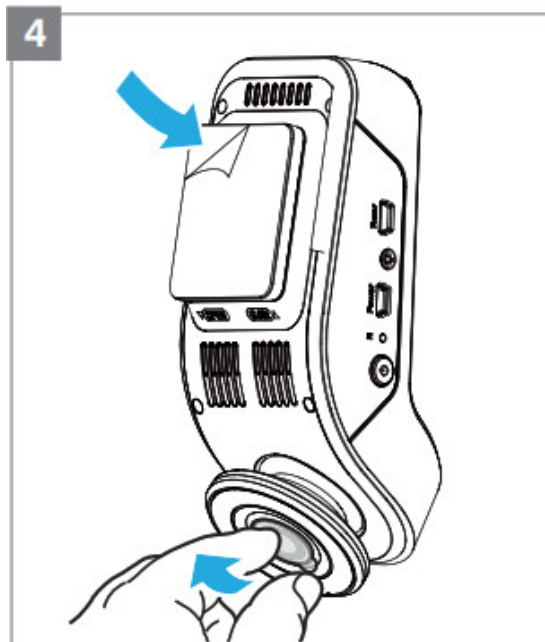

5. Look at the live view on the LCD screen and adjust the angle of the lens up / down if necessary.



6. Plug the USB power adapter into your vehicle's 12V / 24V female power socket. Insert the long USB cable's male port into the camera's mount USB port.

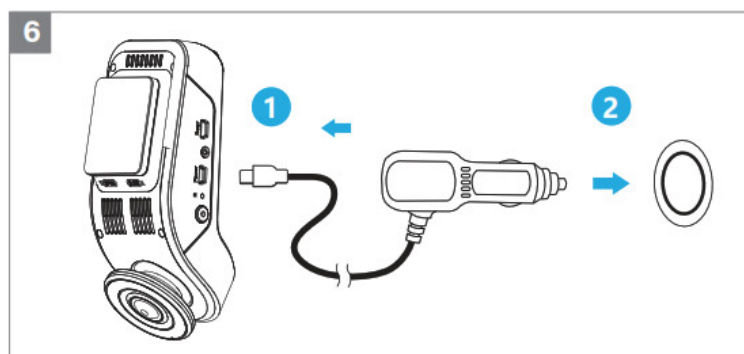

7. The whole look after front camera installation and power connection.

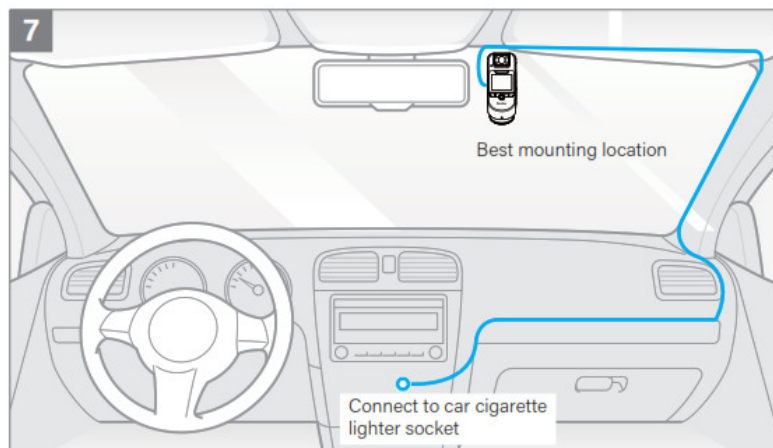

Rear Camera Installation(Optional)

1. Select a location on the windscreen where the camera can record the entire rear view without defrosting grid wires and clean the place.

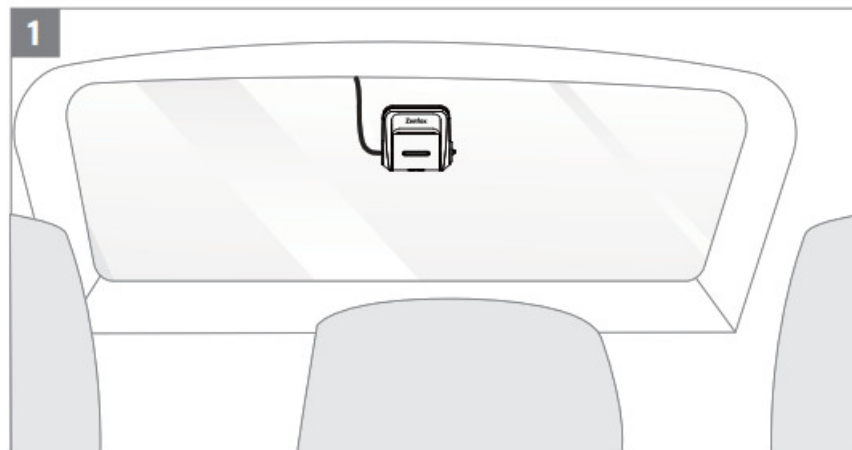

2. Peel the protection film of the sticky pad and camera lens. Fix the rear camera on the selected location and adjust the lens.

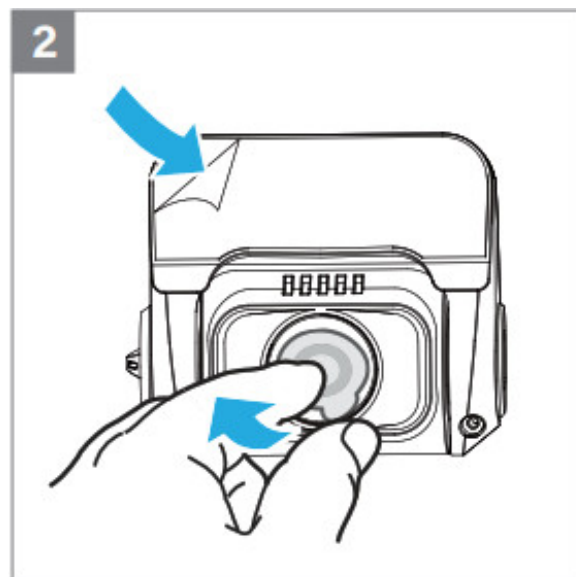

3. Rear camera connection. Power off the product and connect the rear camera cable to the front camera (main unit).

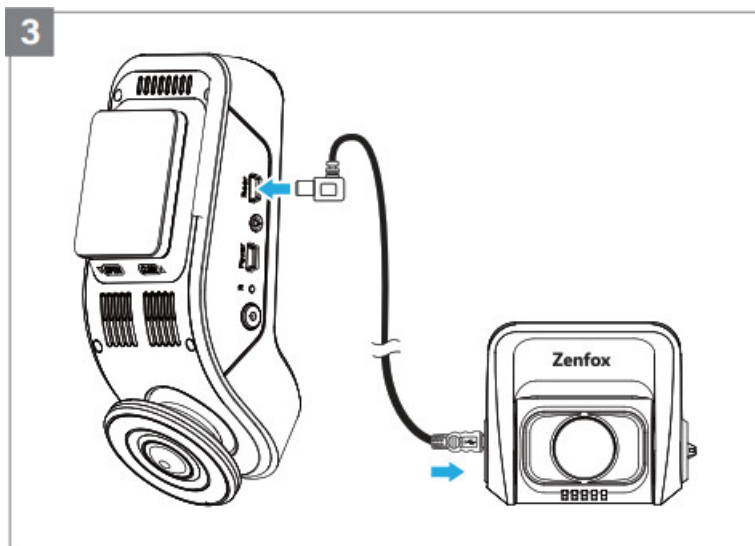

4. The overlook for dashcam installation.

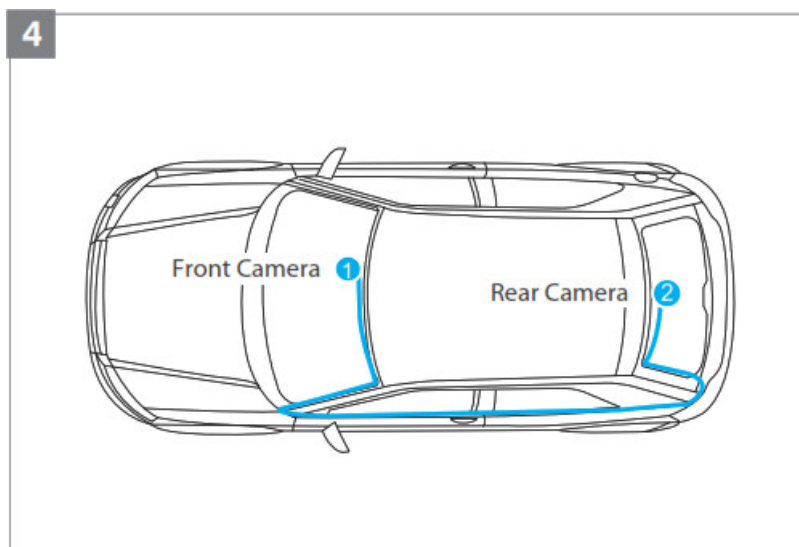

Button Scenario Guide

Buttons	Behavior
	Enter/exit setup menu.
	Move selector up; Stop/Start the video recording; Long press to change mode.
OK	Confirm the action; Lock currently recording video clip.
	Move selector down; Microphone on/off.
	Long press to turn on/off Wi-Fi; Switch live video source.
Note: Please stop recording to enter the menu.	

LED Indicators

LED	LED Status	Behavior
REC	Solid Red	Recording
	Flashing Red	Not recording; Upgrade firmware
MIC	Solid Red	Microphone on
	Lights off	Microphone off

Screen Overview

Video Mode

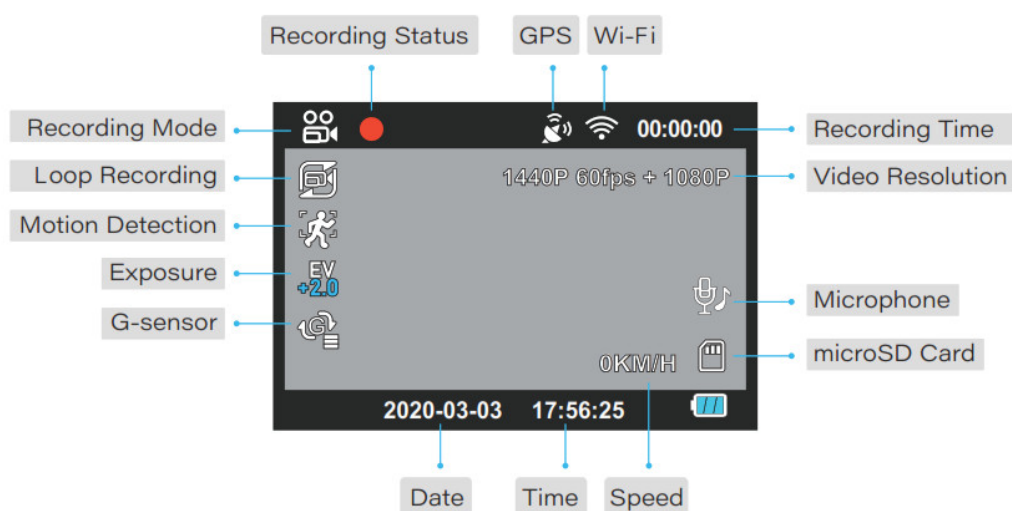

Operation

- ▶ **Power on/off** The camera will automatically turn on/off and begin recording when you turn on/off the engine.

Also, you can manually long press  button to power on/off the camera.

▶ Loop Recording

Insert a microSD card into the camera's card slot and automatic loop recording will begin once the camera detects power. The time frame for each video file is 1/2/3/5/10 minutes. When there is insufficient space in the microSD card, loop recording will automatically overwrite the oldest file one by one. Loop recording files are saved to the microSD card:/DCIM/Movie folder.

▶ Emergency Recording

Automatic emergency recording When the G-sensor is activated by a collision, the current footage will be locked automatically to avoid being overwritten by loop recording. **Manual emergency recording** Press the "OK" button during a recording will lock the current recording file. Once locked, the file will not be overwritten by the loop recording feature.



Note: Locked files are saved to microSD card: DCIM/MOVIE/RO

▶ Parking Mode

There are 2 options under parking mode:

1. Time Lapse

Time-lapse record a video at low frames-1fps. It keeps recording continuously without audio recorded.



Note: During Time-Lapse fps mode, the recorded video is silent.

2. Low Bitrate Recording

This mode record video in low bitrate for both front and rear. It keeps recording continuously in mini file size with audio recorded.

► Recording mode



Recording mode	In the memory card
Loop recording (including Motion Detection)	DCIM \ Movie
Emergency recording (Locked Video)	DCIM\RO
Parking recording (Auto Event Detection / Time-lapse Recording / Low Bitrate Recording)	DCIM \ Movie





• File Format Definition

Files recorded by the front camera, interior, and rear camera are saved separately.

2019_1201_170010_062PF.MP4	• F for the front camera
2019_1201_170010_063PI.MP4	I for the interior camera
2019_1201_170010_064PR.MP4	R for the rear camera
	P for the video recorded in parking mode.
Year Date Time Sequence Number	

• Playback Videos

Under standby mode(not recording), long-press   button to enter the playlist.

Use the arrow buttons  **REC MIC**  to select the desired video and press the button OK to play Press the   button to exit.

• GPS

An internal GPS could record data including time, date, speed, and location in the recorded videos (only available when connected with GPS signal). If disabled, your camera will no longer measure your speed and position, nor synchronize the time/date.

- **View on a TV**

The camera has an AV out port for connecting an external display such as a monitor or TV. Please note that the product doesn't come with a 3.5mm male to 3 RCA AUX cable.

- **Play Back Video on Computer**

- Remove the microSD card from the
- Insert the card into the microSD card reader and connect it to a
- The computer will detect a "removable disk" .
- There will be two folders under the DCIM folder: Movie (loop recording video files) contains subfolder: RO (Protected / Locked video files) Photo (Video snapshot files)"
- Copy the files needed to your computer

- **Connect with a Phone**

Zenfox App

Zenfox APP will allow live view of cameras and settings adjustable using a smartphone after connected with T3 Wi-Fi. Along with the live view, also support downloading videos/images directly to your phone.

Download Zenfox APP

IOS users could download it on the APP store. Android users could download it on Google Play or download APK directly from our official website <https://www.zenfox.com>. The app is free for Android devices and IOS devices.

Connect Zenfox APP

Step 1	Long press the  button on the main camera to turn on Wi-Fi.
Step 2	Use the phone to search and connect with T3 Wi-Fi.
Step 3	Open the Zenfox app and choose "Connect your camera" to use your phone to control the dashcam.
Step 4	Now you can see the live view of front, interior and rear cameras. You can change the settings and check the files on the microSD card.



Note: The default Wi-Fi password is 12345678. It can be changed by the Zenfox app. Please turn off Wi-Fi if you do not use the Zenfox app to prevent from draining the car battery.

Firmware Upgrade

Follow the instructions on this website to upgrade the firmware: (<https://support.zenfox.com>)

-  Before using a microSD card to upgrade the firmware, formatting the card in the camera is necessary to ensure stable read and write operation.
- Do not unplug or power off the camera during a firmware upgrade, it may cause the camera to subsequently fail to boot.

System Settings

You can set the product features according to your needs and preferences using the front camera or the Zenfox app. To enter the menu settings, please stop recording first.

- **Resolution:**

Setting video resolution of footage recorded, Front + Interior + Rear Camera: 2560 * 1440P + 1920 * 1080P + 1920 * 1080P 30F PS Front + Interior Camera: 2560 * 1440P 60F PS + 1920 * 1080P 30F PS

- **Bitrate:**

Low/Medium/High/Maximum Higher rate could improve the quality and smoothness of the video, especially when recording fast motion or high contrast scenes with larger video file. Lower bitrate will save space and record for a longer time.

- **Live Video Source:**

Front Camera / Interior Camera / Rear Camera / All.

- **Loop Recording:**

Off / 1 / 2 / 3 / 5 / 10 minutes. A recording will begin automatically after powering on with a microSD card in the device. Each file is recorded up to the set length, with old footage being replaced when microSD card storage is full.

- **WDR (Wide Dynamic Range):**

On / Off. The dynamic range is the ratio of the brightest portion of the image to the darkest portion of the image. WDR enables the camera to deliver video with a near-perfect exposure in varying lighting situations.

- **Exposure:**

EV Front / Interior / Rear (-2.0 – 2.0) Adjusting the value of the EV (Exposure Value) properly can create better footage under different light sources. It ranges from -2.0 to +2.0. You can adjust the EV for the front, interior, and rear camera separately. The default is set at 0.0. • Recording Audio Off/On Turn on/off recording audio.

- **G-Sens or:**

Off / Low / Middle / High The G-sensor measures shock forces and locks the video recorded at the time. The settings from “low to high” determine the amount of force needed to lock the file from being overwritten. We recommend that you set it at low.

- **Parking Mode**

OFF / Time Lapse lips / Low Bitrate Recording Details could see at the operation part.

- **Time-lapse Recording:**

Record video from frames captured at specified time intervals to conserve memory and reduce the time it takes to review video. The default is off.

- **Wi-Fi**

Off / 2.4GHz / 5GHz

5GHz Wi-Fi recommends for faster speed.

Note: Please turn off Wi-Fi when you are not using the Zenfox app.

- **GPS:**

On/Off

Turn on / off GPS logger. The built-in GPS module includes the location data in the recorded videos. If disabled, your camera will no longer measure your speed and position; nor synchronize the time/date. (Only available when connected with GPS signal) .

- **GPS Speed Unit:**

Kilometer per hour (KMH), miles per hour (MPH).

- **GPS Info Stamp:**

Off / All Info / Speed / Coordinates

Imprint the GPS information on the recorded video.

- **Date / Time:** Set system date /

- **Time Zone:** Set the current time zone for GPS time and date

- **Date Stamp:** On / Imprint the time and date on the recorded video.

- **Camera Model Stamp:** On / Imprint the camera model on the recorded video.

- **Car Number:** On / Imprint the camera model on the recorded video.

- **Custom Text Stamp:** Imprint the customize text on the recorded

- **Beep Sound**

On / Off

Turn on/off all notification sounds.

- **Image Mirror**

Rear Camera Off / Rear Camera On

Rear Camera Mirror can make the image of the rear camera to be displayed and recorded as reversed compared to the actual view.

- **Boot Delay**

Off / 5sec / 10sec

The camera will boot seconds later when powered on.

- **IR LED**

On/Auto/Off

On means, IR lights are always on, so the video color is black and white. Auto means the dashcam will decide to turn on/off infrared lights with different light conditions. Off means, the IR lights are all turned off.

By means, IR lights are always on, so the video color is black and white. Auto means the dashcam will decide to turn on/off infrared lights with different light conditions. Off means, the IR lights are all turned off.

- **Language**

English

- **Frequency:**

50Hz / 60Hz. Set it to minimize flickering and banding in the recorded video.

- **Record Audio:**

Turn on and of the microphone. This can also be changed during recording by pressing the microphone button



- **Screen Saver:** 1 Minute / 3 Minutes / 5 Minutes.

The screen turns off by default after the interval you choose while recording.

- **Format:** The operation will delete all data on the microSD card.

Note: Once you format the card, all information will be deleted and unrecoverable. Make sure to back up all files that you needed before formatting.

- **Default Setting:** Restore device to factory settings.

- **Firmware Version:** Check the current firmware version of the camera.

Notice

FCC Caution:

Any changes or modifications not expressly approved by the party responsible for compliance could void the user's authority to operate the equipment.

This device complies with part 15 of the FCC Rules. Operation is subject to the following two conditions: (1) This device may not cause harmful interference, and (2) this device must accept any interference received, including interference that may cause undesired operation

Note: This equipment has been tested and found to comply with the limits for a Class B digital device, pursuant to part 15 of the FCC Rules. These limits are designed to provide reasonable protection against harmful interference in a residential installation. This equipment generates, uses, and can radiate radio frequency energy and, if not installed and used in accordance with the instructions, may cause harmful interference to radio communications. However, there is no guarantee that interference will not occur in a particular installation. If this equipment does cause harmful interference to radio or television reception, which can be determined by turning the equipment off and on, the user is encouraged to try to correct the interference by one or more of the following measures:

– Reorient or relocate the receiving antenna.

- Increase the separation between the equipment and receiver.
- Connect the equipment into an outlet on a circuit different from that to which the receiver is connected.

Consult the dealer or an experienced radio/TV technician for help

FCC RF Radiation Exposure Statement:

- 1. This Transmitter must not be co-located or operating in conjunction with any other antenna or
- 2. This equipment complies with RF radiation exposure limits set forth for an uncontrolled environment. This equipment should be installed and operated with a minimum distance 20cm between the radiator& your body.

Zenfox Limited declares that this Radio Frequency peripheral is in compliance with the essential requirements and other relevant provisions of Directive 1999/5/EC.

Customer Service

12-month Limited warranty, Lifetime technical support support@zenfox.com

Mon-Fri 9am-6pm

The User Manual is available on <https://support.zenfox.com>



Documents / Resources

	Zenfox T3 Dash Camera [pdf] User Manual T3 Dash Camera
--	---