



## ZEEVA XB Remote Control Dart Tank with Suction Darts Instruction Manual

[Home](#) » [Zeeva](#) » ZEEVA XB Remote Control Dart Tank with Suction Darts Instruction Manual 



### REMOTE CONTROL DART TANK *with suction darts*

Size: 350(w) x 220(h) mm

Instruction Manual

Thank you for purchasing the  
REMOTE CONTROL DART TANK.

This manual provides more information about this DART TANK,  
please read the instructions before using.

AGES 10+



## Contents

- 1 Product Overview
- 2 Package Contents
- 3 Specifications
- 4 Standard Control
- 5 How to shoot the suction dart
- 6 IMPORTANT: BATTERY INFORMATION
- 7 FCC Statement
- 8 Documents / Resources
- 9 Related Posts

## Product Overview

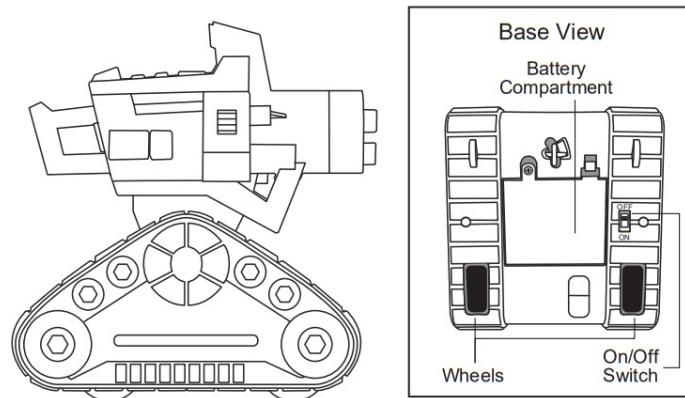

Remote Control Dart Tank

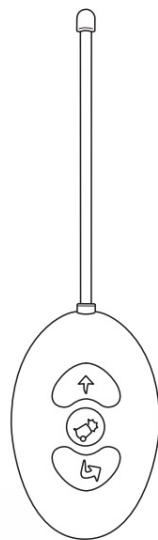

Remote Controller

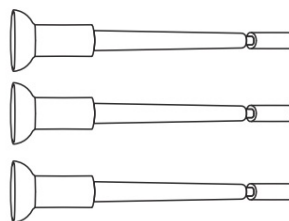

Suction Dart x 3

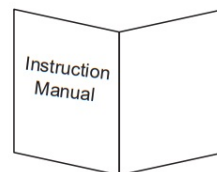

Instruction Manual

## Package Contents

- Remote Control Dart Tank x 1
- Remote Control x 1
- Suction Dart x 3
- Instruction Manual x 1

## Specifications

Remote Control Dart Tank Power Supply:

3 x "AA" 1.5V Batteries

(Alkaline type preferred, not included)

Remote Control Power Supply:

2 x "AAA" 1.5V batteries (not included)

## Remote

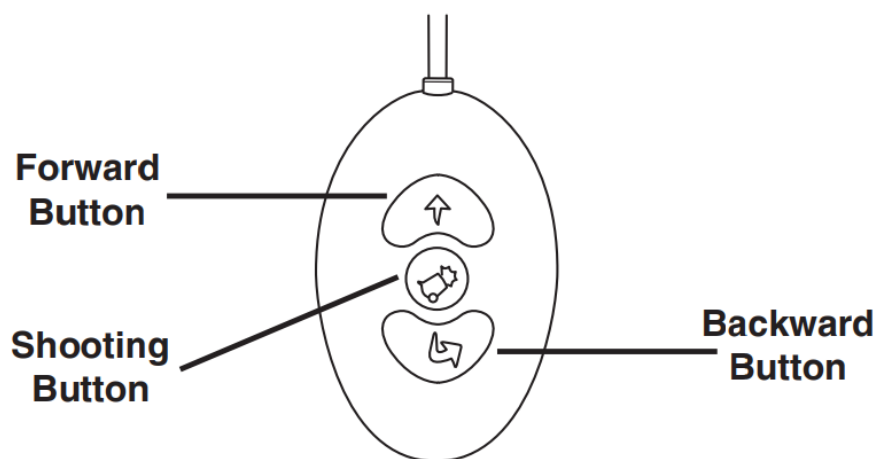

## Standard Control

**Note:** To avoid losing control, always pay attention when controlling the Remote Control Dart Tank.

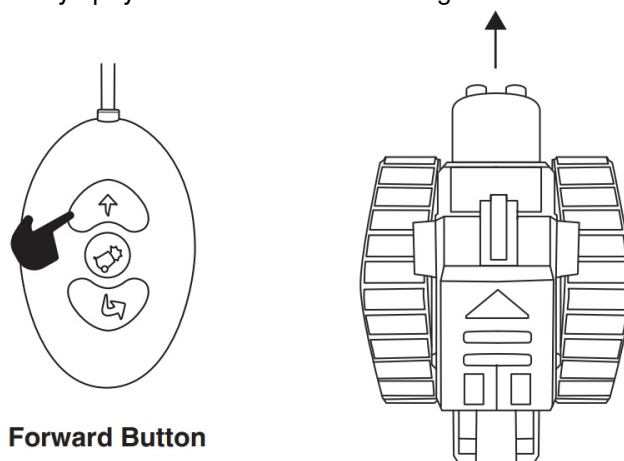

Press Forward Button to move forward the tank

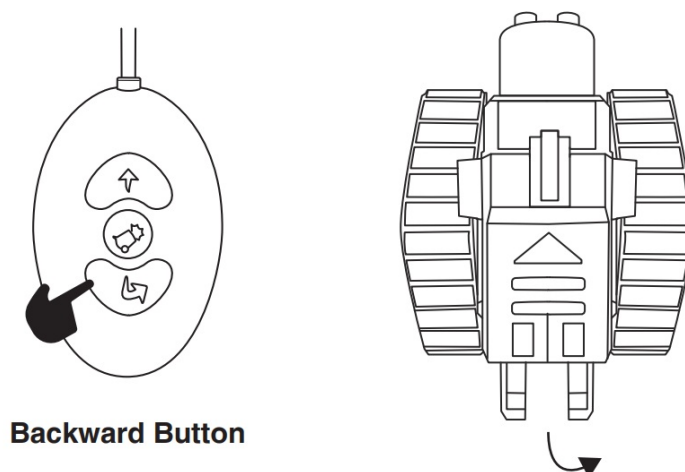

Press Backward Button to move backward anti-clockwise the tank

## Power On/Off

Slide the ON/OFF Switch to ON to turn on the RC Dart Tank.

Slide the ON/OFF Switch to OFF to turn off the RC Dart Tank.

## How to shoot the suction dart

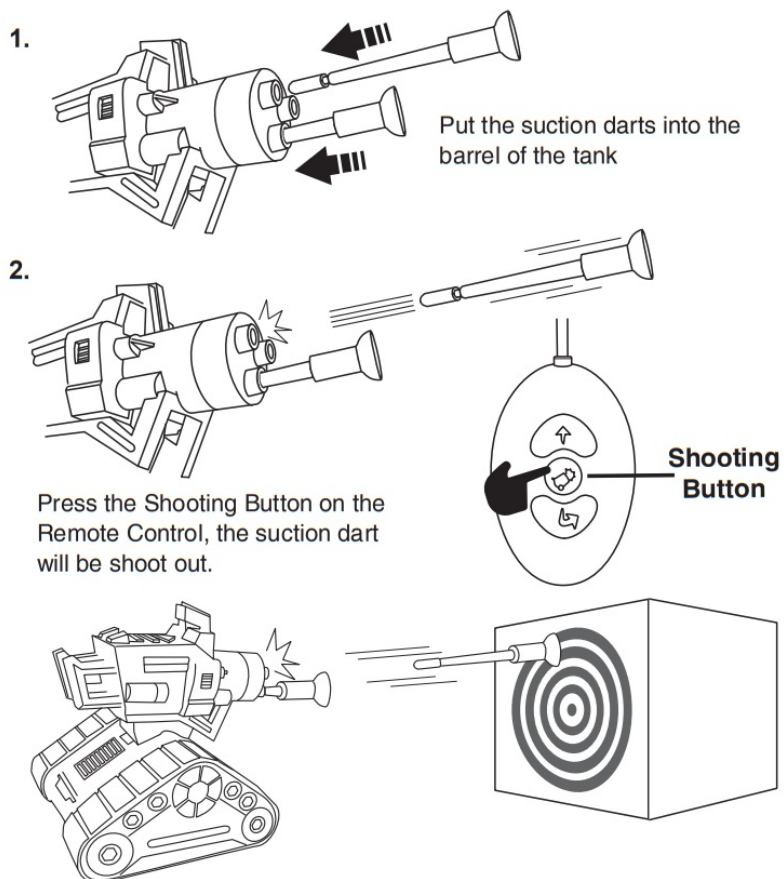

Recommend to use the back of the packaging for the target when shooting.



**Warning:** Never aim the suction dart at the eyes and any part of the body.

## Batteries Installation – Dart Tank

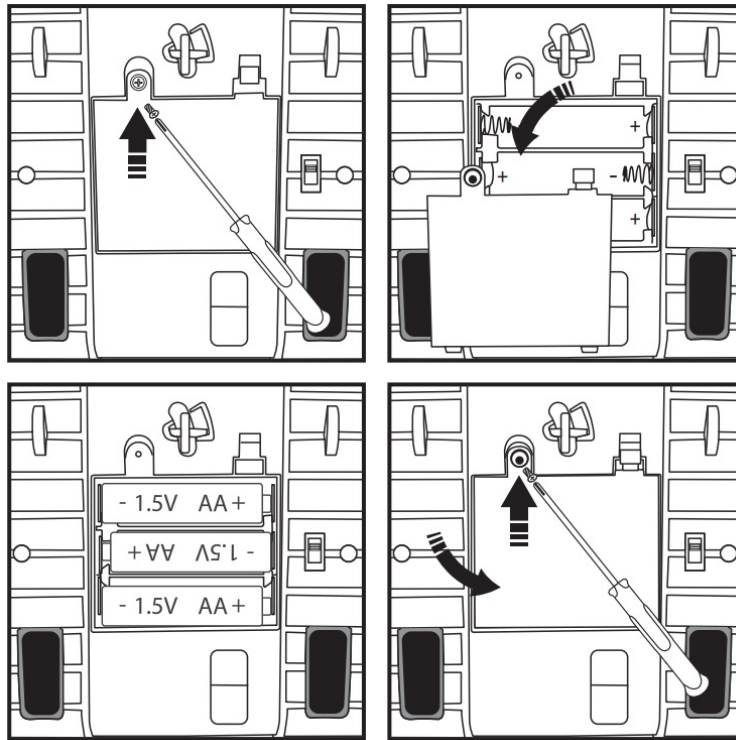

To install batteries into the Remote Control Dart Tank, unscrew the screw on the battery box cover to open the cover. Insert 3 x “AA” 1.5V batteries (Not Included) into the battery box. Batteries should be placed as shown on the diagram. Put back in place the battery box cover and tighten the screw.

**Notice:**

When placing the batteries, you must insert them according to the correct polarity, the Remote Control Dart Tank won’t function if the batteries are reversed.

**Batteries Installation – Remote Control**

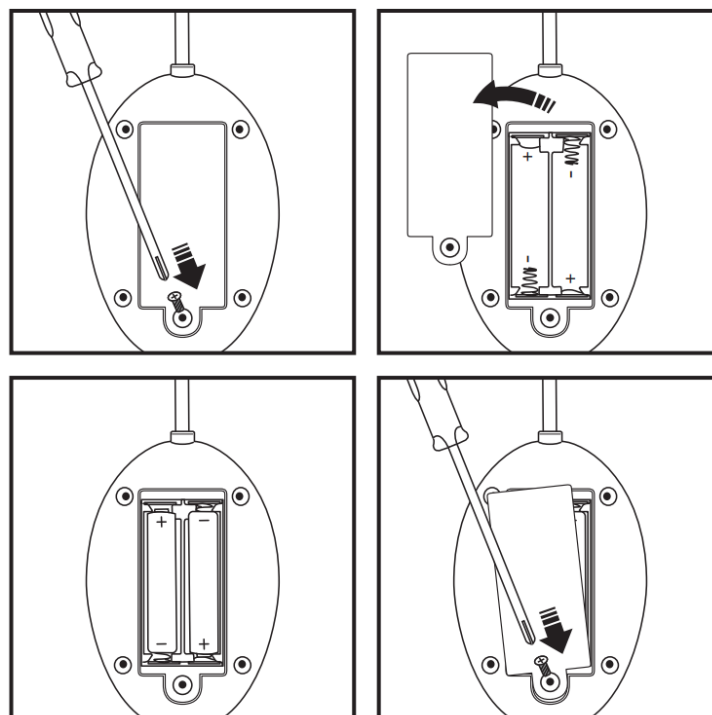

To install batteries into the Remote Control, unscrew the screw on the battery box cover to open the battery compartment. Insert 2 x “AAA” 1.5V batteries (Not Included) into the battery box. Batteries should be placed as shown on the diagram.

Put back in place the battery box cover and tighten the screw.

**Notice:**

When placing the batteries, you must insert them according to the correct polarity, the Remote Control won’t function if the batteries are reversed.

## Performance Tips

1. Do not drive the RC Dart Tank on grass, or sand, or go through water.
2. Do not drive the RC Dart Tank in windy or rainy weather.
3. Do not drive the RC Dart Tank into any sharp object.
4. Keep fingers, hair, and loose clothing away from RC Dart Tank wheels.
5. Never aim the suction dart to the eyes and any part of the body.

## Care and Maintenance

Always use a dry and soft cloth to clean this product.

Avoid this product from being exposed to sunlight or heat.

Avoid immersing these toys in water, otherwise, the electronic parts may be damaged.

Check the product regularly. If any damages are discovered, please stop using it immediately, until it is completely repaired and in good working condition.

## IMPORTANT: BATTERY INFORMATION



### **WARNING:** TO AVOID BATTERY LEAKAGE:

1. The batteries used with this product are small parts and should be kept away from small children who still put things in their mouths. If they are swallowed, promptly see a doctor and have the doctor phone the American Association of Poison Control Centers (1-800-222-1222).
2. Always purchase the correct size and grade of battery most suitable for the intended use.
3. Do not mix old and new batteries, alkaline, standard (Carbon – Zinc), or rechargeable (Nickel-cadmium) batteries.
4. Clean the battery contacts and those of the device prior to battery installation.
5. Ensure the batteries are installed correctly with the regard to polarity (+ and -).
6. Always remove batteries if consumed or if a product is to be left unused for a long time.

## Warning

This product is suitable to be used by people who have operating experience in a remote toy or aged no less than 10 years old.

Please do not put the product in your mouth to prevent choking hazards of small parts.

Except for the screw on the battery cover. Never try to open the product by unscrewing the other screws of the product. Nothing inside for service.

Please do not put your finger into available interspaces.

Please do not play the product in a brutal way such as throwing, crashing, or twisting it.

Please store the smaller-sized product accessories in places that are out of reach of children, in order to avoid the occurrence of accidents.

Avoid placing the batteries in places at high temperatures and avoid exposure to heat.

When young children are operating the product, it shall be ensured that the adults are guiding and making sure the product control is within the viewing range of the controller (or instructor) so that it makes the control of the toy more convenient.

When the product is not in use, please switch off the power supplies of the toy, and remove the batteries from the product.

Please note that we won't take any responsibility for any wrong operation as this may result in severe injury or loss of property, and we cannot control the operating process during the time when the user assembles or uses

this product.

Once this product is sold, we won't be responsible for any safety responsibility during the time the user operates or uses or controls of this product.

## FCC Statement

This device complies with the part 15 of the FCC rules. Operation is subject to the following two conditions:(1) this device may not cause harmful interference, and (2) this device must accept any interference received, including interference that may cause undesired operation.

Caution: Changes or modifications not expressly approved by the party responsible for compliance could void the user's authority to operate the equipment.

NOTE: This equipment has been tested and found to comply with the limits for a Class B digital device, pursuant to Part 15 of the FCC Rules. These limits are designed to provide reasonable protection against harmful interference in a residential installation. This equipment generates, uses, and can radiate radio frequency energy and, if not installed and used in accordance with instructions may cause harmful interference to radio or television reception, which can be determined by turning the equipment off and on. The user is encouraged to try to correct the interference by one or more of the following measures:

- Reorient or relocate the receiving antenna.
- Increase the separation between the equipment and receiver.
- Connect the equipment into an outlet on a circuit different from that to which the receiver is connected.
- Consult the dealer or experienced radio/ TV technician for help.

## RF warning statement:

The device has been evaluated to meet general RF exposure requirements. The device can be used in portable exposure conditions without restriction.

## Keep All Relevant Information for Future Reference



Distributed by 1616 Holdings, Inc.  
701 Market Street, Suite 200  
Philadelphia, PA 19106  
Made in China

## Documents / Resources



[ZEEVA XB Remote Control Dart Tank with Suction Darts](#) [pdf] Instruction Manual  
ET-0122-27, ET012227, 2ADM5-ET-0122-27, 2ADM5ET012227, XB, Remote Control Dart Tank  
with Suction Darts, Control Dart Tank, Dart Tank, Tank