



Zebra DS4308P Digital Scanner User Manual

[Home](#) » [ZEBRA](#) » Zebra DS4308P Digital Scanner User Manual 

Contents

- [1 Zebra DS4308P Digital Scanner User Manual](#)
- [2 Warranty](#)
- [3 Scanner Features](#)
- [4 Scanner Adjustment](#)
- [5 Connect Host Interface](#)
- [6 Utility Functionality](#)
- [7 Troubleshooting](#)
- [8 References](#)



Zebra DS4308P Digital Scanner User Manual

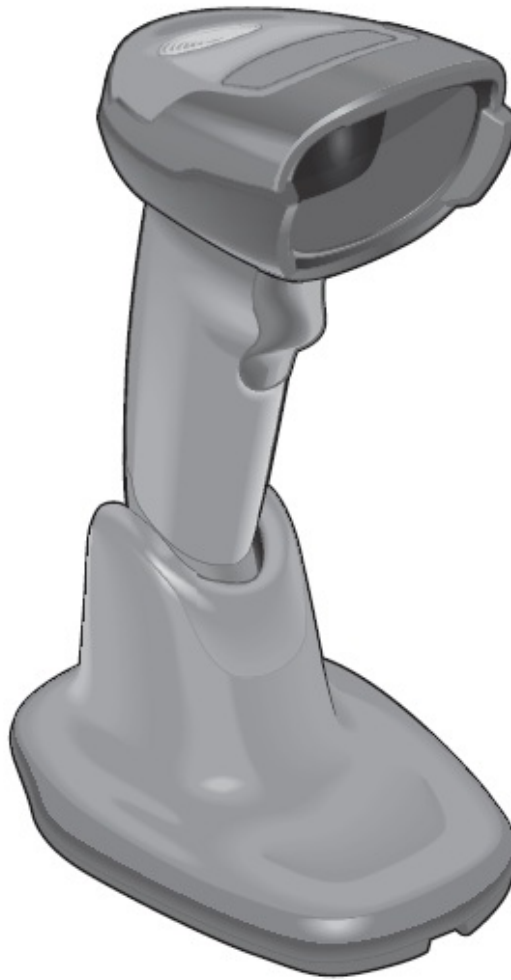

Zebra reserves the right to make changes to any product to improve reliability, function, or design. Zebra does not assume any product liability arising out of, or in connection with, the application or use of any product, circuit, or application described herein.

No license is granted, either expressly or by implication, estoppel, or otherwise, under any patent right or patent, covering or relating to any combination, system, apparatus, machine, material, method, or process in which Zebra products might be used. An implied license exists only for equipment, circuits, and subsystems contained in Zebra products.

Note: This Product may contain Open Source Software. For information regarding licenses, acknowledgements, required copyright notices, and other usage terms, refer to the Documentation at:

<http://www.zebra.com/support>.

Warranty

For the complete Zebra hardware product warranty statement, go to: <http://www.zebra.com/warranty>.

For Australia Only

For Australia Only. This warranty is given by Zebra Technologies Asia Pacific Pte. Ltd., 71 Robinson Road, #05-02/03, Singapore 068895, Singapore. Our goods come with guarantees that cannot be excluded under Australian Consumer Law. You are entitled to a replacement or refund for a major failure and compensation for any other reasonably foreseeable loss or damage.

You are also entitled to have the goods repaired or replaced if the goods fail to be of acceptable quality and the failure does not amount to a major failure. Zebra Technologies Corporation Australia's limited warranty above is in addition to any rights and remedies you may have under the Australian Consumer Law. If you have any queries, please call Zebra Technologies Corporation at +65 6858 0722. You may also visit our website:

<http://www.zebra.com> for the most updated warranty terms.

Service Information

If you have a problem using the equipment, contact your facility's Technical or Systems Support. If there is a problem with the equipment, they will contact the Zebra Global Customer Support Center at:

<http://www.zebra.com/support>.

For the latest version of this GUI, go to: <http://www.zebra.com/support>.

Scanner Features

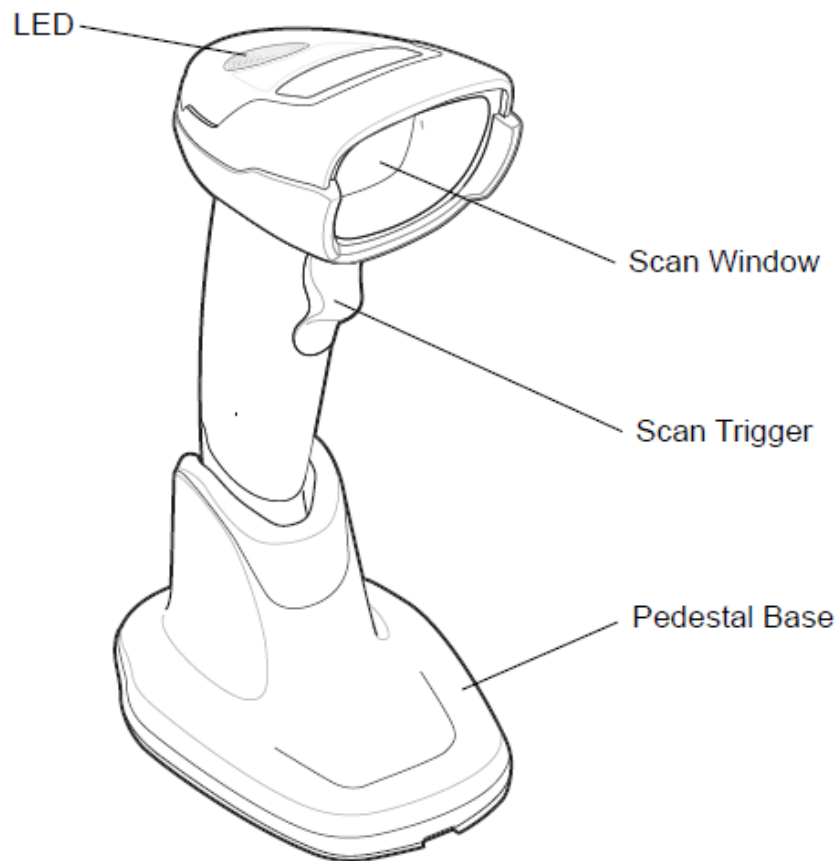

Scanner Adjustment

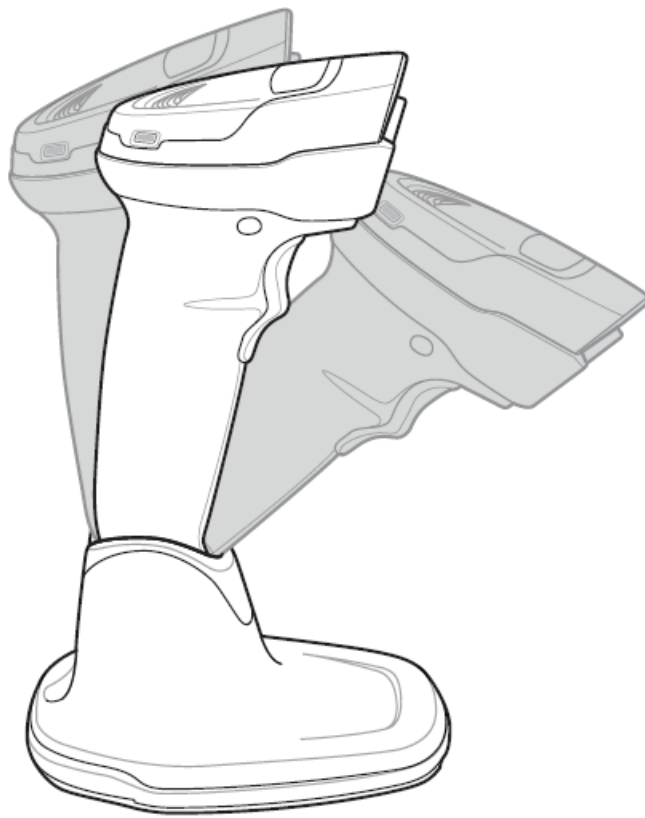

Connect Host Interface

USB

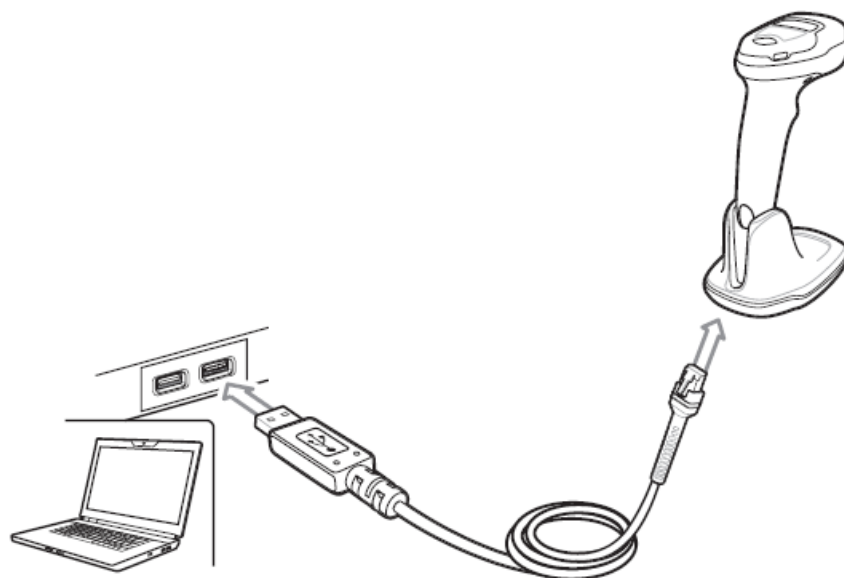

The digital scanner automatically detects the host interface type and uses the default setting. If the default (*) does not meet your requirements, scan another host bar code below.



*USB Keyboard HID



IBM OPOS
(IBM Hand-Held USB with Full Scan Disable)

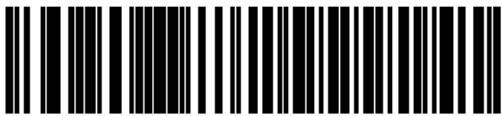

IBM Hand-Held USB



Symbol Native API (SNAPI) with Imaging Interface

RS-232

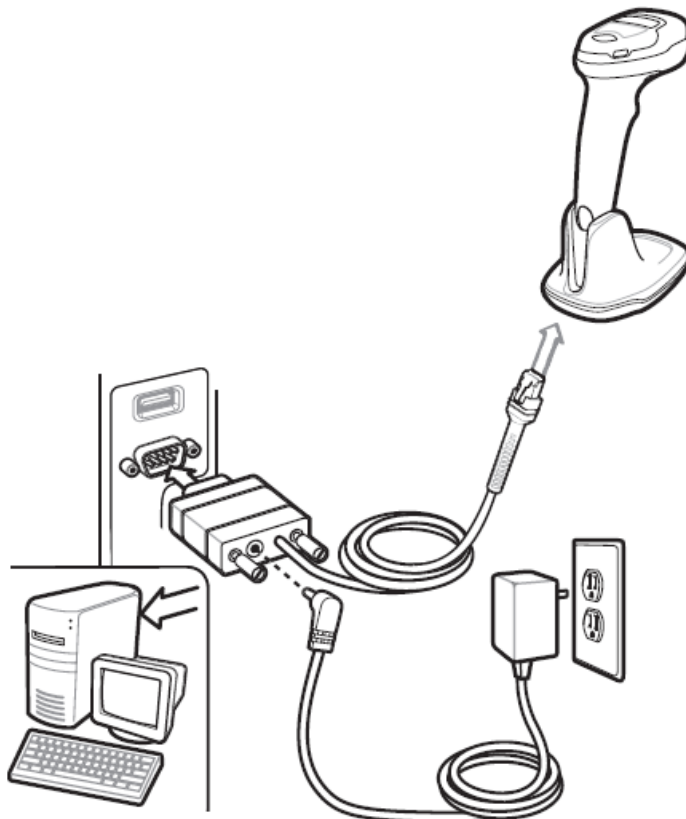

The digital scanner automatically detects the host interface type and uses the default setting. If the default (*) does

not meet your requirements, scan another host bar code below.



* Standard RS-232



ICL RS-232



Wincor-Nixdorf RS-232 Mode A



Wincor-Nixdorf RS-232 Mode B



OPOS/JPOS



Fujitsu RS-232

Keyboard Wedge

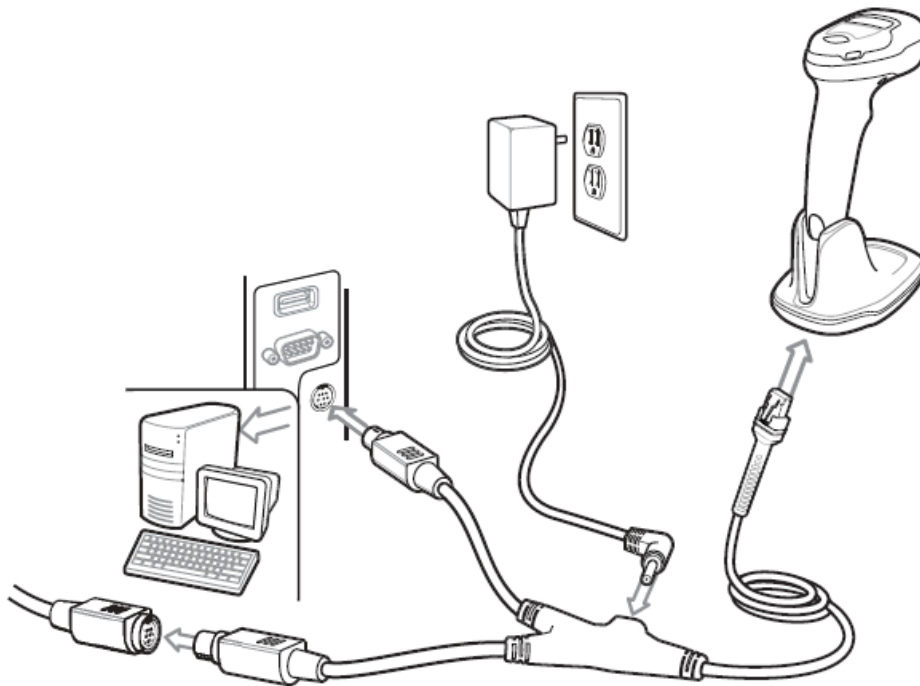

The digital scanner automatically detects the host interface type and uses the default setting. If the default (*) does not meet your requirements, scan the IBM PC/AT & IBM PC Compatibles bar code below.



*** IBM AT Notebook**



IBM PC/AT & IBM PC Compatible

IBM 46XX

The digital scanner automatically detects the IBM host, but there is no default setting. Scan one of the bar codes below to select the appropriate port.

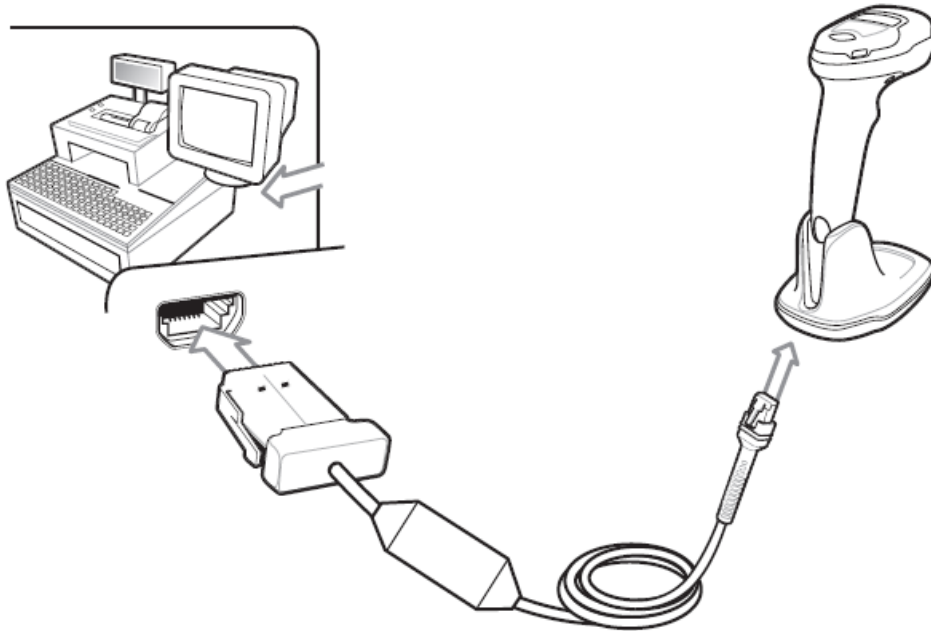

Non-IBM Scanner Emulation (Port 5B)



Hand-Held Scanner Emulation (Port 9B)



Table-Top Scanner Emulation (Port 17)

Set Defaults Bar Code



Return to Factory Defaults

Enter Key Bar Code (Carriage Return/Line Feed)

Add an Enter key after scanned data.

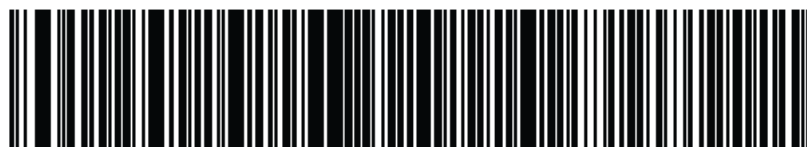

Enter Key (Carriage Return/Line Feed)

Tab Key Bar Code

Add a Tab key after scanned data.



Tab Key

USB Caps Lock Override



Override Caps Lock Key (Enable)



* Do Not Override Caps Lock Key (Disable)

Scanning

Hand-Held and Hands-Free (Presentation) Scanning

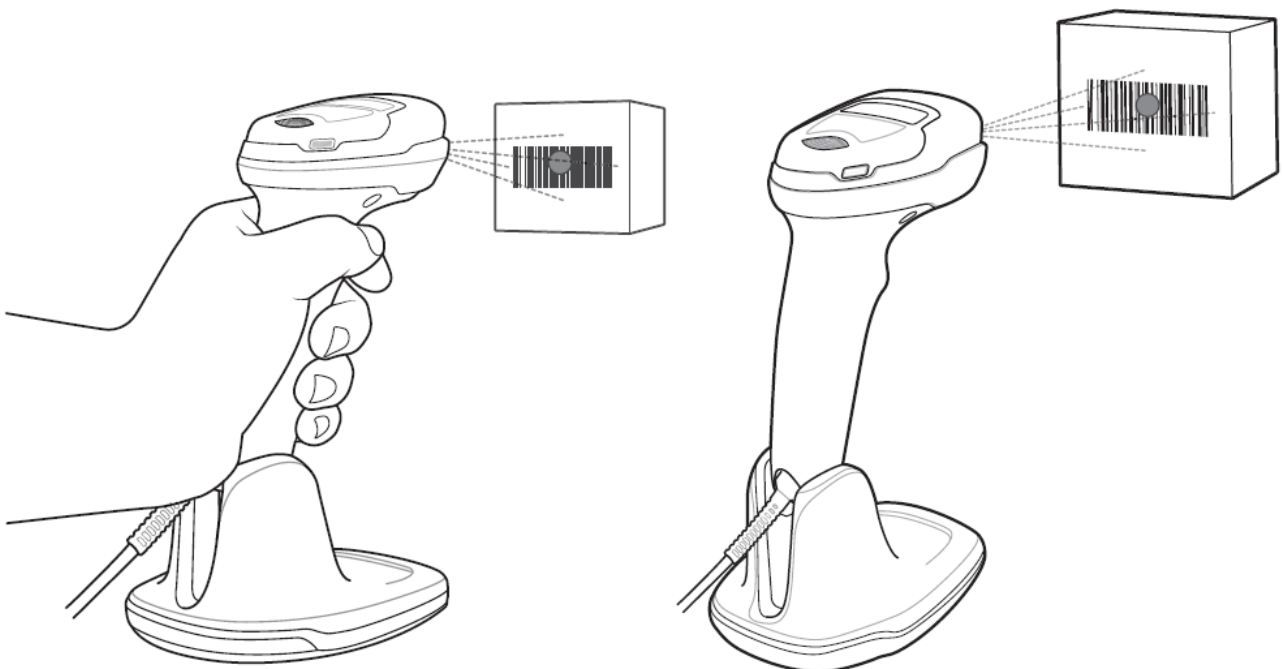

Aiming



LED Indications

Hand-Held Scanning

The scanner is on and ready to scan, or no power to the scanner	Off
A bar code is successfully decoded	Green
Transmission error	Red

Hand-Free (Presentation) Scanning

Beeper Indications

Indication	Beeper Sequence
Power up	Low/medium/high beep
A bar code is successfully decoded	Short high beep
Transmission error	4 long low beeps
Successful parameter setting	High/low/high/low beep
The correct programming sequence was performed	High/low beep
Incorrect programming sequence, or Cancel bar code scanned	Low/high beep

123Scan2

123Scan2 is an easy-to-use, PC-based software tool that enables rapid and easy customized setup of a scanner via a bar code or USB cable.

For more information, visit: <http://www.zebra.com/123Scan2>.

Utility Functionality

- Device configuration
- Electronic programming (USB cable)
- Programming bar code(s)
- Data view – Scan log (display scanned bar code data)
- Access asset tracking information
- Upgrade firmware and view release notes
- Remote management (SMS package generation)

Recommended Usage / Optimum Body Posture

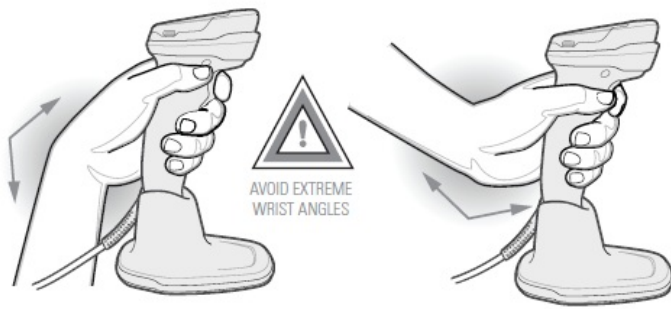

Avoid Extreme Wrist Angles



Avoid Bending



Avoid Reaching

Troubleshooting

Indication	Speaker Sequence
------------	------------------

The aiming dot does not appear

No power to the scanner	Connect the scanner to a powered host, or connect the power supply
Aiming dot is disabled	Enable aiming dot

Scanner decodes bar barcode but does not transmit data

The interface cable is loose	Reconnect the cable
Transmission or format error	Set the proper communication and conversion parameters
Invalid ADF rule	Program the correct ADF rules

The scanner does not decode bar barcode

Scanner not programmed for bar code type	Enable that barcode type
Bar barcode is unreadable	Ensure the bar code is not defaced; scan a test bar code of the same bar code type.
Bar barcode is out of the aiming dot area	Move the aiming dot over the barcode

The scanned data was incorrectly displayed on the host

The host interface is not configured properly	Scan the appropriate host parameter bar codes
Region improperly configured	Select an appropriate country and language encoding scheme

Regulatory Information

This guide applies to Model Number: DS4308P.

All Zebra devices are designed to be compliant with rules and regulations in the locations where they are sold and will be labeled as required. Local language translations are available at the following website:

<http://www.zebra.com/support>.

Any changes or modifications to Zebra equipment, not expressly approved by Zebra, could void the user's authority to operate the equipment.

CAUTION: Only use Zebra-approved and UL-listed accessories.

Declared maximum operating temperature: 40°C.

LED Devices

Aim/Illumination/Proximity

Classified as "EXEMPT RISK GROUP" according to IEC 62471:2006 and EN 62471:2008

Pulse duration: Continuous

Health and Safety Recommendations



Ergonomic Recommendations

Caution: To avoid or minimize the potential risk of ergonomic injury, follow the recommendations below. Consult with your local Health & Safety Manager to ensure that you are adhering to your company's safety programs to prevent employee injury.

- Reduce or eliminate repetitive motion.
- Maintain a natural position.
- Reduce or eliminate excessive force.
- Keep objects that are used frequently within easy reach
- Perform tasks at the correct heights
- Reduce or eliminate vibration
- Reduce or eliminate direct pressure
- Provide adjustable workstations
- Provide adequate clearance
- Provide a suitable working environment
- Improve work procedures.

Power Supply

Use ONLY an approved UL LISTED ITE (IEC/EN 60950-1, SELV) power supply with electrical ratings: Output 5Vdc, min 850mA, with a maximum ambient temperature of at least 40 degrees C. Use of an alternative power supply will invalidate any approvals given to this unit and may be dangerous.

Radio Frequency Interference Requirements – FCC

Note: This equipment has been tested and found to comply with the limits for a Class B digital device, under Part 15 of the FCC rules. These limits are designed to provide reasonable protection against harmful interference in a residential installation.



This equipment generates, uses, and can radiate radio frequency energy and, if not installed and used by the instructions, may cause harmful interference to the radio communications. However, there is no guarantee that interference will not occur in a particular installation. This equipment does cause harmful interference to radio or television reception, which can be determined by turning the equipment off and on. The user is encouraged to try to correct the interference by one or more of the following measures:

- Reorient or relocate the receiving antenna
- Increase the separation between the equipment and the receiver
- Connect the equipment to an outlet on a circuit different from that to which the receiver is connected
- Consult the dealer or an experienced radio/TV technician for help.

Radio Frequency Interference Requirements – Canada

This Class B digital apparatus complies with Canadian ICES-003.



Marking and the European Economic Area (EEA)

Statement of Compliance (Non-radio products)

Zebra hereby declares that this device complies with all applicable Directives, 2014/30/EU, 2014/35/EU, and 2011/65/EU. The full text of the EU Declaration of Conformity is available at the following.

Internet address: <http://www.zebra.com/doc>

Japan (VCCI) – Voluntary Control Council for Interference

Class B ITE

Korea Warning Statement for Class B ITE

Other Countries

Brazil

Regulatory declarations for DS4308P – BRAZIL

For more information, consult the website www.anatel.gov.br

Mexico

Restrict Frequency Range to: 2.450 – 2.4835 GHz.

S. Korea

For radio equipment using 2400~2483.5MHz or 5725~5825MHz, the following two expressions should be displayed;



Waste Electrical and Electronic Equipment (WEEE)

For EU Customers: All products at the end of their life must be returned to Zebra for recycling. For information on how to return a product, please go to: <http://www.zebra.com/weee>.

TURKISH WEEE Statement of Compliance

China RoHS

This table was created to comply with China RoHS requirements.

(Parts)						
	(Pb)	(Hg)	(Cd)	(Cr (VI))	(PBB)	(PBDE)
(Metal Parts)	X	0	0	0	0	0
(Circuit Modules)	X	0	0	0	0	0
(Cables and Cable Assemblies)	0	0	0	0	0	0
(Plastic and Polymeric Parts)	0	0	0	0	0	0
(Optics and Optical Components)	X	0	0	0	0	0
(Batteries)	0	0	0	0	0	0

Zebra Technologies Corporation

Lincolnshire, IL, U.S.A.

<http://www.zebra.com>

Zebra and the stylized Zebra head are trademarks of ZIH Corp., registered in many jurisdictions worldwide. All other trademarks are the property of their respective owners.

2016 Symbol Technologies LLC, a subsidiary of Zebra Technologies Corporation. All rights reserved.

Download PDF: [Zebra DS4308P Digital Scanner User Manual](#)

References

- [User Manual](#)

[Manuals+](#), [Privacy Policy](#)

This website is an independent publication and is neither affiliated with nor endorsed by any of the trademark owners. The "Bluetooth®" word mark and logos are registered trademarks owned by Bluetooth SIG, Inc. The "Wi-Fi®" word mark and logos are registered trademarks owned by the Wi-Fi Alliance. Any use of these marks on this website does not imply any affiliation with or endorsement.