

ZEBRA ZD611R Desktop Printer



ZEBRA ZD611R Desktop Printer User Guide

[Home](#) » [ZEBRA](#) » ZEBRA ZD611R Desktop Printer User Guide 

Contents

- [1 ZEBRA ZD611R Desktop Printer](#)
- [2 Product Information](#)
- [3 Product Usage Instructions](#)
- [4 Setup](#)
- [5 Remove Packing](#)
- [6 Load Media](#)
- [7 Adjust Sensor](#)
- [8 Load Ribbon](#)
- [9 Close Printer](#)
- [10 Connect Power](#)
- [11 Connect USB](#)
- [12 Power On](#)
- [13 Smart Calibration](#)
- [14 Cleaning](#)
- [15 FAQ](#)
- [16 Documents / Resources](#)
 - [16.1 References](#)



ZEBRA ZD611R Desktop Printer



Product Information

Specifications:

- **Model:** ZD611R
- **Type:** Desktop Printer
- **Manufacturer:** Zebra Technologies
- **Power Supply:** AC adapter
- **Connectivity:** USB
- **Compatibility:** Microsoft Windows-based computers

Product Usage Instructions

Setup:

Before starting, ensure the printer driver is installed by visiting zebra.com/setup and following the installation instructions.

Remove Packing:

Slide the release latches to the front to unlock the cover. Open the printer and remove the packing materials.

Load Media:

1. Unroll and discard the outer layer of the media roll.
2. Spread the roll holders open and place the roll into the printer.
3. Verify the roll spins easily on the holder.
4. Pull the end of the roll past the front edge of the printer and press the media under the guides.
5. Align the sensor to the centre of the roll for regular labels and receipts.

Load Ribbon:

1. Align the sensor to marks away from the centre of the roll for marked labels.
2. Attach the ribbon to the spool and printhead, then advance the ribbon using the take-up wheel.

Close Printer:

Push down on the front edge of the printer until it locks.

Connect Power:

1. Plug the power supply into the printer.
2. Connect the power cable to the power supply.
3. Plug the power cord into an appropriate receptacle. The power supply light should turn green.

Power On:

Press the power button. The printer status light will turn green when ready.

Smart Calibration:

Follow steps to calibrate the printer for optimal performance.

Print Configuration Report:

Remove port blocker label and connect the USB cable to print a configuration report.

Setup**IMPORTANT**

Go to zebra.com/setup and install the driver for your printer



The driver **MUST** be installed before connecting the printer to the computer, or it will cause complications. If your Microsoft Windows-based computer does not have the driver installed for this printer, download it from zebra.com/setup and install it before continuing.

Remove Packing



Slide the release latches (1) to the front to unlock the cover.

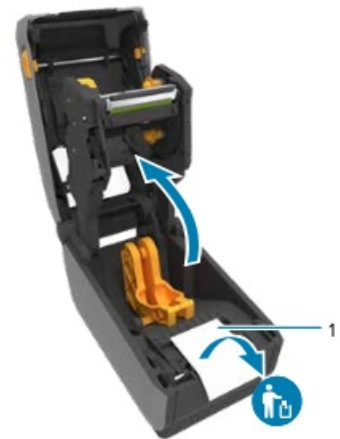

Open the printer and remove the packing (1).

- Slide the release latches (1) to the front to unlock the cover.
- And remove the packing (1).

Load Media

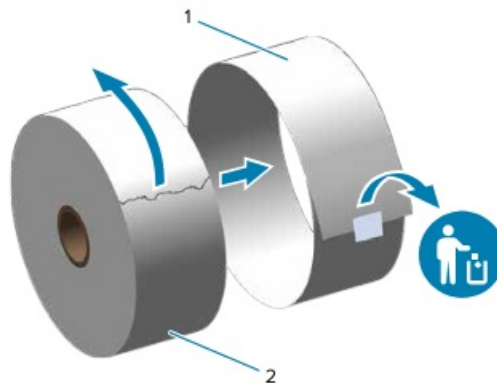

Unroll and discard the outer layer (2) of the media roll (1).

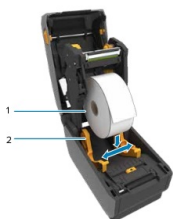

Spread the roll holders (1) open and place the roll (2) into the printer.



Verify the roll spins easily on the holder.



Pull the end of the roll past the front edge of the printer.

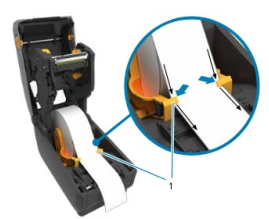

Press the media under the guides (1).

- Unroll and discard the outer layer (2) of the media roll (1).
- Spread the roll holders (1) open and place the roll (2) into the printer.
- Verify the roll spins easily on the holder
- Pull the end of the roll past the front edge of the printer.
- Press the media under the guides (1).

Adjust Sensor

- Align the sensor (1) to the center of the roll for regular labels and receipts.



Align the sensor (1) to the center of the roll for regular labels and receipts.

- Align the sensor (2) to marks (1) away from the centre of the roll for marked labels.

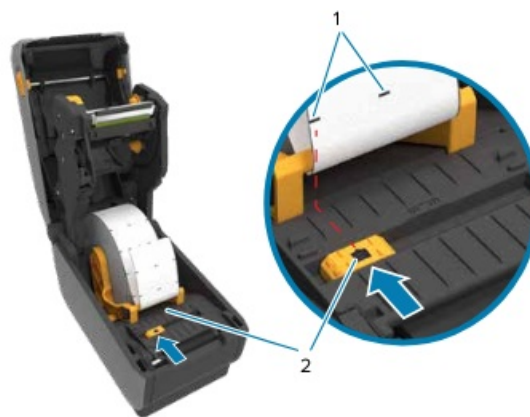

Load Ribbon

- Push the right side of the spool (1) onto the spring-loaded spindle (2).

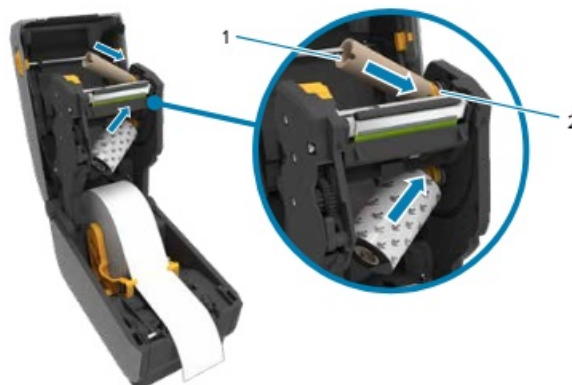

- Place the left side of the spool (2) on the spindle (1) aligning it with the notches (3).

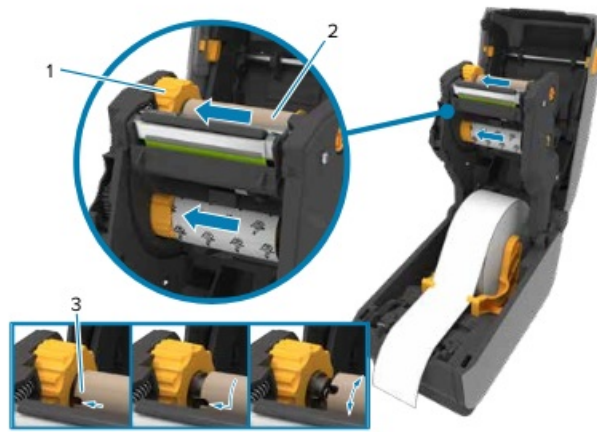

- Pull the supply ribbon leader (2) up and over the printhead (1) and attach it to the take-up spool (3).

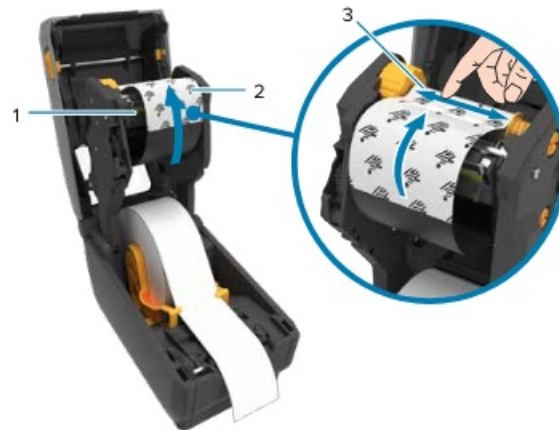

- Turn the ribbon take-up wheel (1) to remove the slack and advance the ribbon.



Close Printer

Push down on the front edge of the printer until it locks.



Connect Power

1. A. Plug the power supply into the printer.
2. B. Plug the power cable into the power supply.



3. C. Plug the power cord into an appropriate receptacle.
4. D. The power supply lights are green.

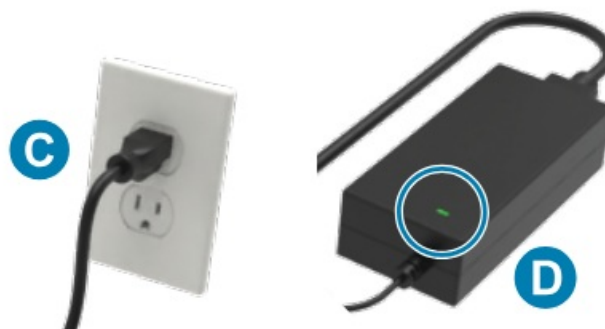

Connect USB

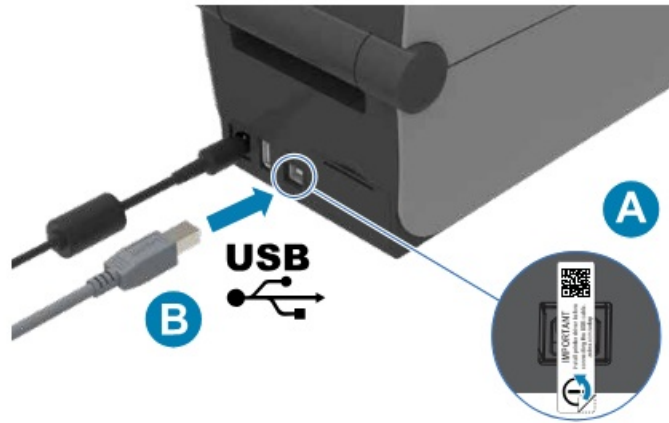

1. A. Remove the port blocker label.
2. B. Connect the USB cable to the printer and your computer.

Power On

Press the power button (1).



When the the printer is ready, the printer status light (1) will turn green.



Smart Calibration

Press and hold the Pause (1) and Cancel (2) buttons for two seconds to line up the labels.



Media Out



When the media runs out, the printer and media status lights (1) will turn red.

Support and Information

- View user documentation and how-to videos.
 - zebra.com/zd611r-info



- View Quick Answers and Knowledge Base.
 - zebra.com/knowledge



- Need to design a label?
 - zebra.com/zebradesigner



- Join Community Connection of Zebra users and ambassadors.

- zebra.com/supportcommunity



- Learn about genuine Zebra supplies.

- zebra.com/supplies



- Contact Zebra about your printer.

- zebra.com/contact



- Need to manage your printer?

- zebra.com/ppme



- Need to secure your printer?

- zebra.com/printsecure



Cleaning

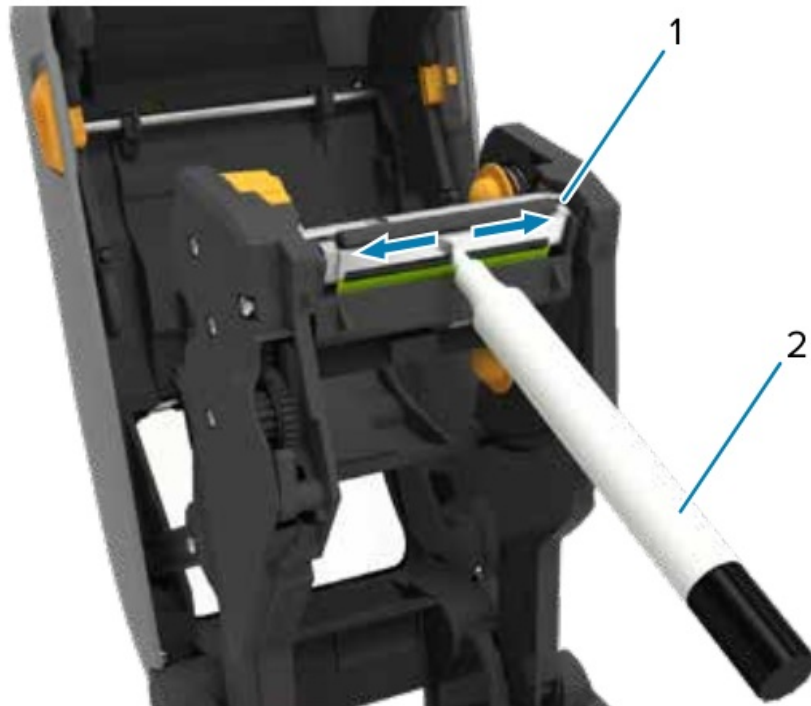

Clean printhead (1) with a cleaning pen (2). Clean from the middle to the outside. The cleaning pen is only for cleaning a printhead.

Ribbon Out



When the ribbon runs out, the printer status and flashing media status lights (1) will turn red.



Open the printer and discard the used ribbon. Keep the empty supply spool (2) to use for the next ribbon take-up (1).

Zebra Technologies | 3 Overlook Point | Lincolnshire, IL 60069 USA — [zebra.com](https://www.zebra.com)











ZEBRA and the stylized Zebra head are trademarks of Zebra Technologies Corp., registered in many jurisdictions worldwide. All other trademarks are the property of their respective owners. © 2021 Zebra Technologies Corp. and/or its affiliates. All rights reserved.

FAQ

Q: What should I do if the media runs out?

A: When the media runs out, both the printer and media status lights will turn red. Open the printer and discard the empty roll.

Documents / Resources

	ZEBRA ZD611R Desktop Printer [pdf] User Guide ZD611R Desktop Printer, ZD611R, Desktop Printer, Printer
	ZEBRA ZD611R Desktop Printer [pdf] User Guide ZD611R Desktop Printer, ZD611R, Desktop Printer, Printer
	ZEBRA ZD611R Desktop Printer [pdf] User Guide ZD611R Desktop Printer, ZD611R, Desktop Printer, Printer
	ZEBRA ZD611R Desktop Printer [pdf] User Guide ZD611R Desktop Printer, ZD611R, Desktop Printer, Printer
	ZEBRA ZD611R Desktop Printer [pdf] User Guide ZD611R Desktop Printer, ZD611R, Desktop Printer, Printer
	ZEBRA ZD611R Desktop Printer [pdf] User Guide ZD611R Desktop Printer, ZD611R, Desktop Printer, Printer
	ZEBRA ZD611R Desktop Printer [pdf] User Guide ZD611R Desktop Printer, ZD611R, Desktop Printer, Printer
	ZEBRA ZD611R Desktop Printer [pdf] User Guide ZD611R Desktop Printer, ZD611R, Desktop Printer, Printer
	ZEBRA ZD611R Desktop Printer [pdf] Installation Guide ZD611R Desktop Printer, ZD611R, Desktop Printer, Printer
	ZEBRA ZD611R Desktop Printer [pdf] Installation Guide ZD611R Desktop Printer, ZD611R, Desktop Printer, Printer
	ZEBRA ZD611R Desktop Printer [pdf] Installation Guide ZD611R Desktop Printer, ZD611R, Desktop Printer, Printer

References

- [User Manual](#)

[Manuals+](#), [Privacy Policy](#)

This website is an independent publication and is neither affiliated with nor endorsed by any of the trademark owners. The "Bluetooth®" word mark and logos are registered trademarks owned by Bluetooth SIG, Inc. The "Wi-Fi®" word mark and logos are registered trademarks owned by the Wi-Fi Alliance. Any use of these marks on this website does not imply any affiliation with or endorsement.