

 **ZEBRA**
TC58e Touch
Computer



ZEBRA TC58e Touch Computer User Guide

[Home](#) » [ZEBRA](#) » ZEBRA TC58e Touch Computer User Guide 

Contents

- [1 ZEBRA TC58e Touch Computer](#)
- [2 Specifications](#)
- [3 Product Usage Instructions](#)
- [4 Features](#)
- [5 Installing a SIM Card](#)
- [6 Charging the Device](#)
- [7 Accessories for Charging](#)
- [8 Ergonomic Considerations](#)
- [9 FAQ](#)
- [10 contact](#)
- [11 Documents / Resources](#)
 - [11.1 References](#)
- [12 Related Posts](#)



ZEBRA TC58e Touch Computer



Specifications

- Model: TC58e Touch Computer
- Front Camera: 8MP
- Display: 6-inch LCD touchscreen

Product Usage Instructions

- Press and hold the power button to turn on the device.
- Use the front camera for taking photos and videos.
- Interact with the device using the 6-inch LCD touchscreen.
- To initiate data capture, use the programmable scan button located on the front or side of the device. The scan LED will indicate the data capture status.
- Use the receiver for audio playback in Handset mode and the microphone for communications in Handset/Handsfree mode, audio recording, and noise cancellation. Adjust the audio volume using the volume up/down button.
- Monitor battery status using the battery status LED. To charge or replace the battery, follow the instructions provided in the manual for battery release latches.

Features

This section lists the features of the TC58e touch computer.

Figure 1 Front and Side Views

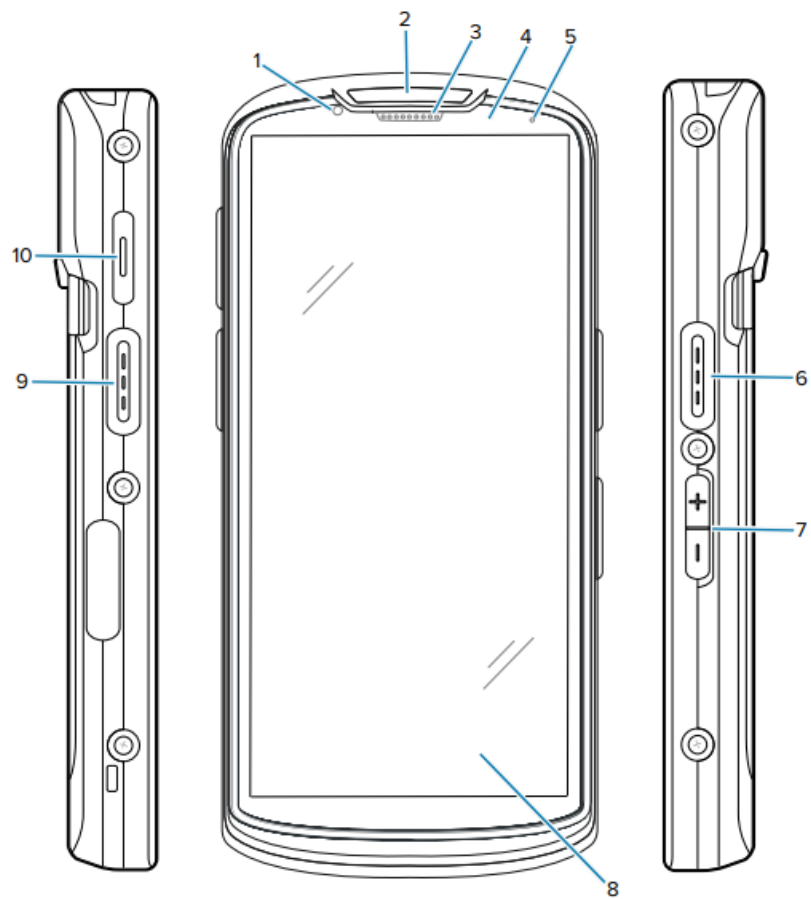

Table 1 TC58e Front and Side Items

Number	Item	Description
1	Front camera (8MP)	Takes photos and videos.
2	Scan LED	Indicates data capture status.
3	Receiver	Use for audio playback in Handset mode.
4	Proximity/light sensor	Determines proximity and ambient light for controlling display backlight intensity.

Number	Item	Description
5	Battery status LED	Indicates battery charging status while charging and application-generated notifications.
6, 9	Scan button	Initiates data capture (programmable).
7	Volume up/down button	Increase and decrease audio volume (programmable).
8	6 in. LCD touch screen	Displays all information needed to operate the device.
10	PTT button	Typically used for PTT communications.

Figure 2 Back and Top View

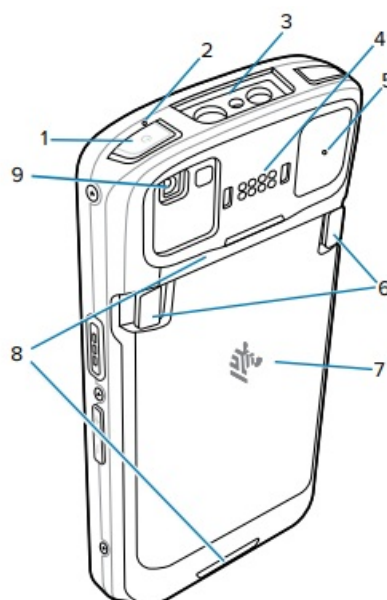

Table 2 Back and Top Items

Number	Item	Description
1	Power button	Turns the display on and off. Press and hold to power off, restart, or lock the device.
2, 5	Microphone	Use for communications in Handset/Handsfree mode, audio recording, and noise cancellation.
3	Exit window	Provides data capture using the imager.
4	Back common I/O 8 pins	Provides host communications, audio, and device charging via cables and accessories.

Number	Item	Description
6	Battery release latches	Pinch both latches in and lift up to remove the battery.
7	Battery	Provides power to the device.
8	Hand strap points	Attachment points for the hand strap.
9	Rear camera (16 MP) with flash	Takes photos and videos with flash to provide illumination for the camera.

Figure 3 Bottom View

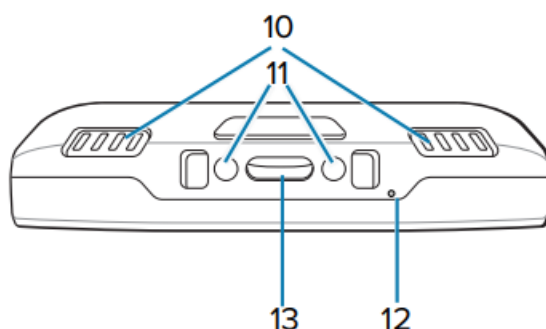

Table 3 Bottom Items

Number	Item	Description
10	Speaker	Provides audio output for video and music playback. Provides audio in speakerphone mode.
11	DC input pins	Power/ground for charging (5V through 9V).
12	Microphone	Use for communications in Handset/Handsfree mode, audio recording, and noise cancellation.
13	USB Type C and 2 charge pins	Provides power to the device using an I/O USB-C interface with 2 charge pins.

Installing a SIM Card

This section describes how to install a SIM card (TC58e only).

CAUTION—ESD: Follow proper electrostatic discharge (ESD) precautions to avoid damaging the SIM card. Proper ESD precautions include, but are not limited to, working on an ESD mat and ensuring the operator is properly grounded

1. Lift the access door.

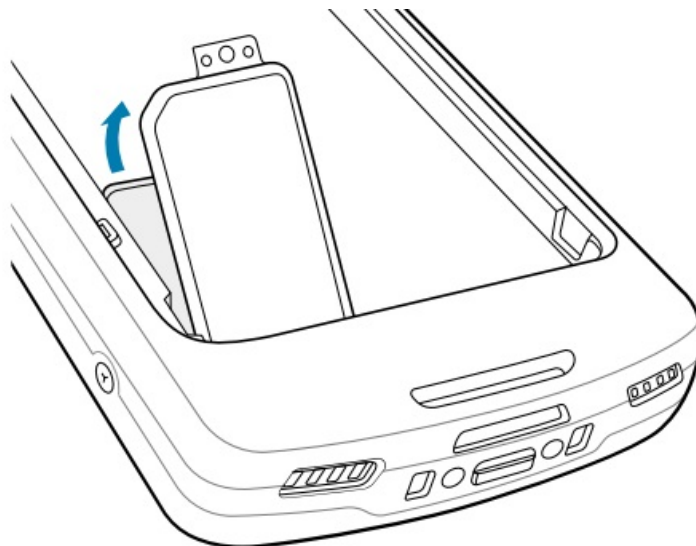

2. Slide the SIM card holder to the unlock position.

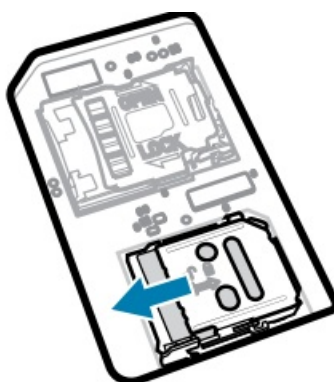

3. Lift the SIM card holder door.

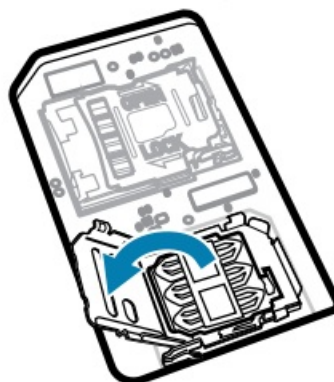

4. Place the SIM card into the card holder with the contacts facing down.

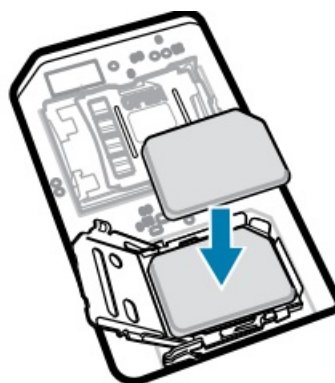

5. Close the SIM card holder door.

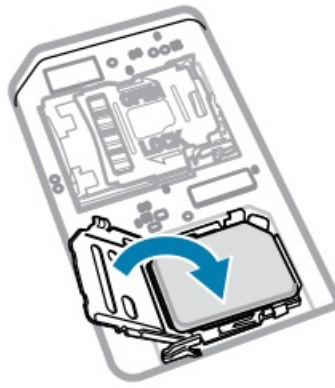

6. Slide the SIM card holder to the lock position.

NOTE: The access door must be replaced and securely seated to ensure proper device sealing.

7. Re-install the access door.

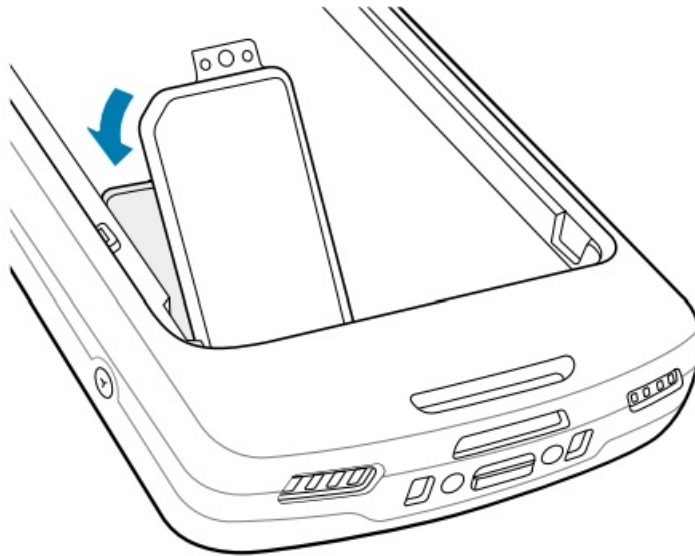

Activating an eSIM

Use a SIM card, an eSIM, or both on the TC58e. Choose which SIM to use for which action, such as messaging or calling. Before using it, you must activate the eSIM.

NOTE: Before adding an eSIM, contact your carrier to obtain the eSIM service and its activation or QR code.

1. On the device, establish an internet connection via Wi-Fi or cellular data with an installed SIM card.
2. Go to Settings.
3. Touch Network & internet > Mobile Networks.
4. Touch + next to SIMs if a SIM card is already installed, or touch SIMs if there is no SIM card installed. The Mobile network screen displays.
5. Select MANUAL CODE ENTRY to enter the activation code, or touch SCAN to scan the QR code to download the eSIM profile. The Confirmation!!! dialog box displays.
6. Touch OK.
7. Enter the activation code or scan the QR Code.
8. Touch NEXT. The Confirmation!!! dialog box displays.
9. Touch ACTIVATE.
10. Touch Done. The eSIM is now active

Deactivating an eSIM

Turn off an eSIM temporarily and re-activate it later.

1. On the device, establish an internet connection via Wi-Fi or cellular data with an installed SIM card.
2. Touch Network & internet > SIMs.
3. In the Download SIM section, touch the eSIM to deactivate.
4. Touch Use SIM switch to turn off the eSIM.
5. Touch Yes.

The eSIM is deactivated.

Erasing an eSIM Profile

Erasing an eSIM profile removes it completely from the TC58e.

NOTE: After erasing an eSIM from the device, you cannot use it again.

1. On the device, establish an internet connection via Wi-Fi or cellular data with an installed SIM card.
2. Touch Network & internet > SIMs.
3. In the Download SIM section, touch the eSIM to erase.
4. Touch Erase. The Erase this downloaded SIM? message displays.
5. Touch Erase. The eSIM profile is erased from the device.

Installing a MicroSD Card

The microSD card slot provides secondary non-volatile storage. The slot is located under the battery pack. Refer to the documentation provided with the card for more information, and follow the manufacturer's recommendations for use.

CAUTION—ESD: Follow proper electrostatic discharge (ESD) precautions to avoid damaging the MicroSD card. Proper ESD precautions include, but are not limited to, working on an ESD mat and ensuring the operator is properly grounded.

1. Lift the access door.

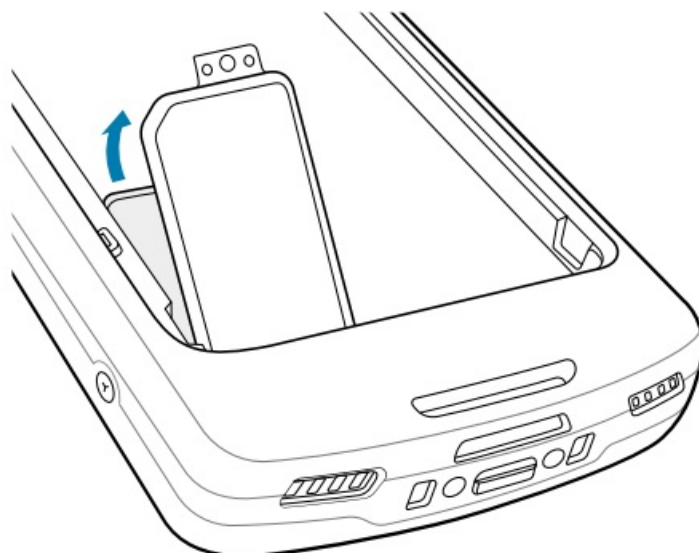

2. Slide the microSD card holder to the Open position.

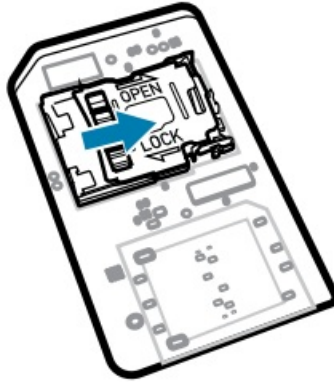

3. Lift the microSD card holder door.

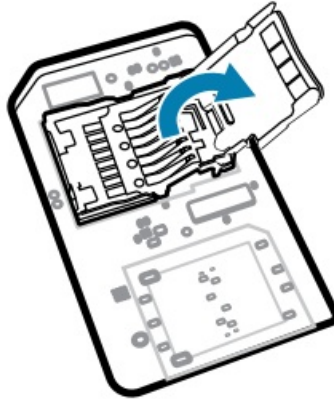

4. Insert the microSD card into the cardholder, ensuring the card slides into the holding tabs on each side of the door.

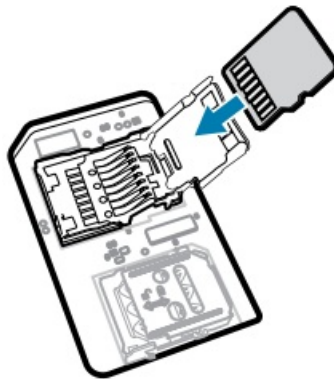

5. Close the microSD card holder.

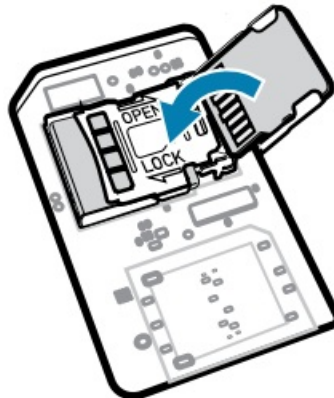

6. Slide the microSD card holder to the Lock position.

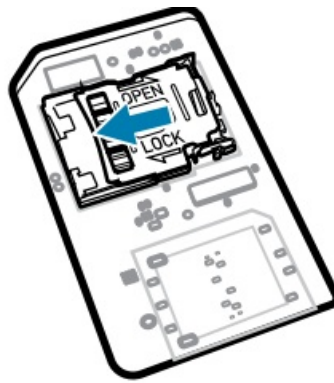

IMPORTANT: The access cover must be replaced and securely seated to ensure proper device sealing.

7. Reinstall the access door.

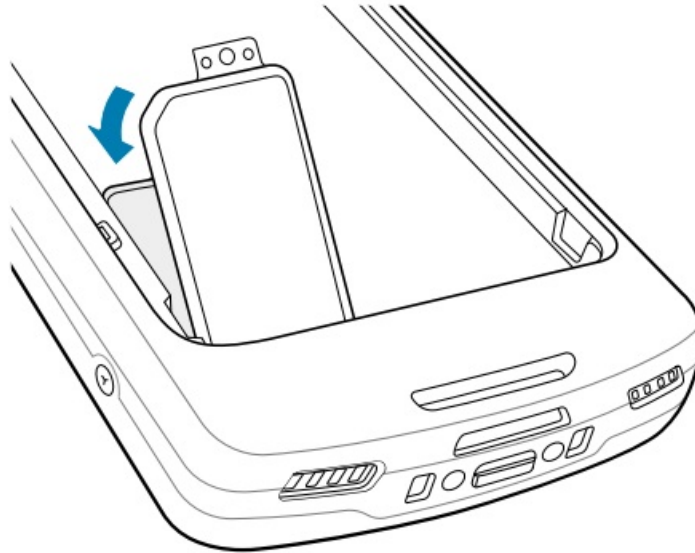

Installing the Battery

This section describes how to install a battery into the device.

NOTE: Do not put any labels, asset tags, engravings, stickers, or other objects in the battery well. Doing so may compromise the intended performance of the device or accessories. Performance levels, such as sealing [Ingress Protection (IP)], impact performance (drop and tumble), functionality, or temperature resistance, could be affected.

1. Insert the battery, bottom first, into the battery compartment in the back of the device.
2. Press the battery down until it snaps into place.

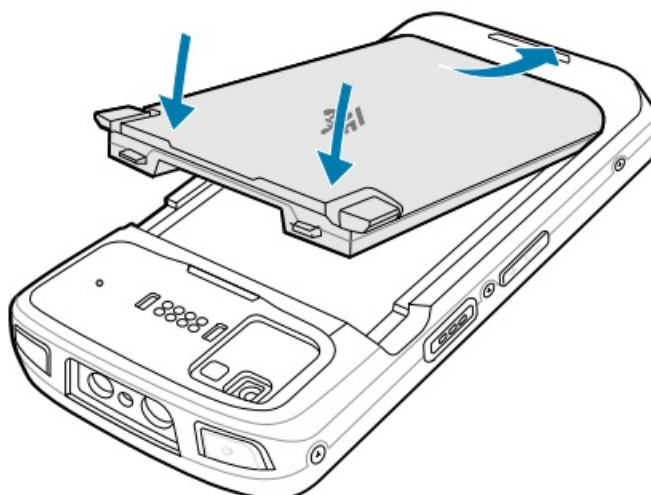

Using the Rechargeable Li-Ion Battery with BLE Beacon

This device utilizes a rechargeable Li-Ion battery to facilitate Bluetooth Low Energy (BLE) Beacon. When enabled, the battery transmits a BLE signal for up to seven days while the device is powered off due to battery depletion.

NOTE: The device transmits a Bluetooth beacon only when it is powered off or in airplane mode.

For additional information on configuring the Secondary BLE settings, see techdocs.zebra.com/emdk-for-android/13-0/mx/beaconmgr/.

Using the Rechargeable Li-Ion Wireless Battery

For TC58e WWAN devices only, use a rechargeable Li-Ion battery to facilitate wireless charging.

NOTE: The rechargeable Li-Ion wireless battery must be used along with the terminal in the Zebra Wireless Charge Vehicle Cradle or Qi-certified wireless chargers.

Charging the Device

To achieve optimal charging results, use only Zebra charging accessories and batteries. Charge batteries at room temperature with the device in sleep mode. A standard battery charges from fully depleted to 90% in approximately 2 hours and from fully depleted to 100% in approximately 3 hours. In many cases, a 90% charge provides enough charge for daily use. Depending on the usage profile, a full 100% charge may last for approximately 14 hours of use. The device or accessory always performs battery charging safely and intelligently and indicates when charging is disabled due to abnormal temperatures via its LED, and a notification appears on the device display.

Temperature	Battery Charging Behavior
20 to 45°C (68 to 113°F)	Optimal charging range.

Temperature	Battery Charging Behavior
0 to 20°C (32 to 68°F) / 45 to 50°C (113 to 122°F)	Charging slows to optimize the JEITA requirements of the cell.
Below 0°C (32°F) / Above 50°C (122°F)	Charging stops.
Above 55°C (131°F)	The device shuts down.







To charge the main battery:

1. Connect the charging accessory to the appropriate power source.
2. Insert the device into a cradle or attach to a power cable (minimum 9 volts / 2 amps). The device turns on and begins charging. The Charging/Notification LED blinks amber while charging, then turns solid green when fully charged.

Charging Indicators

The charging/notification LED indicates the charging status.

Table 4 Charging/Notification LED Charging Indicators

State	LED Color	Indications
Off		The device is not charging. <ul style="list-style-type: none"> The device is not inserted correctly in the cradle or connected to a power source. The charger/cradle is not powered.
Slow Blinking Amber (1 blink every 4 seconds)		The device is charging.
Slow Blinking Red (1 blink every 4 seconds)		The device is charging, but the battery is at the end of its useful life.
Solid Green		Charging is complete.
Solid Red		Charging is complete, but the battery is at the end of its useful life.
Fast Blinking Amber (2 blinks/second)		Charging error. For example: <ul style="list-style-type: none"> Temperature is too low or too high. Charging has gone on too long without completion (typically 12 hours).

State	LED Color	Indications
Fast Blinking Red (2 blinks/second)		Charging error, and the battery is at the end of its useful life. For example: <ul style="list-style-type: none"> The temperature is too low or too high. Charging has gone on too long without completion (typically 12 hours).

Charging the Spare Battery

This section provides information on charging a spare battery. To achieve optimal charging results, use only Zebra charging accessories and batteries.

1. Insert a spare battery into the spare battery slot.
2. Ensure the battery is seated properly.
 1. The Spare Battery Charging LED blinks, indicating charging.
 2. The battery charges from fully depleted to 90% in approximately 2.5 hours and from fully depleted to 100% in approximately 3.5 hours. In many cases, the 90% charge provides plenty of charge for daily use.
 3. Depending on the usage profile, a full 100% charge may last for approximately 14 hours of use.

Accessories for Charging

Use one of the following accessories to charge the device and/or spare battery.

Charging and Communication

Description	Part Number	Charging		Communication	
		Battery (In device)	Spare Battery	USB	Ethernet
1-Slot Charge Only Cradle	CRD-NGTC5-2SC1B	Yes	Yes	No	No
1-Slot USB/Ethernet Cradle	CRD-NGTC5-2SE1B	Yes	Yes	Yes	Yes
5-Slot Charge Only Cradle with Battery	CRD-NGTC5-5SC4B	Yes	Yes	No	No
5-Slot Charge Only Cradle	CRD-NGTC5-5SC5D	Yes	No	No	No
5-Slot Ethernet Cradle	CRD-NGTC5-5SE5D	Yes	No	No	Yes
Charge/USB Cable	CBL-TC5X- USB-C2A-01	Yes	No	Yes	No

1-Slot Charge Only Cradle

This USB cradle provides power and host communications.

CAUTION: Ensure that you follow the guidelines for battery safety described in the Product Reference Guide.

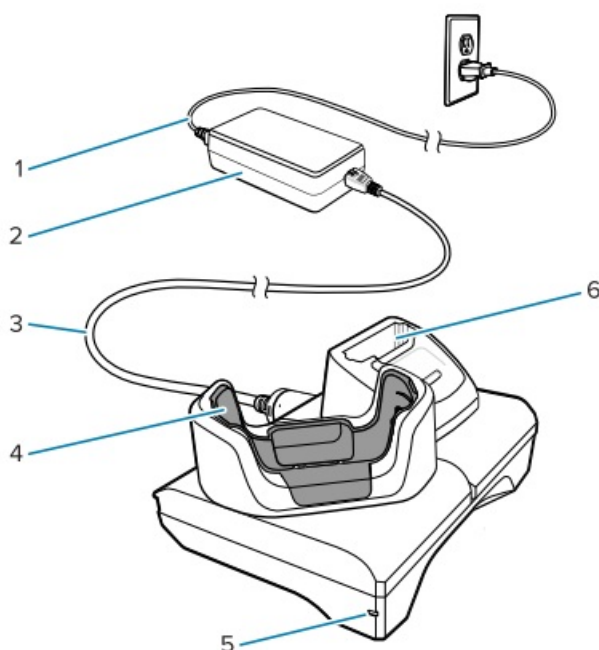

1	AC line cord
2	Power supply
3	DC line cord
4	Device charging slot
5	Power LED
6	Spare battery charging slot

1-Slot Ethernet USB Charge Cradle

This Ethernet cradle provides power and host communications.

CAUTION: Ensure that you follow the guidelines for battery safety described in the Product Reference Guide

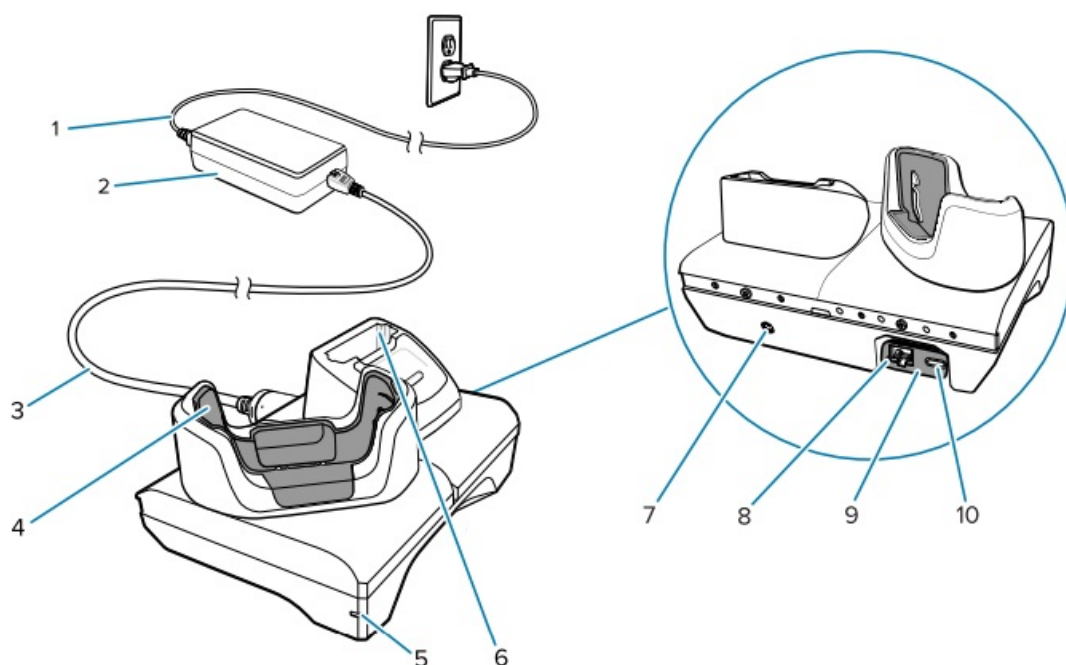

1	AC line cord
2	Power supply
3	DC line cord
4	Device charging slot
5	Power LED
6	Spare battery charging slot
7	DC line cord input
8	Ethernet port (on USB to Ethernet module kit)
9	USB to Ethernet module kit
10	USB port (on USB to Ethernet module kit)

NOTE: The USB to Ethernet module kit (KT-TC51-ETH1-01) connects via a single-slot USB charger.

5-Slot Charge Only Cradle

CAUTION: Ensure that you follow the guidelines for battery safety described in the Product Reference Guide.
The 5-Slot Charge Only Cradle:

- Provides 5.0 VDC power for operating the device.
- Simultaneously charges up to five devices or up to four devices and four batteries using the 4-slot battery charger adapter
- Contains a cradle base and cups that can be configured for various charging requirements

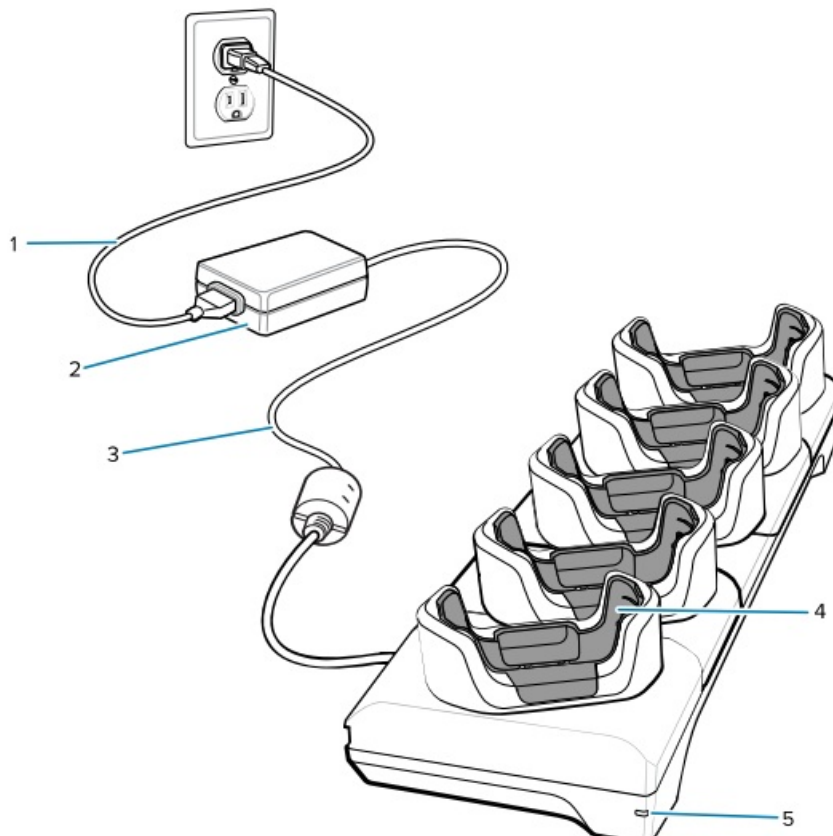

1	AC line cord
2	Power supply
3	DC line cord
4	Device charging slot with shim
5	Power LED

5-Slot Ethernet Cradle

CAUTION: Ensure that you follow the guidelines for battery safety described in the Product Reference Guide. The 5-Slot Ethernet Cradle:

- Provides 5.0 VDC power for operating the device.
- Connects up to five devices to an Ethernet network.
- Simultaneously charges up to five devices or up to four devices and four batteries using the 4-slot battery charger adapter

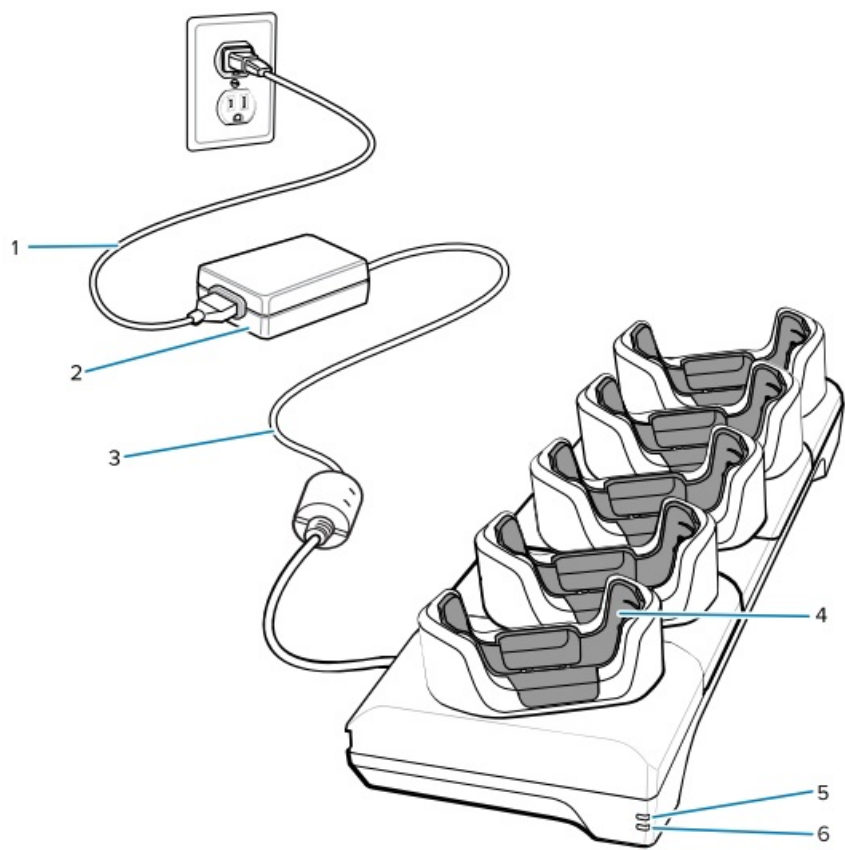

1	AC line cord
2	Power supply
3	DC line cord
4	Device charging slot
5	1000Base-T LED
6	10/100Base-T LED

5-Slot (4 Device/4 Spare Battery) Charge Only Cradle with Battery Charger

CAUTION: Ensure that you follow the guidelines for battery safety described in the Product Reference Guide.
The 5-Slot Charge Only Cradle:

- Provides 5.0 VDC power for operating the device.
- Simultaneously charges up to four devices and four spare batteries.

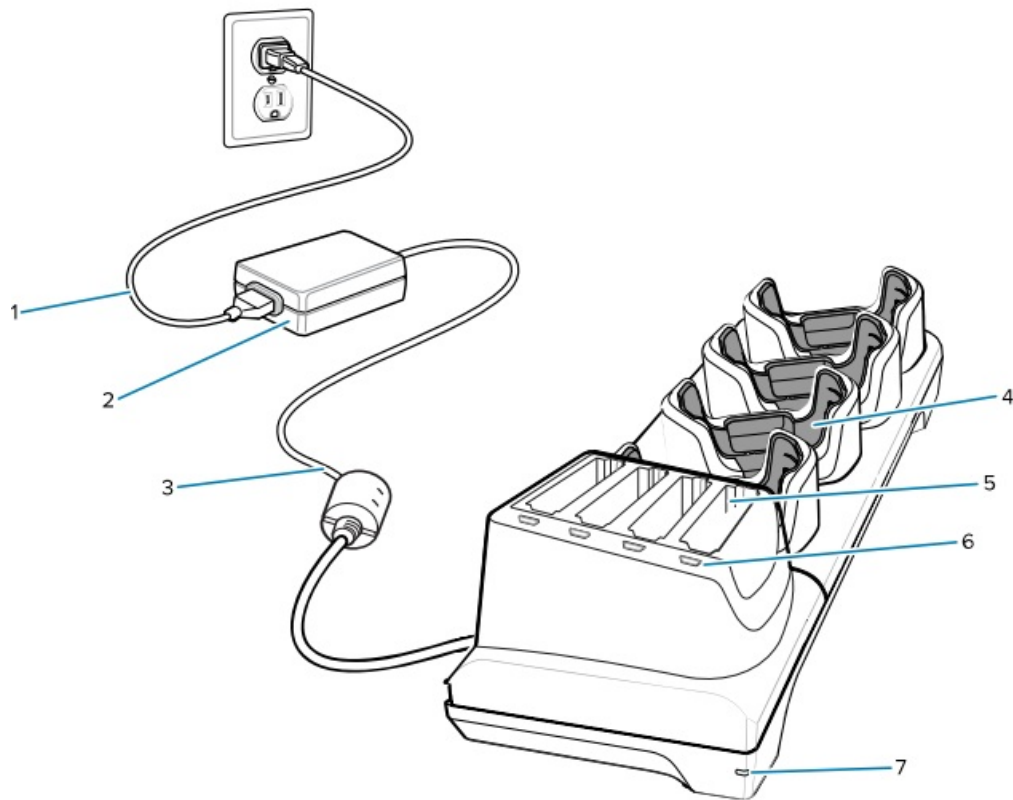

1	AC line cord
2	Power supply
3	DC line cord
4	Device charging slot with shim
5	Spare battery charging slot
6	Spare battery charging LED
7	Power LED

Charge/USB-C Cable

The USB-C Cable snaps onto the bottom of the device and removes easily when not in use.

NOTE: When attached to the device, it provides charging and allows the device to transfer data to a host computer.

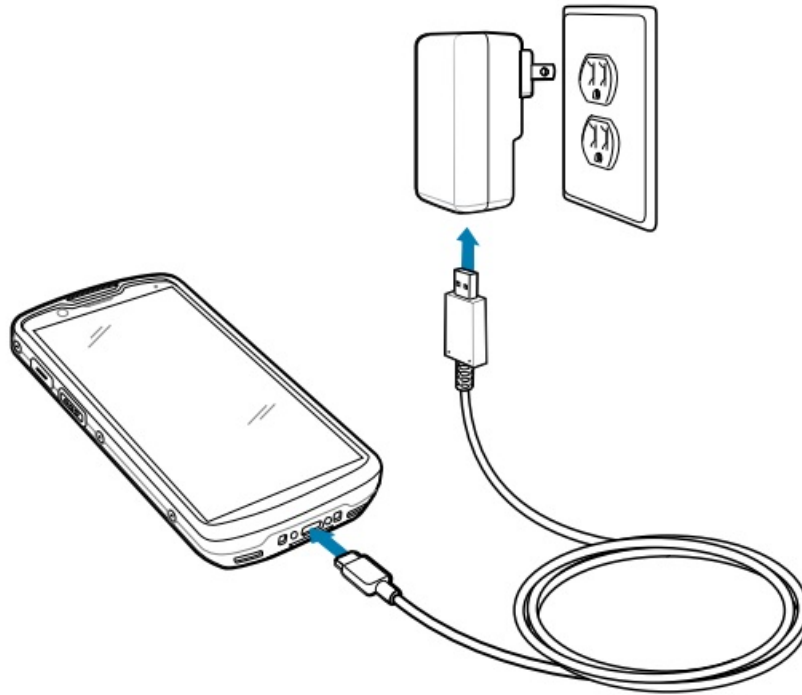

Scanning with Internal Imager

Use the internal imager to capture barcode data. To read a barcode or QR code, a scan-enabled application is required. The device contains the DataWedge Demonstration (DWDemo) app, which allows you to enable the imager, decode the barcode/ QR code data, and display barcode content.

NOTE: The SE55 displays a green dash-dot-dash aimer. The SE4720 displays a red dot aimer.

The SE4770 displays a red crosshair aimer.

1. Ensure that an application is open on the device and a text field is in focus (text cursor in text field).
2. Point the exit window on the top of the device at a barcode or QR code

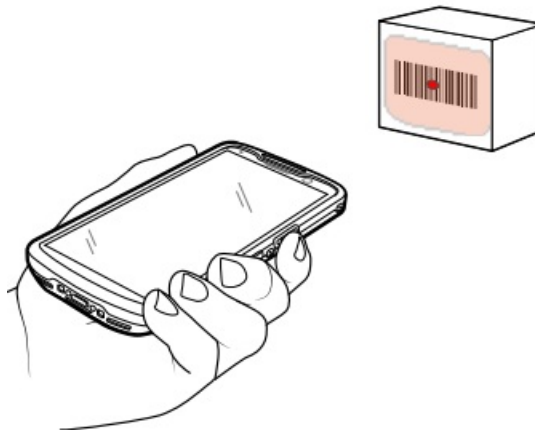

3. Press and hold the scan button. The device projects the aiming pattern.
4. Ensure the barcode or QR code is within the area formed in the aiming pattern

Table 5 Aiming Patterns

SE55	SE4720	SE4770
 	 	 

Table 6 Aiming Patterns in Picklist Mode with Multiple Barcodes

SE55	SE4720	SE4770
 	 	 

NOTE: When the device is in Picklist mode, it does not decode the barcode/QR code until the center of the crosshair touches the barcode/QR code. The Data Capture LED light turns green, and the device beeps, by default, to indicate that the barcode or QR code was decoded successfully.

- Release the scan button. The device displays the barcode or QR code data in the text field.

Ergonomic Considerations

Avoid extreme wrist angles when using the device

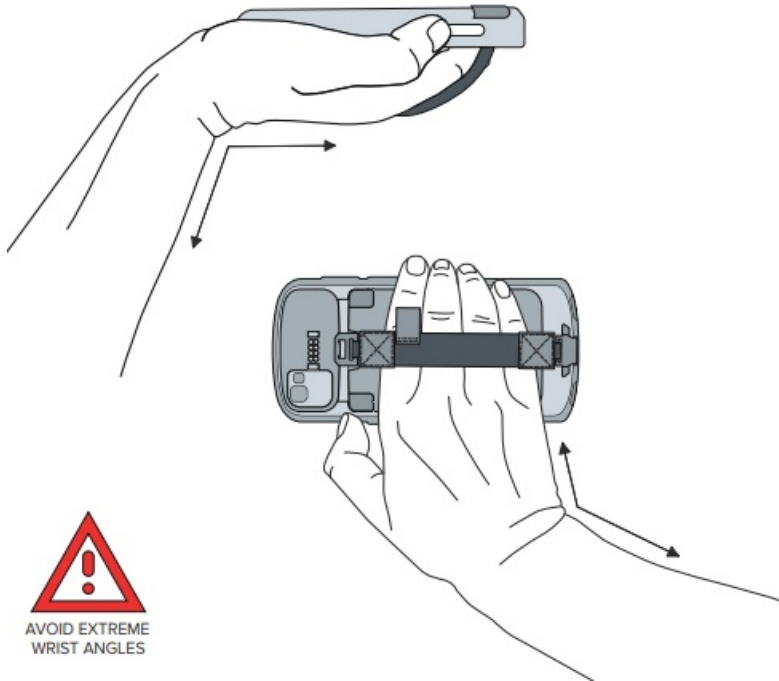

FAQ

- **Q:** How do I power off or restart the device?
- **A:** Press and hold the power button to access options to power off, restart, or lock the device.
- **Q:** What is the function of the PTT button?
- **A:** The PTT button is typically used for PTT (Push-To-Talk) communications.

contact

- Repair services using Zebra-qualified parts are available for at least three years after the end of production and can be requested at zebra.com/support.
- www.zebra.com

Documents / Resources

	<p>ZEBRA TC58e Touch Computer [pdf] User Guide TC58AE, UZ7TC58AE, TC58e Touch Computer, TC58e, Touch Computer, Computer</p>
---	---

References

- [User Manual](#)

[Manuals+](#), [Privacy Policy](#)

This website is an independent publication and is neither affiliated with nor endorsed by any of the trademark owners. The "Bluetooth®" word mark and logos are registered trademarks owned by Bluetooth SIG, Inc. The "Wi-Fi®" word mark and logos are registered trademarks owned by the Wi-Fi Alliance. Any use of these marks on this website does not imply any affiliation with or endorsement.