

ZEBRA TC22 Trigger Handle



## ZEBRA TC22 Trigger Handle Installation Guide

[Home](#) » [ZEBRA](#) » ZEBRA TC22 Trigger Handle Installation Guide 

### Contents

- [1 ZEBRA TC22 Trigger Handle](#)
- [2 Product Information](#)
- [3 Product Usage Instructions](#)
- [4 Features](#)
- [5 Rugged Boot Installation](#)
- [6 Device Installation](#)
- [7 Charging](#)
- [8 Documents / Resources](#)
  - [8.1 References](#)
- [9 Related Posts](#)



**ZEBRA TC22 Trigger Handle**



## Product Information

### Specifications

- Model: TC22/TC27
- Product Type: Trigger Handle
- Manufacturer: Zebra Technologies
- Features: Rugged Boot, Lanyard Mount, Release Latch

## Product Usage Instructions

### Trigger Handle Installation Guide

1. Remove any hand strap if installed before proceeding.
2. Attach the trigger handle to the device following the provided instructions.

### Rugged Boot Installation

1. Remove any existing rugged boot if present.
2. Install the new rugged boot securely onto the device.

### Device Installation

1. For device installation, ensure to follow the specific device model instructions provided.

### Charging:

1. Before charging, remove any shim in the cable cup to ensure proper connection.
2. Connect the charging cable to the device as per the device manual.

### **Optional Lanyard Installation:**

1. If desired, follow the optional lanyard installation steps provided.

### **Removal**

1. To remove the trigger handle or any other accessories, carefully follow the removal steps outlined in the manual.

### **FAQ (Frequently Asked Questions)**

- **Q: How do I attach the lanyard to the trigger handle?**

A: To attach the lanyard, follow the optional lanyard installation steps provided in the installation guide.

- **Q: Do I need to remove any components before charging the device?**

A: Yes, it is recommended to remove any shim in the cable cup before connecting the charging cable to ensure proper charging.

- **Q: Can I install the rugged boot without removing the trigger handle?**

A: It is advisable to remove any existing accessories like the trigger handle before installing the rugged boot for a secure fit.

### **TC22/TC27**

Trigger Handle

Installation Guide

Zebra Technologies | 3 Overlook Point | Lincolnshire, IL 60069 USA

[zebra.com](https://zebra.com)

ZEBRA and the stylized Zebra head are trademarks of Zebra Technologies Corp., registered in many jurisdictions worldwide. All other trademarks are the property of their respective owners. © 2023 Zebra Technologies Corp. and/or its affiliates. All rights reserved.

### **Features**

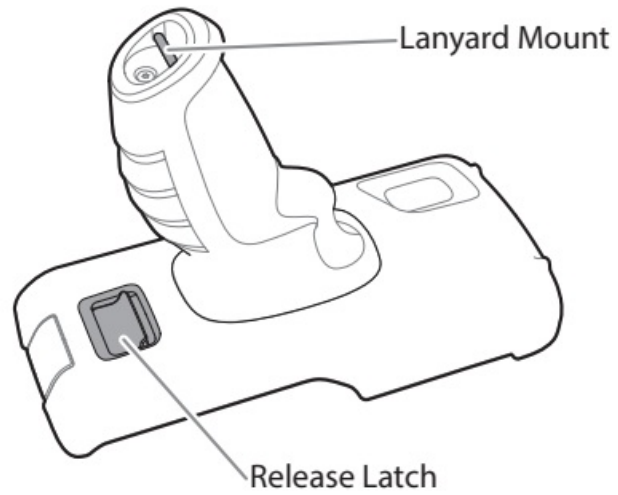

## Rugged Boot Installation

**NOTE:** If hand strap is installed, remove it prior to installation.

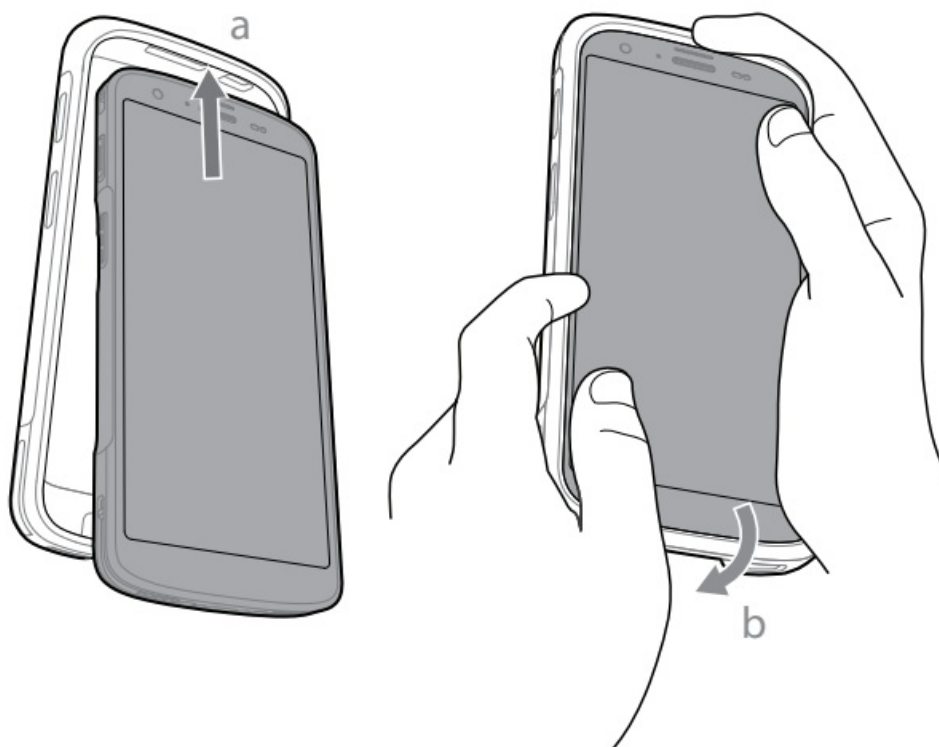

## Device Installation

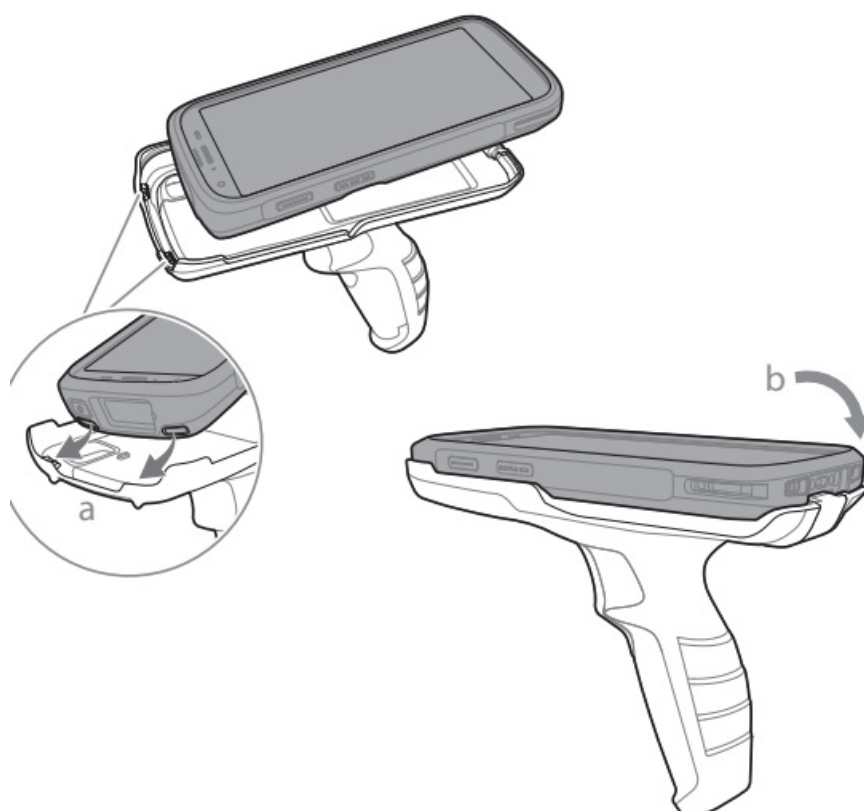

## Charging

**NOTE:** Remove Shim in Cable Cup before installing onto device.

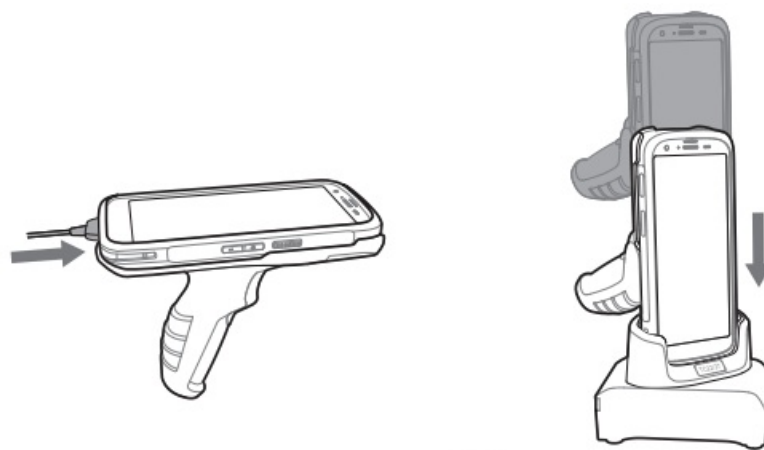

Optional  
Lanyard Installation

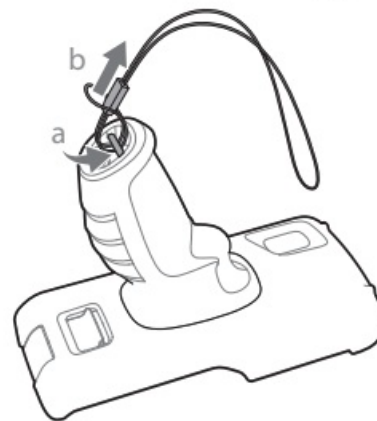

## Removal

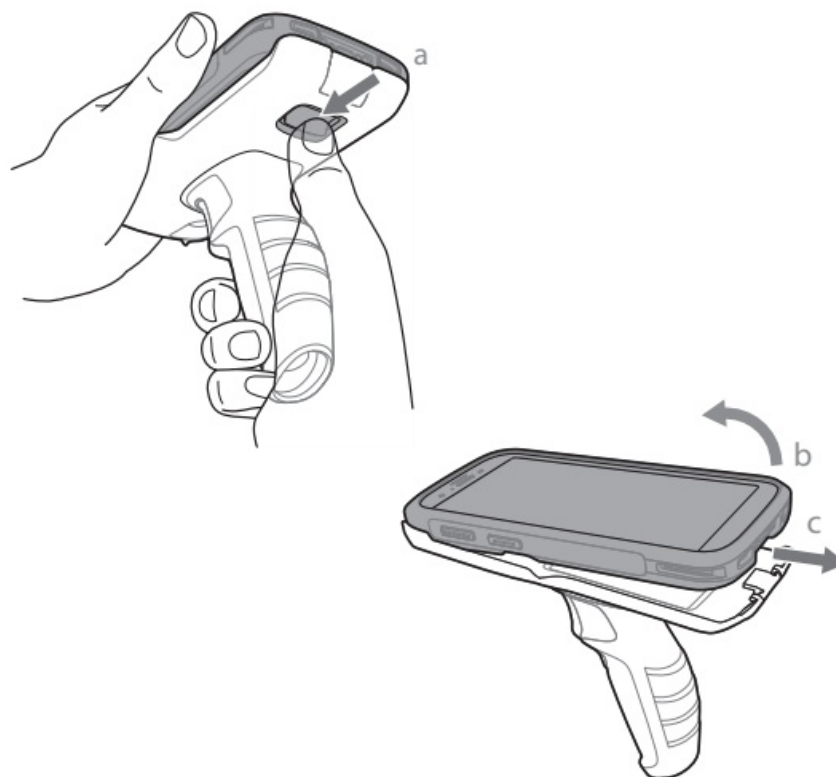



**[ZEBRA TC22 Trigger Handle](#)** [pdf] Installation Guide  
TC22, TC27, TC22 Trigger Handle, Trigger Handle, Handle

**References**

- [User Manual](#)

**Manuals+.** [Privacy Policy](#)

This website is an independent publication and is neither affiliated with nor endorsed by any of the trademark owners. The "Bluetooth®" word mark and logos are registered trademarks owned by Bluetooth SIG, Inc. The "Wi-Fi®" word mark and logos are registered trademarks owned by the Wi-Fi Alliance. Any use of these marks on this website does not imply any affiliation with or endorsement.