



ZANUSSI CKZ39-BL Multi-System Espresso Machine Instruction Manual

[Home](#) » [Zanussi](#) » ZANUSSI CKZ39-BL Multi-System Espresso Machine Instruction Manual 

ZANUSSI

CKZ39-BL Multi-System Espresso Machine
Instruction Manual



Contents

- 1 SAFETY WARNING
- 2 ENVIRONMENT & RECYCLING
- 3 COMPLIANCE
- 4 PARTS GUIDE
- 5 BEFORE FIRST USE
- 6 PREPARING COFFEE & HOT DRINKS
- 7 Cleaning the adapter
- 8 Cleaning the appliance
- 9 TROUBLESHOOTING
- 10 OTHERS INFORMATION
- 11 WARRANTY
- 12 Documents / Resources
- 13 Related Posts

SAFETY WARNING

- Please read the instructions carefully before installing and using this appliance. If you resell this appliance, please make sure you give this instruction booklet to your buyer.
- This appliance is intended for household use and similar applications, such as:
 - o staff kitchen areas in shops, offices, and other working environments;
 - o farmhouses;
 - o by clients in hotels, motels, and other residential type of environments;
 - o bed and breakfast type environments.
- It should not be used for any other purpose or in any other application, such as non-domestic use or in a commercial environment. The manufacturer accepts no responsibility in case of any commercial use, inappropriate use, or failure to comply with the instructions, and the guarantee will not apply.
- After unpacking the appliance, make sure it is not damaged. The appliance must not be used if it has been dropped if there is any visible damage, if it leaks or if it functions abnormally in any way. In case of doubt, do not use the appliance and contact your supplier or a qualified technician.
- Remove all packaging and do not leave the packaging material, such as plastic bags, polystyrene, and elastic bands within easy reach of children as they may cause serious injuries.
- Never use accessories or parts from another manufacturer. The use of this type of accessories or parts will void the warranty. The appliance must be used only with the base and accessories supplied.
- The appliance shall be used and kept on a flat and stable surface. Leave at least 10 cm of space between the appliance and any rear or sidewalls, and 15 cm clearance above the espresso machine. Do not put your appliance and its power cord on or near a heat source, such as a hotplate, oven, heater, etc.
- The appliance should not be placed inside a cabinet when in use.
- Before plugging in your appliance, ensure that the electrical voltage in your home corresponds to that of the appliance's rating label.
- Connect your appliance to an earthed wall socket, correctly installed and connected to the electrical supply in accordance with applicable standards.
- Do not use this appliance outdoors and do not store it below 0°C. Water left in the appliance can freeze and cause damage.
- This appliance should not be used with an external timer or separate remote-control system.

- Warning: potential injury from misuse.
- Warning: avoid spillage on the connector.
- Warning: the filling aperture shall not be opened during use.
- This appliance can be used by children aged 8 years and above if they have been given supervision or instruction concerning the use of the appliance in a safe way and understand the hazards involved.
- Cleaning and user maintenance shall not be performed by children unless they are over the age of 8 years and are supervised.
- Children shall not play with the appliance.
- Keep the appliance and its power cord out of reach of children aged less than 8 years old.
- This appliance can be used by persons with reduced physical, sensory or mental capabilities or lack of experience and knowledge if they have been given supervision or instruction concerning the use of the appliance in a safe way and understand the hazards involved.
- The appliance must not be immersed. Never immerse its power cord and plug in water or any liquids.
- Never drip water on the control panel buttons.
- If the supply cord is damaged, it must be replaced by the manufacturer, its service agent or similarly qualified persons in order to avoid a hazard.
- The appliance must not be left unattended while it is connected to the power outlet.



Warning: hot surface! Surfaces are liable to get hot during use. The temperature of accessible surfaces may be high when the appliance is operating. The heating element surface is subject to residual heat after use.

Warning: danger of scalding by hot liquid. The appliance produces hot water and hot steam may form. There is a risk of hot water splashing or hot steam.

- The appliance must not be left unattended while it is connected to the power outlet.
- To avoid the risk of burns during use:
 - o do not remove the drip tray and the grid,
 - o do not move the appliance,
 - o do not put your fingers under the coffee output,
 - o do not touch the adapter compartment.
- The appliance uses high pressure; do not force the locking/unlocking mechanism of the lever during operation, the appliance would be damaged and could cause injuries.
- Do not use the appliance without water in the water tank or without its water tank. Respect the maximum and minimum filling capacities as indicated on the appliance.
- Regarding the information on operating the machine, please refer to the following section of the booklet: **“Appliance set up”**.
- For cleaning surfaces that have come into contact with food, please refer to the following section of the booklet: **“Cleaning and maintenance”**.
- Unplug and let the appliance cool down completely:
 - o after each use,
 - o in case of malfunction,
 - o before cleaning the appliance.
- The power cord should be inspected regularly for any signs of deterioration.
- Do not plug/unplug or touch the control panel buttons with wet hands.
- Never unplug the appliance by pulling the power cord or the appliance from the power outlet. Unplug by pulling

the plug out of the power outlet.

- Do not use this appliance near a tap, sink, bathtub, shower or swimming pool.
- Do not use the appliance:
 - o if the plug or the power cord is damaged,
 - o in case of malfunction,
 - o if the appliance has been damaged in any way,
 - o if the appliance or its power cord is immersed in water,
 - o if you drop the appliance.

Take the appliance to the after-sales services where it will be inspected and repaired. No repairs can be carried out by the end-user.

ENVIRONMENT & RECYCLING



The European Directive on Waste Electrical and Electronic Equipment (WEEE) states that old household electrical appliances should not be disposed of in the normal unsorted municipal waste stream. Old appliances must be collected separately in order to optimize the recovery and recycling of the materials they contain and reduce the impact on human health and the environment.

The crossed-out “wheelie bin” symbol on the product reminds you of the obligation, of separate collection when you dispose of the appliance.

Consumers should contact their local authority or retailer for information concerning the correct disposal of their old appliances.

COMPLIANCE

The appliance meets the main requirements of the European

Directives: 2014/35/UE (Low Voltage), 2014/30/UE (Electromagnetic Compatibility), 2011/65/UE (Limitation of use of certain substances in electronic equipment).

This instruction booklet is also available on the following website:

www.zanussismallappliances.fr

www.zanussismallappliances.be

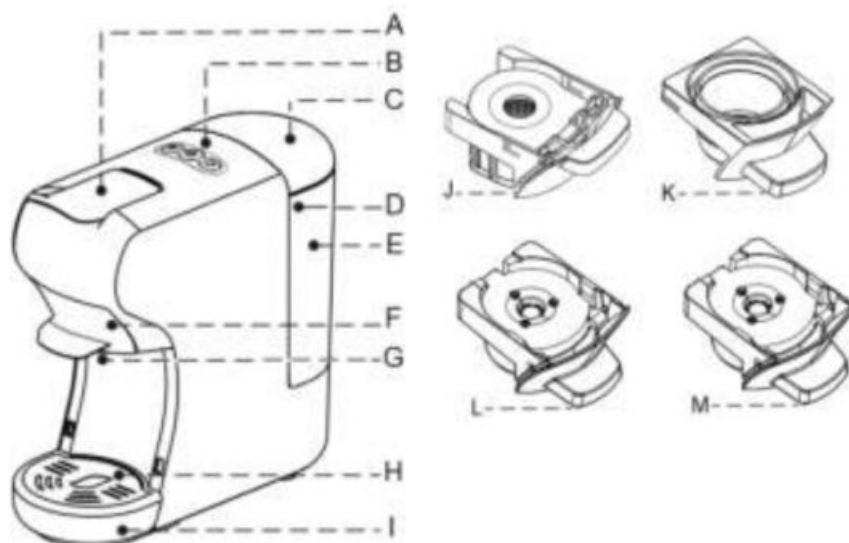

www.zanussismallappliances.nl

PARTS GUIDE



A. Locking/Unlocking lever

B. Control panel buttons

	Small cup
	ON/OFF button
	Large cup

- C. Water tank lid
- D. Water outlet tube
- E. Water tank
- F. Adapter compartment
- G. Coffee output
- H. Removable grid
- I. Removable drip tray
- J. Adapter compatible with Nespresso® capsules
- K. Adapter compatible with Dolce Gusto® capsules
- L. Adapter for coffee powder
- M. Adapter compatible with E.S.E.® pods

BEFORE FIRST USE

Filling the water tank

Filling without removing the water tank



Use a carafe, fill it with cold tap water.

Remove the lid of the water tank and pour the water into the water tank (600ml) up to the MAX line indicated on the tank.

Close the lid on the tank.

Filling by removing the water tank



Remove the water tank from the appliance by tilting it slightly; fill the water tank with cold, still water to its MAX level (600 ml). Put the water tank back in place by sliding it slowly onto the base making sure that the water outlet pipe is inside the water tank.

Then press firmly on the tank to ensure it locks in place. Place the lid on the water tank.

Important

- **The amount of water in the water tank must be between the minimum “MIN” and the maximum “MAX” levels indicated on the tank. Add water as soon as the water level reaches the “MIN” line of the water tank.**
- **Never operate the appliance without water in the tank or without the tank in place. This can damage the pump and shorten the life of the machine.**
- **Only use still and cold water.**

Internal cleaning: procedure

Before using the appliance for the first time, clean the inside of the machine by running 2 internal rinsing cycles with cold water only in order to remove any dust or residue contained in the device.

Internal rinsing of the device is also recommended after a long period of non-use.

Plugging in the appliance



Unwind the appliance's power cord and plug the plug into a power outlet.

Preparation



Lift the lever and insert an empty adapter (without capsules or coffee). Lower the lever to close. Place a large cup (min. 250 ml) on the removable grid.

Switching on the appliance

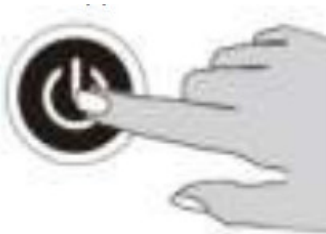

Press the ON/OFF button to switch on the appliance.

Preheating phase



The 3 control buttons light up to indicate that the appliance is in preheating mode. The warm-up time is approximately 45 seconds.

Starting the internal rinsing cycle



Press the small and large cup buttons simultaneously to start the internal rinsing cycle.

End of procedure



Lift the lever and remove the empty adapter (without capsules or coffee). Lower the lever to close.

Important

- Do not interrupt the internal cleaning procedure if it is started.
- Check that water the tank is filled to the “MAX” level and correctly set to avoid any risk of water leakage.
- Make sure to close the lever before pressing the buttons.
- Always make sure to put a cup with a minimum capacity of 250ml on the drip grid before starting the internal rinsing procedure.

Standby mode (Energy saving)

This appliance is equipped with an energy-saving function. It goes into standby automatically after 15 minutes (factory default) if it is not in use.

Exiting stand-by mode



The appliance is set by default to enter standby mode after 15 minutes of non-use. Press the ON/OFF button to exit the standby mode.

Setting the coffee volume Setting the volume of the small cup



The coffee volume of the small cup is set by default for a flow of approximately 25 seconds. Follow the steps below to change the factory setting. Place a cup on the drip grid, and insert the capsule adapter. Press and hold the small cup button. Release once the desired volume is reached. The new level of coffee volume is stored. Programmable flow time: 10 to 90 seconds.

Canceling and reactivating the default standby mode



To cancel the default standby, unplug the power cord from the power outlet. Press the small cup and large cup buttons simultaneously, then plug the power cord into the power outlet. The ON/OFF button lights up, release your fingers. Press the small cup button, the indicator light on the small cup button switches off; the default standby mode is canceled. To reactivate the default standby mode, repeat the same procedure.

Setting the volume of the large cup



The coffee volume of the large cup is set by default for a flow of approximately 47 seconds. Follow the steps below to change the factory setting. Place a cap on the drip grid, and insert the capsule adapter. Press and hold the large cup button. Release once the desired volume is reached. The new level of coffee volume is stored. Programmable flow time: 10 to 90 seconds.

Restoring the factory settings

Procedure for restoring default settings

To return to the factory settings, unplug the power cord from the power outlet. Press and hold the large cup button, then plug the power cord into the power outlet. After the ON/OFF button has blinked twice, release the button. The factory settings have been restored.



PREPARING COFFEE & HOT DRINKS

This appliance is equipped with 4 adapters compatible with different capsule systems for the preparation of coffee and hot drinks.



* Third-party brands not related to the appliance and not owned by Zanussi®.

* Nespresso® and Dolce Gusto® have registered trademarks of the Nestle SA group.

Important

Before preparing your hot drink:

- Check that the tank is filled to the “MAX” level and in the correct position to avoid any risk of water

leakage.

- Check that the appliance is connected to the socket.
- Lower the lever before pressing the buttons.
- Always put a cup on the drip grid.

When using your appliance, please follow the instructions given below to avoid any risk of injury and damage to the device.



Never spray water on the appliance.



Never lift the lever during use.



Risk of injury! Do not touch the top of the capsule compartment, there is a sharp needle.





Never immerse the appliance in water.



Do not use the appliance if the water tank is empty. Make sure the water tank is filled at least to the “MIN” marking.



Risk of burns! Do not touch the adapter after making coffee, wait until the adapter has cooled down.



For Nespresso® capsules

1. Preparation

Lift the lever and remove any adapter from the appliance.



2. Insert the capsule into the adapter Lift the adapter cover and insert the capsule. Lower the cover to close it.



3. Inserting the adapter into the machine Lift the lever and insert the adapter into its compartment. Lower the lever to close.



4. Switching on the appliance & preheating Press the ON/OFF button to turn on the appliance. The 3 control buttons light up and flash to indicate that the appliance is in preheating mode. The warm-up time is approximately 45 seconds.



5. Selecting your coffee volume

Place a cup on the removable grid. As soon as the lights on the control buttons stop flashing, press the small cup or large cup button to start making coffee. To stop the coffee flow, press the selected cup button again.



6. End of procedure

Lift the lever and remove the adapter. Lower the lever to close.

Wait until the adapter has cooled down before opening its cover to discard the used capsule. If you are no longer using the device, please wash the adapter with hot soapy water for future use.



Tips

- To have a hot coffee, you should first make a cup with the adapter but without placing a capsule inside.
- We recommend using a preheated cup.
- The coffee volume of the large cup is set by default for a flow of approximately 47 seconds and that of the small cup is approximately 25 seconds. To set the flow time, refer to the instructions “Setting the coffee volume”.
- Make sure you lower the lever before pressing the buttons.
- Always put a cap on the drip grid.
- If you are no longer using the appliance after preparation, please wash the adapter with hot soapy water for future use.

For Dolce Gusto® capsules

1. Preparation

Lift the lever and remove any adapter from the appliance.



2. Inserting the capsule into the adapter

Lift the adapter cover and insert the capsule. Lower the cover to close.



3. Inserting adapter into the machine

Lift the lever and insert the adapter into its compartment. Lower the lever to close.



4. Switching on the appliance & preheating

Press the ON/OFF button to turn on the appliance.

The 3 control buttons light up and flash to indicate that the appliance is in preheating mode. The warm-up time is approximately 45 seconds.



5. Selecting your coffee volume

Place a cup on the removable grid. As soon as the lights on the control buttons stop flashing, press the small cup or large cup button to start making coffee.

To stop the coffee flow, press the selected cup button again.



6. End of procedure

Lift the lever and remove the adapter. Lower the lever to close.

Wait until the adapter has cooled down before opening its cover and discarding the used capsule. If you are no longer using the device, please wash the adapter with hot soapy water for future use.



For E.S.E.® pods

1. Preparation

Lift the lever and remove any adapter from the appliance.



2. Inserting the pod into the adapter Insert the stainless steel filter holder into the adapter then place the E.S.E. in the filter holder. Close the adapter cover.



3. Inserting the adapter into the machine

Lift the lever and insert the adapter into its compartment. Lower the lever to close it.



4. Switching on the appliance & preheating press the ON/OFF button to turn on the appliance. The 3 control buttons light up and ash to indicate that the appliance is in preheating mode. The warm-up time is approximately 45 seconds.



5. Selecting your coffee volume

Place a cup on the removable grid. As soon as the lights on the control buttons stop flashing, press the small cup or large cup button to start making coffee.

To stop the coffee flow, press the selected cup button again.



6. End of procedure

Lift the lever and remove the adapter. Lower the lever to close.

Wait until the adapter has cooled down before opening its cover to discard the used capsule. If you are no longer using the device, please wash the adapter with hot soapy water for future use.



For coffee powder

1. Preparation

Lift the lever and remove any adapter from the appliance.



2. Placing coffee in the adapter

Insert the stainless steel filter holder (if it is not already in place) into the adapter then place the coffee with a spoon in the filter holder. Compress the coffee with the bottom of the spoon. Close the adapter cover lid.

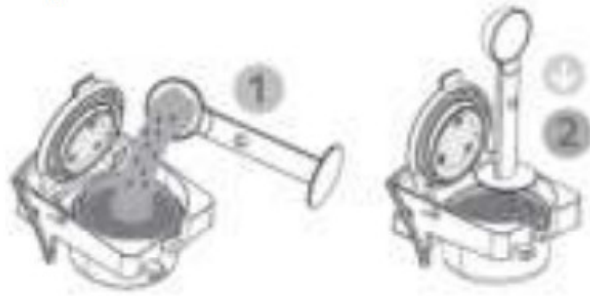

3. Inserting the adapter into the machine

Lift the lever and insert the adapter into its compartment. Lower the lever to close it.



4. Switching on the appliance & preheating

Press the ON/OFF button to turn on the appliance.

The 3 control buttons light up and flash to indicate that the appliance is in preheating mode. The warm-up time is approximately 45 seconds.



5. Selecting your coffee volume

Place a cup on the removable grid. As soon as the lights on the control buttons stop flashing, press the small cup or large cup button to start making coffee.

To stop the coffee flow, press the selected cup button again.



6. End of procedure

Lift the lever and remove the adapter. Lower the lever to close.

Wait until the adapter has cooled down before opening its cover to discard the used capsule. If you are no longer using the device, ensure to wash the adapter with hot soapy water for future use.



Cleaning the adapter



Wait until the adapter has cooled down before opening its cover to dispose of the used coffee. Wash the adapter in hot soapy water and rinse it before allowing it to air dry.

Note: the Dolce Gusto capsule adapter has no cover.

Cleaning the appliance



Use a soft cloth or sponge dampened with a neutral pH product to clean the surfaces of the machine. Remove the water tank, wash it in soapy water and rinse it thoroughly before drying it with a clean cloth.

Descaling procedure

It is normal for limescale to form in the appliance.

Limescale particles can form in the water deposit and in the machine and can block the pipes and cause malfunctioning or damage. To avoid this, please descale the appliance after 300 to 400 uses or if there is a noticeable slowdown in the flow rate.

To descale your appliance, please follow the instructions below:

- Buy a commercial descaling product, especially for descaling espresso machines.
- Dilute the descaling solution with water according to the manufacturer's instructions. Wait until the descaling solution is completely dissolved in the mixture.
- Pour this solution into the water tank, filling it to the "MAX" mark.
- Connect the appliance to a power outlet.
- Place a large bowl on the drip grid. Insert an empty adapter (without capsule and without coffee) into the appliance.
- Press the ON/OFF button.
- Press the large cup button to circulate the descaling mixture through the appliance's internal circuits. At the end of the large cup program flow cycle, repeat several large cup program cycles until the mixture in the water tank runs out.
- Repeat another descaling cycle by filling the water tank with the mixture for a second time.
- Carry out two internal rinsing cycles of the device with clean water.

TROUBLESHOOTING

ISSUES	CAUSES	SOLUTIONS,
NO COFFEE COMES OUT OF THE APPLIANCE.	<ol style="list-style-type: none"> 1. The water tank is not positioned correctly. 2. There is no capsule in the machine. 3. The lever is not properly locked. 	<ol style="list-style-type: none"> 1. Please check if the water tank is installed correctly. 2. Insert a capsule into the adapter. 3. Raise the lever and lower it until it locks.
THE DEVICE DOES NOT WORK, NO BUTTONS LIGHT UP.	<ol style="list-style-type: none"> 1. The appliance is not plugged in. 2. The appliance is in standby mode. 	<ol style="list-style-type: none"> 1. Check whether the device is connected to the power supply. 2. Press the ON/OFF button to exit standby mode.
THE COFFEE IS NOT HOT ENOUGH.	<ol style="list-style-type: none"> 1. The machine is cold. 2. The cup is cold. 3. Build-up of limescale in the device. 	<ol style="list-style-type: none"> 1. Start a large cup cycle with an empty adapter to warm the internal circuits of the appliance. 2. Preheat the cup. 3. Descale the appliance.
THE VOLUME OF DRINK IS NOT GOOD.	<ol style="list-style-type: none"> 1. Accumulation of limescale in the device. 2. Not enough water in the tank. 	<ol style="list-style-type: none"> 1. Descale the appliance. 2. Fill the water tank and press the small or large cup button to continue the flow.
WATER ON THE TABLE.	<ol style="list-style-type: none"> 1. The water tank is leaking. 2. The drip tray is full. 	<ol style="list-style-type: none"> 1. Stop the appliance, remove the water tank and replace it, checking that the valve is not blocked. 2. Empty the drip tray.
THE LEVER DOES NOT CLOSE.	<ol style="list-style-type: none"> 1. The adapter is not placed correctly. 	<ol style="list-style-type: none"> 1. Raise the lever, remove the adapter, and put it back in the correct position.

OTHERS INFORMATION

Technical information

SPECIFICATIONS	
REFERENCE DEPENDING ON COLOURS (MODEL)	CKZ39-WH CKZ39-BL
POWER SUPPLY	220-240V~ 50/60Hz
POWER	1450W
PUMP PRESSURE	19 bars
WATER TANK CAPACITY	600ml

WARRANTY

The warranty of the product does not cover any use that breaches the product instructions for use:

- an installation that does not comply with legal and regulatory provisions (not having an earth connection, moving the appliance during use leading to a cut in the power cord or the supply and drainage pipe, or subsequent to external phenomena, such as lightning, flooding, and more generally nonobservance by the end-user, the installer or the reseller of the assembly and set up conditions listed in the user booklets of the products of the brand) ;
- abnormal use in the event of commercial, professional, and industrial use;
- use that does not meet the conditions listed in the instructions for use;
- exposure of the product to external conditions affecting the product (rain, excessive humidity, abnormal variation in electrical voltage);
- deterioration of the product due to shocks falls, negligence, and user maintenance defects;
- transformation of the product and its unauthorized technical specifications;
- a product transportation problem;
- cracks on enameled products that are the consequence of differences in sheet-enamel or cast-enamel expansion and do not modify the adhesion of the enamel;
- breakage of glass, plastic accessories, rubber parts, aesthetic and wearing parts;
- an intervention carried out directly by a user or an unauthorized company; – use of spare parts other than original spare parts referenced by the brand.

Finally, the following are also excluded from the guarantee:

- a breakdown during unpacking which only concerns appearance defects that may arise from a transport or handling incident;
- aesthetic pieces;
- the accessories;
- breakdowns relating to accessories; – no detectable defects;
- interventions that do not require changing any parts;
- so-called “second hand” or “refurbished” products;
- repetitive failures due to a wrong diagnosis.



The warranty will be void if the product nameplate and/or serial number are removed.

ZANUSSI

ZANUSSI is a registered trademark used under license from AB Electrolux (publ).

Importer :
CLD Distribution SA
Rue du Grand Champ 14
Fernelmont 5380 – Belgium

www.zanussismallappliances.fr
www.zanussismallappliances.be
www.zanussismallappliances.nl

Documents / Resources

	<p>ZANUSSI CKZ39-BL Multi-System Espresso Machine [pdf] Instruction Manual CKZ39-BL, CKZ39-WH, Multi-System Espresso Machine</p>
--	--

[Manuals+.](#)