



zamel ROW-02 Flush Mounted 2 Channel Wi-Fi Receiver User Manual

[Home](#) » [ZAMEL](#) » zamel ROW-02 Flush Mounted 2 Channel Wi-Fi Receiver User Manual 

zameL



SUPLA.ORG
USER'S MANUAL

Flush mounted
2-channel
Wi-Fi receiver
supla ROW-02

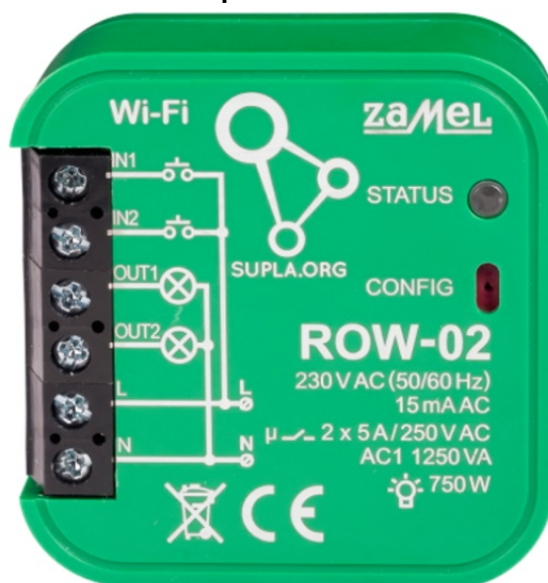

Contents

- [1 BEFORE GETTING STARTED](#)
- [2 WARNING](#)
- [3 INFORMATION](#)
- [4 TECHNICAL DATA](#)
- [5 GETTING STARTED IN 5 STEPS](#)
- [6 RESETTING THE DEVICE](#)
- [7 MORE INFORMATION](#)
- [8 WARRANTY](#)
- [9 Documents / Resources](#)
 - [9.1 References](#)
- [10 Related Posts](#)

BEFORE GETTING STARTED

RECEIVER FEATURES:

- Wi-Fi 2,4 GHz radio communication,
- Works with ordinary switches and push-buttons,
- Independent 2-channel control option,
- Control possible locally with a switch or remotely via a smartphone
- Ideal for installation under a 2-key switch which allows to add the smartphone control functionality.

WHAT'S INSIDE THE BOX

- ROW-02 device
- user's manual

WHAT YOU NEED TO GET STARTED:

- screwdriver / pliers,
- max. 2.5 mm² cable for connecting the power supply,
- qualification certificate for voltages up to 1 kV is recommended.

WARNING



The device must be connected to power supply in accordance with applicable electrical and safety standards or regulations.

See this User Manual for the wiring instructions.

Installation, wiring and setting of this product shall only be done by qualified electrical engineers who have read and understood this User Manual and the product features.

Do not open or otherwise disassemble the product enclosure; otherwise the product warranty will be void and an electrocution hazard may occur. Prior to installing and wiring this product, make sure that the wiring to be connected is not live. The conditions and methods of transport, storage and operation of this product may affect its performance.

Do not install the product if any of its components is missing, the product is damaged or deformed in any way.

If any malfunctions are found, consult the manufacturer.

ZAMEL Sp. z o.o. hereby declares that the type of ROW-02 radio device complies with Directive 2014/53/EU. The entire EU declaration of conformity is available at: www.zamel.com

INFORMATION

During installation, make sure that the receiver is not exposed to direct contact with water and that it does not operate in a humid environment. The installation place temperature should be within the range of -10 and +55°C. The ROW-02 receiver is designed for indoor installation.

When installed outdoors, the device should be placed in an additional enclosure of hermetic type and protected against water penetration – in particular where connection terminals are located.

TECHNICAL DATA

ROW-02

| | |
|---|--|
| Rated supply voltage: | 230 V AC |
| Rated mains frequency: | 50 / 60 Hz |
| Rated power consumption: | 1.2 W |
| Transmission: | Wi-Fi 2.4 GHz 802.11 b/g/n |
| Maximum transmit power: | ERP <20 mW |
| Number of inputs: | 2 |
| Compatible connectors: | monostable (bell buttons), bistable (standard light switches without backlight function) |
| Number of output channels: | 2 |
| Relay contact parameters (normally open voltage-free contact): | 2 x NO 5A / 250 VAC |
| Number of terminals: | 6 (conductor cross-section up to 2.5 mm ²) |
| Enclosure installation: | gate drive or installation box Ø 60 mm |
| Operating temperature range: | -10 + +55°C |
| Enclosure protection rating: | IP20 |
| Dimensions | 47.5 x 47.5 x 23 mm |
| Weight: | 0.046 kg |
| Maximum output current-carrying capacity: | 2 x 5 A/ 250 V AC: incandescent and halogen light bulbs — 750 W; LED lamps — 60 W; compact fluorescent loops (CFL) — 250 W |

GETTING STARTED IN 5 STEPS

LET'S GET STARTED



download, install and launch the supla mobile app



STEP 1 install the app

5.1. INSTALL THE SUPLA MOBILE APP



www.supla.org/android



www.supla.org/ios



STEP 2 create an account / log in

5.2. CREATING A SUPLA ACCOUNT IF YOU DO NOT HAVE AN ACCOUNT

Create it by tapping "Create Account" in your app.

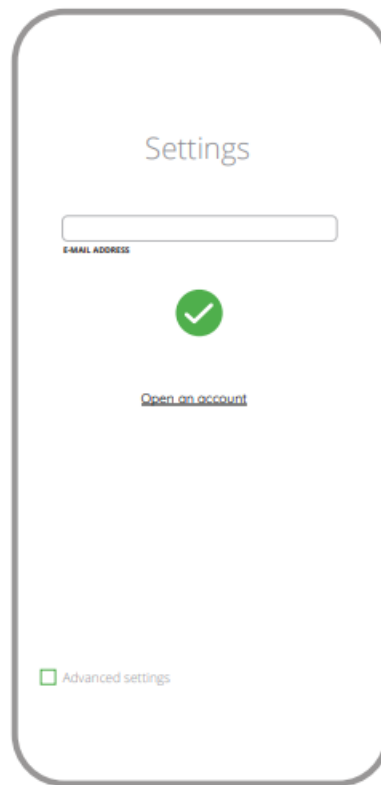

IF YOU ALREADY HAVE

AN ACCOUNT

Enter the e-mail address which you have used to create the account.

CREATE AN ACCOUNT

On this page, enter the following data:

- e-mail address,
- password,
- password confirmation.

Confirm all information by tapping "Create an account".

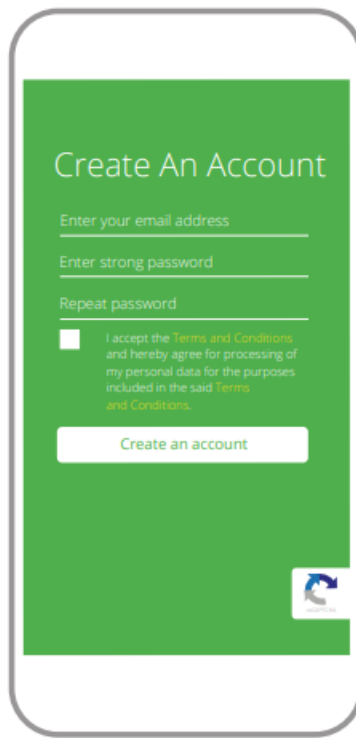

STEP 3

connect to the power supply

5.3. WIRING DIAGRAM

Connect the ROW-02 device to the installation according to the following diagram.

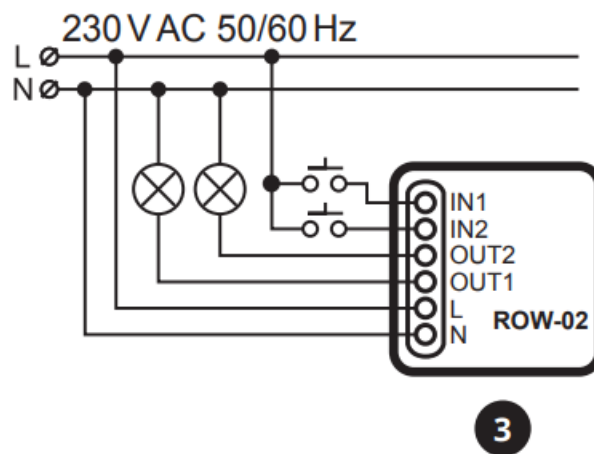

STEP 4 add the device

5.4. ADDING THE DEVICE AUTOMATICALLY

OPEN THE APP

Then select "Add device" from the menu.

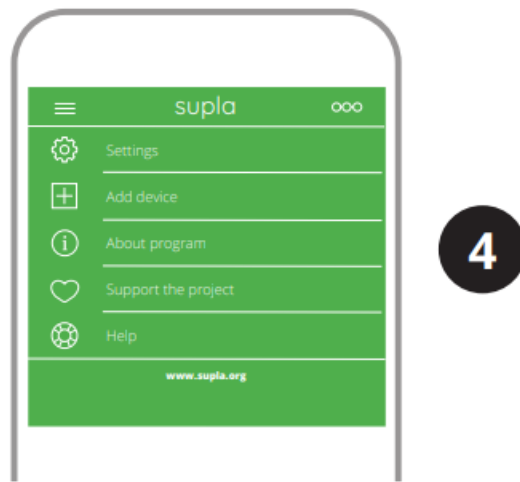

STARTING THE WIZARD

The Add Device Wizard will appear. To continue, press the “Next” button.

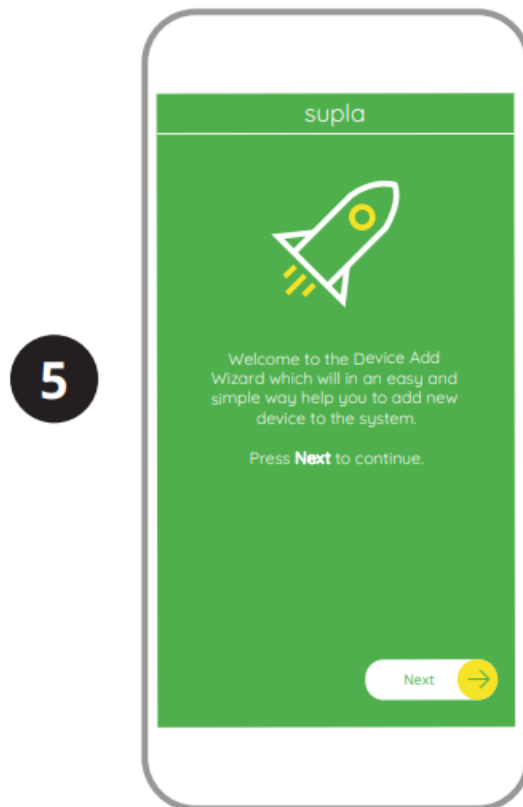

NETWORK PASSWORD

Choose a WiFi network to enable Internet connectivity for the device. Enter the network password and tap “Next” to continue.

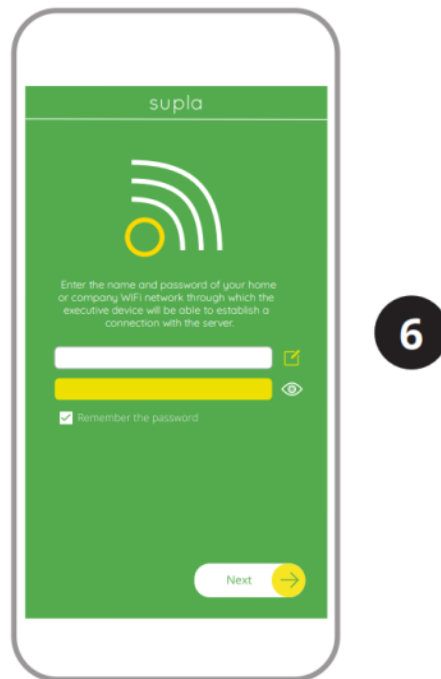

CONNECTING THE DEVICE

Wire the power supply to the device as shown in the diagram. Make sure that the device STATUS LED responds as shown in the animation on screen. If it does not, switch the device into the configuration mode by holding the CONFIG button on the device. Next, press the START button.

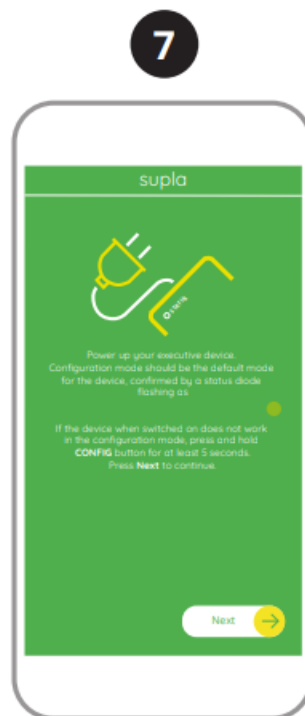

NEW DEVICE REGISTRATION DISABLED

If the “New Device Registration Disabled” message is displayed, open this website: <https://cloud.supla.org/>, Log into your account, go to the “My SUPLA” tab and Enable Device Registration. Next, repeat the device adding process.

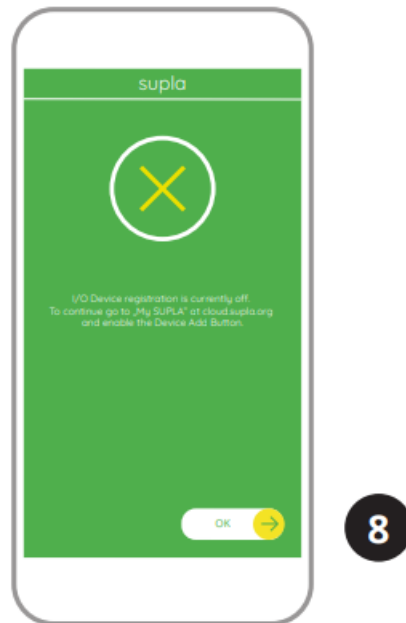

8

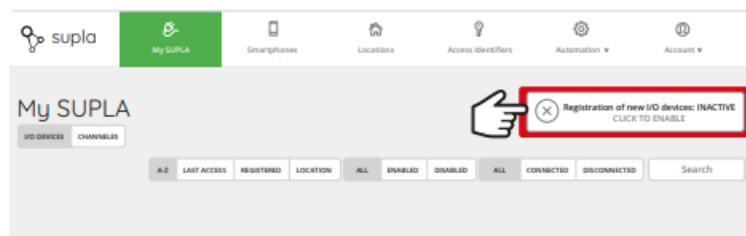

9

DEVICE ADDED SUCCESSFULLY

Adding a device is simple and should end without any problems.

If the device is added successfully, the following message is displayed: "Device configuration successful". Tap OK. Now, the supla app should display the device which you have just added on the list. The ROW-02 STATUS LED in the front goes on steadily when the connection with the server is active.

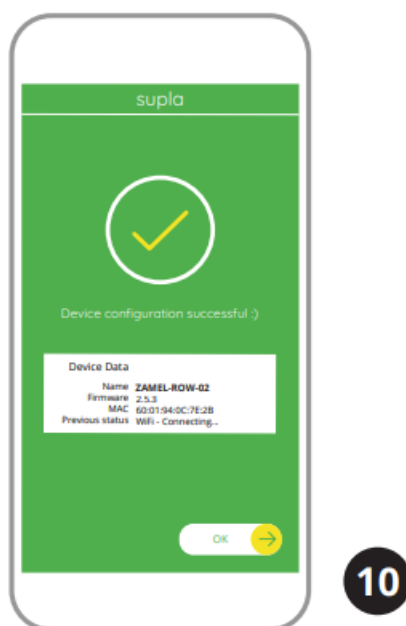

10

CAUTION!

If the connected device is not shown on the list immediately once the configuration is complete, check the device STATUS LED. When added for the first time, the STATUS LED of some devices may flash very fast and irregularly. This happens when the device controller is updating its firmware.

A moment after the update, the STATUS LED should go on steadily which means there is an active connection with the server.

ADDING THE DEVICE MANUALLY

Add the device manually when the automatic device adding mode of the supla app fails somehow.

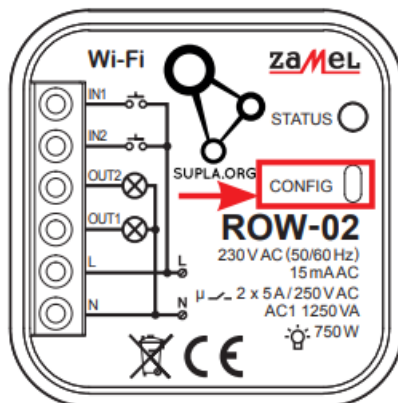

11

DEVICE CONFIGURATION MODE

To do this, switch the device into the configuration mode by pressing and holding the CONFIG button until the STATUS LED starts to flash.

CONFIGURING THE DEVICE

Now, find the device in the available Wi-Fi network list on your mobile device and connect to it. The Wi-Fi network name should begin with "ZAMEL-ROW-02", followed by the device serial number.

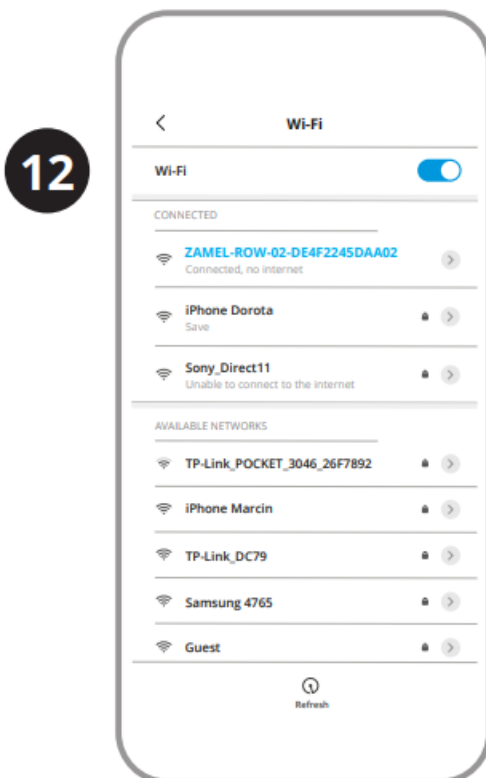

12

Open a web browser and type the following address in the address bar: 192.168.4.1 and open it. The configuration page will be displayed. Here, you can easily change the network settings.

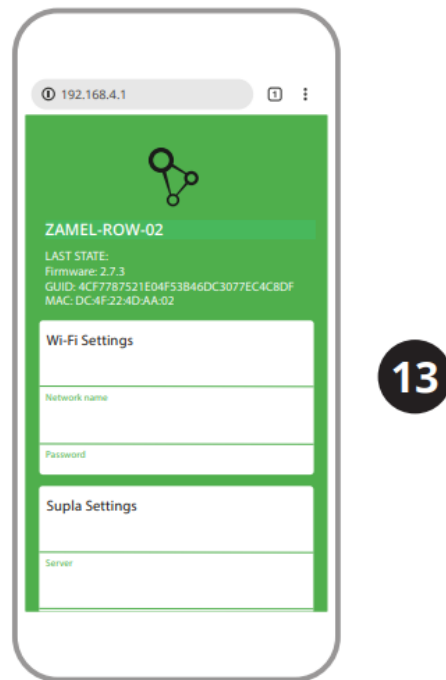

When done, tap “SAVE” at the bottom of the screen.

The message “Data saved!” should be displayed. To confirm the entered data, briefly press the CONFIG button on the device. If the device connects to the server successfully, the STATUS LED will go on steadily.

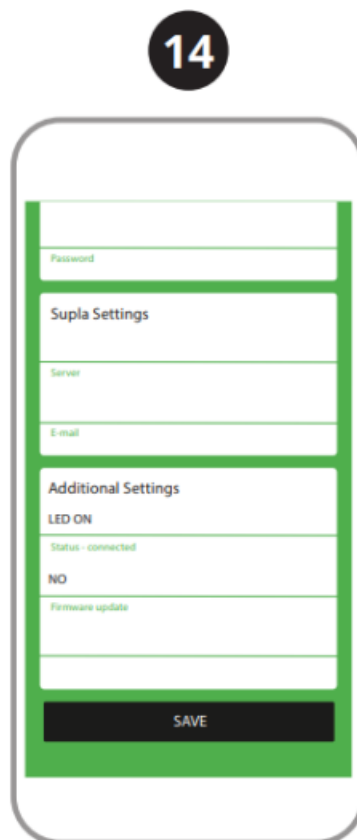

STEP 5 control the lights

5.5. APP FUNCTIONS

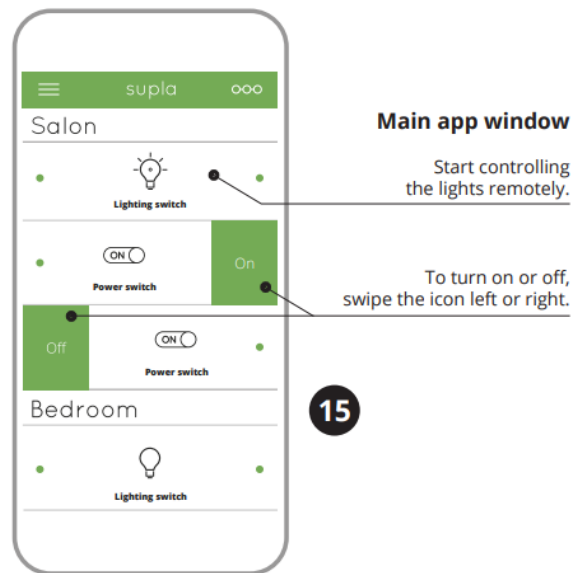

5.6. CHANNEL GROUPS

Channel groups allow several channels to be controlled with only one app button. For channels to be grouped together, they must be of the same type, e.g. light switches can only be grouped with light switches, roller shutters with roller shutters etc. Channel groups may also be associated with schedules, e.g. adding a group with e.g. 4 light controllers to one schedule.

CREATING A CHANNEL GROUP

1. Press “Automation” from the menu and then select the “Channel groups” option.
2. Press “Add new channel group”. A new channel group will be displayed at the bottom.
3. Press “Choose the first channel to define and save the group function”.
4. Select the first channel; it will define the function of other channels e.g. when a light switch channel is selected, only light switches can be added to it.
5. Press the “Add” button. When the first channel is added, a group is created and its ID is visible at the top.
6. Select another channel and press “Add”. Channels will be displayed next to each other as additional squares.
7. After adding more channels, you can name it in the group details to make it more recognisable.
8. Save the changes by pressing the button on the right.

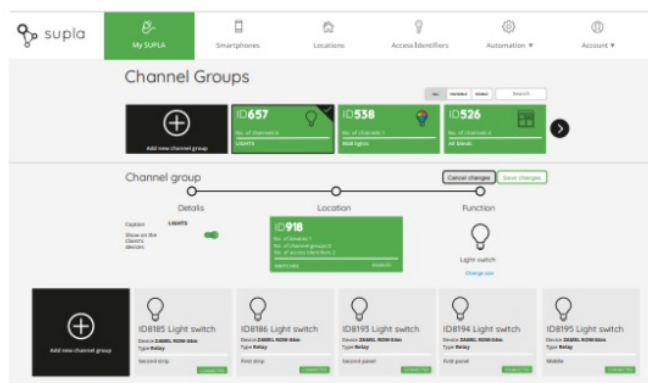

CONTROLLING A CHANNEL GROUP USING THE APP

1. Open the SUPLA app on your smartphone.

2. Switch to the channel group view (three dots) in the upper right corner of the app.
3. A channel group with the name previously entered should appear. From now on, you can control the group exactly the same way as a single device.

RESETTING THE DEVICE

RESETTING THE DEVICE TO DEFAULT SETTINGS

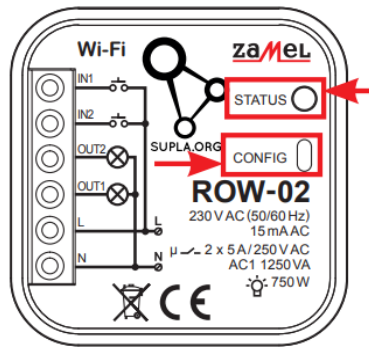

17

1. Press and hold CONFIG
The STATUS LED should flash fast.
2. Release the CONFIG button The STATUS LED will continue to flash.
3. Press and hold CONFIG again The STATUS LED should blink once.
4. Release the CONFIG button The device has been reset to defaults and restarts now.
The STATUS LED should flash fast.

MORE INFORMATION

Additional information and video material You can find by scanning QR code or by using the following link:
<https://supla.zamel.com/en/product/row-02/>



18

WARRANTY

1. ZAMEL Sp. z o.o. grants a 24-month warranty for the products it sells.
2. The warranty granted by ZAMEL Sp. z o.o. does not cover:
 - (a) defects caused by transport, handling or other factors;
 - (b) defects caused by improper installation or operation of the products manufactured ZAMEL Sp. z o.o.;
 - (c) defects caused by any modifications or alterations made by the BUYER or any third party to the sold products or to the equipment required for the proper operation of the sold products;
 - (d) defects caused by any force majeure event or another fortuitous event beyond any reasonable control of ZAMEL Sp. z o.o.
3. The BUYER shall report all warranty claims in writing at the point of sale or to ZAMEL Sp. z o.o.
4. ZAMEL Sp. z o.o. will examine each warranty claim as regulated by the applicable provisions of the Polish law.
5. If found valid by examination, the warranty claim will be processed by replacement of the defective product, its repair or a refund of the price of purchase at the sole discretion of ZAMEL Sp. z o.o.
6. No rights of the BUYER arising from the statutory or regulatory laws concerning implied warranty for defects of sold goods are limited, prejudiced or excluded by this warranty.



Documents / Resources



[zamel ROW-02 Flush Mounted 2 Channel Wi-Fi Receiver](#) [pdf] User Manual
ROW-02 Flush Mounted 2 Channel Wi-Fi Receiver, ROW-02, Flush Mounted 2 Channel Wi-Fi
Receiver, Mounted 2 Channel Wi-Fi Receiver, Channel Wi-Fi Receiver, Wi-Fi Receiver

References

- [!\[\]\(444b1eae2189e5cd8d096594c07a0a6e_img.jpg\) SUPLA Cloud](#)
- [!\[\]\(b81fe50bc966474a9bf510149094d8e3_img.jpg\) SUPLA - Apps on Google Play](#)
- [!\[\]\(94faa64fb42ea7f60c43d916dda9de51_img.jpg\) SUPLA on the App Store](#)
- [**User Manual**](#)

[Manuals+, Privacy Policy](#)

This website is an independent publication and is neither affiliated with nor endorsed by any of the trademark owners. The "Bluetooth®" word mark and logos are registered trademarks owned by Bluetooth SIG, Inc. The "Wi-Fi®" word mark and logos are registered trademarks owned by the Wi-Fi Alliance. Any use of these marks on this website does not imply any affiliation with or endorsement.