



ZALMAN Z3 Iceberg ATX Mid Tower Computer Case User Manual

[Home](#) » [ZALMAN](#) » ZALMAN Z3 Iceberg ATX Mid Tower Computer Case User Manual 

ZALMAN Z3 Iceberg ATX Mid Tower Computer Case User Manual



RAZER CHROMA can be compatible with Z3 ICEBERG through Z-Sync or H/W supported

- To ensure safe and easy installation, please read the following precautions.
- Product design and specifications may be revised to improve quality and performance without notice.

Contents

- 1 Precautions
- 2 Specifications
- 3 Diminsion
- 4 Accessories component
- 5 I/O Ports
- 6 How to control RGB LED
- 7 Removing the side panels
- 8 Removing the front panel
- 9 Mounting the motherboard
 - 9.1 Motherboard size
- 10 Mounting PCI-E(VGA) card
- 11 Mounting the 2.5" SSD
- 12 Mounting the 3.5" and 2.5" SSD / HDD
- 13 Mounting the PSU
- 14 Mounting the radiator
- 15 Mounting the fans
 - 15.1 Fan(s) Included / Fan Specifications
- 16 I/O Connectors
- 17 Certification
- 18 Documents / Resources
 - 18.1 References
- 19 Related Posts

Precautions

- Read this manual carefully before installing.
- Check the product and components before installing. If you find any abnormality, contact the location where you purchased the product for a replacement or refund.
- Wear gloves to prevent accidents when installing the product.
- Severe damage may occur when mounting the system, so do not apply excessive force.
- Connecting the cable incorrectly may cause a fire due to a short circuit. Make sure to refer to the manual when connecting the cable.
- Be careful not to block the ventilation hole of the product when using the system.
- Avoid locations with direct sunlight, water, moisture, oil, and excessive dust. Store and use the product in a well-ventilated location.
- Do not wipe the surface of the product using chemicals. (organic solvents such as alcohol or acetone)
- Do not insert your hand or other object into the product during operation, as this may injure your hand or damage the object.
- Store and use the product out of children's reach.
- Our company assumes no responsibility for any problem that occurs due to the use of the product for purposes other than its designated purposes and/or the carelessness of the consumer.
- The exterior design and specifications of the product are subject to change without prior notice to consumers for quality improvement.

Specifications

Model		Z3 Iceberg KOR	Z3 Iceberg
Case Form Factor		ATX Mid-Tower	
Dimensions		410 x 210 x 480(H)mm	
Weight		6.6kg	6.4kg
Case Materials		Plastic, Steel, Tempered Glass	
Motherboard Support		E-ATX(~280mm) / ATX / mATX / Mini-ITX	
Maximum VGA Length		315mm	
Maximum CPU Cooler Height		163mm	
Maximum PSU Length		160mm	
PCI Expansion Slots		7	
Drive Bays		2 x 3.5" (2 x Combo, 1 x Toolless), 4 x 2.5"	
Fan Support	Top	2 x 120mm / 2 x 140mm	
	Front	3 x 120mm / 3 x 140mm	
	Rear	1 x 120mm	
	Front	3 x 120mm (with White LED Effect)	1 x 120mm (Addressable RGB)

Fan(s) Included	Rear	1 x 120mm (with White LED Effect)	1 x 120mm (Addressable RGB)
			ARGB Controller Included
Radiator Support	Top	120mm / 240mm	
	Front	120mm / 240mm / 280mm / 360mm	
	Rear	120mm	
I/O Ports		1 x Headphone, 1 x Mic, 1 x USB 2.0, 2 x USB 3.0, Power Button, Reset Button, LED Button	

Diminsion

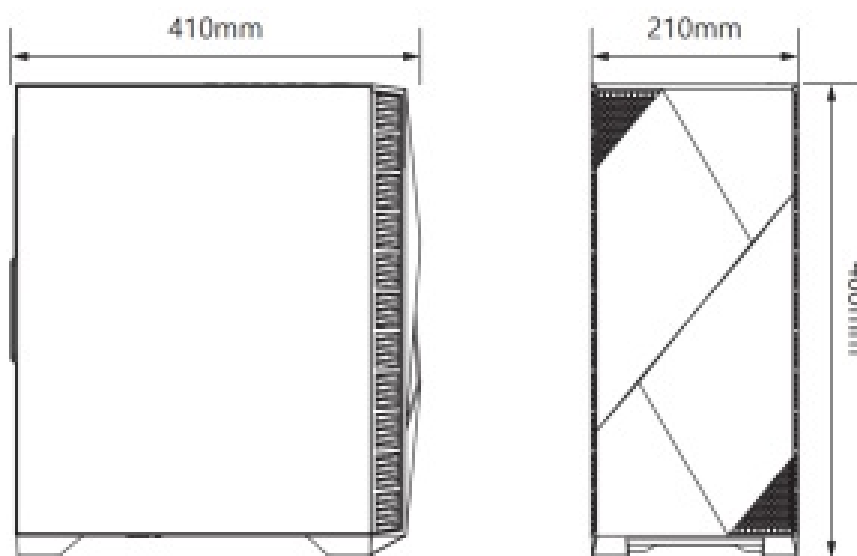

Accessories component

- User's Manual

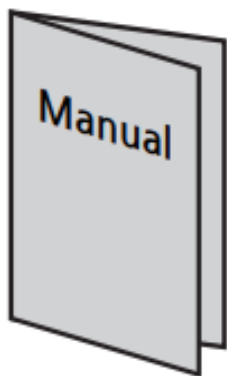

- Buzzer

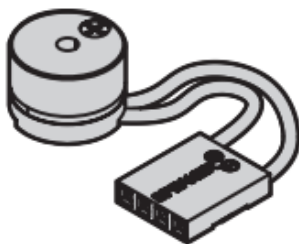

- PCI Slot Covers x 2

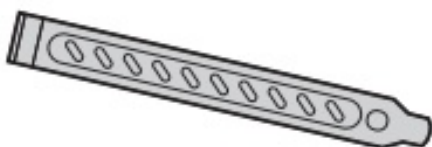

- Cable Ties x 5



- Glass Cleaner



- USB Rubber overs x 3



- Fan Screws x 6



- Media Rubber Covers x 2



- Thumb Screws x 2



- HDD Screws x 8



- SSD / MB Screws x 22



- PSU / VGA Screws x 8



- Motherboard Standoffs x 6



I/O Ports



#	Part	#	Part	#	Part	#	Part
⑥	Power Button		HDD / Power LED		Reset Button		USB 3.0 Ports
	USB 2.0 Port		Headphone Jack		Microphone Jack		LED Button

How to control RGB LED

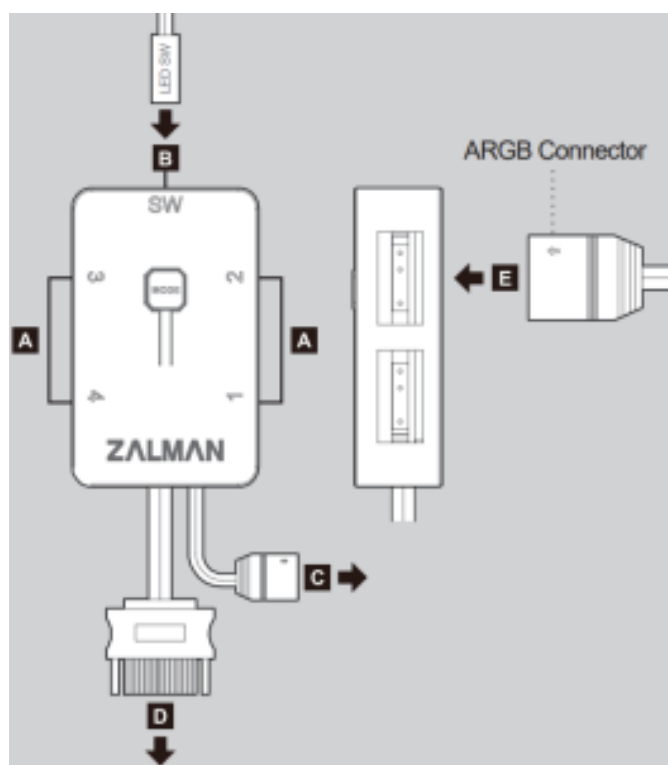

Caution : Please do not connect ARGB fans more than 8pcs, otherwise it may cause malfunction.

- LED colors & patterns can be changed by pressing the LED Button on I/O ports.
- Long pressing on the LED Button for 6 seconds, RGB LED will be turn off after blinking twice in white.
- Long pressing on the LED Button for 3 seconds, RGB will be synchronized with motherboard after blinking once in white. Press the LED Button again to desynchronize with motherboard.

1. (A) ARGB LED 1~4 / 3-Pin

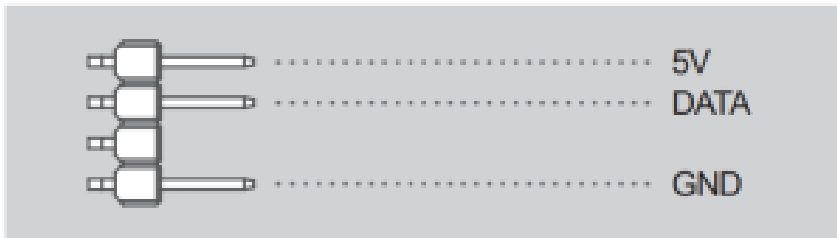

2. **(B)** ARGB LED Control Button / 2-Pin

- Connector to ARGB LED Control Button

3. **(C)** Other Motherboards Sync / 3-Pin

- Connector to Motherboard
- Requires Motherboard that Supports RGB Sync

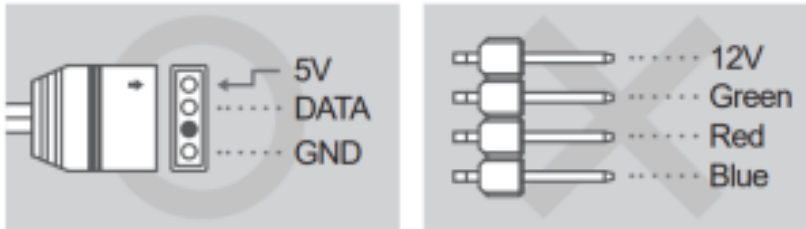

Caution: if Addressable 3 Pin connects to 12V header instead of 5V header improperly, It may cause fatal damages to the product by the overvoltage.

4. **(D)** SATA Power / 15-Pin

- Connector to PSU
- Input : 5V



5. **(E)** Connect the ARGB connector to the RGB hub

Removing the side panels

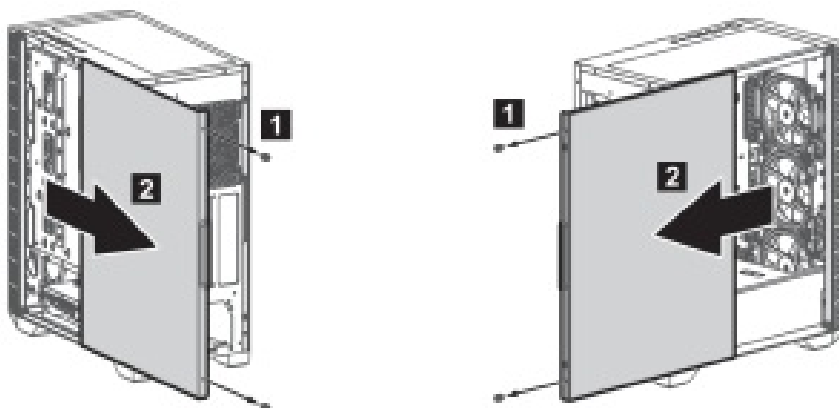

Removing the front panel

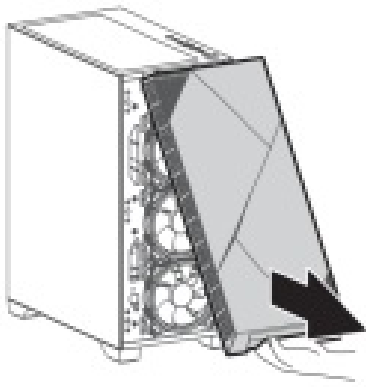

Mounting the motherboard

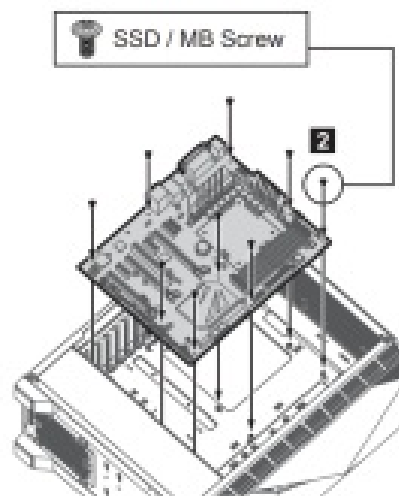
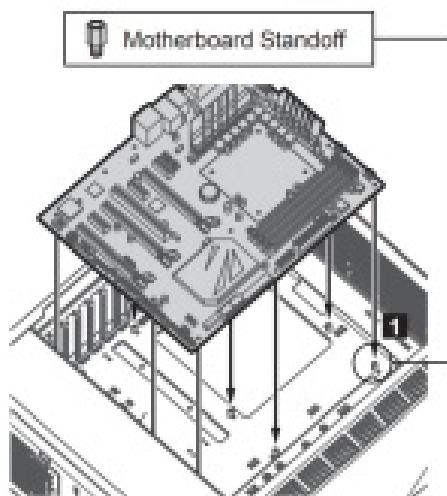

Motherboard size

1. E-ATX (~280mm)

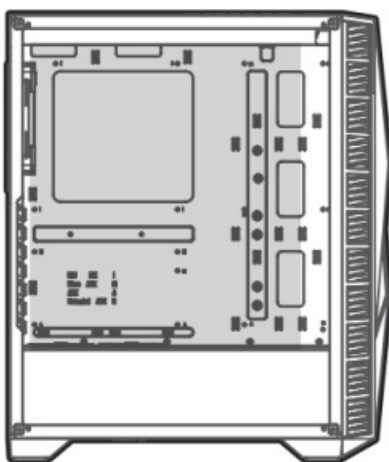

2. ATX

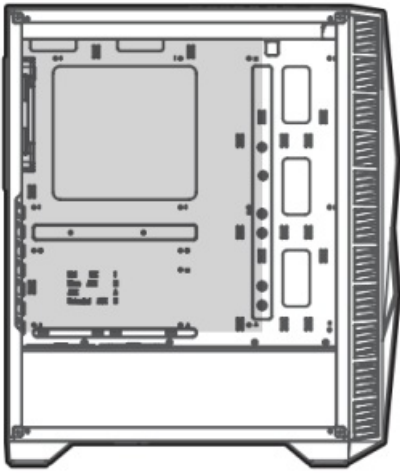

3. mATX

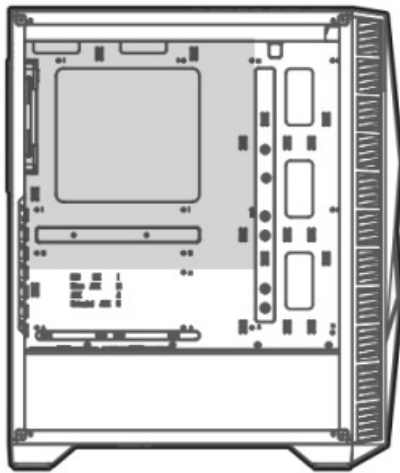

4. Mini-ITX

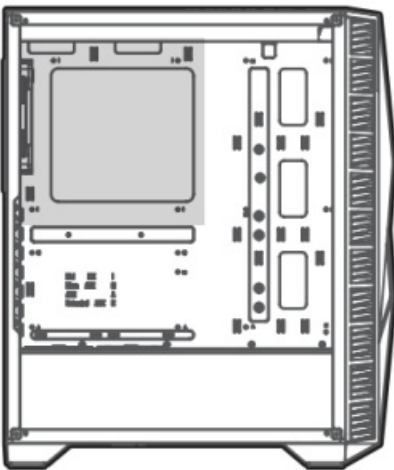

Mounting PCI-E(VGA) card

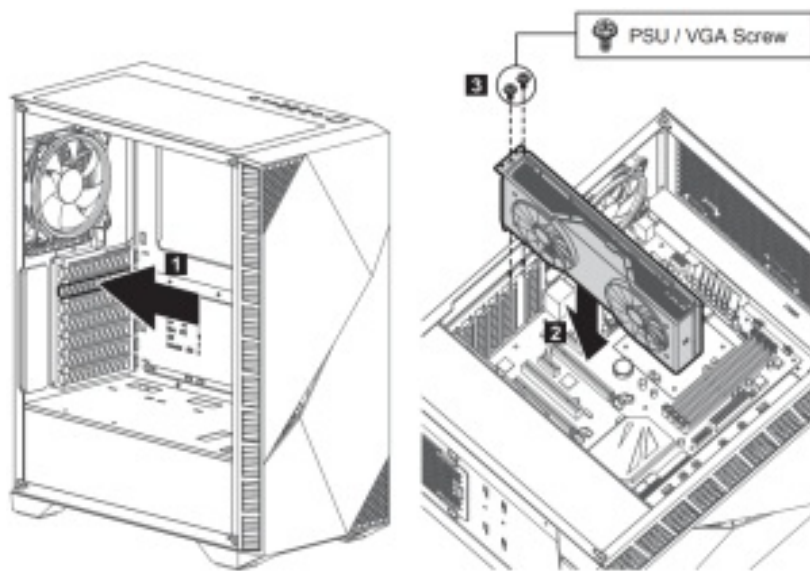

Mounting the 2.5" SSD

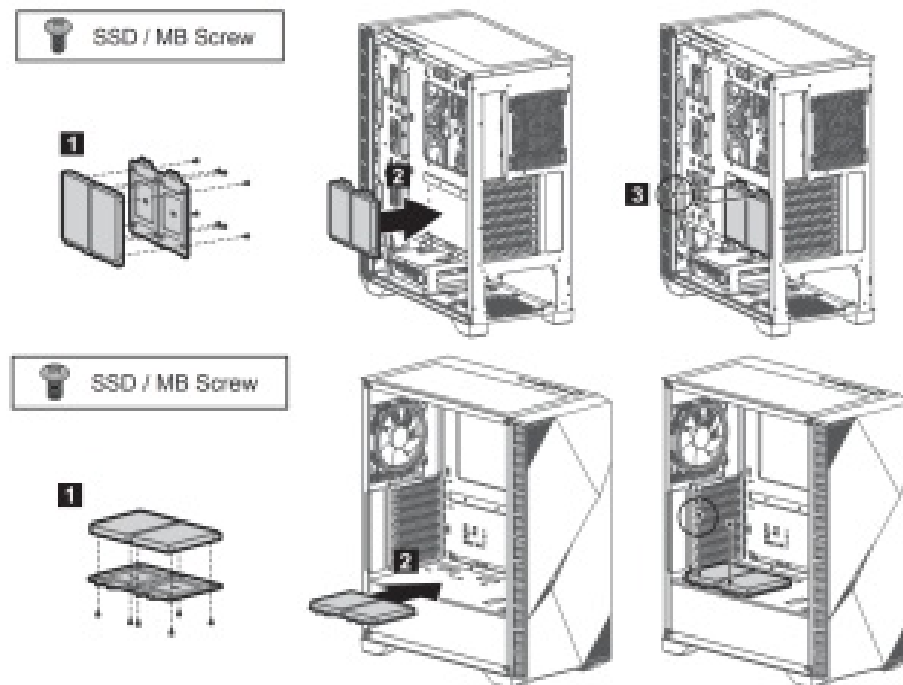

Mounting the 3.5" and 2.5" SSD / HDD

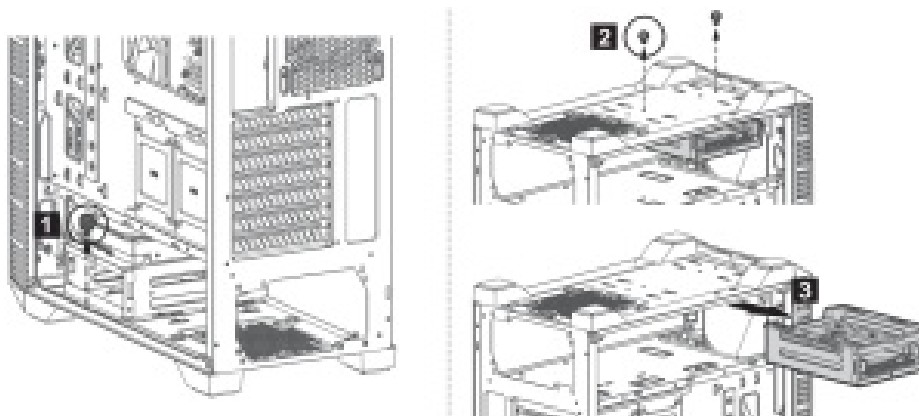

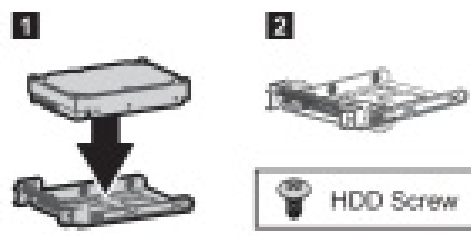
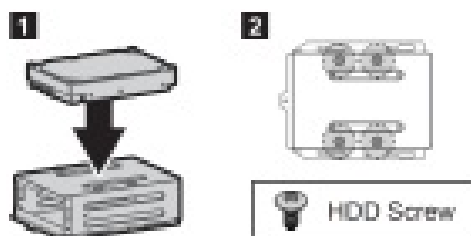

* 3.5" HDD can be mounted without bolting.

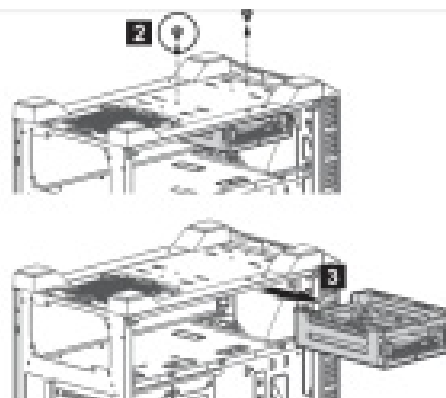
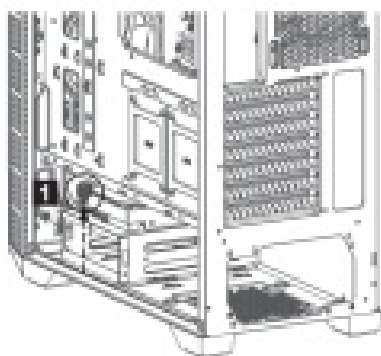
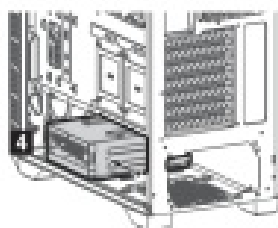
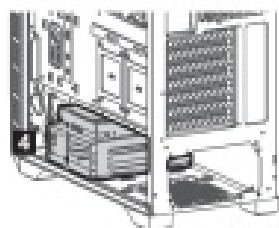
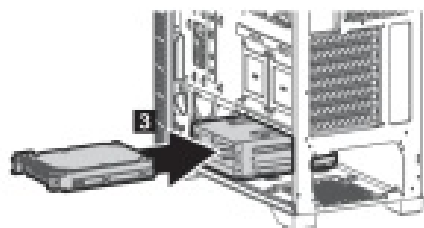
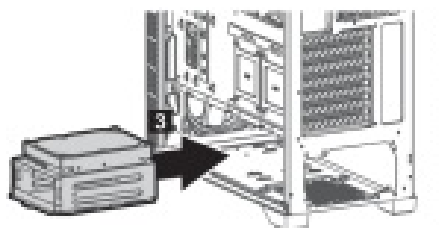

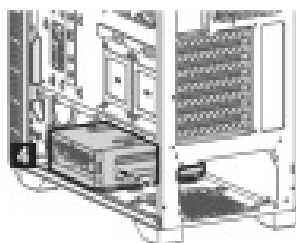
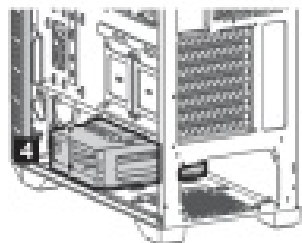
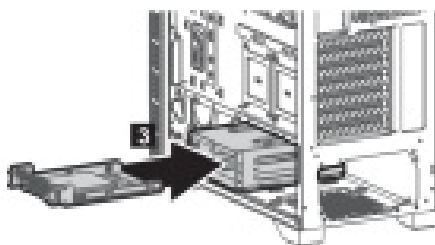
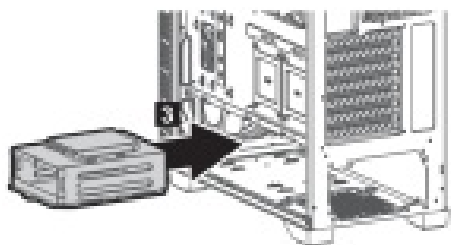

Mounting the PSU

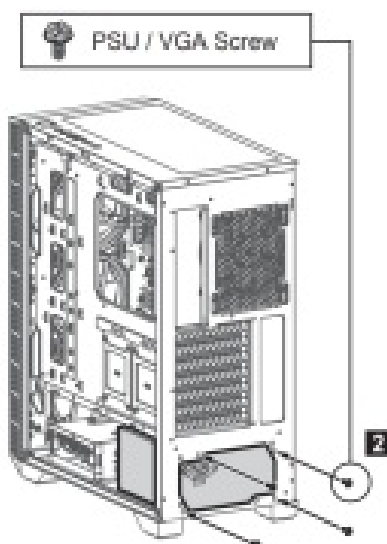
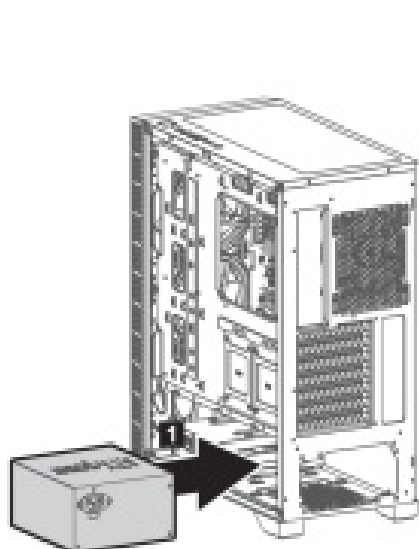

Mounting the radiator

1. Mounting the front radiator

- 120mm / 240mm / 280mm / 360mm

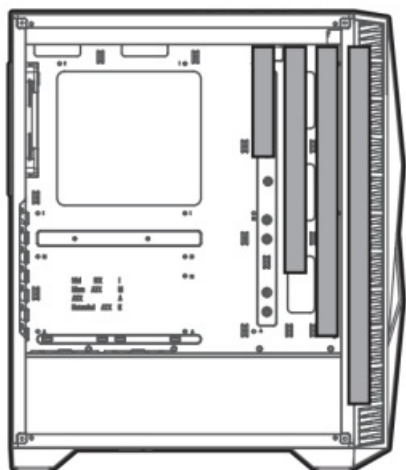

2. Mounting the top radiator

- 120mm / 240mm

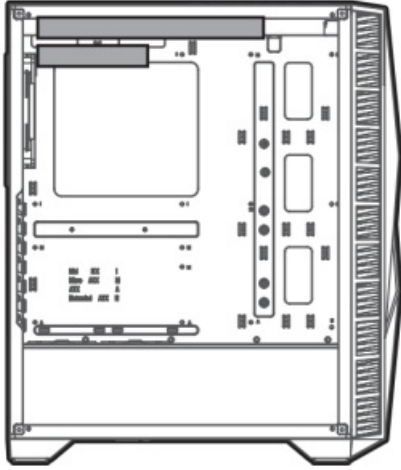

3. Mounting the rear radiator

- 120mm

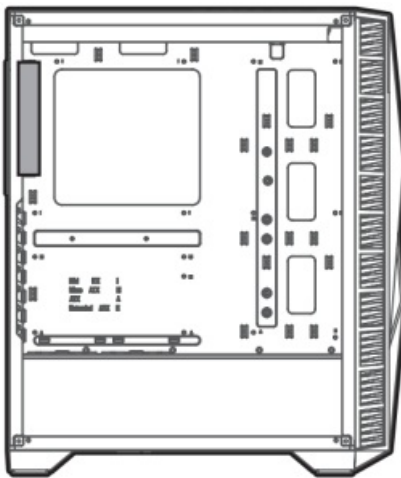

Mounting the fans

1. Mounting the top fans

- 120mm x 2, 140mm x 2

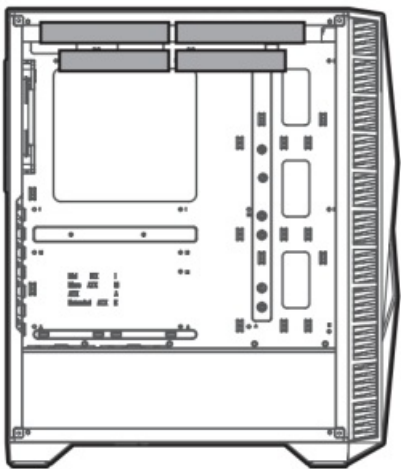

2. Mounting the front fans

- 120mm x 3, 140mm x 3

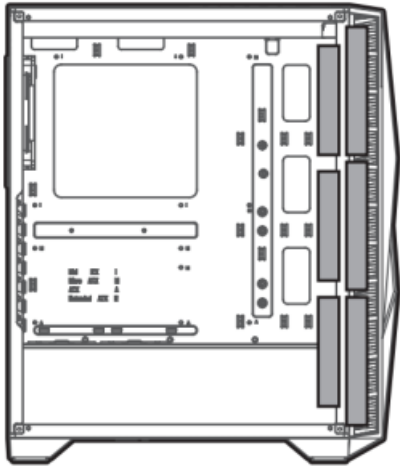

3. Mounting the rear/bottom fan

- 120mm x 1 / 120mm x 2

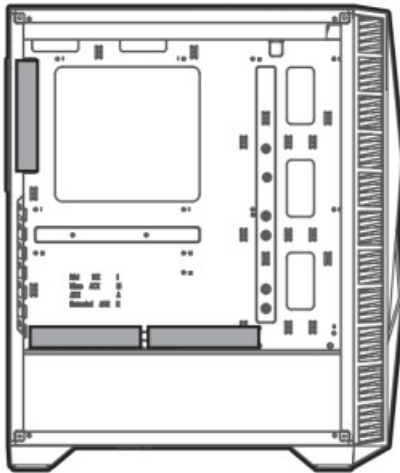

Fan(s) Included / Fan Specifications

Z3 Iceberg

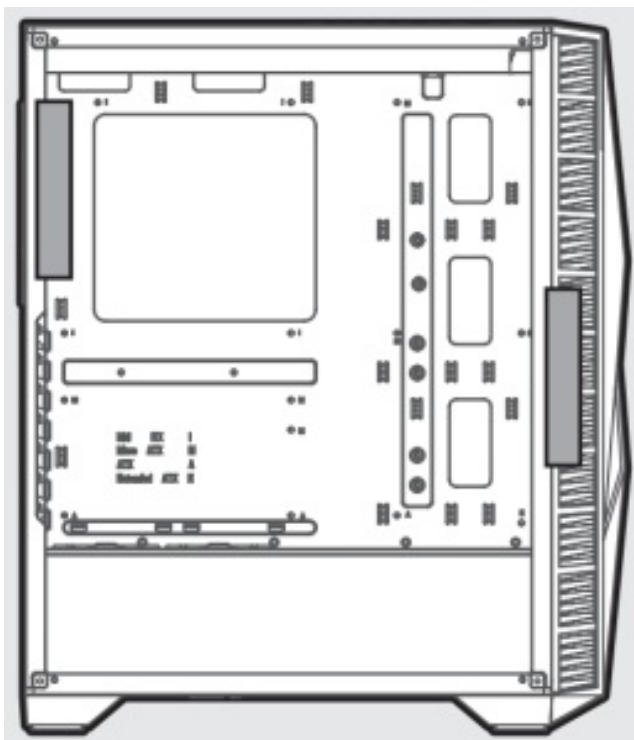

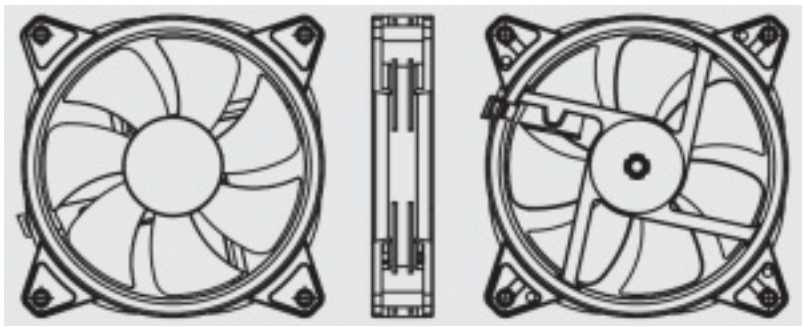

Addressable RGB LED Fan	Front / Rear
Dimensions	120 x 120 x 25(T)mm
RPM	1,300 \pm 15%
Fan	DC 12V 0.15A \pm 20%
LED	DC 5V 0.72A
Bearing	Hydro Bearing
Power Connector	Fan-3PIN

Z3 Iceberg KOR

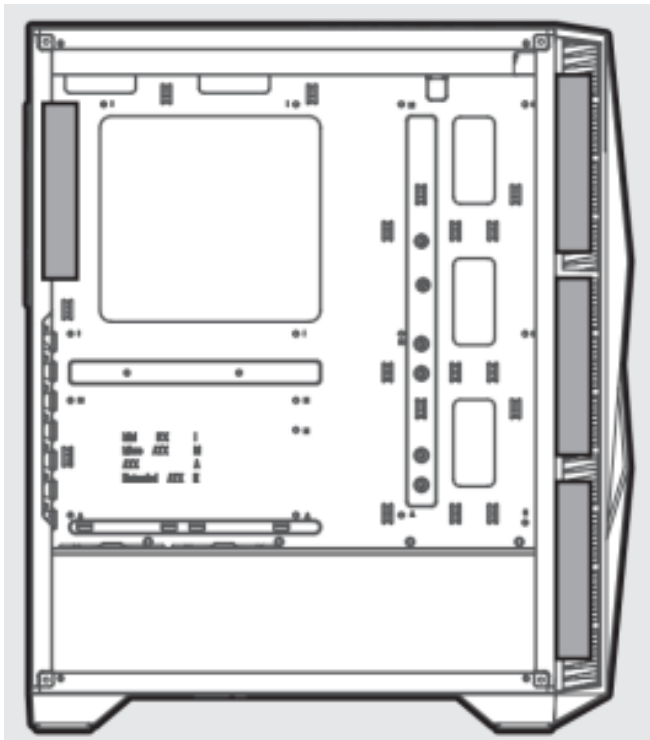

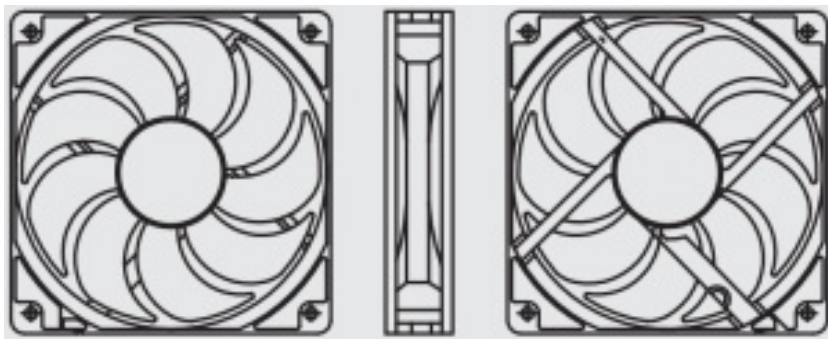

Addressable RGB LED Fan	Front / Rear
Dimensions	120 x 120 x 25(T)mm
RPM	1,200 ±10%
Fan LED	DC 12V 0.27A ±20%
Bearing	Hydro Bearing
Power Connector	IDE-4PIN Fan-3PIN

I/O Connectors





Certification

CE RoHS This mark, designed by Zalman, indicates product compliance with the European Union's RoHS (Restriction of Hazardous Substances) Directive.



Disposal of Old Electrical & Electronic Equipment (Applicable in the European Union and other European countries with separate collection systems)

Documents / Resources

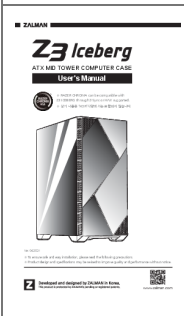
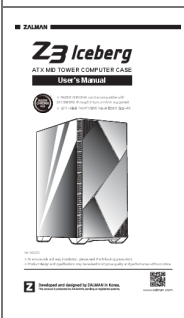
	<p>ZALMAN Z3 Iceberg ATX Mid Tower Computer Case [pdf] User Manual Z3 Iceberg, ATX Mid Tower Computer Case</p>
	<p>ZALMAN Z3 Iceberg ATX MID Tower Computer Case [pdf] User Manual Z3 Iceberg, ATX MID Tower Computer Case</p>
	<p>ZALMAN Z3 Iceberg ATX MID Tower Computer Case [pdf] User Manual Z3 Iceberg ATX MID Tower Computer Case, Z3 Iceberg, Z3, Iceberg, ATX MID Tower Computer Case, Tower Computer Case, ATX MID Computer Case, MID Computer Case, ATX Computer Case, Computer Case, Case</p>
	<p>ZALMAN Z3 Iceberg ATX MID Tower Computer Case [pdf] User Manual Z3 Iceberg ATX MID Tower Computer Case, Z3 Iceberg, ATX MID Tower Computer Case, ATX Tower Computer Case, MTD Tower Computer Case, Computer Case, Tower Case, Case</p>

References

- [zalman.com](https://www.zalman.com)