



ZALMAN X7 ATX Full Tower Computer Case User Manual

[Home](#) » [ZALMAN](#) » ZALMAN X7 ATX Full Tower Computer Case User Manual 

ZALMAN X7 ATX Full Tower Computer Case User Manual



Contents

- 1 Precautions
- 2 Specification
- 3 Accessories Component
- 4 Case construction
- 5 I/O Port
- 6 Separating the side panel
- 7 Mounting the main board
- 8 Mounting PSU
- 9 Mounting PCI-E(VGA) card
- 10 Mounting the riser card
- 11 Mounting 5.25" device
- 12 Mounting 2.5" SSD and HDD
- 13 Mounting the 3.5" and 2.5" HDD
- 14 Cable Connection
- 15 Separating the top panel
- 16 Mounting the top fan and radiator
- 17 Separating the front panel
- 18 Separating the front bezel
- 19 Mounting the fan and radiator in the front
- 20 Mounting the custom water cooler
- 21 Warranty
- 22 Documents / Resources
 - 22.1 References
- 23 Related Posts

Precautions

- Read this manual carefully before installing.
- Check the product and components before installing. If you find any abnormality, contact the location where you purchased the product for a replacement or refund.
- Wear gloves to prevent accidents when installing the product.
- Severe damage may occur when mounting the system, so do not apply excessive force.
- Connecting the cable incorrectly may cause a fire due to a short circuit. Make sure to refer to the manual when connecting the cable.
- Be careful not to block the ventilation hole of the product when using the system.
- Avoid locations with direct sunlight, water, moisture, oil, and excessive dust. Store and use the product in a well-ventilated location.
- Do not wipe the surface of the product using chemicals. (organic solvents such as alcohol or acetone)
- Do not insert your hand or other object into the product during operation, as this may injure your hand or damage the object.
- Store and use the product out of children's reach.
- Our company assumes no responsibility for any problem that occurs due to the use of the product for purposes other than its designated purposes and/or the carelessness of the consumer
- The exterior design and specifications of the product are subject to change without prior notice to consumers for quality improvement.

Specification

Model		X7
Case Form Factor		ATX FULL TOWER
Dimensions		617 x 230 x 587(H)mm
Weight		17.5kg
Case Materials		Aluminum, Steel, Plastic
Motherboard Support		E-ATX / ATX / M-ATX / M-ITX
Maximum GPU Length		420mm
Maximum CPU Cooler Height		175mm
Maximum PSU Length		180mm
PCI Expansion Slots		8 + 2
Case Drive Bays		1 x 5.25", 6 x 3.5". 5 x 2.5"
Fan Mount Locations	Front	3 x 120mm / 2 x 140mm
	Top	3 x 120mm / 2 x 140mm
	Rear	1 x 120mm / 1 x 140mm
Fans Included	Front	3 x 120mm(with RGB LED effect)

	Rear	1 x 120mm(with RGB LED effect)
Radiator Mount Locations	Front	240mm / 280mm / 360mm
	Top	240mm / 280mm / 360mm
	Rear	120mm / 140mm
I/O Ports		1 x Headphone, 1 x Mic, 4 x USB 3.0
RGB Fan Controller	Channels	8 + 2
	Connectors	Fan: 8 x 6-Pin
		LED Strip: 2 x 4-Pin
		Power: 1 x 4-Molex Pin

RGB Fan Controller

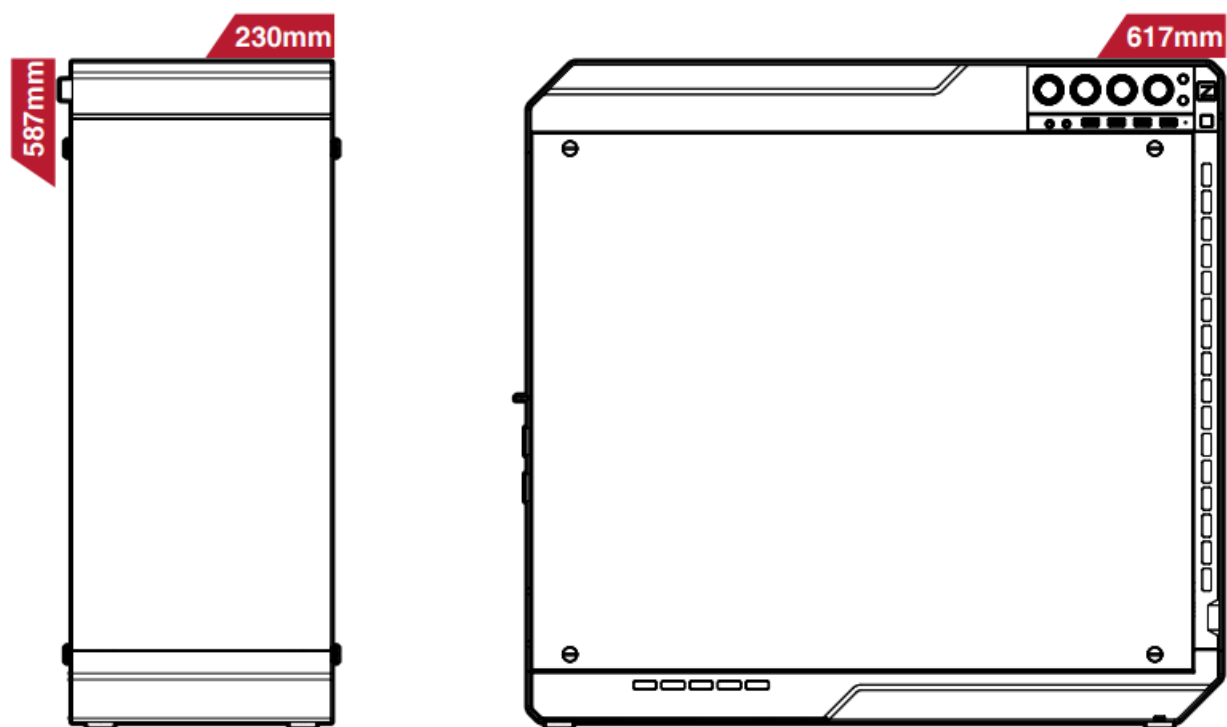

Accessories Component



Bolt A x 6



Bolt B x 8



Bolt C x 12



Bolt D x 18



Stand-off x 12



Hand screw x 12



Cable tie x 10



VGA guide x 2



Velcro tie x 8



Beep speaker x 1



ZM-MFC5
Quick guide x 1



Case
Quick guide x 1

Case construction

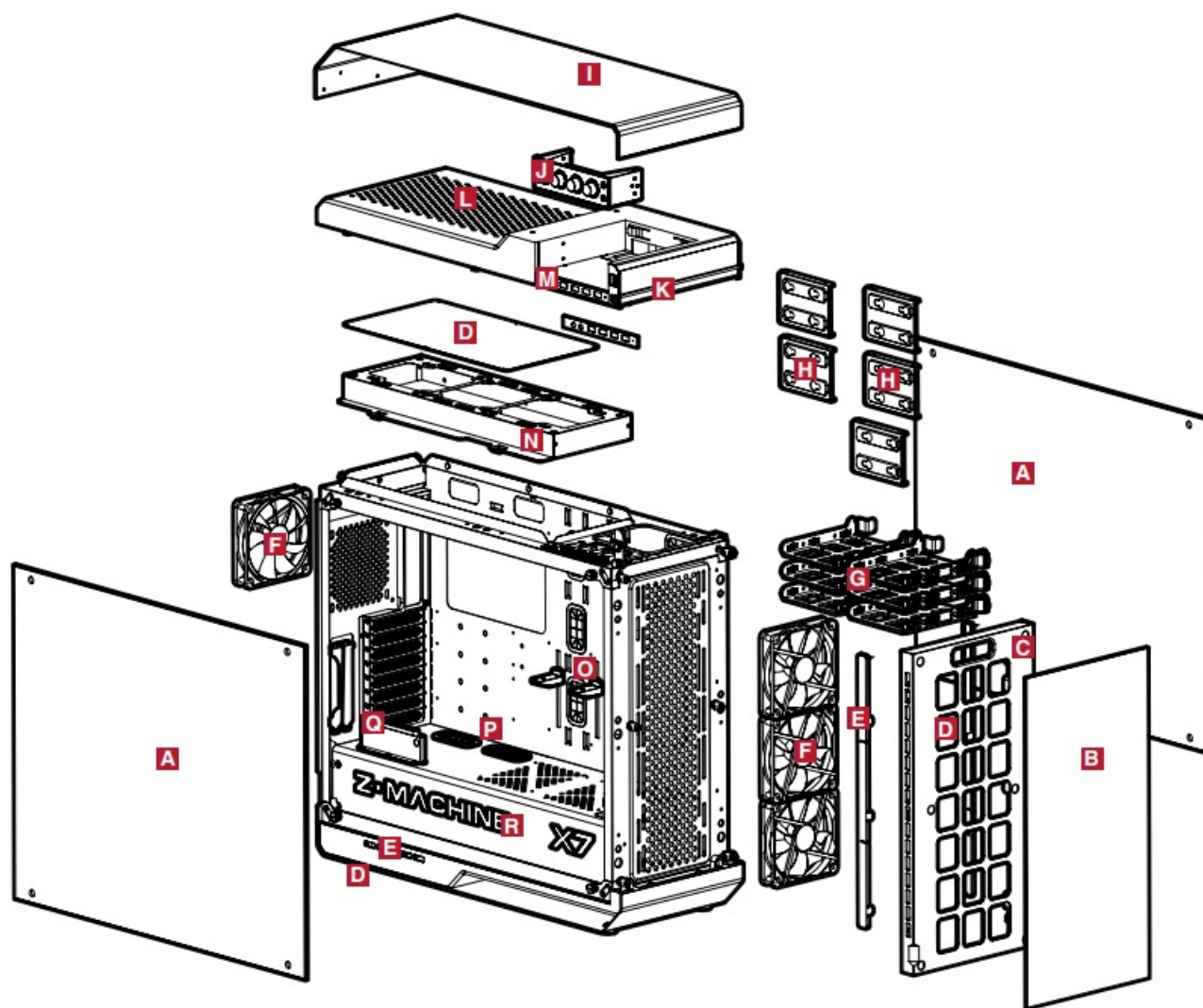

A Tempered glass	G .. Tool-free 2.5", 3.5" combo HDD cage	M Side I/O port
B Aluminum front panel	H2.5" SSD, HDD cage	N Radiator & Fan bracket
C Front bezel	I Aluminum top panel	O VGA guide
D Dust filter	J ZM-MFC5(RGB fan controller)	P Rubber cover
E Vent filter	K Front RGB display	Q VGA mounting guide
F ZM-F3 STR(120mm RGB fan)	L Top bezel	R Side RGB display

I/O Port

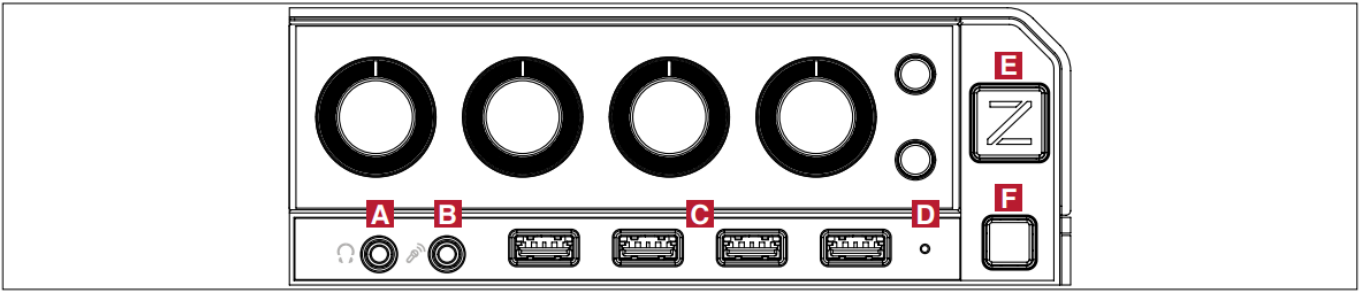

#	Part	#	Part	#	Part
A	Headphone	B	Mic	C	USB 3.0
D	HDD LED	E	Power button	F	Reset button

Separating the side panel

Loosen the side hand screw and separate the tempered glass panel.

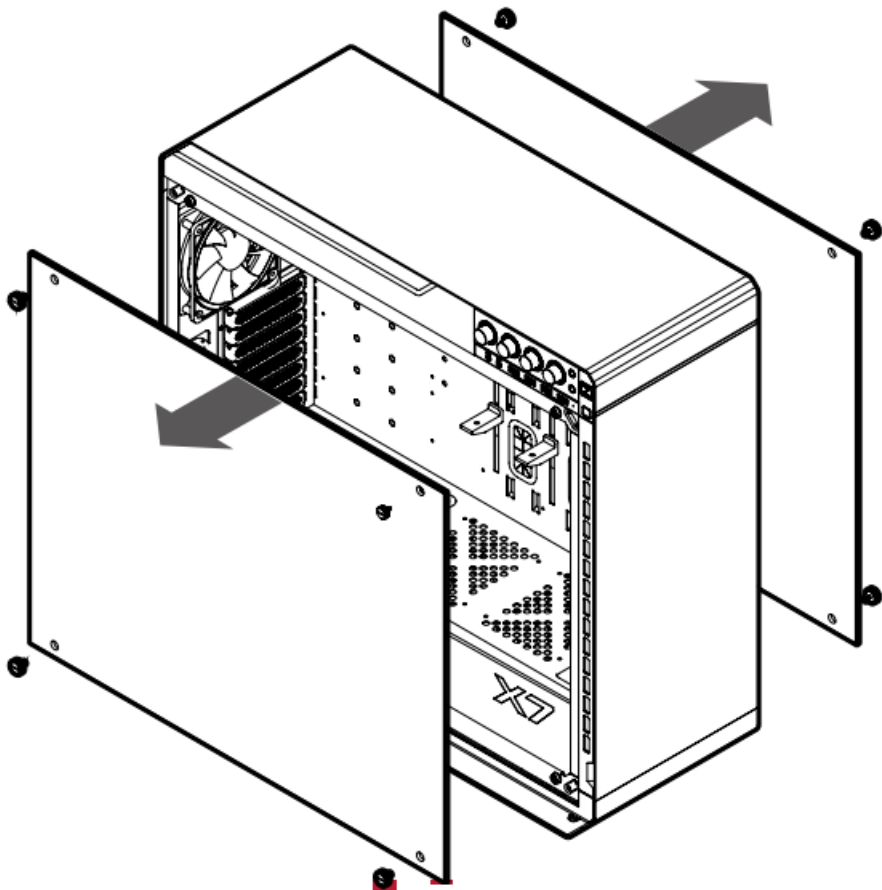

Mounting the main board

As 6 stand-offs are mounted by default, insert an additional standoff according to the type of main board by referring to the mounting position of the main board, and mount the main board on the case.

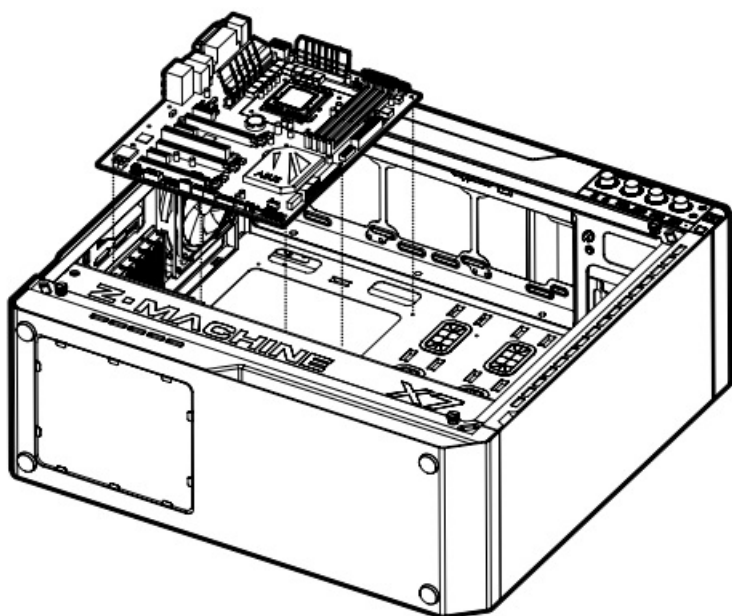

M-ITX

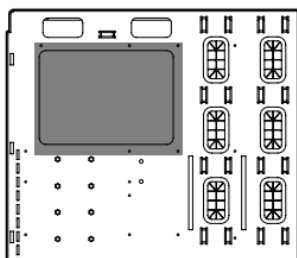

M-ATX

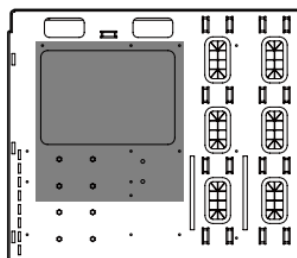

ATX

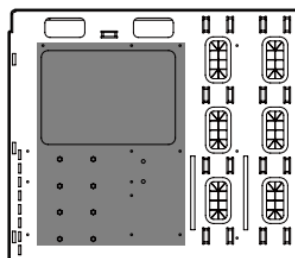

E-ATX

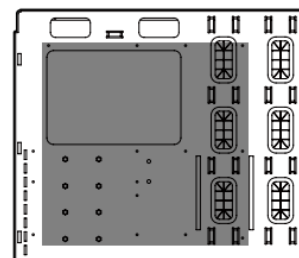

Mounting PSU

Fix the PSU on the PSU mounting hole located at the bottom of the case using the screw.

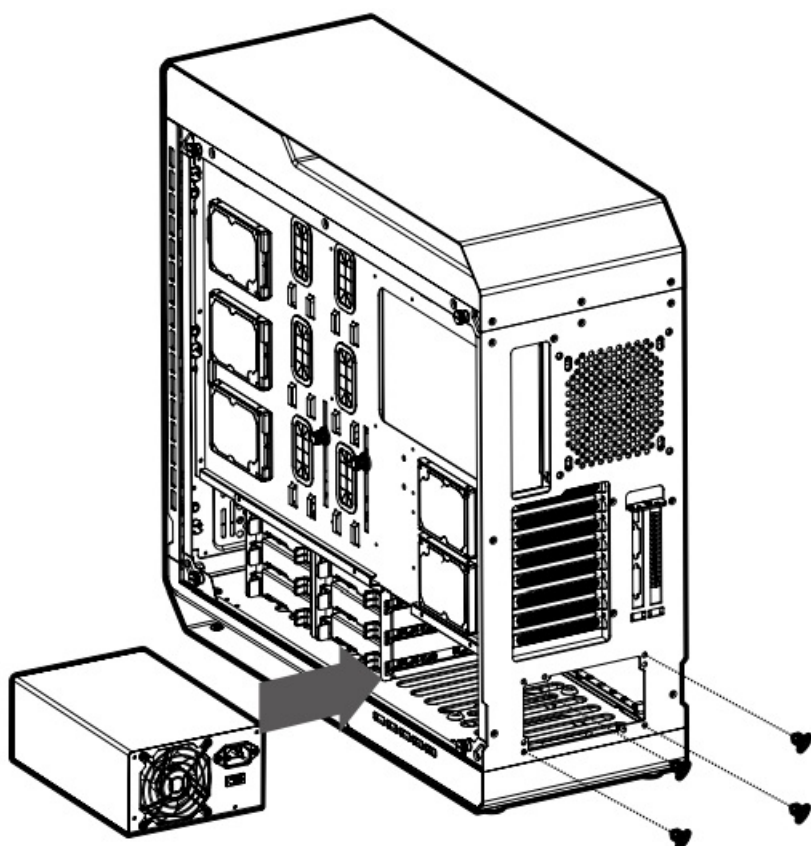

Mounting PCI-E(VGA) card

Loosen the screw, separate the PCI cover, mount the graphic card, and fix it using the screw.

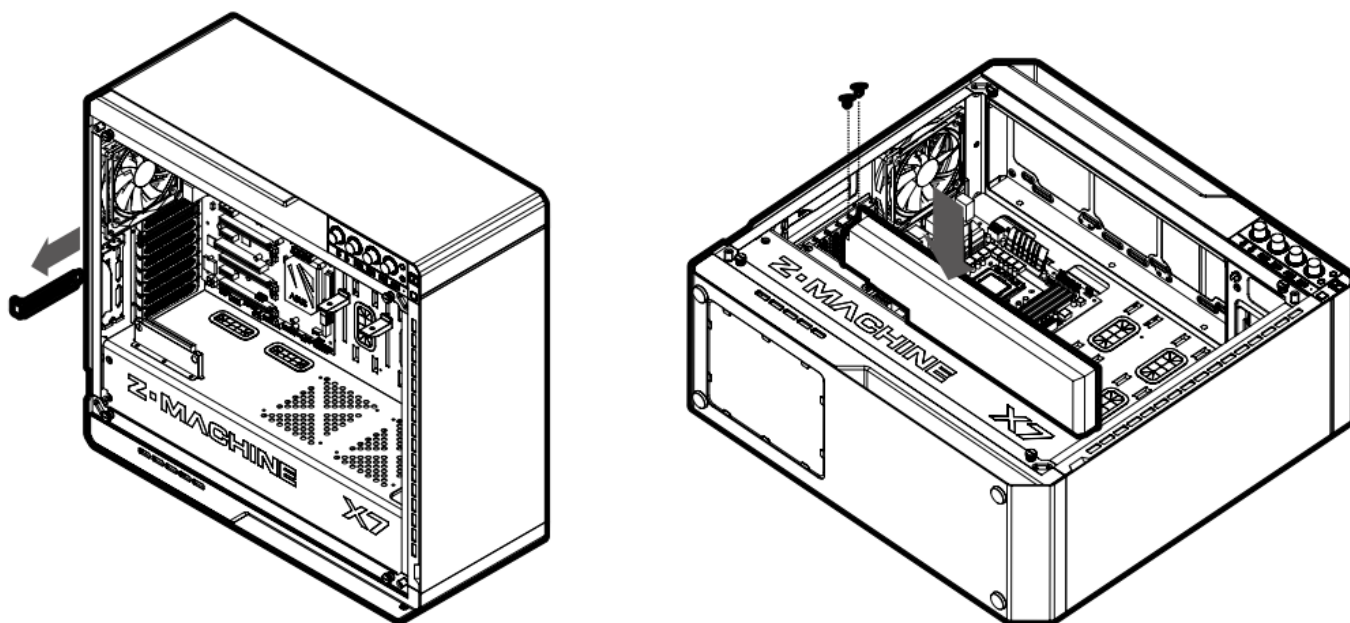

Mounting the riser card

Fix the riser card on the riser card-mounting hole using the screw, and mount the graphic card on the relevant position.

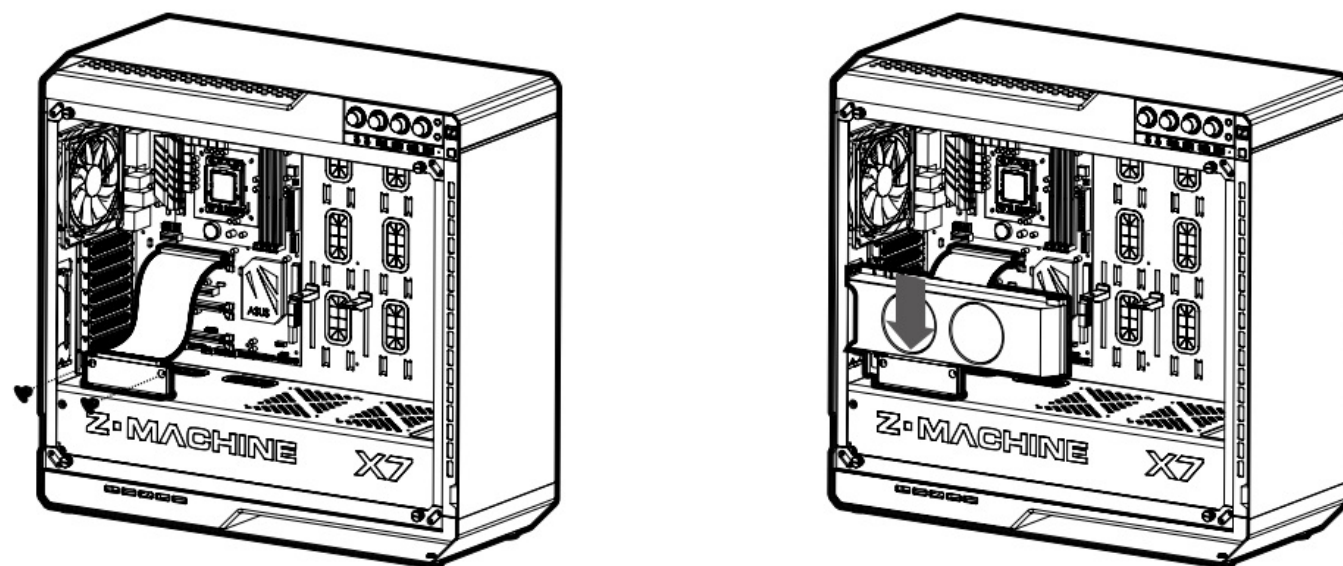

Mounting 5.25" device

Insert the 5.25" device into the side 5.25" bay until it is latched. (For a product where the fan controller is mounted, installation is possible only after separating the product and the fan. Separate the panel at the top, loosen the screw from the bottom of the fan controller, and separate it.)

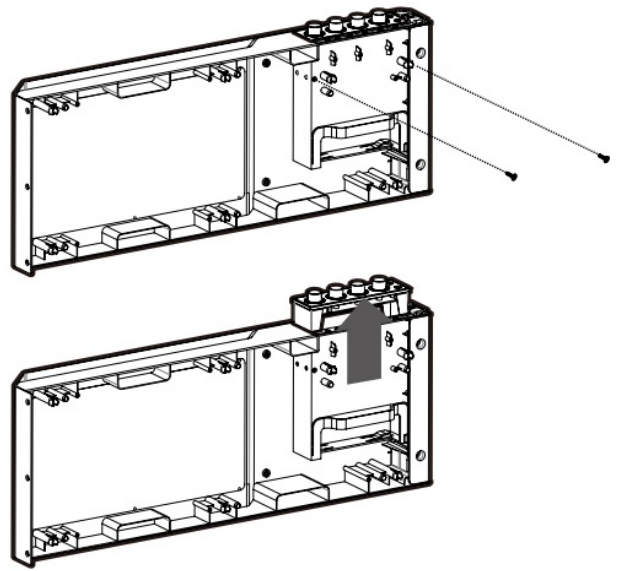
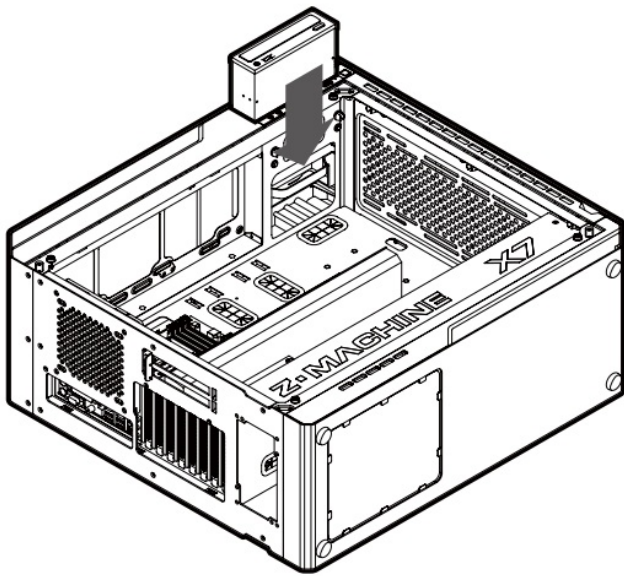

Mounting 2.5" SSD and HDD

Separate the 2.5" SSD and HDD cage on the side of the case by pushing it to the right and assemble the 2.5" SSD or HDD. Mount the assembled SSD on the cage-mounting hole by pushing it to the left.

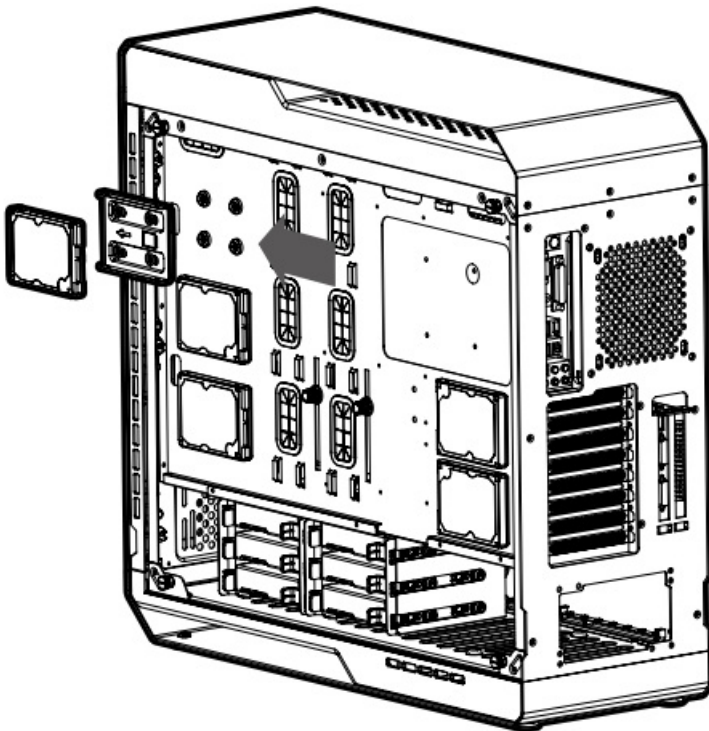

Mounting the 3.5" and 2.5" HDD

Separate the tool-free 2.5" and 3.5" combo HDD cage and assemble the HDD or SSD. Mount the assembled HDD on the slot.

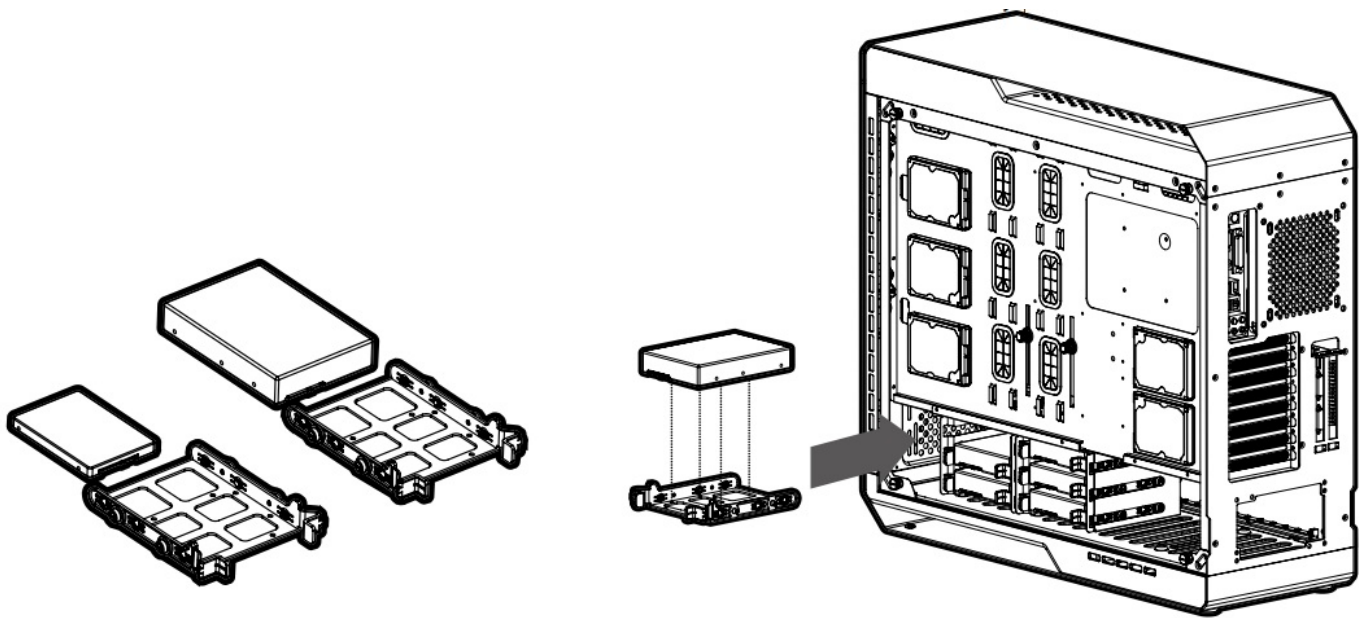

Cable Connection

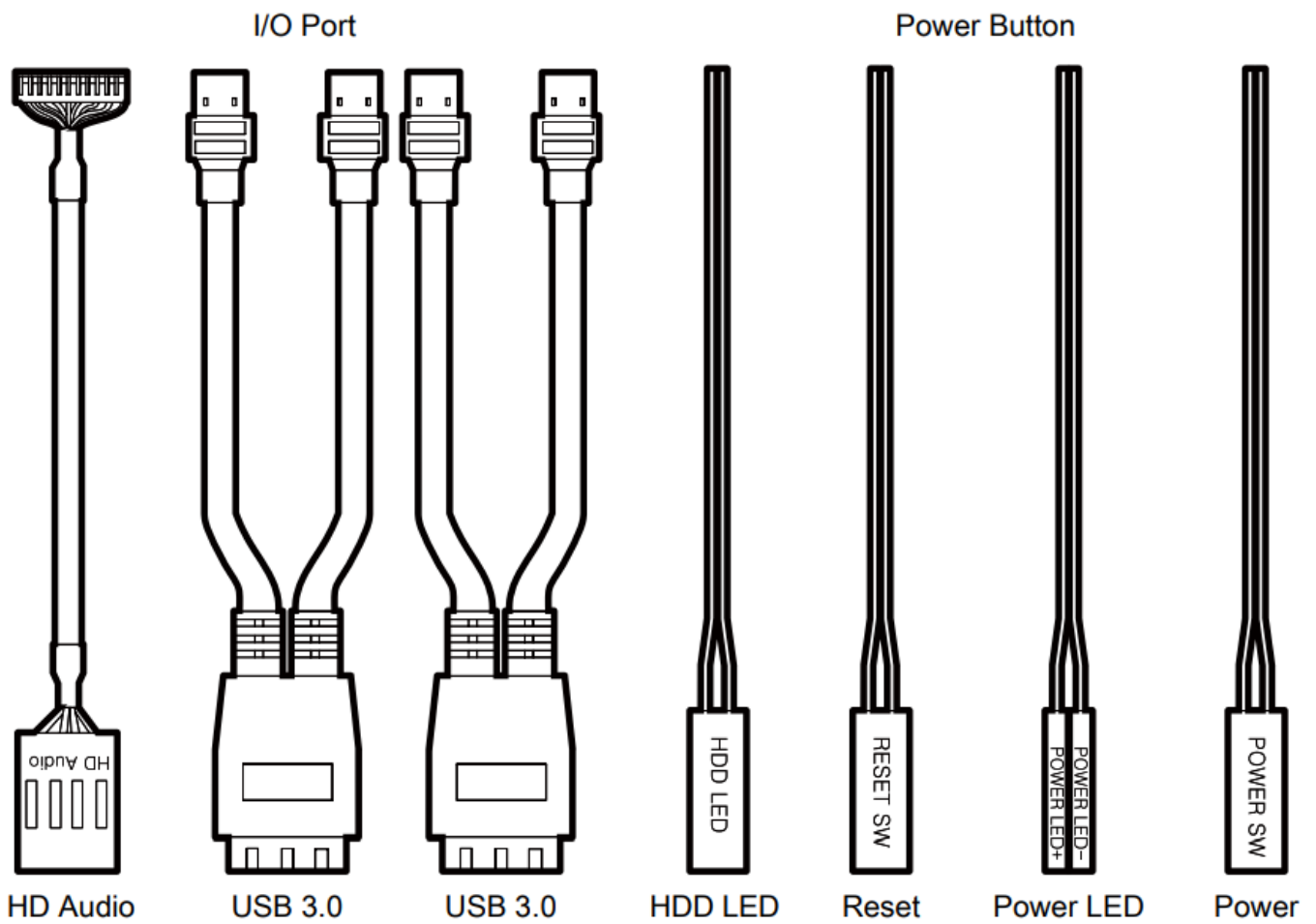

Separating the top panel

Loosen the screw at the back and separate the top panel.

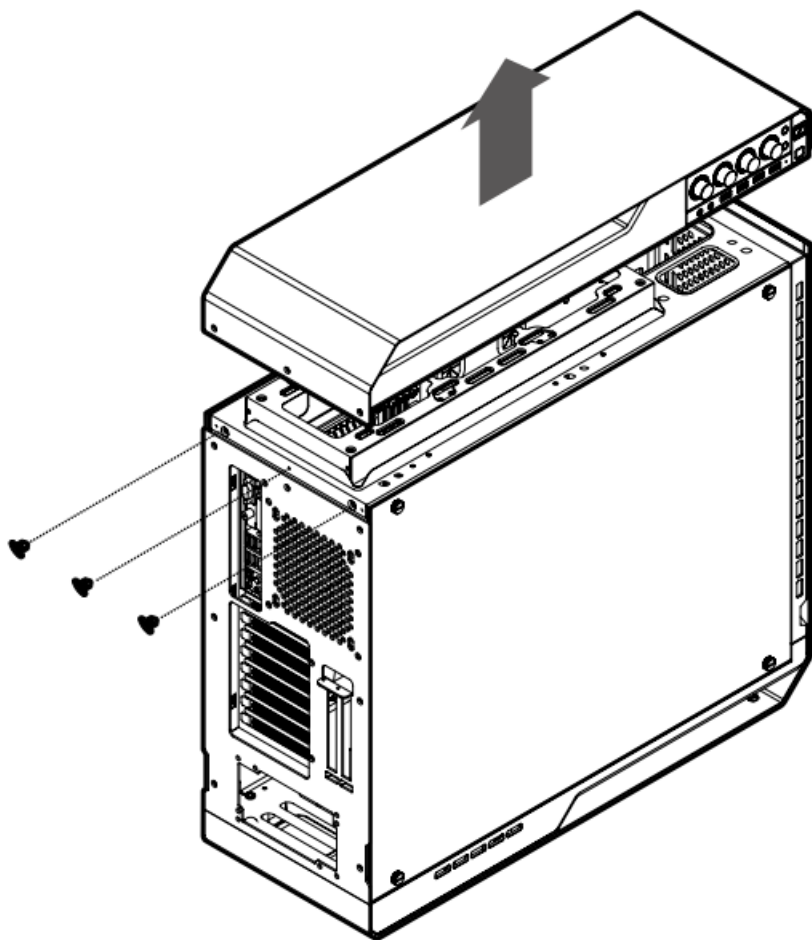

Mounting the top fan and radiator

Separate the radiator and fan bracket by loosening the fixed hand screw and assemble the radiator or the fan. Fix the assembled radiator and fan bracket on the top bracket-mounting hole using the hand screw.

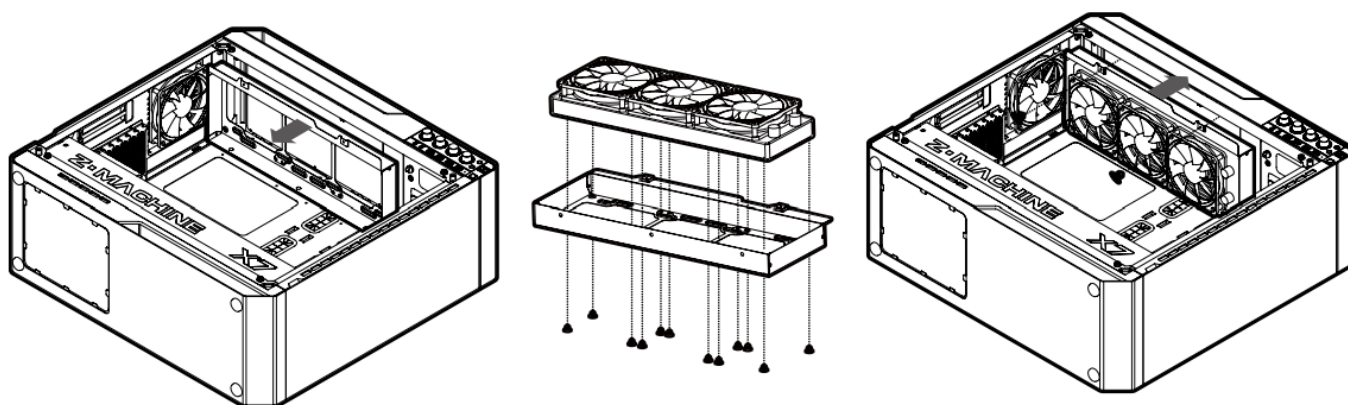

Separating the front panel

Hold the groove at the bottom front and separate the panel.

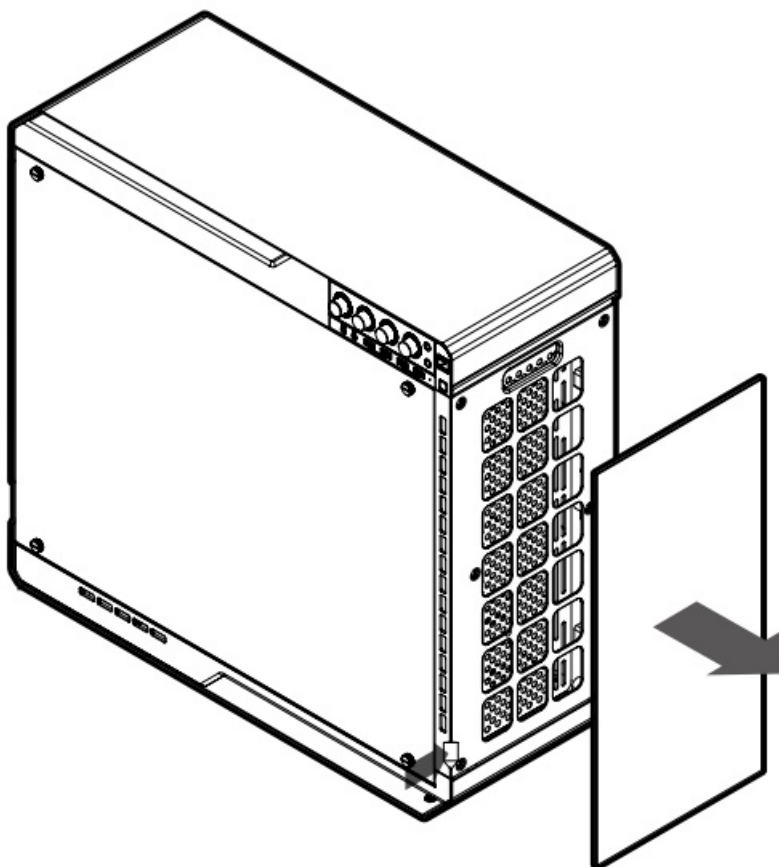

Separating the front bezel

Separate the bezel by pulling it in the direction of the arrow as shown in the figure.

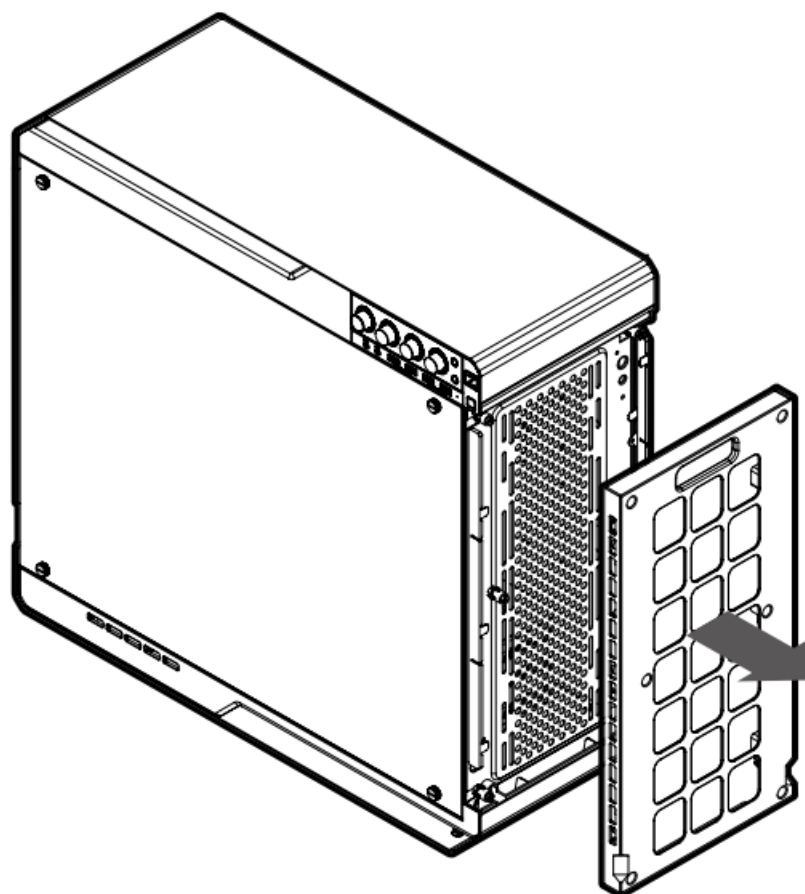

Mounting the fan and radiator in the front

Mount the fan or the radiator on the mount hole in the front as shown in the figure.

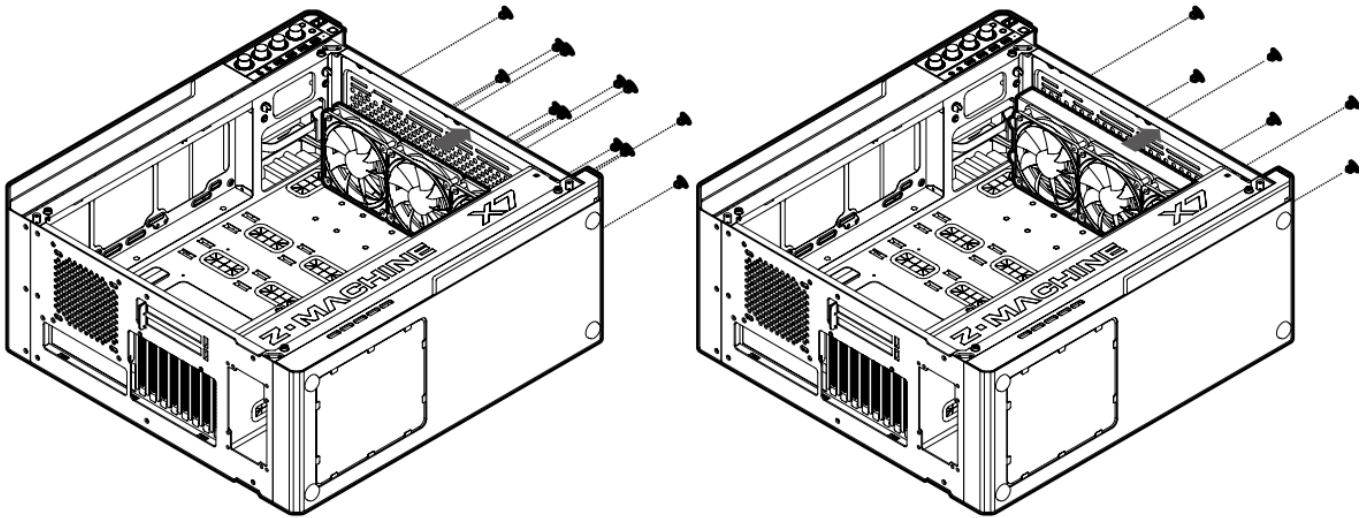

Mounting the custom water cooler

You can clamp the water bottle to the custom water cooler mounting hole as shown in the figure.

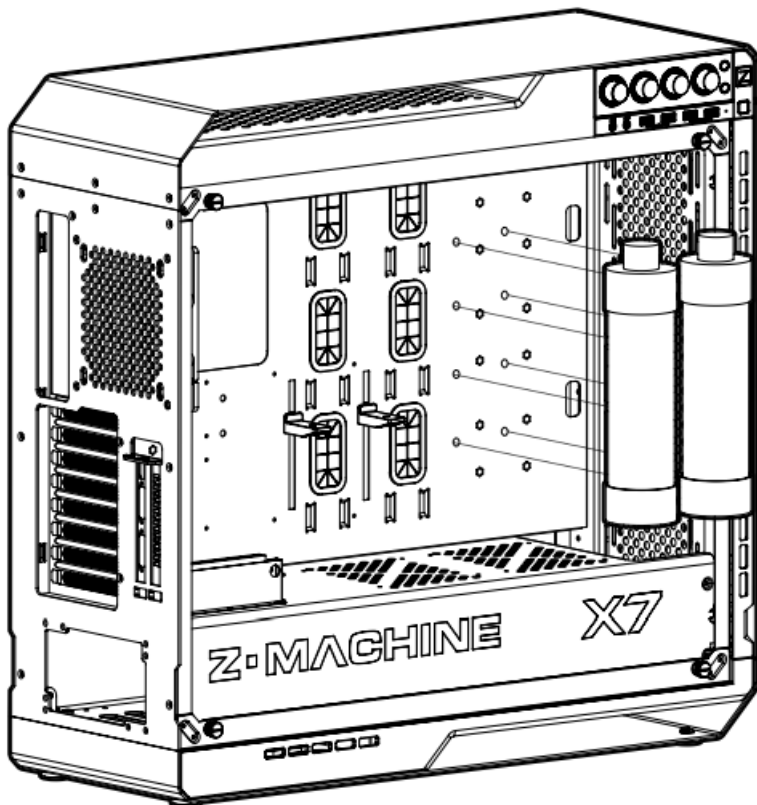

Warranty

Zalman Tech products come with the following limited warranties:

1 Year Warranty

CPU coolers (All CNPS series, Reserator 3 Max series), computer cases, keyboards, mice, laptop coolers, case

fans, hardware enclosures (including VE series), audio devices, and all other accessories not specified below.

3 Year Warranty

GVM Series Power Supply Units

7 Year Warranty

ARX, EBT series Power Supply Units

Zalman USA has the right to change availability of limited warranty at its own discretion and any changes will not be retroactive.

The limited warranty does not cover...

1. Non-Zalman brand products and accessories.
2. Problems resulted from external causes such as accident, abuse, misuse, and/or problems with electrical power.
3. Any service not authorized by Zalman USA.
4. Usage that is not in accordance with product instructions.
5. Failure to follow the product instructions and/or failure to perform preventive maintenance.
6. Problems caused by using accessories, parts, and/or components not supplied by Zalman.
7. Products with missing, altered Service Tags and/or serial numbers.

For United States and Canada

Technical support and warranty related inquiries: support.usa@zalmanusa.com

Toll free customer service: 1-888-925-6266

For all other regions

Send e-mail to techsupport@zalman.co.kr

For detailed warranty information, please visit www.zalman.com.

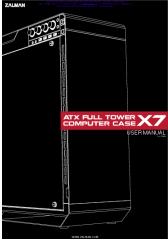

Documents / Resources

	<p>ZALMAN X7 ATX Full Tower Computer Case [pdf] User Manual X7, ATX Full Tower Computer Case, X7 ATX Full Tower Computer Case</p>
---	---

References

- ZALMAN.COM
- ANDPRO.RU - интернет магазин компьютерной и офисной техники с выгодными ценами и доставкой

