



ZALMAN N5 TF ATX Mid Tower Computer Case User Manual

[Home](#) » [ZALMAN](#) » ZALMAN N5 TF ATX Mid Tower Computer Case User Manual 

ZALMAN N5 TF ATX Mid Tower Computer Case



Contents

- 1 Precautions
- 2 Specifications
- 3 Accessories
- 4 I/O Ports
- 5 Removing the side panels
- 6 Removing the front panel
- 7 Mounting the motherboard
 - 7.1 Motherboard size
- 8 Mounting the PSU
- 9 Mounting the PCI-E(VGA) card
- 10 Mounting the 3.5" and 2.5" SSD / HDD
- 11 Mounting the 2.5" SSD / HDD
- 12 Mounting the fans
- 13 Fan(s) Included
- 14 Fan Controller
- 15 I/O Connectors
- 16 Documents / Resources
 - 16.1 References
- 17 Related Posts

Precautions

- Read this manual carefully before installing.
- Check the product and components before installing. If you find any abnormality, contact the location where you purchased the product for a replacement or refund.
- Wear gloves to prevent accidents when installing the product.
- Severe damage may occur when mounting the system, so do not apply excessive force.
- Connecting the cable incorrectly may cause a fire due to a short circuit. Make sure to refer to the manual when connecting the cable.
- Be careful not to block the ventilation hole of the product when using the system.
- Avoid locations with direct sunlight, water, moisture, oil, and excessive dust.
- Store and use the product in a well-ventilated location.
- Do not wipe the surface of the product using chemicals. (organic solvents such as alcohol or acetone)
- Do not insert your hand or other object into the product during operation, as this may injure your hand or damage the object.
- Store and use the product out of children's reach.
- Our company assumes no responsibility for any problem that occurs due to the use of the product for purposes other than its designated purposes and/or the carelessness of the consumer.
- The exterior design and specifications of the product are subject to change without prior notice to consumers for quality improvement.

Specifications

Model		N5 TF
Case Form Factor		ATX Mid-Tower
Dimensions		432(D) x 200(W) x 450(H)mm
Weight		3.8kg
Case Materials		Plastic, Steel, Tempered Glass
Motherboard Support		ATX / mATX / Mini-ITX
Maximum VGA Length		365mm
Maximum CPU Cooler Height		158mm
Maximum PSU Length		160mm
PCI Expansion Slots		7
Drive Bays		2 x Combo(3.5" or 2.5"), 4 x 2.5" SSD
Fan Support	Top	3 x 120mm
	Front	3 x 120mm
	Rear	1 x 120mm
	Bottom	2 x 120mm
Fan(s) Included	Front	3 x 120mm (with Spectrum RGB LED Effect)
	Rear	1 x 120mm (with Spectrum RGB LED Effect)
Radiator Support	Front	120mm / 240mm / 360mm
	Rear	120mm
I/O Ports		1 x Headphone, 1 x Mic, 2 x USB 2.0, 1 x USB 3.0, Reset Button, Power Button, Fan Controller(Change Fan Speed & LED Brightness), LED Controller(Change LED Pattern)

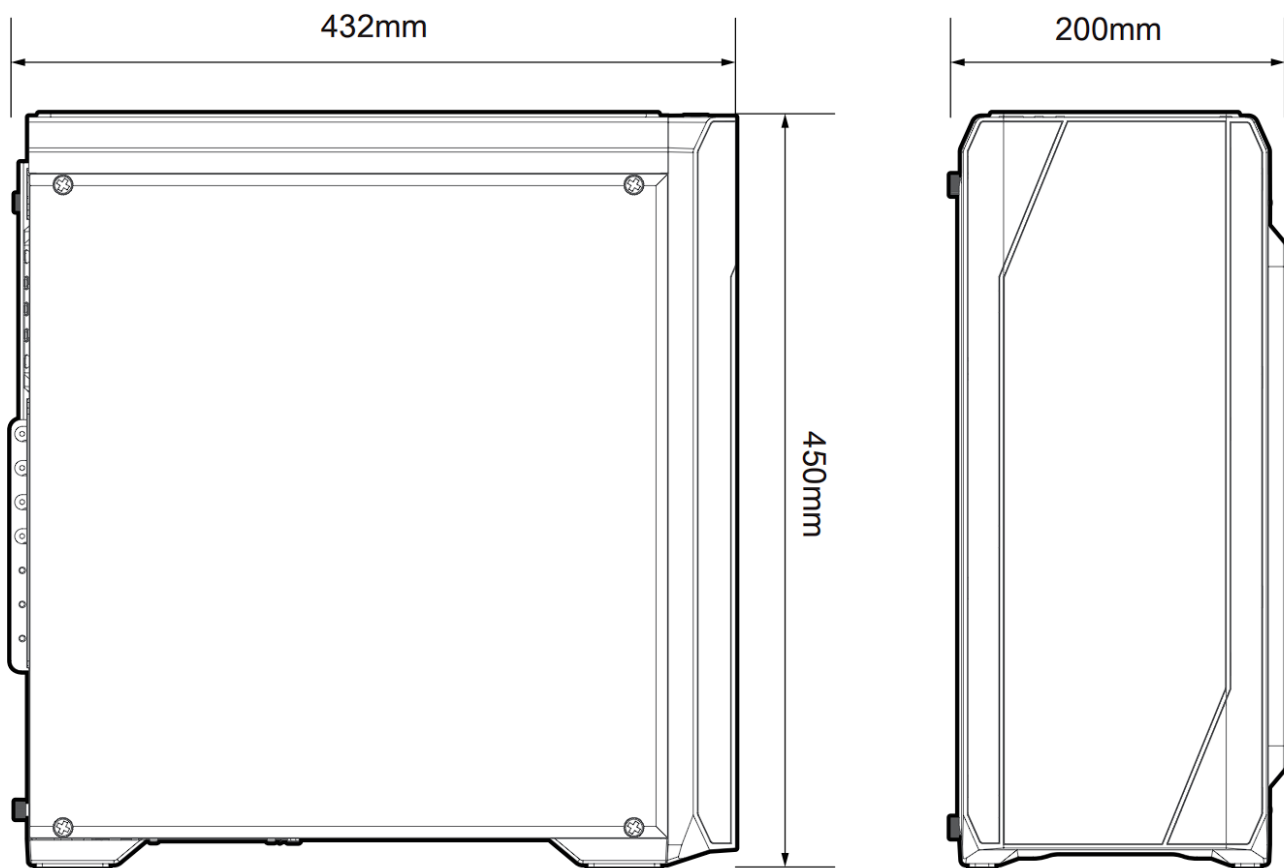

Accessories

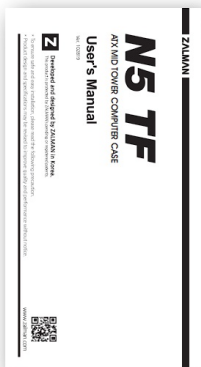

User's
Manual

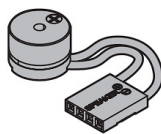

Buzzer



Cable
Ties x 5



Thumm
Screws x 2



SSD / MB
Screws x 20



PSU / HDD / VGA
Screws x 8



Motherboard
Standoffs x 3

I/O Ports

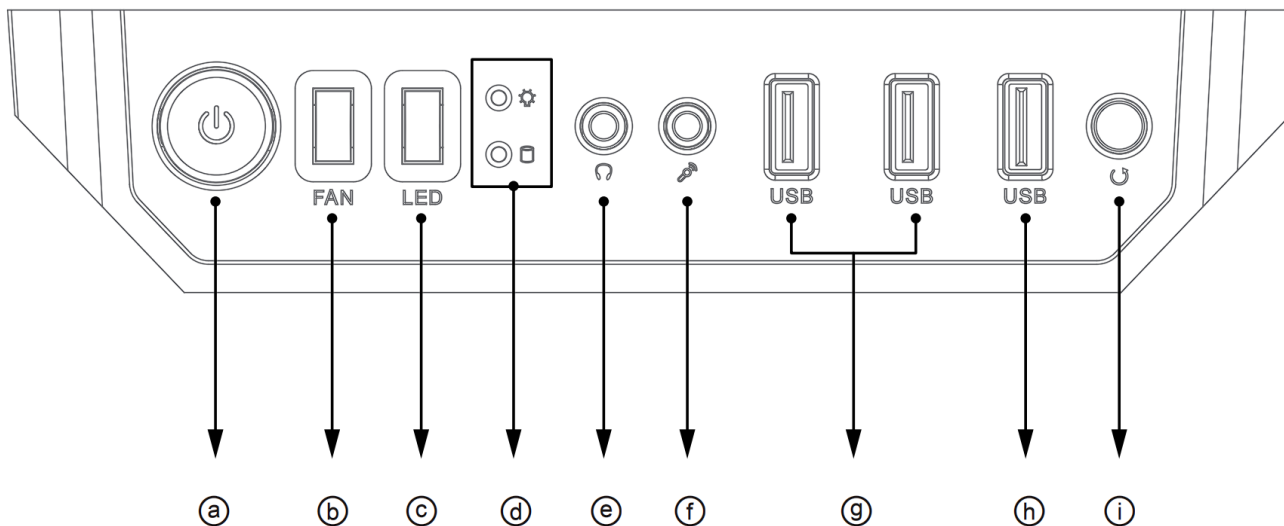

#	Part	#	Part	#	Part	#	Part	#	Part
a	Power Button	b	Fan Controller	c	LED Controller	d	HDD / Power LED	e	Headphone Jack
f	Microphone Jack	g	USB 2.0 Ports	h	USB 3.0 Port	i	Reset Button		

Removing the side panels

1. Tempered Glass

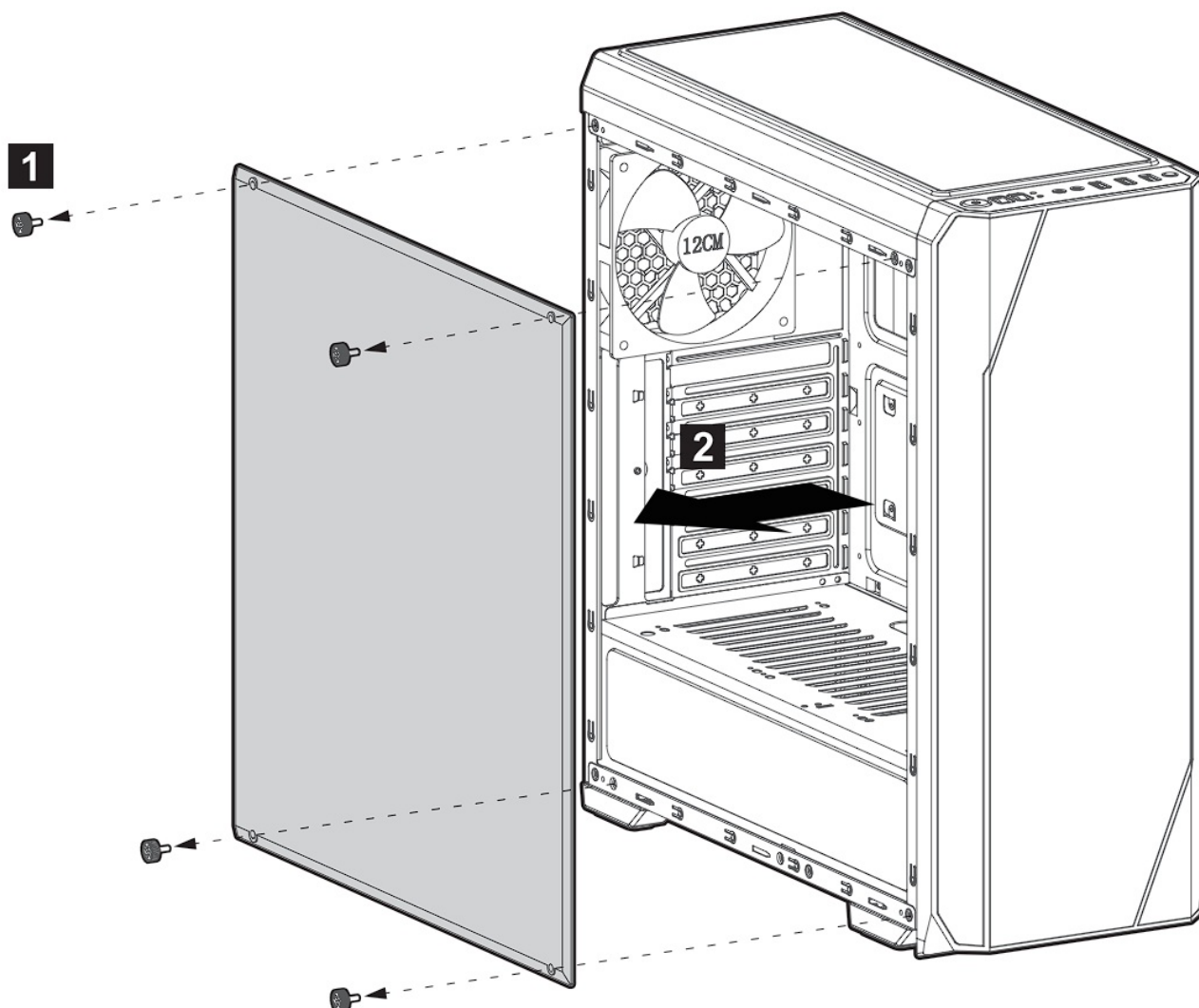

2. Steel Panel

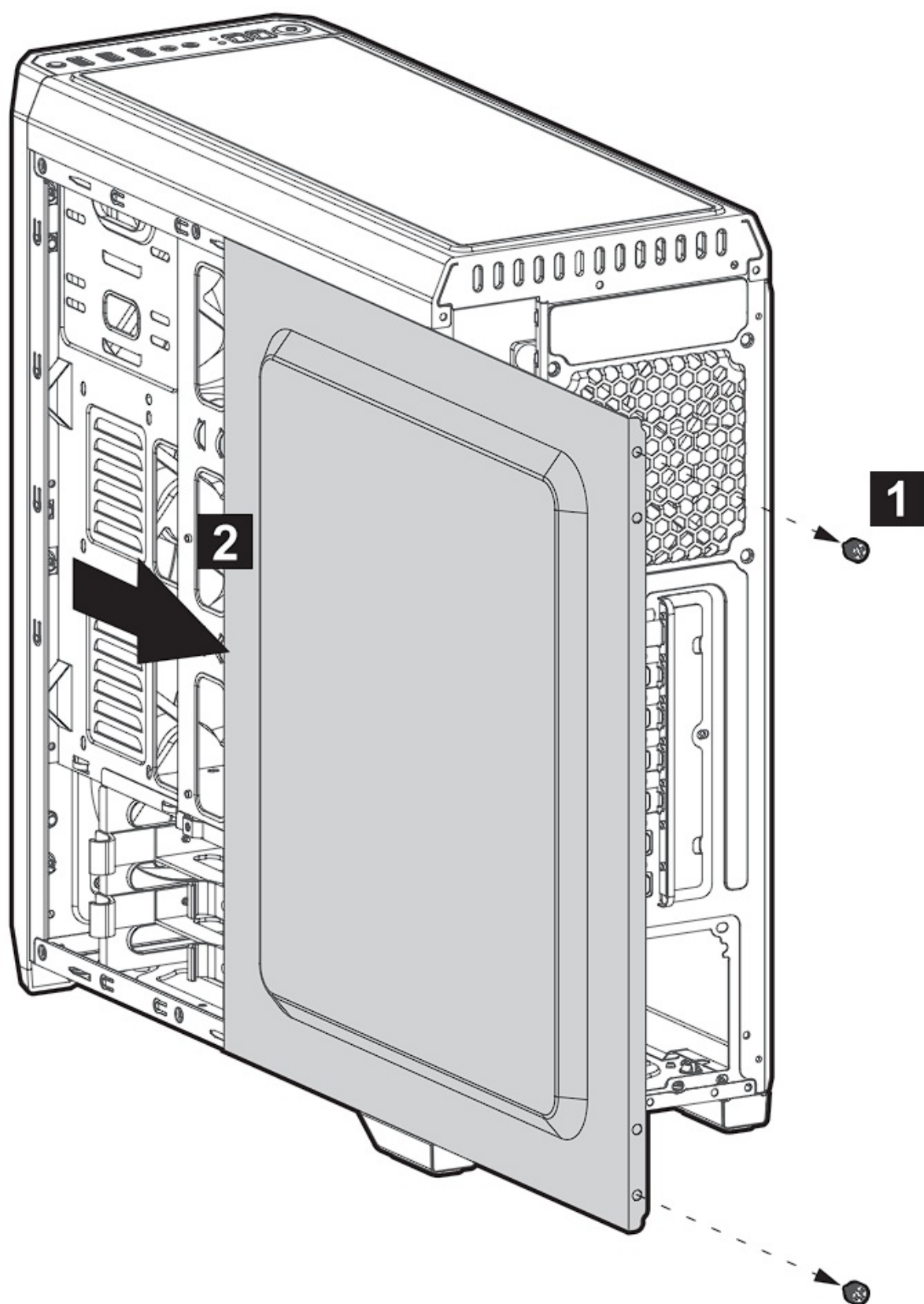

Removing the front panel

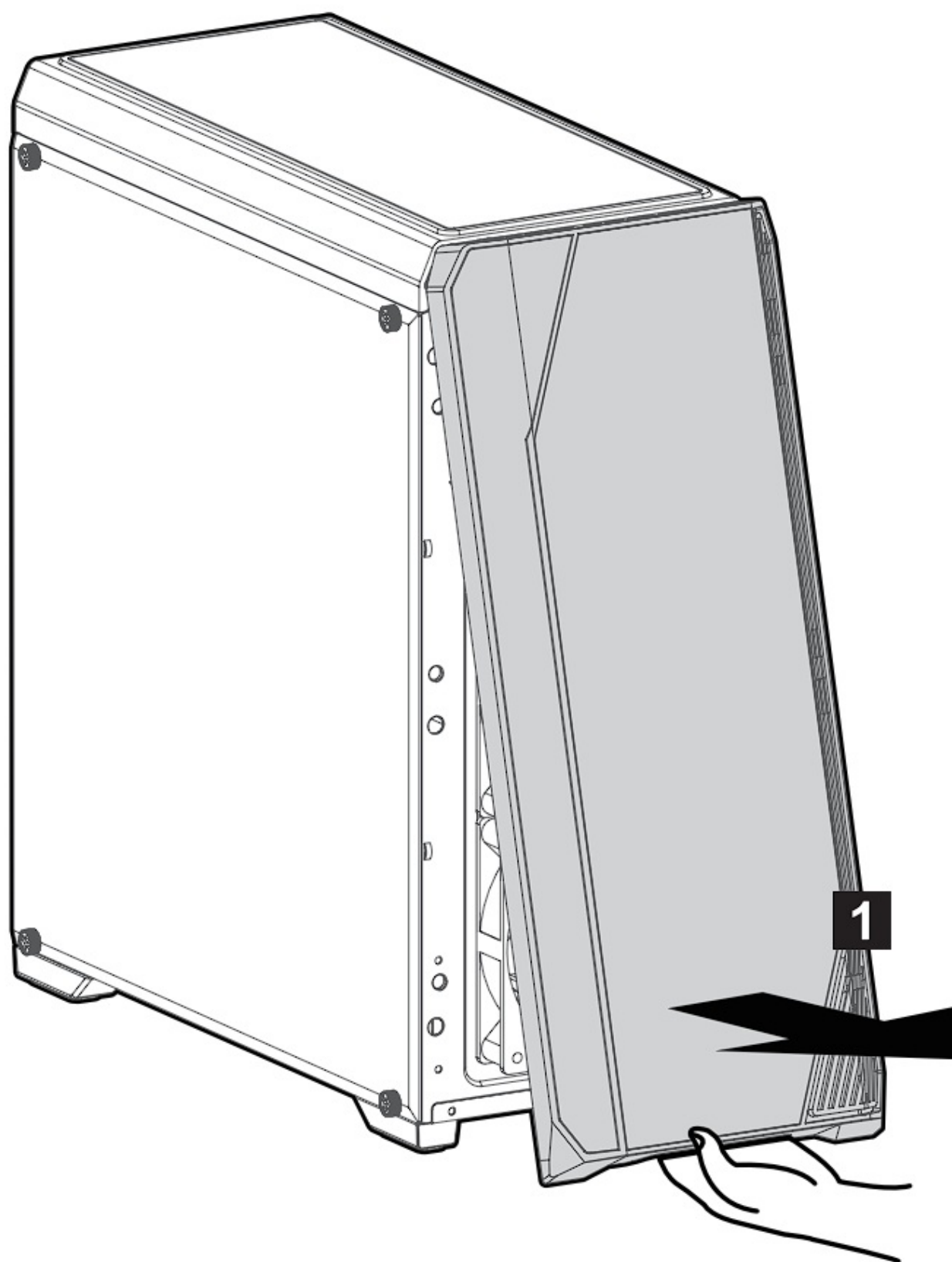

Mounting the motherboard



Motherboard Standoffs

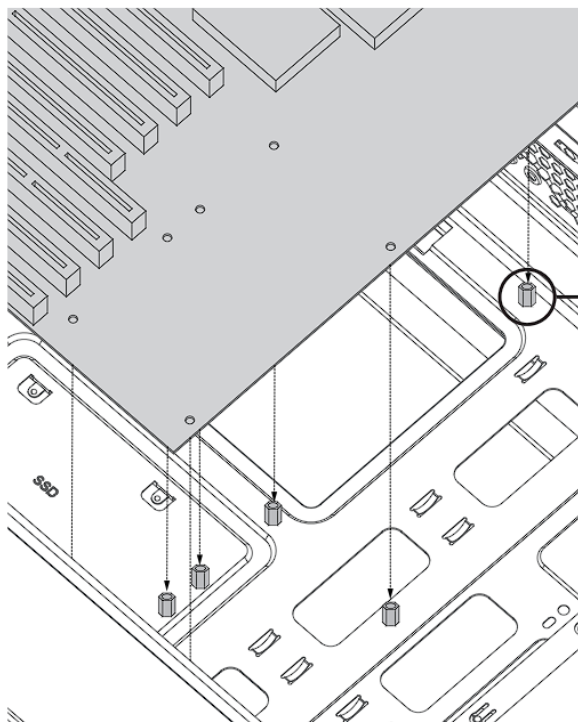

SSD / MB Screws

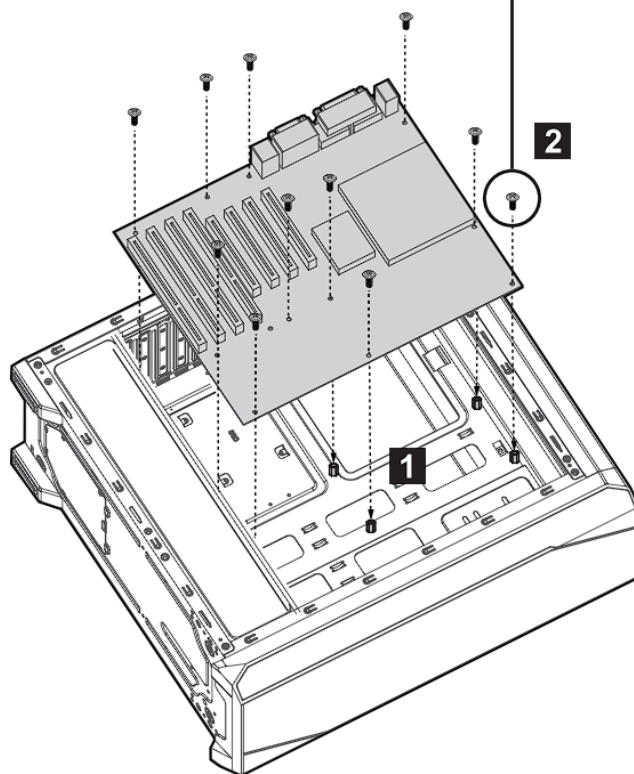

Motherboard size

※ Pick out the 8-Pin auxiliary power cable(CPU power connector) through the groove on top before installing motherboard.

1. ATX

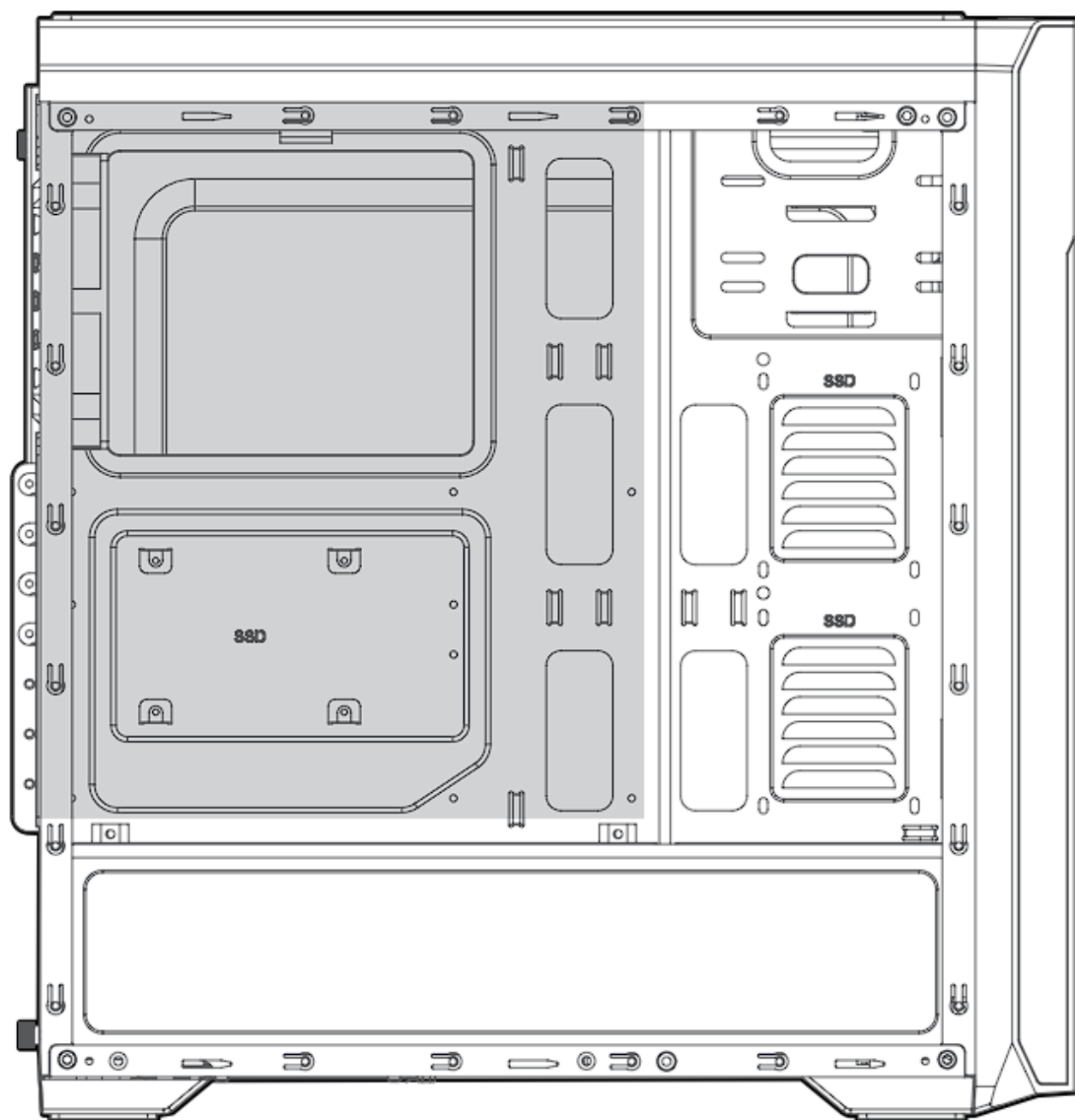

2. mATX

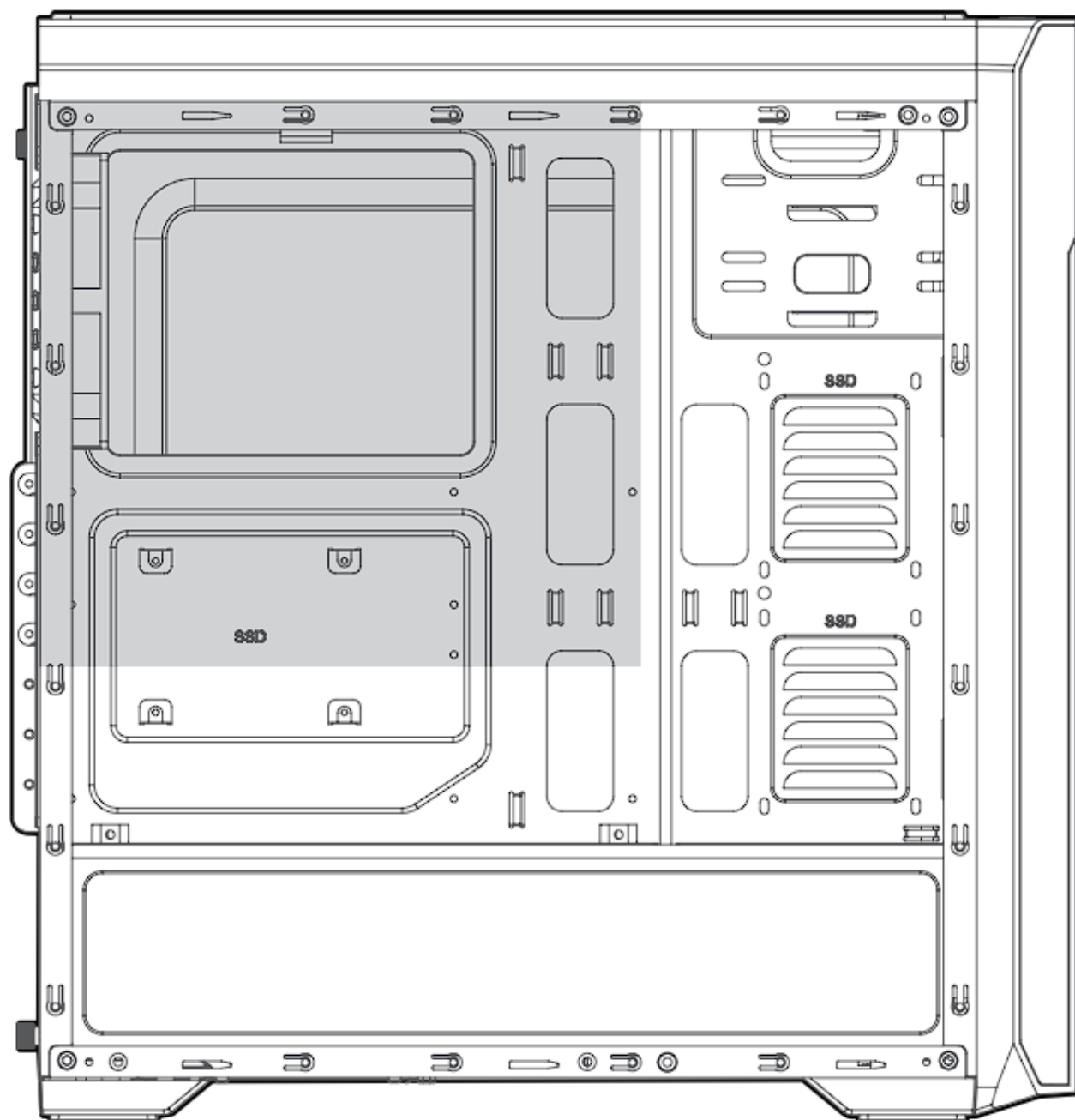

3. Mini-ITX

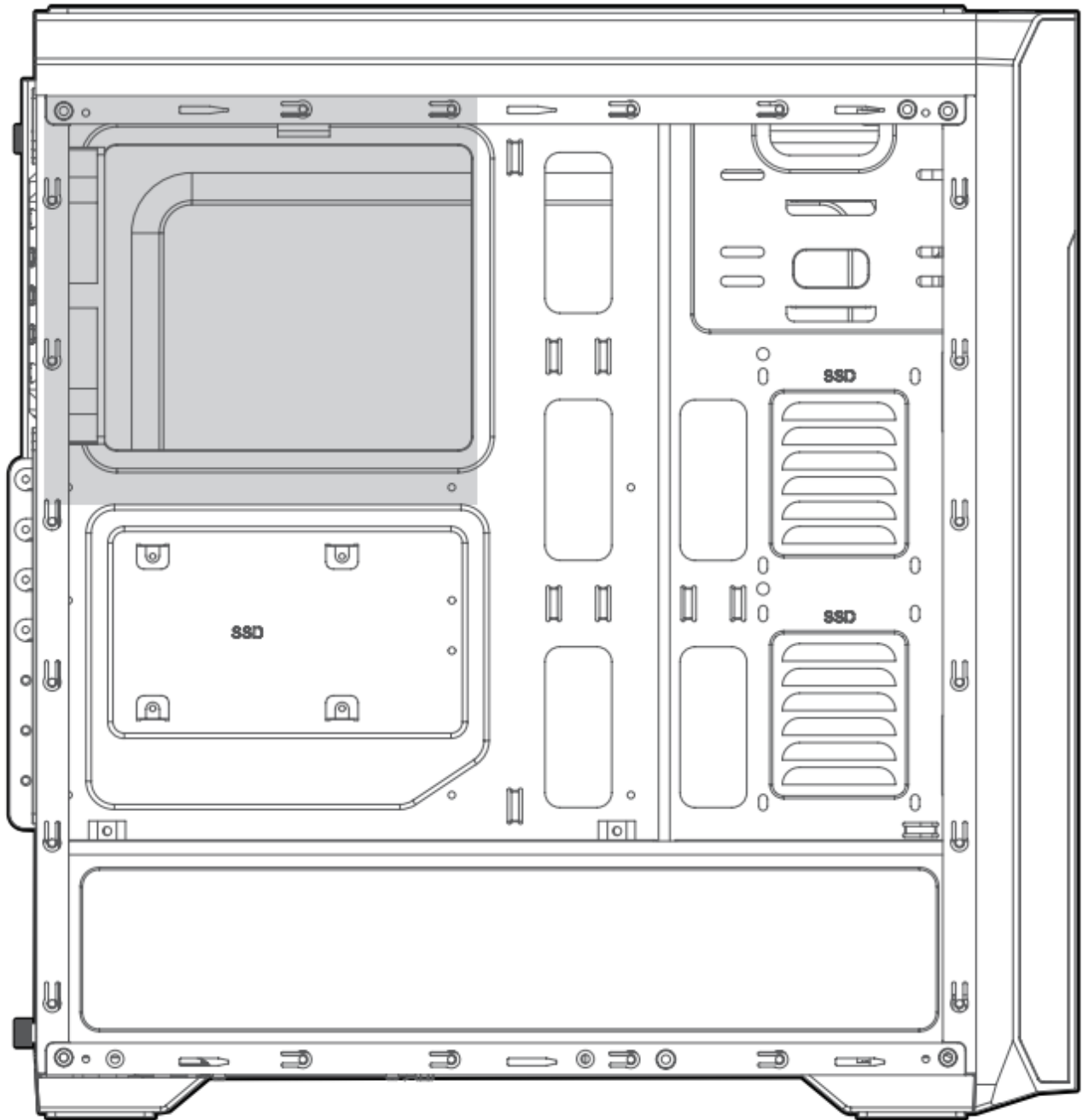

Mounting the PSU

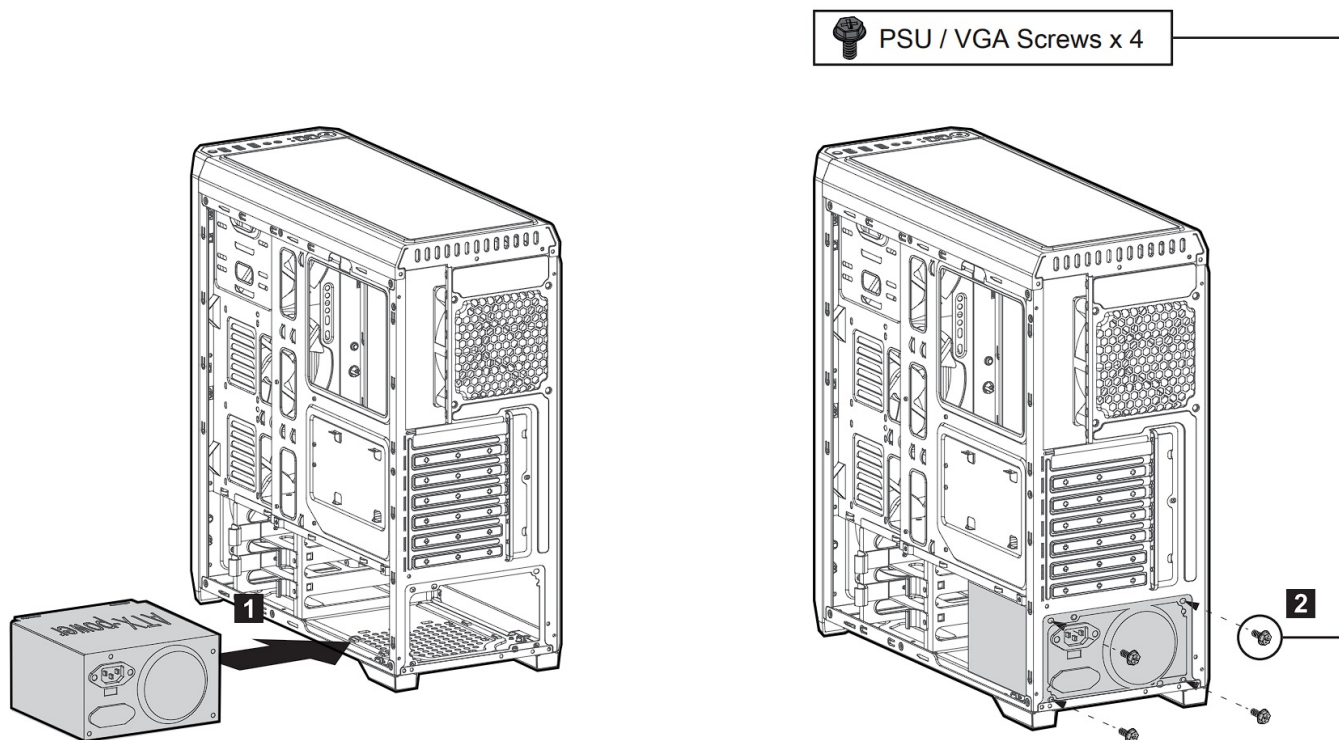

Mounting the PCI-E(VGA) card

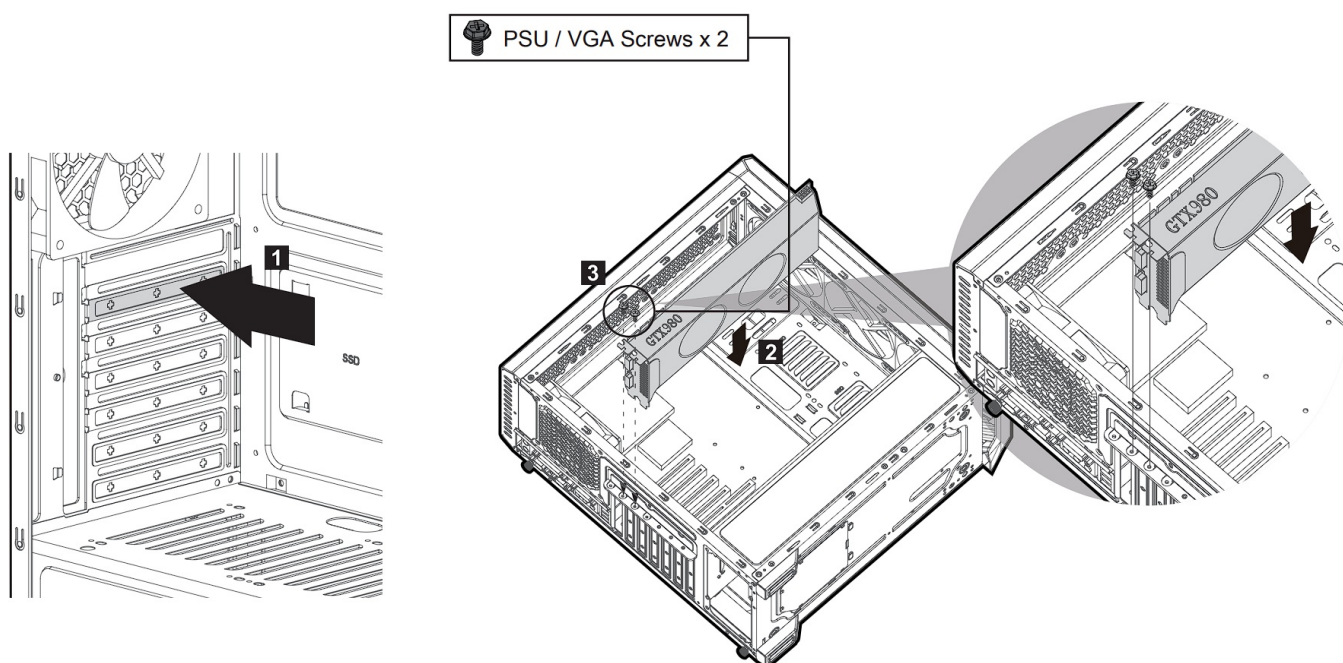

Mounting the 3.5" and 2.5" SSD / HDD

1. HDD

HDD Screws

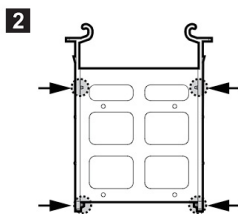
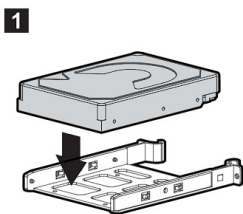

2. SSD

SSD / MB Screws

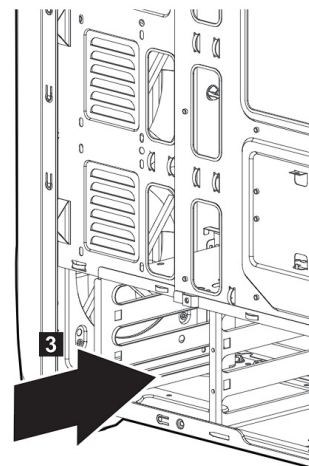
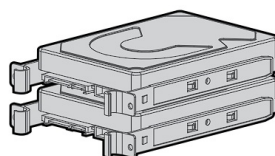
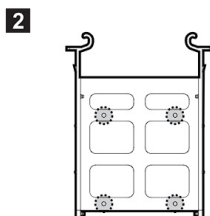
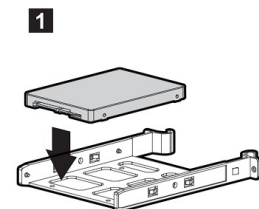

Mounting the 2.5" SSD / HDD

1 SSD / MB Screws x 8

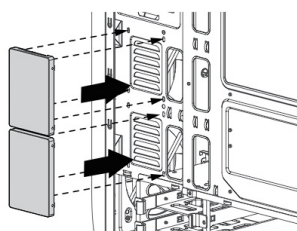

1 SSD / MB Screws x 4

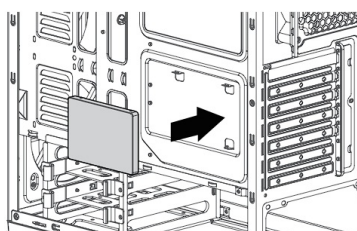

1 SSD / MB Screws x 4

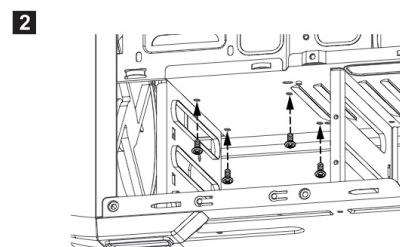
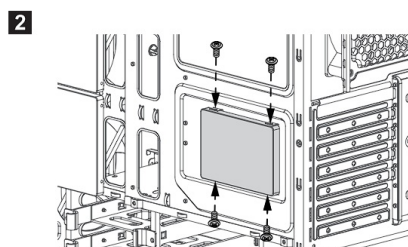
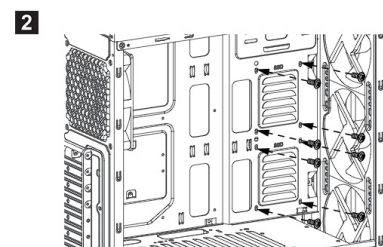
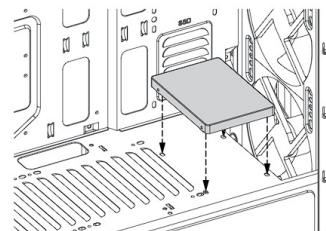

Mounting the fans

1. Mounting the top fans
2. Mounting the bottom fans

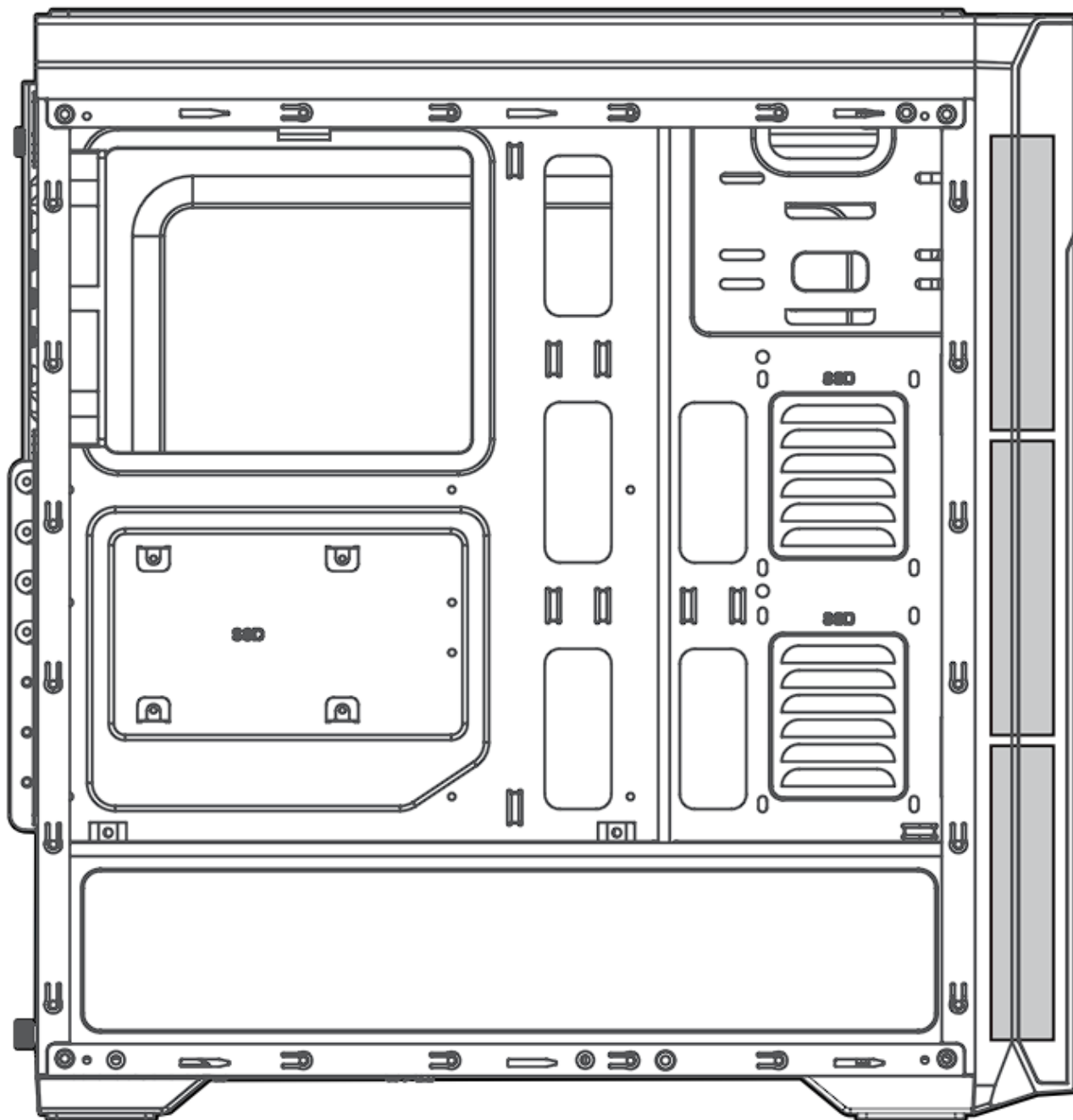

Fan(s) Included

1. Front : 3 x 120mm Fan
– with Spectrum RGB LED Effects
2. Rear : 1 x 120mm Fan
– with Spectrum RGB LED Effects

Fan Controller

LED Control

Press : Change LED Pattern
Press Hold 5 seconds : LED Off

3 Control Modes of Fan speed & LED brightness

Mode	Fan Speed	LED Brightness
Mode 1.	High	High
Mode 2.	Low	Low
Mode 3.	Off	Off

※ LED Patterns can be changed even if the fan is not working. (Push “LED” Button)
※ Caution: shutting off your system fans could cause increase of system temperature.

I/O Connectors

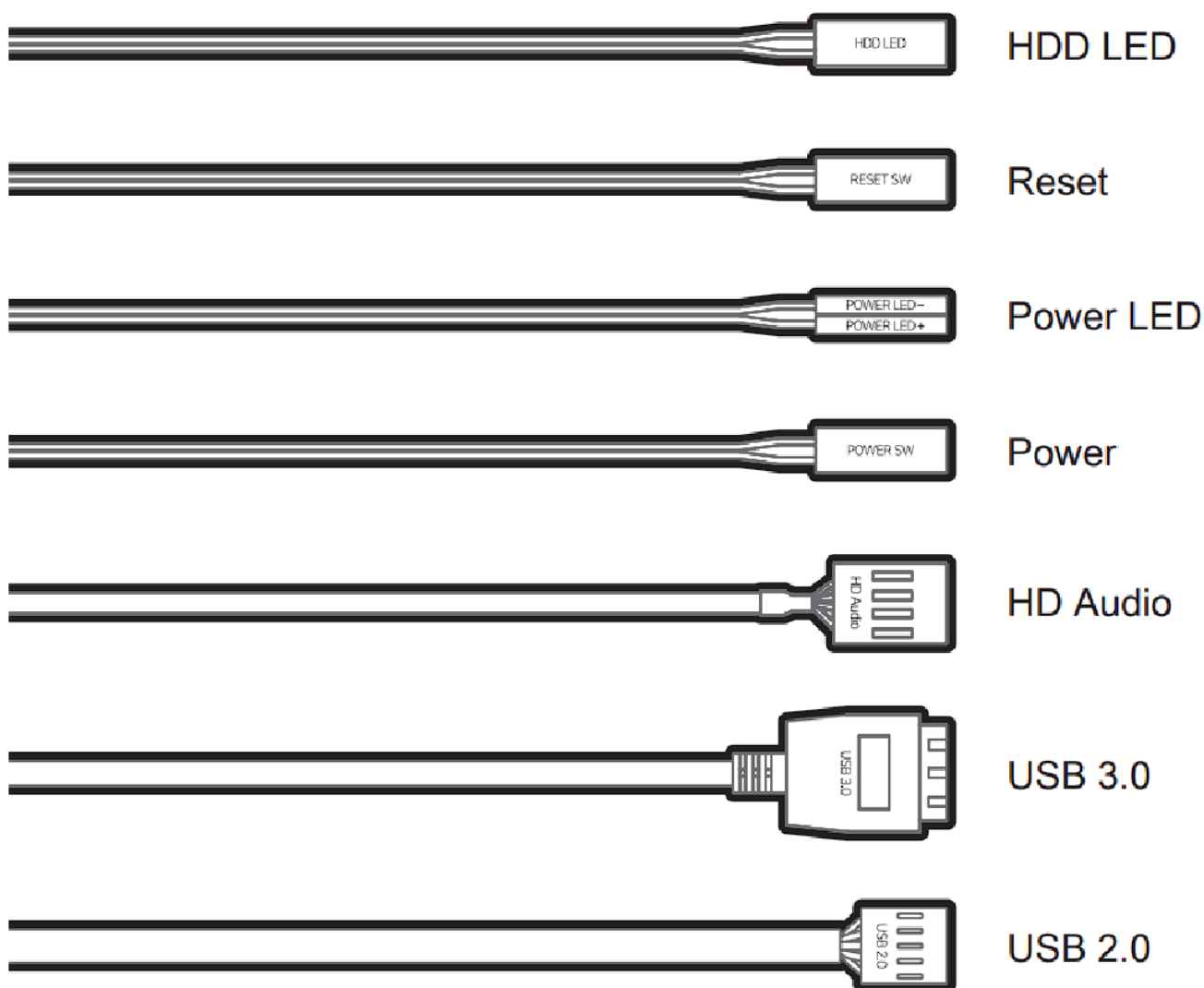

Developed and designed by ZALMAN in Korea.

This product is protected by ZALMAN's pending or registered patents.



Developed and designed by ZALMAN in Korea.

This product is protected by ZALMAN's pending or registered patents.

- * To ensure safe and easy installation, please read the following precaution.
- * Product design and specifications may be revised to improve quality and performance without notice.



www.zalman.com



Documents / Resources

	<p>ZALMAN N5 TF ATX Mid Tower Computer Case [pdf] User Manual N5 TF, ATX Mid Tower Computer Case, Tower Computer Case, Computer Case, N5 TF, ATX Mid Tower, Mid Tower</p>
	<p>ZALMAN N5 TF ATX Mid Tower Computer Case [pdf] User Manual N5 TF ATX Mid Tower Computer Case, N5 TF, ATX Mid Tower Computer Case, ATX Mid Computer Case, Tower Computer Case, Computer Case, Tower Case, Case</p>
	<p>ZALMAN N5 TF ATX MID Tower Computer Case [pdf] User Manual N5 TF ATX MID Tower Computer Case, N5 TF, ATX MID Tower Computer Case, MID Tower Computer Case, Tower Computer Case, Computer Case, Case</p>

References

- zalman.com