



# ZALMAN N5 MF ATX MID Tower Computer Case User Manual

[Home](#) » [ZALMAN](#) » ZALMAN N5 MF ATX MID Tower Computer Case User Manual 

## Contents

- [1 ZALMAN N5 MF ATX MID Tower Computer Case](#)
- [2 Precautions](#)
- [3 Specifications](#)
- [4 Accessories](#)
- [5 I/O Ports](#)
- [6 Documents / Resources](#)
  - [6.1 References](#)
- [7 Related Posts](#)

# ZALMAN

**ZALMAN N5 MF ATX MID Tower Computer Case**



## Precautions

- Read this manual carefully before installing.
- Check the product and components before installing. If you find any abnormality, contact the location where you purchased the product for a replacement or refund.
- Wear gloves to prevent accidents when installing the product.
- Severe damage may occur when mounting the system, so do not apply excessive force.
- Connecting the cable incorrectly may cause a fire due to a short circuit. Make sure to refer to the manual when connecting the cable.
- Be careful not to block the ventilation hole of the product when using the system.
- Avoid locations with direct sunlight, water, moisture, oil, and excessive dust. Store and use the product in a well-ventilated location.
- Do not wipe the surface of the product using chemicals. (organic solvents such as alcohol or acetone)
- Do not insert your hand or other object into the product during operation, as this may injure your hand or damage the object.
- Store and use the product out of children's reach.
- Our company assumes no responsibility for any problem that occurs due to the use of the product for purposes other than its designated purposes and/or the carelessness of the consumer.
- The exterior design and specifications of the product are subject to change without prior notice to consumers for quality improvement.

## Specifications

Model		N5 MF
Case Form Factor		ATX Mid-Tower
Dimensions		437(D) x 200(W) x 450(H)mm
Weight		3.6kg
Case Materials		Plastic, Steel
Motherboard Support		ATX / mATX / Mini-ITX
Maximum VGA Length		365mm
Maximum CPU Cooler Height		158mm
Maximum PSU Length		160mm
PCI Expansion Slots		7
Drive Bays		2 x Combo(3.5" or 2.5"), 4 x 2.5" SSD
Fan Support	Top	3 x 120mm
	Front	3 x 120mm
	Rear	1 x 120mm
	Bottom	2 x 120mm
Fan(s) Included	Front	3 x 120mm (with RGB LED Effect)
	Rear	1 x 120mm (with RGB LED Effect)
Radiator Support	Front	120mm / 240mm / 360mm
	Rear	120mm
I/O Ports		1 x Headphone, 1 x Mic, 2 x USB 2.0, 1 x USB 3.0, Reset Button, Power Button, Fan-LED Controller (Change Fan Speed & LED Brightness)

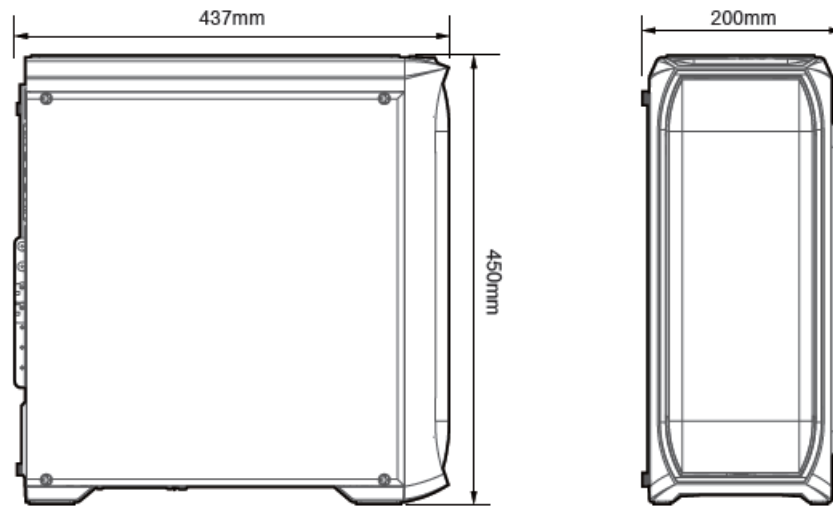

## Accessories

- User's Manual

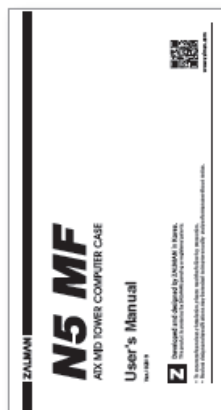

- Buzzer

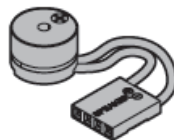

- SSD / MB Screws x 20



- Cable Ties x 5



- PSU / HDD / VGA Screws x 8



- Thumm Screws x 2



- Motherboard Standoffs x 3



## I/O Ports

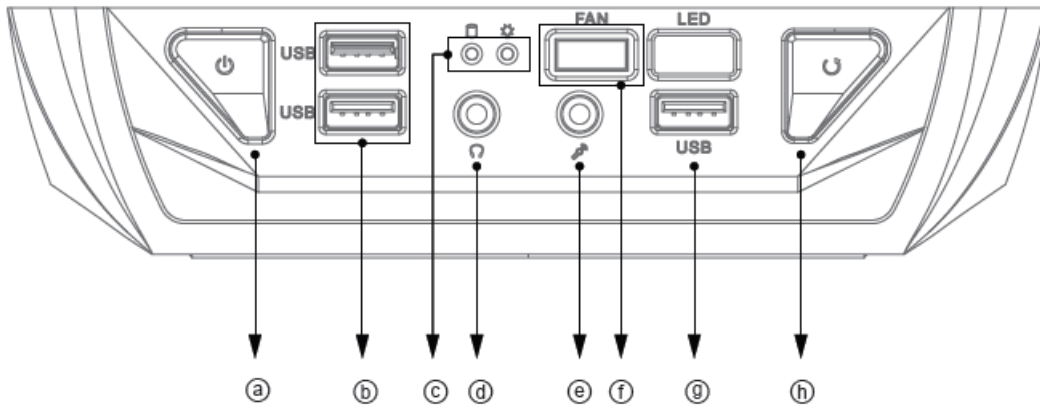

#	Part	#	Part	#	Part	#	Part
	Power Button		USB 2.0 Ports		HDD / Power L ED		Headphone Jack
	Microphone Jack		Fan Controller		USB 3.0 Port		Reset Button

### 1. Removing the side panels

- Acrylic Panel
- Steel Panel

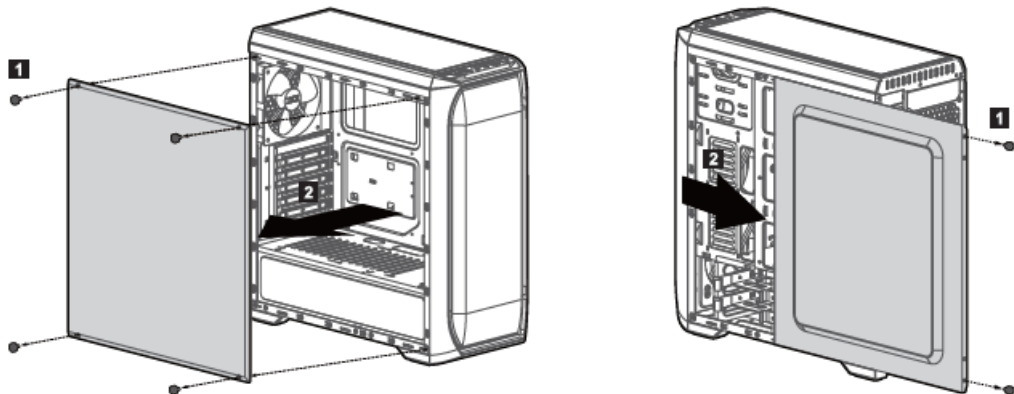

### 2. Removing the front panel

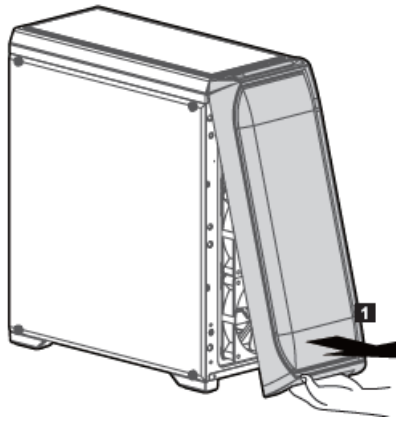

### 3. Mounting the motherboard

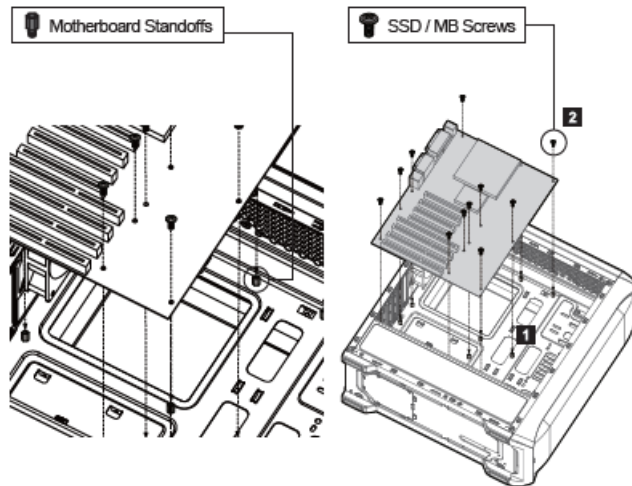

- Motherboard size

Pick out the 8-Pin auxiliary power cable(CPU power connector) through the groove on top before installing motherboard.

- ATX
- mATX
- Mini-ITX

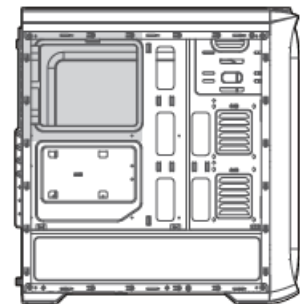
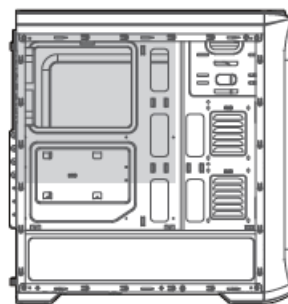
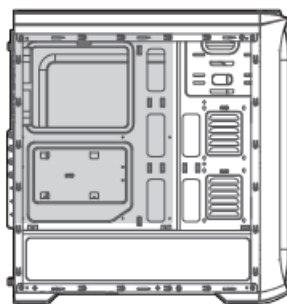

### 4. Mounting the PSU

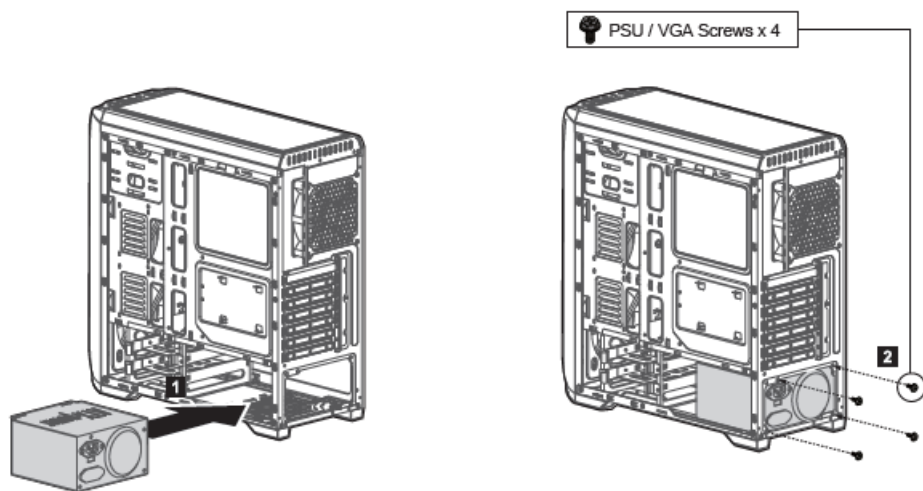

## 5. Mounting the PCI-E(VGA) card

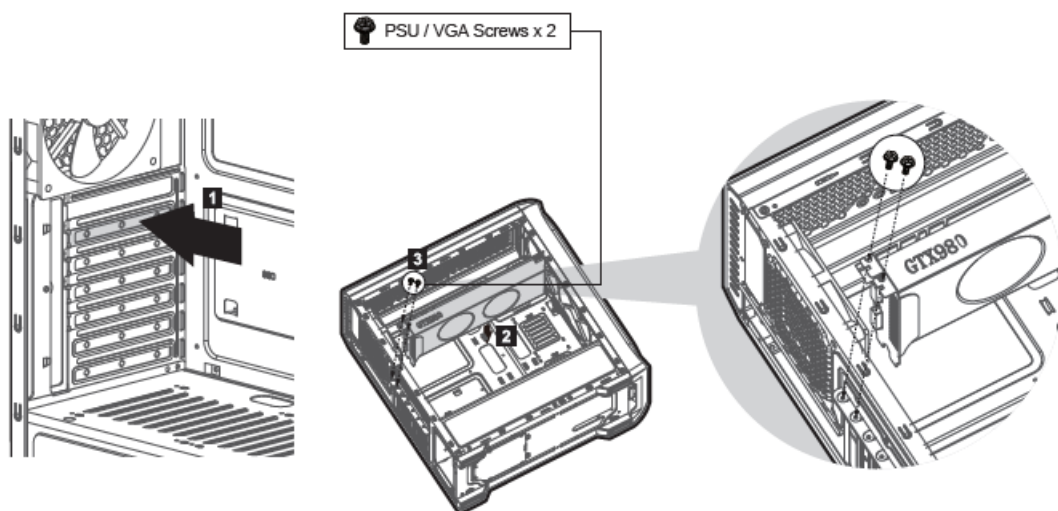

## 6. Mounting the 3.5" and 2.5" SSD / HDD

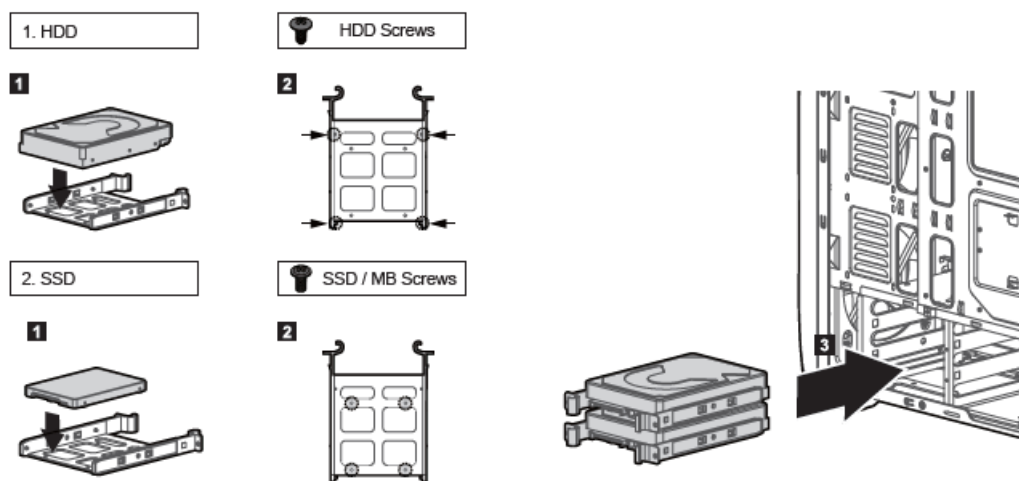

**1** SSD / MB Screws x 8

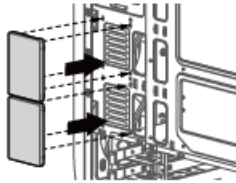

**1** SSD / MB Screws x 4

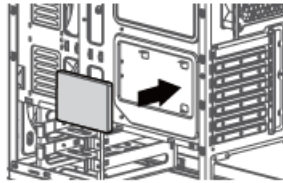

**1** SSD / MB Screws x 4

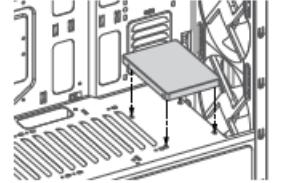

**2**

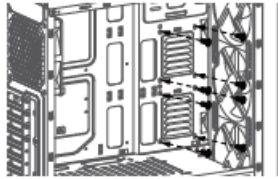

**2**

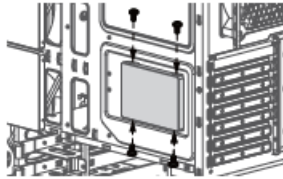

**2**

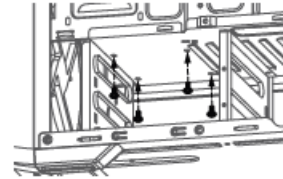

## 8. Mounting the fans

- Mounting the top fans
- Mounting the bottom fans

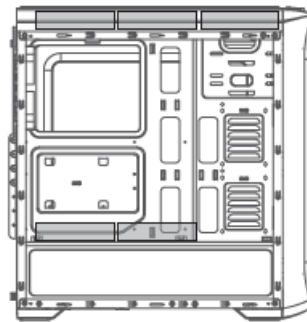

## 9. Fan(s) Included

- Front : 3 x 120mm Fan – with RGB LED Effects
- Rear : 1 x 120mm Fan – with RGB LED Effects

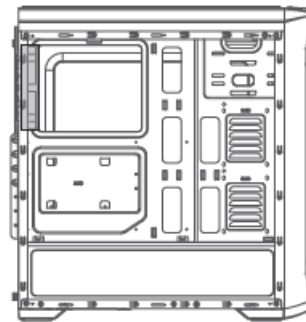
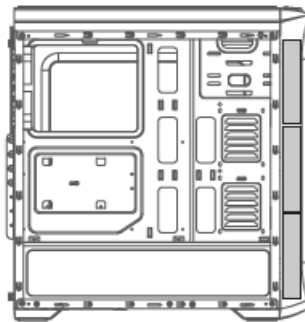

## 10. Fan Controller

4 Control Modes of Fan speed & LED brightness

Mode	Fan Speed	LED Brightness
Mode 1.	High	High
Mode 2.	Low	Low
Mode 3.	Low	Off
Mode 4.	Off	Off



Caution: shutting off your system fans could cause increase of system temperature.

## 11. I/O Connectors

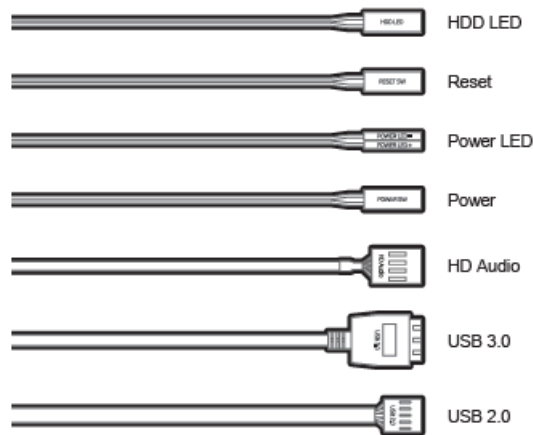



## Documents / Resources

	<a href="#">ZALMAN N5 MF ATX MID Tower Computer Case</a> [pdf] User Manual N5 MF ATX MID Tower Computer Case, N5 MF, ATX MID Tower Computer Case
	<a href="#">ZALMAN N5 MF ATX Mid Tower Computer Case</a> [pdf] User Manual N5 MF ATX Mid Tower Computer Case, N5 Computer Case, MF ATX Mid Tower Computer Case, Computer Case, ATX Mid Tower Computer Case, ATX, ATX Computer Case
	<a href="#">ZALMAN N5 MF ATX MID Tower Computer Case</a> [pdf] User Manual N5 MF, ATX MID Tower Computer Case, N5 MF ATX MID Tower Computer Case, MID Tower Computer Case, Tower Computer Case, Computer Case, Case

## References

- [zalman.com](https://zalman.com)
- [ANDPRO.RU](https://andpro.ru) - интернет магазин компьютерной и офисной техники с выгодными ценами и доставкой