



# ZALMAN M3 Plus mATX Mini Tower Computer Case User Manual

[Home](#) » [ZALMAN](#) » ZALMAN M3 Plus mATX Mini Tower Computer Case User Manual 

## Contents

- [1 ZALMAN M3 Plus mATX Mini Tower Computer Case](#)
- [2 Precautions](#)
- [3 Specifications](#)
- [4 Accessories](#)
- [5 I/O Ports](#)
- [6 INSTALLATION](#)
- [7 Fans Included / Specifications](#)
- [8 I/O Connectors](#)
- [9 Documents / Resources](#)
  - [9.1 References](#)
- [10 Related Posts](#)

# ZALMAN

**ZALMAN M3 Plus mATX Mini Tower Computer Case**



## Precautions

Read this manual carefully before installing.

- Check the product and components before installing. If you find any abnormality, contact the location where you purchased the product for a replacement or refund.
- Wear gloves to prevent accidents when installing the product.
- Severe damage may occur when mounting the system, so do not apply excessive force.
- Connecting the cable incorrectly may cause a fire due to a short circuit. Make sure to refer to the manual when connecting the cable.
- Be careful not to block the ventilation hole of the product when using the system.
- Avoid locations with direct sunlight, water, moisture, oil, and excessive dust. Store and use the product in a well-ventilated location.
- Do not wipe the surface of the product using chemicals. (organic solvents such as alcohol or acetone)
- Do not insert your hand or other object into the product during operation, as this may injure your hand or damage the object.
- Store and use the product out of children's reach.
- Our company assumes no responsibility for any problem that occurs due to the use of the product for purposes other than its designated purposes and/or the carelessness of the consumer.
- The exterior design and specifications of the product are subject to change without prior notice to consumers for quality improvement

## Specifications

<b>Model</b>		M3 PLUS
<b>Case Form Factor</b>		mATX Mini Tower
<b>Dimensions</b>		407(D) x 210(W) x 457(H)mm
<b>Weight</b>		6.0kg
<b>Case Materials</b>		Plastic, Steel, Tempered Glass
<b>Motherboard Support</b>		mATX / Mini-ITX
<b>Maximum VGA Length</b>		330mm
<b>Maximum CPU Cooler Height</b>		165mm
<b>Maximum PSU Length</b>		180mm
<b>PCI Expansion Slots</b>		4
<b>Drive Bays</b>		2 x 3.5" / 4 x 2.5"
<b>Fan Support</b>	<b>Top</b>	2 x 120mm
	<b>Front</b>	3 x 120mm
	<b>Rear</b>	1 x 120mm
	<b>Bottom</b>	2 x 120mm
<b>Pre-Installed Fan(s)</b>	<b>Front</b>	3 x 120mm (with White LED Effect)
	<b>Rear</b>	1 x 120mm (with White LED Effect)
<b>Radiator Support</b>	<b>Top</b>	240mm
	<b>Side</b>	240mm
<b>I/O Ports</b>		1 x Headphone Jack, 1 x Mic, 1 x USB3.0, 2 x USB2.0, Power Button, Reset Button, Fan-LED Controller

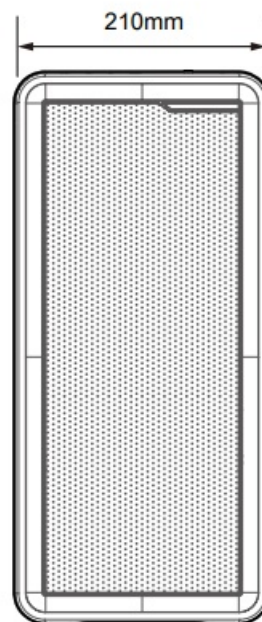
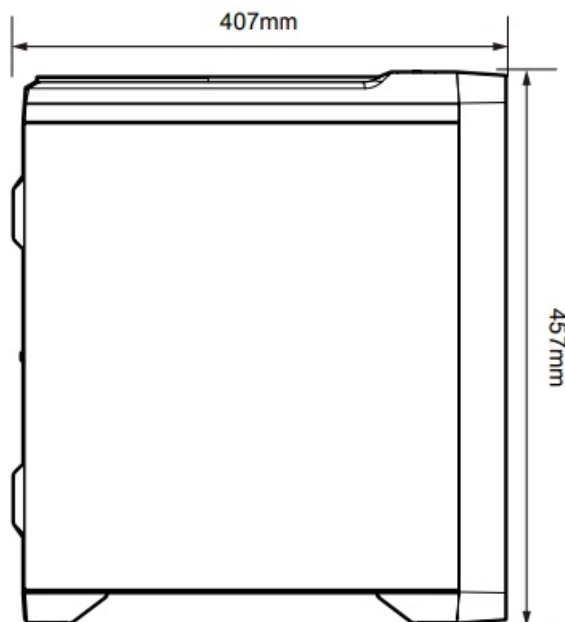

## Accessories



User's Manual



Glass Cleaner



Buzzer



PCI Slot Covers



Cable Ties x 5



Motherboard Standoffs x 3



Thumb Screws x 2



HDD Screws x 20



SSD / MB Screws x 25



PSU / VGA Screws x 6

I/O Ports

⑨ Fan & LED Control Button



Fan & LED Control Button

1. Fan Speed : 100% / LED Bright : 100%
2. Fan Speed : 50% / LED Bright : 50%
3. Fan Speed : 50% / LED Bright : Off
4. Fan Speed : Off / LED Bright : Off

※ **Caution :**  
Shutting off your system fans could cause increase of system temperature.

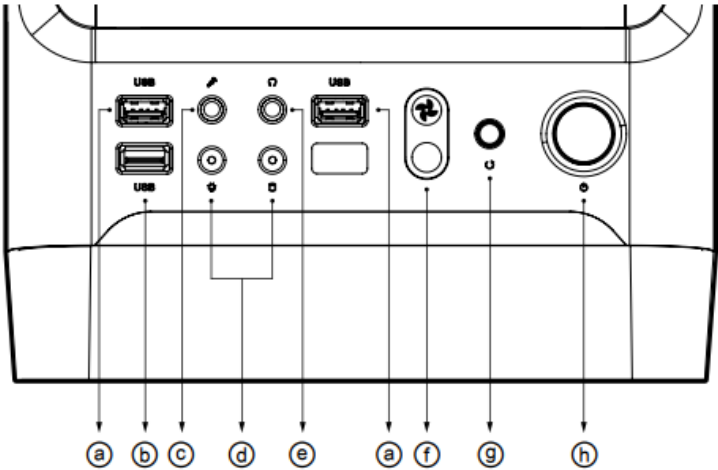

#	Part	#	Part	#	Part	#	Part
②	USB 2.0 Ports	⑥	USB 3.0 Port	④	Microphone Jack	⑧	HDD / Power LED
③	Headphone Jack	⑦	Fan-LED Controller	⑤	Reset Button	⑨	Power Button

INSTALLATION

Removing the side panels

1. Tempered Glass
2. Steel Panel

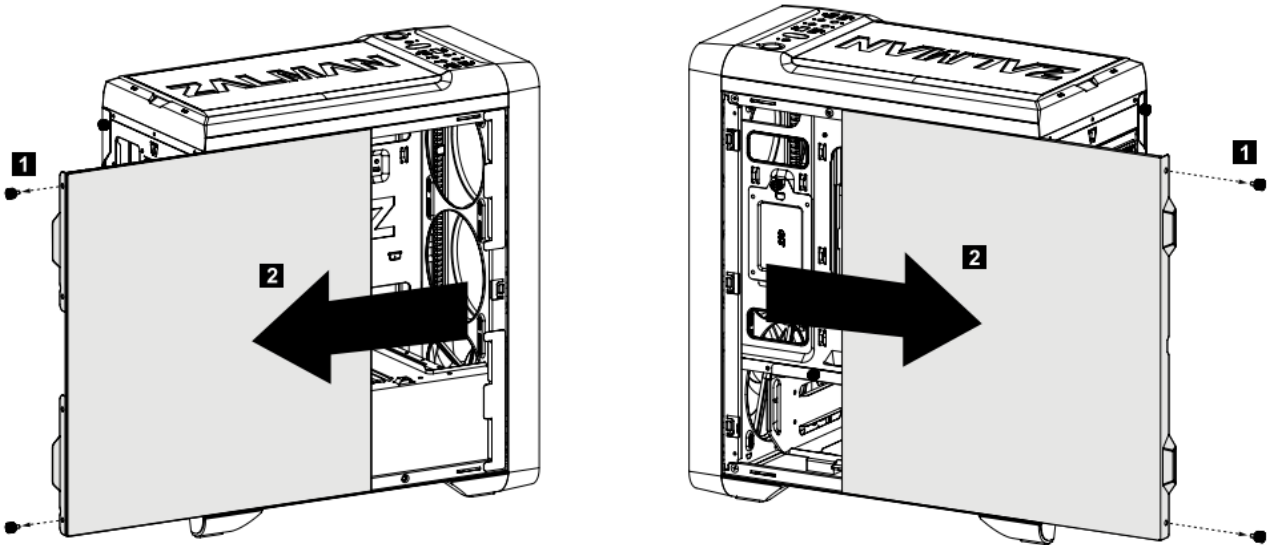

Removing the front panel

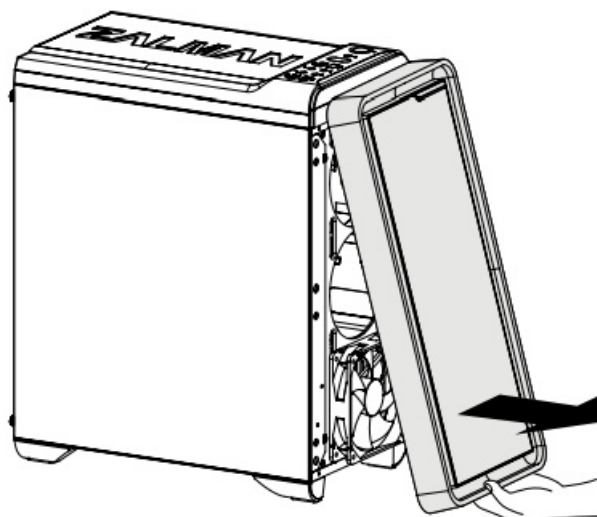

## Mounting the motherboard

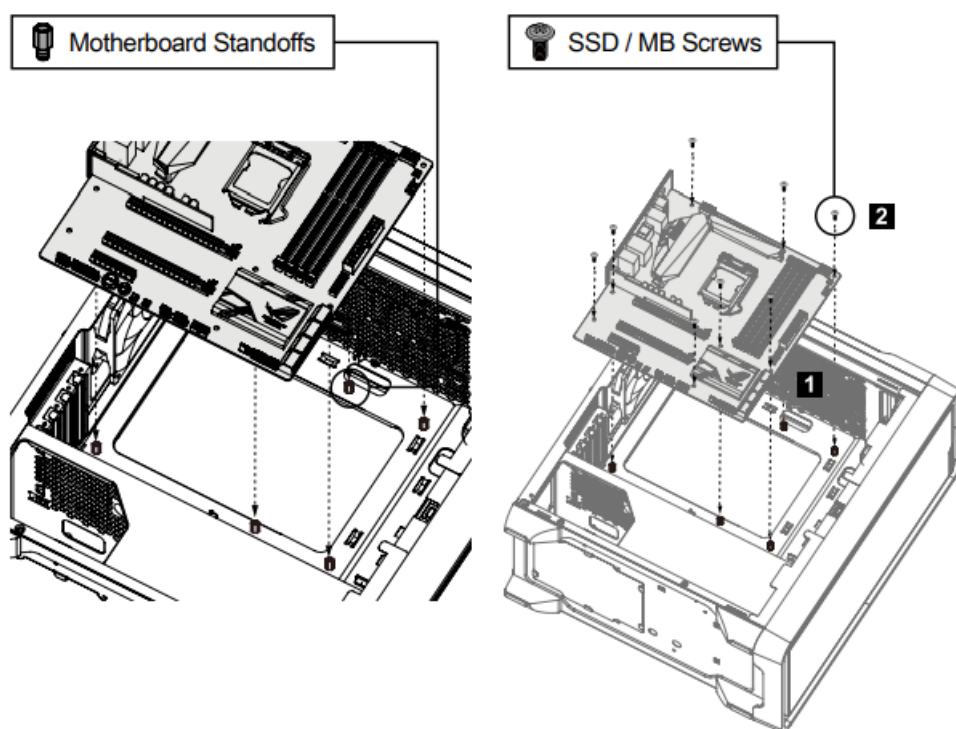

## Motherboard size

1. mATX
2. Mini-ITX

### 1) mATX

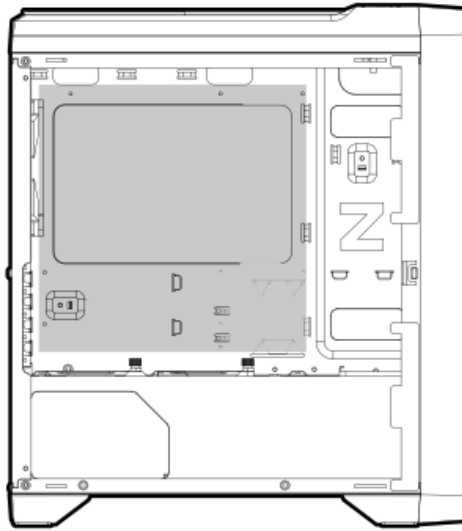

### 2) Mini-ITX

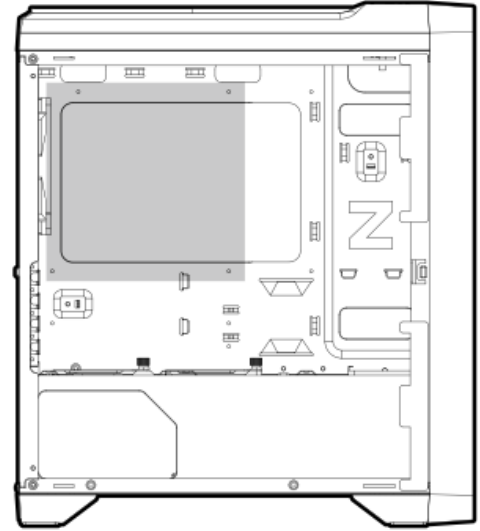

## Mounting the PSU

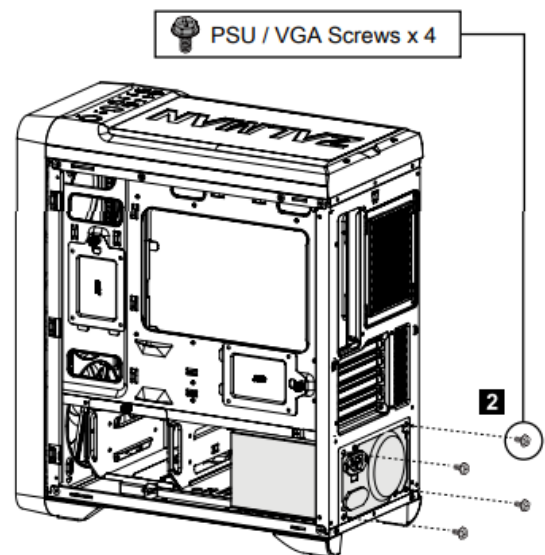
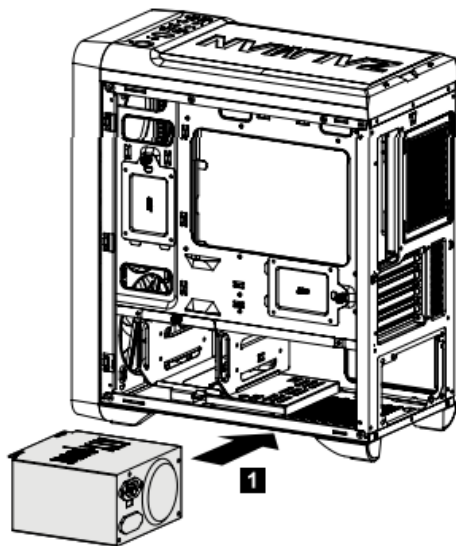

## Mounting the PCI-E(VGA) card

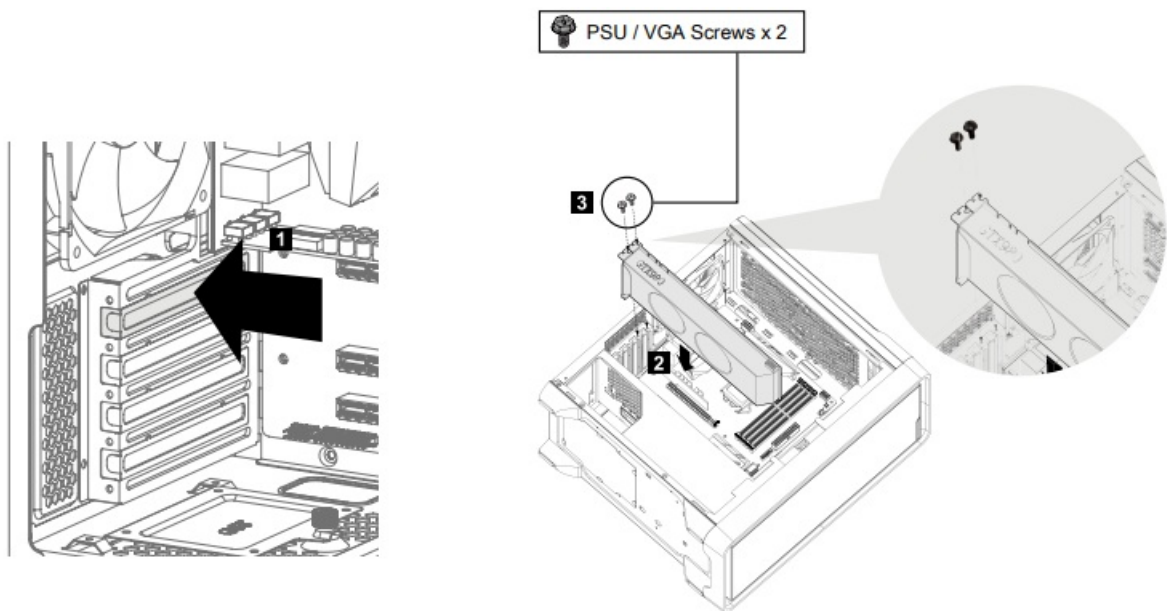

### Mounting the 3.5" HDD

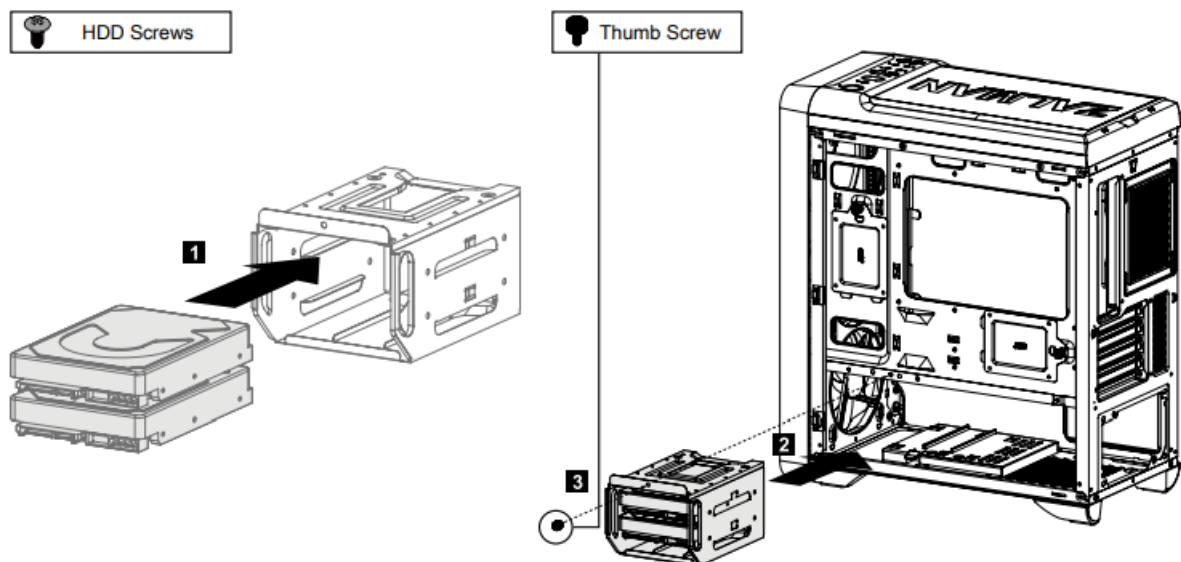

### Mounting the 2.5" SSD / HDD

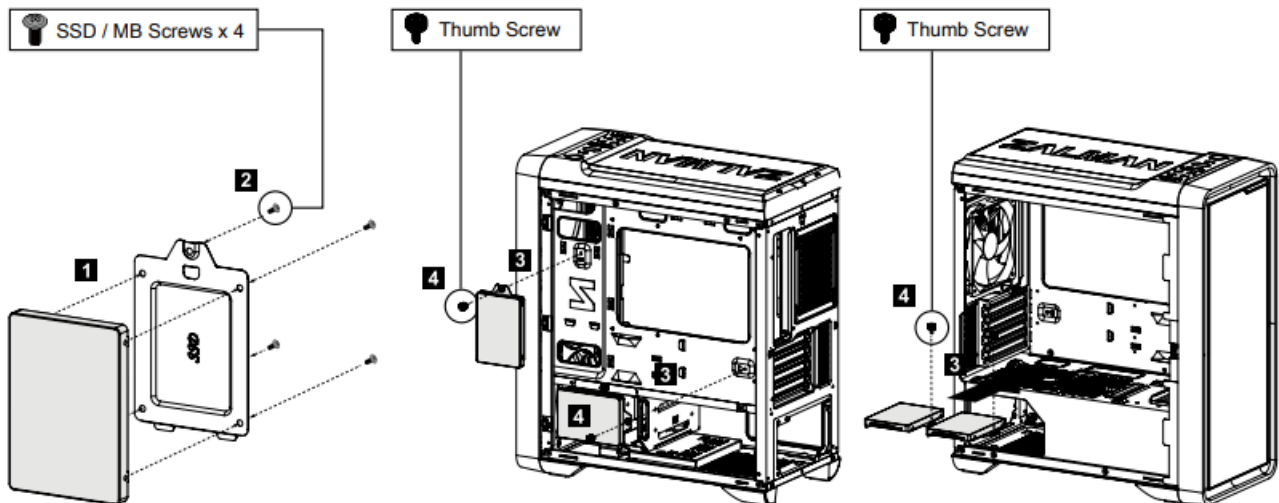

### Mounting the radiator



1. Top radiator
2. Front radiator

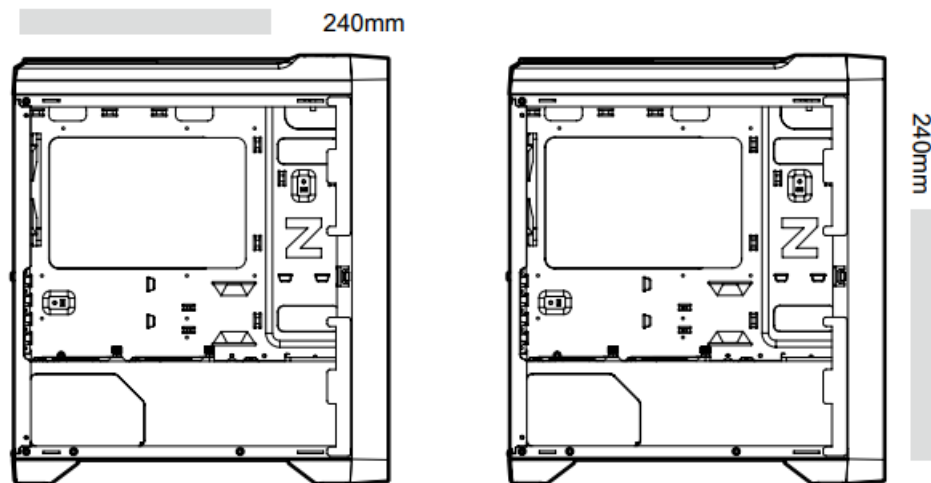

### Fans Included / Specifications

RPM :  $1100 \pm 10\%$   
Input :  $12V \approx 0.24A$   
 $12V \approx 0.11A$

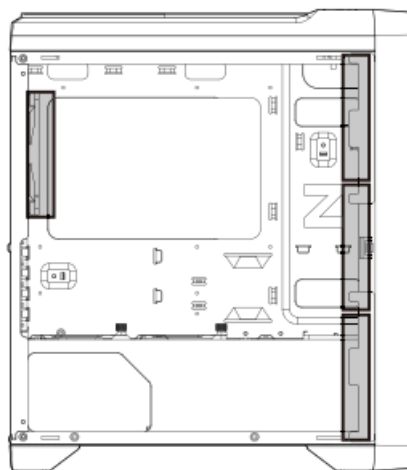

### Mounting the fans

1. Mounting the top fans
2. Mounting the bottom fans

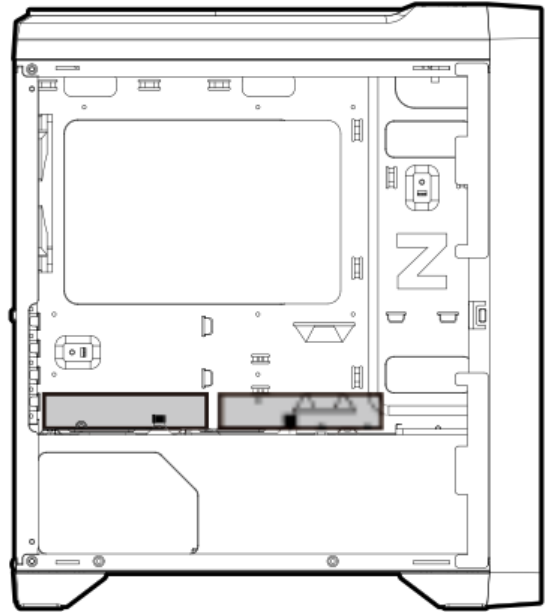
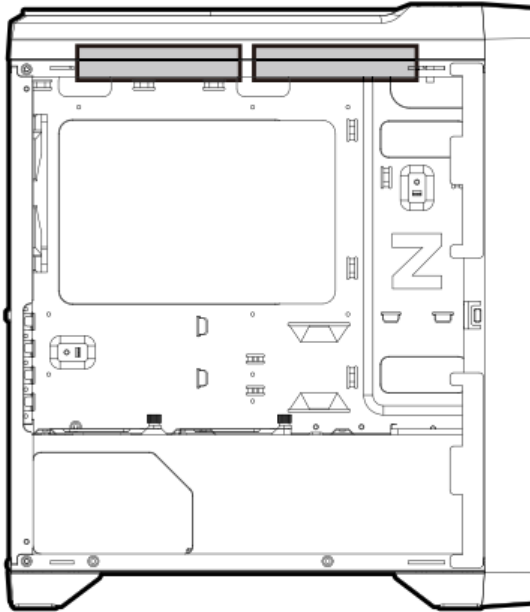

## I/O Connectors

HDD LED

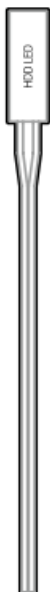

Reset

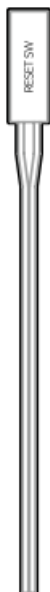

Power LED



Power

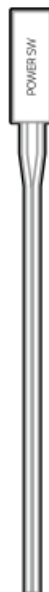

HD Audio



USB 3.0

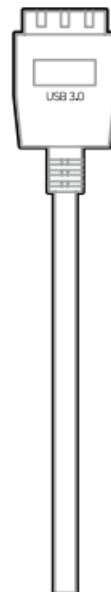



USB 2.0

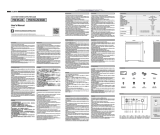

[www.zalmansvc.com](http://www.zalmansvc.com)

Documents / Resources

	<p><b><a href="#">ZALMAN M3 Plus mATX Mini Tower Computer Case</a></b> [pdf] User Manual  M3 Plus mATX Mini Tower Computer Case, M3 Plus, mATX Case, Mini Tower Computer Case, Computer Case, Tower Computer Case, Mini Case</p>
	<p><b><a href="#">ZALMAN M3 PLUS mATX Mini Tower Computer Case</a></b> [pdf] User Manual  M3 PLUS, M3 PLUS RGB, mATX Mini Tower Computer Case, Mini Tower Computer Case, Tower Computer Case, M3 PLUS, Computer Case</p>
	<p><b><a href="#">ZALMAN M3 PLUS MATX Mini Tower Computer Case</a></b> [pdf] User Manual  M3 PLUS MATX Mini Tower Computer Case, M3 PLUS, MATX Mini Tower Computer Case, Mini Tower Computer Case, Tower Computer Case, Computer Case, Case</p>

## References

- [zalman.com](https://zalman.com)
- [ANDPRO.RU](https://andpro.ru) - интернет магазин компьютерной и офисной техники с выгодными ценами и доставкой