



ZALMAN i3 NEO ATX MID Tower Computer Case User Manual

[Home](#) » [ZALMAN](#) » ZALMAN i3 NEO ATX MID Tower Computer Case User Manual

Contents [[hide](#)]

- [1 ZALMAN i3 NEO ATX MID Tower Computer Case](#)
- [2 Precautions](#)
- [3 Specifications](#)
- [4 Accessories component](#)
- [5 Documents / Resources](#)
 - [5.1 References](#)
- [6 Related Posts](#)

ZALMAN

ZALMAN i3 NEO ATX MID Tower Computer Case



Precautions

- Read this manual carefully before installing.
- Check the product and components before installing. If you find any abnormality, contact the location where you purchased the product for a replacement or refund.
- Wear gloves to prevent accidents when installing the product.
- Severe damage may occur when mounting the system, so do not apply excessive force.
- Connecting the cable incorrectly may cause a fire due to a short circuit. Make sure to refer to the manual when connecting the cable.
- Be careful not to block the ventilation hole of the product when using the system.
- Avoid locations with direct sunlight, water, moisture, oil, and excessive dust. Store and use the product in a well-ventilated location.
- Do not wipe the surface of the product using chemicals. (organic solvents such as alcohol or acetone)
- Do not insert your hand or other object into the product during operation, as this may injure your hand or damage the object.
- Store and use the product out of children's reach.
- Our company assumes no responsibility for any problem that occurs due to the use of the product for purposes other than its designated purposes and/or the carelessness of the consumer.
- The exterior design and specifications of the product are subject to change without prior notice to consumers for quality improvement.

Specifications

Model		i3 NEO
Case Form Factor		ATX Mid-Tower
Dimensions		422 x 219 x 484(H)mm
Weight		5.6kg
Case Materials		Plastic, Steel, Tempered Glass
Motherboard Support		ATX / mATX / Mini-ITX
Maximum VGA Length		355mm
Maximum CPU Cooler Height		160mm
Maximum PSU Length		210mm
PCI Expansion Slots		7
Drive Bays		2 x Combo (3.5" or 2.5", 1 x Toolless), 3 x SSD (2.5")
Fan Support	Top	2 x 120mm / 2 x 140mm
	Front	3 x 120mm / 3 x 140mm
	Rear	1 x 120mm
	Bottom	2 x 120mm
Fan(s) Included	Front	3 x 120mm (With RGB LED Effect)
	Rear	1 x 120mm (With RGB LED Effect)
Radiator Support	Top	120mm / 240mm
	Front	120mm / 240mm / 280mm / 360mm
	Rear	120mm
I/O Ports		1 x Headphones, 1 x MIC, 1 x USB2.0, 2 x USB3.0, Reset Button, Power Button

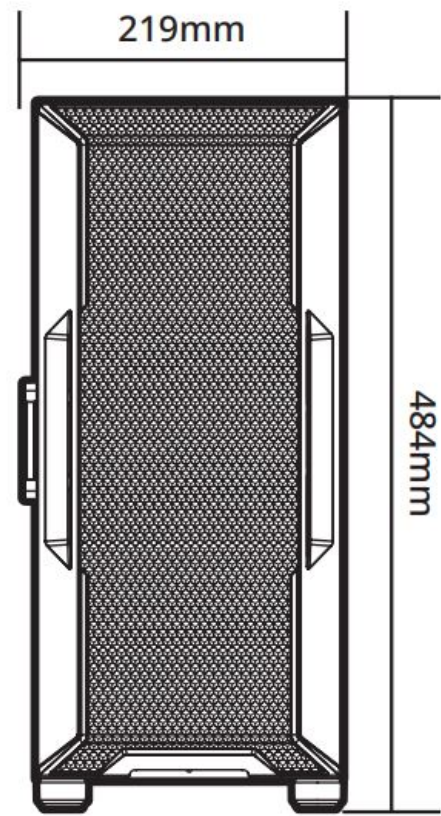
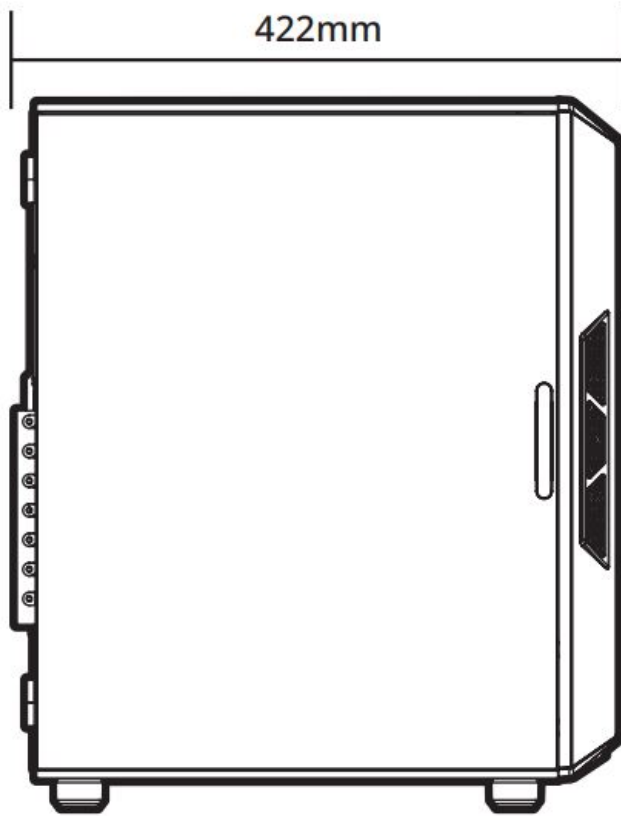

Accessories component

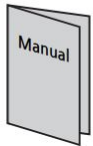

User's
Manual

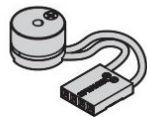

Buzzer



PCI Slot
Covers x 2



Cable
Ties x 5



Glass
Cleaner



USB Rubber
Covers x 3



Media Rubber
Covers x 2



Thumb
Screws x 2



HDD
Screws x 8



SSD / MB
Screws x 22



PSU / VGA
Screws x 8



Motherboard
Standoffs x 6

I/O Ports

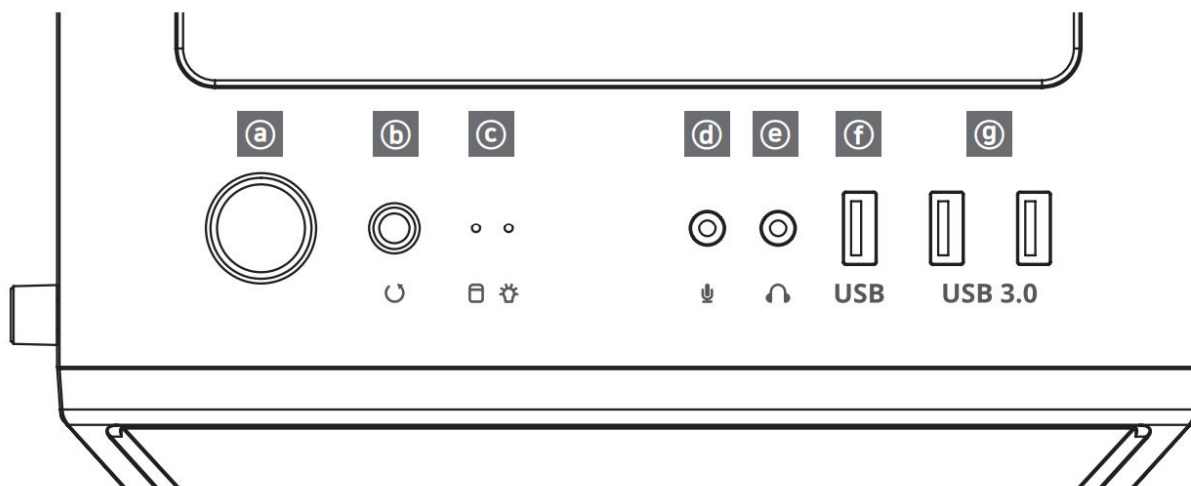

#	Part	#	Part	#	Part	#	Part
a	Power Button	b	Reset Button	c	HDD / Power LED	d	Microphone Jack
e	Headphone Jack	f	USB 2.0 Port	g	USB 3.0 Ports		

1. Removing the side panels

1

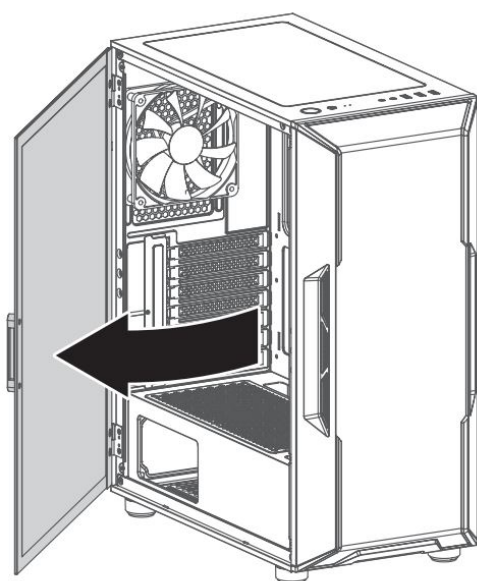

2

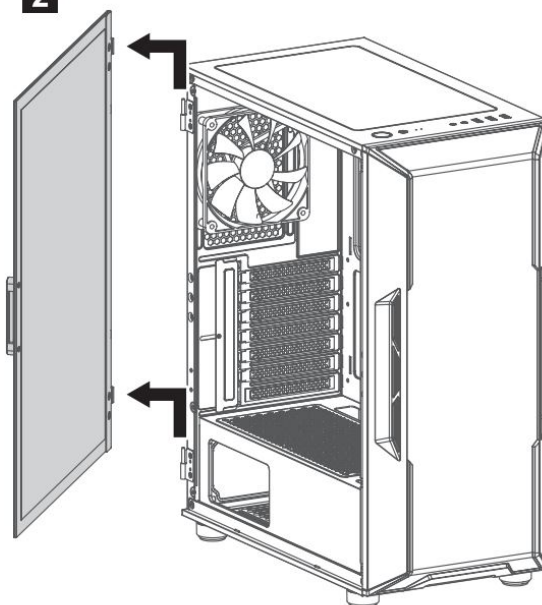

2. Removing the front panel

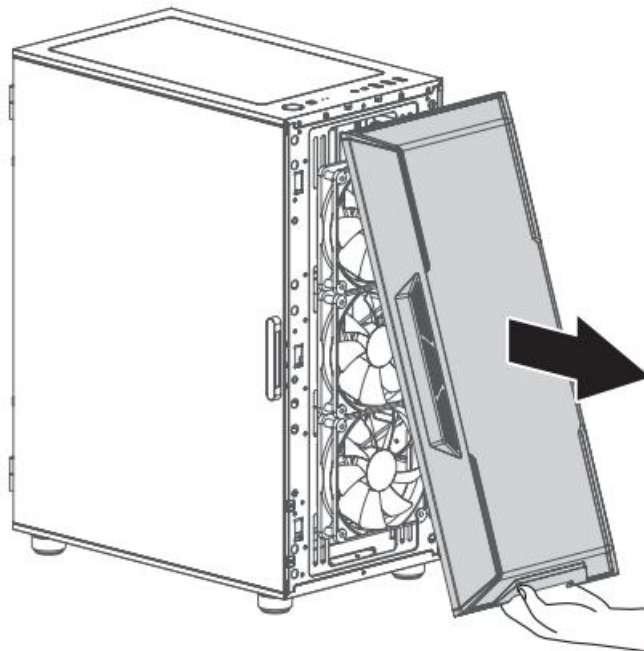

3. Mounting the motherboard

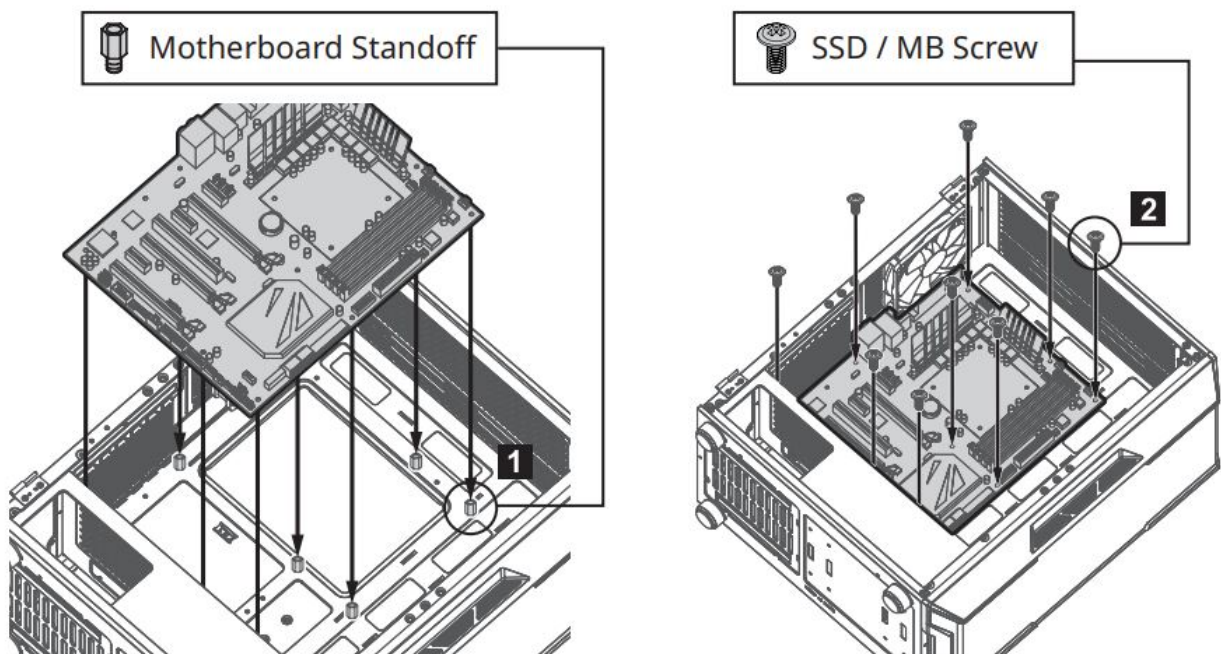

1. Motherboard size

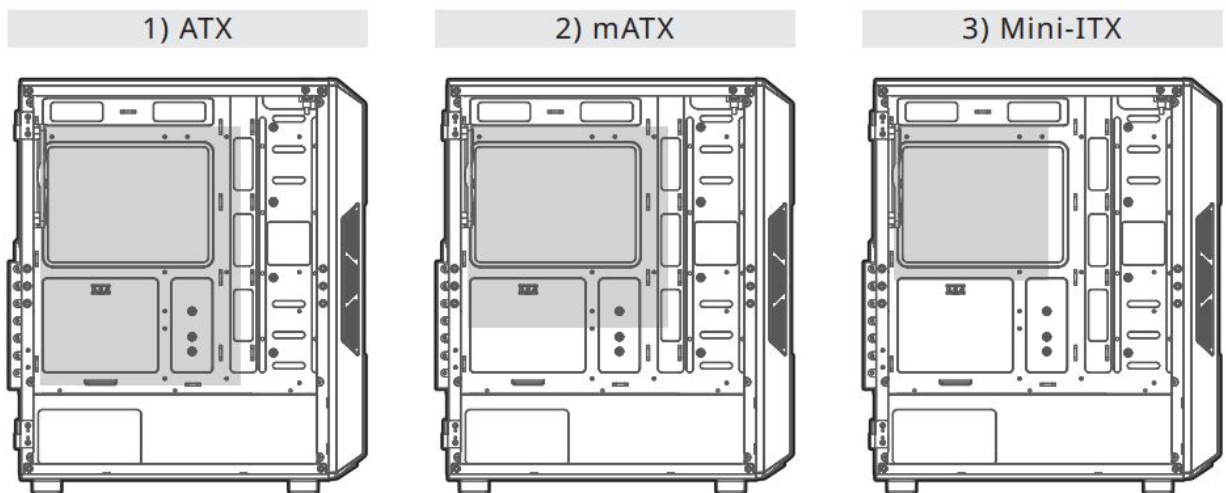

4. Mounting PCI-E(VGA) card

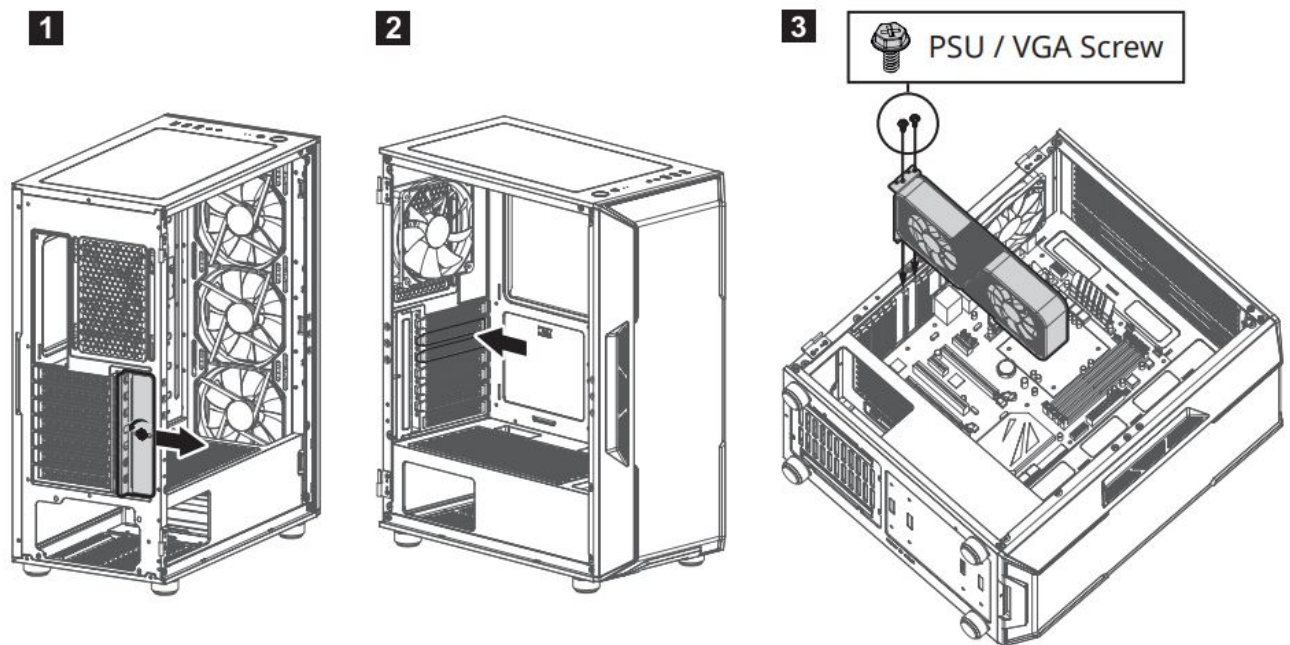

5. Mounting the 2.5" SSD

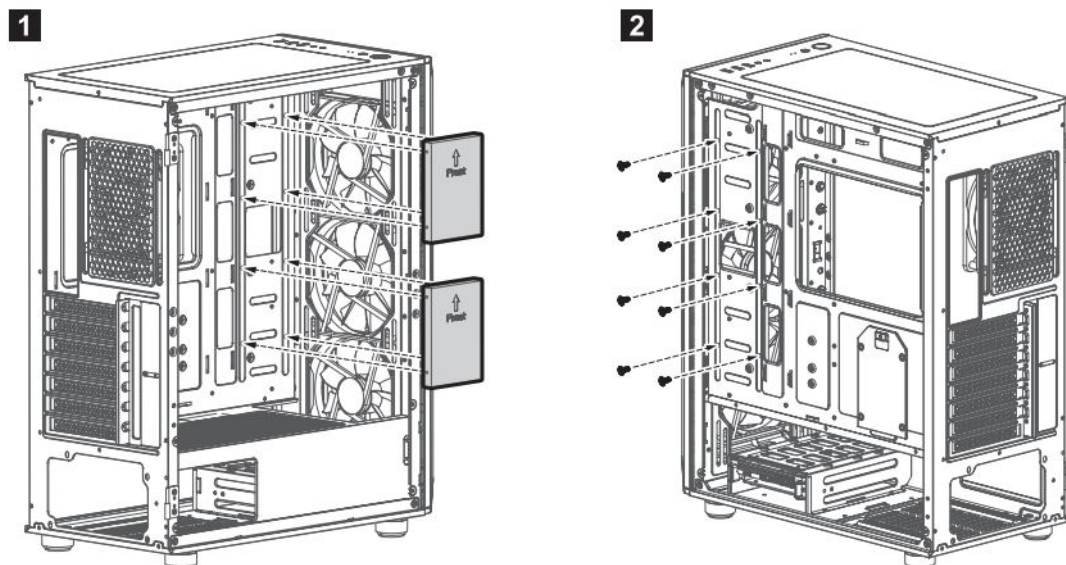
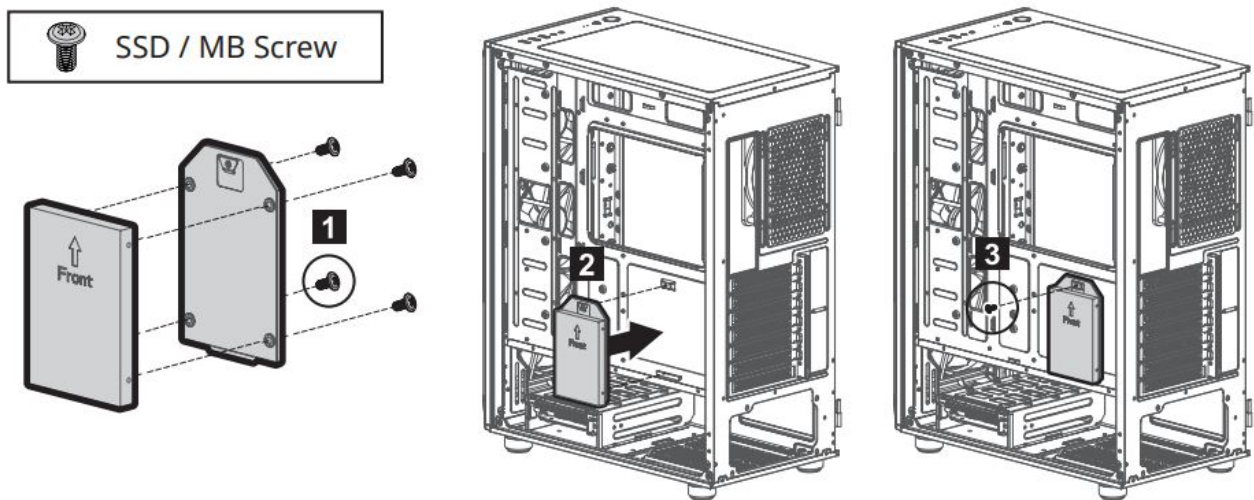

6. Mounting the 3.5" and 2.5" SSD / HDD

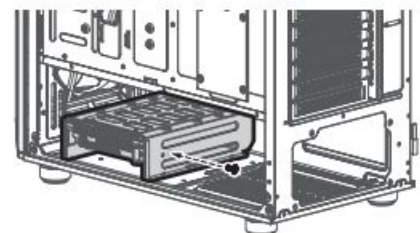
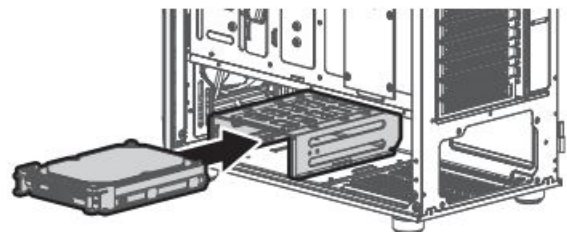
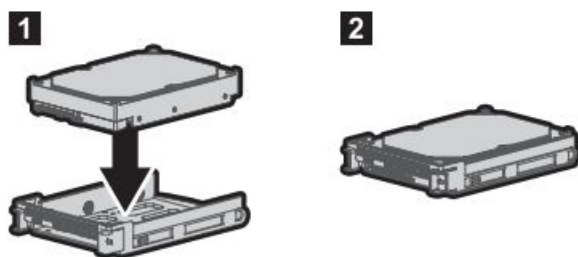
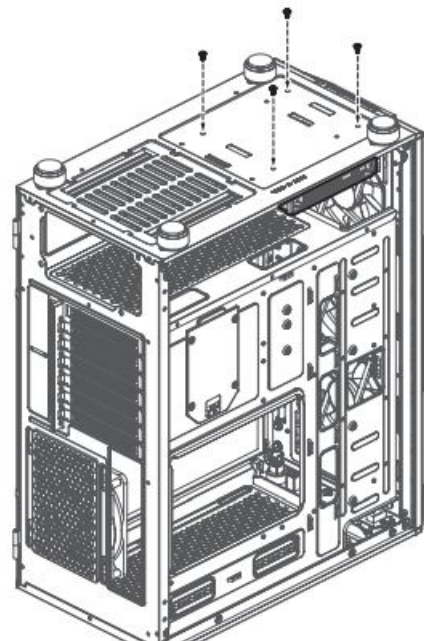
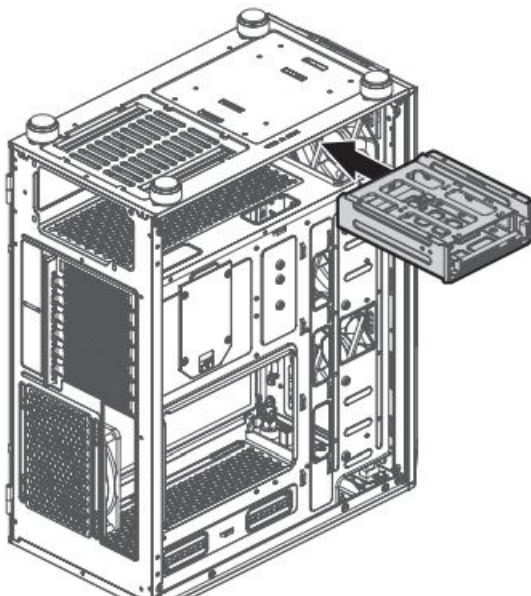
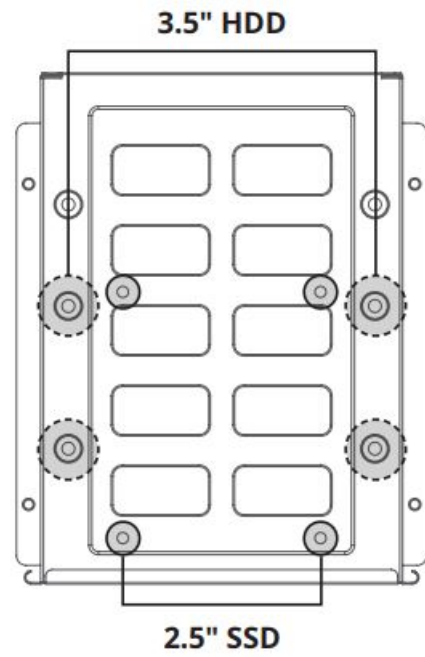
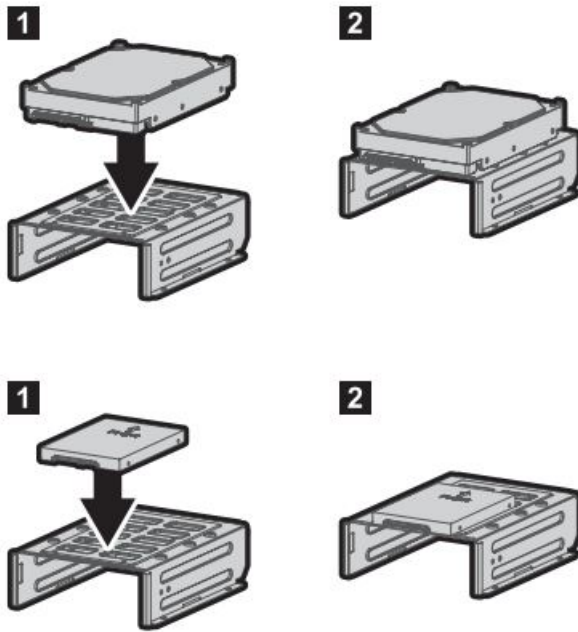

7. Mounting the PSU

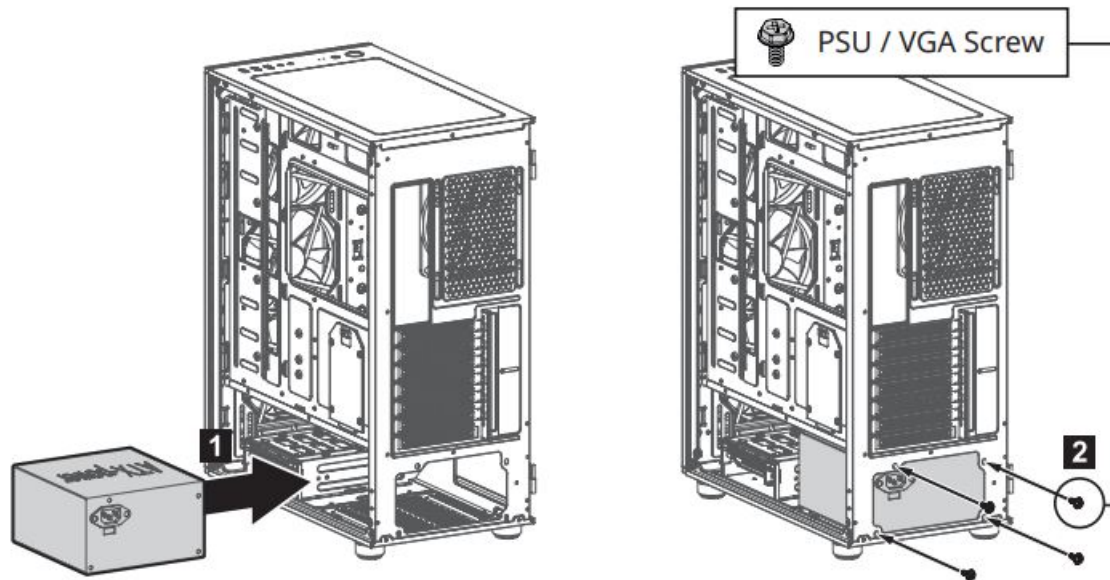

8. Mounting the radiator

1) Mounting the front radiator
• 120mm / 240mm / 280mm / 360mm

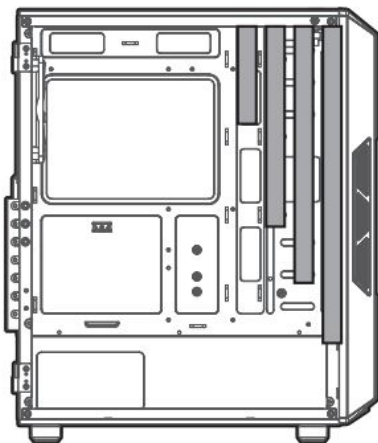

2) Mounting the top radiator
• 120mm / 240mm

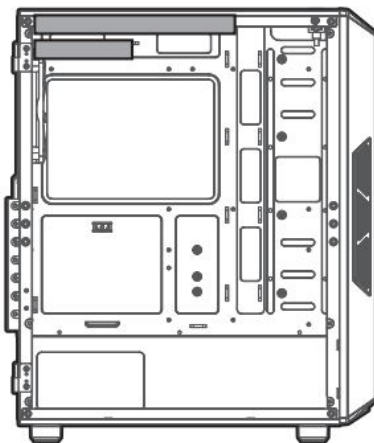

3) Mounting the rear radiator
• 120mm

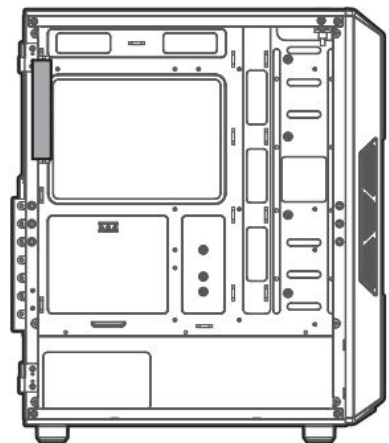

1. Mounting the front radiator 120mm / 240mm / 280mm / 360mm

2. Mounting the top radiator 120mm / 240mm

3. Mounting the rear radiator 120mm

9. Mounting the fans

1) Mounting the top fans
• 2 x 120mm, 2 x 140mm

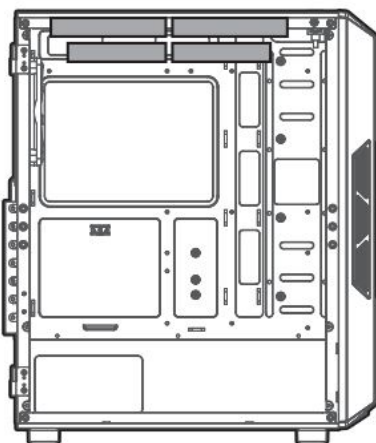

2) Mounting the front fans
• 3 x 120mm, 3 x 140mm

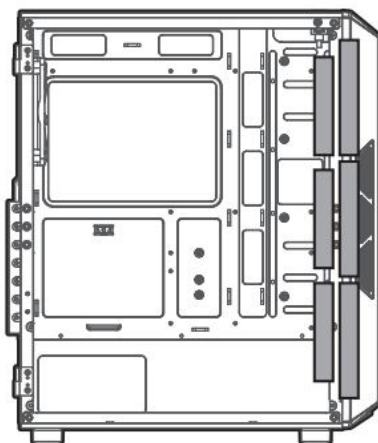

3) Mounting the rear/bottom fans
• 1 x 120mm / 2 x 120mm

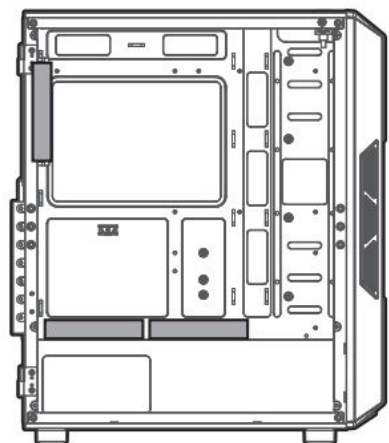

- 1. Mounting the top fans 2 x 120mm, 2 x 140mm
- 2. Mounting the front fans 3 x 120mm, 3 x 140mm
- 3. Mounting the rear/bottom fan 1 x 120mm / 2 x 120mm

10. Fan(s) Included / Fan Specifications

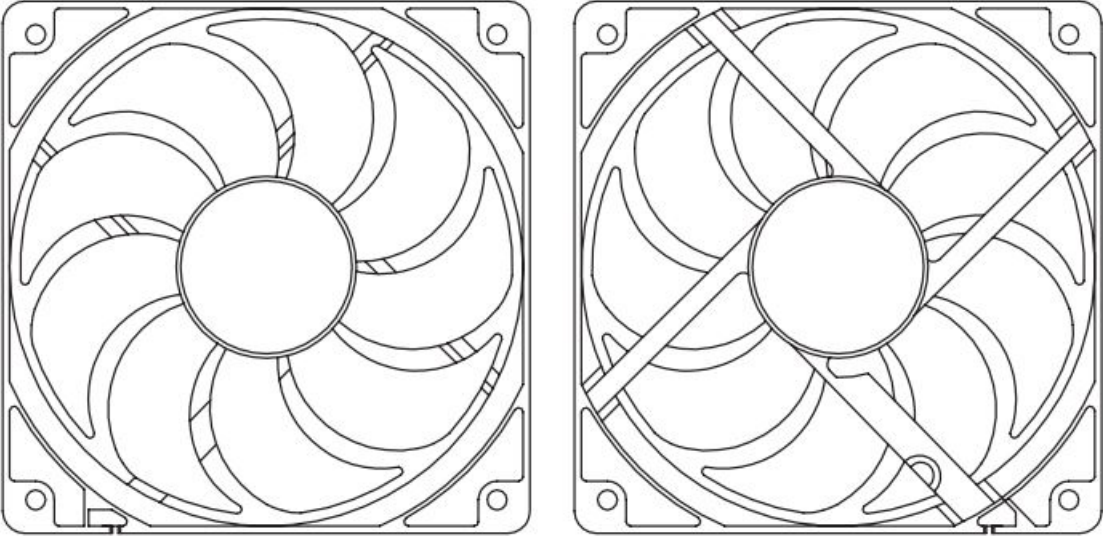

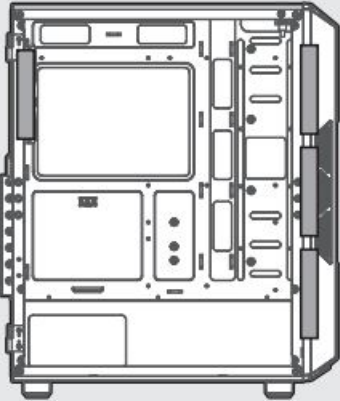

RGB LED Fan	Front / Rear
Dimensions	120 x 120 x 25(T)mm
Bearing	Hydro Bearing
Startup Voltage	5 ~ 12 V DC
Max Airflow	41.5 CFM
Max Noise Level	22.4 dB

11. I/O Connectors

HDD LED

Reset

Power LED

Power

HD Audio

USB 3.0

USB 2.0

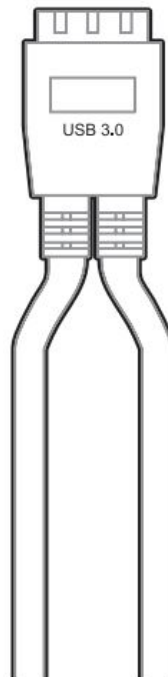
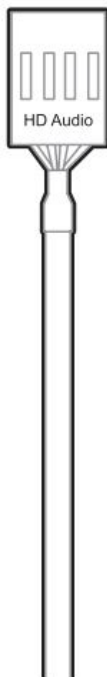

Documents / Resources

	<p>ZALMAN i3 NEO ATX MID Tower Computer Case [pdf] User Manual i3 NEO, ATX MID Tower Computer Case, Tower Computer Case, Computer Case</p>
	<p>ZALMAN i3 NEO ATX MID Tower Computer Case [pdf] User Manual i3 NEO, ATX MID Tower Computer Case, i3 NEO ATX MID Tower Computer Case, Tower Com puter Case, Computer Case, Case</p>

References

- zalman.com