



ZALMAN CNPS16X Real RGB LED CPU Cooler with 4D Patented Corrugated Fin Design User Manual

[Home](#) » [ZALMAN](#) » ZALMAN CNPS16X Real RGB LED CPU Cooler with 4D Patented Corrugated Fin Design User Manual 

ZALMAN CNPS16X Real RGB LED CPU Cooler with 4D Patented Corrugated Fin Design User Manual



- To ensure safe and easy installation, please read the following precaution.
- Product design and specifications may be revised to improve quality and performance without notice.

Contents

- [1 Precautions](#)
- [2 Specifications](#)
- [3 Components](#)
- [4 INTEL, AMD Backplate](#)
- [5 INTEL, AMD Loading Block](#)
- [6 Intel Users](#)
- [7 AMD Userse](#)
- [8 Cable Connection](#)
- [9 Fan Specifications](#)
- [10 Documents / Resources](#)
 - [10.1 References](#)
- [11 Related Posts](#)

Precautions

- Avoid tempering with objects or hands into the fan while it is in operation to prevent product damage and injuries.
- Do not eat the thermal grease, and avoid its contact with skin and eyes. If contact is made with skin, wash off with water. If irritation persists, seek medical attention.
- To prevent possible injuries, gloves must be worn while handling this product.
- Excessive force exerted on the fan may cause damage to the fan and/or system.
- Use and keep product away from reach of children.
- Check the components list and condition of the product before installation. If any problem is found, contact the retailer to obtain a replacement.
- Our company assumes no responsibility for any problem that occurs due to the use of the product for purposes other than its designated purposes and/or the carelessness of the consumer.
- Zalman Tech Co., Ltd. is not responsible for any damages due to overclocking CPU such as, CPU and system components.
- During transportation of the system, the cooler must be removed. Zalman Tech Co., Ltd. is not responsible for any damages that occur during the transport of a system.
- Product design and specifications may be changed to improve quality and performance without notice

Specifications

Model		CNPS16X
Materials		Pure Copper, Pure Aluminum, ABS
Dimensions		140(L) x 100(W) x 165(H)mm
Weight		880g
Heat Dissipation Area		5,117
TDP		150W
Fan(s)	Dimensions	120(L) x 120(W) x 26(H)mm
	Bearing Type	EBR Bearing
	Fan Speed	800~1,500 RPM $\pm 10\%$
	Max Noise Level	27.0 dB(A) $\pm 10\%$
	Max Airflow	49 CFM
	Max Air Pressure	1.21mmH ₂ O
	Rated Voltage	12 V DC
	Life Span	50,000 hours
Thermal Compound (ZM-STC8)	Volume / Net Weight	1.5g
	Temperature Range	-40°C ~ +150°C (-40°F ~ +302°F)

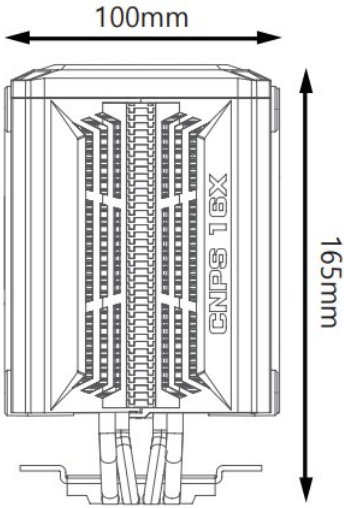
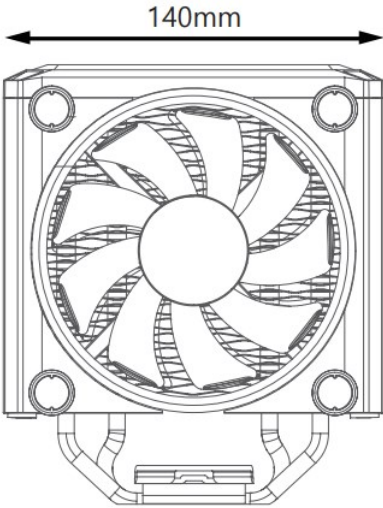

Components

- Cooler

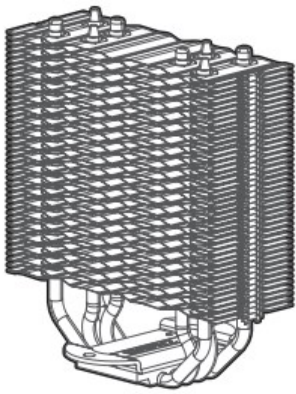

- **Fan+Guide**

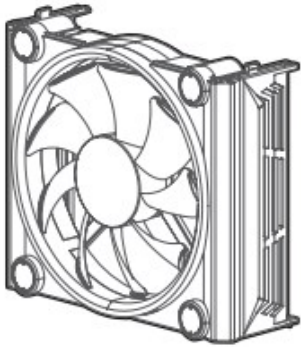

- **Fan+Guide (Reverse)**

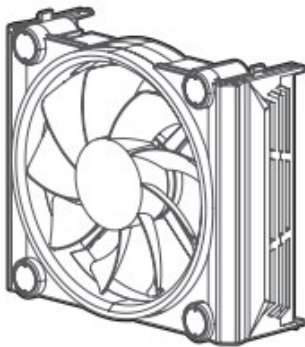

- **Top LED Cover**



- **Intel Guide**

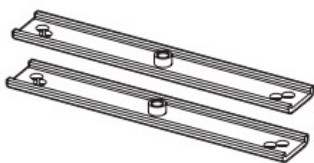

- **AMD Guide**



- **Backplate**

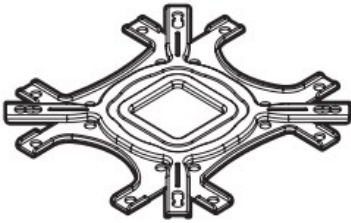

- **Washers**

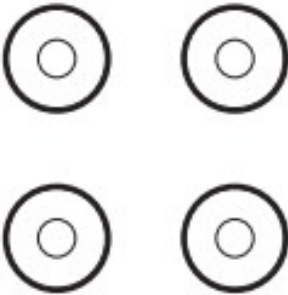

- **Side Caps**

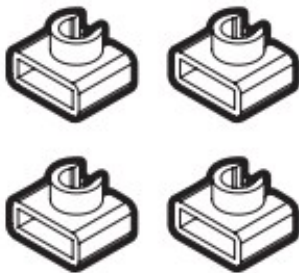

- **Nuts**

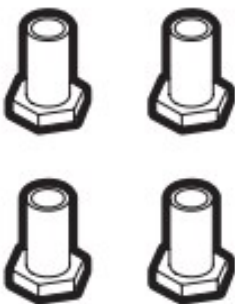

- **Loading Block (Intel)**



- **Loading Block (AMD)**



- Thermal Compound

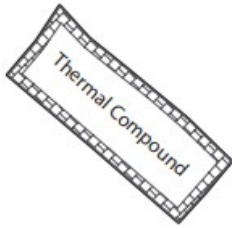

- Manual



- Fixing Bolts

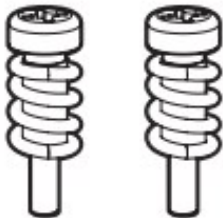

- Stand-off Nuts

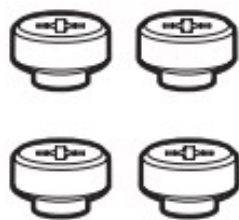

- Standoffs(A) 115X / AM3 / AM4

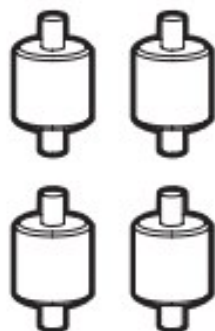

- Standoffs(B) 2066 / 2011-V3 / 2011

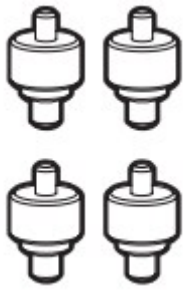

- **PWM Fan ‘Y’ Cable**

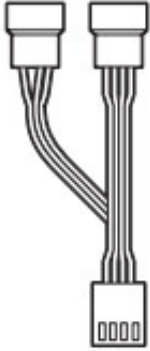

- **Gigabyte Cable**

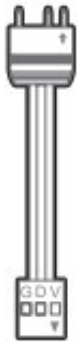

- **LED Cable**

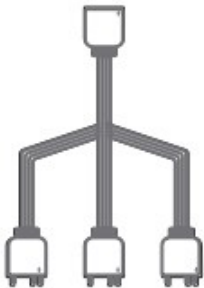

INTEL, AMD Backplate

1. Nuts Position

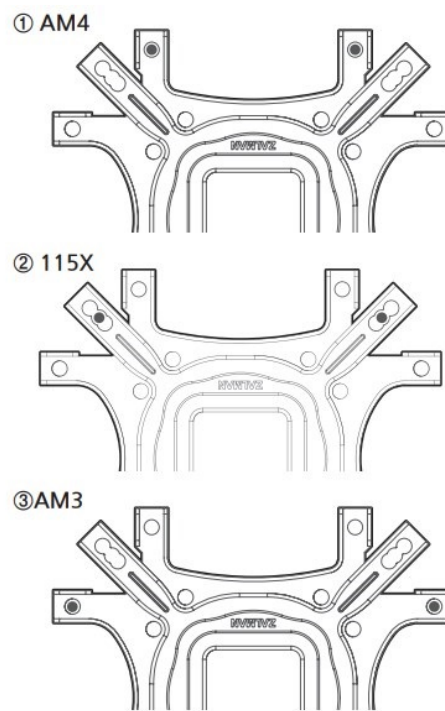
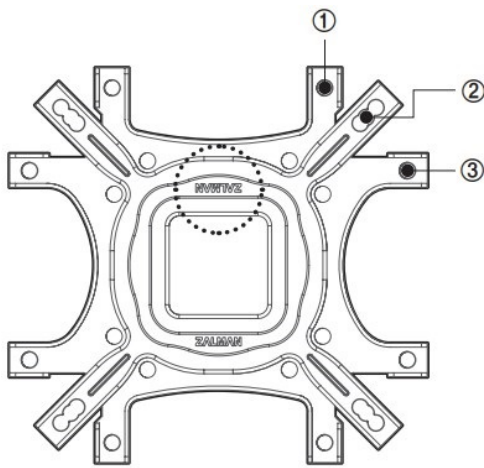

Caution

Please check the proper ZALMAN logo direction on backplate for each Intel and AMD socket. No backplate is necessary for Intel LGA2066/2011-V/2011 socket.

2. 115X

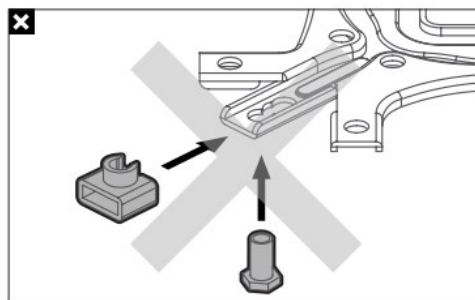
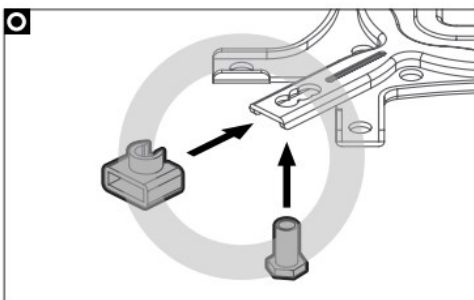
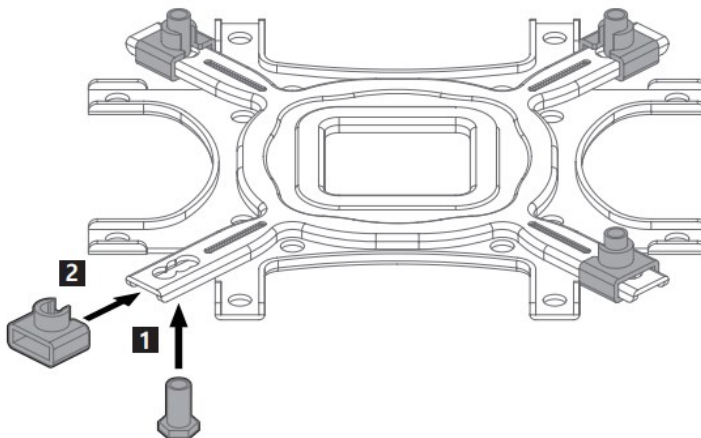

3. AM3

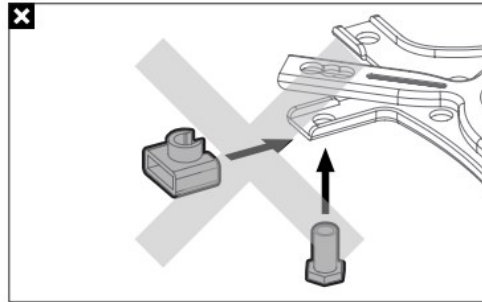
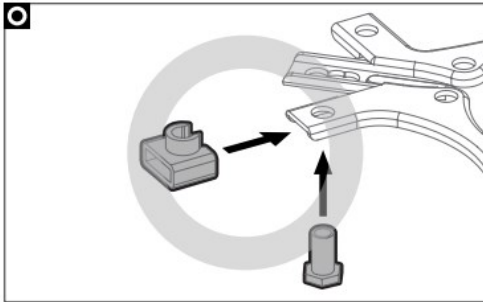
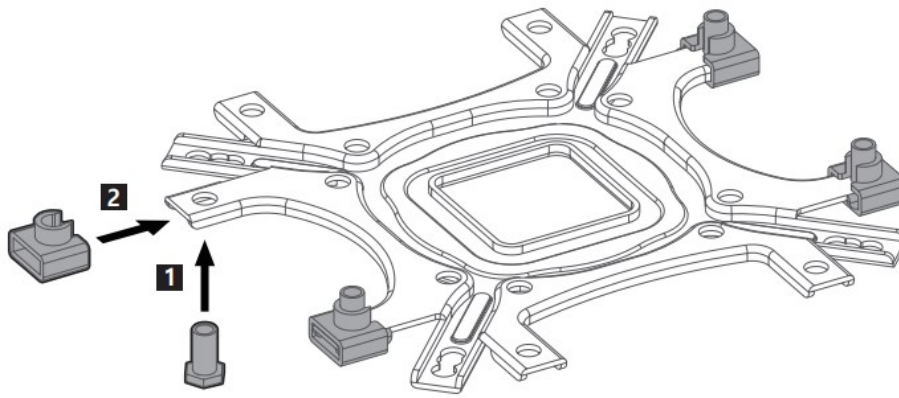

4. AM4

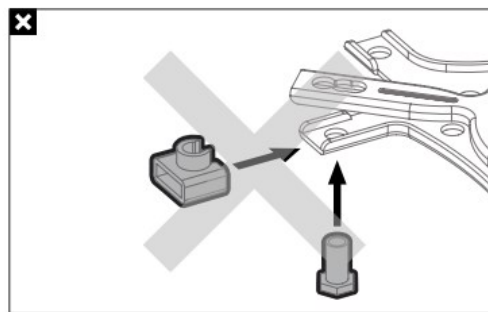
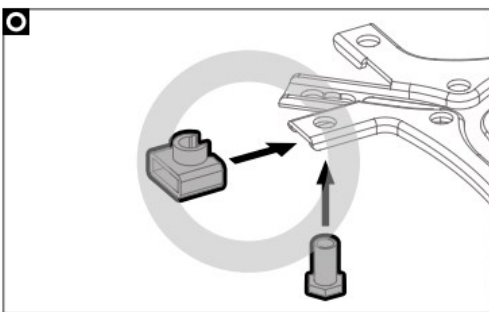
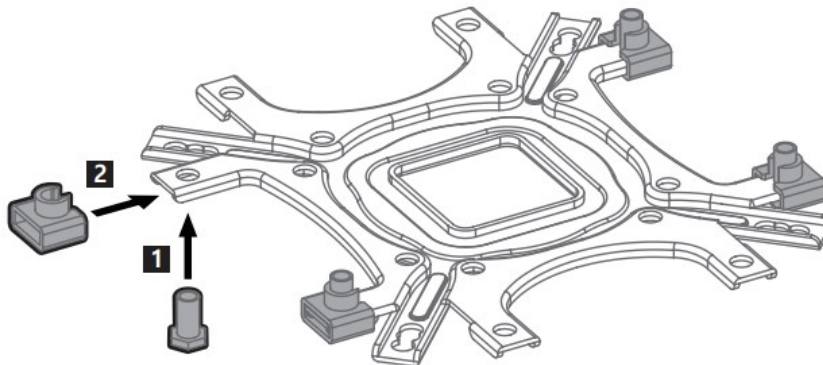

Caution

Take note of the orientation of the nuts and the side caps

INTEL, AMD Loading Block

1. Intel



Loading Block(Intel)

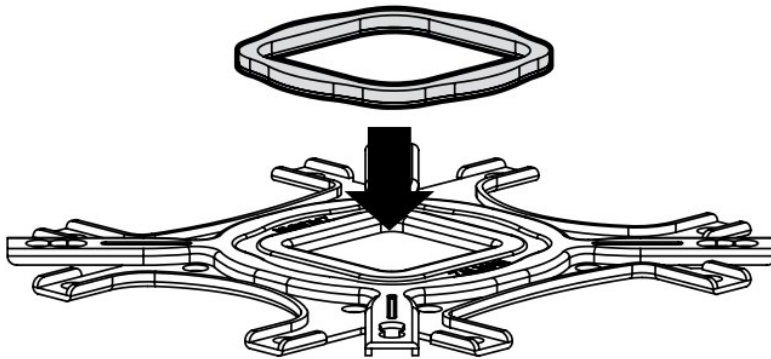

2. AMD



Loading Block(AMD)

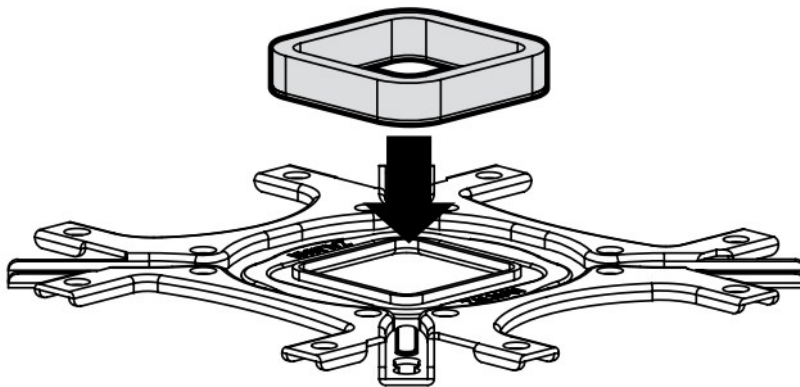

Caution

Remove the tape cover of loading block and attach it to the backplate

Intel Users

1. LGA2066 / 2011-V3 / 2011



Stand-offs(B)



Intel Guide



Stand-off Nuts

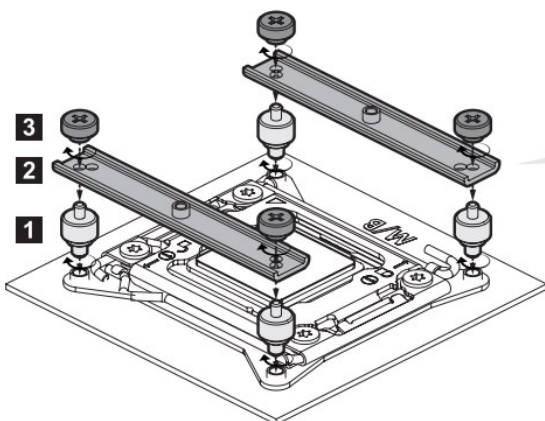

2) Nuts Position





Caution

Backplate is not needed for LGA2066 / 2011-V3 / 2011 sockets.

4



Thermal Compound

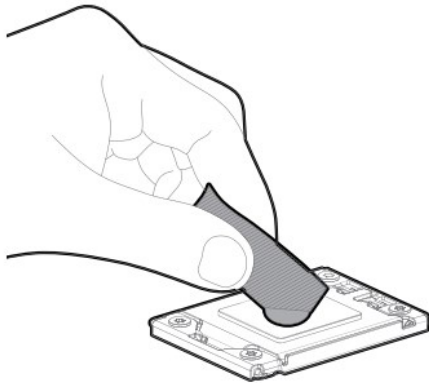

5

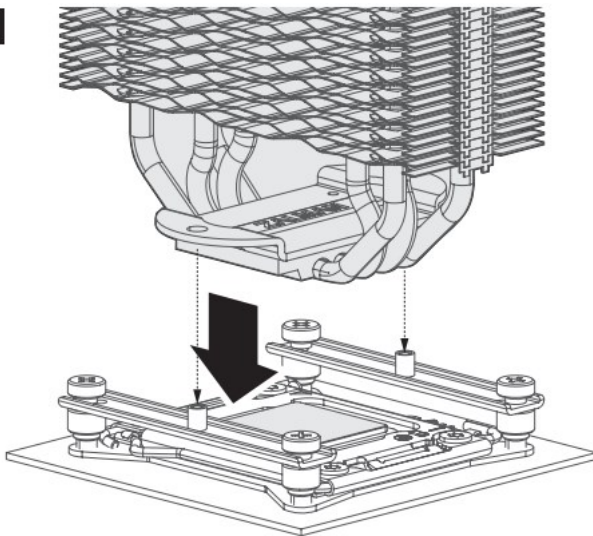

Fixing Bolts

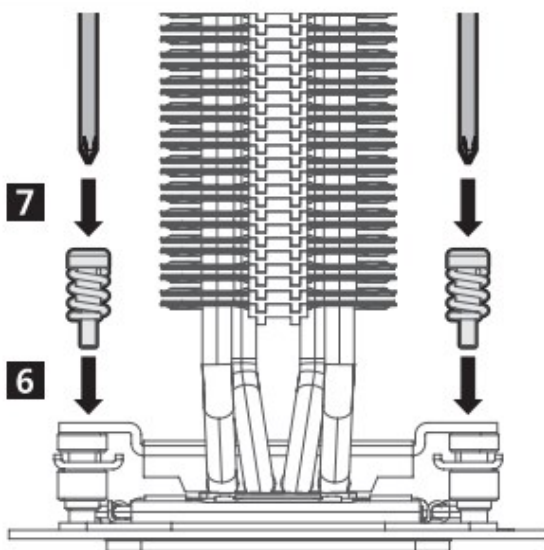

Detail Image

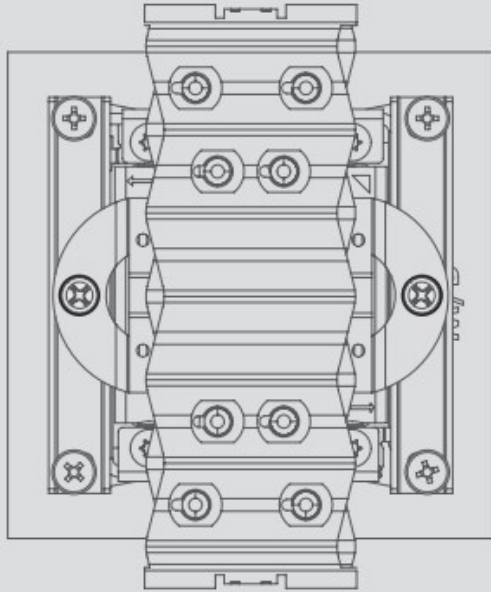

Caution

Screw-in both bolts in an alternating fashion until they are completely tightened.

8



Fan + Guide

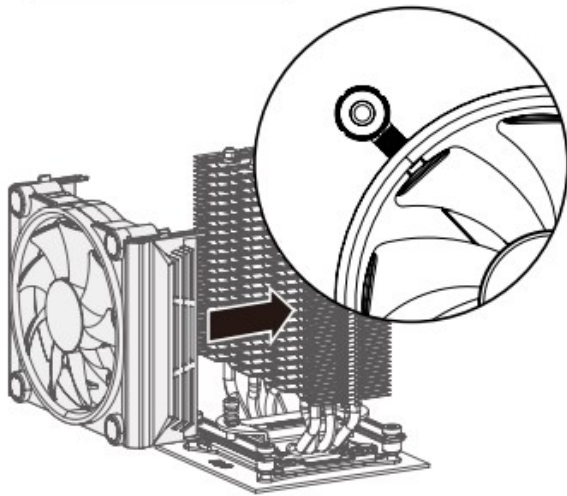

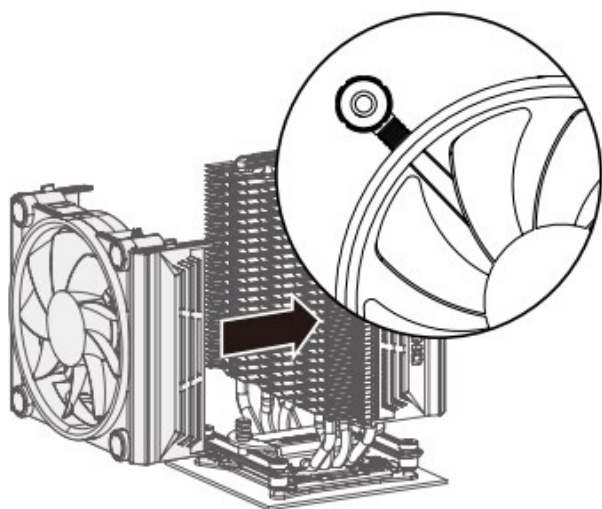
9**Fan + Guide(Reverse)****Caution**

Please check the direction of the fan before installation.

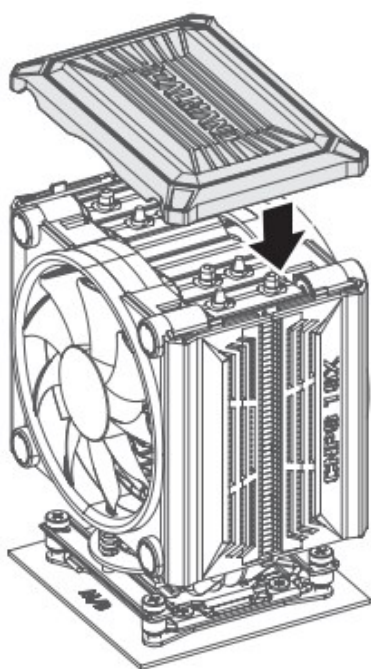
10**Top LED Cover**

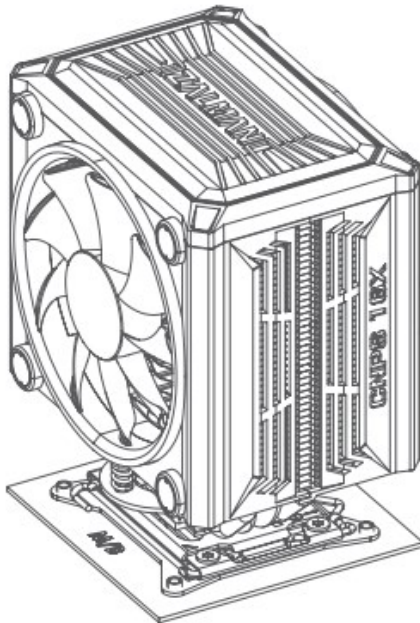

2. LGA115X

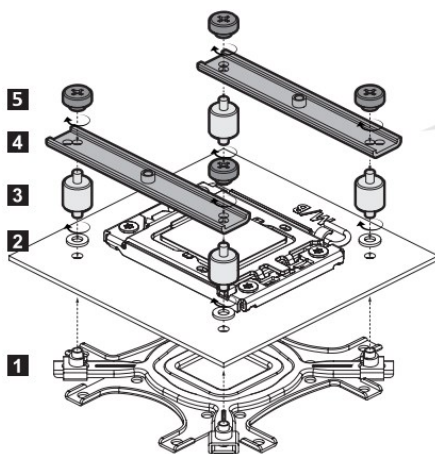

3) Nuts Position



6



Thermal Compound

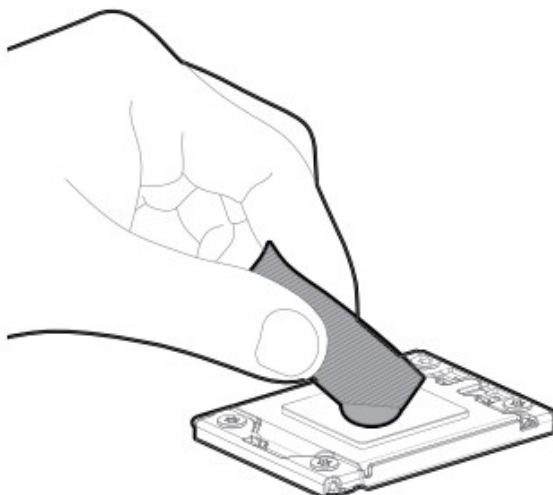

7

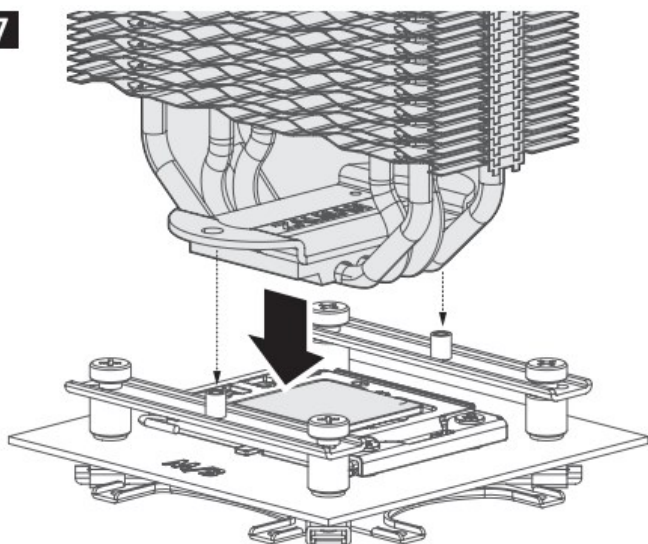

 Fixing Bolts

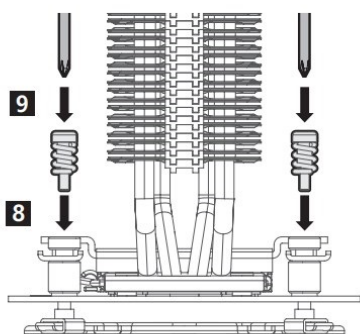

Detail Image

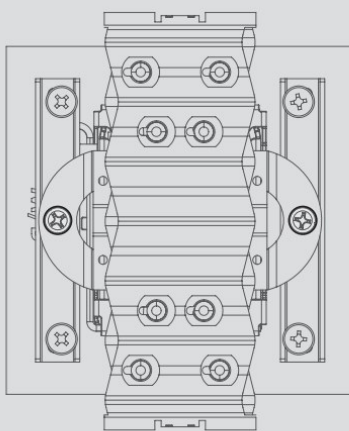

Caution

Screw-in both bolts in an alternating fashion until they are completely tightened.

10



Fan + Guide

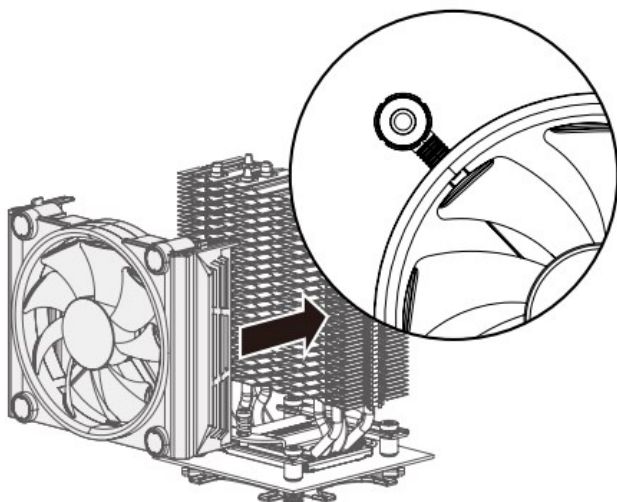

11

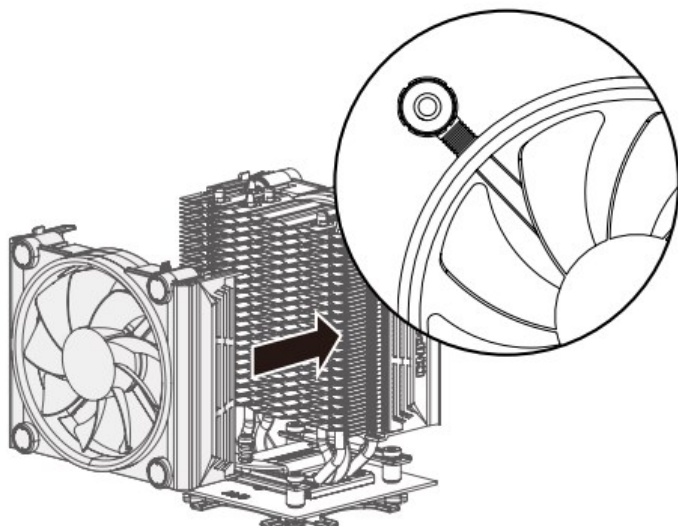

Fan + Guide(Reverse)

**Caution**

Please check the direction of the fan before installation.

12



Top LED Cover

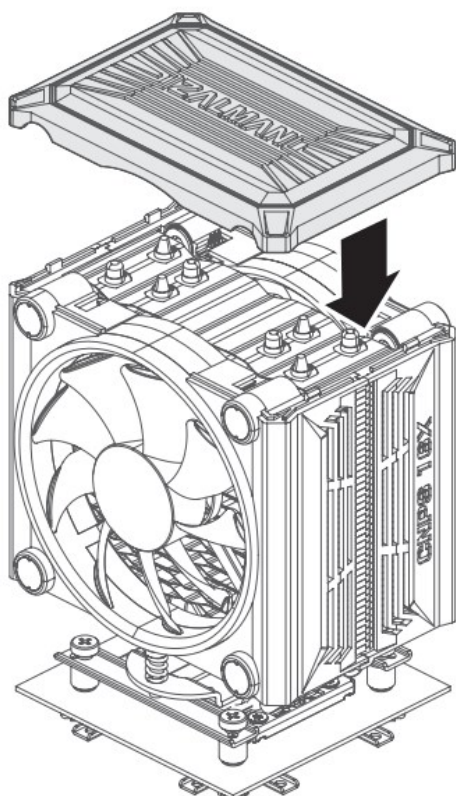

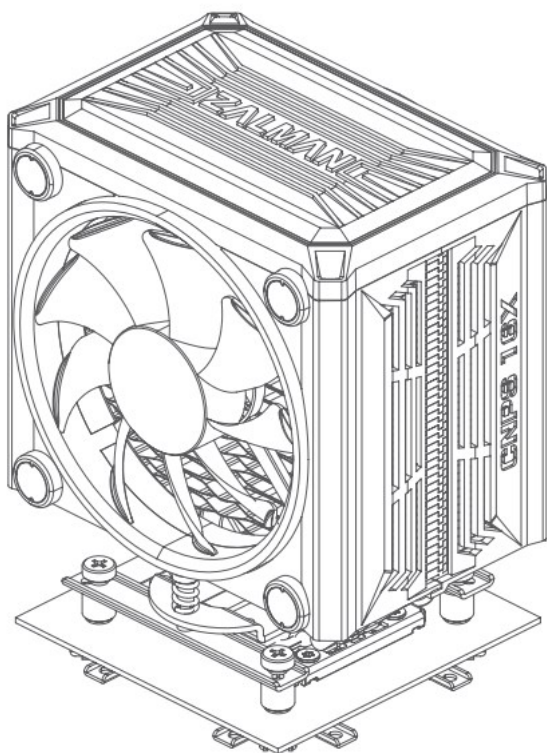

AMD Userse

1. AM3 / AM4

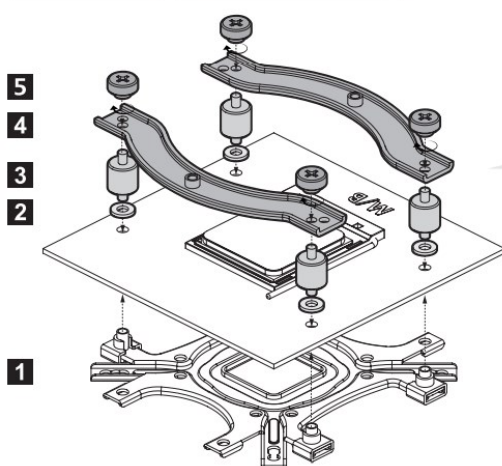

2) Nuts Position AM3

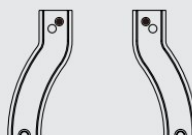

AM4

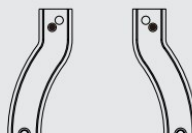

Caution

Please be cautious for the direction of AMD Guide installation

6



Thermal Compound



7

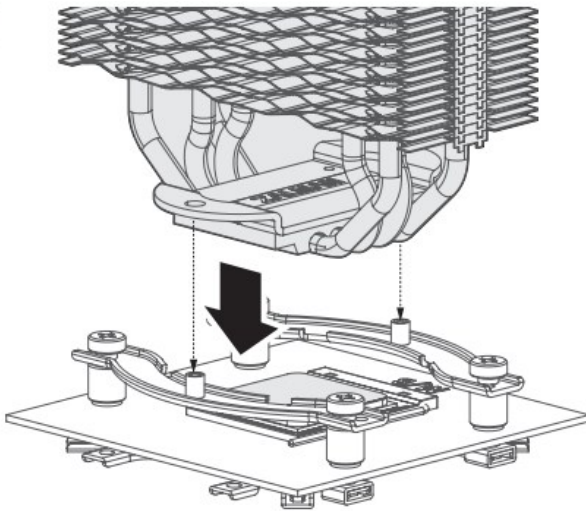

Fixing Bolts

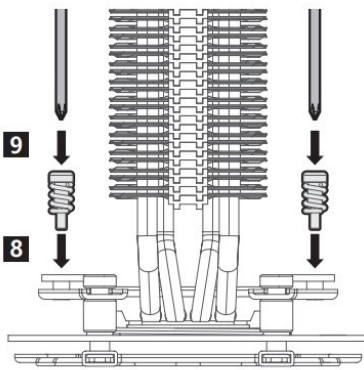

Detail Image

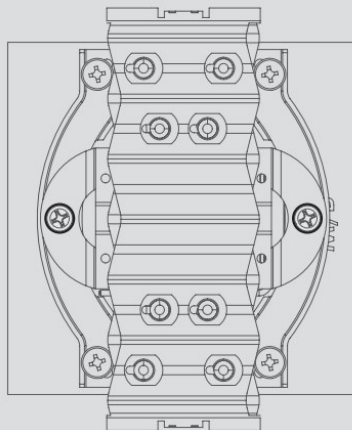
**Caution**

Screw-in both bolts in an alternating fashion until they are completely tightened.

10

Fan + Guide

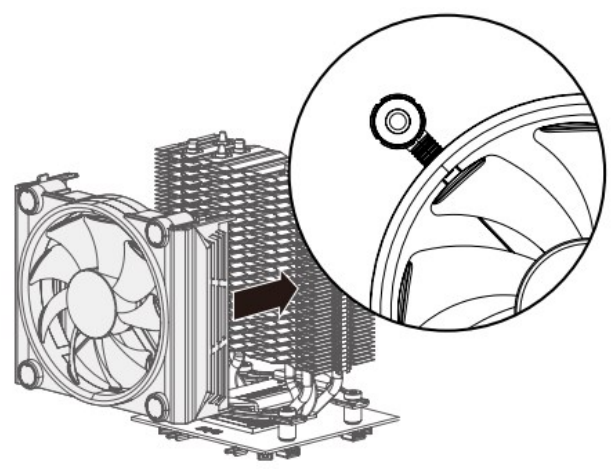

11

Fan + Guide(Reverse)

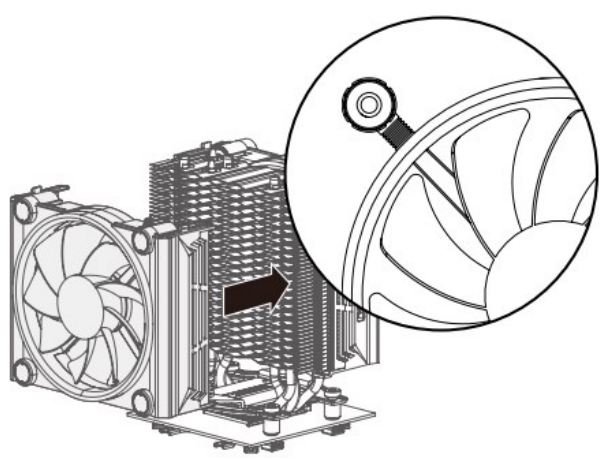

Caution

Please check the direction of the fan before installation

12



Top LED Cover

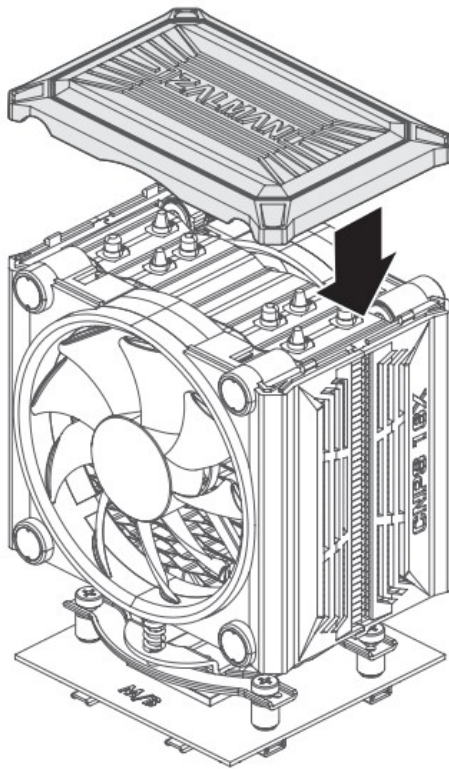

13

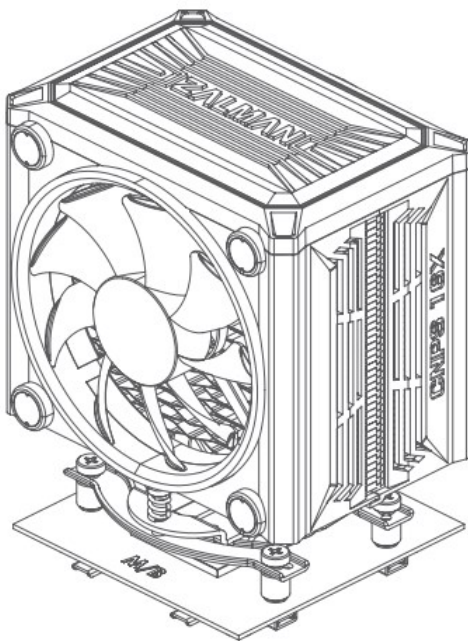

Cable Connection

1. Connection to other motherboards

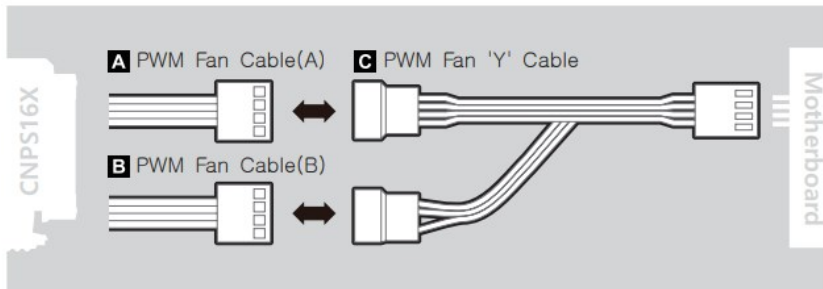
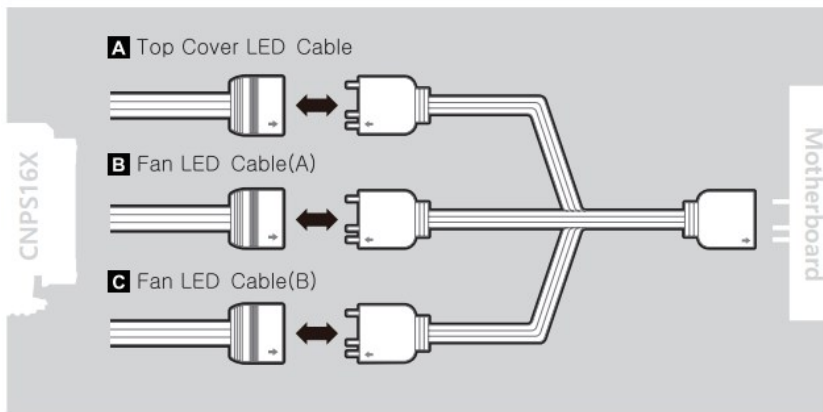

2. Connection to Gigabyte motherboards

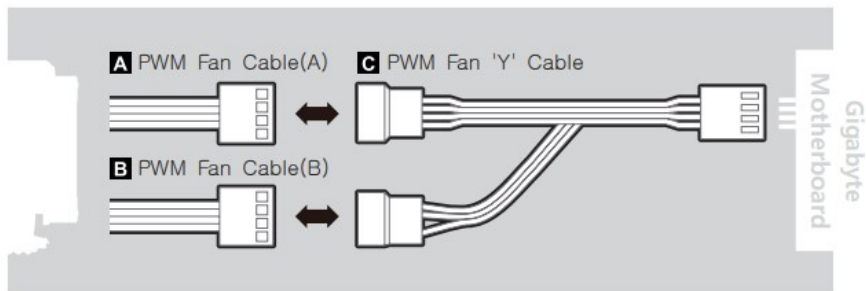
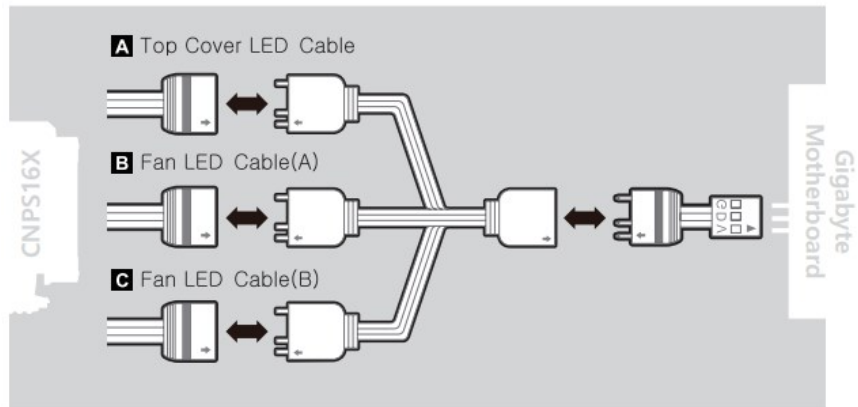

Fan Specifications

Model : LF120

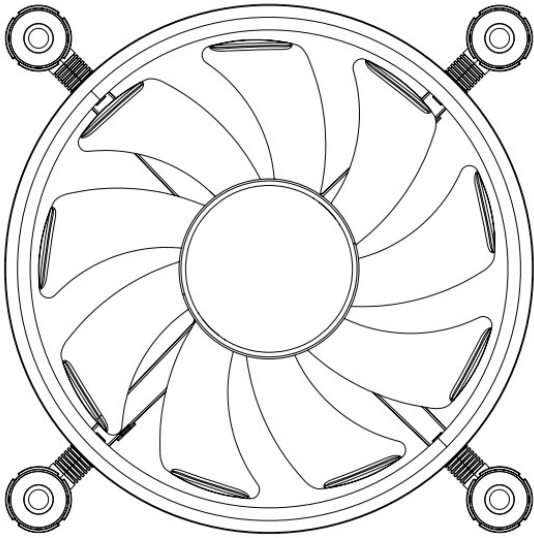

- **Dimensions** : 120 x 120 x 26(H)mm
- **Fan Speed** : 800 ~ 1,500 $\pm 10\%$ RPM
- **Max Noise Level** : 27 dB(A) $\pm 10\%$
- **Bearing Type** : EBR Bearing
- **Max Airflow** : 49 CFM $\pm 10\%$
- **Max Air Pressure** : 1.21mmH₂O
- **Pin Connector** : 4-Pin (PWM), 3-Pin (Addressable)
- **Rated Voltage** : 5~12 V DC
- **Life Span** : 50,000 hours

Model : LF120 (Reverse)

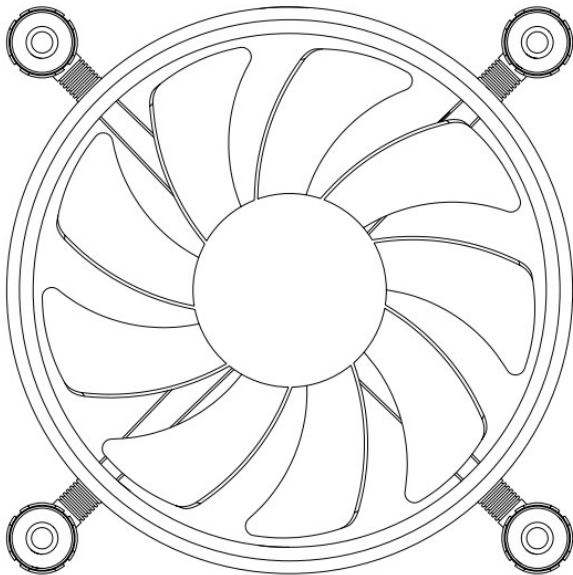

- **Dimensions** : 120 x 120 x 26(H)mm
- **Fan Speed** : 800 ~ 1,500 $\pm 10\%$ RPM
- **Max Noise Level** : 27 dB(A) $\pm 10\%$
- **Bearing Type** : EBR Bearing
- **Max Airflow** : 49 CFM $\pm 10\%$
- **Max Air Pressure** : 1.21mmH₂O

- **Pin Connector** : 4-Pin (PWM), 3-Pin (Addressable)
- **Rated Voltage** : 5~12 V DC
- **Life Span** : 50,000 hours



This mark, designed by Zalman, indicates product compliance with the European Union's RoHS (Restriction of Hazardous Substances) Directive.



Disposal of Old Electrical & Electronic Equipment (Applicable in the European Union and other European countries with separate collection systems)



www.zalman.com

Documents / Resources

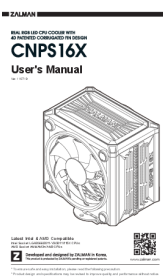
	<p>ZALMAN CNPS16X Real RGB LED CPU Cooler with 4D Patented Corrugated Fin Design [pdf] User Manual</p> <p>CNPS16X Real RGB LED CPU Cooler with 4D Patented Corrugated Fin Design, CNPS16X, Real RGB LED CPU Cooler with 4D Patented Corrugated Fin Design, Real RGB LED CPU Cooler, RGB LED CPU Cooler, LED CPU Cooler, CPU Cooler, Cooler</p>
---	--

References

- zalman.com