

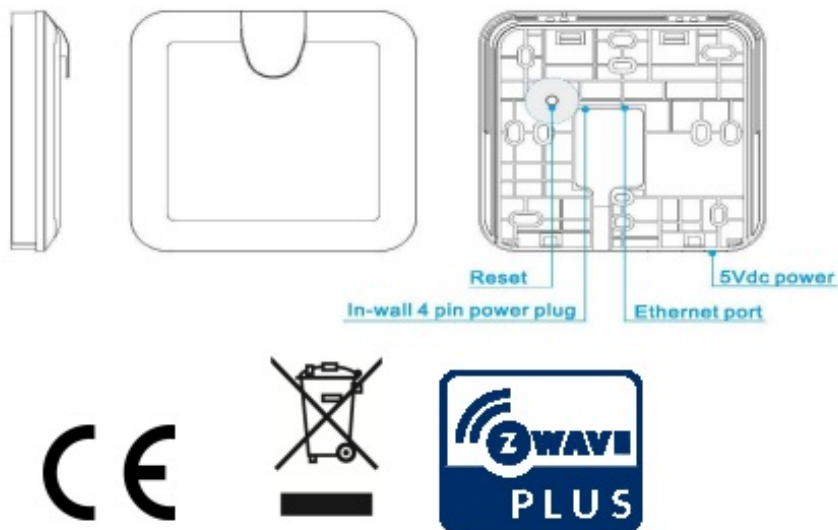

Z-Wave PSC03 Gateway User Manual

[Home](#) » [Z-Wave](#) » Z-Wave PSC03 Gateway User Manual 

GatewayPSC03



Introduction:

The PSC03 Smart Wireless Network Gateway Controller makes it easy and fast to set up a Z-Wave automation system. Do not need a tedious setup, just connect the power and connect the network modem in the home, then scan the QR code on the body of the box through the APP that is downloaded and installed on the mobile phone or tablet to complete the installation. You can easily include other wireless sensors or light control devices to immediately enjoy smart home automation. PSC03 uses the Z-Wave 500 series chip modules, not only has higher transmission efficiency and lower power consumption, and supports AES 128 bits encryption and a longer transmission distance. The PSC03 controller has two network operating modes, AP and STA. When working in AP mode, the controller can connect to a home network modem and provide wireless network signals to other wireless network devices. The STA mode allows the smart wireless network gateway controller to connect to existing wireless networks by means of wireless. and greatly increase the convenience of use.

PSC03 Function Compare:

	PSCO3-1A	PSCO3-1B	PSCO3-1C	PSCO3-1D	PSCO3-1E
SIREN	V				
USB Function	V	V		V	V
Battery	Option			Option	
Top case	Normal	Slim type	Slim type	Slim type	Slim type
Jump Wires		V			

Contents

- 1 Specification
- 2 CAUTION
- 3 Troubleshooting
- 4 For Instruction to <http://www.philio-tech.com>Getting Started
- 5 Getting Started
- 6 Setup Devices
- 7 Scenes
- 8 Macros
- 9 Advanced Function/Setting
- 10 Settings
- 11 Over The Air (OTA) Firmware Update
- 12 FCC Interference Statement
- 13 Documents / Resources
- 14 Related Posts

Specification

Rated	DC5V 1A or 2A from adapter Backup battery 3.7Vdc 1150mAh (Li-battery)
RF distance (Z-wave)	Min. 40M indoor, 100M outdoor line of sight,
RF Frequency (Z-wave)	868.40 MHz, 869.85 MHz (EU) 908.40 MHz, 916.00 MHz (US) 920.9MHz, 921.7MHz, 923.1MHz (TW/KR/Thai/SG)
RF Maximum Power	+5dBm
RF Frequency (Wi-Fi)	Wi-Fi IEEE 802.11 b/g/n
RF Maximum Power	+20dBm
Location	indoor use only
Operation temperature	0 to 40 C
Humidity	85%RH max
FCC ID	RHHPSCO3

Specifications are subject to change and improvement without notice.

CAUTION

— replacement of a battery with an incorrect type that can defeat a safeguard (for example, in the case of some lithium battery types); — disposal of a battery into fire or a hot oven, or mechanically crushing or cutting of a battery, that can result in an explosion; — leaving a battery in an extremely high temperature surrounding environment that can result in an explosion or the leakage of flammable liquid or gas; — a battery subjected to the extremely low air pressure that may result in an explosion or the leakage of flammable liquid or gas

The marking information is located at the bottom of the apparatus.

Troubleshooting

Symptom	Cause of Failure	Recommendation
The device can not join to the 7-Wave™ network	The device may be in a Z-Wave™ network.	Exclude the device then include it again.

For Instruction to <http://www.philio-tech.com>



Getting Started

1. Install APP “Home Mate2”

Please download the “Home Mate 2” App from Google/App stores



Home Mate2



iOS



Android

2. Power up the gateway

Connect the gateway to the WiFi router via Ethernet cable and power on the device with AC cable; the white LED in the front cover will be ON as confirmation of connecting to the Internet.

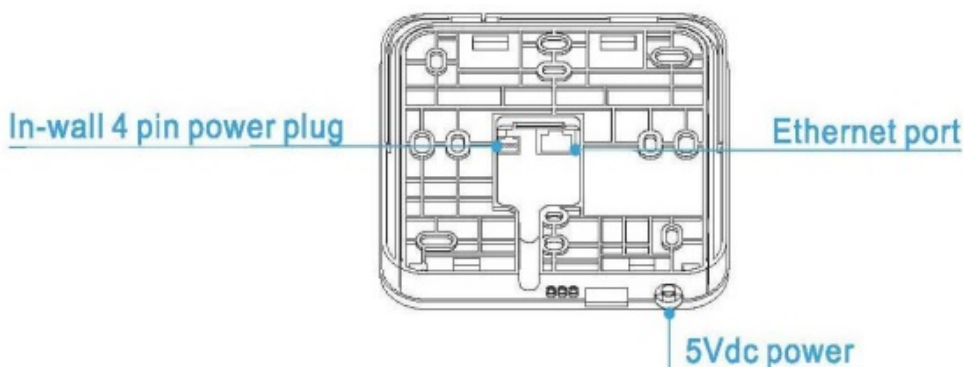

Getting Started

3. Find Gateway

Launch the " Home Mate 2" App, press the search button connecting to the gateway, and retrieve the gateway's UID. Or you can scan the QR code directly to retrieve the gateway UID and then key in the default password " 888888".

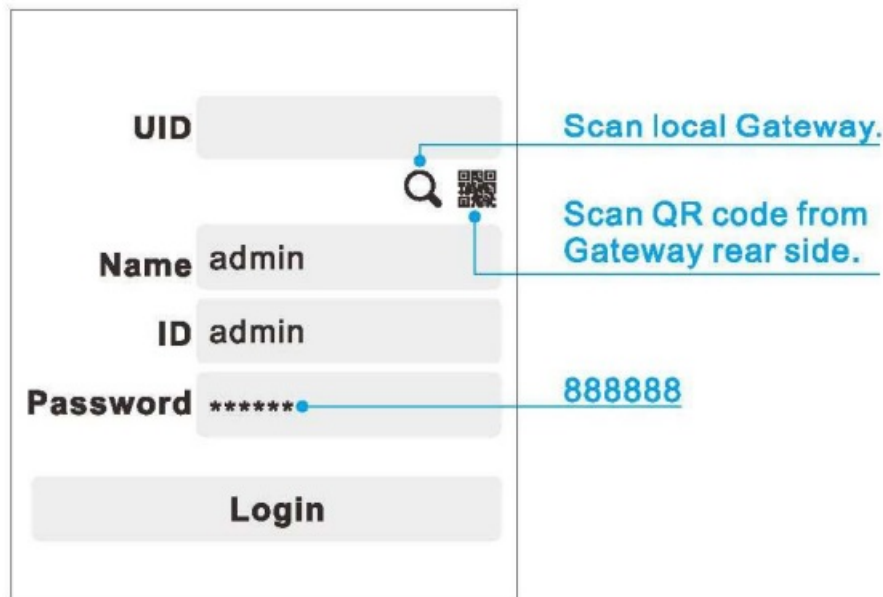

The screenshot shows the login interface of the Home Mate 2 app. It features four input fields: 'UID' (empty), 'Name' (pre-filled with 'admin'), 'ID' (pre-filled with 'admin'), and 'Password' (pre-filled with '*****'). A 'Login' button is at the bottom. Annotations with blue lines point to specific elements: 'Scan local Gateway.' points to a magnifying glass icon next to the UID field; 'Scan QR code from Gateway rear side.' points to a QR code icon next to the UID field; and '888888' points to the password field.

Getting Started

4. Reset function

If the Gateway setting is done and you would like to carry Gateway to a new place, press the reset button as below, Press I Os then release, Gateway will reset. Follow Getting Started step 1 again you will set done in a new place.

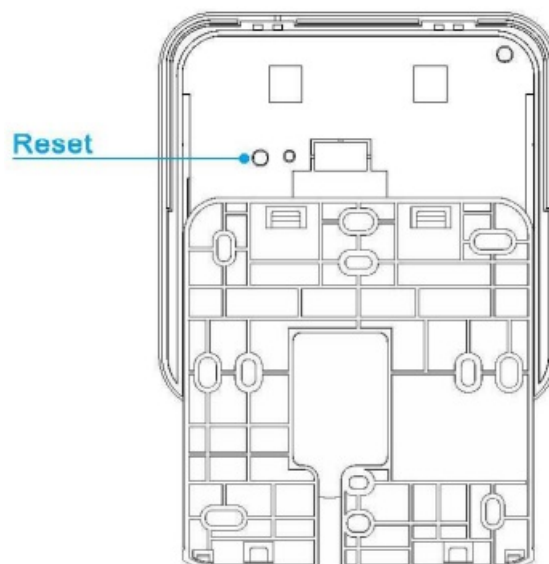

Setup Devices

1. To add sensor devices or WiFi IF' camera by pressing the " + " on the "Devices" page



2. Select "Include Device" > press "START INCLUSION" (the gateway LED will be flashing_ as confirmation to proceed in inclusion mode)



3. To press the include button on each sensor device (see below remarks)
4. Once completed inclusion: You could appoint sensors in different rooms by adding "+" new rooms.

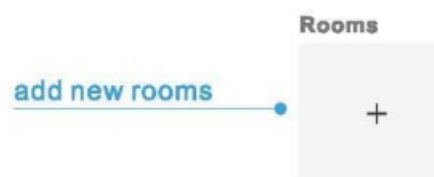

This block right side as name and status, click right side to control device, click the left side to setup advance setting.

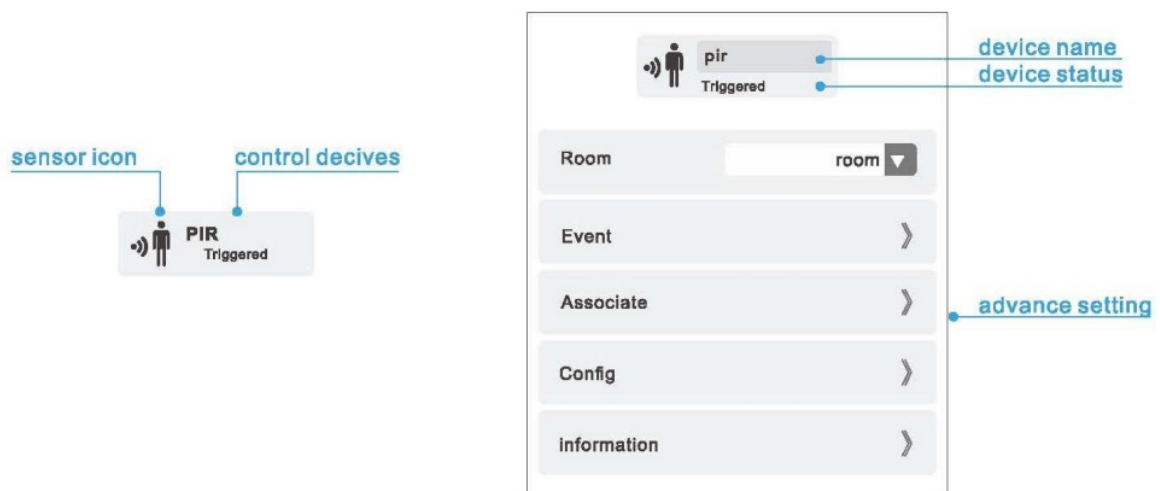

5. To exclude devices: go to "Settings" page-->Other Settings->Include/Exclude, press the "START EXCLUSION" ->wait for gateway LED flashing (App start countdown), then press the button (as remark above) on the sensor devices (same button behavior as inclusion).

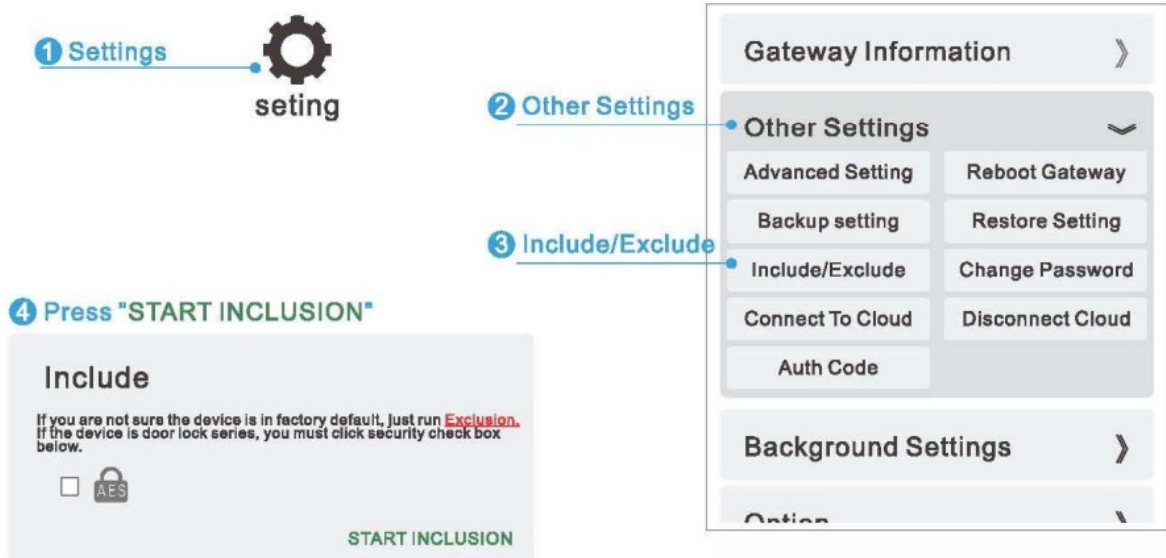

Remark: Or you may exclude the device via the below shortcut

1 .In "Devices" page —> Press the "+"



2. Select "Include Device" —> Press "Exclusion" (the gateway LED will be flashing as confirmation to proceed in exclusion mode)



3. To press the exclude button (same button & method as inclusion) on each sensor device

Noted:

Gateway LED: flash 2 times in 1 second as confirmation to exclude the device Gateway LED: flash 1 time in 1 second as confirmation to exclude the device



Scenes

Press the " + " button to add the new Scenes, you may change the scenes icon/name as you wish and select devices you would like to add.

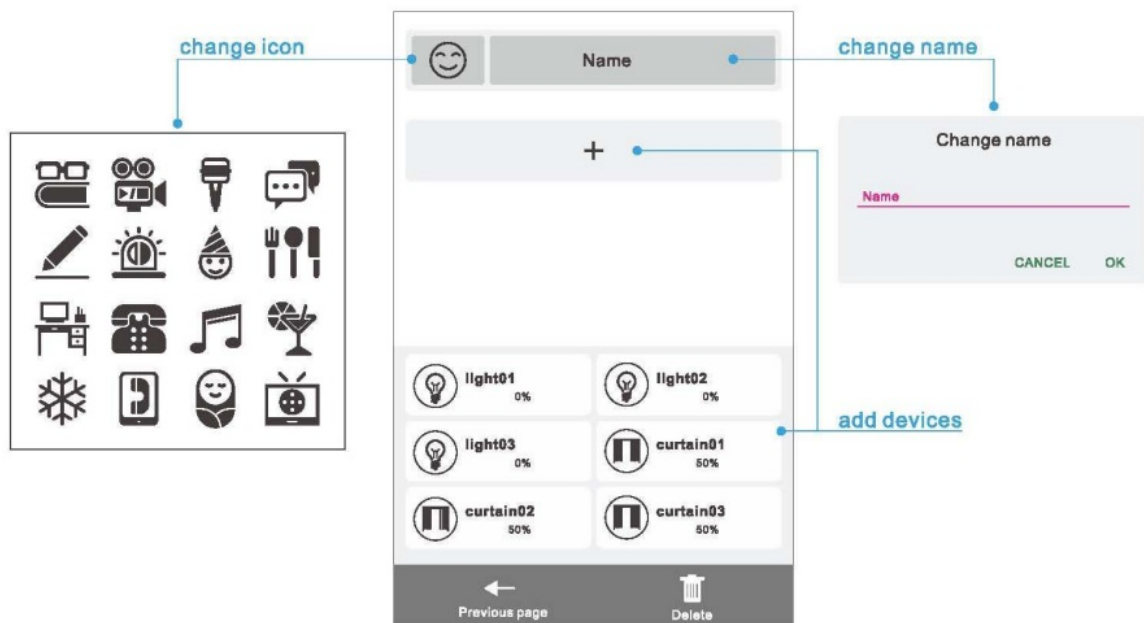

Macros

Press the + " button to add the new Macros group, you may change the macros Icon/name as you wish and set up the scenario with If and Then or Option criteria.

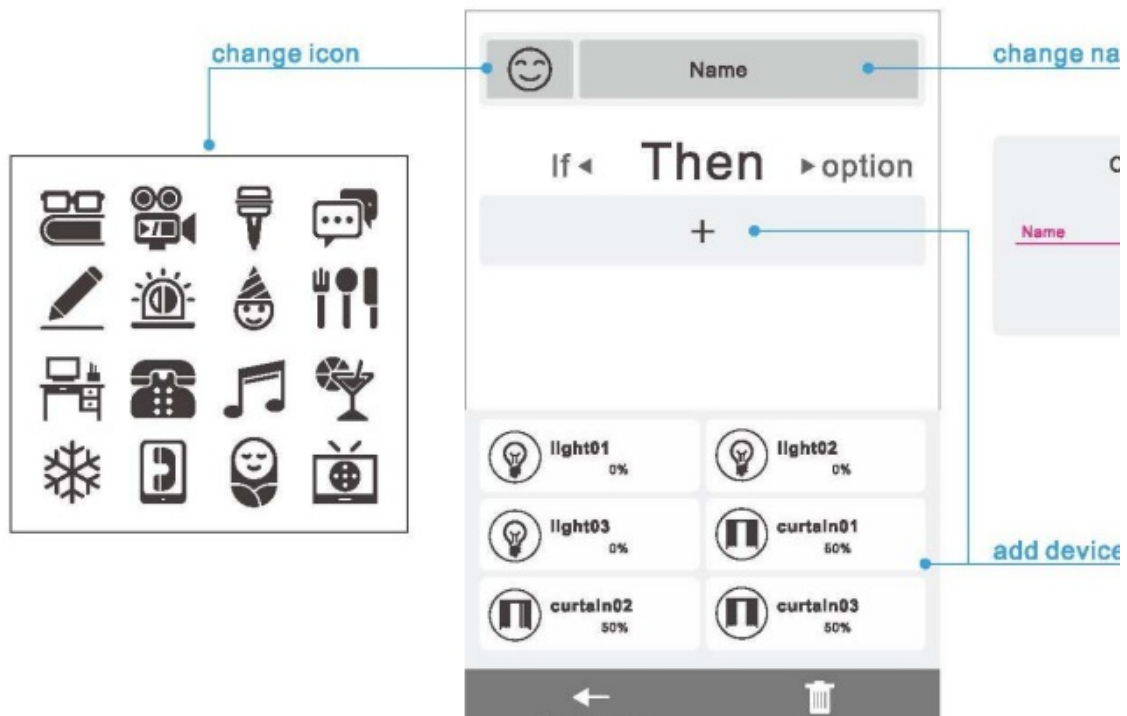

Advanced Function/Setting

• Associate function:

The gateway is as a console to communication/control sensor devices included. However, the individual sensors could be associated with each other and communicate directly without waiting for further commands from Gateway to speed up the response time. For example, you may the dimmer switch could be controlled by the gateway side and also the smart button.



2. Re-configuration Function:

You may change the default setting according to your demand. For example, the sensitivity default setting is 80. You may lower the sensitivity to 50 by keying in below new figures.

PIR Sensitivity	Default	Parameter	Value
	80	2	0~99

PIR sensitivity settings.
 0 means disable the PIR motion.
 1 means the lowest sensitivity.
 99 means the highest sensitivity

High sensitivity means can detected long distance but if there is more noise signal in the environment, it will re-trigger too frequency.

Notice:

1. All of the configurations, the data size is
2. The configuration mark with stern means after the remove the setting still keep, don't reset to factory default. Unless the user executes the 'RESET- procedure.
3. The reserved bit or not supported bit is allowed any value, but no effect.

Settings

In the setting page, you could retrieve App and the gateway's detailed information by clicking on each option.

If you would like to receive the E-mail notification, please fill in your E-mail address/password in columns shown below.

User Information

User

Email

Password

Commit

You may select different background from default or take new photo as background by ourselves.

Over The Air (OTA) Firmware Update

The device supports the Z-Wave firmware update via OTA. Let the controller into the firmware update mode, and then wake up the device to start the update.

After finishing the firmware download, the LED will start flash in every 0.5 seconds. Wait for the LED stop flash, the firmware update is succeeded.

Caution: Do not run the OTA when the battery is running low.

Disposal



This marking indicates that this product should not be disposed of with other household wastes throughout the EU. To prevent possible harm to the environment or human health from uncontrolled waste disposal, recycle it responsibly to promote the sustainable reuse of material resources. To return your used device, please use the return and collection systems or contact the retailer where the product was purchased. They can take this product for environmentally safe recycling.

Philio Technology Corporation

SF., No.653-2, Zhongzheng Rd., Xinzhuang Dist., New Taipei City 24257, Taiwan(R.O.C)

www.philio-tech.com

FCC Interference Statement

This equipment has been tested and found to comply with the limits for a Class B digital device, pursuant to Part 15 of the FCC Rules. These limits are designed to provide reasonable protection against harmful interference in a residential installation. This equipment generates, uses, and can radiate radio frequency energy and, if not installed and used in accordance with the instructions, may cause harmful interference to radio communications. However, there is no guarantee that interference will not occur in a particular installation. If this equipment does cause harmful interference to radio or television reception, which can be determined by turning the equipment off and on, the user is encouraged to try to correct the interference by one of the following measures:

- Reorient or relocate the receiving antenna.
- Increase the separation between the equipment and receiver.
- Connect the equipment into an outlet on a circuit different from that to which the receiver is connected.
- Consult the dealer or an experienced radio/TV technician for help.

This device complies with Part 15 of the FCC Rules. Operation is subject to the following two conditions:

- (1) This device may not cause harmful interference, and
- (2) This device must accept any interference received, including interference that may cause undesired operation.

FCC Caution: Any changes or modifications not expressly approved by the party responsible for compliance could void the user's authority to operate this equipment.

This transmitter must not be co-located or operating in conjunction with any other antenna or transmitter. I A be LL

Warning

Do not dispose of electrical appliances as unsorted municipal waste, use separate collection facilities. Contact your local government for information regarding the collection systems available. If electrical appliances are disposed of in landfills or dumps, hazardous substances can leak into the groundwater and get into the food chain, damaging your health and well-being.

When replacing old appliances with new ones, the retailer is legally obligated to take back your old appliance for disposal at least for free of charge.

Documents / Resources



[Z-Wave PSC03 Gateway](#) [pdf] User Manual
PSC03, Gateway