



Yun Yun Ai YYCBV3 Cubo AI Baby Monitor User Manual

[Home](#) » [Yun Yun Ai](#) » Yun Yun Ai YYCBV3 Cubo AI Baby Monitor User Manual 



Quick Start Guide

Contents

- [1 Cubo at a Glance](#)
- [2 Status Light Color Reference](#)
- [3 In the box](#)
- [4 Choose your Set-up](#)
- [5 A Floor Stand](#)
- [6 B Curb Attachment](#)
- [7 C Mobile Stand](#)
- [8 Documents / Resources](#)
- [9 Related Posts](#)

Cubo at a Glance

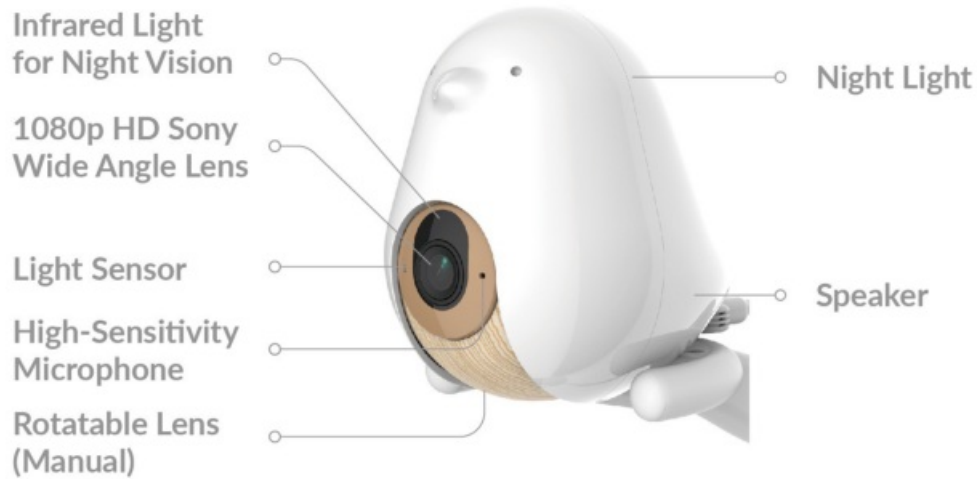



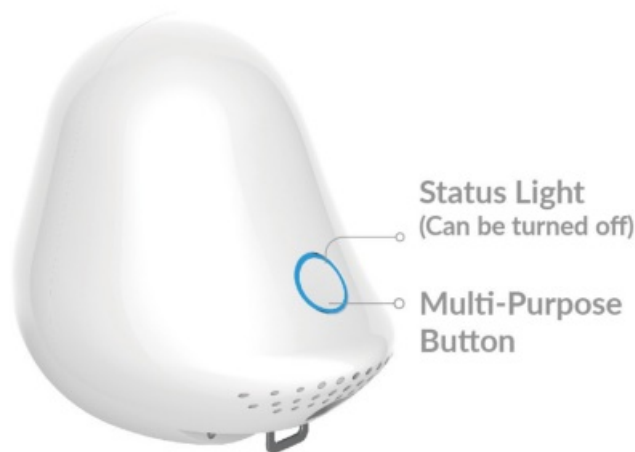



Status Light Color Reference



Sleep Mode

To enter sleep mode, hold the button for 3 seconds until you hear the beep. Press the button once to resume activity.

Night Light: Press the button once to turn on and off the night light

			
Solid White Starting up	Solid Green Working properly, not streaming	Solid Blue Streaming video	Solid Red WiFi Disconnected
			
Pulsing Green Sleep mode	Pulsing White Ready to connect	Blinking White/Green Connecting to WiFi	

In the box

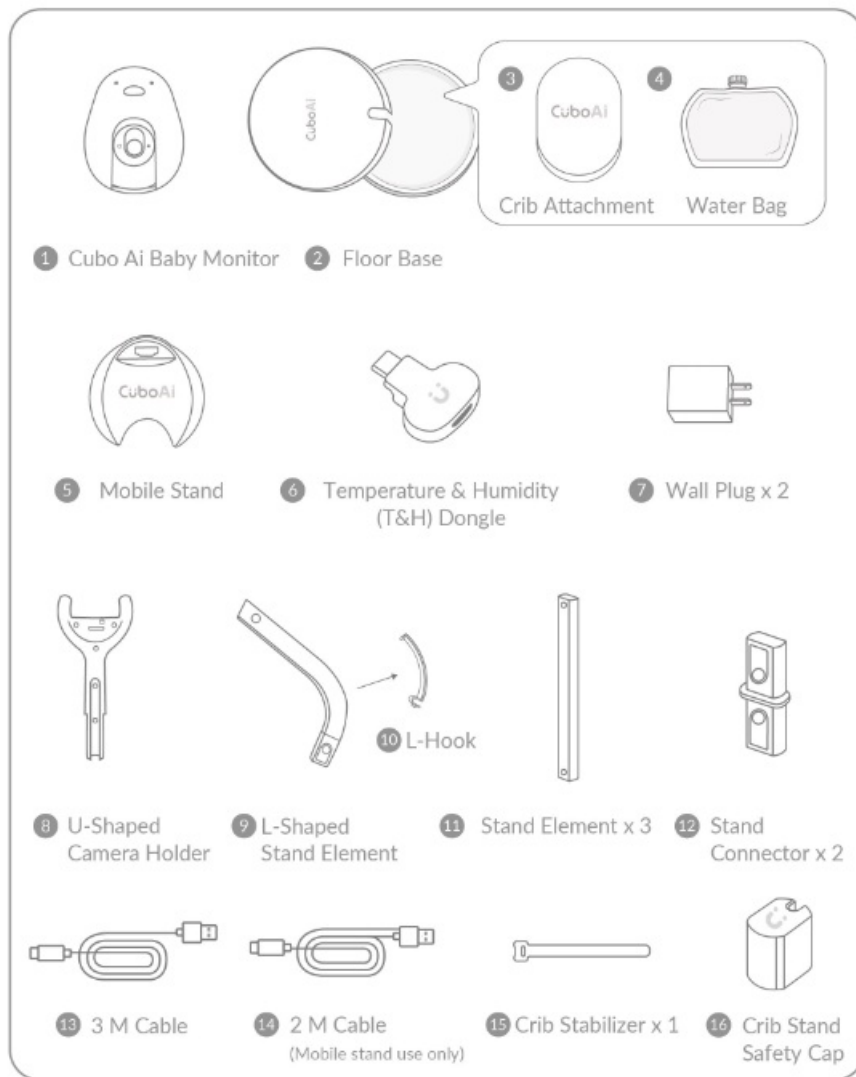

Choose your Set-up

Please follow the instructions according to your desired stand type

A Floor Stand



- Cubo Ai Baby Monitor
- Floor Base

- Water Bag
- T&H Dongle
- Wall Plug
- U-shaped Element
- L-shaped Element
- L-Hook
- Stand Element x 3
- Stand Connector x 2
- 3 M Cable
- Crib Stabilizer

B Crib Attachment



1. Cubo Ai Baby Monitor
2. Crib Attachment
3. T&H Dongle
4. Wall Plug
5. U-shaped Element
6. L-shaped Element
7. L-Hook
8. Stand Element x 3
9. Stand Connector x 2
10. 3 M Cable
11. Crib Stabilizer
12. Crib stand safety cap

C Mobile Stand



1. Cubo Ai Baby Monitor
2. Mobile Stand
3. T&H Dangle
4. Wall Plug
5. 2 M Cable

A Floor Stand

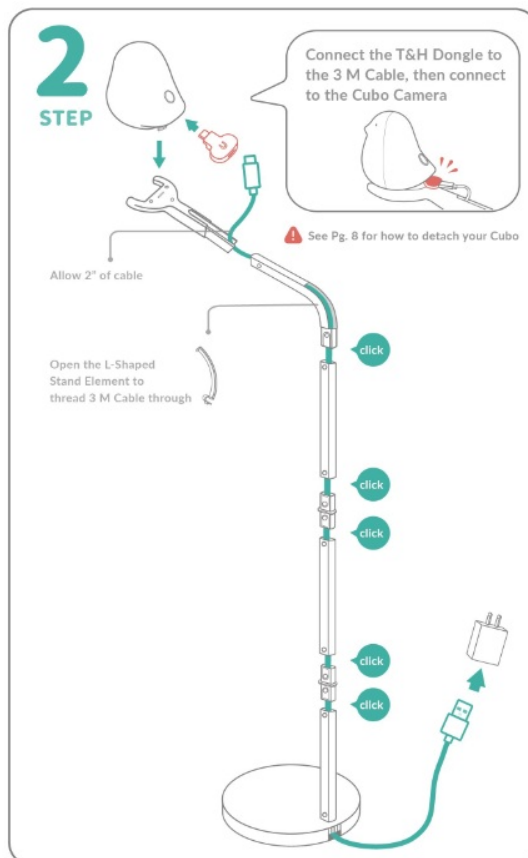
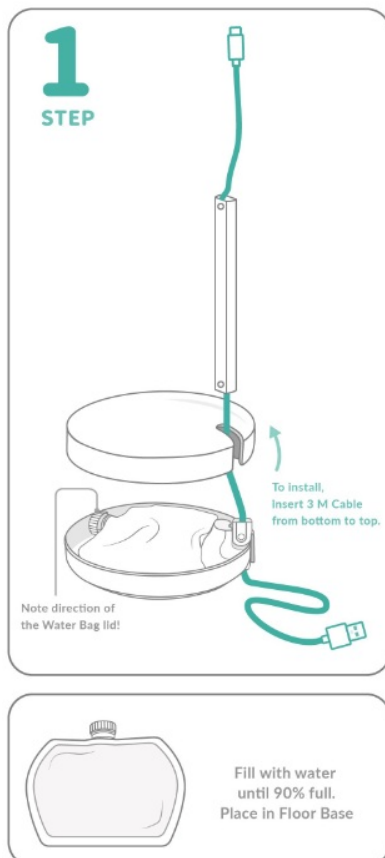

B Curb Attachment

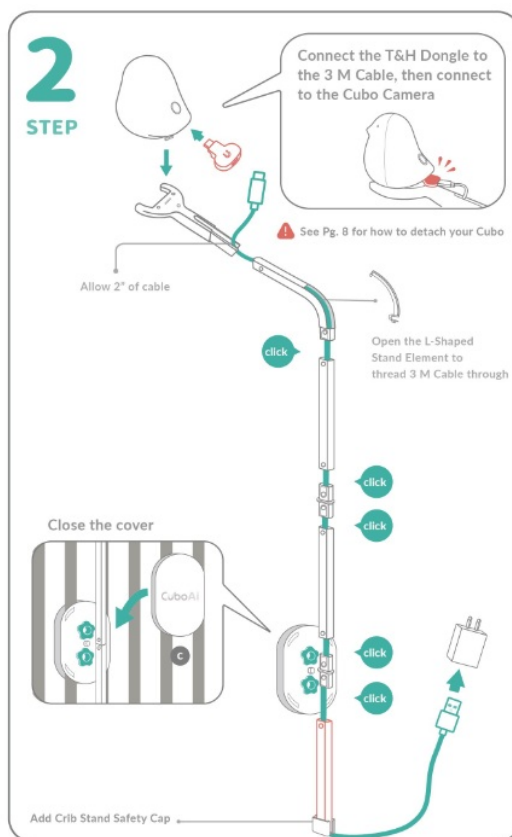
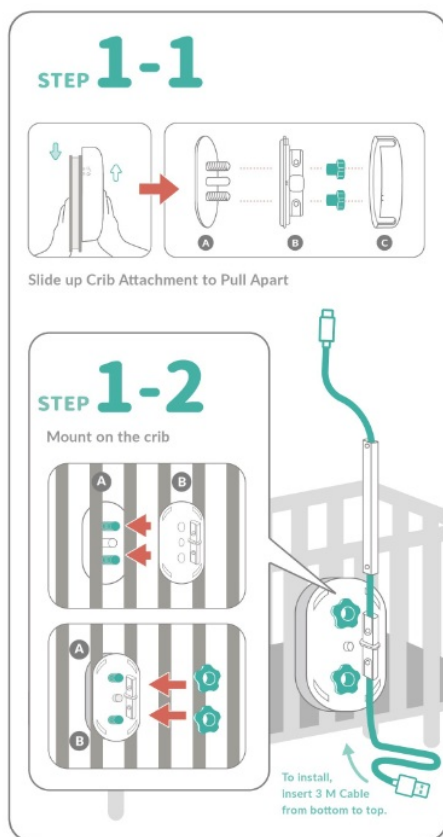

C Mobile Stand

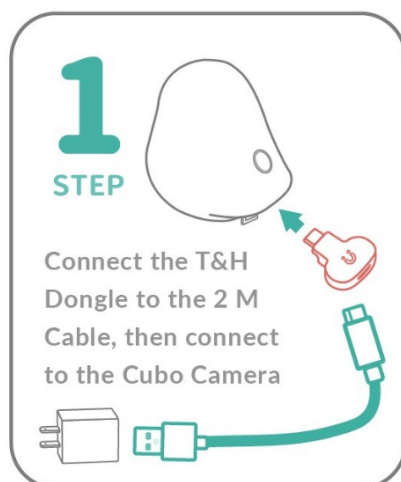

<https://qrco.de/bbTs5L>
Scan to watch video Tutorial

Removing Cubo from the Camera Holder

1. Release the Safety Lock

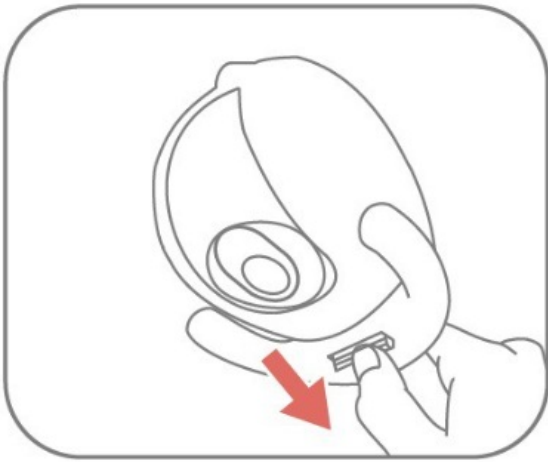

2. Lift Cubo upward from the Camera Holder

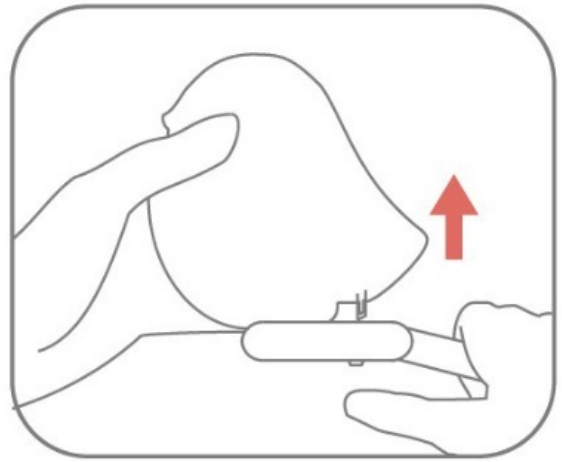

Removing the Stand from the Floor Base

1. Open the round Floor Base

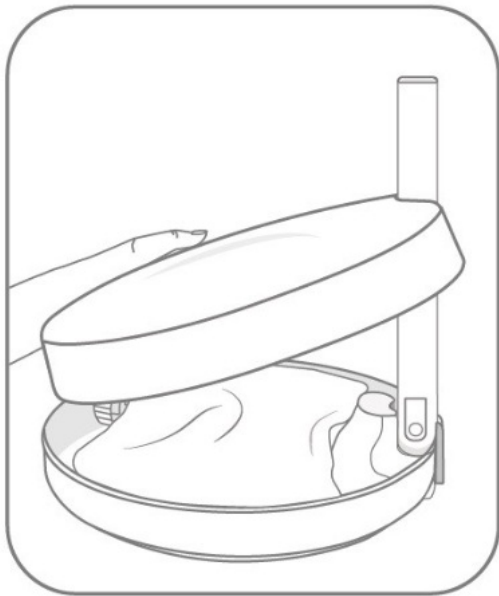

2. Press button to release, pull the Stand Element upward

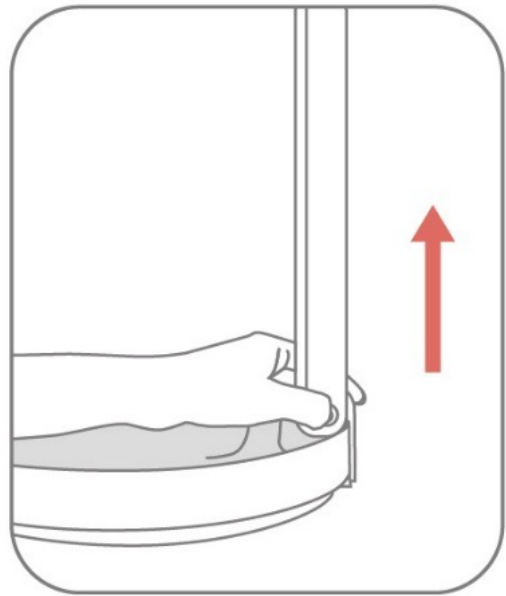

WiFi Connectivity

Make sure your WiFi speed is at least 5Mbps

- Test your connection speed by standing next to your Cubo and heading to <https://fast.com/> while connected to your WiFi.
- If your WiFi speed is less than 5Mbps you may need to contact your Internet provider to improve your internet connectivity.

For more details please scan:



<https://qrco.de/bbTs5L>

Arrange a safe crib environment

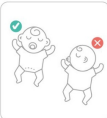
 	<p>Clear the crib!</p> <ul style="list-style-type: none">✓ Don't add bumper pads to the bed rail, sleep in the same room as the baby. but not in the same bed✓ Avoid using pillows, toys, and blankets, wear a onesie to reduce the chance of accidental face coverage✓ The mattress should be hard enough so that baby's face won't sink in <p>Sleeping on the back is safest!</p> <p>Tummy sleeping could lead to indirect suffocation and cause hazards such as reduction in blood oxygen, increase in body temperature, and impact the autonomic nervous system.</p>
--	--

Compliance and Precautions

1. Cubo Ai Baby Camera is not a medical device and should not be used as a SIDS (Sudden Infant Death Syndrome) prevention tool. This is only a tool for caregivers to monitor their babies; the caregivers must check the baby's condition regularly. for premature or potentially ill infants, this product should be used under the direction of a doctor or a medical professional. For more details, please refer to the product website or the terms of use and privacy policy on the App.
2. Please install Cubo according to the instructions in the instruction manual. If the Cubo camera and bracket are installed properly, it may prevent unnecessary accidents. Please follow the instructions in the manual. Product name: Cubo Ai Smart Baby Monitor; Model: Angel Input 100-240V. Output: 5V2A, 2.4/5GHz Wi-Fi Yun Yun AI Baby camera Co., Ltd. 8F.-7, No. 2, Ln. 150, Sec. 5, Xinyi Rd., Xinyi Dist., Taipei City 110, Taiwan Yun Yun US Corporation 1108 S Baldwin Ave #107, Arcadia, CA 91007 Product liability insurance: This product has been insured by product liability insurance for \$1,000,000 USD.

FEDERAL COMMUNICATIONS COMMISSION INTERFERENCE STATEMENT

This equipment has been tested and found to comply with the limits for a Class B digital device, pursuant to Part 15 of the FCC Rules. These limits are designed to provide reasonable protection against harmful interference in a residential installation. This equipment generates, uses, and can radiate radio frequency energy and, if not installed and used in accordance with the instructions. may cause harmful interference to radio communications. However, there is no guarantee that interference will not occur in a particular installation. If this equipment does cause harmful interference to radio or television reception, which can be determined by turning the equipment off and on, the user is encouraged to try to correct the interference by one or more of the following measures:

- Reorient or relocate the receiving antenna.
- Increase the separation between the equipment and receiver.

- Connect the equipment into an outlet on a circuit different from that to which the receiver is connected.
- Consult the dealer or an experienced radio/TV technician for help.



CAUTION: Any changes or modifications not expressly approved by the party responsible for compliance could void the user's authority to operate the equipment. This device complies with part 15 of the FCC Rules. Operation is subject to the following two conditions: (1) This device may not cause harmful interference, and (2) this device must accept any interference received, including interference that may cause undesired operation.

FCC RF Radiation Exposure Statement:





1. This Transmitter must not be co-located or operating in conjunction with any other antenna or transmitter.
2. This equipment complies with FCC RF radiation exposure limits set forth for an uncontrolled environment.

This equipment should be installed and operated with a minimum distance of 20 centimeters between the radiator and your body.

Need help?

 <p>Message us</p>	 <p>In-App Chat Support</p>	 <p>Email Us</p>
Cubo Ai Smart Baby Monitor	App Setting > Chat with Us	support@getcubo.com

Share Cubo with even more parents!

		
<p>Recommend to Friends</p> <p>Earn rewards for each successful referral!</p>	<p>Join Cubo Community</p> <p>Search for us on Facebook</p> <div data-bbox="448 1765 922 1832">  <input type="text" value="Cubo Community"/>  </div>	<p>Love your Cubo?</p> <p>Share your story!</p> <p>Email us your photos for the chance to win a small gift marketing@getcubo.com</p>

Documents / Resources

	<p>Yun Yun Ai YYCBV3 Cubo Ai Baby Monitor [pdf] User Manual YYCBV3 Cubo Ai Baby Monitor, Cubo Ai Baby Monitor, Baby Monitor</p>
--	---