



Yoosee HX-T0008C Smart Camera User Manual

[Home](#) » [YOOSEE](#) » Yoosee HX-T0008C Smart Camera User Manual 



Before using this product, please read this manual carefully and keep it for future reference.

Contents

- [1 Quick Start Guide](#)
- [2 Device sharing](#)
- [3 Trouble Shooting](#)
- [4 Customer Service](#)
- [5 FCC warning statements:](#)
- [6 Documents / Resources](#)
 - [6.1 References](#)

Quick Start Guide

1. Download the App

You can either scan the QR code or search “Yoosee” in the App Store or Google Play, then register to login.



<http://www.yoosee.co/>

2. Power on the device

Power on the device and the device will give out ” Du du” sound in around 30s. If the “Du du” sound can not be heard, please Insert the thimble into the “reset” hole and long press it until the device emits the voice tone.

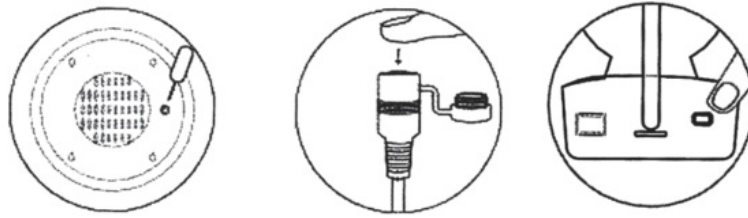

3. Add the device

1. Connect the phone to WiFi (If the device do not supports 5GHz WiFi, please make sure the connected WiFi is 2.4GHz).
2. Go to 'Device'in Yoosee app, click '+', Then add the camera according to the prompt

The App interface may be upgraded occassionally to improve user experience.

Device sharing

1. Invite your friends to download and install Yoosee App, and register to log in.
2. The device owner can click the 'share' icon to choose either way to share.
3. You can follow the App instruction to complete the share

Monitoring

On the monitoring interface of the YooSee app, you can check the camera monitoring images in real time and control camera monitoring, interception and recording functions.

Playback

After you install a TF card (support fat32/exFat), the camera will automatically record videos when the camera is on working condition. You can check the recorded videos in the "local playback" function of the Yoosee app.

Trouble Shooting

after formatting TF card, please replace a new TF card to try." image-3="" count="4" html="true" css_class=""]

For more questions, please refer to "Help and feedback" in Yoosee App.

Note

- Please confirm whether the device supports 5GHz WiFi, otherwise, make sure that the WiFi connected to the mobile phone is 2.4GHz;
- The device supports 128G card storage at maximum and the TF card should be formatted with FAT32/exFat format.
- The device uses loop record technique, when TF card is full, the camera will cover the earliest files automatically to save new videos.
- Please do not install the product in a harsh environment. The product may be damaged if exposed to high temperatures, high humidity, dust and smoke etc.
- The Yoosee App and the device firmware will be updated occasionally. Please update when the software notifies you that an update is available.
- The device will be automatically bound with the Yoosee account after connecting to network. Before binding a new Yoosee account, please unbind the device with the first Yoosee account.
- Yoosee CMS is available in windows PC for camera surveillance.

Please go to <http://www.yoosee.co> and download to install.

Customer Service

For users who need technical support, please contact: ✉ support@gwell.cc

FCC warning statements:

This equipment has been tested and found to comply with the limits for a Class B digital device, pursuant to part 15 of the FCC Rules. These limits are designed to provide reasonable protection against harmful interference in a residential installation. This equipment generates, uses and can radiate radio frequency energy and, if not installed and used in accordance with the instructions, may cause harmful interference to radio communications. However, there is no guarantee that interference will not occur in a particular installation. If this equipment does cause harmful interference to radio or television reception, which can be determined by turning the equipment off and on, the user is encouraged to try to correct the interference by one or more of the following measures:

- Reorient or relocate the receiving antenna.
- Increase the separation between the equipment and receiver.
- Connect the equipment into an outlet on a circuit different from that to which the receiver is connected.
- Consult the dealer or an experienced radio/TV technician for help.

Caution: Any changes or modifications to this device not explicitly approved by manufacturer could void your authority to operate this equipment.

This device complies with part 15 of the FCC Rules. Operation is subject to the following two conditions: (1) This device may not cause harmful interference, and (2) this device must accept any interference received, including interference that may cause undesired operation.

The device has been evaluated to meet general RF exposure requirement This equipment complies with FCC radiation exposure limits set forth for an uncontrolled environment.

This equipment should be installed and operated with minimum distance 20cm between the radiator & your body.

Documents / Resources

	<p>Yoosee HX-T0008C Smart Camera [pdf] User Manual 2BEFB-HX-T0008C, 2BEFBHXT0008C, hx t0008c, HX-T0008C Smart Camera, HX-T0008C, Smart Camera, Camera</p>
---	---

References

- [User Manual](#)

Manuals+ Privacy Policy

This website is an independent publication and is neither affiliated with nor endorsed by any of the trademark owners. The "Bluetooth®" word mark and logos are registered trademarks owned by Bluetooth SIG, Inc. The "Wi-Fi®" word mark and logos are registered trademarks owned by the Wi-Fi Alliance. Any use of these marks on this website does not imply any affiliation with or endorsement.