

Yooksmart GR-09-01 Remote Control User Manual

[Home](#) » [Yooksmart](#) » Yooksmart GR-09-01 Remote Control User Manual 

Contents

- [1 Yooksmart GR-09-01 Remote Control](#)
- [2 Product Usage Instructions](#)
- [3 REMOTE CONTROL](#)
- [4 PARAMETERS](#)
- [5 INSTALL THE BATTERY](#)
- [6 REMOTE CONTROL PROGRAMMING](#)
- [7 SET FAVORITE POSITION](#)
- [8 HOW TO CHANGE UP/DOWN DIRECTION](#)
- [9 SET TOP-LIMIT POSITIONS](#)
- [10 UNPAIR THE MOTOR](#)
- [11 ADD NEW REMOTE "B"](#)
- [12 KNOB FUNCTION](#)
- [13 CERTIFIED STATEMENT](#)
- [14 Documents / Resources](#)

Yooksmart

Yooksmart GR-09-01 Remote Control



Product Information

The product is a remote control for controlling blinds. It allows you to control up to 9 blinds simultaneously. The remote control has a knob that can be used to adjust the opening percentage of the blinds. It also has buttons for setting favorite positions, opening, closing, and stopping the blinds. The remote control operates on a Lithium Cell CR2450 3V battery.

Product Usage Instructions

To control the blinds:

- Each channel on the remote control corresponds to one blind.
- To open multiple blinds together, press the corresponding channel numbers in sequence and then press the "Open" button.

To install the battery:

- Open the remote control and insert a Lithium Cell CR2450 3V battery.
- Make sure to remove any protective covers before use.

To enter setting mode:

- Hold the "P1" button for 5 seconds.
- A green light flashing indicates that the remote control is in setting mode.
- Choose the channel you want to set from 1-9.
- The remote control will exit setting mode if you hold the "P1" button for 5 seconds again or if there is no

operation for 3 minutes.

To set the favorite position:

- Press the channel number for the blind you want to set as the favorite position.
- Hold the “P2” button for 3 seconds.
- The motor will respond to indicate that the favorite position has been set.

To delete the favorite position:

- Hold the “P2” button for 3 seconds.
- The motor will respond to indicate that the favorite position has been deleted.

To change the up/down direction:

- Hold the channel number button for the blind you want to change the direction of.
- Press the “P2” button once.
- The motor will respond to indicate that the direction has been changed.

To adjust the shades running speed:

- Hold the channel number button for the blind you want to adjust the speed of.
- Press and hold the “P2” button for 3 seconds to add speed or reduce speed.
- The motor will respond to indicate that the speed has been adjusted.

To delete the top limit position:

- Hold the channel number button for the blind you want to delete the top limit position of.
- Press the “P2” button once.
- The motor will respond to indicate that the top limit position has been deleted.

To delete the bottom limit position:

- Hold the channel number button for the blind you want to delete the bottom limit position of.
- Press the “P2” button once.
- The motor will respond to indicate that the bottom limit position has been deleted.

To delete both the top and bottom limit positions:

- Hold the “P2” button for 3 seconds.
- The motor will respond to indicate that both the top and bottom limit positions have been deleted.

To set the top limit positions:

- Move the shade to the desired top limit position.
- Hold the channel number button for the blind you want to set the top limit position of.
- Press the “P2” button once.
- The motor will respond to indicate that the top limit position has been set.

To set the bottom limit positions:

- Move the shade to the desired bottom limit position.
- Hold the channel number button for the blind you want to set the bottom limit position of.
- Press the “P2” button once.
- The motor will respond to indicate that the bottom limit position has been set.

REMOTE CONTROL

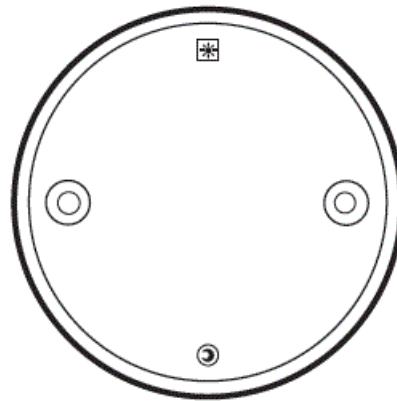
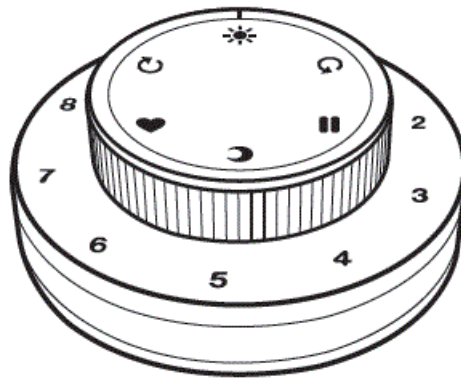

Remote Holder



S x2

PARAMETERS

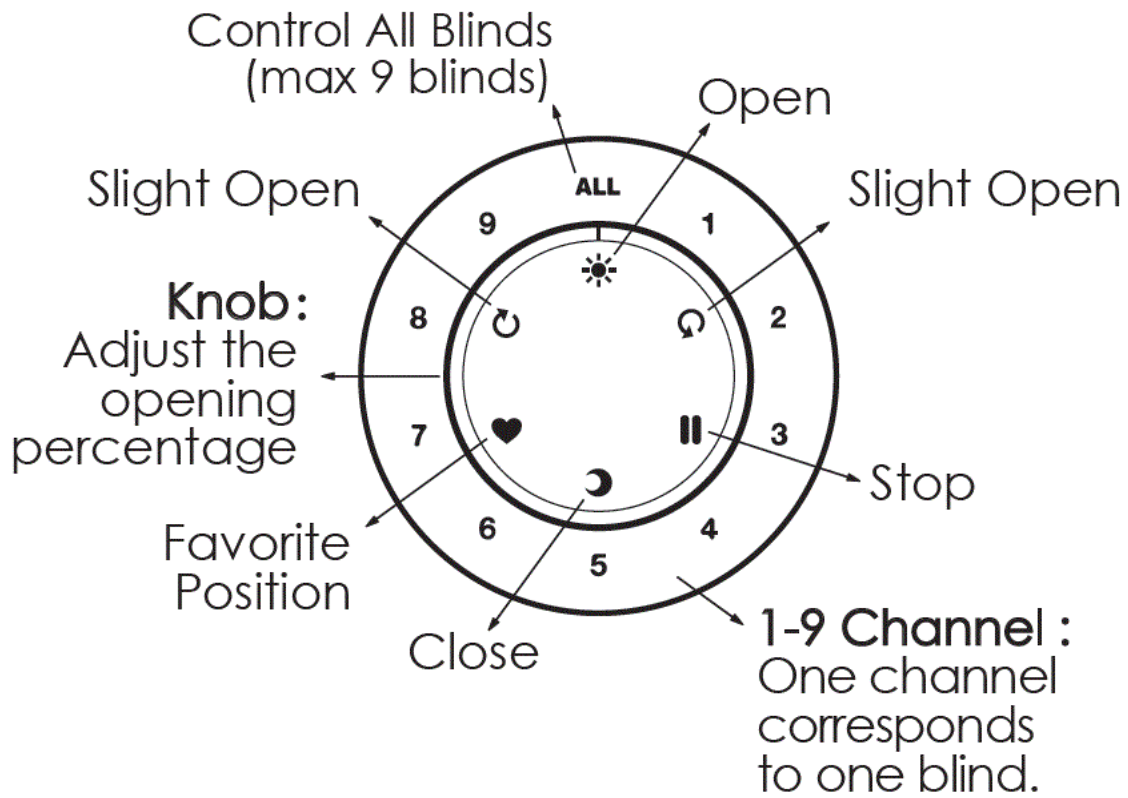

Example Operation:

If there are 9 blinds, and you want to open blinds 1, 3, and 5 together, the operation method is:
Press 1, 3, and 5 in sequence, and then press "Open".

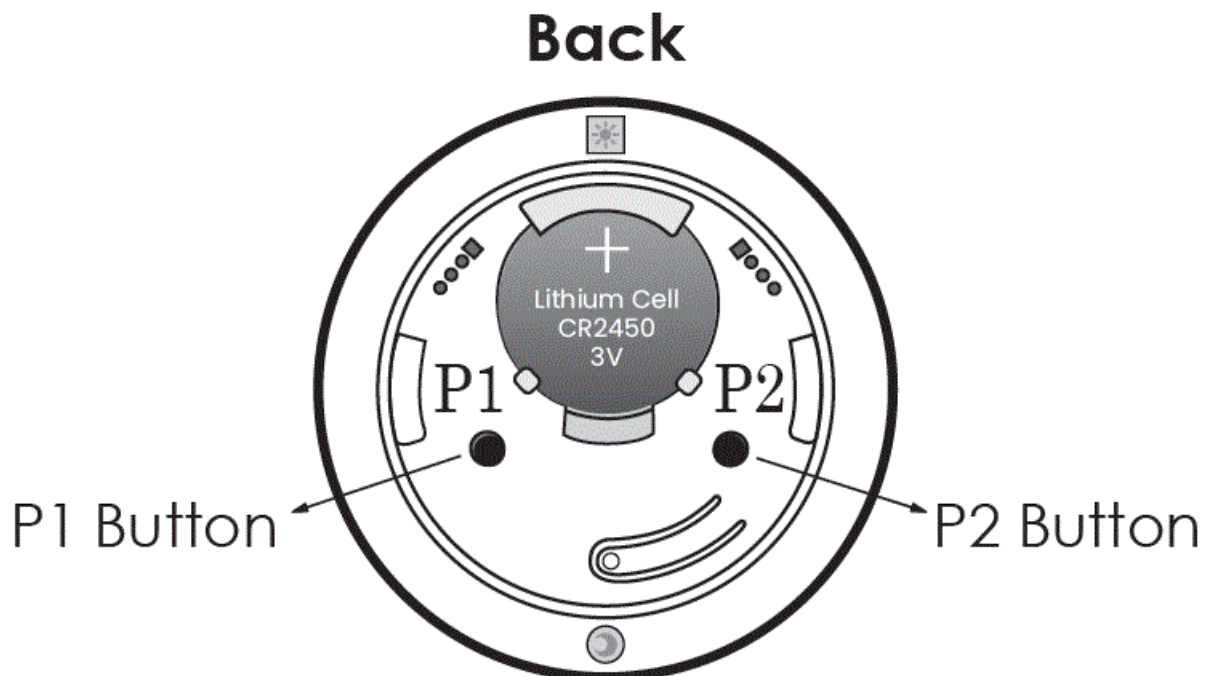

INSTALL THE BATTERY

Your blind has been programmed before shipment.
Please use it directly after installation.

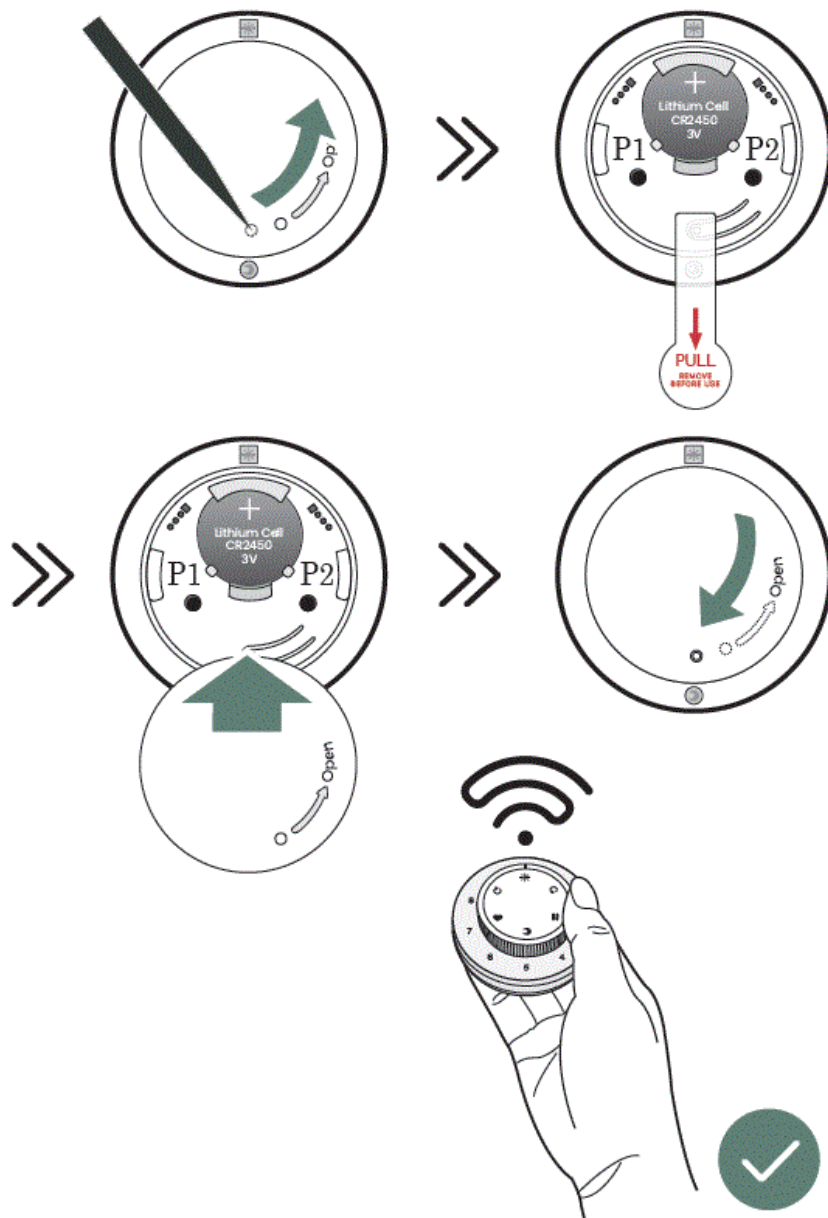

INSTALL THE REMOTE HOLDER ON WALL

Method 1

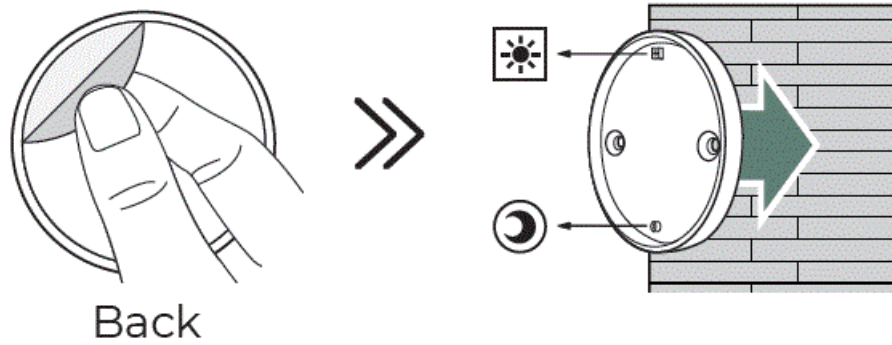

Method 2

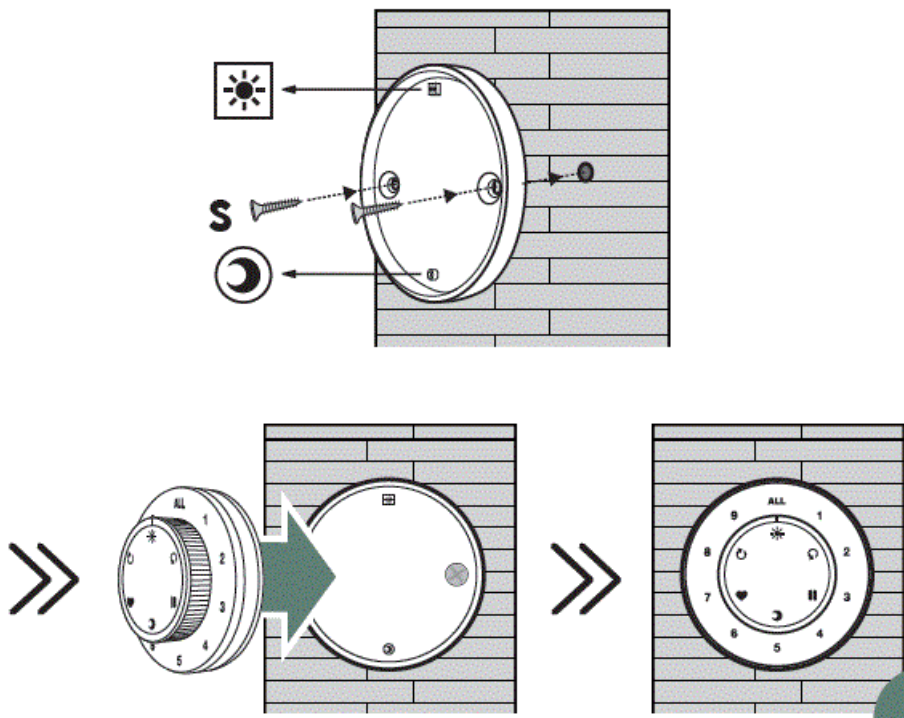

REMOTE CONTROL PROGRAMMING

ENTER SETTING MODE

- Green light flashing indicates setting mode.
- Choose the channel you want to set from "1-9".

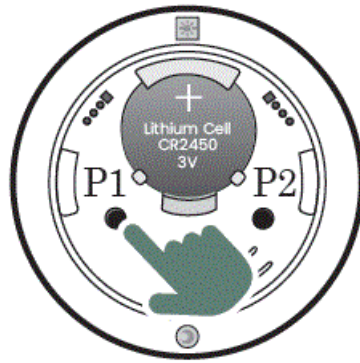

Hold " P1 " for 5s

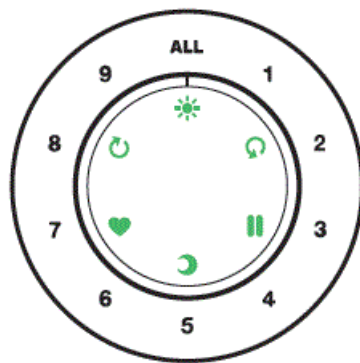

Green light flashing
indicates setting mode.

It will exit setting mode if hold "P1" for 5s again or no operation for 3 mins.

SET FAVORITE POSITION

1. The favorite position is not set at factory.
2. Before setting the favorite running position, please ensure that the top and bottom limit positions have been set.
3. Please ensure that the remote is in setting mode before following the steps below:

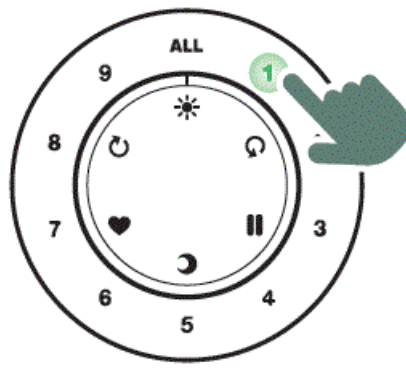

Press " Channel 1 "

(Take channel 1 for example)

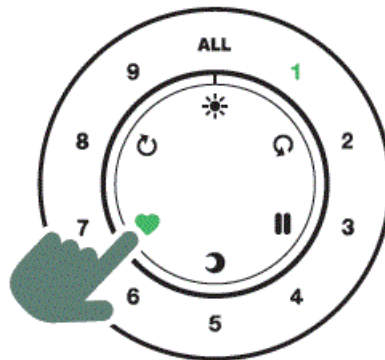

Hold " ♥ " for 3s



The motor responds.

DELETE FAVORITE POSITION

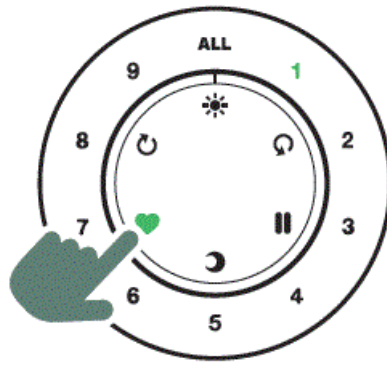

Hold " ♥ " for 3s



The motor responds.

HOW TO CHANGE UP/DOWN DIRECTION

Please ensure that the remote is in setting mode before following the steps below:

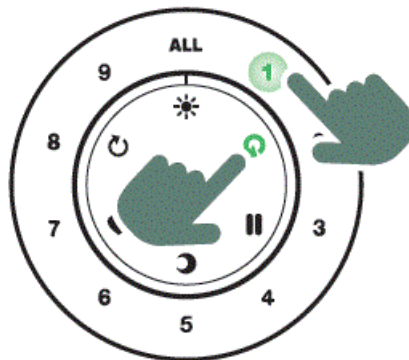

Hold " Channel 1 " then
Press " ☉ " for x1
(Take channel 1 for example)



The motor responds.

HOW TO ADJUST SHADES RUNNING SPEED

1. Please ensure that the remote is in setting mode before following the steps below:
2. If the motor does not jog, it may have reached the maximum or minimum speed.
There are three speed settings available.

Add speed

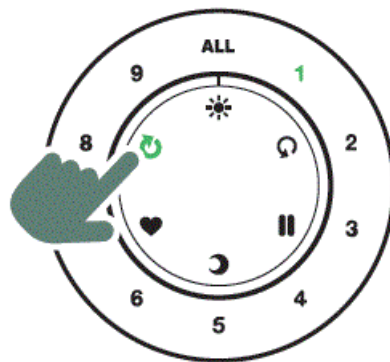

Hold "⌚" for 3s



The motor responds.

Reduce speed



Hold "⌚" for 3s



The motor responds.

DELETE TOP LIMIT POSITION

Please ensure that the remote is in setting mode before following the steps below:

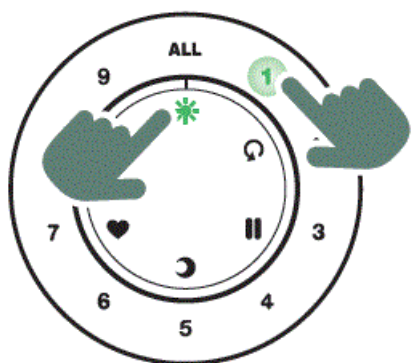

» The motor responds.

Hold " Channel 1 " then
Press " ☀ " for x1
(Take channel 1 for example)

Hold " Channel 1 " then Press " " for x1
(Take channel 1 for example)

DELETE BOTTOM LIMIT POSITION

Please ensure that the remote is in setting mode before following the steps below:



» The motor responds.

Hold " Channel 1 " then
Press " ☾ " for x1
(Take channel 1 for example)

DELETE TOP & BOTTOM LIMIT POSITION

1. The favorite position will also be deleted.
2. Please ensure that the remote is in setting mode before following the steps below:

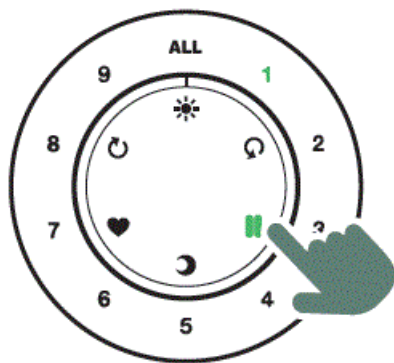

» The motor responds.

Hold " || " for 3s

SET TOP-LIMIT POSITIONS

Please ensure that the remote is in setting mode before following the steps below:

Move the shade to the desired top limit position.

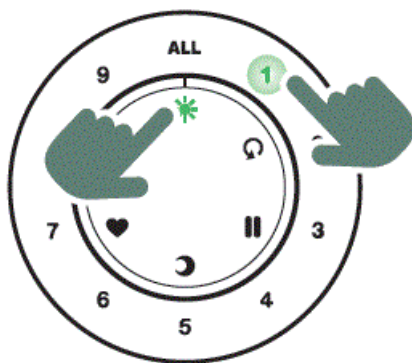

Hold " Channel 1 " then
Press " ☀ " for x1
(Take channel 1 for example)



The motor responds.

SET BOTTOM-LIMIT POSITIONS

Please ensure that the remote is in setting mode before following the steps below:

Move the shade to the desired bottom limit position.

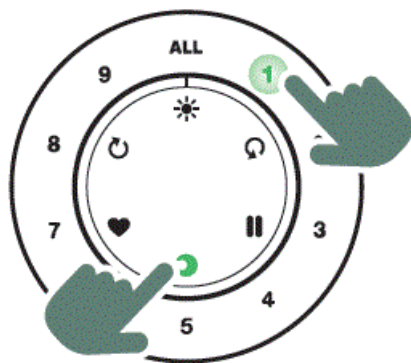

Hold " Channel 1 " then
Press " ☾ " for x1
(Take channel 1 for example)



The motor responds.

UNPAIR THE MOTOR

1. All paired remotes on the current channel won't be able to control the motor after the step.
2. Please ensure that the remote is in setting mode before following the steps below:

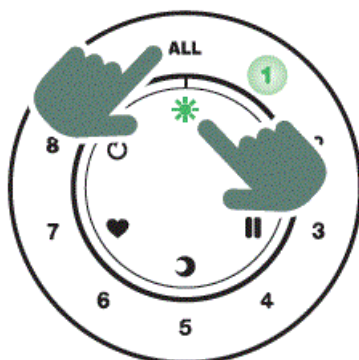

Hold " **ALL** " for 3s then
Press " ☀ " for x1
(Take channel 1 for example)



The motor responds.

RE-PAIR THE MOTOR

Please ensure that the remote is in setting mode before following the steps below:

Hold the motor button for 2s



The motor responds.

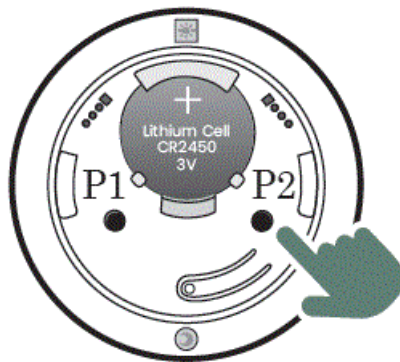

Press " P2 " x1

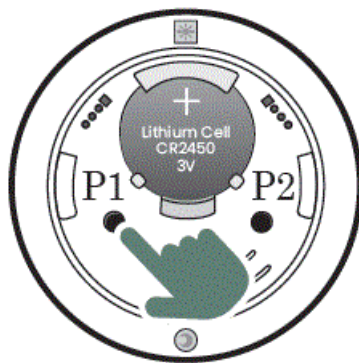

Press " P1 " x1

ADD NEW REMOTE "B"

Please ensure that the remote is in setting mode before following the steps below:

1. Paired remote "A"



Hold " Channel 1 " then
Press " || " for x1
(Take channel 1 for example)

2. Ensure that the unpaired remote "B" has entered setting mode.

Choose the channel you want to set from 1-9. Please refer to Page 3 for this step.

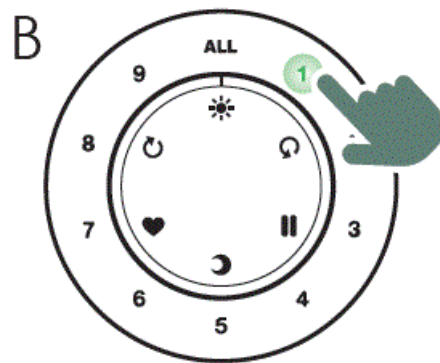

Press " P2 " x1

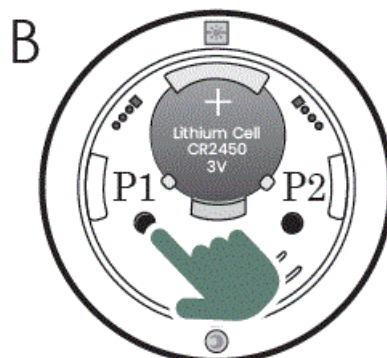

Press " P1 " x1

KNOB FUNCTION

Please ensure that the remote is not in setting mode before following the steps below:
If it's in setting mode, please refer to page 3 to exit setting mode.

ADJUST THE OPENING PERCENTAGE

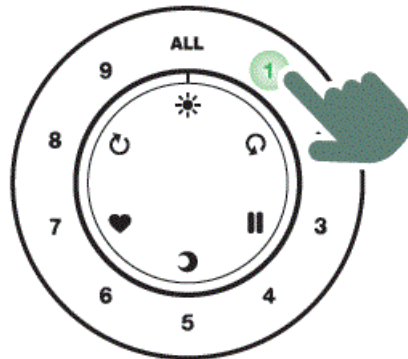

Press " Channel 1 "

(Take channel 1 for example)



>> The shade moves down.

Rotate clockwise

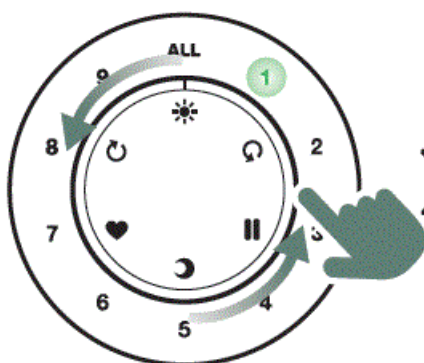

>> The shade moves up.

Rotate counterclockwise

1. At each rotation, the current black mark is the initial position.
2. Rotate it for one cycle, and the shade will open by 40%.

DOT MOVE

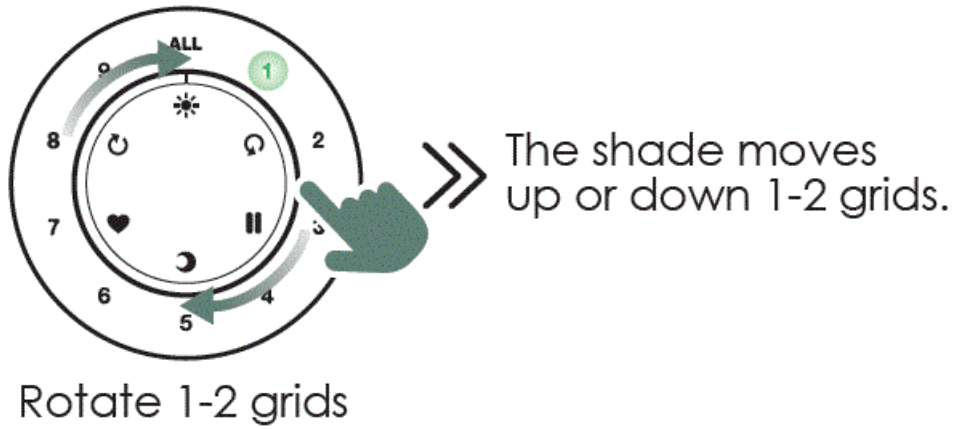

For Shangri-la Shades, please move the shade to bottom limit position and rotate the knob 1-2 grids to achieve dimming function.

CERTIFIED STATEMENT

FCC STATEMENT

FCC ID: 2A9IA-GR-09-01

Please take attention that changes or modification not expressly approved by the party responsible for compliance could void the user's authority to operate the equipment.

This device complies with Part 15 of the FCC Rules.

Operation is subject to the following two conditions:

1. This device may not cause harmful interference, and.
2. This device must accept any interference received, including interference that may cause undesired operation.

Documents / Resources

Yooksmart

MANUAL OF
REMOTE CONTROL

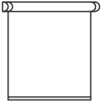

[Yooksmart GR-09-01 Remote Control](#) [pdf] User Manual
GR-09-01 Remote Control, GR-09-01, Remote Control, Control, Remote