

YONGKANG 433-005 Wireless 5 Button Remote Control Owner's Manual

Contents

- [1 YONGKANG 433-005 Wireless 5 Button Remote Control](#)
- [2 Product Information](#)
- [3 Product Usage Instructions](#)
- [4 Safety precautions](#)
- [5 Batteries](#)
- [6 Indicator Light](#)
- [7 Specifications](#)
- [8 Operation instructions](#)
- [9 FCC Caution](#)
- [10 FAQ](#)
- [11 Documents / Resources](#)
 - [11.1 References](#)
- [12 Related Posts](#)

YONGKANG

YONGKANG 433-005 Wireless 5 Button Remote Control

Product Information

Specifications:

- Model: 433-005
- Type: 433 Wireless 5-Button Remote Control
- Manufacturer: Yongkang Boyan Electronic Technology Co., Ltd.
- Address: Room 3, East, Building 1, No. 72 Gongshan Road,
Tangxian Town, Yongkang City, Jinhua City, Zhejiang Province China

Product Usage Instructions

Safety Precautions:

Before using the remote control, it is important to adhere to the following safety precautions:

- Insulate battery electronic contacts with tape when discarding the battery.
- Remove leaking, discolored, deformed, or emitting smoke batteries immediately.
- Keep batteries and battery caps away from children to avoid ingestion.

- Avoid using the product in aircraft or hospitals without confirmation due to electromagnetic interference risks.
- Provide detailed instructions and supervision for children using the product.
- Avoid getting the product wet and do not use organic solvents for cleaning.

Battery Replacement:

To replace the battery in the remote control:

1. Pull out the white battery insulation sheet above the battery box manually.
2. Press the button on the side of the battery bin to release the battery box.
3. Replace the button battery (2xAAA, 3V) and close the battery box securely.
4. If not using the remote for an extended period, remove the battery from the unit.

- Please read this manual carefully before use
- This remote control is 433 wireless product
- Please pull out the insulation sheet on the side after receiving the remote control, so that the remote control can be used normally.

Safety precautions

The following precautions are intended to prevent injury or harm to you and others. Before you start using this product, be sure to thoroughly understand and follow these precautions.

If there is any malfunction, problem or damage to this product, please contact the dealer from whom you purchased this product.

WARNING: Please observe the following warnings. Failure to do so may result in death or a serious injury.

- To avoid causing fire, overheating, chemical leakage, explosion and electric shock accidents, please follow the following safety matters
- Do not use any other batteries than those specified in the instruction manual. Do not use homemade batteries or modified batteries, or if the product is broken.
- Do not short-circuit the battery, disassemble or modify the battery yourself. Do not heat or solder the battery. Do not allow the battery to come into contact with fire or water. Do not expose the battery to a strong physical impact.
- Do not reverse the positive and negative terminals of the battery.
- When discarding the battery, insulate the battery's electronic contacts with tape. If it comes in contact with other metal objects or batteries, it may cause fire or explosion.
- If the battery leaks, changes color, deforms, or emits smoke or fumes, remove it immediately. Take care to avoid burns during handling. If it continues to be used, it may cause fire, electric shock or burns.
- Keep batteries and battery caps out of the reach of children and infants. If a child or infant swallows a battery or battery cover, etc., seek medical attention immediately. Chemicals in batteries may damage the stomach and intestines..
- Before using this product in an airplane or in a hospital, please first confirm whether the use of this product is allowed in that location. Electromagnetic waves emitted by this product may interfere with the operation of aircraft instruments or medical equipment in hospitals.

- Adults are required to provide detailed instructions on how to use this product when children are using it and to supervise children during the use of the product. Improper use may result in electric shock or other injuries.
- Be careful not to get the product wet. If this product is dropped in water or If water or metal enters this product, remove the batteries immediately. This is to prevent fire, electric shock and burns.
- Do not use paint thinner, benzene or other organic solvents to clean this product. Otherwise, it may cause a fire or damage your health.

NOTE: Please observe the following precautions. Failure to do so may result in personal injury or property damage.

Do not insert your fingers into the small holes of this product to prevent getting stuck.

Batteries

Installing Batteries

To replace the battery, please pull out the white battery insulation sheet above the battery box by hand, press the button on the side of the battery bin, and then pull out the battery box by hand to replace the battery. As shown in the figure. Note: The button battery 2xAAA is 3V. Close the battery box in the preceding manner after replacement.



Precautions

If the remote controller is not being used for a prolonged period of time, remove the battery from the unit.

- Do not dismantle or exert heat to the battery.
- Do not drop the battery or exert extreme impact that may even cause the case to be damaged.
- Do not immerse the battery in water.
- There is a danger of explosion if a the battery is inserted incorrectly.
- Properly dispose of used batteries.

Indicator Light

The indicator indicates the status of the host. Press button 1 or button 2 or button 3 or button 4, as shown in the picture, the indicator light will be on and the color is blue. Indicates that the product is running properly.

Specific button selection and use can be based on the different design requirements of the corresponding supporting products. For specific supporting Operations, see section 4

When the key is not pressed, it will enter the sleep mode, press any key to wake up.

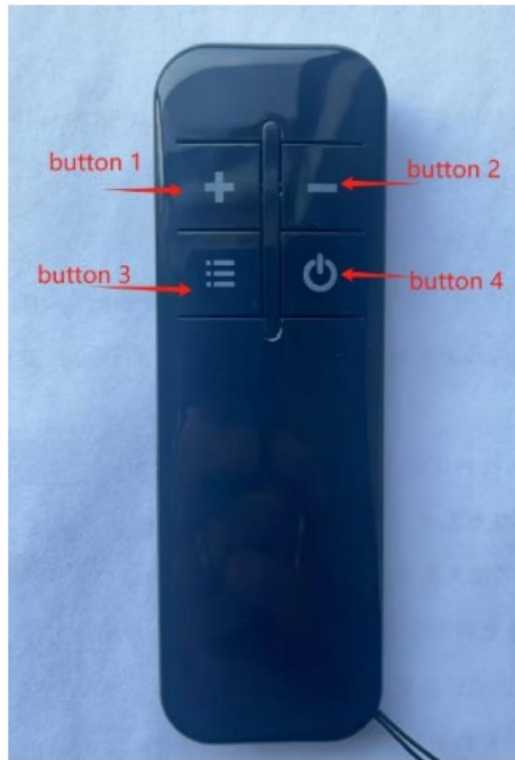

Specifications

Working Voltage	3VDC
Power Consumption	<1W
Remote Control Frequency	433MHz
Remote Control Distance	>15m in open area

Operation instructions

433 Wireless Remote Control

- schematic description: 4keys + 1 indicator
 - Key detection.
1. Any key pressed, send code 5 packets, if after 5 packets of data, the key is still pressed, continue to send code, more than 10s stop sending code.
 2. When the key is not pressed, it needs to sleep, do low power consumption, static power consumption < 1A, sleep program processing, any key can wake up.
 3. Sending code format: 16-bit address (roll code) + 8-bit data code + 8-bit check code:
 - Head code time: 300us+6ms
 - 0Code time: 300us+900us
 - 1Code time: 300us+900us

FCC Caution

This device complies with part 15 of the FCC Rules. Operation is subject to the following two conditions: (1) This device may not cause harmful interference, and (2) this device must accept any interference received, including interference that may cause undesired operation.

Any changes or modifications not expressly approved by the party responsible for compliance could void the user's authority to operate the equipment. NOTE: This equipment has been tested and found to comply with the limits for a Class B digital device, pursuant to Part 15 of the FCC Rules. These limits are designed to provide reasonable protection against harmful interference in a residential installation. This equipment generates, uses and can radiate radio frequency energy and, if not installed and used in accordance with the instructions, may cause harmful interference to radio communications. However, there is no guarantee that interference will not occur in a particular installation.

If this equipment does cause harmful interference to radio or television reception, which can be determined by turning the equipment off and on, the user is encouraged to try to correct the interference by one or more of the following measures:

- Reorient or relocate the receiving antenna.
- Increase the separation between the equipment and the receiver.
- Connect the equipment into an outlet on a circuit different from that to which the receiver is connected.
- Consult the dealer or an experienced radio/TV technician for help.

The device has been evaluated to meet general RF exposure requirements. The device can be used in portable exposure conditions without restriction.

FAQ

- **Q:** What should I do if the remote control is not working?
 - **A:** Check the battery and ensure it is properly inserted following the battery replacement instructions. If the issue persists, contact the dealer for assistance.
- **Q:** Can I use rechargeable batteries with this remote control?
 - **A:** It is recommended to use standard non-rechargeable batteries as specified (2xAAA, 3V) for optimal performance.

Documents / Resources

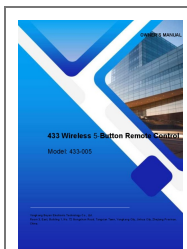

[YONGKANG 433-005 Wireless 5 Button Remote Control](#) [pdf] Owner's Manual
2BGF7433005, 433-005 Wireless 5 Button Remote Control, 433-005, Wireless 5 Button Remote Control, 5 Button Remote Control, Remote Control, Control

References

- [User Manual](#)