



YIONON GC10D Wireless Gaming Controller User Manual

[Home](#) » [YIONON](#) » YIONON GC10D Wireless Gaming Controller User Manual 



Wireless Gaming Controller
User manual
(GC10D)

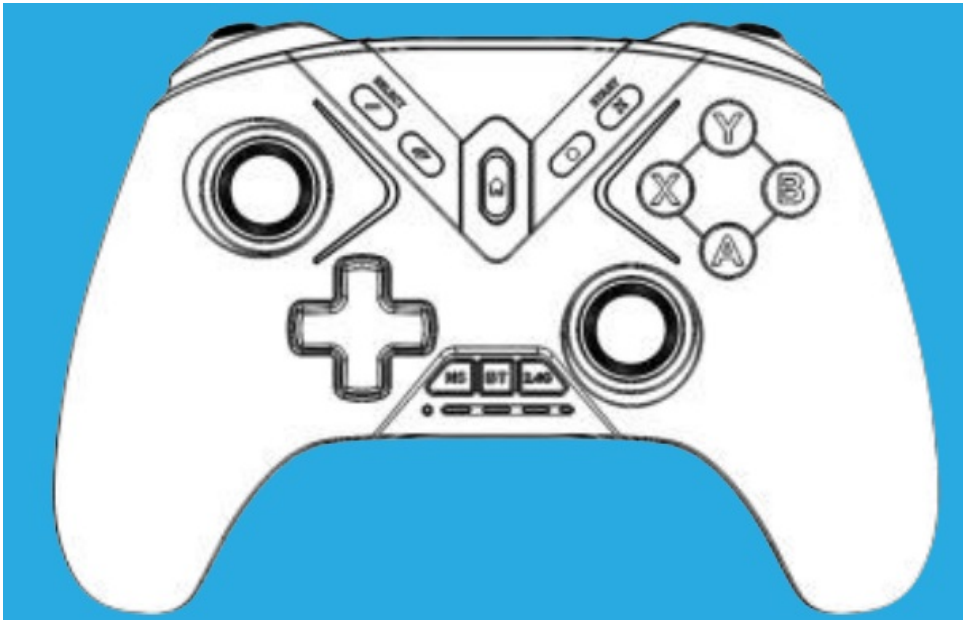

Discover your true gaming power

Contents

- 1 Compatibility
- 2 Connection Ways
- 3 Supported Platforms:
- 4 Supported Games:
- 5 Pairing Brief
- 6 Product Overview
- 7 LED Overview
- 8 Phone Clip Using(sell separately)
- 9 Connecting to N-Switch
- 10 Connecting to Android/Apple/PC (Requires built-in Bluetooth)
- 11 Connecting to Android TV/PC with 2.4G Dongle(sell separately)
- 12 Connecting to PC with Wired Connection
- 13 ABXY Button Instruction
- 14 Back Buttons Function
- 15 Turbo Function
- 16 D-pad and Left Joystick Function Switching
- 17 RGB Light
- 18 Mobile APP Function
- 19 Turn Off/Sleeping Function
- 20 Charging Function
- 21 Reset Function
- 22 Product Specifications
- 23 Attention
- 24 Documents / Resources
 - 24.1 References
- 25 Related Posts

Compatibility

1. N-Switch/Lite/OLED
2. Apple: iPhone, iPad, Macbook, Apple TV, (iOS/iPadOS 13.4 and above)
3. Android: phone, tablet, TV, TV box, (Android 8 and above)
4. PC: Windows 7/8/10/11, steam OS

Connection Ways

Wired, Bluetooth, 2.4G Dongle

Supported Platforms:

Such as, Xbox Game Pass, Steam, Amazon Luna, Apple (Arcade/ MFi) Game, John emulator, Steam Link, Epic, etc.

Supported Games:

Such as, Minecraft, Call of Duty, Apex Legends, Diablo Immortal, Asphalt, Sky: Children of Light, Genshin Impact (Android not supported), NBA 2K, Battle Prime, Fortnite, Tower of Fantasy, Ark, Pokemon Unite, Dead Cells, Warframe, Need for Speed: Most Wanted, Grand Theft Auto, Rocket League Sideswipe, BombSquad, etc.

Pairing Brief

Controller Mode	Platform	Connection Method	LED/RGB Indicator	Reconnection
NS mode	N-Switch	Press and hold the NS button for as	LED1 and red RGB remain on	Press the NS button for 1s
BT mode	Android phone/ tablet/TV box iPhone/iPad/ MacBook/ Apple TV Chromebook Laptop Fire TV Fire Tablet Steam deck	Press and hold the BT button for 3s	LED2 and purple RGB remain on	Press the BT button for 1s
2.4G mode	Windows PC Android TV Fire TV	Press and hold the 2.4G button for 3s	LED3 and RGB remain on	Press the 2.4G button for 1s

Product Overview

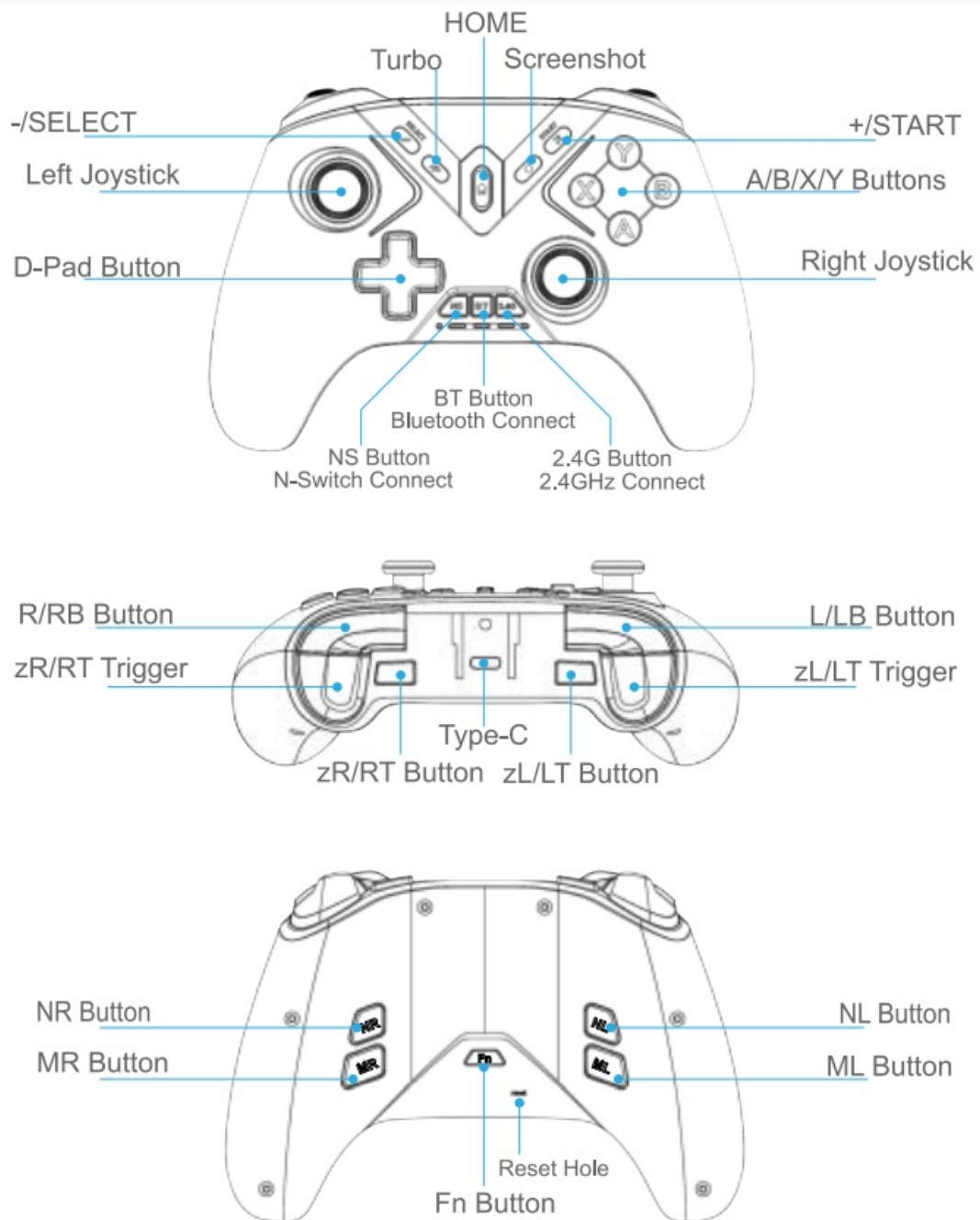

LED Overview

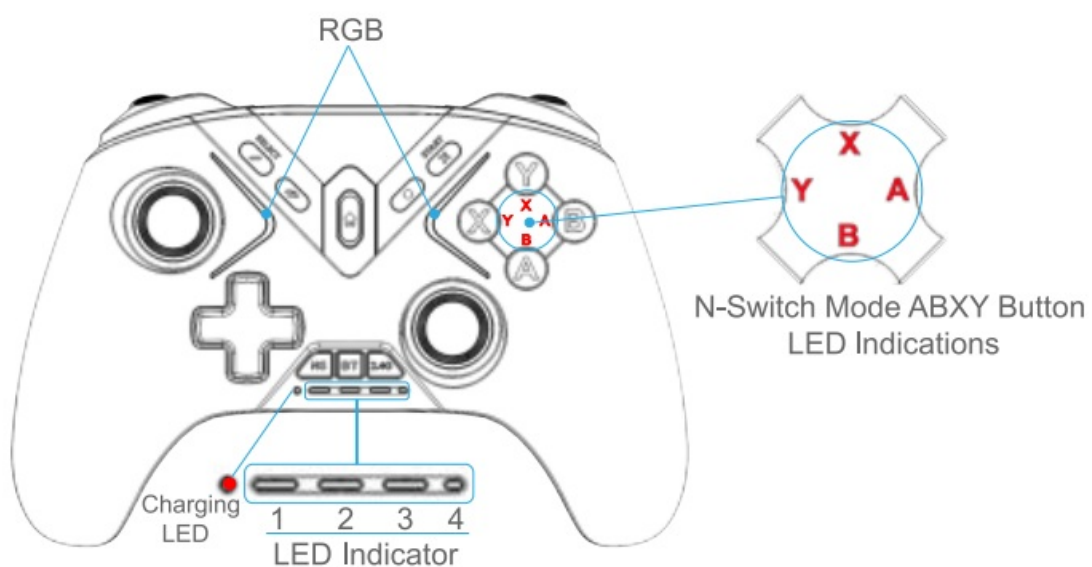

Connection Mode Indicator	Explanation
Flashing slow	Turn on/Re-connection
Flashing fast	Pairing
Always on	Connected

Phone Clip Using(sell separately)

Note: Accessories may not be included and depend upon your seller.

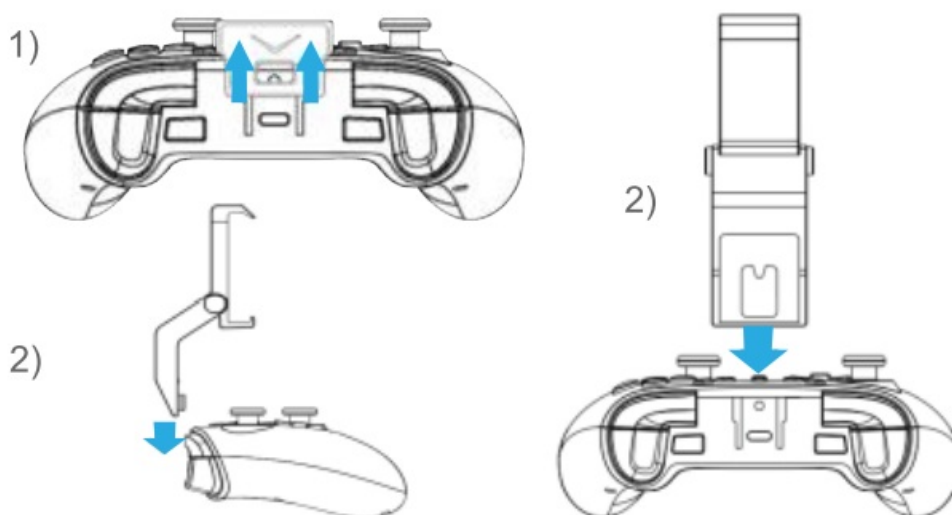

Connecting to N-Switch

Wireless Connection

Step 1: Click Controller  Change Grip/Order on the Switch homepage.

Step 2: Long press NS button for 3s until LED1 and the red RGB change from flash slow to flash quickly, entering pairing.

Step 3: LED1 and red RGB remain ON, and the connection is successful.



Wired Connection

- 1) 
- 2) 
- 3) 

Wake-up and Re-connect: Press the NS button for 1s to power on the controller, will wake up and reconnect the N-Switch device you used last time.

Connecting to Android/Apple/PC (Requires built-in Bluetooth)

Support Platforms:

Apple: iPhone, iPad, Macbook, Apple TV

Android: Android phone, table, Android TV, TV box

PC: Windows, steam OS

Others: Fire TV, Fire tablet, Chromebook, Steam deck

With Bluetooth Connection

Step 1: Long press BT button for 3s until, The LED2 and purple RGB flashes fast, entering pairing.

Step 2: Turn on your device Bluetooth, locate "Xbox wireless controller" and pair it.

Step 3: LED2 and purple RGB remain ON, and the connection is successful.

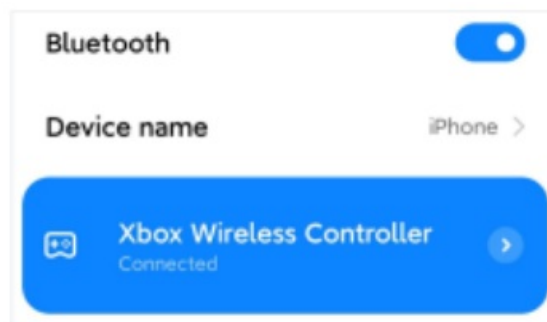

Re-connection: Press the BT button for 1s to power on the controller, then it will reconnect to the device you used last time.

Connecting to Android TV/PC with 2.4G Dongle(sell separately)

Note: Accessories may not be included and depend upon your seller.

Support Platforms: Android TV/TV box, PC Windows, Fire TV, etc.



2.4G Dongle Connection Method

Step 1: Long press 2.4G button for 3s until, The LED Indicator and RGB flashes fast, entering pairing.

Step 2: Insert the 2.4G dongle into the USB port of the device. The red LED on the dongle blinks.

Step 3: Press the pairing button on the dongle for 1s, the LED on the dongle turns red and blinks rapidly, indicating that the dongle is ON entering pairing.

Step 4: Blue RGB on the dongle, LED Indicator and RGB on the controller

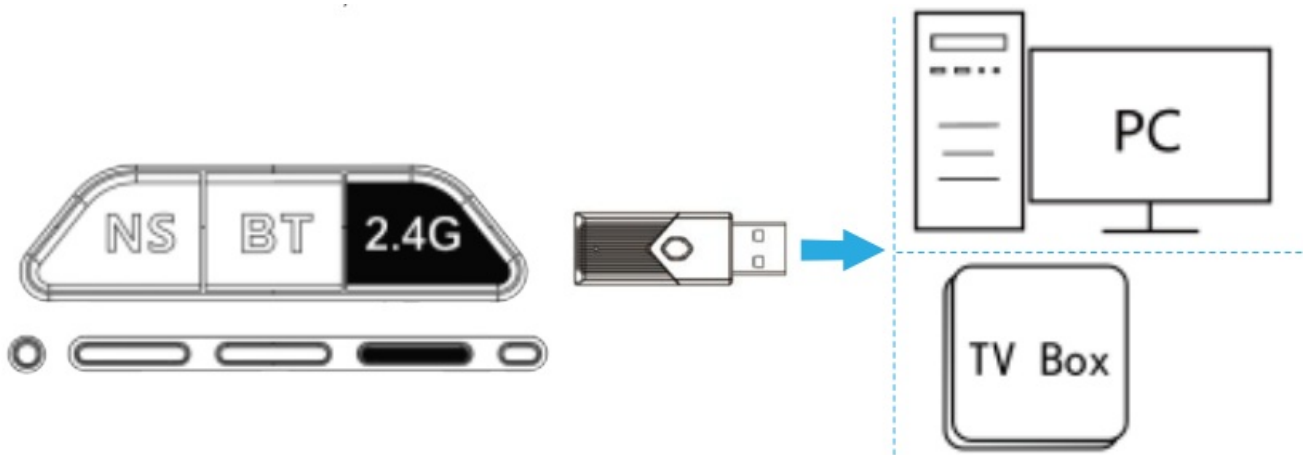

Mode	Xinput	Dinput	Switch Pro
Device name	Xbox360 controller for Windows	GC1OD Controller	Pro Controller
Indicator State			
RGB State	Cyan	Green	Red

Mode Change

The 2.4G dongle has 3 modes, which can be changed manually.

Mode change method: After the controller is successfully connected to the 2.4G dongle, press and hold the controller “-” and “+” buttons at the same time for 3s to change the mode.

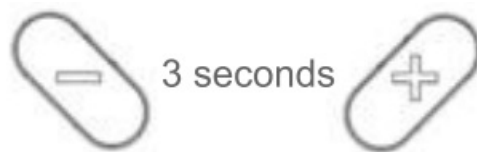

Connecting to PC with Wired Connection

Step 1: Use USB cable to connect the gamepad and the USB port in PC.

Step 2: The PC will prompt new hardware and install automatically.

Step 3: LED3 and cyan RGB on the gamepad remain ON, and the connection is successful. It is in X-input mode.

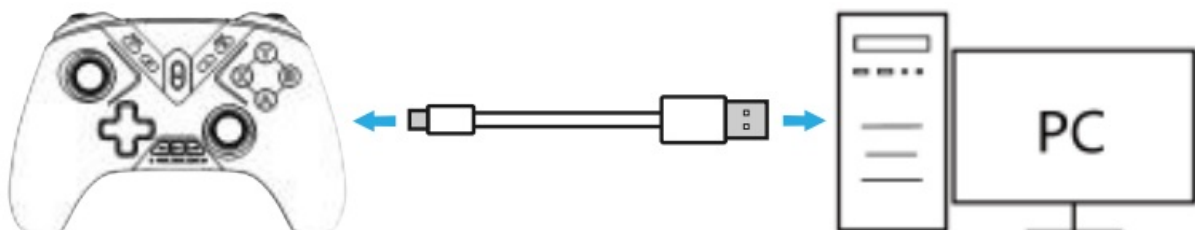

Testing Function:

Function testing is available when used on the computer. The specific steps are shown below: Open Control Panel -> Devices and Printers -> Xbox Wireless Controller, Right click Controller icon -> Game Controller Setting -> click Properties -> Testing.

ABXY Button Instruction

Switch Layout Button

When connecting the controller with the Switch, the buttons shown on the LE are the ABXY function buttons.



PC/Phones layout Button

When connecting the controller with phones or PC, the buttons on the outside are the ABXY function buttons.



Back Buttons Function



NUNR/MUMR Default Function:

NL Button = Gyro Motion Function

This function supports Apple, Android, and PC, N-Switch does not need to use this function.

1. Press and hold the NL button to turn on the gyro motion function.
2. Then move the controller for gyro motion control.
3. Unhold the NL button to turn off the gyro motion function.

Note 1: This feature is still in beta. If you don't like it, you can change it yourself according to the Macro Function customization method below.

Note 2: If the gyroscope is off-center, please follow these steps to calibrate it:

1. Turn off the controller and place it on a horizontal table;
2. Press and hold the "B", "-", and "BT" buttons 1s. The indicator lights LED1, 2, and LED3, 4 will flash alternately,

indicating the controller gyroscope enters the calibration state;

3. Press the + button 1s to complete the gyroscope calibration;

NR Button = Right Joystick Speed-down Function

1. Press and hold the NR button to reduce the right joystick's movement speed.
2. Then move the right joystick for precise aiming.
3. Unhold the NR button to get the right joystick's normal movement speed.



Macro Function

Programming Buttons: NL, NR, ML, MR.

Action Button: A, B, X, Y, LB, RB, LT, RT, Left Joystick(↑/↓/←/→/press down), Right Joystick(↑/↓/←/→/press down), D-pad, -, + buttons.

1-20 buttons and 1-60 seconds can be recorded and saved.

Macro Function Setting:

1. Press and hold one of the programmable buttons (NUNR/MUMR), and then press the Fn button for 1s. The controller vibrates and the orange RGB flashes, signaling the controller is in programming mode.
2. Press the action buttons you want to be programmed. Action Button: A, B, X, Y, LLB, R/RB, ZLLT, zR/RT, Left Joystick(↑/↓/←/→/Press Down), Right Joystick(↑/↓/←/→/IPress Down), D-pad, -/+ buttons.
3. Press again the programmable button (NUNR/MUMR) when complete.
The controller vibrates and the RGB light returns to the state before programming, signaling the programming is successful.
4. Press the NL/NR/ML/MR button to release the programmable function.
Note: Programmed buttons will remain in memory even after being disconnected.

Clear Macro Function:

1. Press one of the programmable buttons (NUNR/ML/MR), and then press Fn button for 1s. The controller vibrates and the orange RGB flashes, signaling the controller is in programming mode.
2. Press again the programmable button (NL/NR/ML/MR) to clear the Macro function.
Turn ON/Off The Back Button Function
Long press the Fn button for 5s to turn on/off the back button(NL,NR,ML,MR) functions.

Turbo Function

Buttons can be set Turbo Function: A, B, X, Y, LB, LT, RB, RT, NL, NR,ML,MR. Manual Turbo

Turn on: Press and hold the function button, and press the TURBO button once, the manual TURBO function will be launched.

Turn off: Repeat the last operation.



Auto Turbo

Turn on: Press and hold the function button, and press the TURBO button twice, the auto TURBO function will be launched.

Turn off: Repeat the last operation.



D-pad and Left Joystick Function Switching

1. Press down and hold the left joystick, and press the Fn button. The D-pad and left joystick will interchange roles internally.
2. Restore to default: press down and hold the left joystick, and press the Fn button.

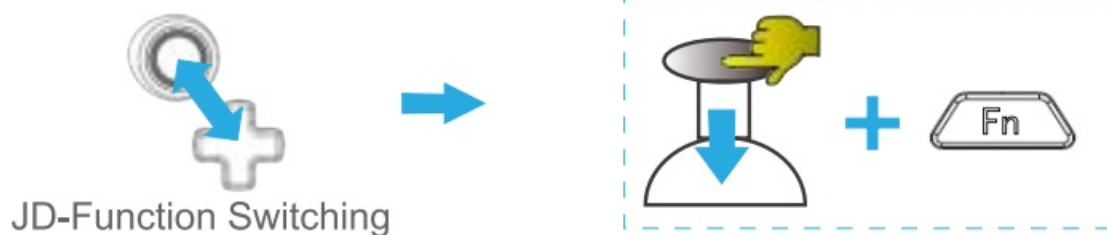

RGB Light

Breathing Mode: Press the Fn button twice.

RGB light off: In breathing mode, press the Fn button twice in a row again to turn off the RGB light;

Change Color: Press and hold Fn button, and press “” or “+” button.

‘RGB lights have 8 color adjustable settings – red, purple, cyan, green, orange, blue, pink, and white.

Mobile APP Function

Download for iOS: Search (Keylinkerl on App Store.

Download for Android: Search (Keylinkerl on Google Play.



How to use the APP:

1. Power on the controller or connect the controller to your device.
2. Turn on the Bluetooth on your mobile phone.
3. Start the (Keylinker! APP, it will automatically search for the nearby controller devices.
4. Click on the “Controller ID Code” found in the search to connect and use the app.

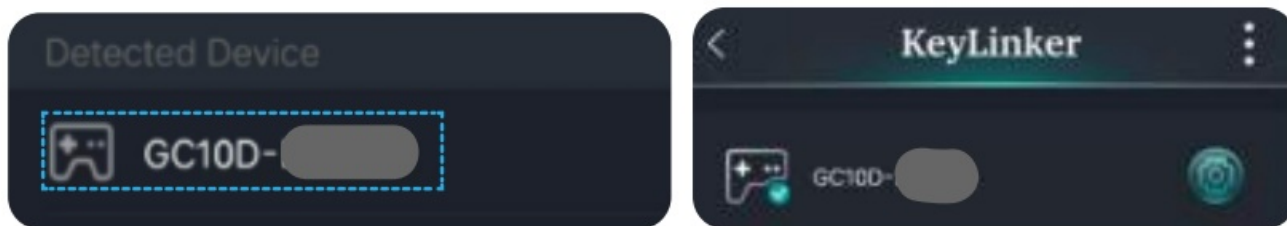

APP Function Introduction:

- Buttons Function Switching
- Joysticks Curves Adjustment
- Triggers Curves Adjustment
- Turbo Function settings
- Vibration Adjustment Function
- Gyro Calibration
- Buttons Testing Function
- Reset
- More functions are under development

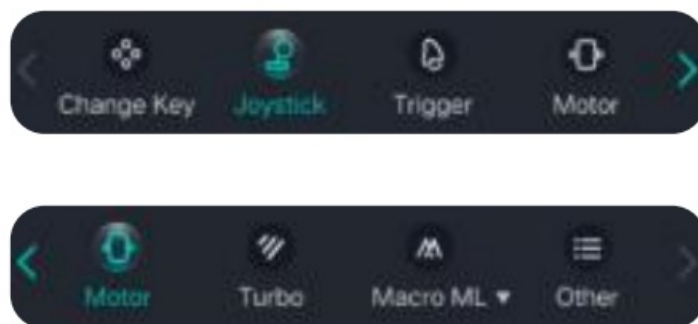

Update Firmware

After connecting the APP, click on the upper right corner of the APP interface  and then click on “Update device” in the drop-down menu to check if there is any new version update.

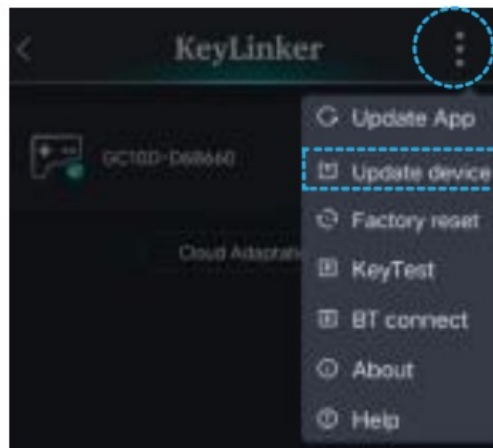

Turn Off/Sleeping Function

Turn Off: Press the HOME button on the controller for 5s.

Sleeping: When the controller is connected wirelessly, it will automatically enter sleeping mode after 20 minutes without any operation on the controller.

When the auto TURBO is turned on, the controller will not enter sleeping mode.

Charging Function

Charging Power: standard USB 5V voltage. The controller can be charged by connecting the USB port of the phone charger, computer, etc.

Fully charged will take about 2-3 hours.

Controller State	Battery State	Indicator State
Working State	Low Battery	Flash Slowly
	Charging	Remain ON
	Fully Charged	Remain OFF
Power OFF	Charging	Remain ON
	Fully Charged	Remain OFF

Reset Function

When the controller has a functional disorder, freezes, or other abnormalities, please use a needle to poke the reset button hole on the back of the gamepad to restore the factory settings.

After restoring, please re-connect and pair it.

Product Specifications

Product Model	GC10D
Connection Method	Wired/Bluetooth/2.4G Dongle
Input Current	Type-C, DC 5V/500 mA
Working Current	3.7V/35—105 mA
Working Power	Built-in 800mAh lithium battery
Charging Time	About 3H
Playing Time	About 15-20H
Product Size	About 15810658mm
Product Weight	About 225 g
Use Temperature	10-40 C
Use Humidity	20-80 %

Attention

- Avoid strong vibration, do not disassemble, modify or repair by yourself.
- Prevent water or other liquids from entering the controller to avoid damage.
- Avoid storing in humid, high-temperature, oily smoke, and other places.
- Built-in battery, please do not throw the controller into the fire to avoid an explosion.
- Children should be under adult supervision at all times when using this product.
- If you have any problems or suggestions about the product, please contact the seller or the after-services.

Documents / Resources

	<p>YIONON GC10D Wireless Gaming Controller [pdf] User Manual GC10D Wireless Gaming Controller, GC10D, Wireless Gaming Controller, Gaming Controller, C ontroller</p>
---	--

References

- [User Manual](#)

[Manuals+](#), [Privacy Policy](#)

This website is an independent publication and is neither affiliated with nor endorsed by any of the trademark owners. The "Bluetooth®" word mark and logos are registered trademarks owned by Bluetooth SIG, Inc. The "Wi-Fi®" word mark and logos are registered trademarks owned by the Wi-Fi Alliance. Any use of these marks on this website does not imply any affiliation with or endorsement.