



Yintiny B0CCSKLTSW Rechargeable Cute CD Player With Bluetooth 5.0 User Manual

[Home](#) » [Yintiny](#) » Yintiny B0CCSKLTSW Rechargeable Cute CD Player With Bluetooth 5.0 User Manual 

Contents

- [1 Yintiny B0CCSKLTSW Rechargeable Cute CD Player With Bluetooth 5.0](#)
- [2 Product Information](#)
- [3 Product Usage Instructions](#)
- [4 CD Player Specifications](#)
- [5 Advantages of the CD player](#)
- [6 Function Introduction](#)
- [7 Faults and Causes](#)
- [8 Wall Mount Bracket Installation](#)
- [9 Documents / Resources](#)
- [10 Related Posts](#)

Yintiny

Yintiny B0CCSKLTSW Rechargeable Cute CD Player With Bluetooth 5.0

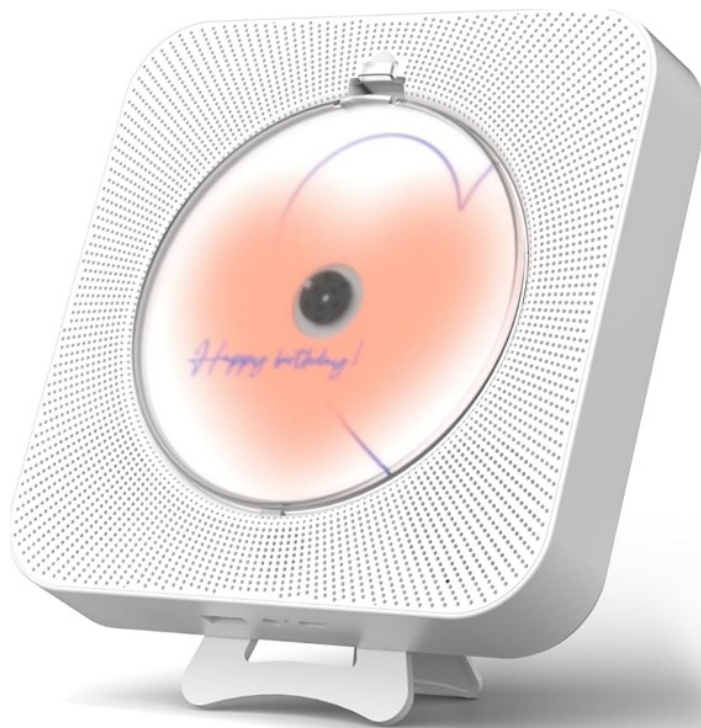

Product Information

Specification	Value
Dimensions	7.4*7.4*1.26 inches
Net Weight	525g
Rated Power	10W
Rated Voltage	5V
Speaker Rated Output Power	3W

Product Usage Instructions

- Powering On:** Press and hold the MODE button on the machine for a few seconds to power on when the battery is charged or the machine is connected to power.
- Powering Off:** While in the power-on state, press and hold the MODE button on the machine or press the power-off button of the remote control to power off. After 10 seconds of powering off with the remote control, the machine will be completely powered off and can be powered on again by pressing the MODE button for a few seconds.
- Playing a CD:** Prepare the CD and place it on the CD tray. Press and hold the MODE button to power on the machine (it defaults to CD mode with a green light). The CD will start spinning and after about 10 seconds of reading, the music will start playing.
- Using the Bluetooth Function:** With the machine powered on, press the MODE button once or press the Bluetooth button on the remote control to switch to Bluetooth mode. The machine light will turn blue and start flashing. Then, go to the Bluetooth settings on your mobile device, search for CD Bluetooth, and pair and connect to it. The light will stay solid blue. You can now play music from your mobile device through the Bluetooth connection.
- Playing Music from a USB Drive:** While the machine is powered on, simply insert the USB drive. It will read

the data briefly and start playing the music.

6. **Connecting External Speakers:** Use an AUX audio cable to connect one end to the CD player's headphone jack and the other end to the audio input on your external speakers. The music will play through the connected speakers.
7. **Using the A-B Repeat Function:** Press the A-B button on the remote control at the beginning of the section you want to repeat. Press the A-B button again at the end of the section. The player will repeat playing that section. Pressing the A-B button again will cancel the A-B repeat function.
8. **Selecting Play Mode in CD Mode:** While the CD is playing, press the repeat button on the remote control to cycle through different play modes: random play, all tracks repeat, single track repeat, and normal play.
9. **Fast Forward or Rewind:**
 - Fast forward: Press and hold the Next Track button on the machine or the remote control.
10. **Connecting Bluetooth Headphones & Bluetooth Speakers (Bluetooth Transmitter models only):**
 1. Using the remote control, press and hold the Bluetooth icon button for 3 seconds, or on the device, press and hold the Play/Pause button for 3 seconds to switch to Bluetooth transmitting mode.
 2. Put your Bluetooth headphones or Bluetooth speakers into pairing mode.
 3. The device will automatically connect to the paired Bluetooth headphones or speakers.

Please refer to the user manual for a detailed description of all the features and functions of the portable Bluetooth CD player. If you encounter any problems or have further questions, please refer to the troubleshooting section or contact our customer support.

CD Player Specifications

1. Dimensions: 7.4*7.4*1.26 inches
2. Net Weight: 525g
3. Rated Power: 10W
4. Rated Voltage: 5V
5. Speaker Rated Output Power: 3W

Advantages of the CD player

1. CD playback.
2. Bluetooth 5.0 connection for music playback from mobile devices.
3. USB and memory card (card reader required) playback.
4. Built-in dual speakers with stereo output.
5. Support for external playback with a 3.5mm audio cable.
6. Support for external speakers to enhance the sound experience.
7. A-B repeat function.
8. Supports normal playback, single-track repeat, full-track repeat, and random play modes.
9. Wall mountable.
10. Suitable for desktop placement.
11. Vinyl CD playback.
12. Supports fast forward and rewind.
13. Built-in high-capacity battery, easy to carry and use anywhere, anytime.

14. Wireless remote control.
15. Bluetooth transmission.

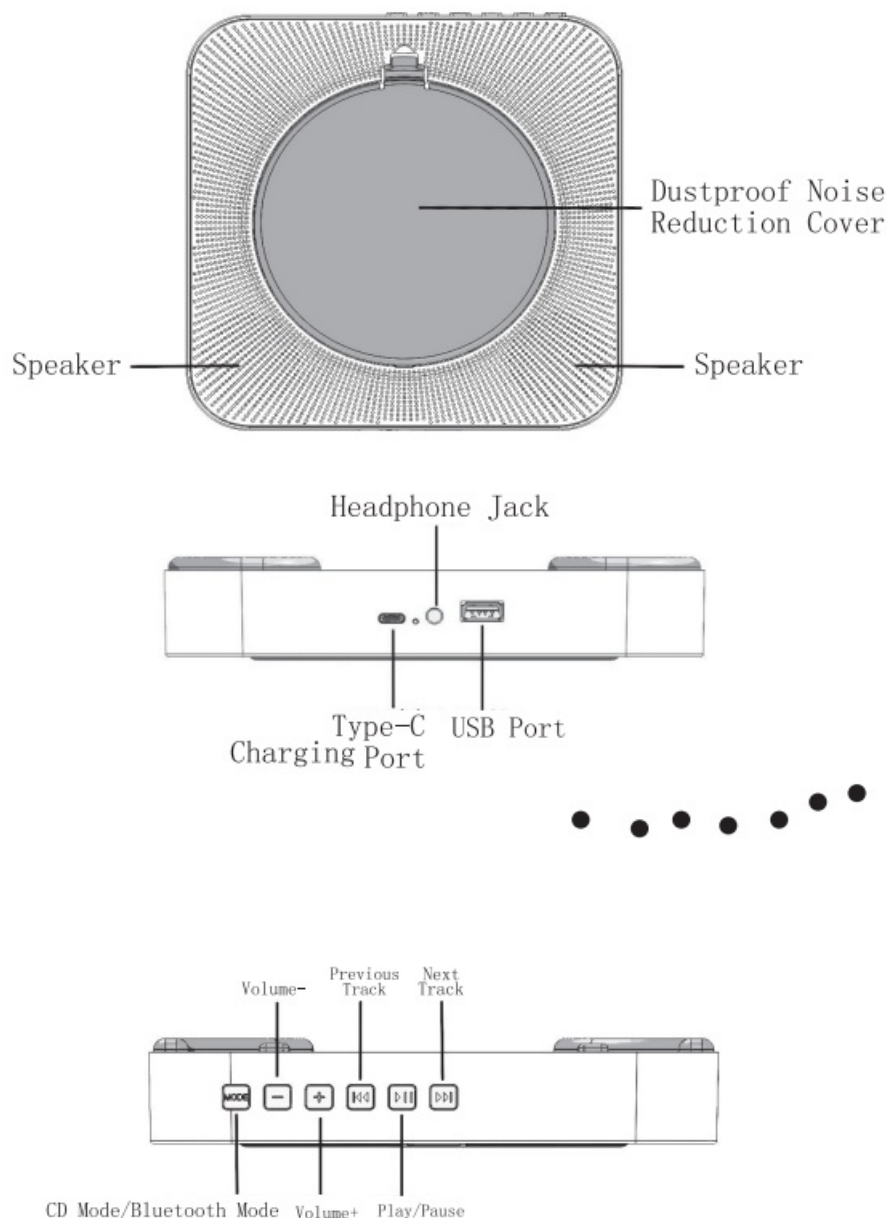

Function Introduction

1. How to power it on?

Press and hold the MODE button on the machine for a few seconds to power on when the battery is charged or the machine is connected to power.

2. How to power off?

While in the power-on state, press and hold the MODE button on the machine or press the power-off button of the remote control to power off. (After 10 seconds of powering off with the remote control, the machine will be completely powered off and can be powered on again by pressing the MODE button for a few seconds.)

3. How to play a CD?

Prepare the CD and place it on the CD tray. Press and hold the MODE button to power on the machine (it defaults to CD mode with a green light). The CD will start spinning and after about 10 seconds of reading, the music will start playing.

4. How to use the Bluetooth function?

With the machine powered on, press the MODE button once or press the Bluetooth button on the remote control to switch to Bluetooth mode. The machine light will turn blue and start flashing. Then, go to the Bluetooth settings on your mobile device, search for “CD Bluetooth,” and pair and connect to it. The light will stay solid blue. You can now play music from your mobile device through the Bluetooth connection.

5. How to play music from a USB drive?

While the machine is powered on, simply insert the USB drive. It will read the data briefly and start playing the music.

6. How to connect external speakers?

Use an AUX audio cable to connect one end to the CD player’s headphone jack and the other end to the audio input on your external speakers. The music will play through the connected speakers.

7. How to use the A-B repeat function?

Press the A-B button on the remote control at the beginning of the section you want to repeat. Press the A-B button again at the end of the section. The player will repeat playing that section. Pressing the A-B button again will cancel the A-B repeat function.

8. How to select the play mode in CD mode?

While the CD is playing, press the repeat button on the remote control to cycle through different play modes: random play, all tracks repeat, single track repeat, and normal play.

9. How to fast forward or rewind?

1. Fast forward: Press and hold the Next Track button on the machine or the remote control.

10. How to Connect Bluetooth Headphones & Bluetooth Speakers (Bluetooth Transmitter models only)?

1. Using the remote control, press and hold the Bluetooth icon button for 3 seconds, or on the device, press and hold the Play/Pause button for 3 seconds to switch to Bluetooth transmitting mode.
2. Put your Bluetooth headphones or Bluetooth speakers into pairing mode.
3. The device will automatically connect to the paired Bluetooth headphones or speakers.

Please refer to this user manual for a detailed description of all the features and functions of the portable Bluetooth CD player. If you encounter any problems or have further questions, please refer to the troubleshooting section or contact our customer support.

Note: The specifications and features mentioned in this user manual are subject to change due to product improvements, if you have any problems using the product, please contact customer support via the shop back office to resolve the problem, thank you for your understanding!!!

Faults and Causes

1. This CD player cannot play DVDs, VCDs, MP4s, CD-ROMs, DVD-ROMs, or other similar discs. If such discs are used, the machine will not be able to read them and will automatically stop spinning after a while.
2. Discs with significant scratches may cause malfunctions during CD playback. Please avoid using heavily scratched discs.
3. Remote control not working:
 - Check if the remote control has batteries installed.
 - Ensure that the batteries are inserted correctly with the correct polarity.
 - Verify if the batteries have sufficient power.
 - Make sure the remote control is pointed towards the CD player’s sensor area.
 - Ensure that the remote control is within a distance of 5 meters from the CD player.
4. For any other malfunction, please contact customer support immediately. Do not attempt to dismantle the CD

player on your own.

5. Avoid using the CD player in damp locations, such as bathrooms, as excessive moisture can damage electronic components.
6. During CD playback, if you experience stuttering or freezing, it may be due to the insufficient power supply. You can try replacing the charging plug to see if it resolves the issue. Please follow these guidelines to address the mentioned faults and ensure the proper functioning and longevity of the CD player.

Wall Mount Bracket Installation

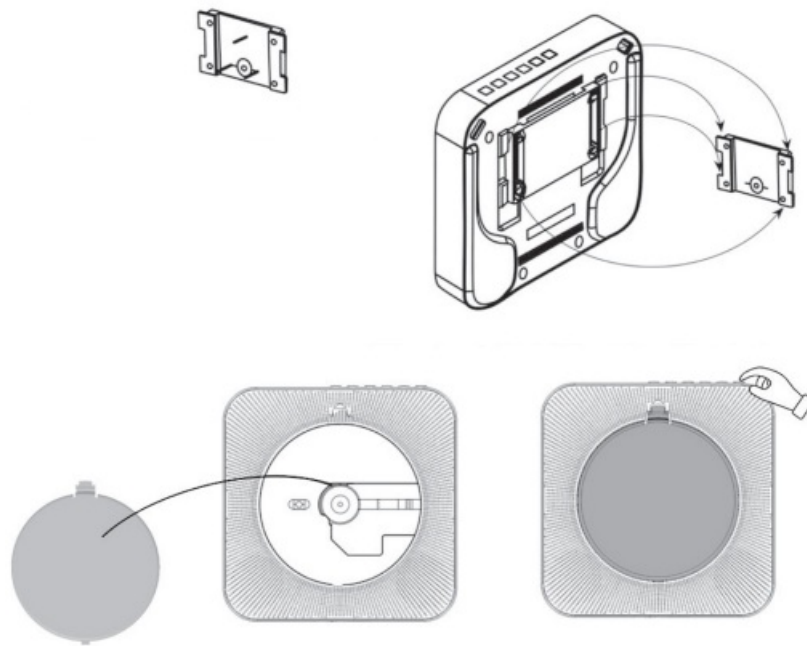

1. Use three new steel screws to secure the bracket to the wall. Make sure the bracket is firmly attached to the wall, providing stable support.
2. Locate the groove on the back of the CD player main unit. The groove is usually located in the center of the CD player. Insert the CD player onto the bracket, aligning the groove with the hooks or protrusions on the bracket.
3. Ensure that the CD player is securely mounted on the bracket to prevent any shaking or detachment.

Introduction of remote control diagram

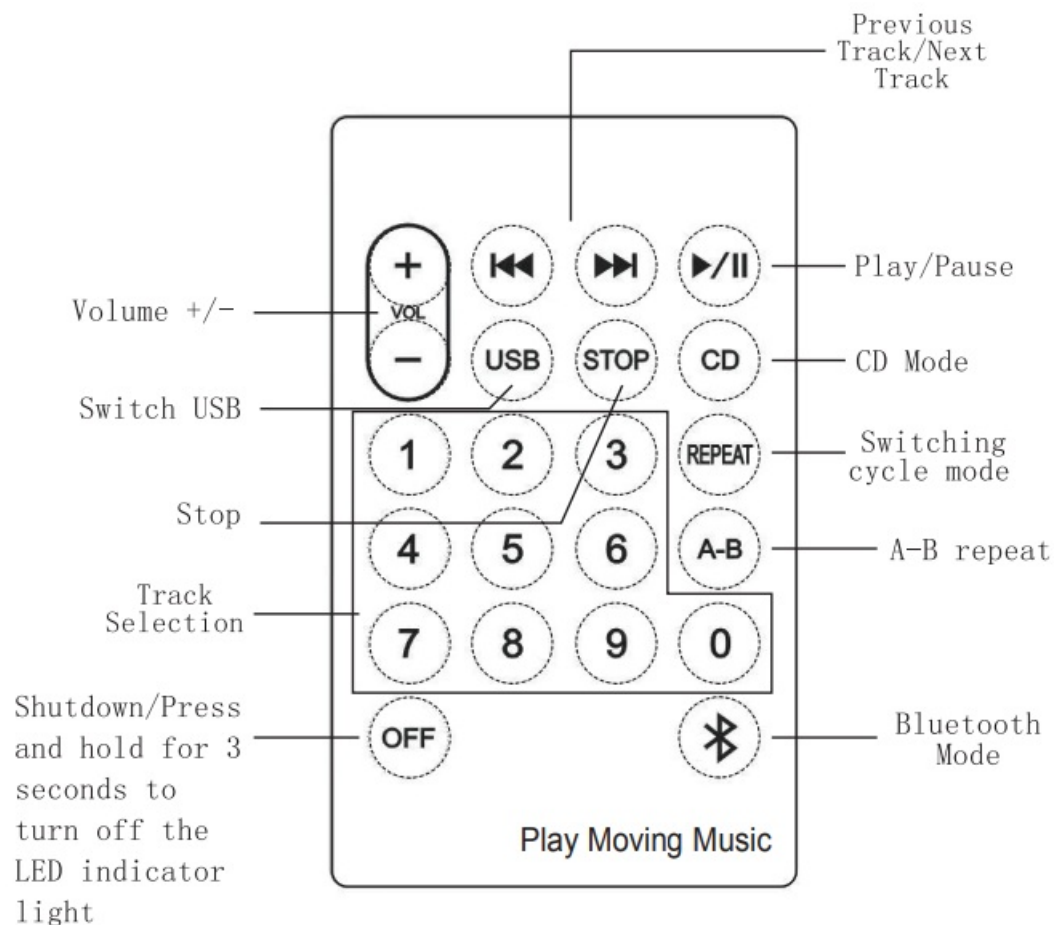

Documents / Resources

	Yintiny B0CCSKLTSW Rechargeable Cute CD Player With Bluetooth 5.0 [pdf] User Manual B0CCSKLTSW Rechargeable Cute CD Player With Bluetooth 5.0, B0CCSKLTSW, Rechargeabl e Cute CD Player With Bluetooth 5.0, Cute CD Player With Bluetooth 5.0, CD Player With Bluet ooth 5.0, Player With Bluetooth 5.0, With Bluetooth 5.0, Bluetooth 5.0
---	---