



yeedi Cube Robot Vacuum and Mop User Manual

[Home](#) » [yeedi](#) » yeedi Cube Robot Vacuum and Mop User Manual 



INSTRUCTION MANUAL cube Robot Vacuum and Mop

Contents

- [1 IMPORTANT SAFETY INSTRUCTIONS](#)
- [2 Package Contents](#)
- [3 Mapping and Cleaning](#)
- [4 Maintenance](#)
- [5 Troubleshooting](#)
- [6 Product Specifications](#)
- [7 Documents / Resources](#)
 - [7.1 References](#)

IMPORTANT SAFETY INSTRUCTIONS

When using an electrical Appliance, basic precautions should always be followed, including the following:
READ ALL INSTRUCTIONS BEFORE USING THIS APPLIANCE SAVE THESE INSTRUCTIONS

1. This Appliance can be used by children aged from 8 years and above and persons with reduced physical, sensory or mental capabilities or lack of experience and knowledge if they have been given supervision or instruction concerning use of the Appliance in a safe way and understand the hazards involved. Children shall not play with the Appliance. Cleaning and user maintenance shall not be made by children without supervision.
2. Clear the area to be cleaned. Remove power cords and small objects from the floor that could entangle the

Appliance. Tuck rug fringe under the rug base, and lift items such as curtains and tablecloths off the floor.

3. If there is a drop off in the cleaning area due to a step or stairs, you should operate the Appliance to ensure that it can detect the step without falling over the edge. It may become necessary to place a physical barrier at the edge to keep the unit from falling. Make sure the physical barrier is not a trip hazard.
4. Only use as described in this manual. Only use attachments recommended or sold by the manufacturer.
5. Please make sure your power supply source voltage matches the power voltage marked on the OMNI Station.
6. For INDOOR household use ONLY. Do not use the Appliance in outdoor, commercial or industrial environments.
7. Use only the original rechargeable battery and OMNI Station provided with the Appliance from the manufacturer. Nonrechargeable batteries are prohibited.
8. Do not use without dust bin and/or filters in place.
9. Do not operate the Appliance in an area where there are lit candles or fragile objects.
10. Do not use in extremely hot or cold environments (below -5°C/23°F or above 40°C/104°F).
11. Keep hair, loose clothing, fingers, and all parts of body away from any openings and moving parts.
12. Do not operate the Appliance in a room where an infant or child is sleeping.
13. Do not use Appliance on wet surfaces or surfaces with standing water.
14. Do not allow the Appliance to pick up large objects like stones, large pieces of paper or any item that may clog the Appliance.
15. Do not use Appliance to pick up flammable or combustible materials such as gasoline, printer or copier toner, or use in areas where they may be present.
16. Do not use Appliance to pick up anything that is burning or smoking, such as cigarettes, matches, hot ashes, or anything that could cause a fire.
17. Do not put objects into the suction intake.
Do not use if the suction intake is blocked.
Keep the intake clear of dust, lint, hair, or anything that may reduce air flow.
18. Take care not to damage the power cord. Do not pull on or carry the Appliance or OMNI Station by the power cord, use the power cord as a handle, close a door on the power cord, or pull power cord around sharp edges or corners. Do not run Appliance over the power cord. Keep power cord away from hot surfaces.
19. If the power cord is damaged, it must be replaced by the manufacturer or its service agent in order to avoid a hazard.
20. Do not use the OMNI Station if it is damaged. The power supply is not to be repaired and not to be used any longer if it is damaged or defective.
21. Do not use with a damaged power cord or receptacle. Do not use the Appliance or OMNI Station if it is not working properly, has been dropped, damaged, left outdoors, or come in contact with water. It must be repaired by the manufacturer or its service agent in order to avoid a hazard.
22. Turn OFF the power switch before cleaning or maintaining the Appliance.
23. The plug must be removed from the receptacle before cleaning or maintaining the OMNI Station.
24. Remove the Appliance from the OMNI Station, and turn OFF the power switch to the Appliance before removing the battery for disposal of the Appliance.
25. The battery must be removed and discarded according to local laws and regulations before disposal of the Appliance.
26. Please dispose of used batteries according to local laws and regulations.
27. Do not incinerate the Appliance even if it is severely damaged. The batteries can explode in a fire.
28. When not using the OMNI Station for a long period of time, please unplug it.

29. The Appliance must be used in accordance with the directions in this Instruction Manual. The manufacturer cannot be held liable or responsible for any damages or injuries caused by improper use.
30. The Robot contains batteries that are only replaceable by skilled persons. To replace the Robot's battery, please contact Customer Service.
31. If the Robot will not be used for a long time, power OFF the Robot for storage and unplug the OMNI Station.
32. **WARNING:** For the purposes of recharging the battery, only use the detachable supply unit CH2251 provided with the Appliance.

To satisfy RF exposure requirements, a separation distance of 20 cm or more should be maintained between this device and persons during device operation.









To ensure compliance, operations at closer than this distance is not recommended. The antenna used for this transmitter must not be co-located in conjunction with any other antenna or transmitter.

To disable Wi-Fi module on Robot, power the Robot ON.

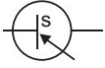
Place the Robot on the Charging Station making sure the Charging Contacts on Robot and the Charging Station Pins make a connection.

Press and hold the SPOT Button on the Robot for 20 seconds until Robot emits 1 beep.

To enable Wi-Fi module on Robot, power the Robot OFF and then power ON. The Wi-Fi module is turned on when Robot is restarted.

	Class II
	Short-circuit-proof safety isolating transformer
	Switch mode power supply
	For indoor use only
	Direct current
	Alternating current
	Read all instructions before using (this appliance)
	Time-lag miniature fuse-link

For EU Countries

For EU Declaration of Conformity information, visit <https://service.yeedi.com/pages/user-manuals>.

For UK

For UK Declaration of Conformity information, visit <https://service.yeedi.com/pages/user-manuals>.

Correct Disposal of this Product



This marking indicates that this product should not be disposed of with other household waste throughout the EU. To prevent possible harm to the environment or human health from uncontrolled waste disposal, recycle it responsibly to promote the sustainable reuse of material resources. To recycle your used device, please use the return and collection systems or contact the retailer where the product was purchased. They can safely recycle this product.

The remote surveillance is for the absolute private use of non-public, private owned places for the pure self-

protection and single control intended only. Please be aware of the local data protection based legal obligations in case of use. No surveillance of public places, especially with clandestine intent and/or on the part of the employer without justified reasons. Such not justified use is in the risk and responsibility of the user only.

Package Contents

1.1 Package Contents



Robot

(Pre-installed with UFO Water Tank, Dustbin, Multi-Surface Main Brush, Washable Filter and Easy-to-Clean Mopping Pad)



Edge Brushes



Water Tank Plug



Instruction Manual

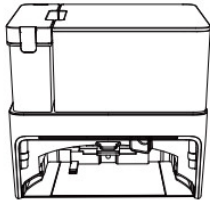

Cube Station

(Pre-installed with Dirty Water Tank and Dust Bag)



Detachable Base



Station Extension Pad

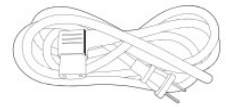

Power Cord

Note:

1. All figures and illustrations are for reference only and may present differences in appearance from the actual product.
2. The “Edge Brushes”, ”Water Tank Plug” , “Detachable Base” ,”Station Extension Pad” and “Power Cord” need to be installed by the user prior to use.
3. Accessories from different countries shall be subject to the actual product configuration at the time of purchase, and the patterns are for reference only.

1.2 Product Diagram

Robot Top View

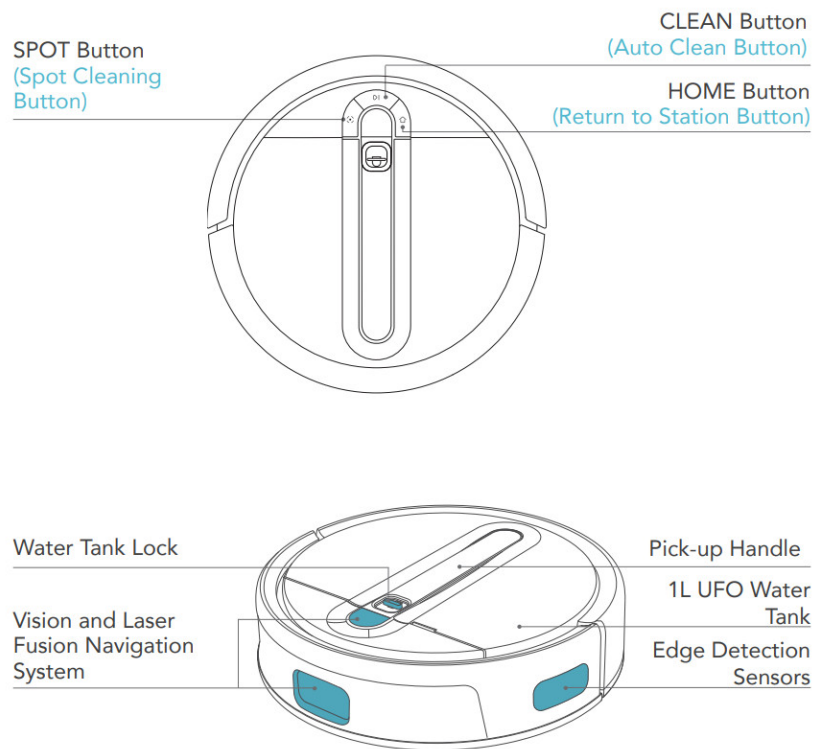

Robot Side View

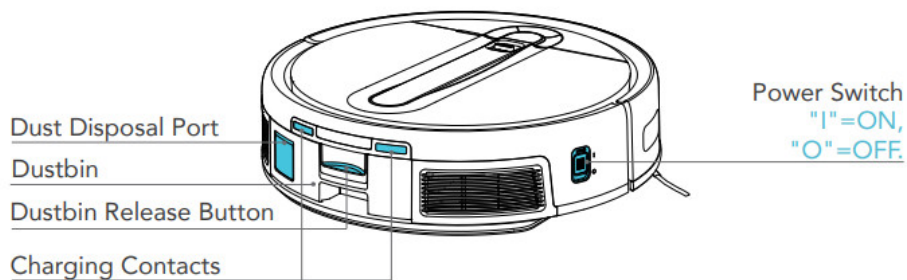

Robot Bottom View

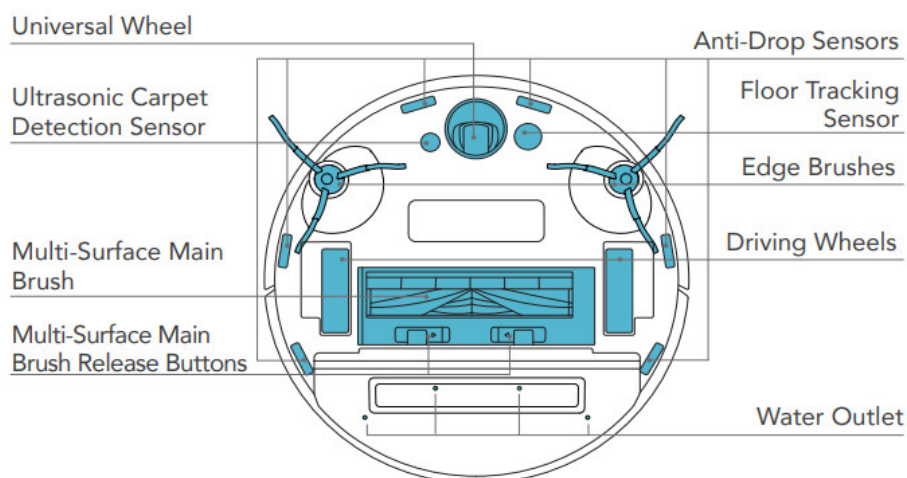

1.2 Product Diagram

UFO Water Tank

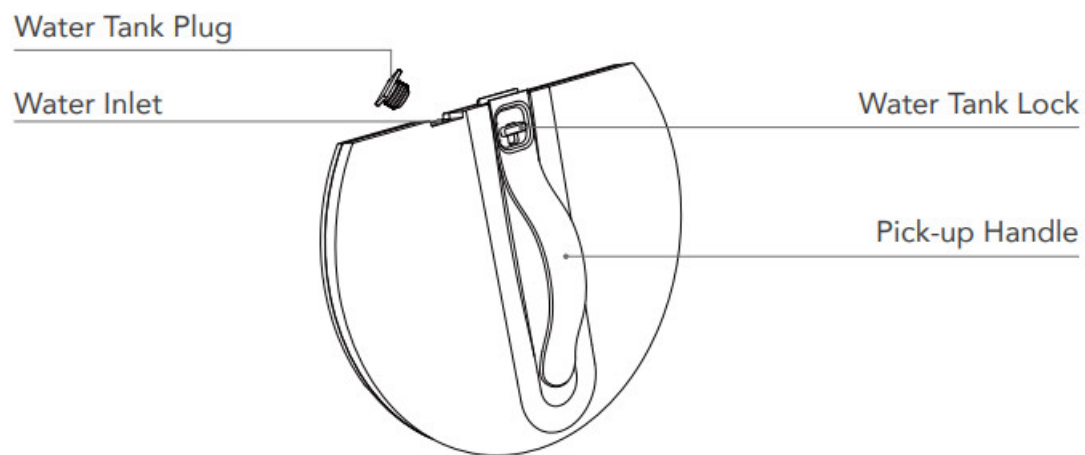

Dustbin

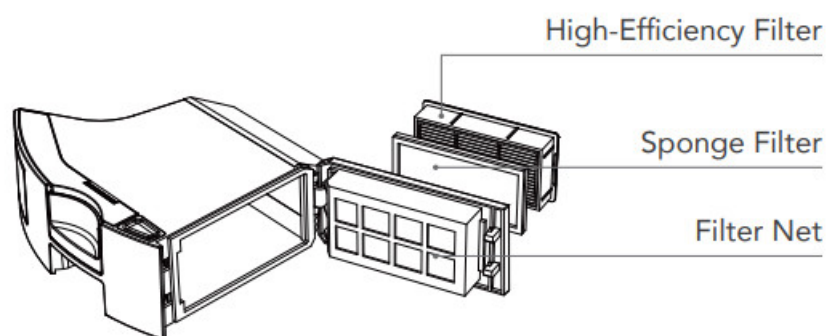

Cube Station

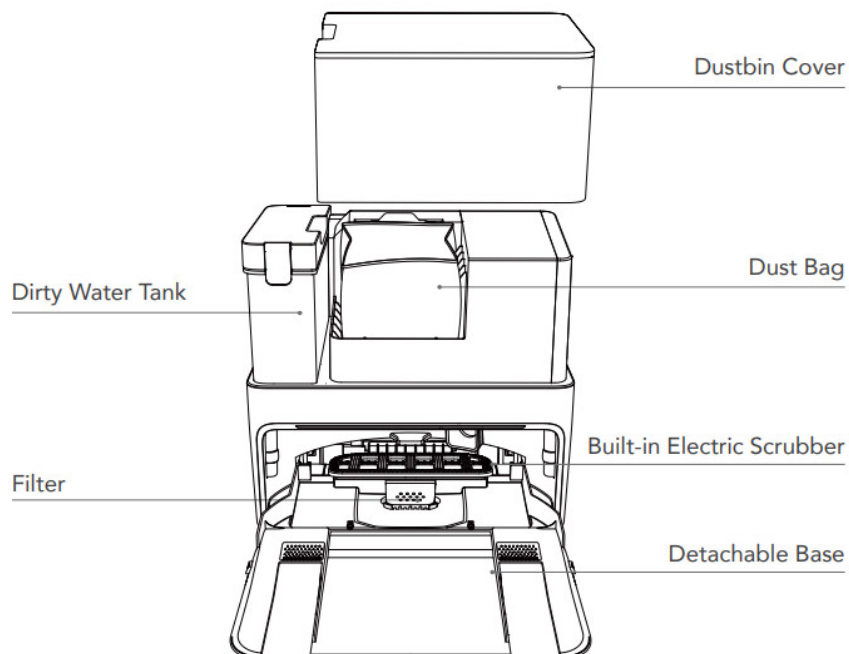

Note:

1. The Detachable Base needs to be installed by the user before use.
2. Lift the mop Built-in Electric Scrubber before installation and put it down after installation. Otherwise, the

Robot's operations will be affected.

3. The Filter is removable and needs to be cleaned regularly.

Mapping and Cleaning

2.1 Notes before Cleaning

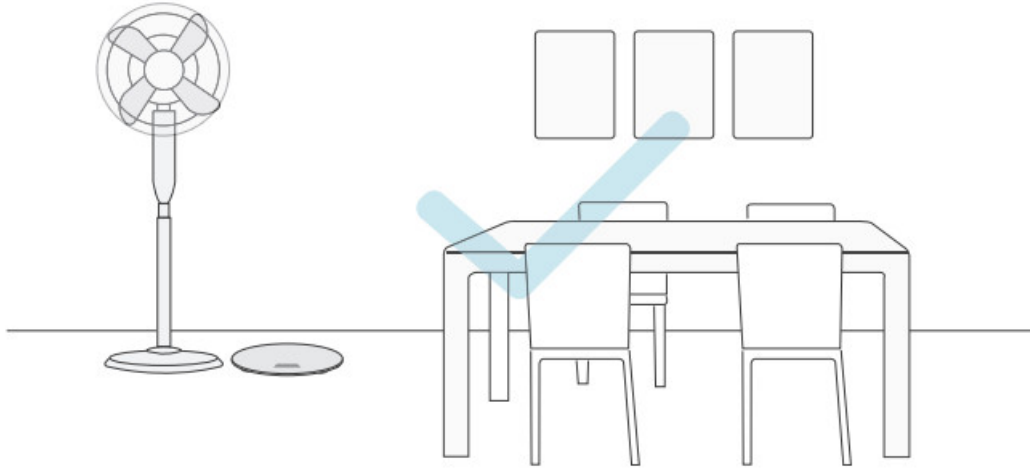

Tidy up the area to be cleaned

Put furniture, such as chairs and floor fans, in their proper place. Put away low items such as scales to ensure the maximum cleaning space.

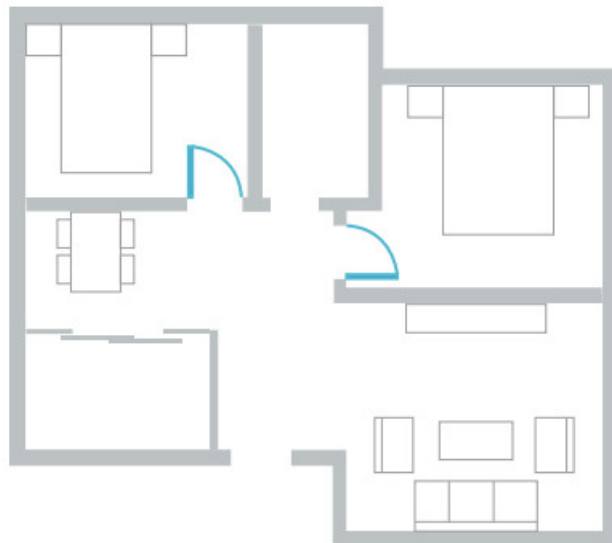

Open the door to help the Robot explore

During the first use, make sure each room door is open to help the Robot fully explore your house.

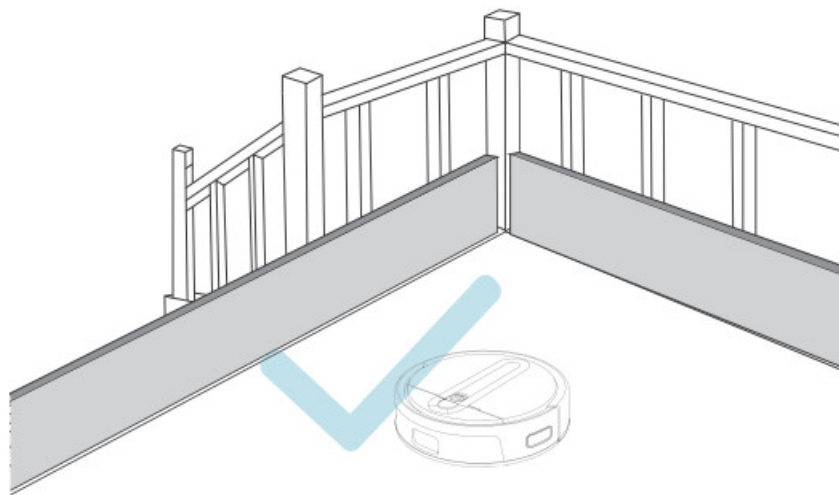

Stop the Robot from falling

It may be necessary to place a physical barrier at the edge of a drop to stop the Robot from falling over it.

	<p>Put away objects such as wires, cloths, or slippers that may be on the floor to improve the mapping and cleaning efficiency.</p>
	<p>Before using the Robot on a rug with tasseled edges, please fold the edges under the rug. Note: Do not use the mopping function on the carpet.</p>
	<p>Please do not stand in narrow spaces such as hallways so as to avoid preventing the Robot from identifying the area to be cleaned.</p>
	<p>Please make sure that the Robot has created a home map in the yeedi App before it starts cleaning.</p>

2.2 Notes before Using

1. Remove all protection materials

Please remove all protection materials on the Robot before use.

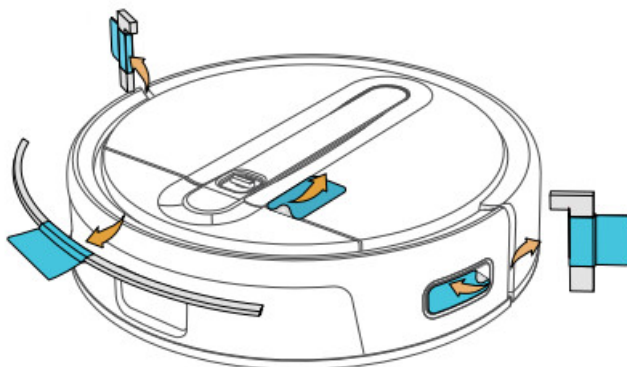

2. Install Edge Brushes

Make sure the color of the Edge Brushes is consistent with that of mounting slot. The “click” sound indicates a

successful connection.

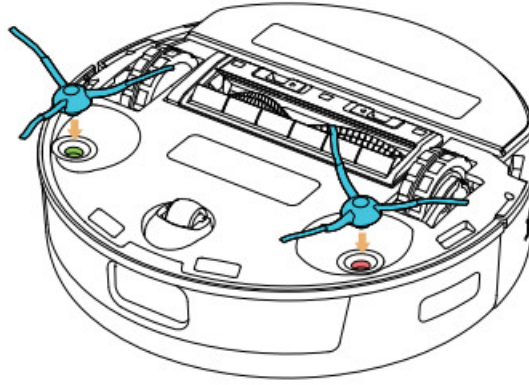

Note:

The Robot experience may be affected if protection materials are not removed.

3. Lift the Scrubber and install the Detachable Base.

Step 1: Lift the Scrubber and a “click” sound will be heard;

Step 2: Push the Detachable Base into the Station on a flat surface.

The “click” sound indicates a successful connection.

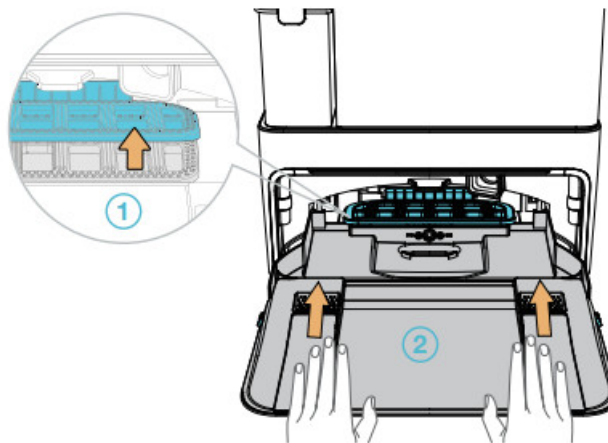

4. Reset the Scrubber once it has been successfully installed.

Lower the Scrubber to finish **installation**.

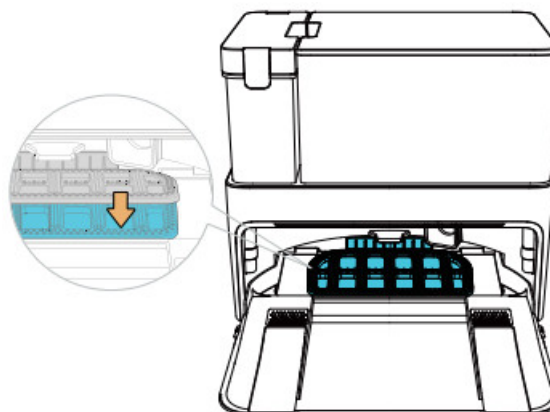

Note:

The Robot experience may be affected if the Scrubber is not lowered in time after installing the “Detachable Base”.

5. Put the Cube Station in place and connect it to the power supply. Install the Station Extension Pad.

Step 1: Place the Cube Station against the wall in a large space and do not place items within a radius of about 0.5 m or 1.5 m in front of it.

Step 2: Align the dashed line with the edge of the base, with the rough side facing up, and place it under the base. After putting it in place, peel off the transparent tape from the smooth bottom and stick the extension pad

onto the hard, non-carpeted **floor**.

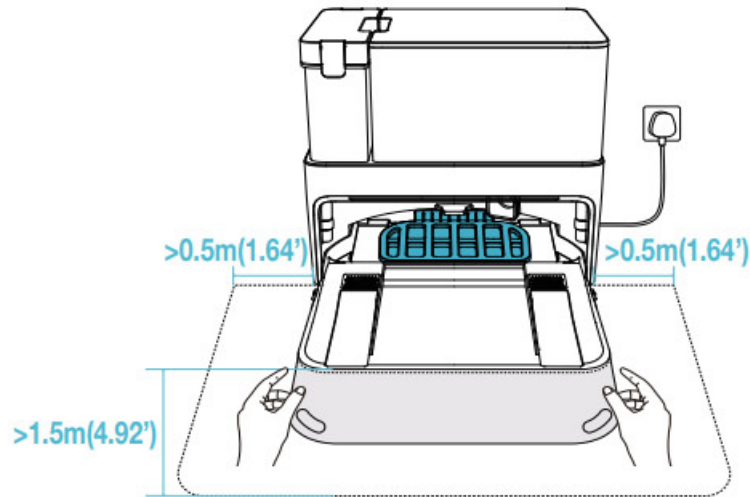

Note:

1. Cover an area of at least 5 cm height from the bottom of any reflective objects such as mirrors.
2. Do not place the Cube Station in direct sunlight.
3. Periodically wipe off any accumulated water on the Extension Pad to maintain its anti-slip effect.
4. Please do not move it frequently to avoid affecting the fixation of the extension pad.

6. Remove the UFO Water Tank.

Step 1: Hold the handle on the Water Tank with one hand and slide down the lock with your thumb to lift the Tank upward.

Step 2: Fill the Tank with clean water and put it back into the Robot after installing the **Plug**.

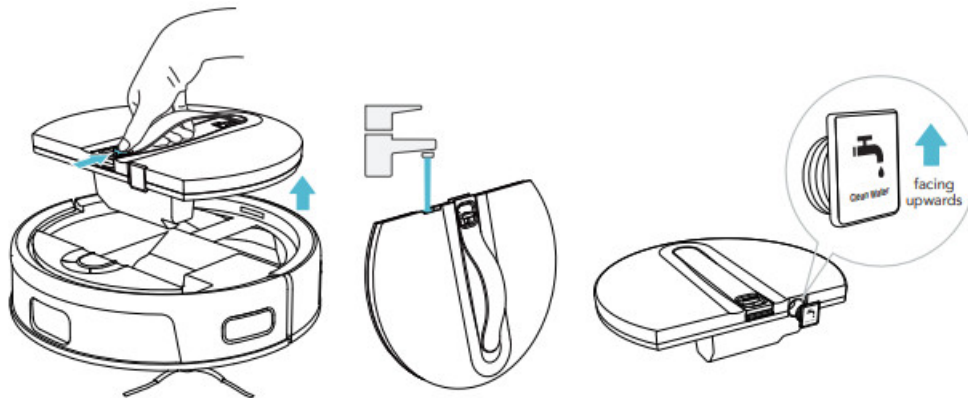

Note:

1. Please make sure the Tank Plug is installed.
 2. To prolong the service life of the Water Tank, it is recommended to use purified water or softened water.
 3. Do not add any cleaning solution from any other brands; excessive solution could cause the Robot to slip or be damaged.
 4. Keep the UFO Water Tank Plug properly.
 5. Do not put any foreign objects in the Tank.
- 7. Turn on the power switch, put the Robot near the Cube Station and press the HOME Button. The Robot will automatically return to the Station to charge.**

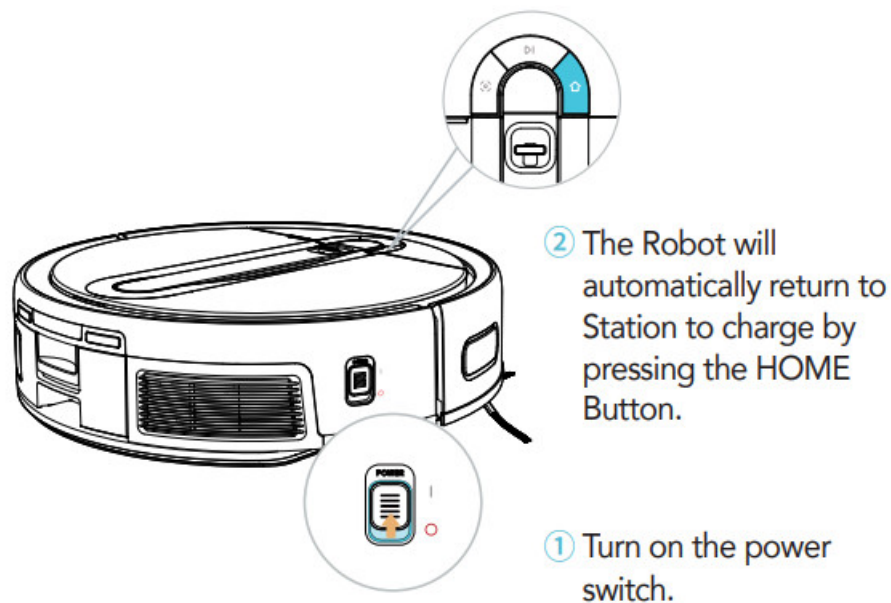

③ It will charge for about 6.5 hours until fully charged.

Note:

1. "I"=ON, "O"=OFF
2. The Robot cannot be charged when being powered OFF.
3. When the Robot completes the cleaning or when the battery gets low, it automatically returns to the Cube Station to recharge.
4. Please make sure that the Robot starts cleaning from the Station. Do not move the Station while it is cleaning.

2.3 yeedi App

1. Download the yeedi App to experience more functions:

Method 1: Open "Scan" in your mobile phone to scan the QR code on the Robot, download and install the yeedi App according to the prompts.

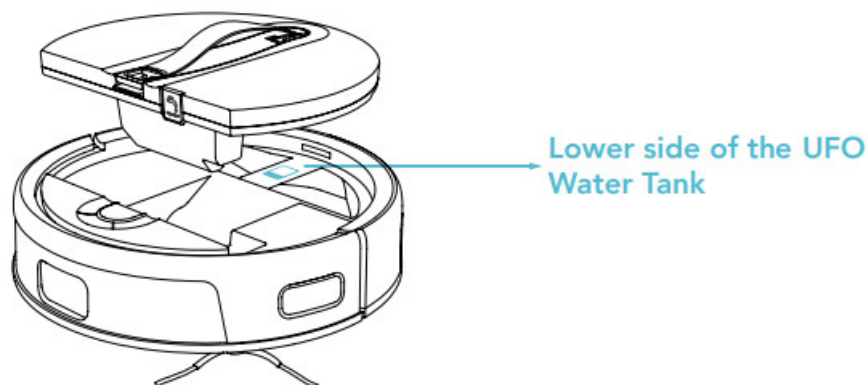

Method 2: Open the mobile App store, search "yeedi", download and install the yeedi App.

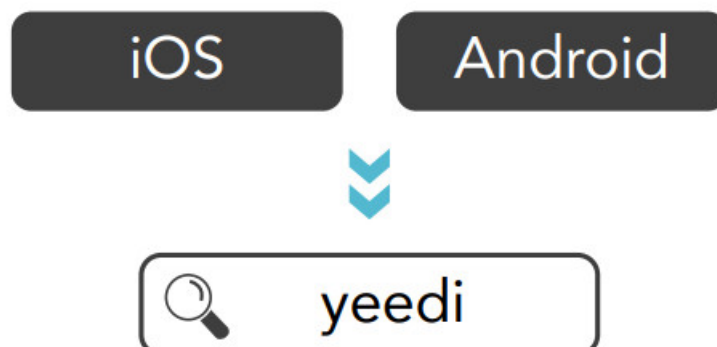

2. After downloading, please complete registration, login, and the network setup according to the guide in the mobile App page.

2.4 Connect the Robot to the Mobile Phone

Network setup steps:

1. Please turn on your mobile phone Bluetooth and Wi-Fi;
2. Make sure that yeedi cube Robot Vacuum and Mop is on;
3. Open the yeedi App;
4. Scan the QR code on the Robot using the yeedi App, complete “Confirm access to the setup mode”, “confirm the device and Wi-Fi to be connected”, and “enter the Wi-Fi password” respectively according to the prompts in the App, and then wait for the setup result;
5. If the network setup fails, it is recommended that you try again according to the above steps, or choose other network setup methods according to the prompts in the App.

	Slowly flashing white light	Disconnected from Wi-Fi or waiting for home Wi-Fi connection
	Rapidly flashing white light	Connecting to home Wi-Fi
	Solid white	Connected to home Wi-Fi

Note:

If you have any problems during the Wi-Fi setup process, refer to the Troubleshooting section in this manual.

2.5 Robot Operation Buttons

1. Function of the CLEAN Button (Auto Clean Button)

- Please ensure that the Robot is on the Cube Station and is fully charged before starting.
- Press the CLEAN Button to start the first mapping and Auto Clean.
- When the Robot is working, press the CLEAN Button to stop cleaning and press again to continue.
- Press and hold for 2 seconds to end the current cleaning task.

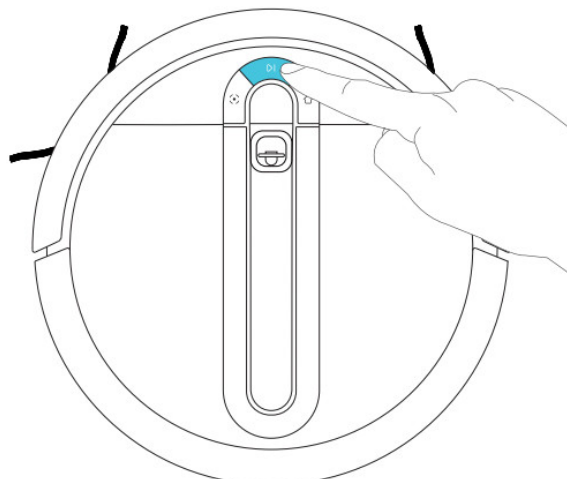

2. Function of the SPOT Button (Spot Cleaning Button)

- Please place the Robot in the area to be cleaned before starting.

- Press the SPOT Button to start the Spot Cleaning task, which will focus on the 1.5*1.5 meters area centered on the Robot (the Cleaning Settings can be modified in the App).
- When the Robot is working, press the SPOT Button to pause cleaning and press again to continue.
- Move the Robot to end the current Spot Cleaning and start the next one by pressing the SPOT Mode Button again.

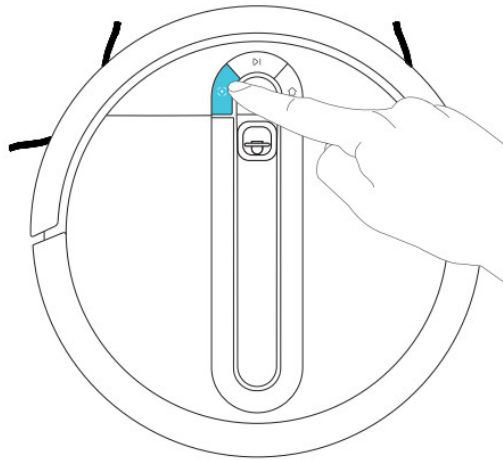

3. Function of the HOME Button (Return to Station Button)

- When the Robot is outside the Cube Station, press the HOME Button to return.
- Press the HOME Button to pause the returning; and press again to continue.

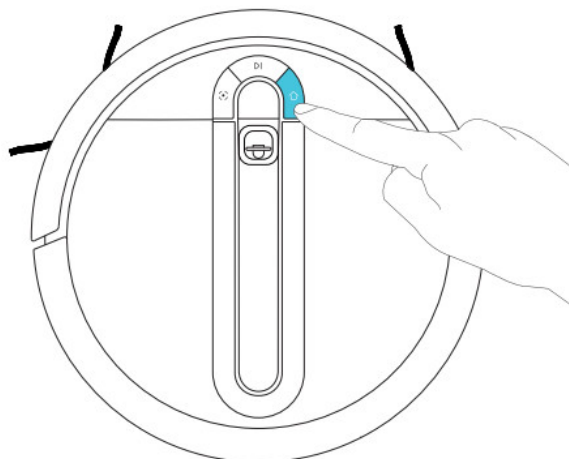

4. Button combination for network setup of the Wi-Fi Model

- Press the SPOT and HOME Buttons at the same time for 2 seconds.
- When you hear the prompt tone, the Robot enters the network setup mode.

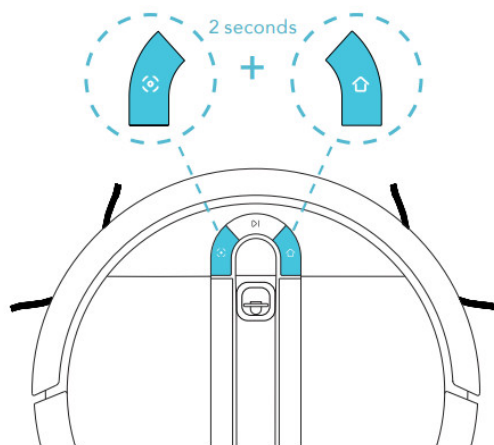

5. Button combination for restoring default setting

- Press the SPOT and HOME Buttons at the same time for 5 seconds.
- When the startup music sounds, the Robot has successfully restored default setting.

Note:

Use this button combination with caution as all of the Robot's usage data will be deleted after the default setting has been restored.

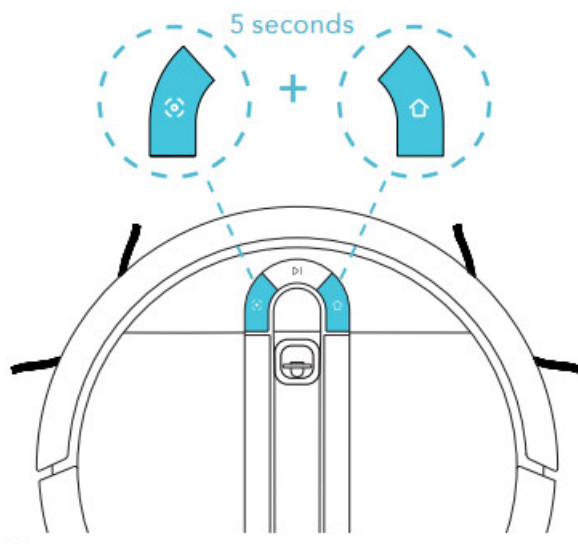

6. ON and OFF Button

- If you are not going to use the Robot for a long time, turn the power switch to “o” to shut it down.

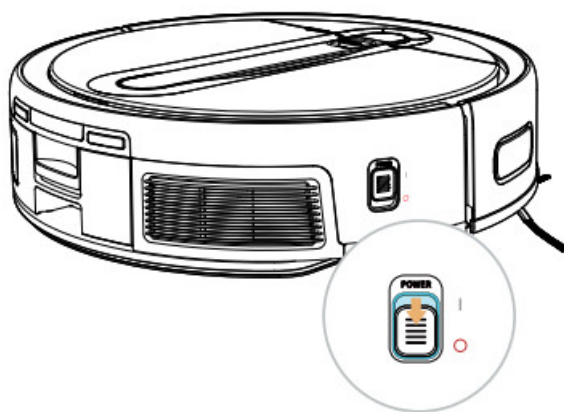

Note:

1. Do not turn the Robot off and keep it in charging state after working completed so as to facilitate control by the App and all forthcoming work.
2. If you are not going to use the Robot for a long time, please charge it every three months.

2.6 Instructions for Robot and Station Indicator Lights

1. Robot lighting effect

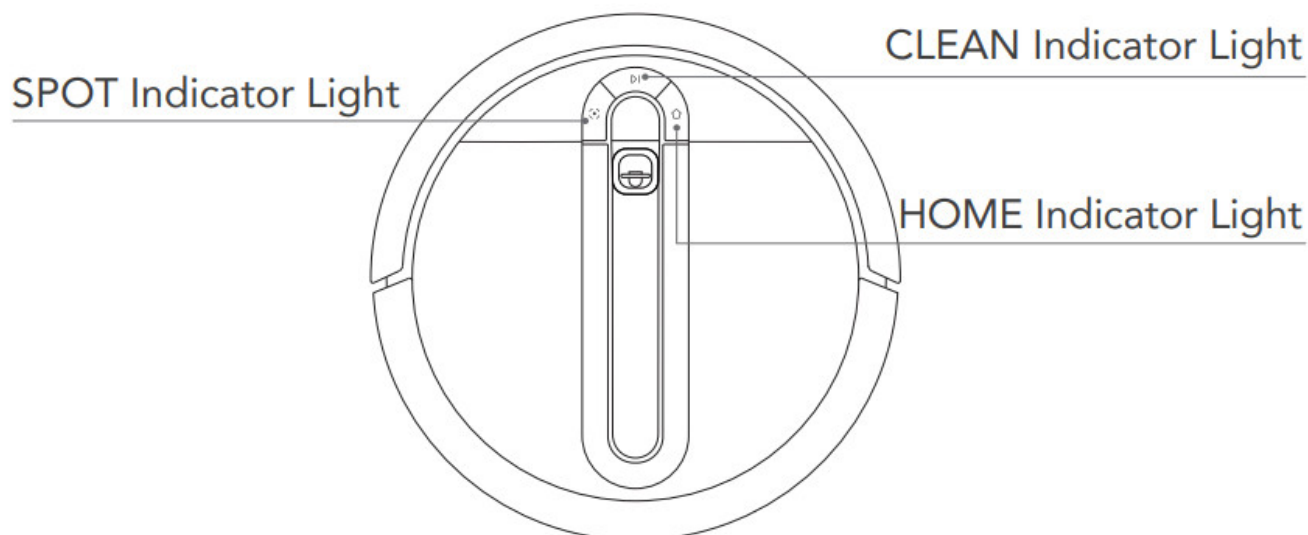

2. Cube Station lighting effect

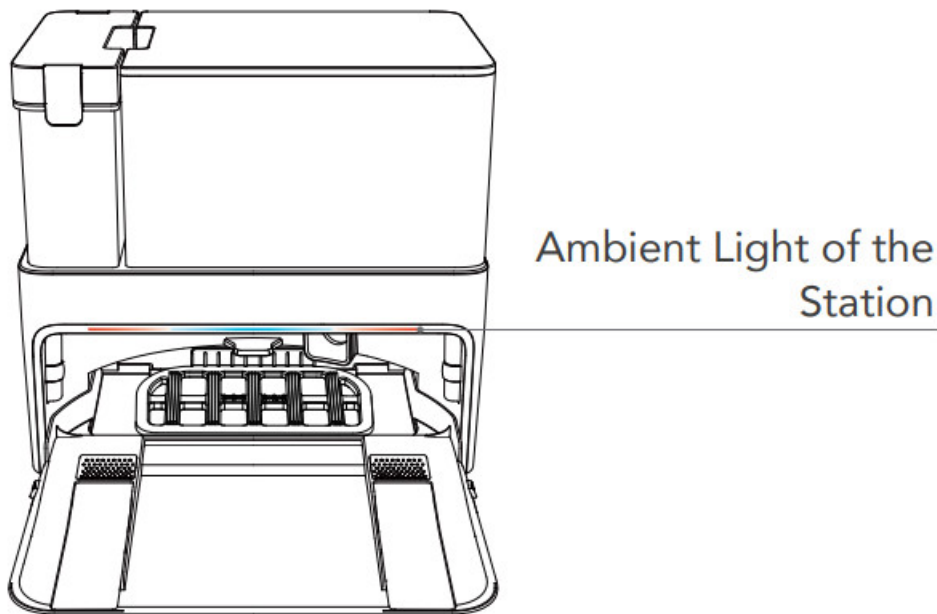

Indicator Light	Display Status	Robot Status
CLEAN Indicator Light	The light blue light is solid on	Have a cleaning task
	The red light is solid on	Low power/power off charging
	The red light flashes	Robot alarm status
	The white light is solid on	Standby/network setup succeeded/Base Station docking successful
	The white light is flashing	Charging/Start up/Robot loading/Firmware update
HOME Indicator Light	The white light is solid on	Return to Station
SPOT Indicator Light	The light blue light is solid on	Spot Cleaning
Ambient Light of the Station	The light blue light is solid on	Working/Charging
	The left red light is solid on	Dirty water bucket out of place/full of water
	The right red light is solid on	Dust Bag out of place

Maintenance

3.1 Regular Maintenance

To keep the Robot cleaning at peak performance, perform maintenance tasks and replace parts with the following frequencies:

Robot Parts	Maintenance Frequency	Replacement Frequency
Easy-to-Clean Mopping Pad	/	Every 3-6 months
Edge Brushes	Once every 2 weeks	Every 3-6 months
Multi-Surface Main Brush	Once per week	Every 6-12 months
Washable Filter	Once per week	Every 3-6 months
Edge Detection Sensors Vision and Laser Fusion Navigation System Universal Wheel Anti-Drop Sensors Robot Charging Contacts Station Charging Contacts Pins	Once per week	/
Detachable Base and Filter	Once every 2 weeks	/
Dirty Water Tank	After each mopping	/

Note:

yeedi manufactures various replacement parts and fittings. Please contact Customer Service for more information on replacement parts.

3.2 Dustbin and Washable Filter

1. Press the Dustbin Release Button to remove the Dustbin

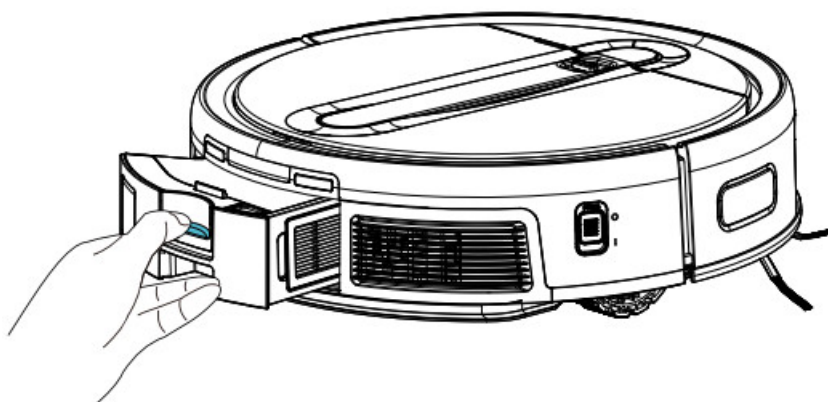

2. Press the Dustbin Cover Release Button to empty the Dustbin

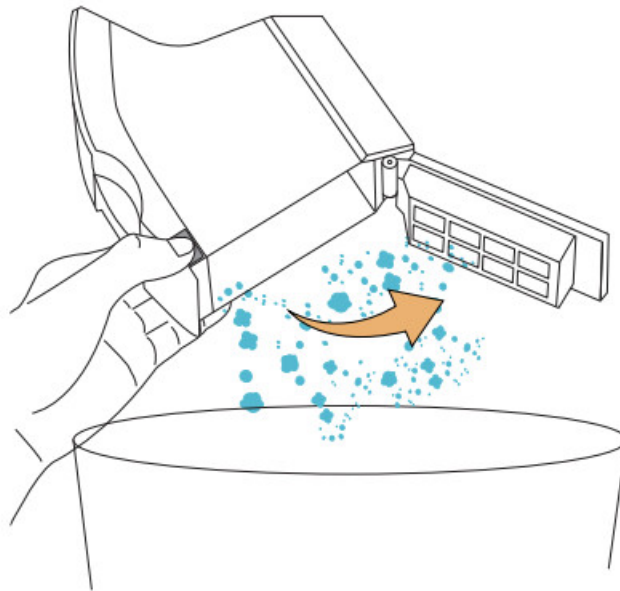

3. Open the Filter Net, remove the fine Washable Filter and the High-Efficiency Filter Assembly

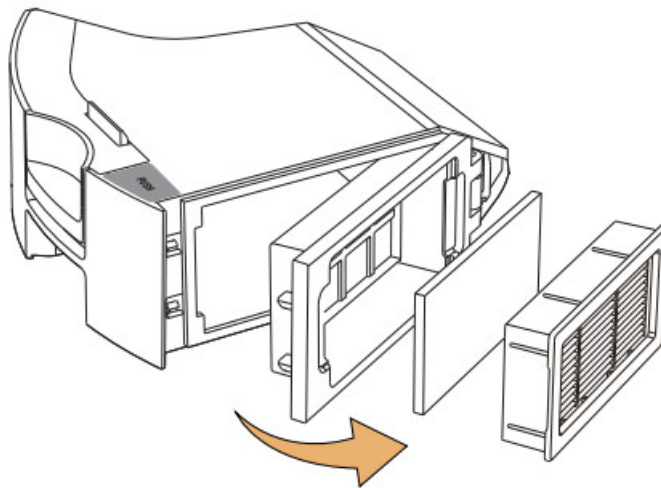

4. Clean the dust on both sides of the Filter Net with the Multi Function Cleaning Tool

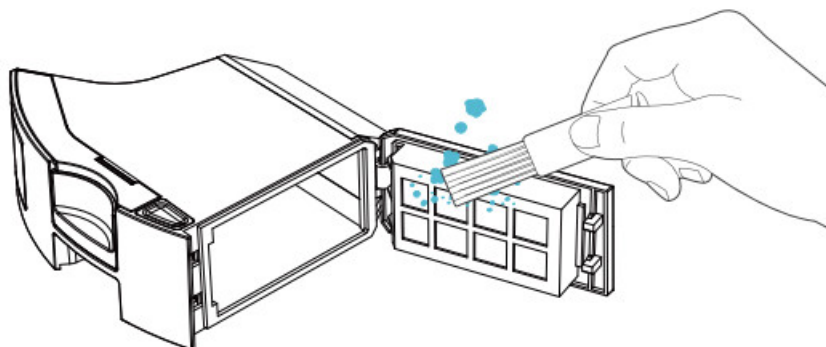

5. Wash High-Efficiency Filter Assembly, Sponge Filter and Dustbin with water

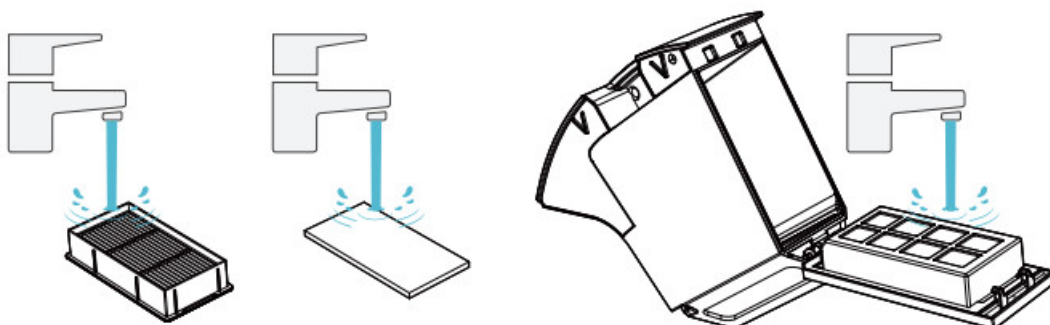

6. Air-dry High-Efficiency Filter Assembly, Sponge Filter and Dustbin

Note: Please avoid direct sunlight and exposure to high temperatures.

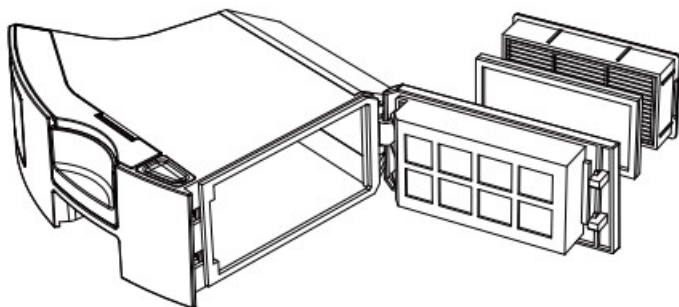

3.3 Vision and Laser Fusion Navigation System and Edge Detection Sensors

Please wipe with a clean soft cloth, and do not use detergent.

1. Wipe Vision and Laser Fusion Navigation System

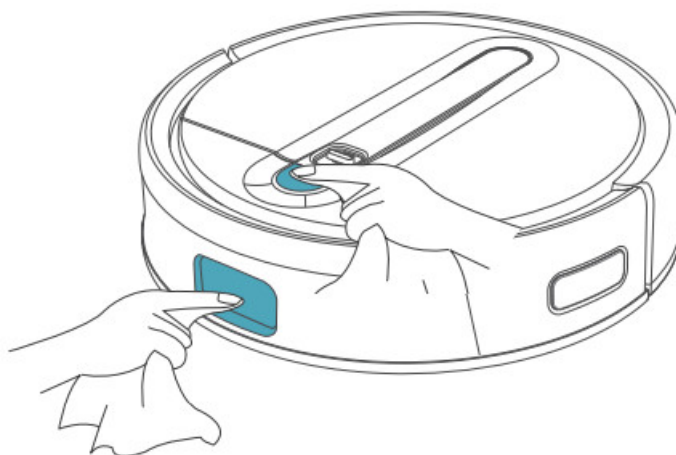

2. Wipe Edge Detection Sensors

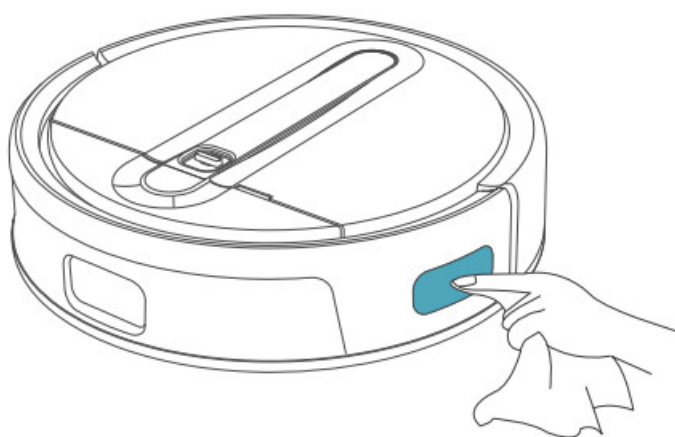

3.4 Anti-Drop Sensors and Charging Contacts Pins

Please wipe with a clean soft cloth, and do not use detergent.

1. Wipe Anti-Drop Sensors

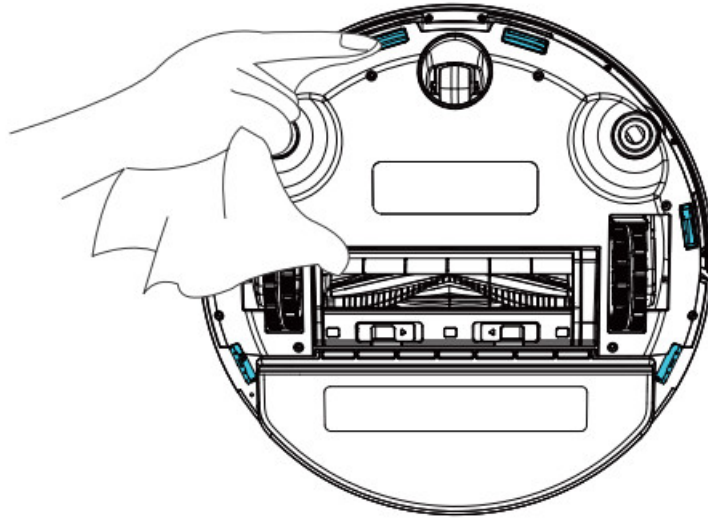

2. Wipe Robot Charging Contacts

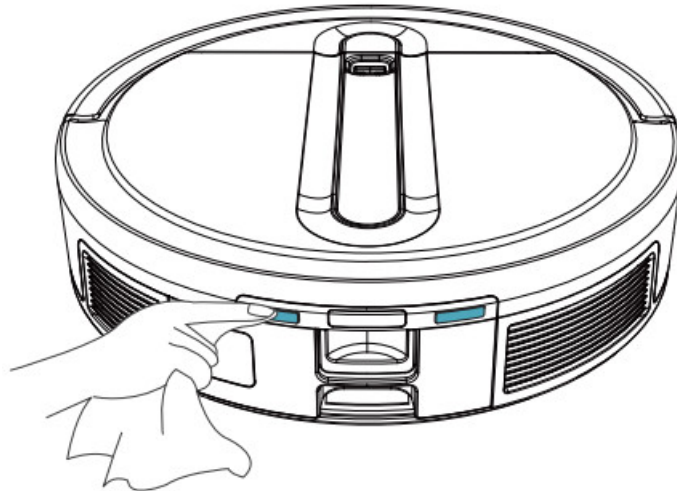

3. Wipe Station Charging Contacts Pins

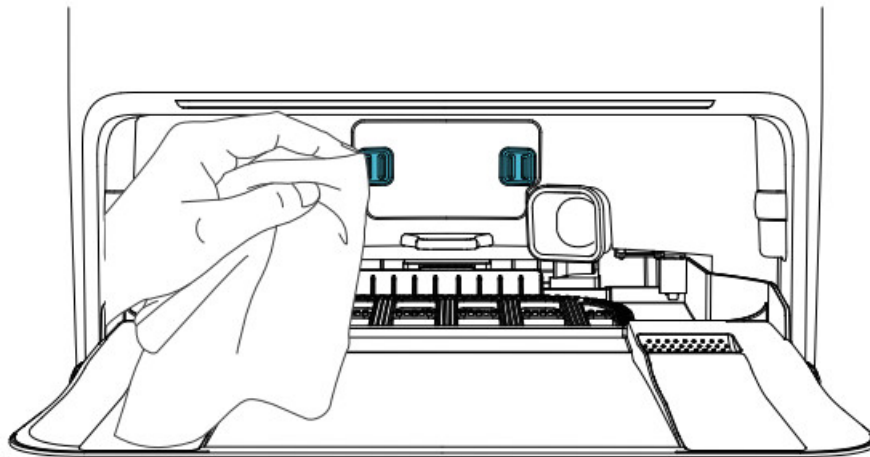

Note:

1. Sensitive electronic components are contained in the Charging Contacts. Please use dry cloth when cleaning. Do not use wet cloth to prevent damage.
2. Before cleaning the Robot Charging Contacts and Station Charging Contacts Pins, turn the Robot OFF and unplug the Cube Station.

3.5 Multi-Surface Main Brush Clean Multi-Surface Main Brush

Remove any foreign objects caught in the Multi-Surface Main Brush with the Multi-Function Cleaning Tool.

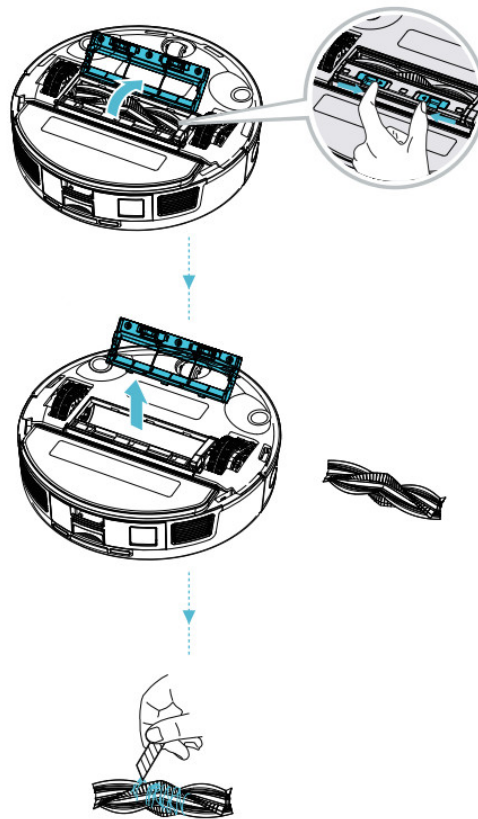

3.6 Edge Brushes

1. Remove Edge Brushes

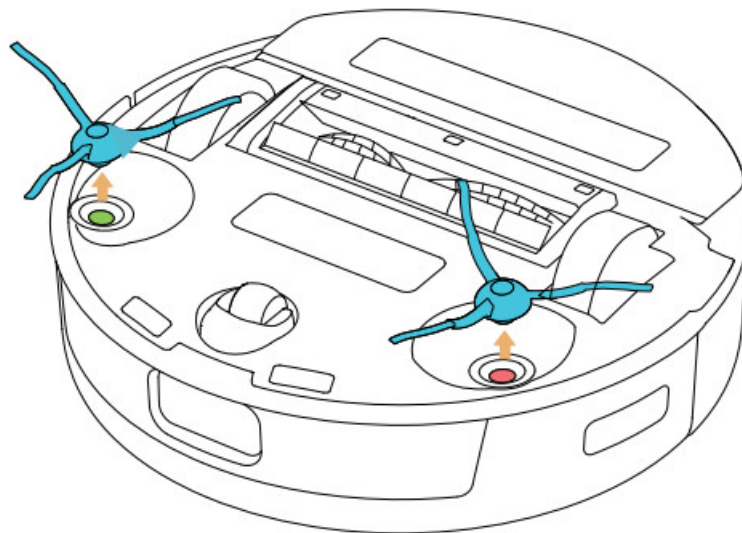

2. Clean Edge Brushes with the Multi-Function Cleaning Tool

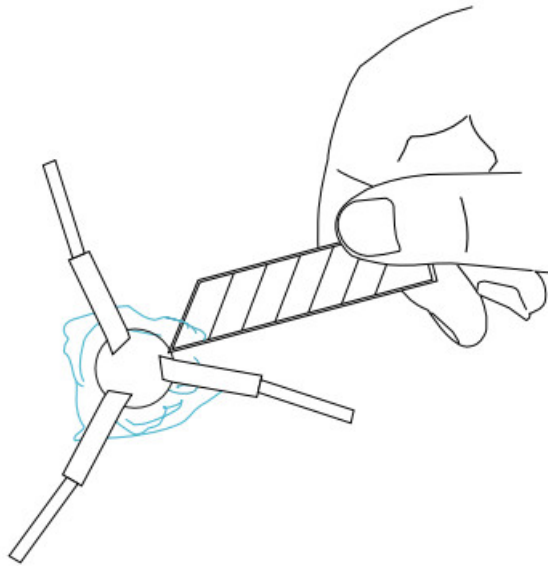

Note:

Before cleaning the Robot, turn it OFF.

3.7 Driving Wheels and Universal Wheel

1. Clean Driving Wheels

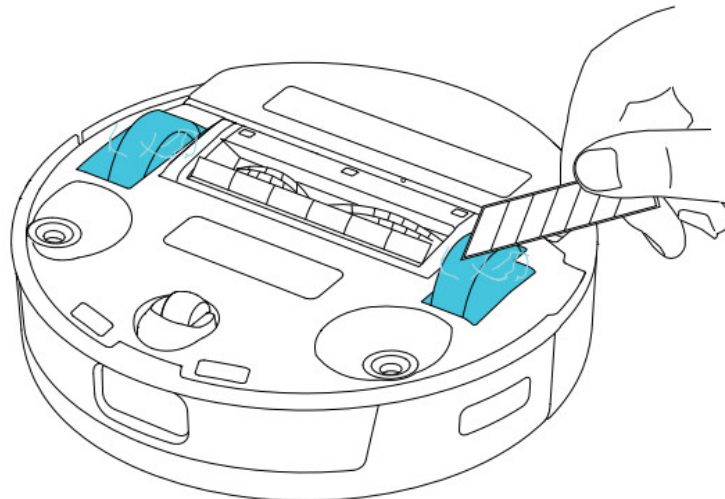

2. Clean Universal Wheel

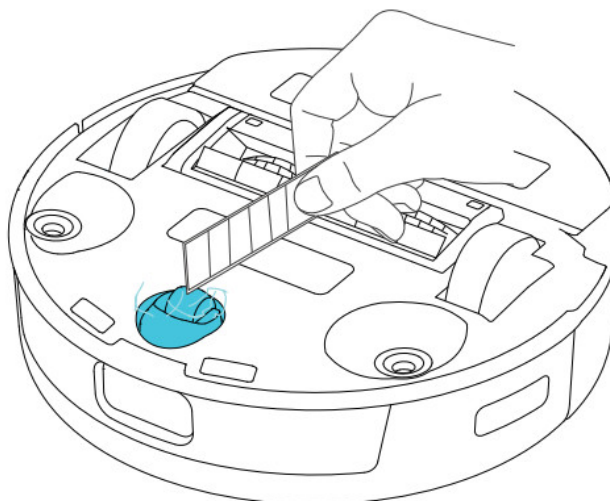

Note:

Please check regularly whether the Edge Brushes, Main Brush, Driving Wheels and Universal Wheel have picked up excessive amounts of hair or trapped foreign objects to avoid abnormal sound during cleaning.

3.8 Dirty Water Tank, Detachable Base and Filter

1. Empty Dirty Water Tank

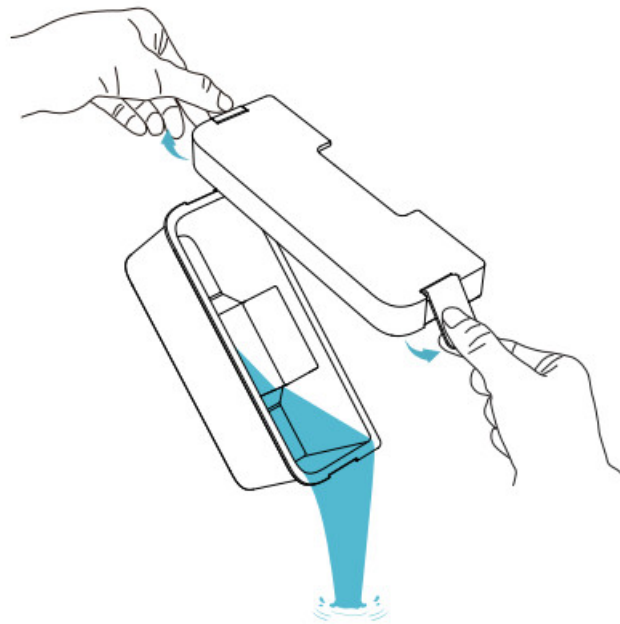

2. Detachable Base

Remove the Detachable Base regularly.

(Lift the Scrubber, press the buttons on both sides of the Detachable Base and pull it out in parallel.)

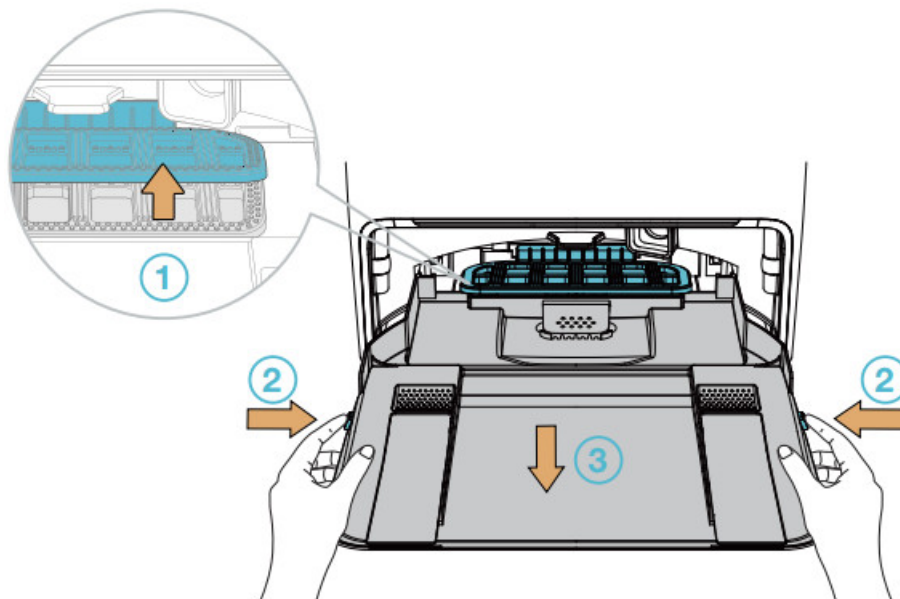

3. Pull up and remove Filter

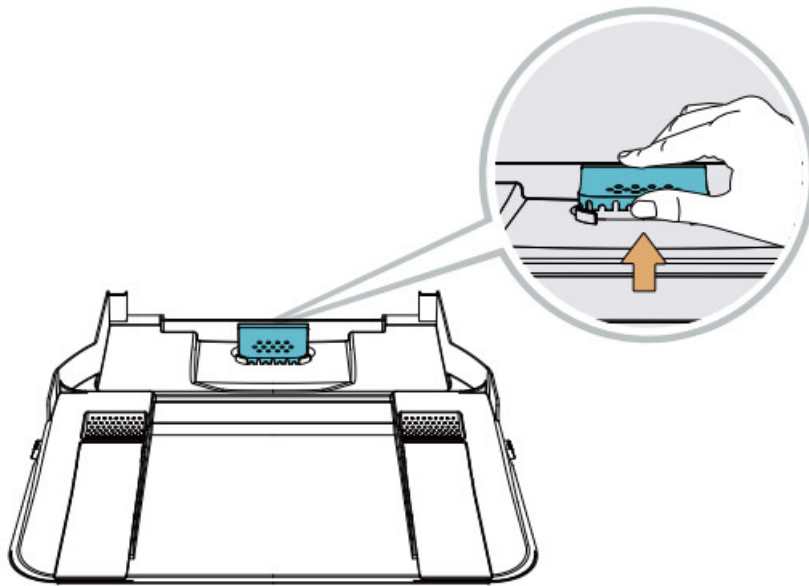

4. Clean Detachable **Base**

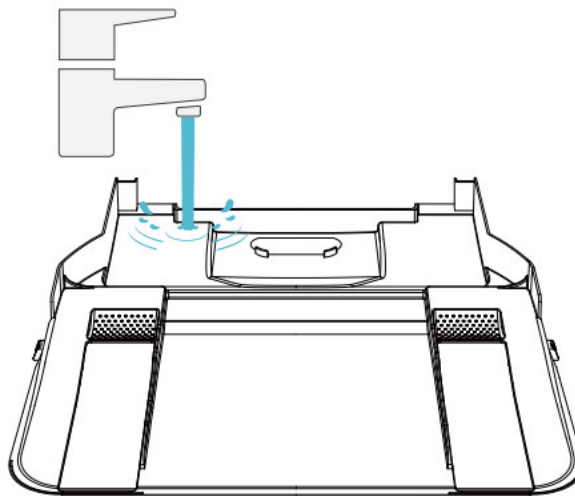

Note: After rinsing, please dry the Detachable Base and Filter with a soft cloth or put in a cool place. Do not expose to direct sunlight to avoid deformation of the Detachable Base or Base Filter.

5. Wipe Filter

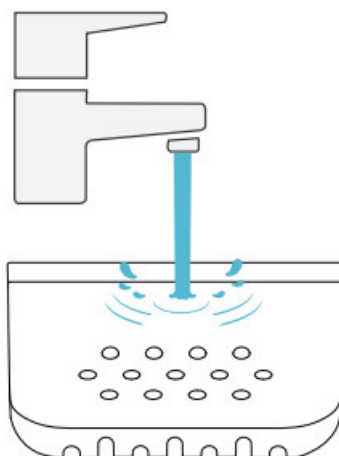

6. **Install Filter**

Press down and when you hear a “click”, the Filter is in place.

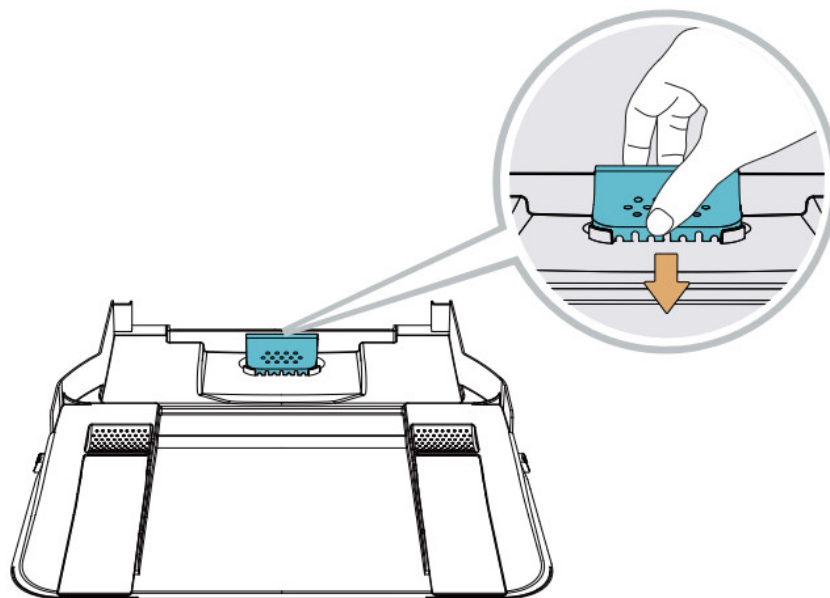

7. Install Detachable Base

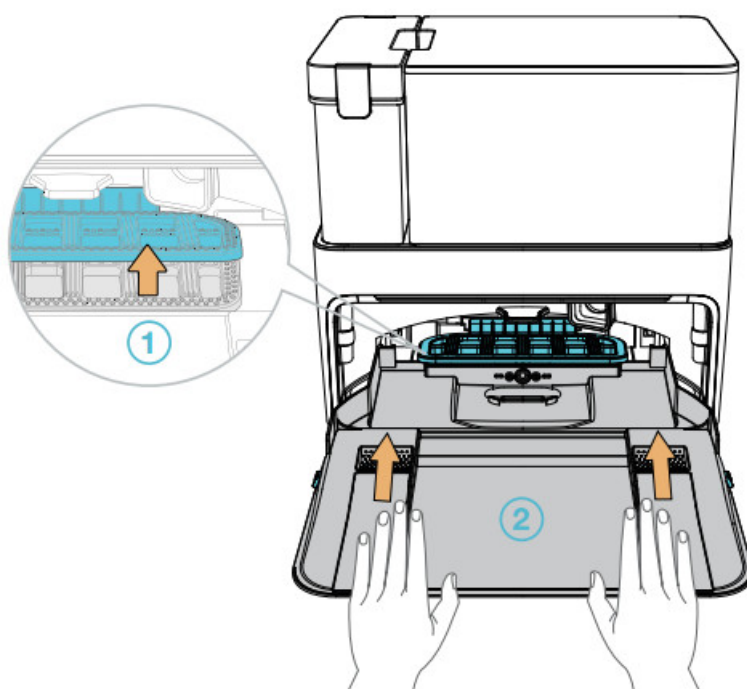

8. Lower Scrubber

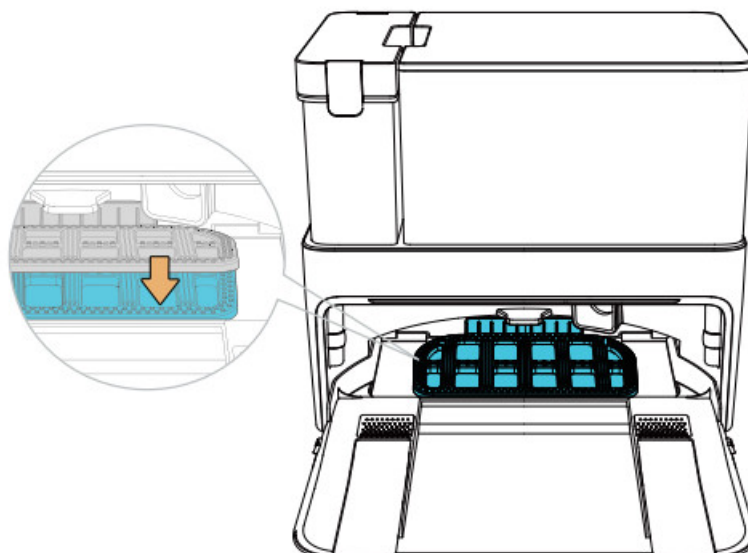

Note: Be sure to lower the Scrubber.

Troubleshooting

Problems encountered during use can refer to the following solutions.

No.	Malfunction	Possible Causes	Solutions
1	Unable to connect the Robot to the App (Wi-Fi Model)	The maximum number of devices connected to the router has been reached.	1. Delete devices connected to the router. 2. Connect the Robot to a new router.
		Incorrect Wi-Fi username or password entered.	Connect to the Wi-Fi and enter the correct username and password.
		The Robot is not within range of your home Wi-Fi signal.	Make sure the Robot is within range of your home Wi-Fi signal.
		Network setup started before the Robot was ready.	Network setup can only be performed when the Robot is ready. Press the SPOT and HOME Buttons at the same time for 2 seconds. When you hear the voice prompt, the Robot is ready for network setup.
		No 2.4GHz network.	The Robot does not yet support 5GHz networks. Enable the 2.4GHz network during network connection. Wi-Fi network requirements: <ul style="list-style-type: none">• You are using a 2.4GHz or 2.4/5 GHz mixed network.• Your router supports 802.11b/g/n and IPv4 protocol.• Do not use a VPN (Virtual Private Network) or Proxy Server.• Do not use a hidden network.• WPA and WPA2 using TKIP, PSK, AES/CCMP encryption.• WEP EAP (Enterprise Authentication Protocol) is not supported.• Use Wi-Fi channels 1-11 in North America and channels 1-13 outside North America (refer to local regulatory agency).• If you are using a network extender/repeater, the network name (SSID) and password are the same as your primary network.



2	The Robot is unable to charge.	The Robot is not turned ON.	Turn ON the Robot. CLEAN white light flashing indicates that the Robot has started charging.
		Charging Contacts are dirty.	Please check whether the Charging Contacts of the Cube Station and the Robot are dirty or clean by referring to the “Maintenance” section of the manual.
		The Cube Station is not connected to the power supply.	Make sure that the Cube Station is connected to the power supply.
		The battery is completely discharged.	1. If you are not going to use the Robot for a long time, please charge it every three months. 2. Please contact the after-sales service if the Robot cannot be charged after not having been used for a long time.
3	Situations such as disorderly routes, deviation, repeated cleaning and small area leakage may occur when the Robot is working.	The Robot will make a back-and-forth exploration for the whole home environment during initial mapping.	1. The Robot will complete the cleaning task according to the self-planned route when it is used for the first time. 2. After generating the map, the Robot will clean the rooms in order.
		Dust accumulates on the sensor surface.	Please wipe the Laser Sensor in front of the Robot and the Visual Sensor at the top of the Robot regularly with a dry cloth.
		Power cords, slippers and other objects placed on the ground will affect the normal operation of the Robot.	1. Before the Robot starts work, please tidy up the scattered power cords, slippers and other objects on the ground, and reduce the number of objects on the floor as much as possible to prevent areas containing many obstacles from being uncleanable. 2. The Robot will automatically remedy any leakage in the cleaning process, please do not interfere (for example: move the Robot or block its path).
		Working on freshly waxed and polished floors, resulting in reduced friction between the Driving Wheels and the floor.	Please have the Robot clean the floor after the wax has dried.
		The Robot may not be able to enter narrow areas to clean due to the layout of your house and the location of the furniture.	1. Tidy up the home environment and free up the space that can be cleaned by the Robot to the maximum extent. 2. Due to the limitation of the Robot in height/diameter terms, it cannot enter spaces less than 10 cm in height and 40 cm in width.
4	The Robot gets stuck while working and stops.	The Robot is tangled with something on the floor (electrical wires, curtains, carpet fringing, etc.).	1. The Robot will try various ways to free itself. 2. If it is unsuccessful, manually remove the obstacles and restart.

5	The Robot makes a lot of noise when cleaning.	The Edge Brushes and Multi-Surface Main Brush may be tangled, or the Dustbin and Filter may be stuck.	Clear out any stuck debris regularly. Please refer to the “Maintenance” section of this manual.
		The Robot’s Driving Wheels or Universal Wheel are/is stuck.	Clear the wheels. Please refer to the “Maintenance” section of the manual.
		The Robot is in Max and Max + Mode.	1. Disable the Auto-Boost Suction function in the App. 2. Use “standard” Vacuum Power for daily floor cleaning.
6	The Easy-to-Clean Mopping Pad is installed, but no water is coming out of the Robot while it mops.	The UFO Water Tank is short of water.	Make sure the UFO Water Tank is filled with water before each cleaning task.
		The Robot did not start cleaning from the Station.	1. The Robot will clean the Mopping Pad first to ensure that the Pad is wet if it starts cleaning from the Station. 2. Please move the Robot to a location near the Cube Station. Press the HOME Button to return the Robot to the Cube Station; press the CLEAN Button / “Start” Button in the App for it to start cleaning.
		The water outlets on the bottom of the Robot are clogged.	Clean the water outlets on the bottom of the Robot with a clean cloth and start it to check whether water is coming out normally. If water is still not coming out, please contact after-sales service.
7	There will be a voice prompt stating “Please install the UFO Water Tank”.	The UFO Water Tank is not installed properly.	Please press hard when installing until you hear a “click”, to ensure that the UFO Water Tank is installed correctly.
8	The Robot leaves behind dust or debris while cleaning.	The blocking plate of the Dustbin or the Dust Disposal Port is stuck by debris.	Please clear the debris.
9	The Robot returns to charge before it has finished cleaning.	The room is so large that the Robot needs to return to recharge.	1. Before starting the cleaning task, ensure that the Robot is fully charged; 2. “Standard” Vacuum Power is recommended; 3. Please enable Resumed Clean. For more details, please follow the instructions in the App.
		In the case of a very complex home environment, cleaning time may be prolonged and the Robot may return to charge before the work has been finished.	1. Tidy up any obstacles on the floor before the Robot starts cleaning; 2. If repeated cleaning occurs several times, please delete the existing map and create a new one.

10	The Robot could not find the Cube Station signal and is unable to return to the Station.	The Cube Station is not positioned correctly.	Please position the Cube Station correctly by following the instructions in the Mapping and Cleaning section of the manual.
		The Cube Station is powered off.	1. Please check whether the Cube Station is connected to the power supply; 2. Please check whether the socket is powered on.
		The Cube Station was moved manually while the Robot was cleaning.	Do not manually move the Cube Station while the Robot is cleaning.
		The Robot did not start from the Cube Station.	Have the Robot start from the Cube Station in the Auto Clean and Area Clean modes.
		The recharge route is blocked, for example: (1) The door of the room where the Cube Station is located is closed; (2) There is an obstacle that is preventing recharging, for which reason the Robot cannot enter the room where the Cube Station is located.	Please open the door of the room where the Cube Station is located and keep the way to the recharge point clear.
11	The Robot cannot return to the Cube Station.	The Robot has slipped.	1. Remove the Detachable Base, clean and dry it before installing. 2. Wipe any water or oil stains at the front of the Cube Station and on the Driving Wheels.
		Detachable Base is not installed properly.	1. Please install the Detachable Base properly by following the instructions in the “Notes before Using” section of the manual. 2. Ensure that the Scrubber is put down after installing the Detachable Base.
		The Robot positioning has failed and it cannot find the Cube Station.	1. Move the Robot to the nearby of the Cube Station and press the HOME Button; 2. If the Station still cannot be found during the next cleaning, please restore and use the backup map. 3. If the Cube Station cannot be found several times, please delete the current map to create a new one.

12	Warnings relating to the Driving Wheels	The Driving Wheels are tangled or stuck by foreign objects.	Please rotate and press the Driving Wheels to check whether any foreign objects have become tangled with or stuck to them. If yes, please clean them up promptly.
13	The Cleaning Sink of the Cube Station is full of water that cannot be sucked out. There is a voice alarm stating that the sink is full of water.	The Dirty Water Tank is not installed properly.	Press the Dirty Water Tank down to ensure proper installation and the indicator light shall be solid blue.
		The Dirty Water Tank is full.	Please clean up the dirty water in the Dirty Water Tank and reset.
		There are foreign objects at the water inlet of the Cleaning Sink.	Ensure that there are no foreign objects blocking the Cleaning Sink water inlet. Remove the Filter from the Base and reinstall it after removing any foreign objects.
		The above has been performed but the voice alarm remains.	Unplug the power socket of the Cube Station and re-plug in.

Product Specifications

Model	YDAX11	
Rated Input	20V  2A	
Charging Time	About 6.5 h	
OMNI Station Model	CH2251	
	Rated Input (Charging)	220-240 V  50-60 Hz 0.3 A
	Power(Washing Mopping Pads)	35W
	Power(Drying)	90W
	Power (Emptying)	1000 W
	Rated Output	20 V  2 A
	Frequency bands	2400-2483.5MHz
	Networked Standby Power	Less than 2.00W

Note:

1. Output power of the Wi-Fi module is less than 100mW.
2. Technical and design specifications may be changed for continuous product improvement.
3. Explore more accessories at <https://www.yeedi.com>.

Shenzhen Reecoo Electronic Co., Ltd.

Building 5-6, Shang Li Lang Science and Technology Park,
Shang Li Lang Community, Nan Wan Street, Long Gang District,
ShenZhen City, Guangdong Province, P. R. China

Documents / Resources

	yeedi Cube Robot Vacuum and Mop [pdf] User Manual Cube Robot Vacuum and Mop, Cube, Robot Vacuum and Mop, Vacuum and Mop, and Mop, Mop
---	--

References

- [yeedi User Manuals | yeedi Robot Vacuum – yeedi Service](#)
- [yeedi | Self-Cleaning Robot Vacuum and Mop | Robot Vacuums – yeedi US](#)