



Yealink W80DM DECT IP Multi Cell System User Guide

[Home](#) » [Yealink](#) » Yealink W80DM DECT IP Multi Cell System User Guide

Contents [[hide](#)]

- [1 Yealink W80DM DECT IP Multi Cell System](#)
- [2 Package Contents](#)
- [3 Installation](#)
- [4 Defining the Device Role](#)
- [5 Accessing the Web User Interface](#)
- [6 Regulatory Notices](#)
- [7 Warranty](#)
- [8 Safety Instructions](#)
- [9 ENVIRONMENTAL RECYCLING](#)
- [10 Troubleshooting](#)
- [11 Declaration of Conformity](#)
- [12 Technical Support](#)
- [13 Documents / Resources](#)
 - [13.1 References](#)
- [14 Related Posts](#)

Yealink

Yealink W80DM DECT IP Multi Cell System

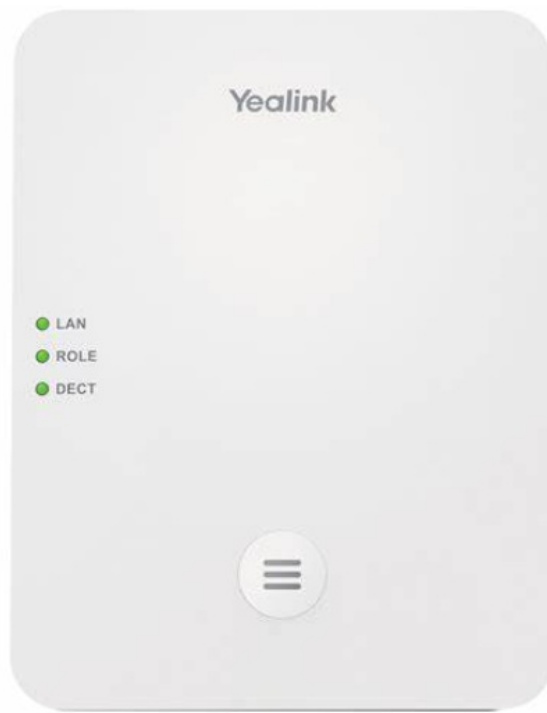

DECT IP Multi-Cell System W80DM/W80B

Package Contents



W80DM/W80B

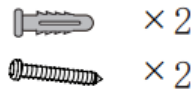

Expansion Screws

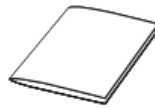

Quick Start Guide

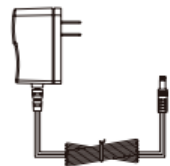

Power Adapter
(Optional)

Installation

1. Connect the power and the network using method a or method b.

a. AC Power Option

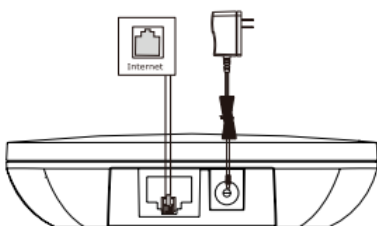

b. PoE (Power over Ethernet) Option

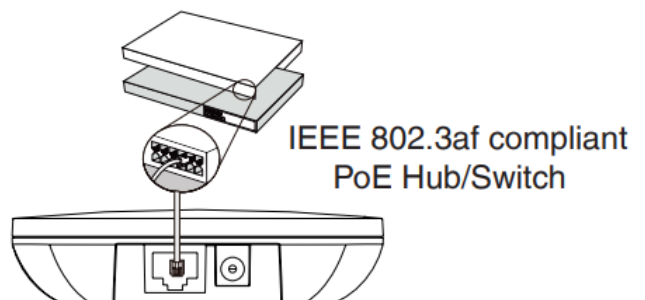

Note:

- If you choose method a, use Yealink supplied power adapter (5V/1.2A). A third-party power adapter may damage the device.
- If you choose method b, you do not need to connect the power adapter. Make sure the hub/switch is PoE-compliant.

2. Mount W80DM/W80B on the wall.

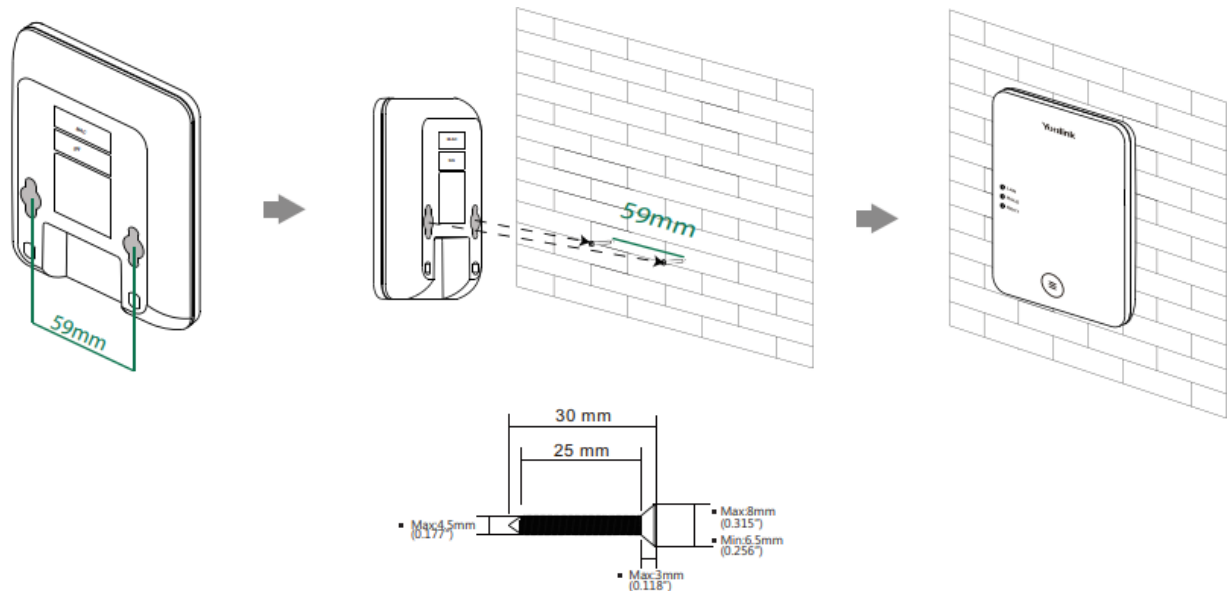

Defining the Device Role

The W80DM is shipped as a DECT Manager (DM) and the W80B is shipped as a base station.

Base Mode Options

The following shows the LED status after the W80DM/W80B connects to the power and network:

Base Mode Option	Role	DECT LED	ROLE LED	LAN LED
1	Base	Off	Green	Green
2	DM	Off	Orange	Green

Accessing the Web User Interface

1. Find the current IP address of the device on the DHCP server in the list of registered DHCP clients.
2. Open a web browser on your computer, enter the IP address into the address bar (for example, “<https://192.168.0.10>” or “192.168.0.10”), and then press the Enter.
3. Enter the user name (default: admin) and password (default: admin) in the login page and click Login.

Regulatory Notices

Operating Ambient Temperatures

- **Operating temperature:** +32 to 104°F (0 to 40°C)
- **Relative humidity:** 5% to 90%, noncondensing
- **Storage temperature:** -22 to +160°F (-30 to +70°C)

Warranty

Our product warranty is limited only to the unit itself, when used normally in accordance with the operating instructions and the system environment. We are not liable for damage or loss resulting from the use of this product, or for any claim from a third party. We are not liable for problems with Yealink device arising from the use

of this product; we are not liable for financial damages, lost profits, claims from third parties, etc., arising from the use of this product.

DC symbol is the DC voltage symbol.

Restriction of Hazardous Substances Directive (RoHS)

This device complies with the requirements of the EU RoHS Directive. Statements of compliance can be obtained by contacting support@yealink.com.

Safety Instructions

Save these instructions. Read these safety instructions before use!

To reduce risk of fire, severe personal injury and damage to property, read the following safety information carefully before using the product.

Environmental Requirements

- Place the product on a stable, level and non-slip surface.
- Do not place the product close to heat sources, in direct sunlight or next to any house hold appliance with strong magnetic field or electromagnetic field, such as a microwave oven or a refrigerator.
- Do not allow the product to come into contact with water, dust and chemicals.
- Protect the product from aggressive liquids and vapors.
- Do not place the product on or near any inflammable or fire-vulnerable object, such as rubber-made materials.
- Do not install the product in rooms with high humidity, for example, in bathrooms, laundry rooms and wet basements.

Safety Notes During Operation

- Use only spare parts and accessories supplied or authorized by Yealink. The operation of non-authorized parts cannot be guaranteed.
- Do not place heavy objects on top of the handset or the base station in case of damage and deformation caused by the heavy load.
- Do not open the handset or the base station by yourself for repair purpose, which could expose you to high voltages. Have all repairs carried out by authorized service personnel.
- Do not let a child operate the product without guidance.
- Keep the small accessories contained in your product out of reach of small children in case of accidental swallowing.
- Before plugging or unplugging any cable, make sure that your hands are completely dry.
- Do not hold the handset up to your ear when speakphone is on or when the ringer is ringing as the volume can be very loud, which may be harmful to your hearing.
- During a thunderstorm, stop using the product and disconnect it from the power supply to avoid lightning strike.
- If the product is left unused for a rather long time, disconnect the base station from the power supply and unplug the power adapter.
- When there is smoke emitted from the product, or some abnormal noise or smell, disconnect the product from the power supply, and unplug the power adapter immediately.
- Remove the electrical cord from an outlet by pulling gently on the power adapter, not by pulling the cord.

Notices of Cleaning

- Before cleaning the base station, stop using it and disconnect it from the power supply.
- Remove the battery before cleaning the handset to reduce risk of electric shock.
- Only clean your product with a piece of slightly moist and anti-static cloth.
- Keep the power plug clean and dry. Using a dirty or wet power plug may lead to electric shock or other perils.

ENVIRONMENTAL RECYCLING



Never dispose of the device with domestic waste

Ask your Town Council about how to dispose of it in an environmentally friendly way. The cardboard box, plastic packaging and player components may be recycled in accordance with prevailing recycling regulations in your country.

Always adhere to prevailing regulations

Those who fail to do so may be fined or prosecuted in accordance with the law. The crossed out garbage can that appears on the device means that when it has reached the end of its useful life, it should be taken to a special waste disposal center and treated separately to general urban waste.

Troubleshooting

The unit cannot supply power to Yealink device. There is a bad connection with the plug.

1. Clean the plug with a dry cloth.
2. Connect it to another wall outlet.

The usage environment is out of operating temperature range.

- Use in the operating temperature range.

The cable between the unit and the Yealink device is connected incorrectly.

- Connect the cable correctly.

You cannot connect the cable properly.

1. You may have connected a wrong Yealink device.
2. Use the correct power supply.

Some dust, etc., may be in the port.

- Clean the port.

Contact your dealer or authorized service facility for any further questions.

Contact Information

YEALINK NETWORK TECHNOLOGY CO.,LTD.

309, 3rd Floor, No.16, Yun Ding North Road, Huli District, Xiamen City, Fujian, P.R.C YEALINK (EUROPE) NETWORK TECHNOLOGY B.V.

Strawinskylaan 3127, Atrium Building, 8th floor, 1077ZX Amsterdam, The Netherlands YEALINK (USA) NETWORK TECHNOLOGY CO., LTD.

999 Peachtree Street Suite 2300, Fulton, Atlanta, GA, 30309, USA

Made in China

Declaration of Conformity



We, YEALINK(XIAMEN) NETWORK TECHNOLOGY CO.,LTD, Address: 309, 3rd Floor, No.16, Yun Ding North Road, Huli District, Xiamen City, Fujian, P.R.C

CE DATE: 20th /July/2019

declare that the product

Type: DECT IP Multi-Cell System

Model: W80DM/W80B meets the essential requirements and other relevant provisions according to the following EC directive

Directive: 2014/30/EU, 2014/35/EU, RED 2014/53/EU;

The presumption of conformity with the essential requirement is ensure according to: Article 3.1 a : (protection of the health &the safety of the user)

Safety: EN 62368-1:2014/AC2015

SAR: ETSI EN 50385:2017

Article 3.1 b : (protection requirement with respect to electromagnetic compatibility)

EMC: EN55032:2012+AC:2013 and EN55032:2015+AC2016 EN55035:2017

EN301489-6 V2.2.2,EN301489-1 V2.2.2

Article 3.2 (effective use of the radio spectrum)

Radio: ETSI EN 301406 V2.2.2

Directive 2011/65/EU and (EU)2015/863

of the European Parliament and of the Council of 8 June 2011 and 4 June 2015 on the restriction of the use of certain hazardous substanc-es in electrical and electronic equipment(RoHS 2.0)

Directive 2012/19/EU of the European Parliament and of the Council of 4.July.2012 on Waste electrical and electronic equipment(WEEE)

Regulation (EC) No.1907/2006 of the European Parliament and of the Council of 18. December.2006 on Registration, Evaluation, Authorization, and Restriction of Chemicals (REACH)

NAME: Stone Lu

DATE: 20/July/2019

TITLE: Vice President

Email: EUROPE@Yealink.com

YEALINK (EUROPE) NETWORK TECHNOLOGY B.V

Address: Strawinskylaan 3127, Atrium Building, 8th floor, 1077ZX Amsterdam, the Netherlands

Telephone: +31(0)646111373

Addr: 309, 3rd Floor, No.16, Yun Ding North Road, Huli District, Xiamen City, Fujian, P.R.C

Tel: +86-592-5702000

Fax: +86-592-5702455

About Yealink

Yealink (Stock Code: 300628) is a global brand that specializes in video conferencing, voice communications and collaboration solutions with best-in-class quality, innovative technology and user-friendly experience. As one of the best providers in more than 140 countries and regions, Yealink ranks No.1 in the global market share of SIP phone ship-ments (Global IP Desktop Phone Growth Excellence Leadership Award Report, Frost & Sullivan, 2019).

Copyright

Copyright © 2022 YEALINK(XIAMEN) NETWORK TECHNOLOGY CO., LTD.

All rights reserved. No parts of this publication may be reproduced or transmitted in any form or by any means, electronic or mechanical, photocopying, recording, or otherwise, for any purpose, without the express written permission of Yealink(Xiamen) Network Technology CO., LTD.

Technical Support

Visit Yealink WIKI (<http://support.yealink.com/>) for firmware downloads, product documents, FAQ, and more. For better service, we sincerely recommend you to use Yealink Ticketing system (<https://ticket.yealink.com>) to submit all your technical issues.



YEALINK(XIAMEN) NETWORK TECHNOLOGY CO.,LTD.

Web: www.yealink.com

Addr: No.1 Ling-Xia North Road, High Tech Park,
Huli District, Xiamen, Fujian, P.R.C

Copyright©2022 Yealink Inc. All rights reserved.



Documents / Resources

	<p>Yealink W80DM DECT IP Multi Cell System [pdf] User Guide W80DM, W80B, W80DM DECT IP Multi Cell System, DECT IP Multi Cell System, IP Multi Cell System, Multi Cell System</p>
---	--

References

- [Yealink Support](#)
- [Yealink | UC & C Terminal, Video Collaboration, Conference Phone, IP Phone, Headsets & Video Conferencing](#)
- [Yealink Ticket](#)