

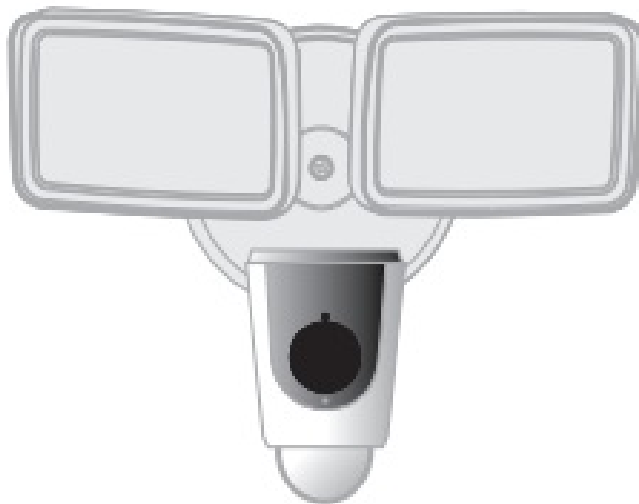

Yale YFL01-BLK-PKG1.0.2 Floodlight Camera User Guide

[Home](#) » [Yale](#) » Yale YFL01-BLK-PKG1.0.2 Floodlight Camera User Guide 

Yale YFL01-BLK-PKG1.0.2 Floodlight Camera



Contents

- [1 Identifying the parts](#)
- [2 Assembly](#)
- [3 Application](#)
- [4 Camera Introduction](#)
- [5 Installing Camera](#)
- [6 Operating with Yale View app](#)
- [7 Disclaimer](#)
- [8 About the Guide](#)
- [9 Documents / Resources](#)
- [10 Related Posts](#)

Identifying the parts

- Floodlight Camera ×1

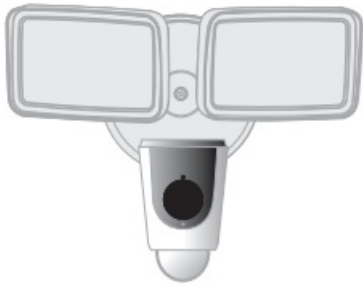

- Mounting Box ×1



- Fixing Pack ×1

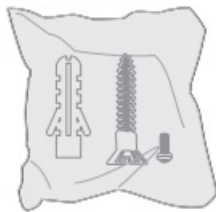

- QSG ×1



- Hook ×1



- Mounting Screw ×1



- Drilling Template ×1

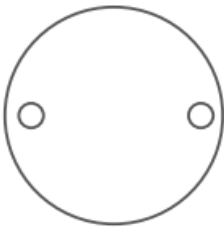

Note

In the fixing pack, there are 3 wall plugs, and 3 self-tapping screws.

Assembly

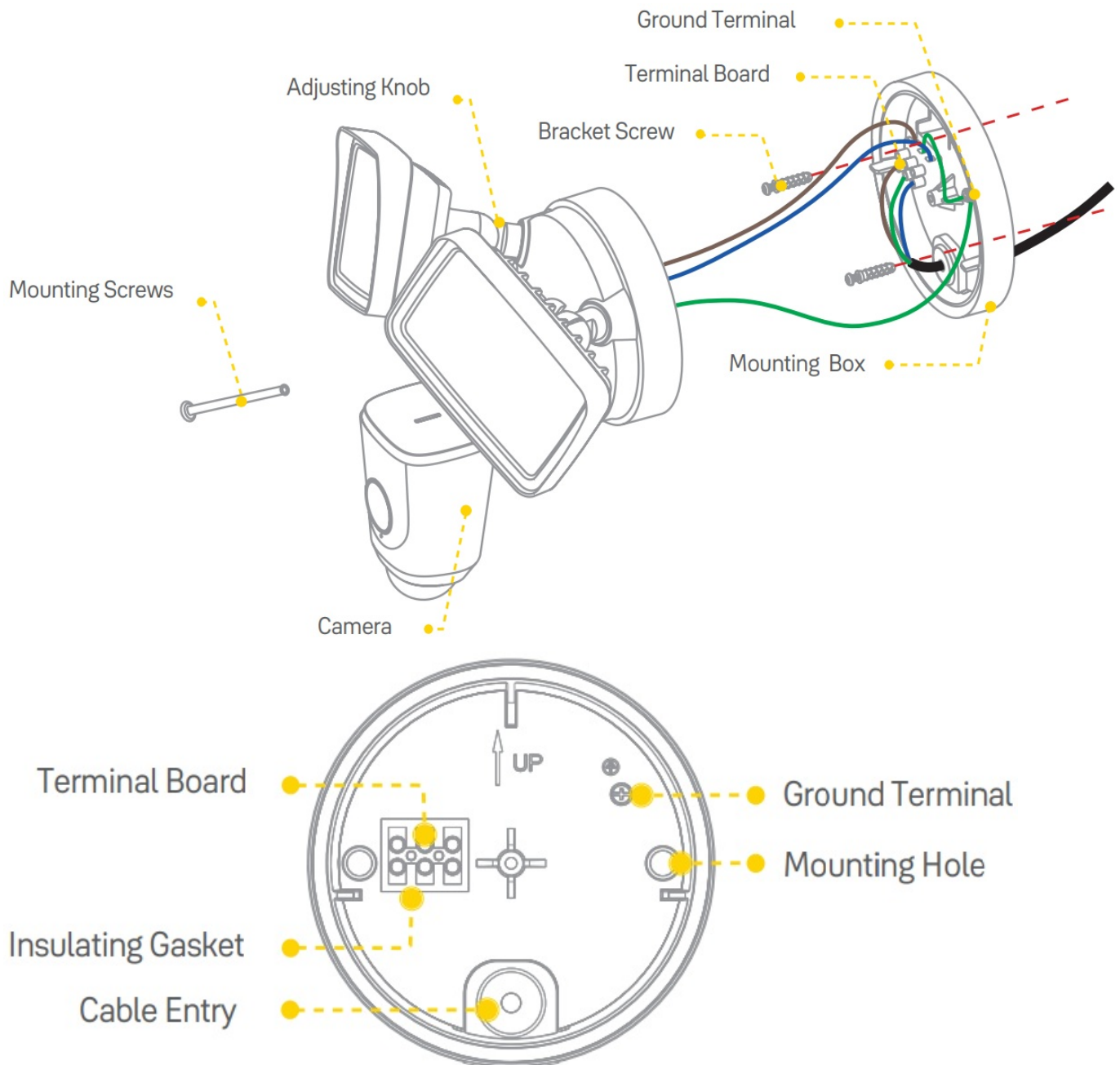

Application

When mounted at 3 m (10 feet) off the ground, with the PIR lens parallel to the ground, the motion detector is optimized to detect human-sized objects at up to 10 m (33 feet).

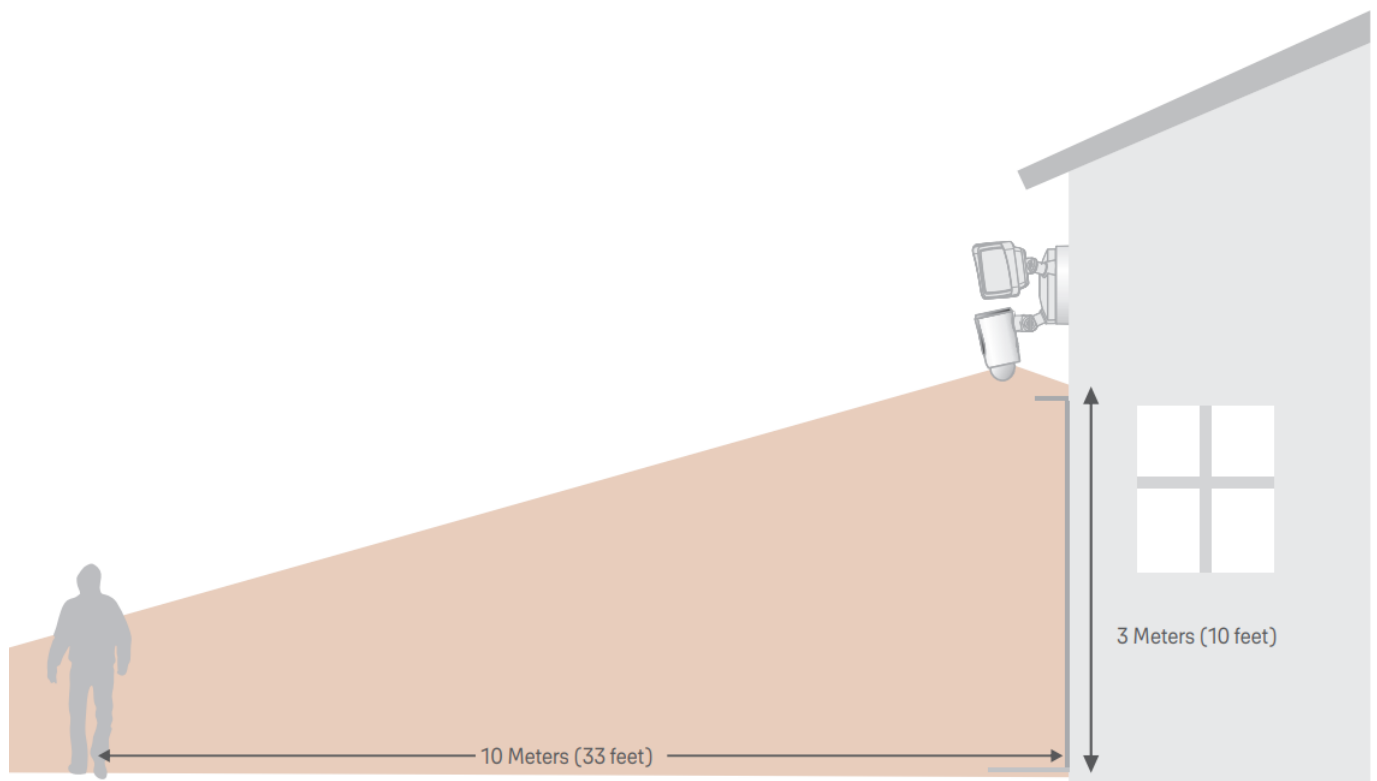

Camera Introduction

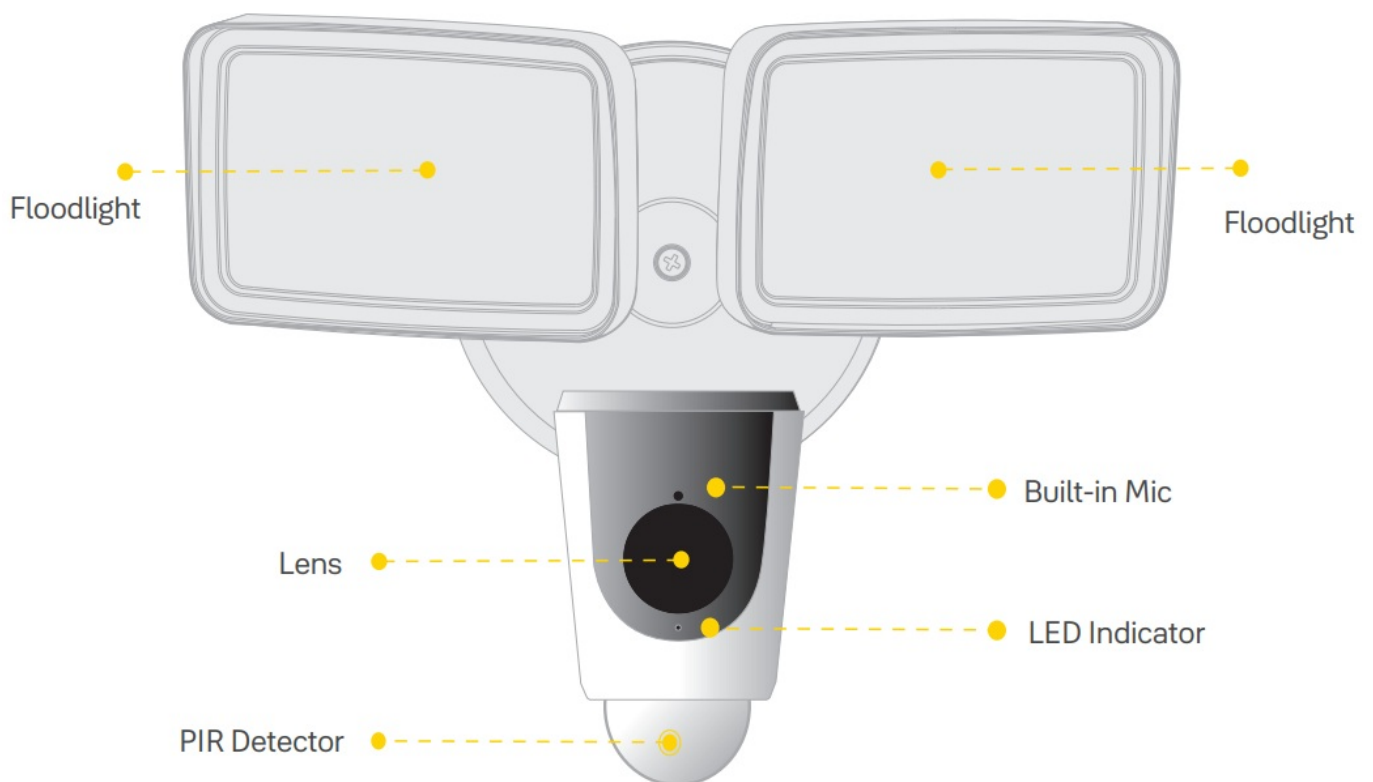

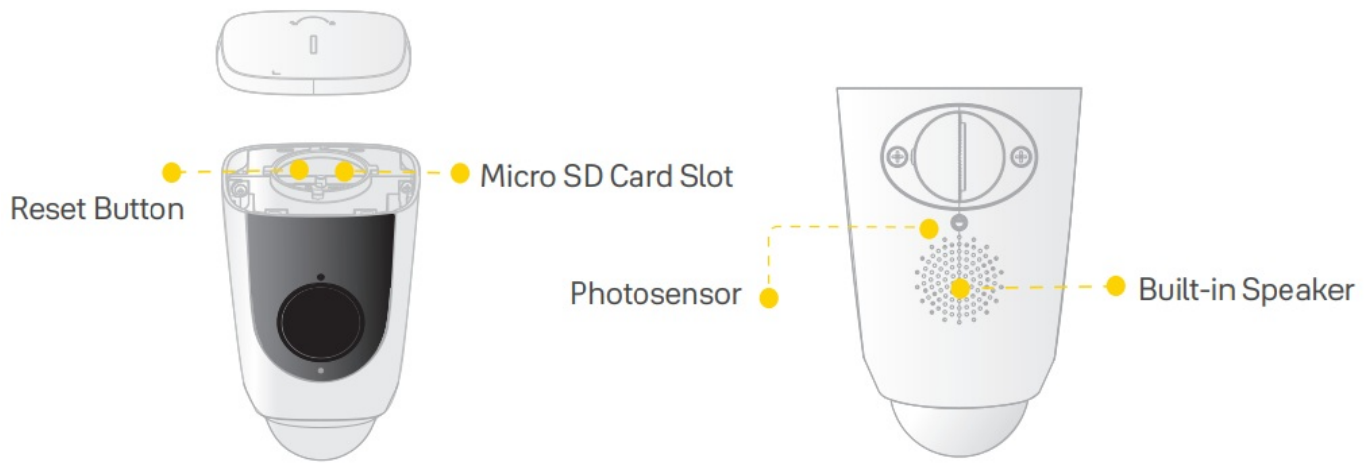

Note: Press and hold the reset button for 10 s to reset the camera.
Camera
The pattern of the LED indicator is included in the following table.

LED Indicator Status	Device Status
Off	Powered off/LED turned off Rebooting after reset
Red light on	Booting Device malfunction
Green light flashing	Waiting for network
Green light on	Operating properly
Red light flashing	Network connection failed
Green and red light flashing alternately	Firmware updating

Installing Camera

WARNING

Risk of electrical shock

- Be sure to disconnect the power at the fuse or circuit breaker before installation.
- Verify that the supply voltage is correct. Connect fixture to a 100–240VAC 50/60 Hz power source.
- Always follow code standards when installing wired connection.
- We strongly suggest that you hire a licensed electrician to install the camera.
- For permanently connected equipment, a readily accessible disconnect device shall be incorporated external to the equipment.
- For pluggable equipment type B or permanently connected equipment, the maximum rating of an overcurrent protective device to be provided external to the equipment is 20A.

Risk of fire

Do not install the camera near combustible or flammable surfaces.

Note

- Do not connect this light fixture to a dimmer switch or timer.
 - Make sure that the mounting surface is strong enough to hold at least three times of the device weight.
1. Step 1 If there is no holes in the wall, insert the drilling template where you want the floodlight camera to be installed. Using the drill template as a guide drill the two parallel holes on the wall, add the wall plugs and move to the next step.
 2. Step 2 Turn the adjusting knobs to loosen the lights, and adjust the light angles to give space to the mounting screw. Loosen the mounting screw to open the mounting box, and then loosen the screw on the ground terminal to remove the ground wires.

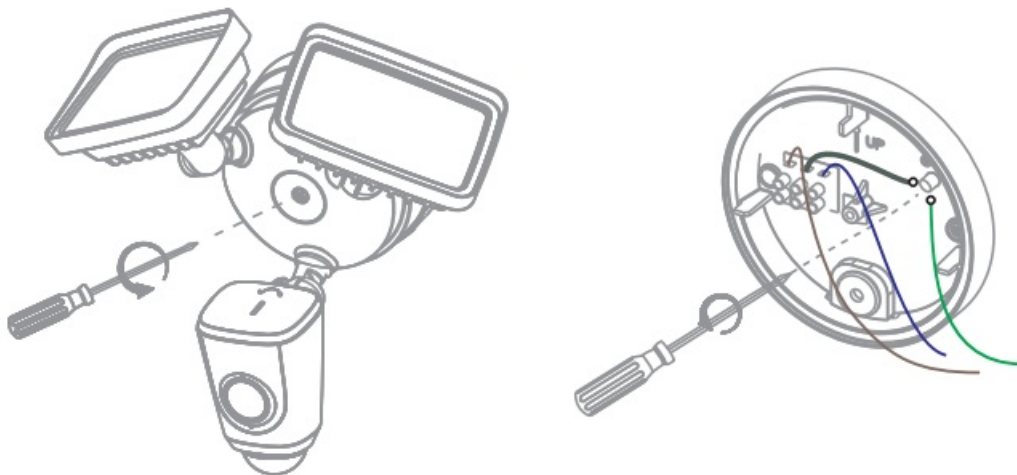

3. Step 3 Attach the mounting box to the wall with the self-tapping screws, making sure the UP arrow is in the correct position.

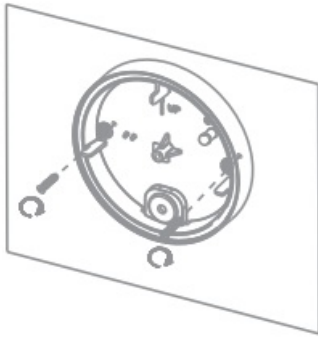

4. Step 4 Using the hook provided, hook one end of the hook into the hole on the mounting box, and the other end to the edge of the camera, so you can use both hands to complete the installation.

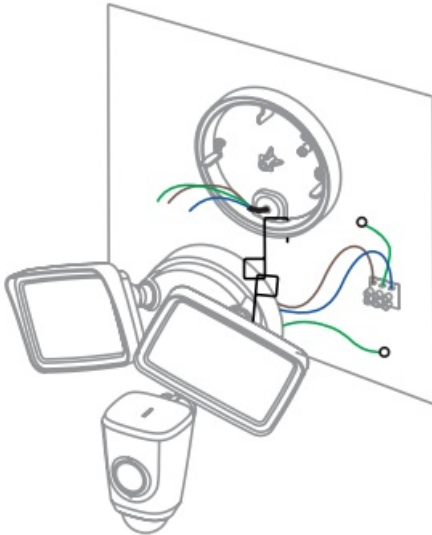

5. Step 5 Take out the terminal block from the mounting box. Connect the blue wires (neutral wires) to the terminals N, and the brown wires (live wires) to terminals L, and then the yellow and green strip wire to ground terminal on the board.
6. Step 6 Connect the two removed yellow and green striped wire (ground wires) to the ground terminal again, tighten the screw on the ground terminal, and then put back the terminal board with the insulating gasket in the mounting box.

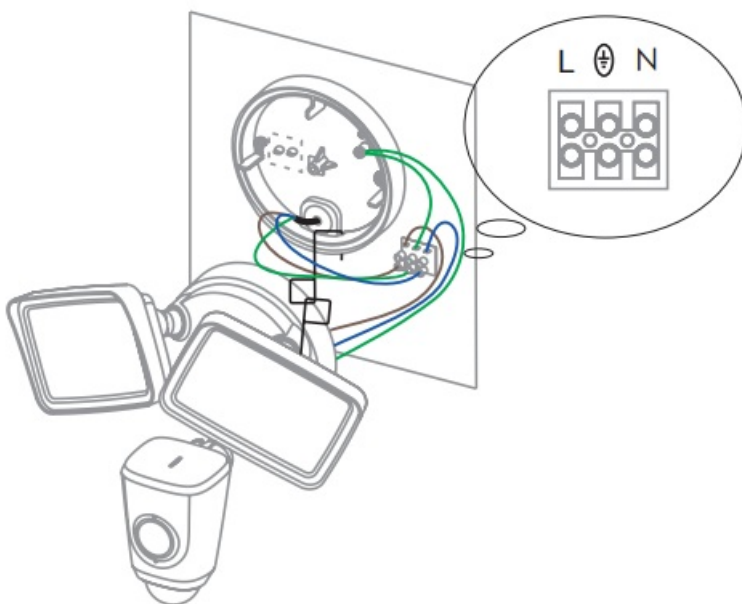

7. Step 7 Put away all the wires, attach the camera to the mounting box, and fix the camera with mounting screws and apply the screw cover to the mounting box.



8. Step 8 Adjust the light and lens angle, and keep the PIR detector parallel to the ground to ensure optimal detection.

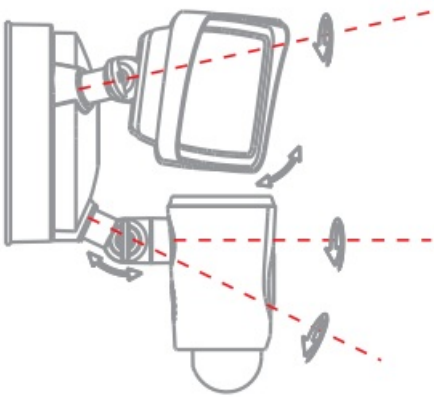

Operating with Yale View app

1. Step 1 Power on the camera.
2. Step 2 Scan the following QR code or search Yale View app in Google Play or App Store to download and install the Yale View app.

Note If you have installed the app, update it to the latest version.



3. Step 3 Run the Yale View app, and then register an account for first use.
4. Step 4 Wait for the camera to finish the booting cycle, and then the camera indicator flashes with a green light.

5. Step 5 Connect your smart phone to your Wi-Fi network, and make sure that your smartphone is connected to Wi-Fi network with 2.4 GHz band, then follow the in app instructions to complete finishing setting up the camera.

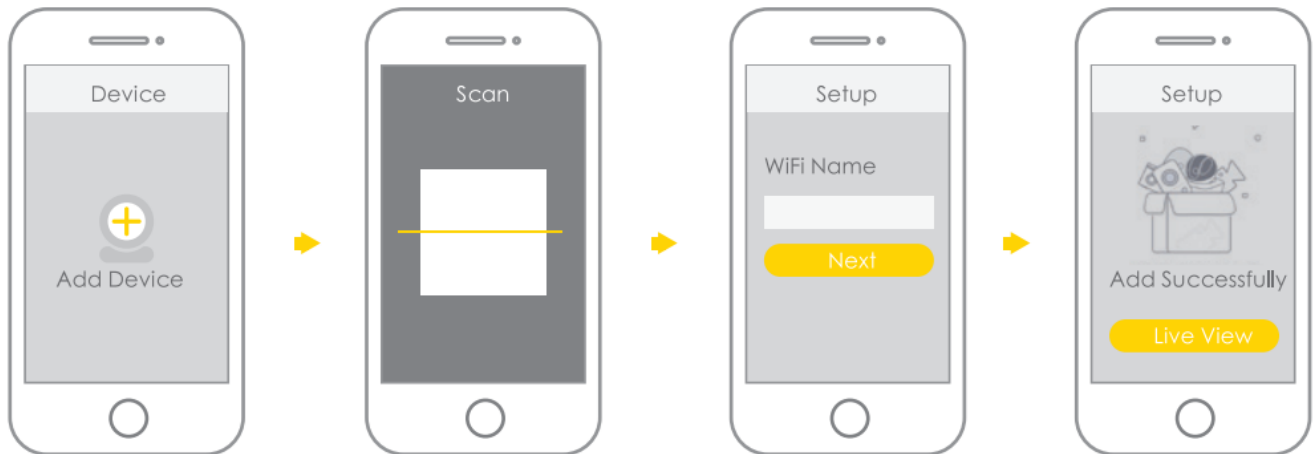

Note

- If you have more than one camera, do step 5 to add them one by one.
- If your Wi-Fi network changes or the indicator status changes, reset the camera and re-do the setup from step 5 to add it again.

Disclaimer

This guide is for informational purpose only. Working with electricity can be dangerous unless proper safety precautions are taken. If you are not comfortable or are inexperienced with the processes and tools described in this manual, we strongly suggest that you hire a licensed electrician.

About the Guide

- All the design and software here are subject to change without prior written notice.
- All trademarks and registered trademarks mentioned are the properties of their respective owners.
- Please visit our website or contact your local service engineer for more information.
- If there is any uncertainty or controversy, please refer to our final explanation.



Documents / Resources

	Yale YFL01-BLK-PKG1.0.2 Floodlight Camera [pdf] User Guide YFL01-BLK-PKG1.0.2 Floodlight Camera, YFL01-BLK-PKG1.0.2, Floodlight Camera, Camera
--	---