

Yale YRD256iM1619 Assure Lock Network Module Quick Start Guide

[Home](#) » [Yale](#) » Yale YRD256iM1619 Assure Lock Network Module Quick Start Guide 

Contents

- [1 Yale YRD256iM1619 Assure Lock Network Module](#)
- [2 Introduction](#)
- [3 Product Specifications](#)
- [4 Included Components](#)
- [5 Product Features](#)
- [6 Installation](#)
 - [6.1 Download the App](#)
- [7 FAQs](#)
- [8 Video- Product Information](#)



Yale YRD256iM1619 Assure Lock Network Module

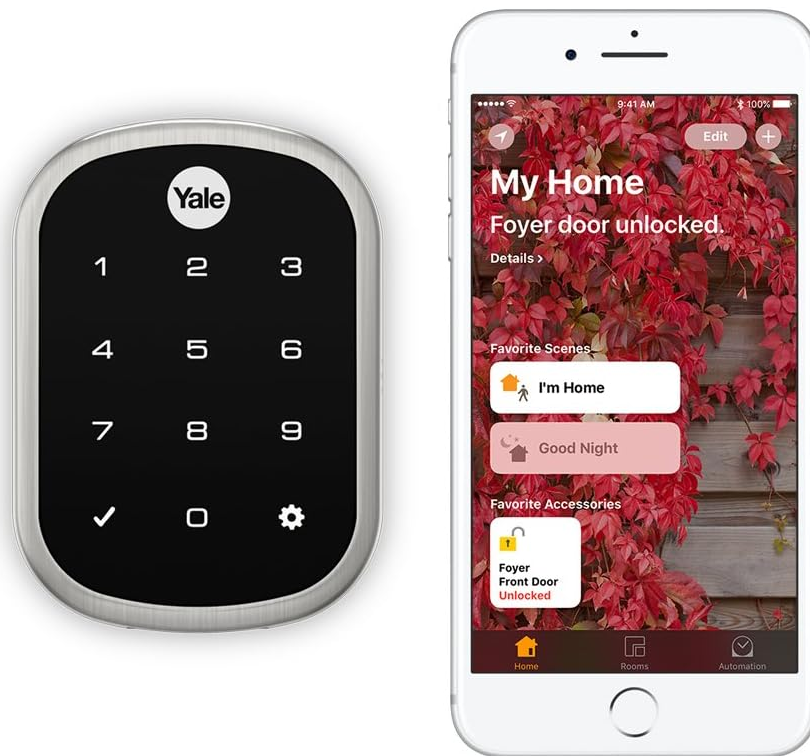

Introduction

The Yale YRD256iM1619 Assure Lock Network Module is an innovative accessory designed to enhance the capabilities of your Yale Assure Lock smart lock. This network module allows you to connect your Yale Assure Lock to a home automation or security system, enabling you to control and monitor your lock remotely, integrate it with other smart devices, and enjoy advanced security features.

Product Specifications

- **Brand:** Yale
- **Special Feature:** HomeKit
- **Lock Type:** Keypad
- **Item Dimensions LxWxH:** 1 x 2.5 x 3 inches
- **Material:** Steel
- **Recommended Uses For Product:** Front Door
- **Style:** Apple HomeKit Enabled
- **Color:** Satin Nickel
- **Number of Pieces:** 2
- **Finish Type:** Brushed
- **Controller Type:** Apple HomeKit, IOS
- **Shape:** Rectangular
- **Item Weight:** 3 Pounds
- **Control Method:** Voice
- **Connectivity Protocol:** Bluetooth
- **Manufacturer:** Yale Security Inc.
- **Part Number:** YRD256-iM1-619
- **Item Weight:** 3 pounds
- **Product Dimensions:** 1 x 2.5 x 3 inches

- **Country of Origin:** China
- **Item model number:** YRD256-iM1-619
- **Batteries:** 4 AA batteries required. (included)
- **Is Discontinued By Manufacturer:** No
- **Finish:** Brushed
- **Power Source:** Battery powered
- **Voltage:** 120 Volts
- **Horsepower:** 1 hp
- **Item Package Quantity:** 1
- **Sound Level:** 1 dB
- **Display Style:** Touchscreen
- **Special Features:** HomeKit
- **Batteries Included?:** Yes
- **Batteries Required?:** Yes
- **Battery Cell Type:** Alkaline
- **Warranty Description:** Lifetime limited warranty on mechanical and finish. 1 Year on electronics

Included Components

Installation Manual, Yale Assure Lock SL, Yale iM1 Network Module, Mounting Hardware, 4 AA Batteries

Product Features

- **Enhanced Connectivity:** The Yale YRD256iM1619 Assure Lock Network Module serves as a bridge between your Yale Assure Lock and various home automation and security systems. It uses wireless communication protocols to connect your smart lock to a network, enabling remote access and control.
- **Seamless Integration:** Once installed, the network module seamlessly integrates your Yale Assure Lock into your smart home ecosystem. It allows you to manage your lock alongside other connected devices, such as smart lights, thermostats, and security cameras, all from a single app or interface.
- **Remote Access:** With the network module in place, you can remotely control your Yale Assure Lock from your smartphone or computer. Whether you're at work, on vacation, or simply away from home, you can lock or unlock your door, grant access to guests, and receive real-time notifications about lock activity.
- **Advanced Security Features:** The Yale YRD256iM1619 Assure Lock Network Module often comes with advanced security features, including secure encryption and authentication protocols. This ensures that your smart lock's communication with your network and mobile devices is highly secure, protecting your home from unauthorized access.
- **Compatibility:** It's crucial to ensure that the network module is compatible with your specific Yale Assure Lock model. Different Yale locks may require different network modules, so be sure to check compatibility before purchase.
- **Easy Installation:** Installing the Yale YRD256iM1619 Assure Lock Network Module typically involves connecting it to your Yale Assure Lock's internal components. While the exact installation process may vary depending on your lock model and system, it's generally designed to be a straightforward DIY project.

Yale Secure App Quick Start Guide

For use with a Yale Assure Lock® with iM1 Network Module

For app quick start guides and manuals in other languages, visit YaleHome.com/Support

Installation

Download the App

- **Yale Secure App**

- Install the free Yale Secure app, available from the App StoreSM. This app is compatible with iPhone®, iPad® and iPod touch® running iOS 10.3 and later.
- After completing this set-up, you can manage your Yale lock with iM1 Network Module using the Apple Home app or Siri voice commands!

- **Turn on Bluetooth**

- Ensure that your iPhone, iPad or iPod touch has Bluetooth® turned on. This can be done within your device settings.

- **Install the Yale iM1 Network Module**

After your Yale lock has been successfully installed and your master pin code has been created (follow the installation instructions packaged with your lock), continue with the below steps:

- Remove the lock's battery cover and batteries.
- Insert the Yale iM1 Network Module into the slot above the battery compartment. The module has visible pins that should be located at the bottom right corner when inserted into the lock.
- Reinstall the batteries and battery cover.

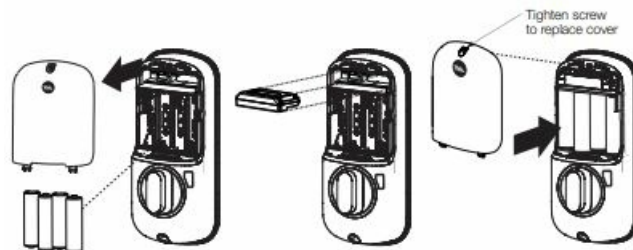

- **Yale-YRD256iM1619-Assure-Lock-Network-Module-1**

- Wake the keypad by touching it with three fingers.
- Enter your master pin code followed by the gear key.
- Tap 7, followed by the gear key.
- Tap 1, followed by the gear key.

Your module has now been successfully enrolled.

- **Create Your Home**

- If you already have a home created, please skip this step. While holding your phone close to your Yale lock, open the Yale Secure app. Agree to allow access to your home data. Tap the + icon in the top right corner to add your new home. Enter your home name and tap 'Create'.

- **Add Your Yale Lock to Your Home**

- Tap the + icon next to your home name. Tap your Yale lock when it appears. Using your iOS device, scan the 8-digit Accessory Setup Code located on the back of your iM1 Installation Manual. You can also manually enter your code. In case you misplace the Installation Manual, your code is also printed on the

module itself. Once the lock has been added, you'll be prompted to rename your lock.

- **Customize Your Lock**

- Within the lock settings you can customize several features including Auto Relock, Language, One - Touch Locking, Operation Mode and more. You can also edit your lock name at any time. The name of your lock will be what is used when locking or unlocking with Siri®.
- For example, for a lock named "Front Door" you could say, "Siri, unlock my front door."

- **Control From Anywhere!**

- Remote access requires an Apple TV 4th gen or later or an iPad with iOS 10.3 or later set up as a home hub.
- Set up Apple TV as a home hub
- On your iOS device set up two-factor authentication for your Apple ID. Then go to iCloud and make sure that you have iCloud Keychain turned on.
- On your Apple TV, go to Settings > Accounts and make sure that you're signed in to iCloud with the same Apple ID as your iOS device.
- After you sign in to iCloud, your Apple TV automatically sets itself up as a home hub. To check the status of your home hub, go to Settings > Accounts > iCloud and look under HomeKit to see if your home hub is connected.

- Set up iPad as a home hub

- Go to Settings > [your name] > iCloud.
- Sign in with your Apple ID.
- Check that iCloud Keychain and Home are both turned on.
- Go to Settings > Home and turn on Use this iPad as a Home Hub.

FAQs

What is a network module for a smart lock?

A network module is an accessory that can be added to a compatible smart lock to enable remote access and control via a network connection. It allows you to lock or unlock your door using a smartphone app or a web interface.

What is the Yale Assure Lock SL with iM1 Network Module?

The Yale Assure Lock SL with iM1 Network Module is a smart lock that allows you to lock and unlock your door using your iPhone, iPad, or Apple Watch, as well as by voice commands with Siri. It also offers keyless entry via a touchscreen keypad.

How does Siri integration work with this lock?

You can use Siri to lock or unlock the door and check the current lock status. Siri commands work when you have an Apple TV (4th Gen or later) or iPad with iOS 10.3 or later set up as a home hub.

Can I control the lock when I'm away from home?

Yes, you can control the lock from anywhere using the Apple Home app or the Yale Secure app when you

have an Apple TV (4th Gen or later) or iPad set up as a home hub.

How do I create and manage access codes for friends and family?

You can create and manage up to 25 unique pin codes for friends and family using the Yale Secure app on your iPhone or iPad. It's easy to delete codes when needed.

What if the lock's batteries run out?

Don't worry about getting locked out due to dead batteries. The lock features a 9V terminal under the keypad for emergency charging.

Does the lock automatically relock itself?

Yes, you can enable the Auto Relock feature from the lock menu settings to ensure that the door locks automatically after a set period.

Is the installation of the Assure Lock SL complicated?

Not at all! The Assure Lock SL can replace your existing deadbolt in just a matter of minutes using only a screwdriver. It fits on doors 1-3/4 inches to 2-1/4 inches thick.

Can I use the Yale Assure Lock SL with iM1 Network Module with multiple iOS devices?

Yes, you can use the lock with multiple iOS devices, such as iPhones, iPads, and Apple Watches, as long as they are running iOS 10.3 or later.

What should I do if I forget my PIN code?

If you forget your PIN code, you can use the Yale Secure app to manage your codes. You can delete the existing code and create a new one.

Does the lock have a warranty?

Yes, the Yale Assure Lock SL comes with a lifetime limited warranty on mechanical and finish, and a 1-year warranty on electronics. Be sure to check the warranty details for more information.

Can I use the lock with Apple HomeKit automation routines?

Yes, you can integrate the lock into your Apple HomeKit automation routines for added convenience and security.



[Download This PDF Link: Valen/AP 2564/2023/03/Short Form Network Model Quick Start Guide 9-1409173089793-rpcbe5-4.mp4](#)

[Manuals+](#)