



Yale ASSYDACCESSKIT YDM Access Kit With Connect Bridge And Module User Manual

[Home](#) » [Yale](#) » Yale ASSYDACCESSKIT YDM Access Kit With Connect Bridge And Module User Manual 

Yale ASSYDACCESSKIT YDM Access Kit With Connect Bridge And Module User Manual



Contents

- [1 Download Yale Access app](#)
- [2 Plug in Yale Access Module](#)
- [3 Pair lock with Yale Access app](#)
- [4 Install Connect Wi-Fi Bridge](#)
- [5 Documents / Resources](#)
- [6 Related Posts](#)

Download Yale Access app

The app requires a minimum operating system of iOS 11 Plus for iPhone, and 8 Plus for Android based phones. Bluetooth 4.0.



IOS SYSTEM: Once you have the app you can press and hold on the app to share the app to other iphone users.

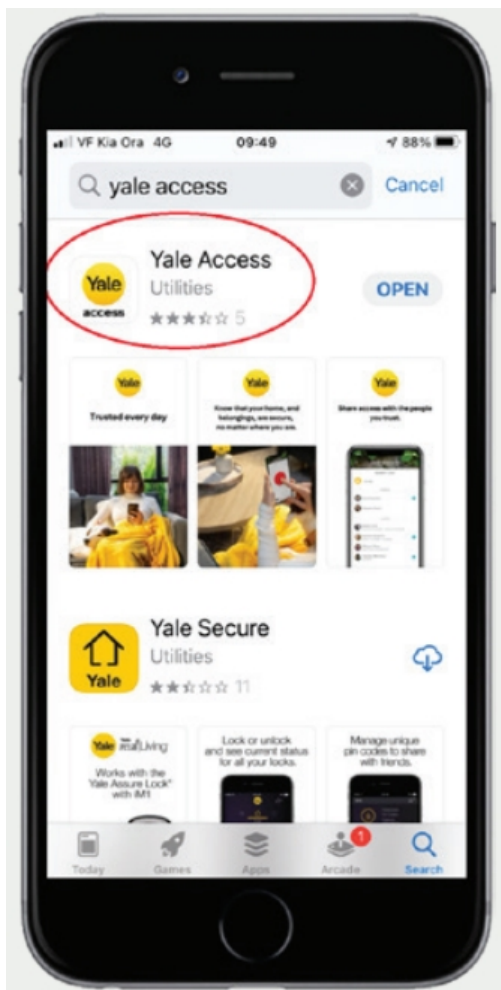

IMPORTANT!

1. Always set up a **master code** at the face of the lock before setting up the app
2. When downloading the app there is a **dual authentication** process required and as part of this you will be sent a text message with a code in it and then you will be sent an email with code in it
3. Always make sure that you set up your phone with the lock and don't try to Install and set up the Connect Wi-Fi Bridge first – **THIS WON'T WORK.**

ANDROID SYSTEM: For an Android based phone you will need to search for the app in the Google app store, you can save a link to this store in your favourites.

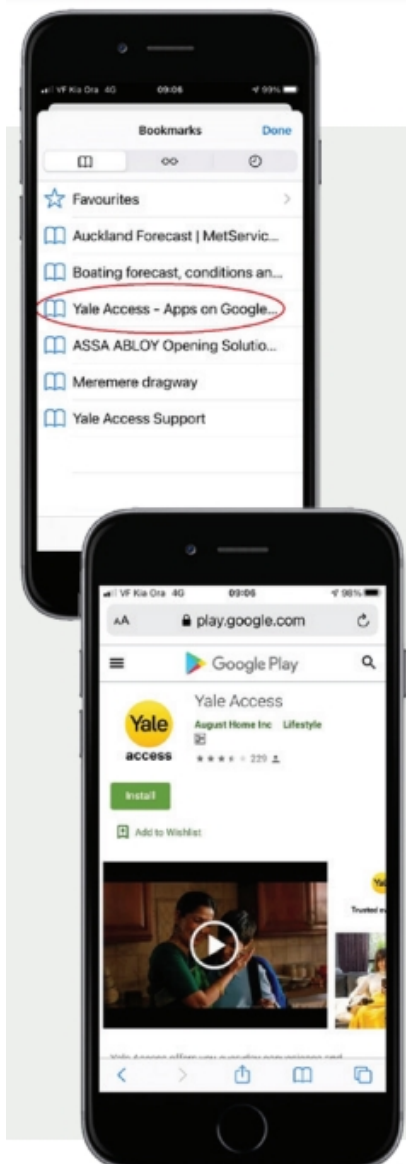

IMPORTANT!

1. Always set up a master code at the face of the lock before setting up the app
2. With Android phone this text message number will auto populate – it's easy to miss this step and you will be trying to put the text number where the email number should go. Read carefully and take your time! (When downloading the app there is a dual authentication process required and as part of this you will be sent a text message with a code in it and then you will be sent an email with code in it)
3. Always make sure that you set up your phone with the lock and don't try to install and set up the Connect Wi-Fi Bridge first – THIS WON'T WORK

Plug in Yale Access Module

Make a note of the **serial number beforehand**, as you may need to use this if the QR code doesn't register or you want to set this up manually.



IMPORTANT!

- The serial number always uses zero's not the letter "O" (See pic 'M210000ELP')
- Always remove at least one battery before inserting the module*



- Input your master code at the face of the lock. Using this master code should allow you to bring up the master menu and the screen will display the numbers 1 and 7. Once in this screen you can register the module by pressing the (7) and then the # symbol. The light on the front of the lock will flash and play a 3 key notes sound to confirm that your Accesss Module is registered to your lock.

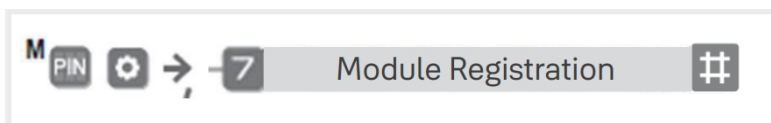



Pair lock with Yale Access app

Just follow the steps in the app and once completed the lock will appear in the home screen as seen in one of the photos above.

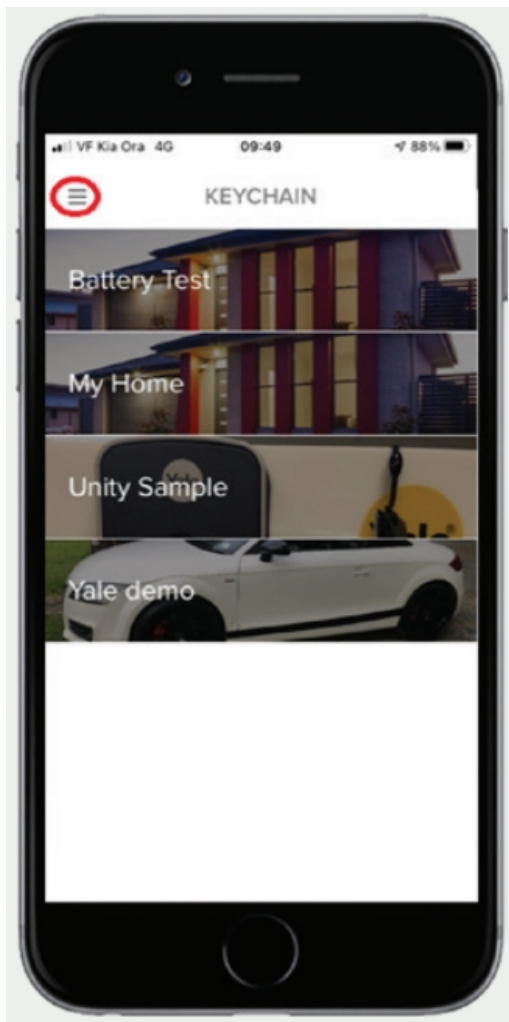

- Open the app and go to the tab at the top left of the home page, once in here press on **“SET UP A DEVICE”**

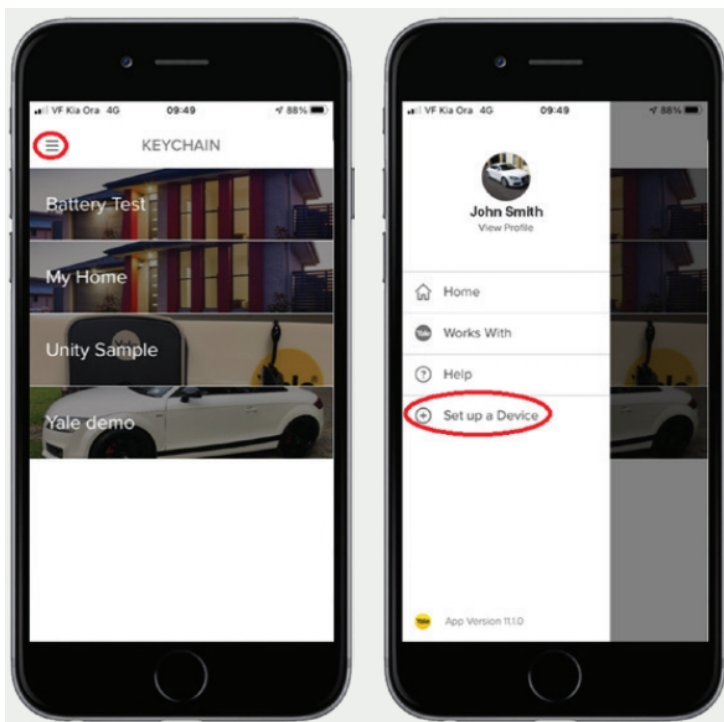

- **Scan the QR** code on the left side of your Access Module.Or to enter a code manually if the lock doesn't have one*

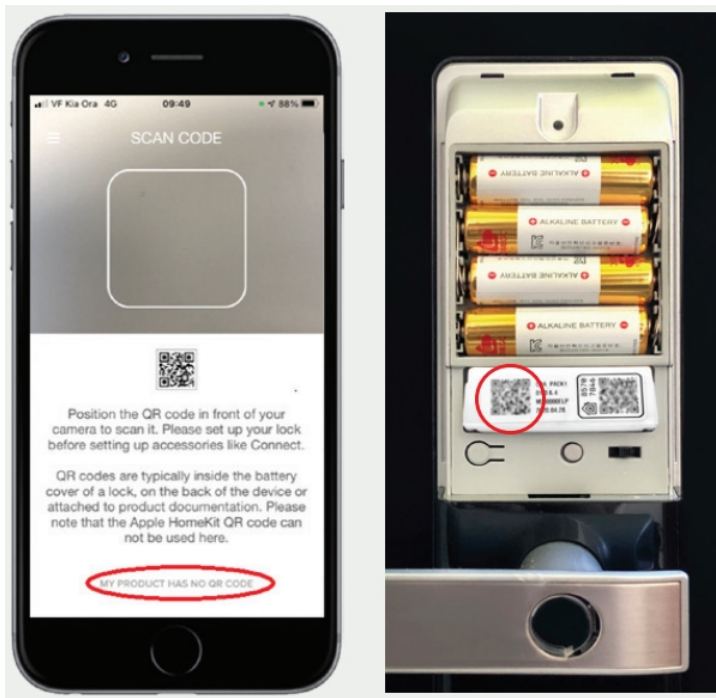

IMPORTANT!

- Scan the code as on the left side of the module **as circled in the picture above**.
The QR code that is not circled and has the image of the house is for APPLE HOME KIT
- *Alternatively, you can select “my product has no QR code” and follow the steps using the Module code you have written down before plugging in the module.

Install Connect Wi-Fi Bridge

Install the Connect Wi-Fi Bridge if you wish to extend the range from Bluetooth to remote access. Please note that before you set it up, make sure your phone is connected to the WiFi using 2.4GHZ*.

Note: Only 2.4GHZ will work with Yale Access



- Open the app and go to the tab at the top left of the home page, once in here press on **“SET UP A DEVICE”**

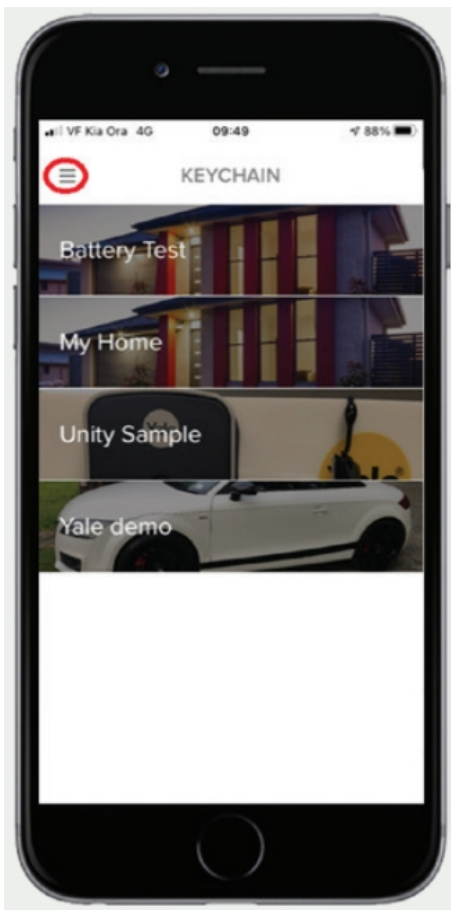

- **Scan the QR** code(or enter the code as circled), then plug the bridge into a power socket within BLE range of the lock. Follow as instructed by the Yale Access app.



IMPORTANT!

- You won't be able to make the connection if you are using **5GHZ**.
- The “**signal appears to be weak**” doesn't affect the bridge's performance, continue past this point until the set up is finished.

Yale is trusted by millions of people every day to keep what's important to them safe.

Our innovations have protected their homes, families and belongings for over 180 years. We have expanded from being a leader in mechanical lock engineering to innovating connected smart locks and homes. Because we

always make every effort to push the boundaries in a changing world.

We were there for your grandparents (and probably theirs) and we'll be there for your children.

ASSA ABLOY is the global leader in door opening solutions, dedicated to satisfying end-user needs for security, safety and convenience.

Trusted every day

ASSA ABLOY New Zealand Limited

6 Armstrong Road, Albany
Auckland 0632, New Zealand
www.yalehome.com.nz

For customer feedback: nzsales@assaabloy.com
Part of ASSA ABLOY

Documents / Resources

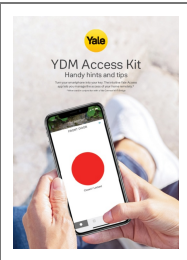
	<p>Yale ASSYDACCESSKIT YDM Access Kit With Connect Bridge And Module [pdf] User Manual</p> <p>ASSYDACCESSKIT YDM Access Kit With Connect Bridge And Module, ASSYDACCESSKIT, YDM Access Kit With Connect Bridge And Module, Module, Bridge</p>
--	---

Manuals+.